

Assembly Manual

Bookcase Headboard

HB002-S

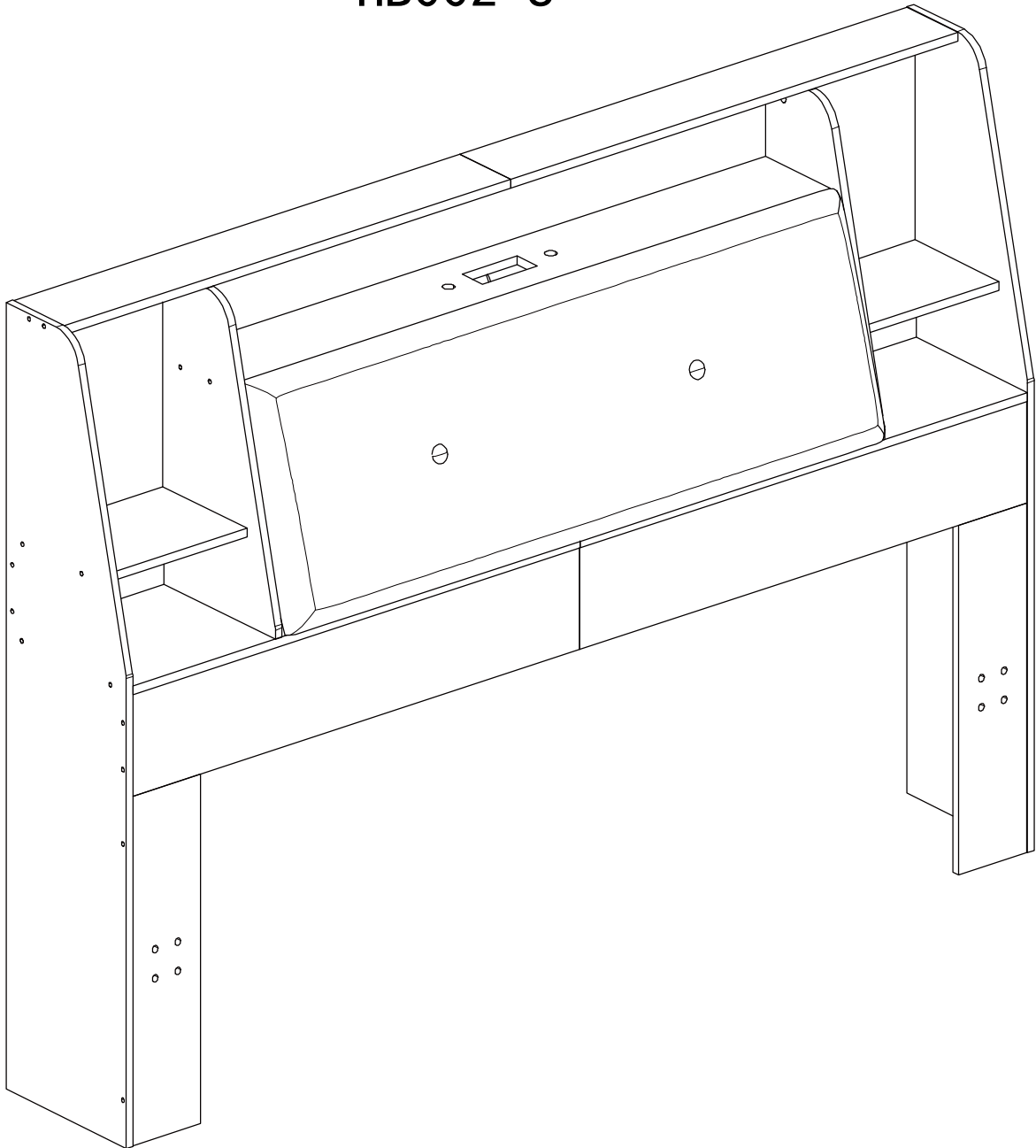

Please read this manual carefully before any operation and keep it properly for future use.

Customer Service: service@sunoft.com

Exploded View

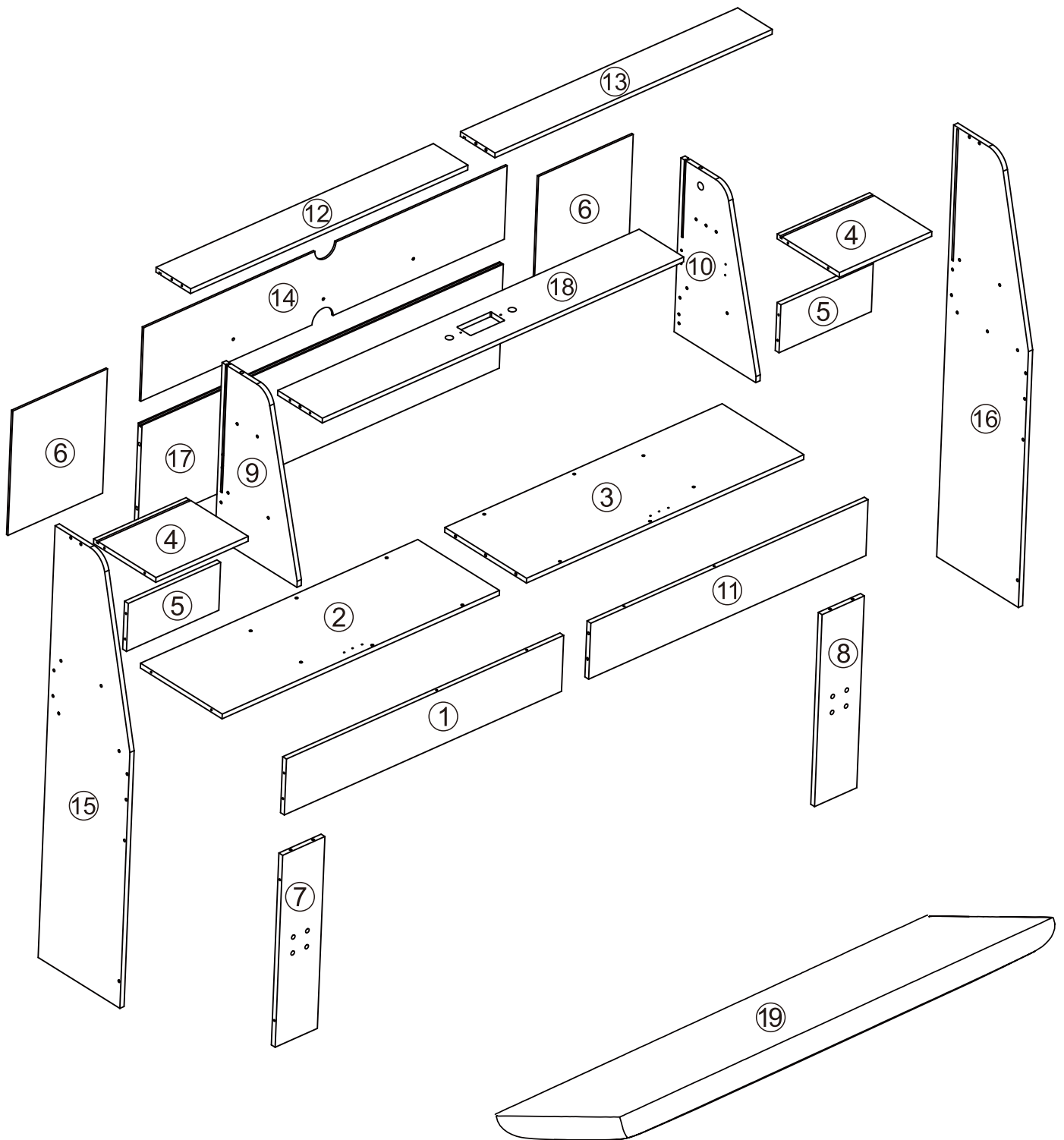

Warnings

ATTENTION:

FUNCTION OF KLIX CAM

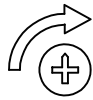

1/2 RIGHT
TURN FOR
LOCKING

MAKE SURE THE ARROW OVER AGAINST THE
TOPSIDE OF CAM LOCK PIN BEFORE
INSERTING INTO THE PANEL'S HOLE

IMPORTANT!

After 180° right turn, if there is a gap
between the boards, please check
whether the cam lock pin is tightened
enough.

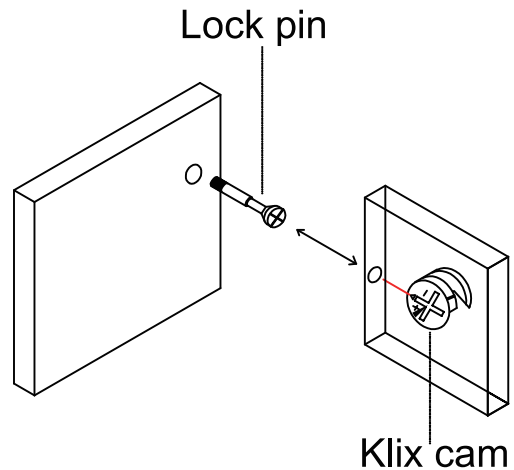

Components List

A retainer*2

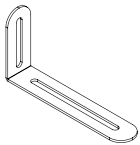

B connecetor*5

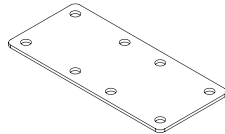

C nut*6



D bolt*6

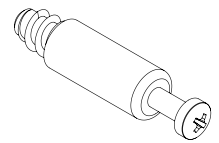

E dowel*13

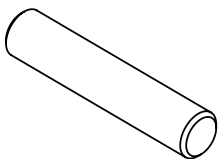

F bolt*52



G bolt*62

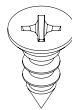

H Allen wrench*1



I screwdriver*1



J plug*1

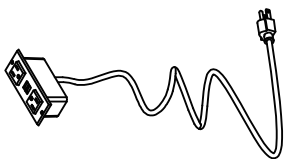

K power

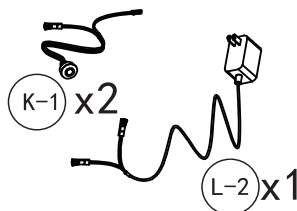

L hinge

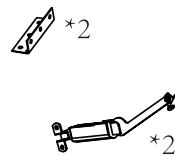

M Corner code*2



Components List

① ×1

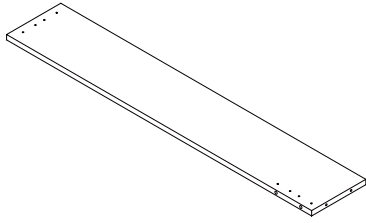

② ×1

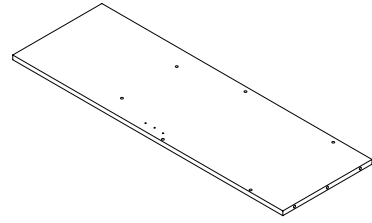

③ ×1

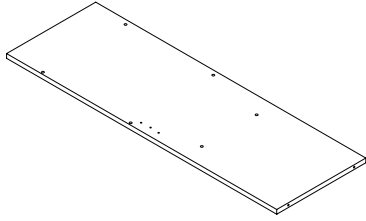

④ ×2

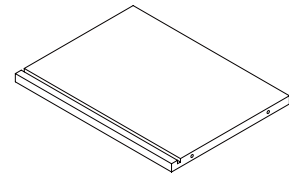

⑤ ×2

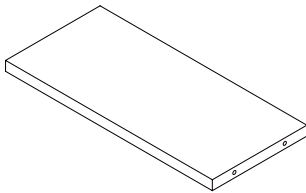

⑥ ×2

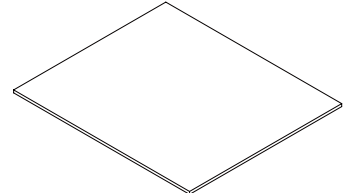

⑦ ×1

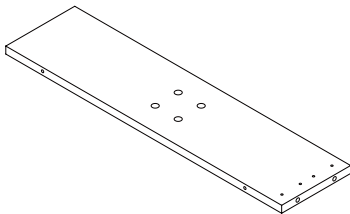

⑧ ×1

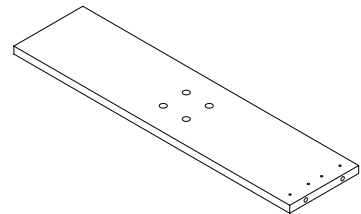

⑨ ×1

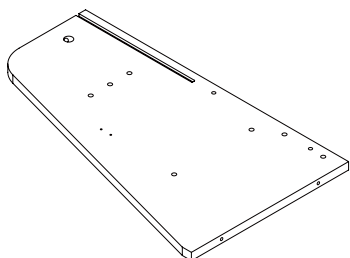

⑩ ×1

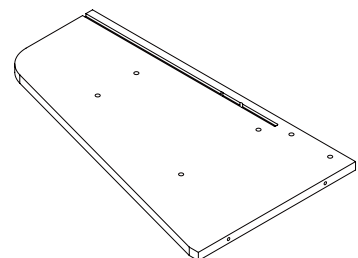

⑪ ×1

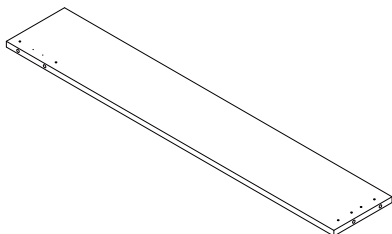

⑫ ×1

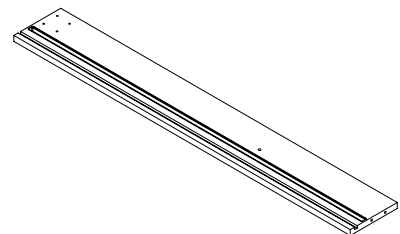

Components List

⑬ × 1

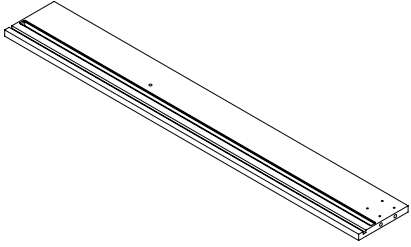

⑭ × 1

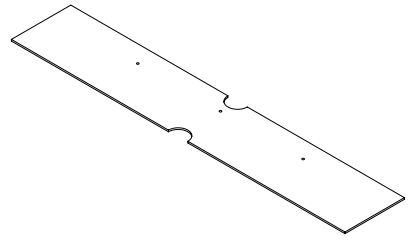

⑮ × 1

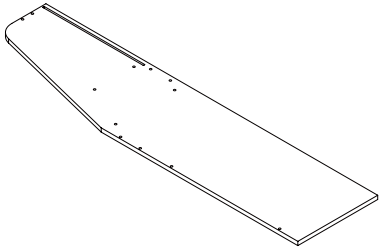

⑯ × 1

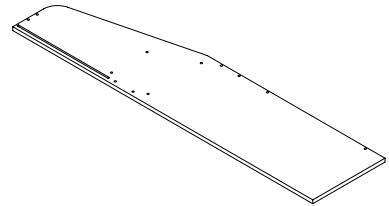

⑰ × 1

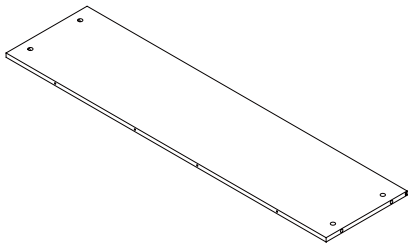

⑱ × 1

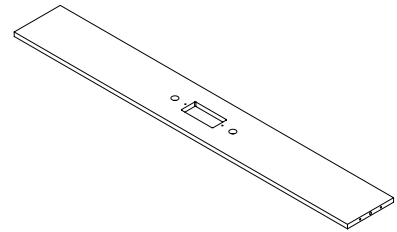

⑲ × 1

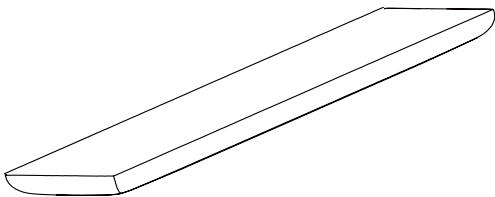

Assembly Instruction

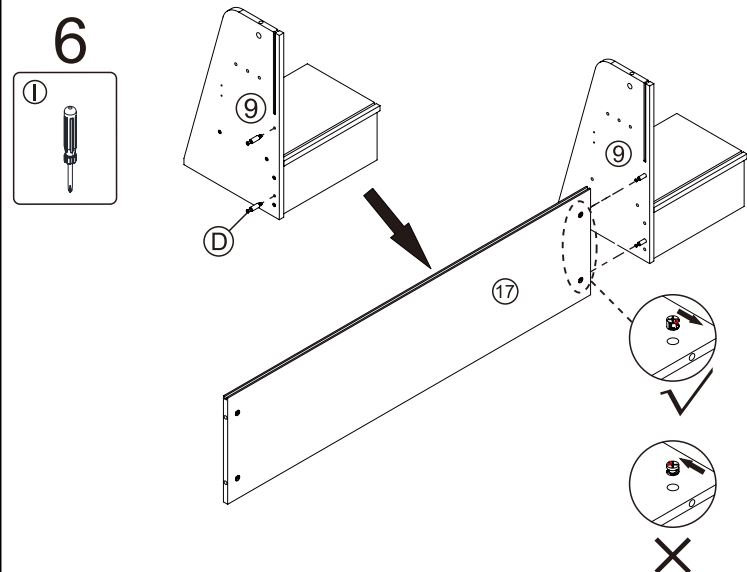
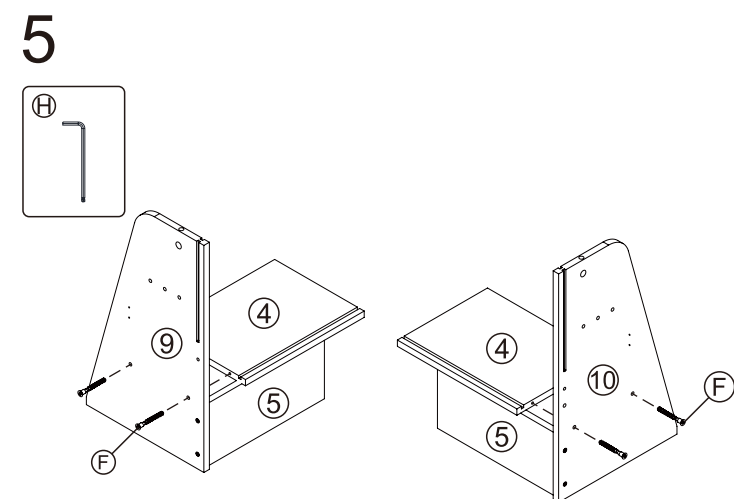
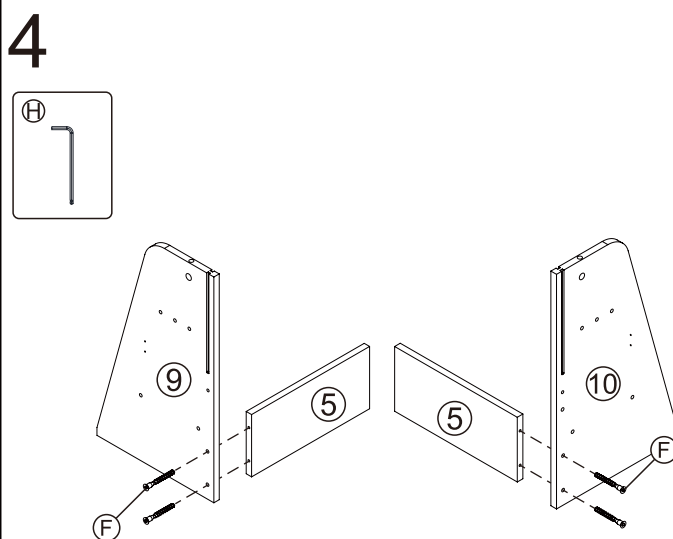
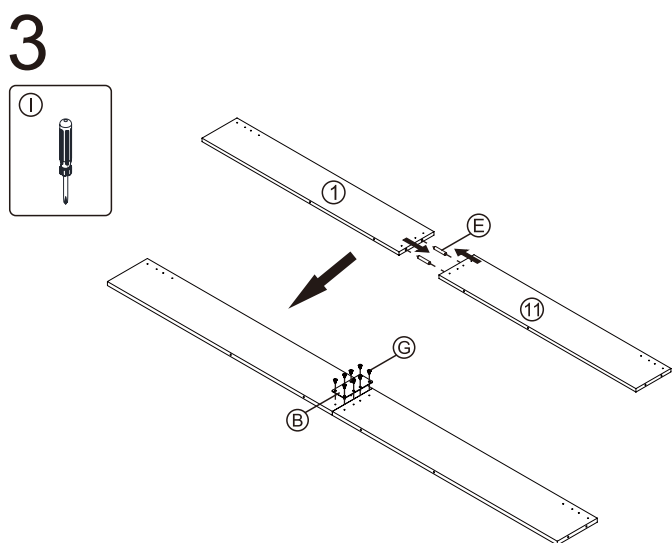
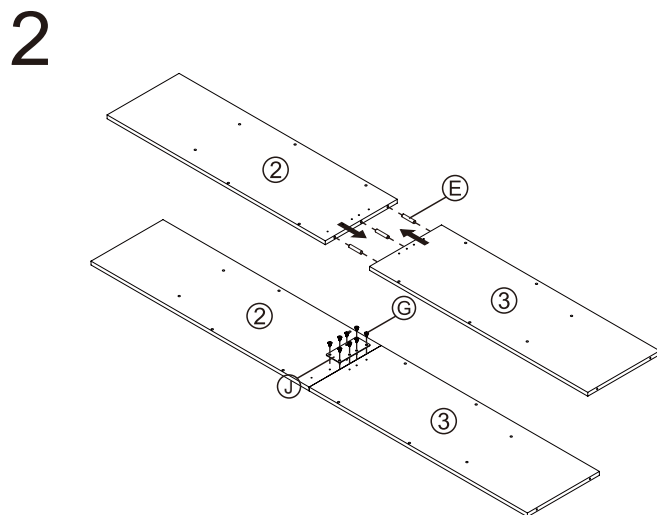
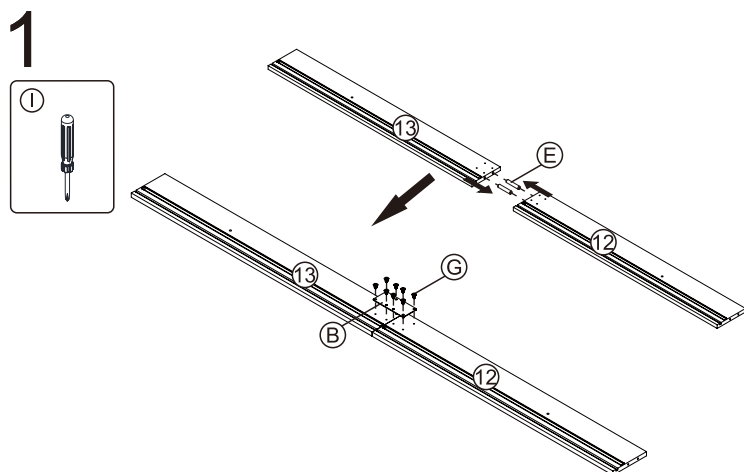

Assembly Instruction

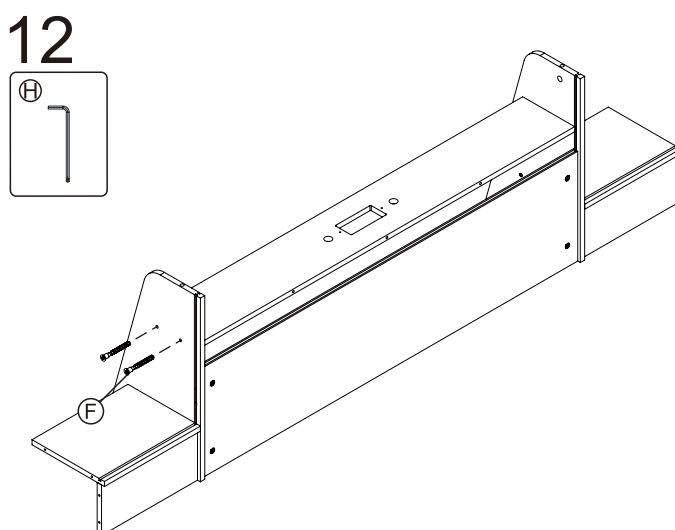
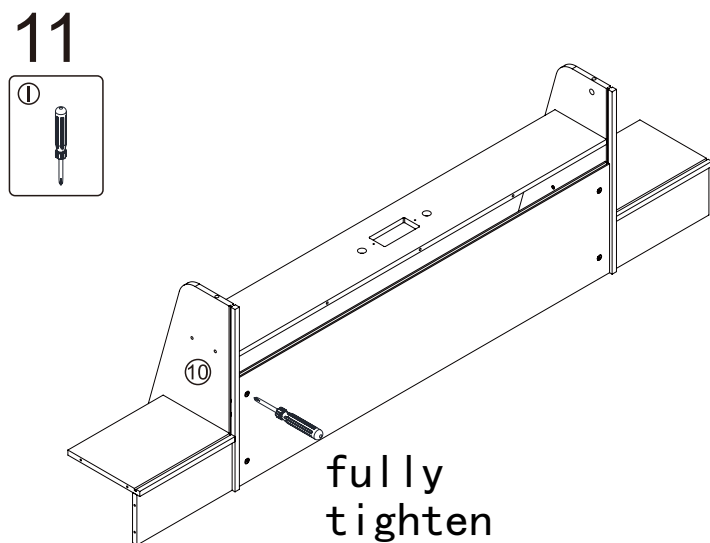
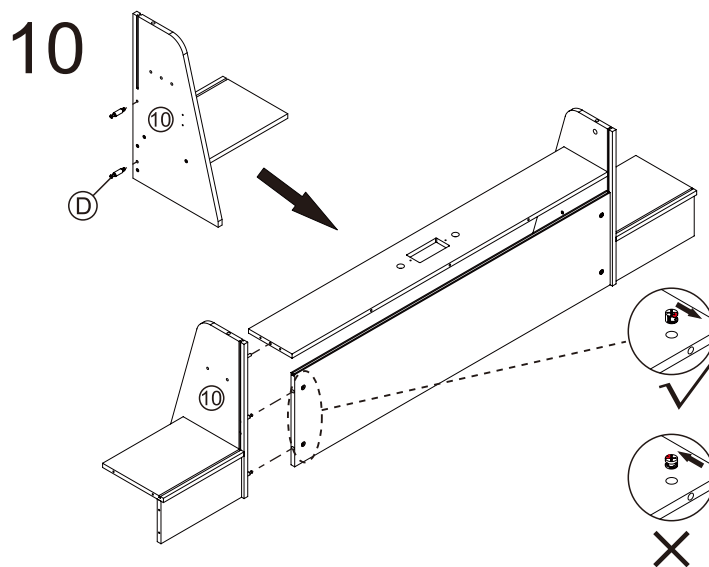
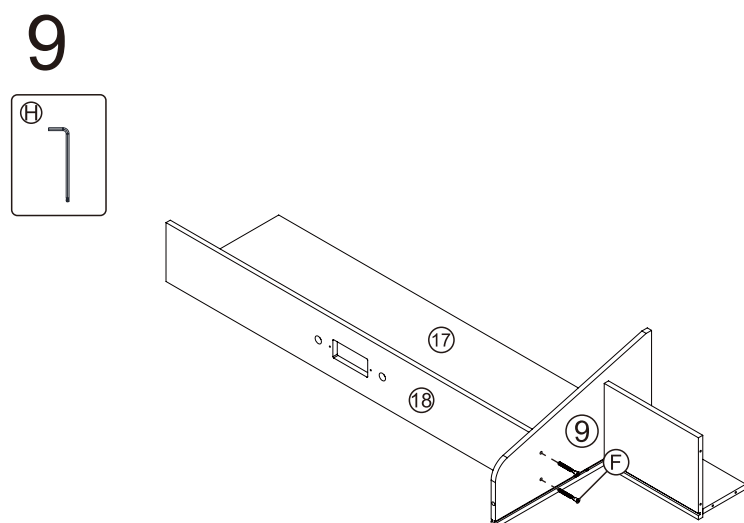
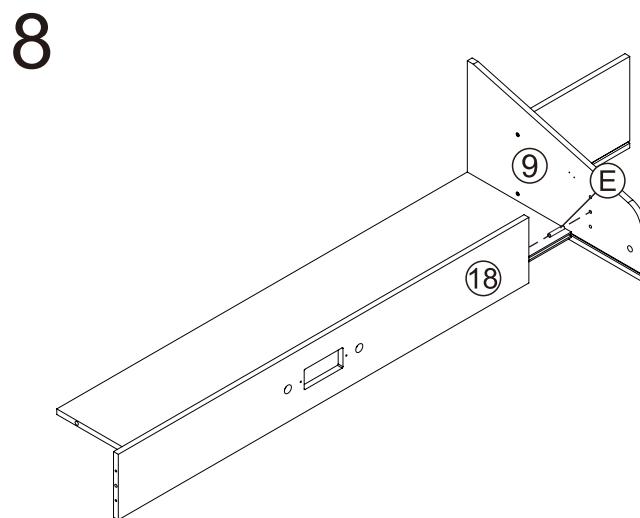
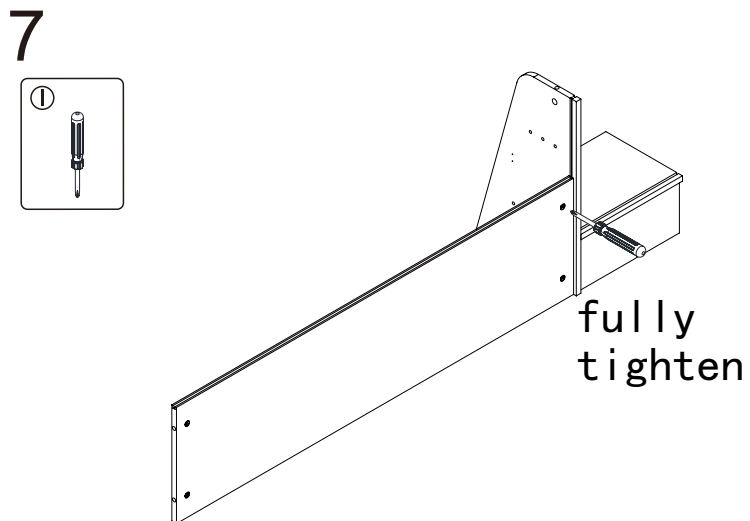

Assembly Instruction

13

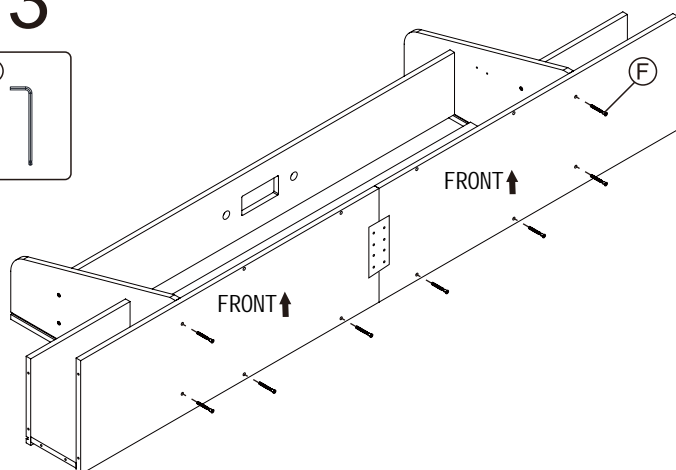
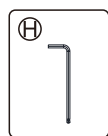

14

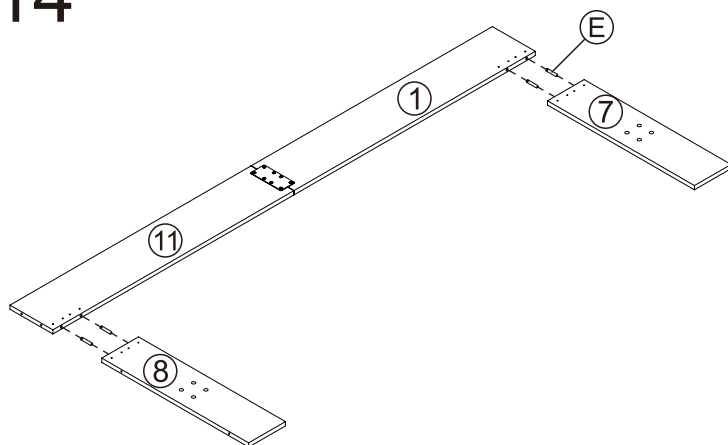

15

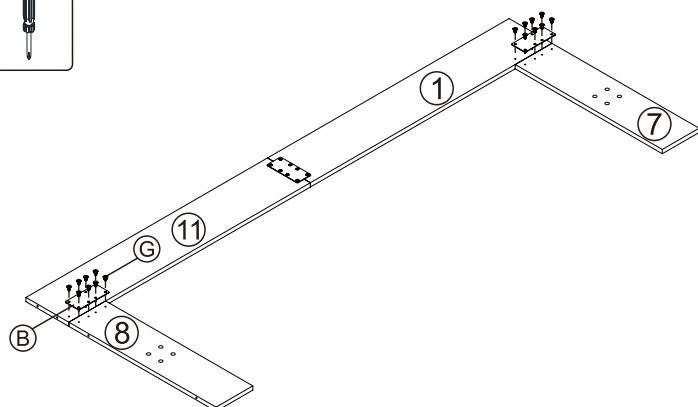
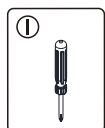

16

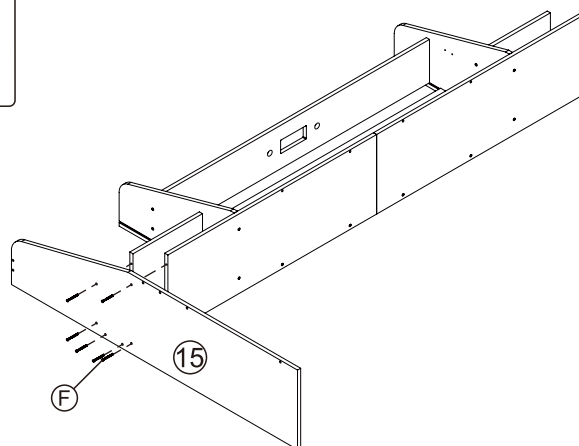
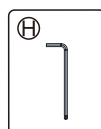

17

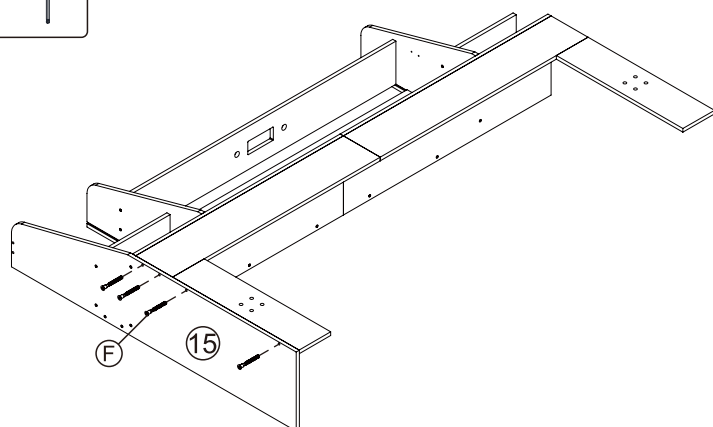

18

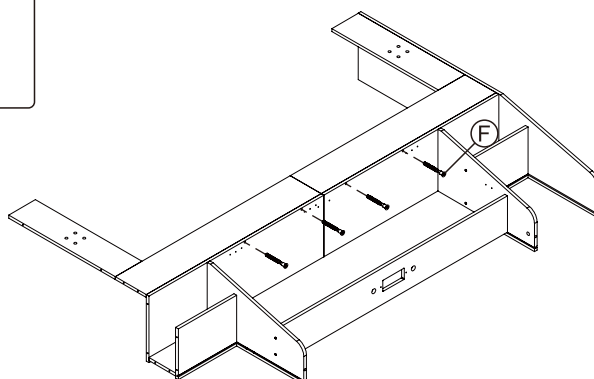

Assembly Instruction

19

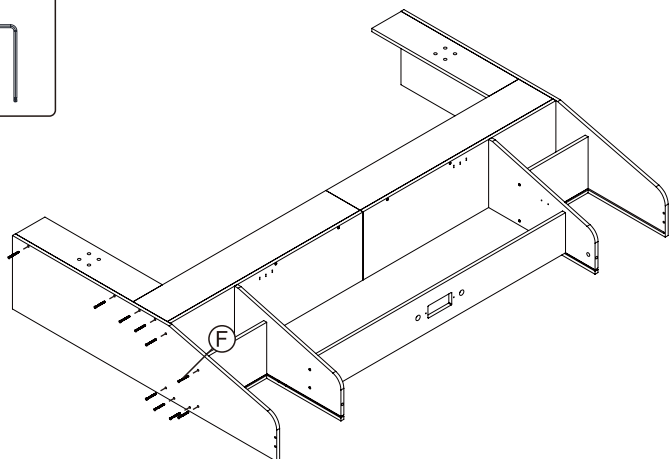

20

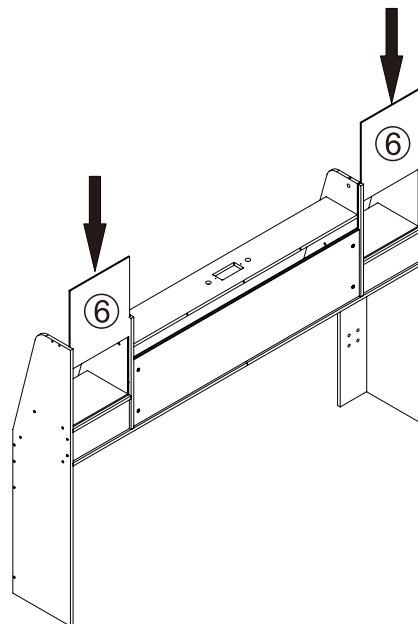

21

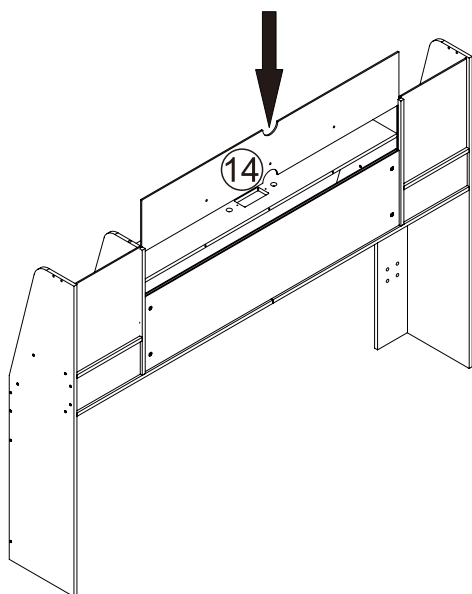

22

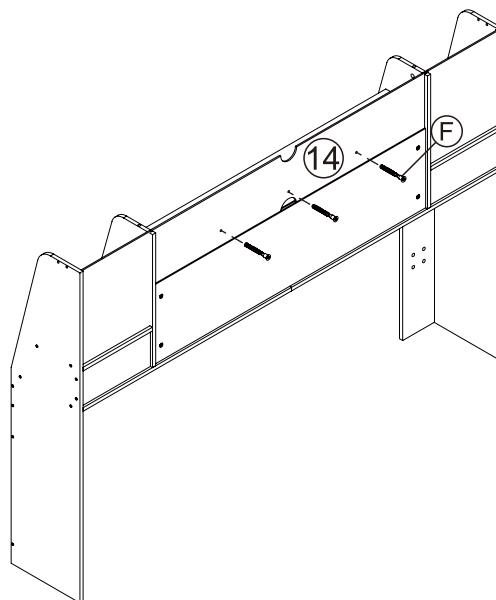

23

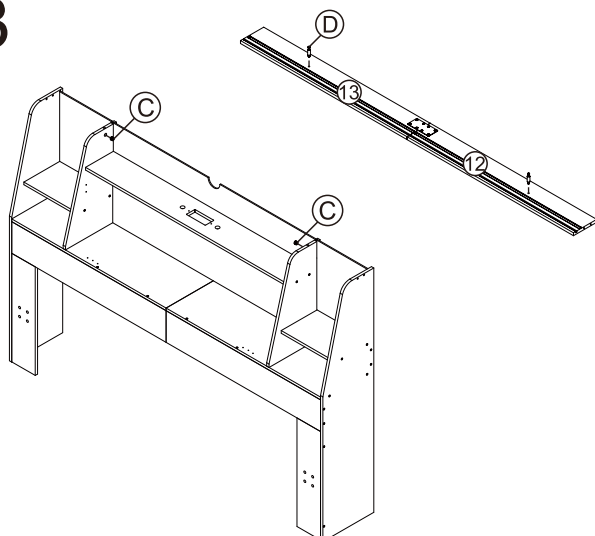

24

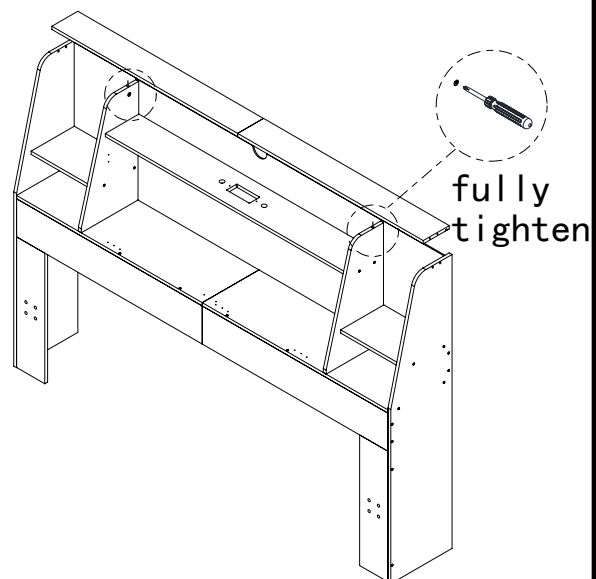

Assembly Instruction

25

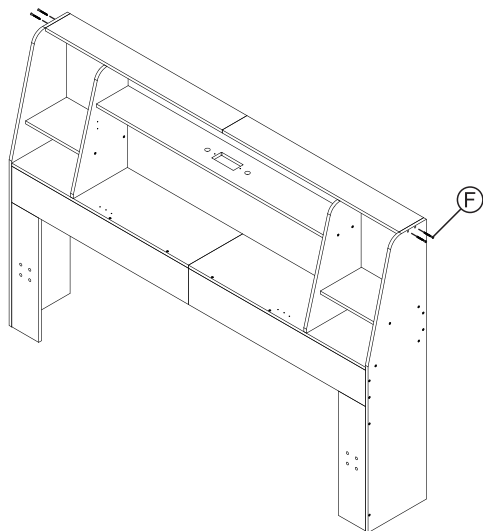

26

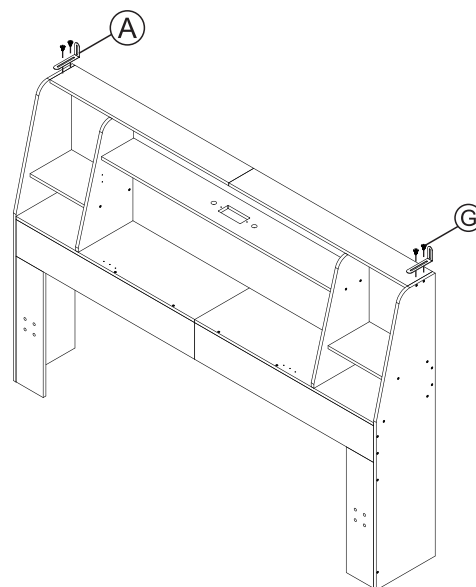

27

Install the plastic corner code between the back plate and the top plate.

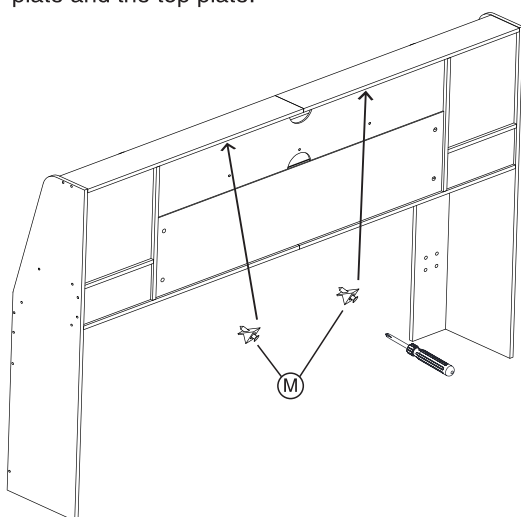

28

Install hinges on plates 9 and 10

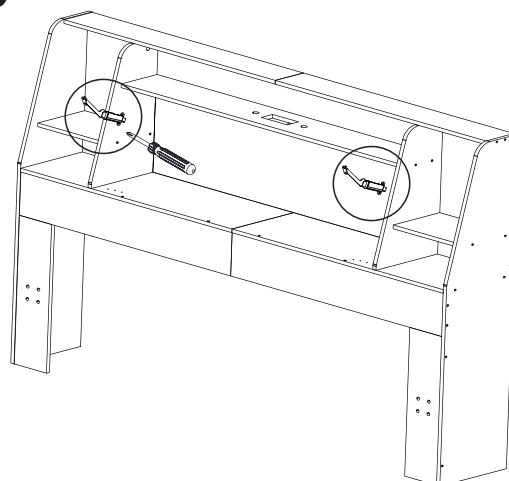

29

Install hinges on board 19.

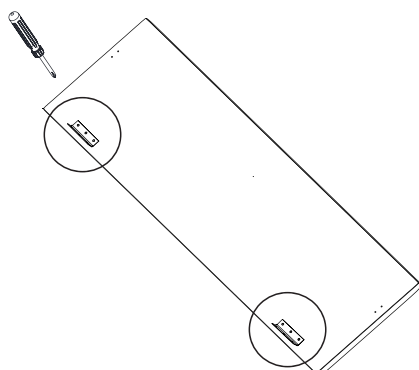

30

Connect part 19 to the cabinet,

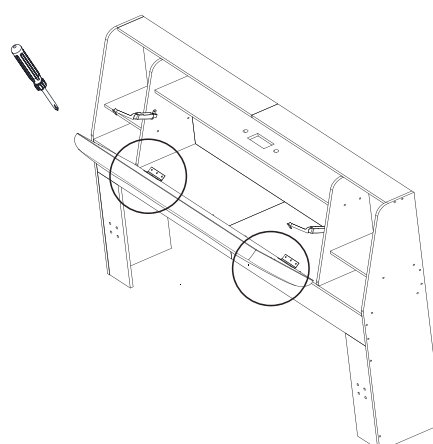

Assembly Instruction

31 Attach the hinges on board 9 and 10 to board 19.

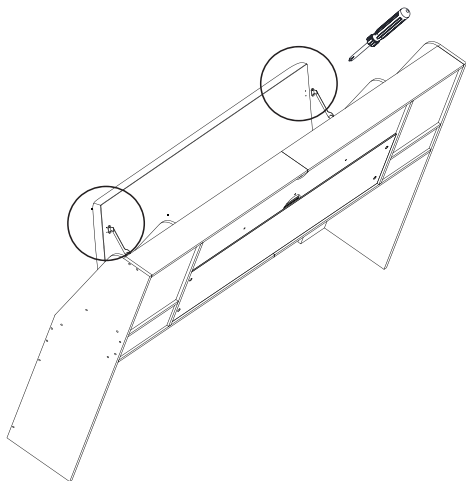

32

Connect the touch dimmer buttons (K-1) to the power cord (K-2). Organize the cables using the tie cables (M) to neatly arrange them. First remove the backing of the tie cables, then push hard to place the cable tie where desired.

