



Achim Home Décor - Peel 'N Stick Hexagon

Vinyl Floor Tiles - Installation Instructions:

Easy Do-It-Yourself Installation!

Tools needed: Utility knife, straight edge, pencil, tape measure and safety glasses.

Tools recommended to install like a pro: 6-foot level, Knee pads, hepa filtered vacuum, heat gun/ hairdryer, dust mask, framer's square, chalk line.

IMPORTANT: Before installing your new tiles, store them at room temperature for at least one day. The installation and maintenance instructions along with the warranty must be read, understood, and followed before installation. Failure to do so may result in an uneven installation, premature wear, gapping, de-bonding, buckling of the flooring, peaked seams, or cupping, and will void the warranty.

DO NOT INSTALL OVER: Cushioned vinyl flooring, carpet, rubber, cork, asphalt tile, paneling, cement board, fiber-based backing boards or any non-underlayment grade panel or flooring. Remove flooring or cover with plywood. If installing plywood, remember to countersink the nails and cover the holes with filler and then completely seal with suitable latex sealer.

Achim Peel 'N Stick Vinyl Floor Tiles are not recommended for walls.

WARNINGS: All local, state and federal regulations must be followed. Always wear safety glasses and respiratory protection to avoid inhaling any dust. Water, trapped beneath any flooring may facilitate mold, mildew and/or fungi growth. Any resulting health issues or property damage is not covered by the warranty. Do not leave spills unattended; wipe up promptly and dry thoroughly.

1. Preparing the Surface:

All floor surfaces must be dry, clean, smooth and level.

- **Cement:** Fill in all cracks and holes with a suitable latex filler and coat all areas with a suitable latex sealer. Not to be installed on untreated cement.
- **Wood:** Make sure all old wooden planks are securely nailed down. Countersink nail heads and cover with latex filler. The surface must be completely clean and free of paint, varnish or wax.
- **Resilient Vinyl:** Remove all dirt, grease, or wax build up. **DO NOT** install new tiles over cushioned vinyl rubber flooring. Remove flooring or cover with plywood. If installing over plywood, remember to countersink the nails and cover holes with filler and completely seal all areas of the wood with a latex floor sealer.

DO NOT INSTALL TILES OVER:

- Any floor exposed to excessively hot or cold temperatures
- Any floor exposed to excessive moisture
- Radiant heated floors
- Particle board



Achim Home Décor - Peel 'N Stick Hexagon

Vinyl Floor Tiles - Installation Instructions:

- Directly over any area treated with a chemical adhesive remover or over existing adhesive residue of any kind (remove or cover prior to installation).

2. To Begin:

You must determine the center point of your room. Measure the center points of opposite walls and secure a chalk line from one to the other. Snap the line. Repeat process with the other set of opposite walls. The point at which the chalk lines intersect is the room's center and the lines have created four equal quadrants. See Figure 1

LAYOUT: It is greatly recommended to perform a layout (with the protective backing in place) with as many full tiles to fill the space and determine which orientation will fit best and to make sure your flooring is equally balanced where it meets the walls, See Figure 2 for orientation. Slight adjustments may be needed to either the room's center point guidelines or your tile's starting point, this depends upon your rooms focal point. For instance, tiles that will be against a threshold should be full and half sized tiles, not small portions of tiles, see Figure 3 A&B. To install hexagon tiles like a pro, make additional parallel guidelines as needed for your layout; lines should coincide with the corners and points on the hexagon tiles as shown in Figure 4. We recommend placing a guideline for every row of tiles to follow. This will help ensure your tiles are evenly placed during installation.

3. Tiles Installation:

Wherever tiles are marked with arrows on the back, install them so that all arrows point in the same direction. Starting at your center point or center guideline as shown in Figure 5, peel off the protective paper and carefully align the tile with the guideline line markings. Press down firmly. (Caution: The tile's protective paper covering is very slippery. To avoid accidents, do not leave paper on the floor after you have peeled it from the tile.) Moving along the guidelines, carefully and firmly align each tile to the guidelines and as tightly as possible against the previously laid tile. Continue placing full/uncut tiles following along your guidelines, as shown in Figure 5. Install tiles to the edges of the room until the main floor area has been covered.

4. Cutting Tiles:

Tiles should be cut with a straight edge and utility knife. Carefully, use a sharp utility knife and a straight edge or framer's square to score the surface. Bend tile downwards at score to snap and then carefully cut protective paper. To fit tiles around irregularly shaped objects, make a pattern of the exposed area with a sheet of paper. Use the paper cutout as a template. Place the paper cutout on the front side of the tile, trace the contours of the paper onto the tile. Carefully cut around the marked contours through the tile. For best results, all cut edges should face the



Achim Home Décor - Peel 'N Stick Hexagon

Vinyl Floor Tiles - Installation Instructions:

wall. If possible, slide cut edges under wall molding or add wall molding over cut edges once all tiles are installed.

5. Maintenance:

While Achim Peel 'N Stick Vinyl Tile floors require minimum maintenance, please follow these guidelines:

- Sweep, damp mop, or vacuum regularly
- Avoid abrasive cleansers
- Use furniture leg coasters
- Occasionally use appropriate vinyl floor cleaner
- DO NOT WAX! This will make the floor's surface too slippery and may cause accidents.

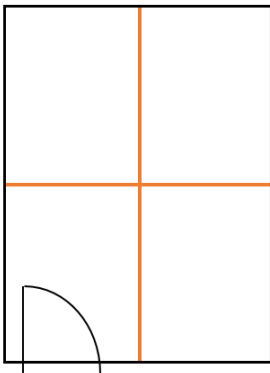

Figure 1

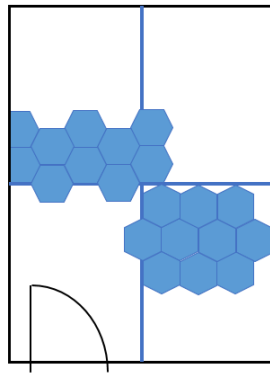

Figure 2 – Decide orientation

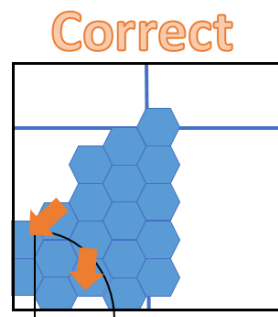

Figure 3A = Correct

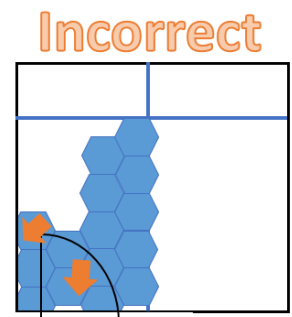

Figure 3B = Incorrect

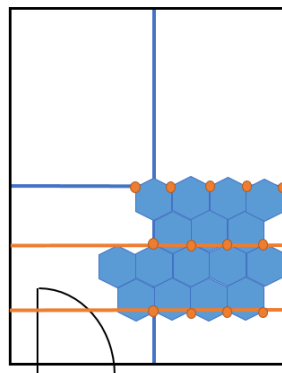

Figure 4

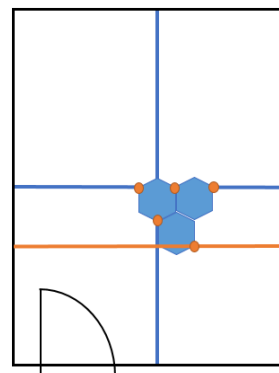

Figure 5