

## Before you begin

1. Check for damaged or missing parts
2. Gather all tools prior to assembly.
3. Use the assembly, surface to prevent product damage during assembly.
4. Do not over tighten.
5. During assembly, as this may damage the product. .  
Do not use power tools.

## Care Instruction

1. Wipe clean with damp cloth
2. Do not use strong detergents or abrasive cleaners, they may damage the surface
3. Check and tighten screws regularly
4. Do not stand on the product, do not use the product as a stepladder
5. Do not put anything hot on the surface.
6. Indoor use only.
7. Questions and concerns about your BALANBO product ? Send email to [wendy123@balanbo.com](mailto:wendy123@balanbo.com)

AFTER SALES SUPPORT

## STEP10

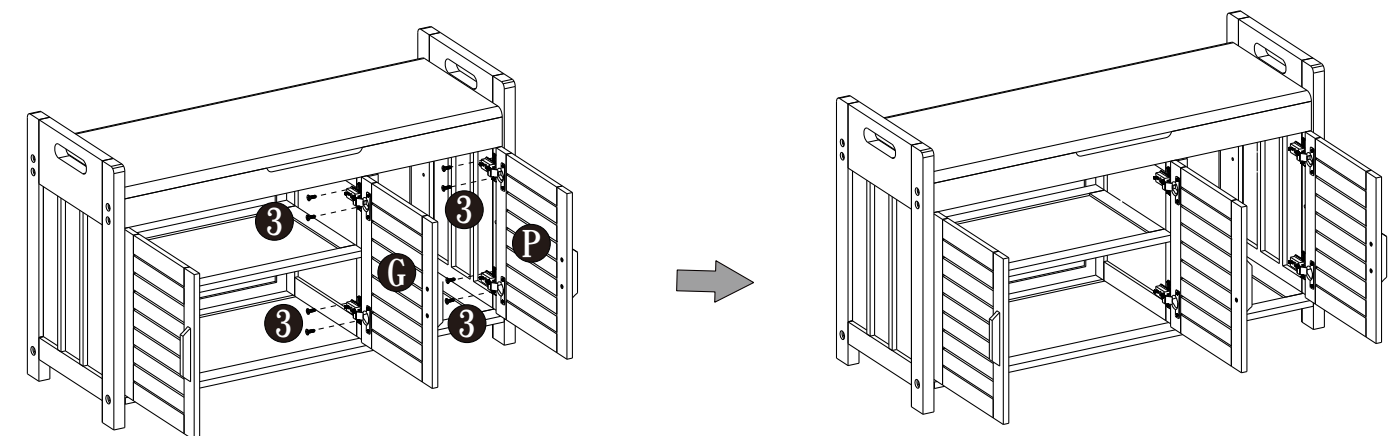

## STEP11

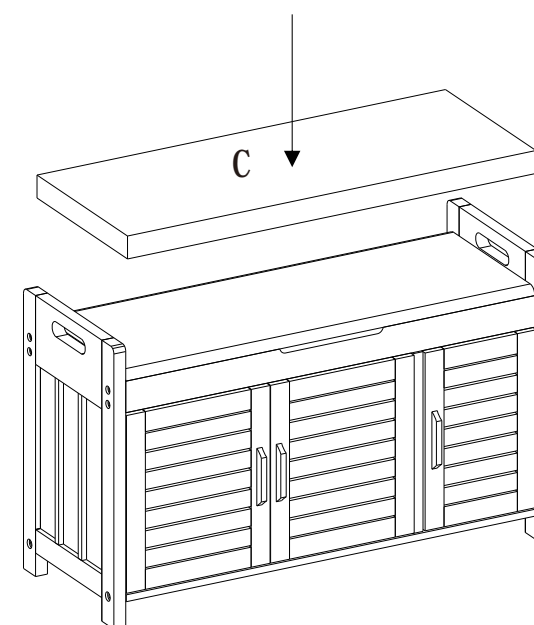

adjust the cabinet door up and down  
adjust screw NO. 1

Adjust cabinet door front and back  
adjust screw NO. 2

Adjust right and left of cabinet door  
adjust screw NO. 3

AFTER SALES SUPPORT

## STEP7

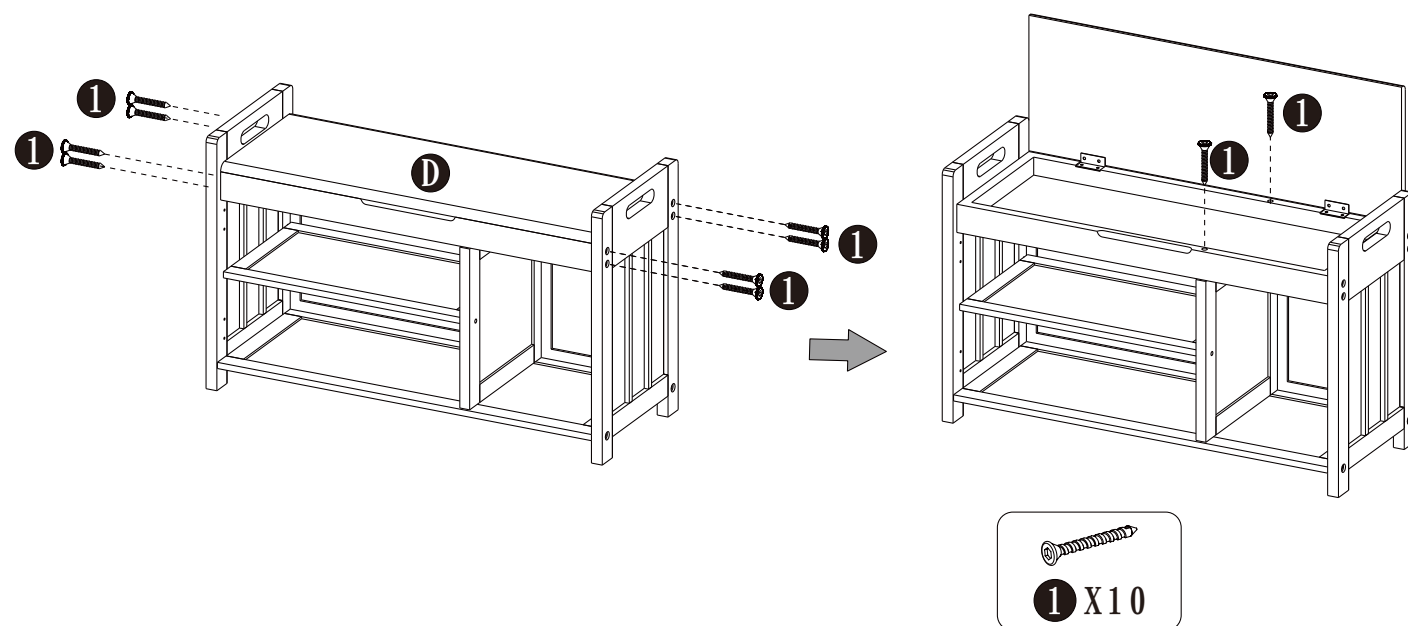

## STEP8

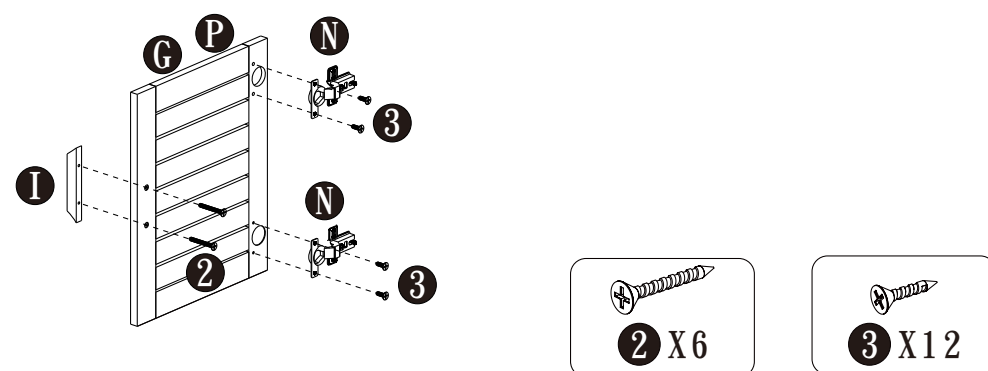

## STEP9

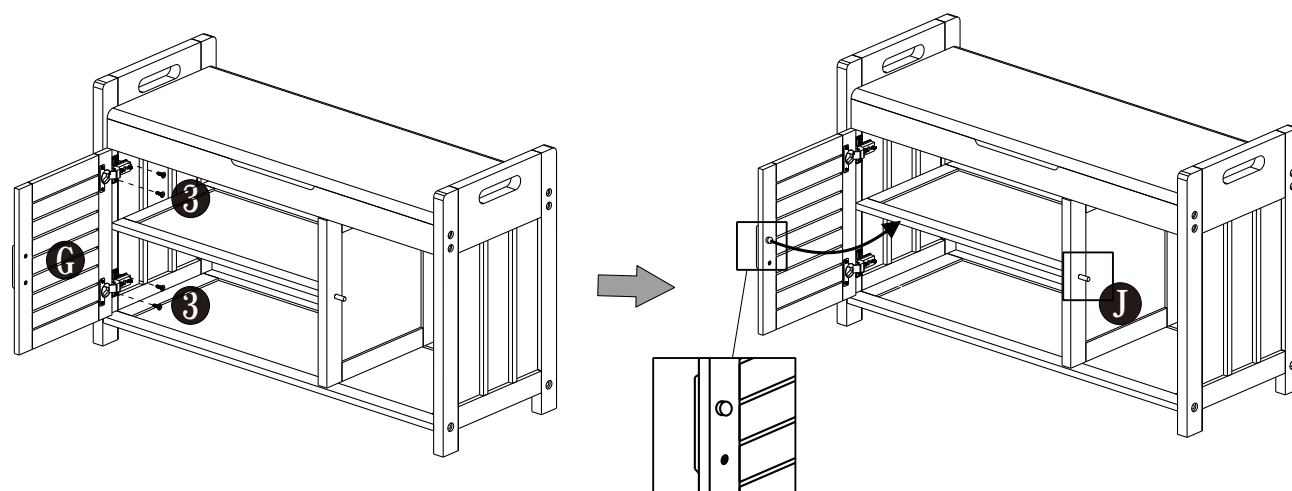

AFTER SALES SUPPORT

## Part List

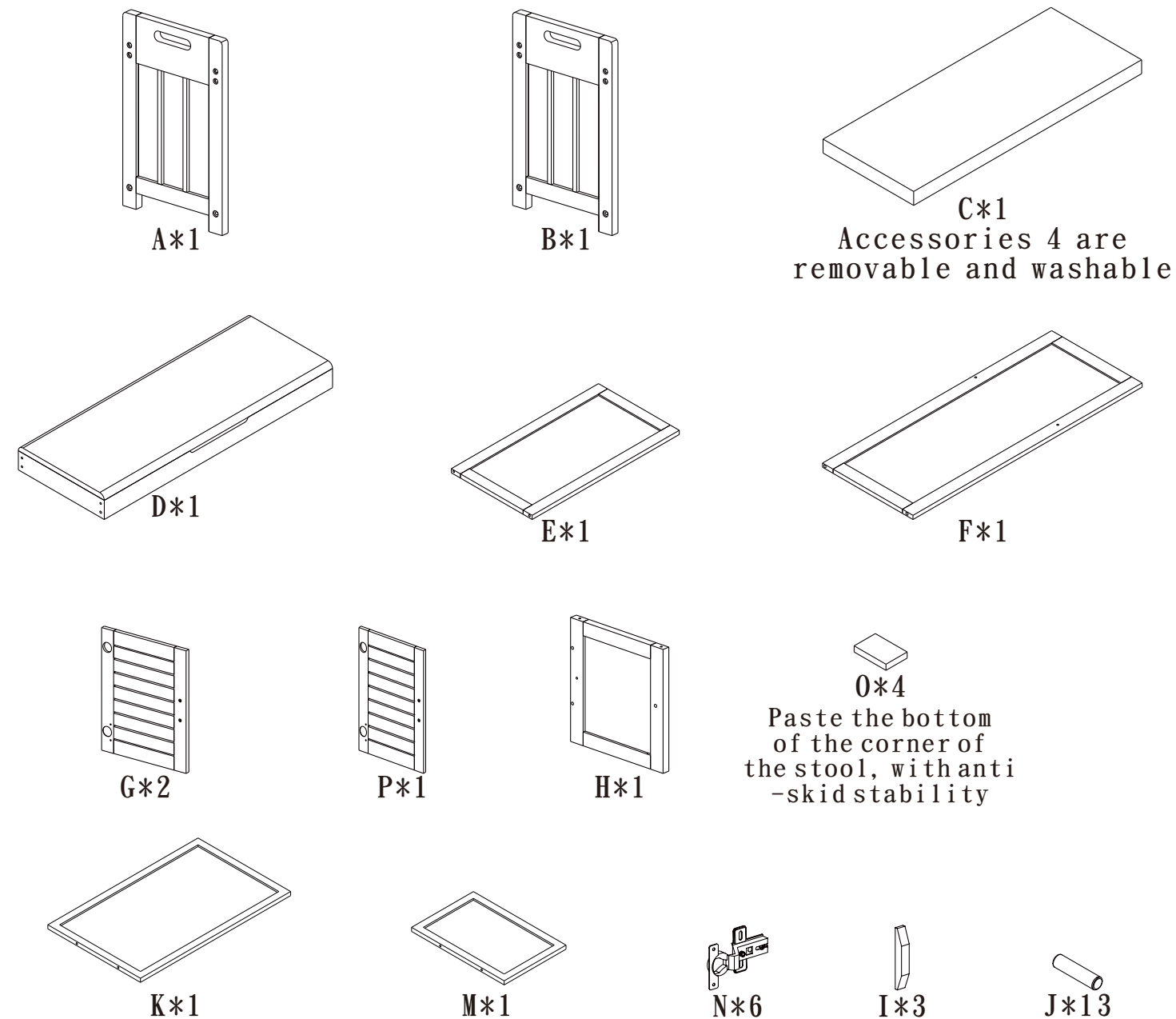

## Hardware List

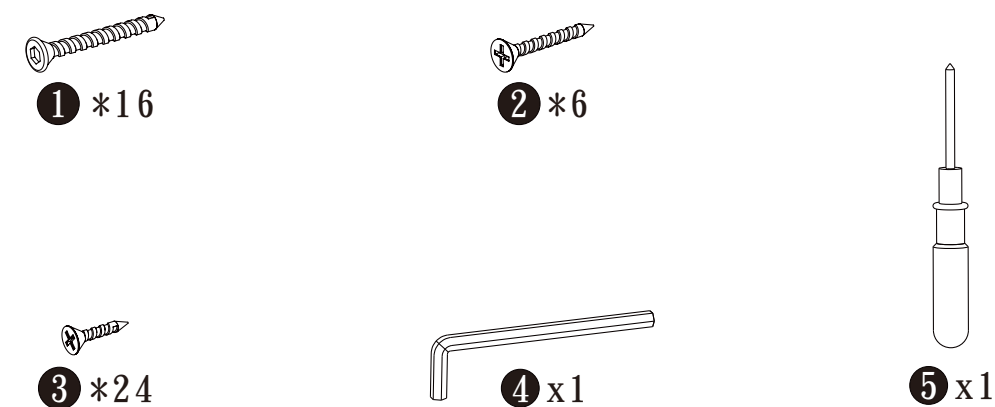

AFTER SALES SUPPORT

STEP1

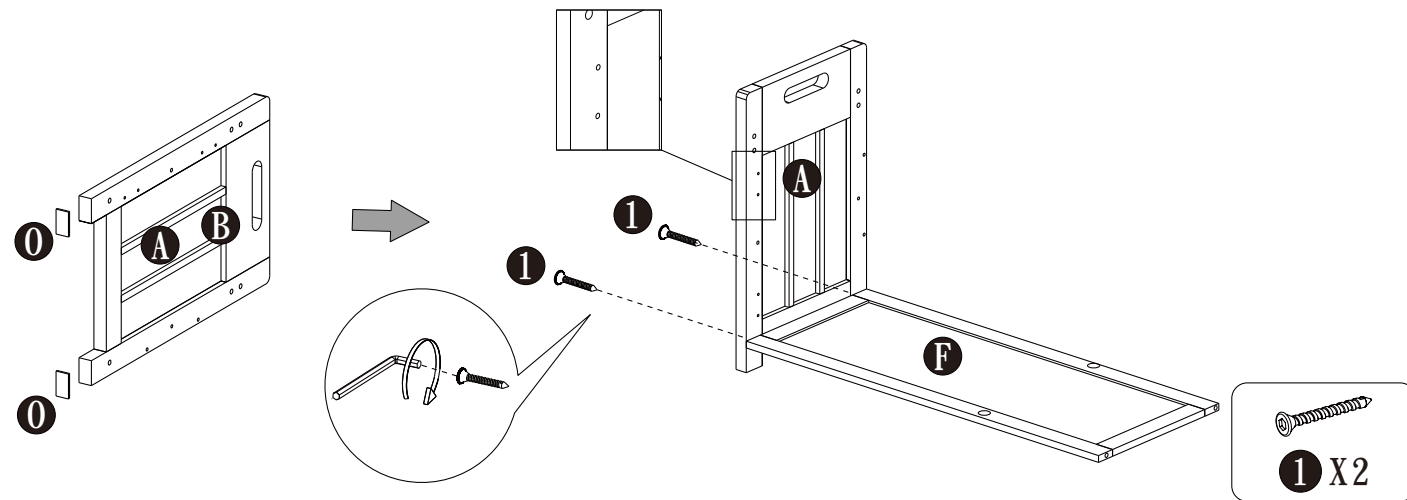

STEP2

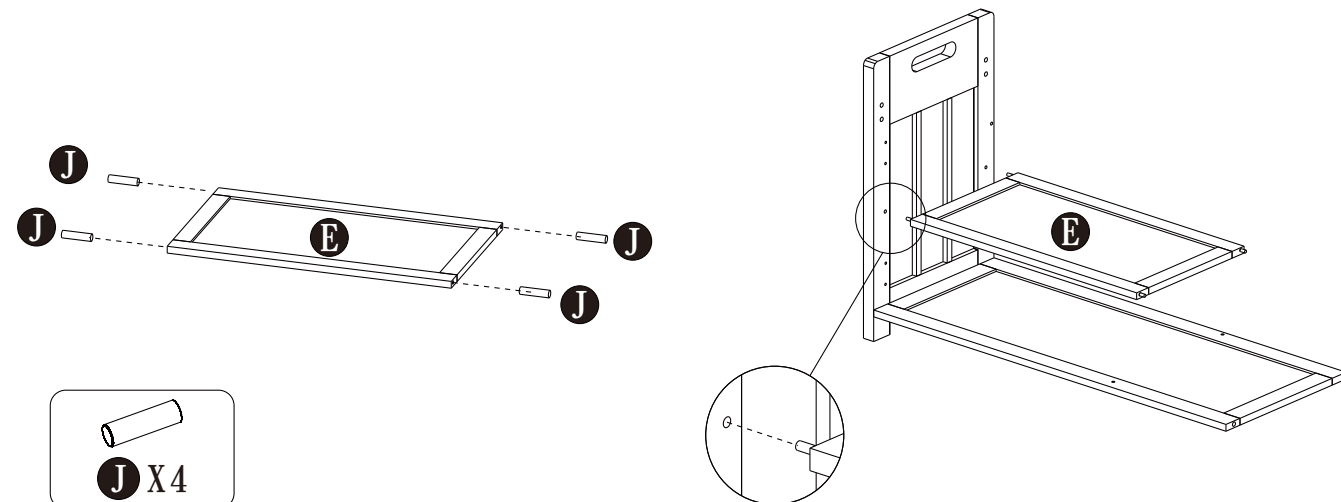

STEP3

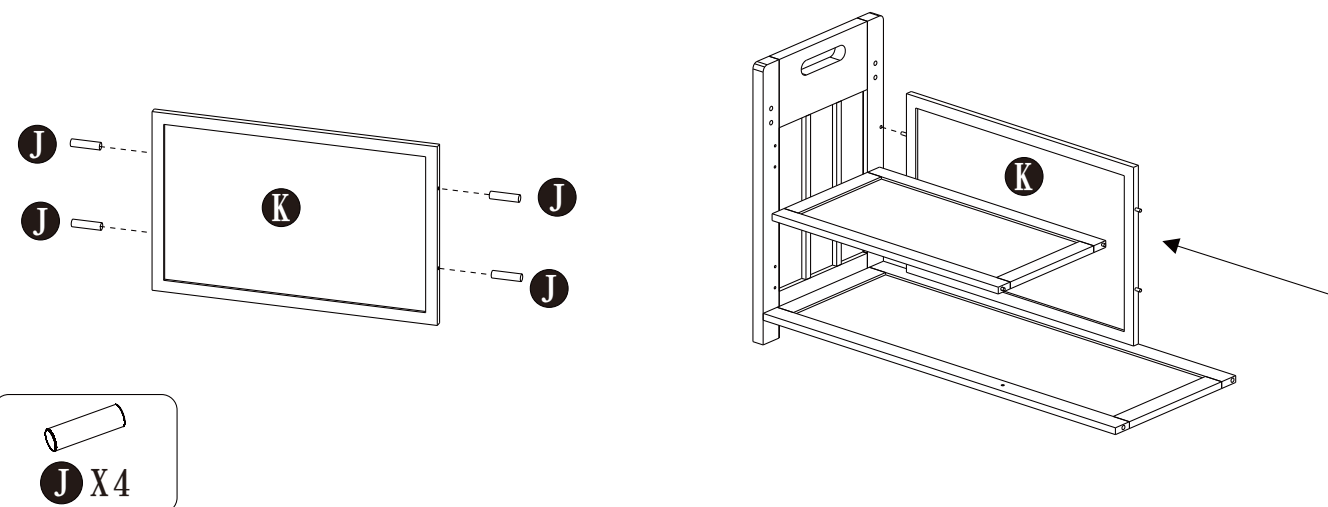

AFTER SALES SUPPORT

STEP4

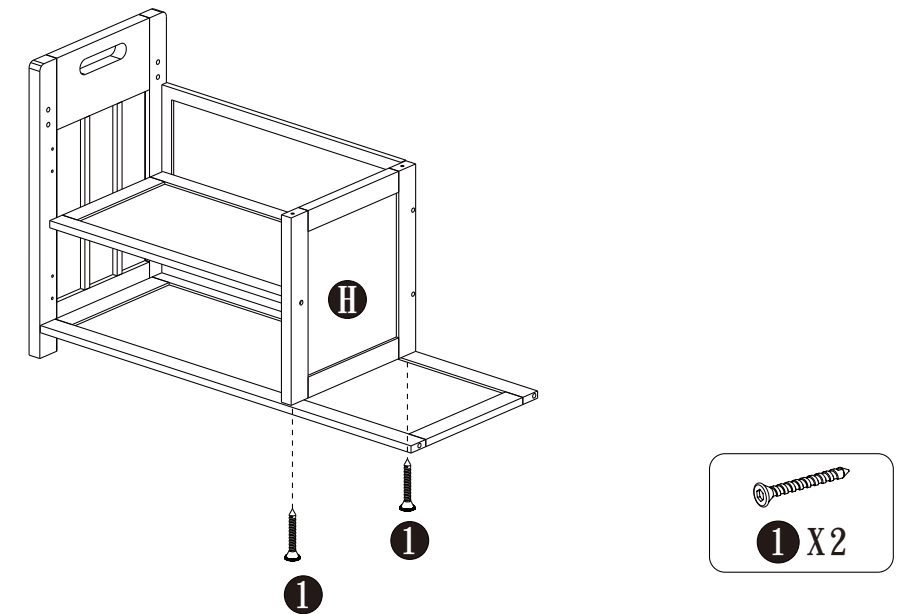

STEP5

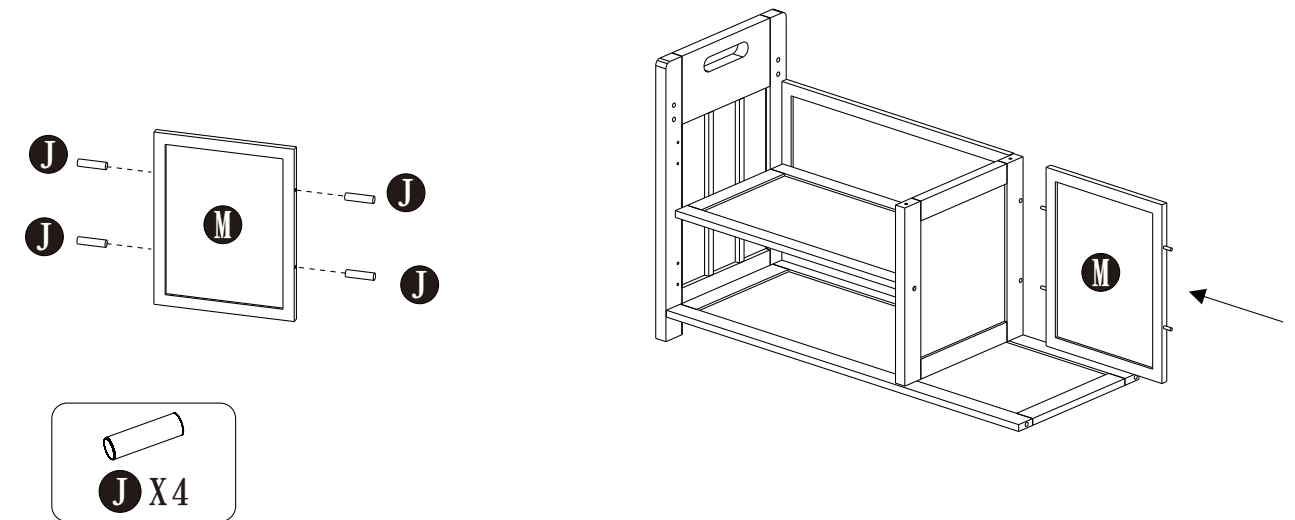

STEP6

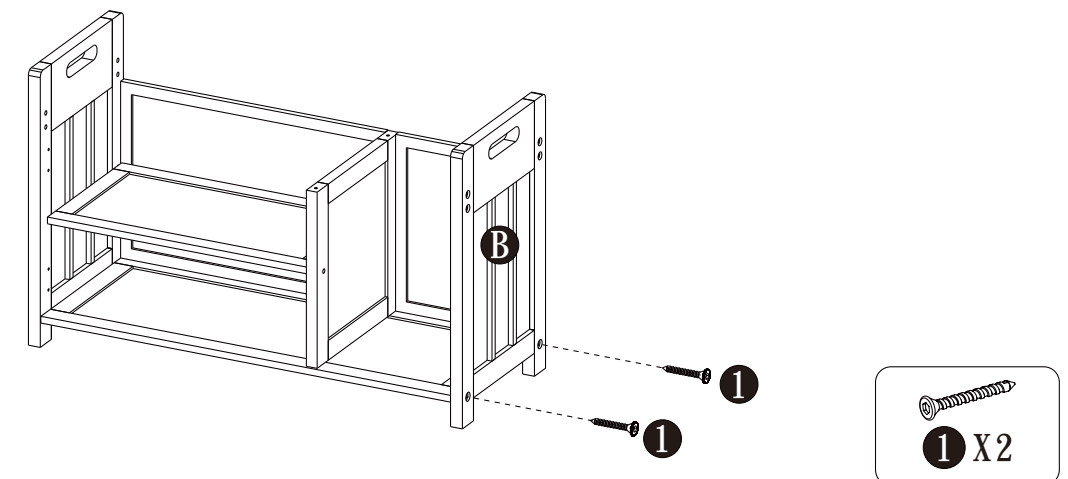

AFTER SALES SUPPORT