



Leaders in Reception Seating

Lesro Industries, Inc.
1 Griffin Road South
Bloomfield, CT
06002

Phone
860.243.3226
Fax
860.243.5392
www.lesro.com

Assembly Instructions

Mystic and Chat Benches & Scooters

Tools required: Allen wrenches (included in hardware pack)

Note: These instructions are intended for various models and configurations. Your products may not look exactly as those shown in the diagrams.

Important: The assembly process requires that some hardware be kept loose until later in the sequence. Follow these instructions closely to ensure correct assembly.

Recommendation: Retighten all bolts on a seasonal basis to ensure your product remains strong and stable for many years of use.

Weight Capacity: Single 275 lbs. Double 550 lbs. Triple 550 lbs.

Parts List

Seat Cushion
Leg Frames, 2 pcs.
Center Support Tube

Hardware Pack

1/2" Allen Bolts, 2 pcs.
1 5/8" Allen Bolts, 8 pcs.
Allen Wrenches, 2 pcs.

Figure 2

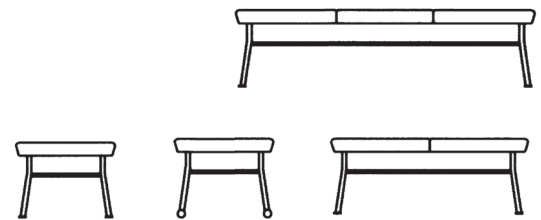
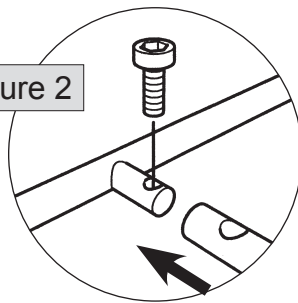

1. Unpack and identify all parts. **Note:** Leg frames are interchangeable - no left or right.
2. Connect the center support tube between the two leg frames as shown in figure 1. Attach at each end using 1/2" Allen bolts as shown in figure 2. Keep bolts slightly loose for now.
3. Place the seat cushion upside down on a clean surface.
4. Place leg frame assembly on seat cushion as shown in figure 1. Align holes and attach using 1 5/8" Allen bolts. Tighten these bolts securely.
5. Securely tighten the 1/2" Allen bolts connecting center support tube to leg frames from step 2.
6. Your product is now assembled and ready to use.

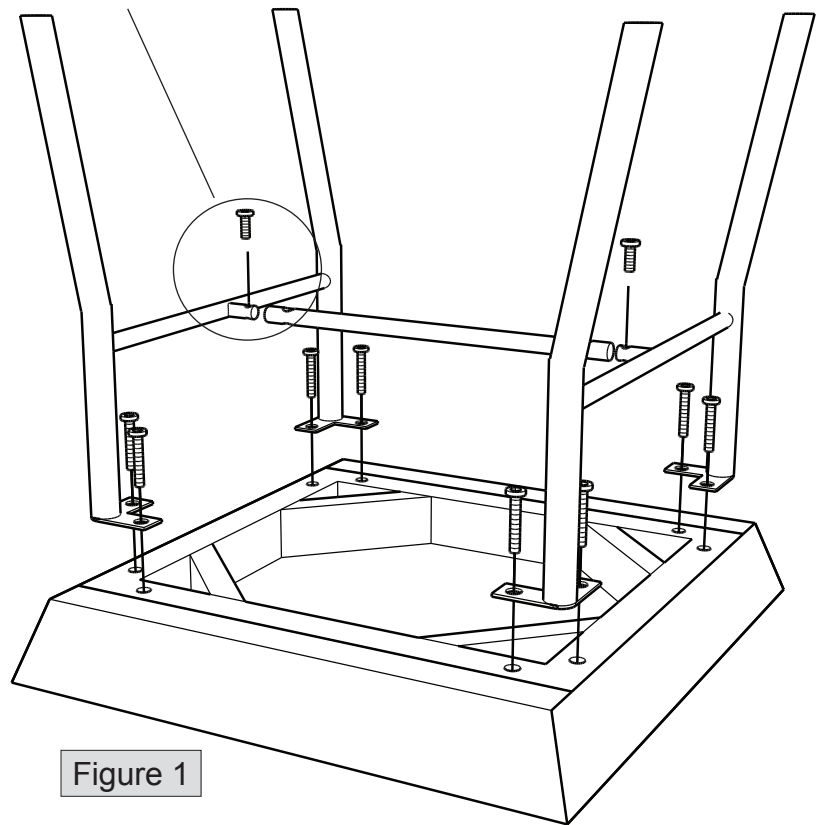

Figure 1

Thank you for purchasing a Lesro product.
Need assistance with assembly? Call Lesro customer service 1-800-275-7545.
Visit us on-line at www.lesro.com