

ceiling fan installation manual

READ AND SAVE THIS MANUAL

Warning:To reduce the risk of fire,electrical shock or injury to persons,please observe the following:

- 1.Installation must be carried out by qualified wiring installer**
- 2.Turn off electrical source before installing**
- 3.Make sure the power supply range is 220v-250v~,50Hz**
- 4.The ceiling must be able to withhold a minimum weight of 30kgs**
- 5.The ceiling fan must be mounted to a minimum height ceiling of 9'(2.3 meter) from the floor**
- 6.Do not place any objects to the path of the blades**
- 7.Make sure that all screws and connections are tightly screwed and secured**
- 8.When all electrical connections are done,store all wires neatly**

complete exploded view

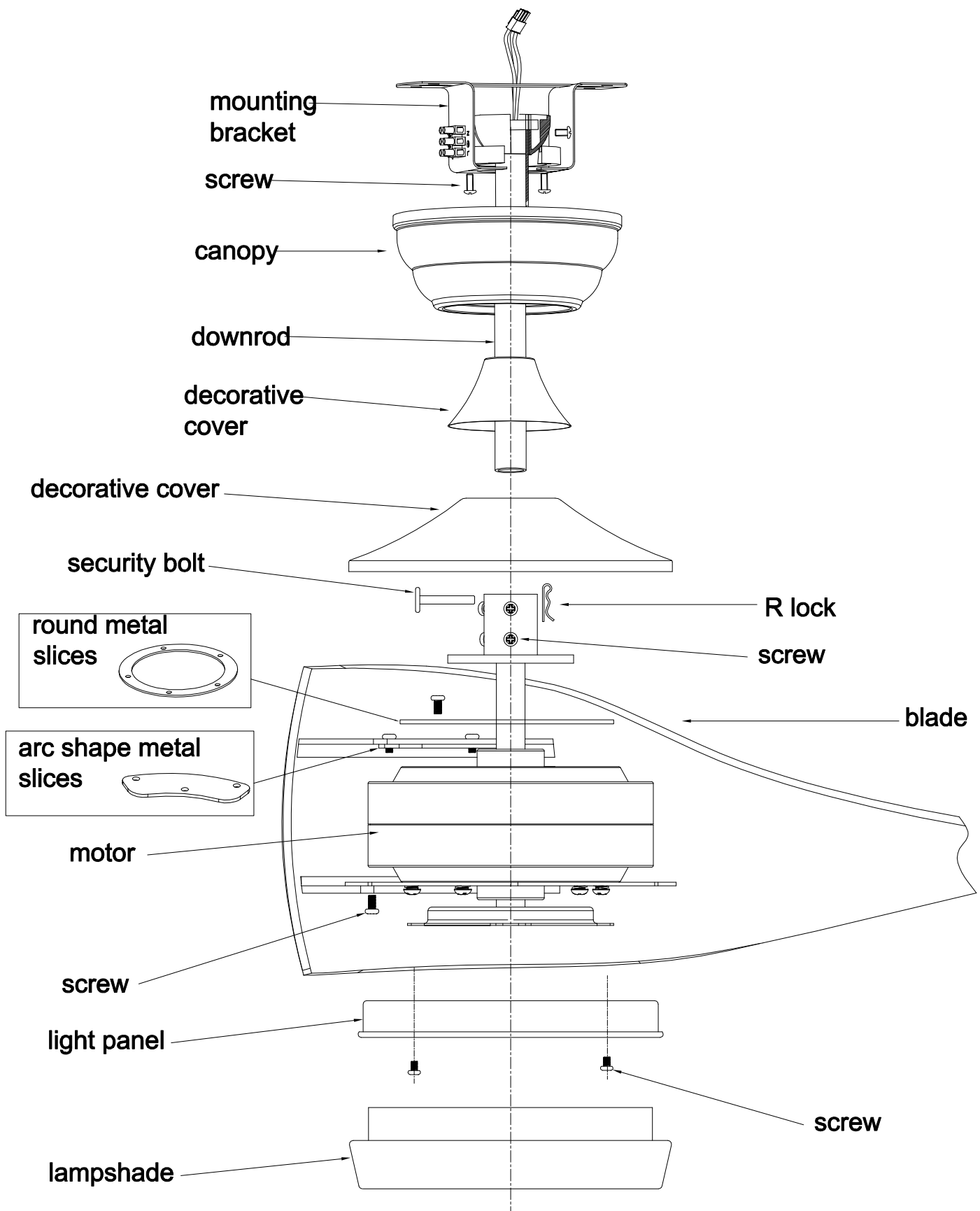

Installation steps

1.check the parts below and ensure they are all inside your package (see figure 1)

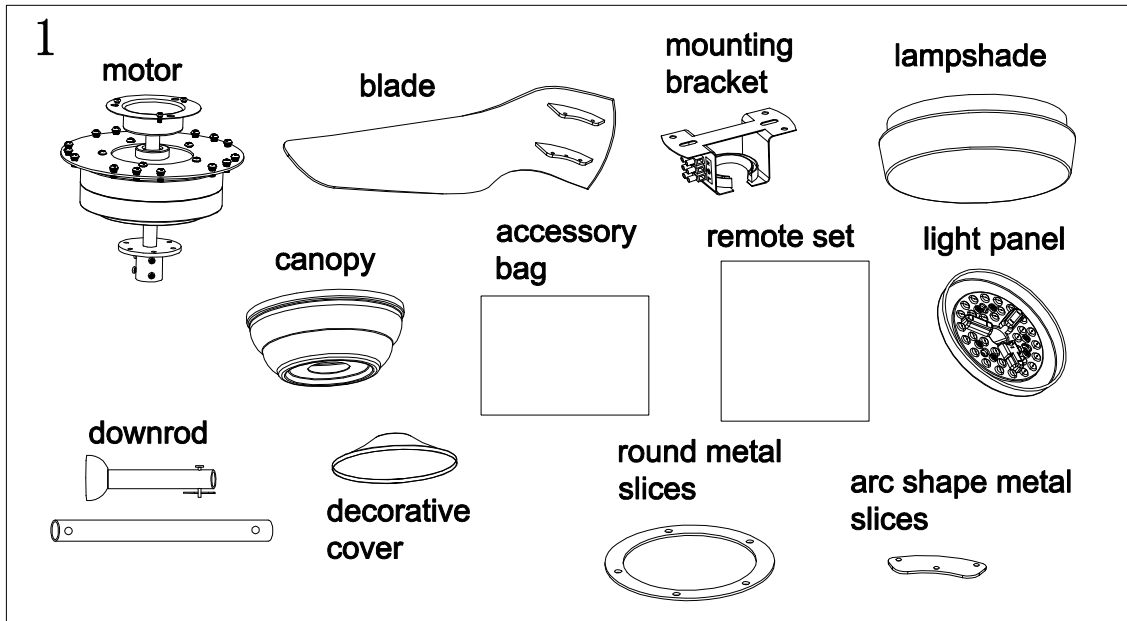

2.Fix mounting bracket

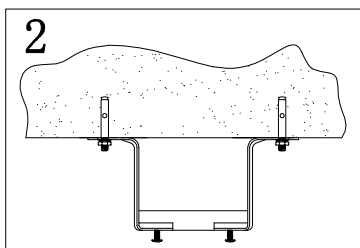

2. 1 Place the mounting bracket to the ceiling, draw holes on it through the bracket holes, then use impact drill with 8mm drill bit and screws to drill holes and fix the bracket to the ceiling. if the ceiling is cement, use set screws (see figure 2)

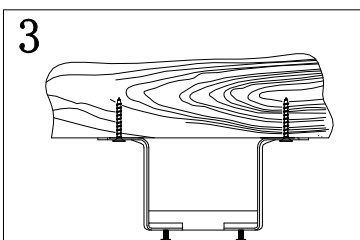

2. 2 If the ceiling is wood, use self tapping screws (see figure 3)

3.Install fan blades

3.1 align the arc-shape metal slices to the blade holes and lock them.loosen and take out the screws from the metal edges on motor,lock the left screws through the arc-shaped metal slices of each blades to the motor first,adjust blades to proper position and later lock all the screws (see figures 4,5,6,7,8).

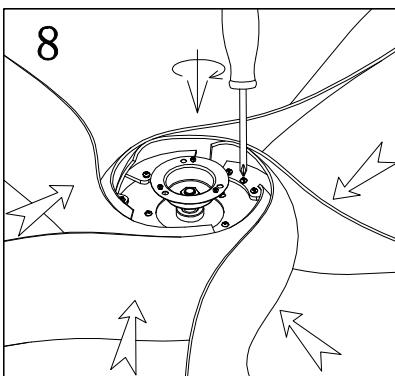
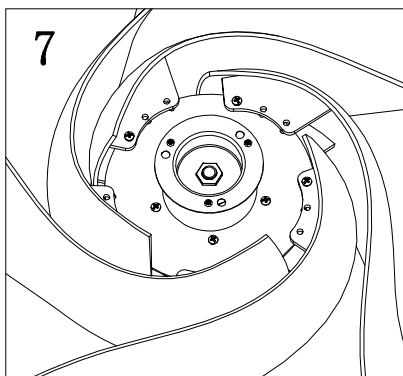
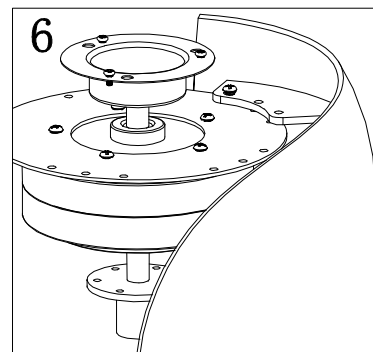
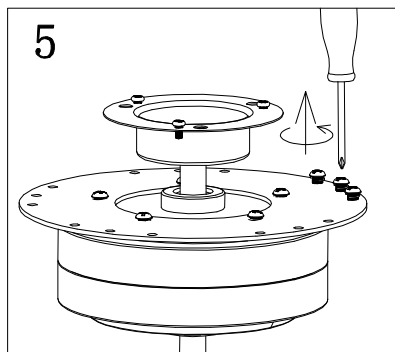
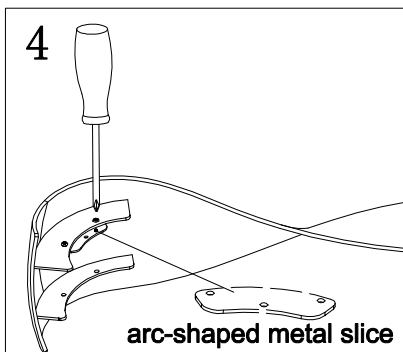

3.2 Upside down the fan,lock the round metal slice to fix the blades together (see figures 9,10).

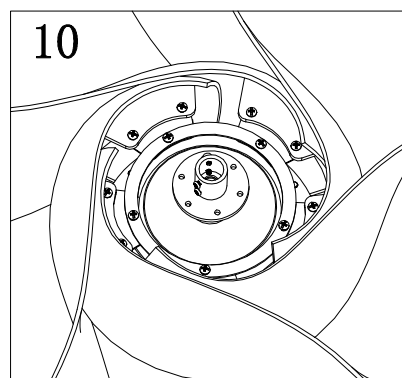
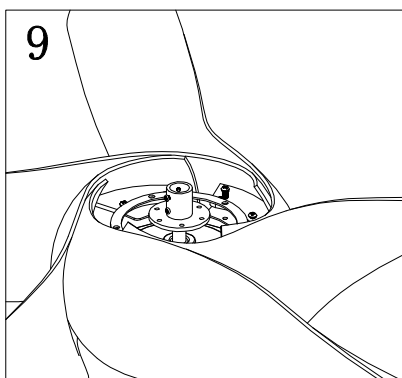

4.Install light kit

remove the screws from the light holder on the motor,connect the power wires and then lock the light panel to it (see figures 11,12,13).

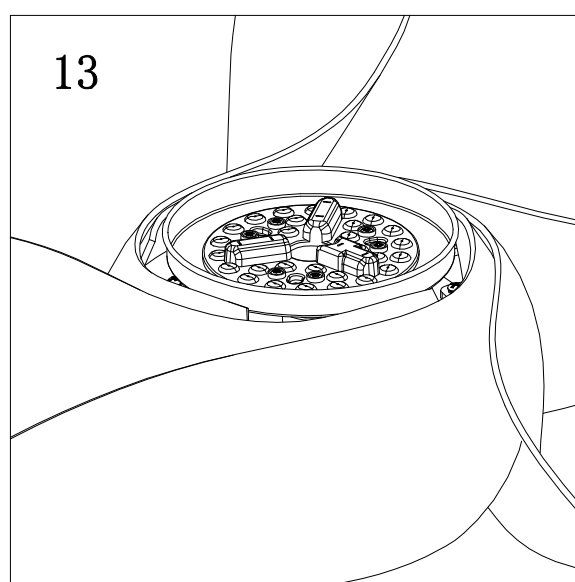
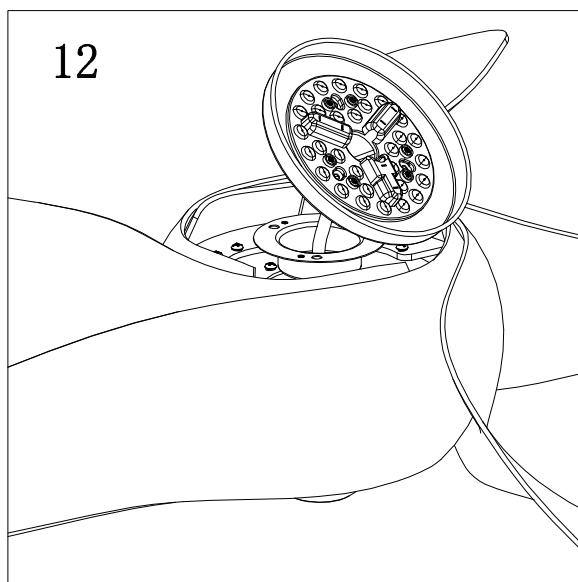
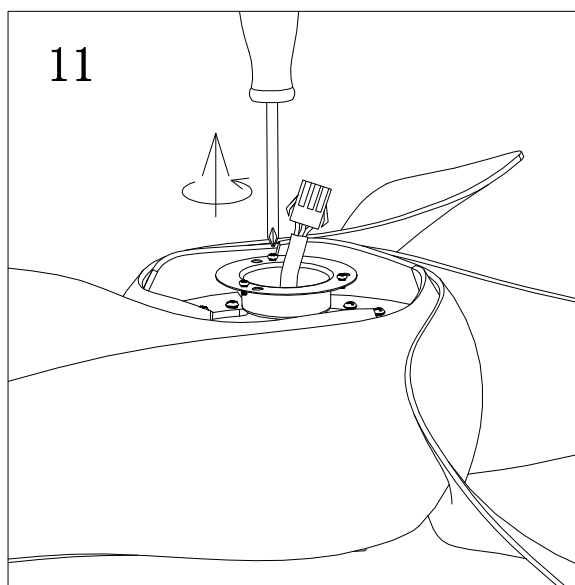

5. Install downrod

Put power wire through the decorative cover, canopy and downrod by turns, then connect the downrod to the motor. inserting the security bolt and fixed by R lock, finally tighten the screws (see figures 14,15,16,17).

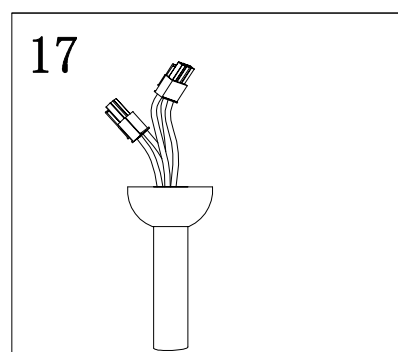
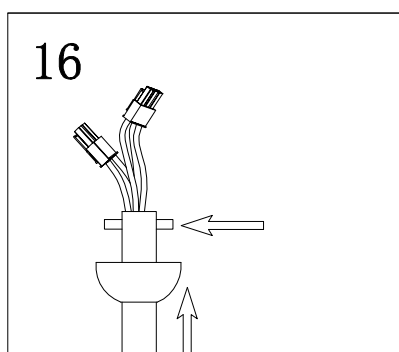
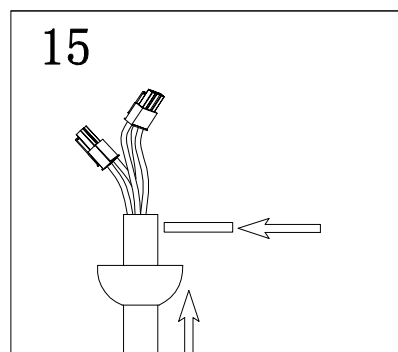
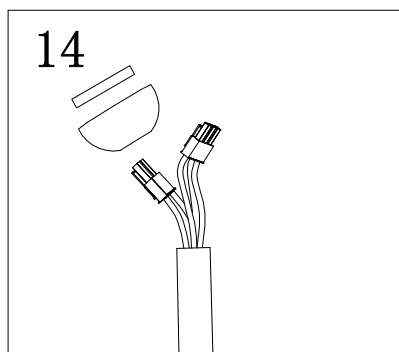
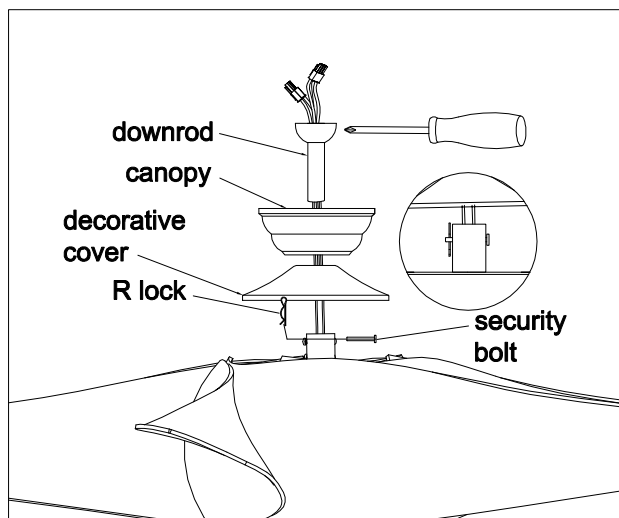

6.Install receiver and canopy

6.1 Hang the assembled ceiling fan to the the mounting bracket,rotate the downrod to ensure the groove on the head of the downrod to match the salient point on the mounting bracket (see figures 18,19)

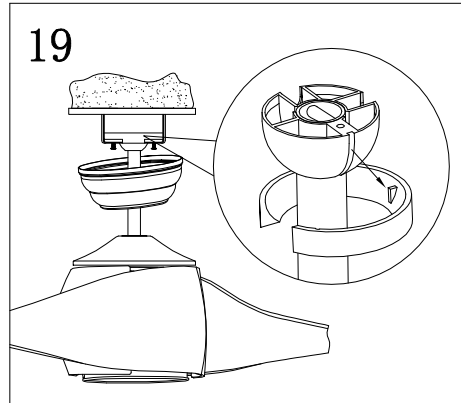
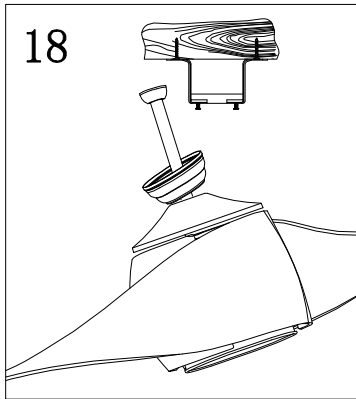

6.2 connect the wires of the receiver to the wires of the motor,insert the receiver into the mounting bracket,then lock the canopy to the bracket (see figures 20,21,22,23,24).

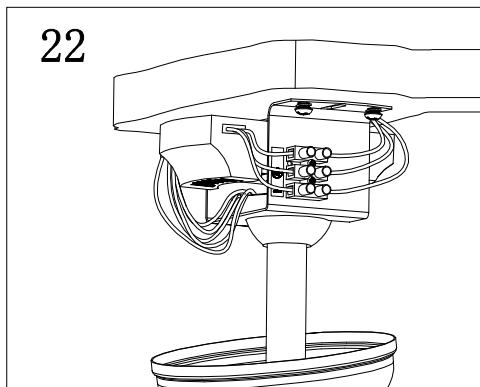
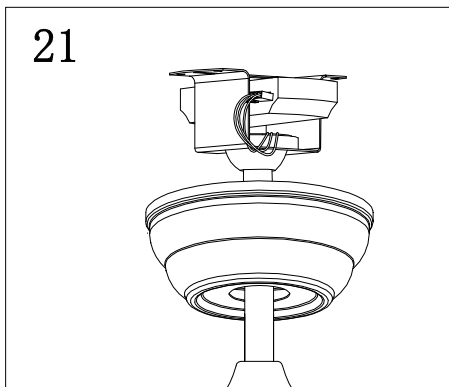
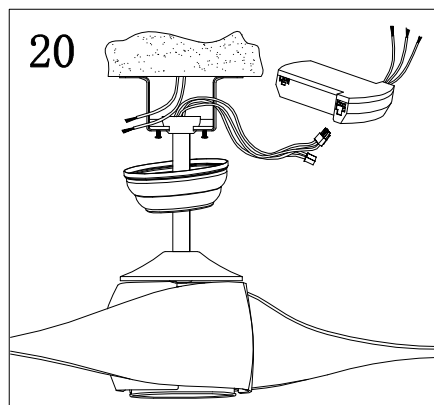

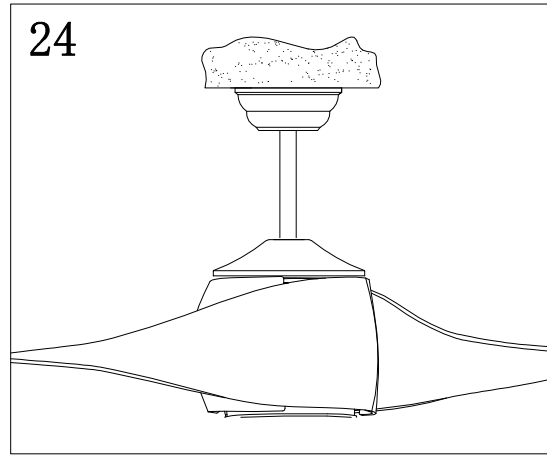
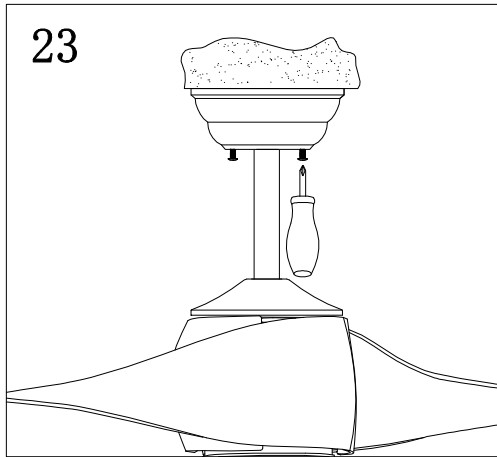

7. Install lampshade

Place the lampshade to the bottom of the light panel, rotate it by clockwise direction until it fix tight (see figures 25,26)

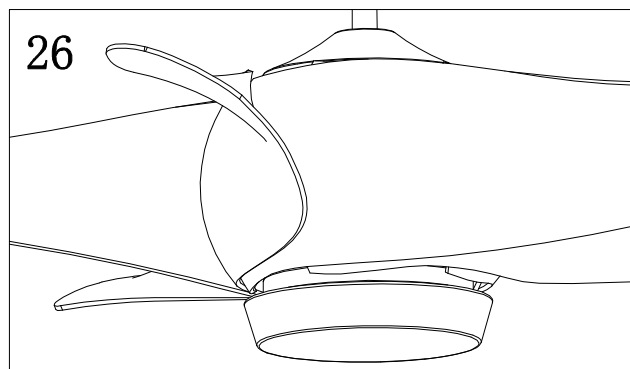
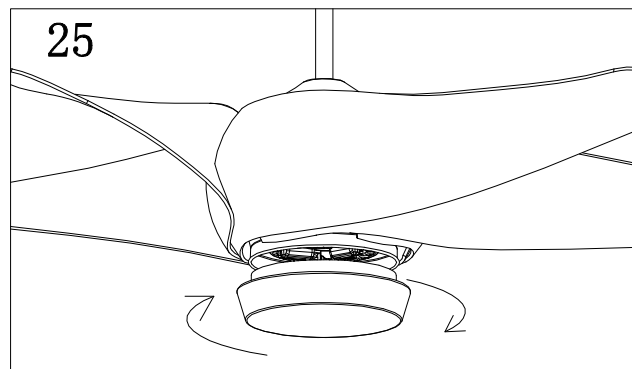

TROUBL SOLVED

FAN DO NOT WORK

- 1.check all fuses or circuit breakers,replace if missing
- 2.turn off electric power and check all wire connections
- 3.check the power voltage and see if it is normal

FAN SHAKE

1. switch on the ceiling fan,if shake is found, switch it off and stick one of the balance pad to the middle of one blades.switch on the fan again to see if there is any improvement.
2. If there is no improvement,take off the balance pad and stick it to other blades and repeat the testing until fan works well (see figure 27).

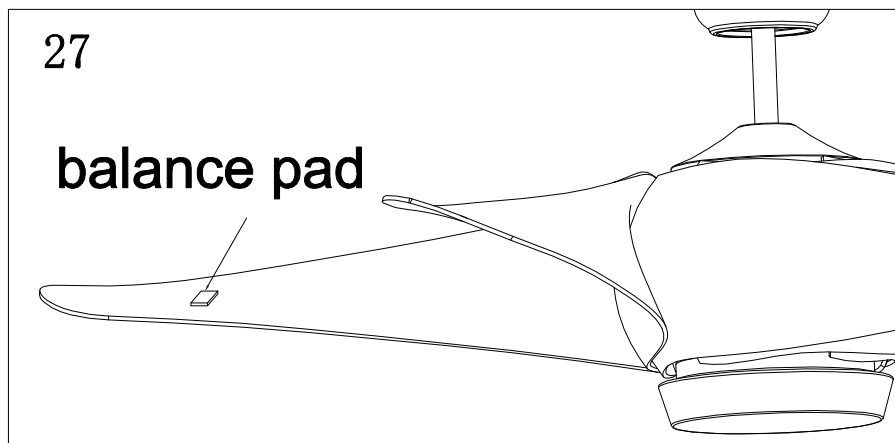

FAN NOISY

- 1.check all the screws and see if they were all tighten
- 2.check if there is any friction between motor and other parts during fan working

FAN TURNS BUT DOES NOT CREATE MUCH AIR

- 1.the fan may be running in reverse,so air is directed upwards
- 2.the room may contain items that block the air flow
- 3.the fan may be too small for size of the room

MAINTENANCE

- 1.clean your fan periodically.use only soft cloth,never use hard objects or solvents.
- 2.the fans natural movements may cause some connections to work loose,a clicking noise is the certain sign,check all connections if this happens,tighten all screws which have been loosen.do not use a screw driver or pliers to tighten glass screws. make sure the fan is power off before adjusting anything on it.