

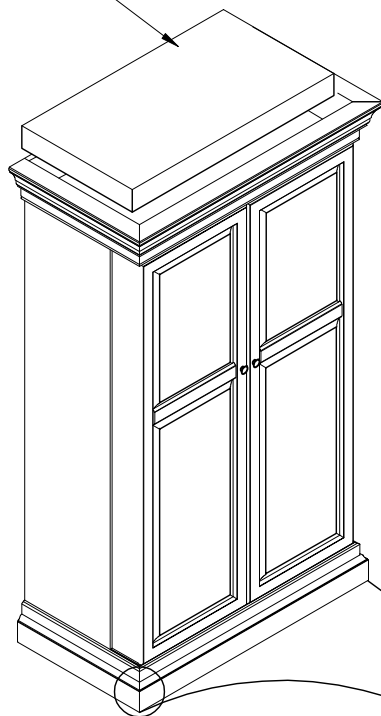

ASSEMBLY INSTRUCTIONS

ASHTON WINE AND SPRIT BAR

Glass Shelves Pack



Slide bolt lock

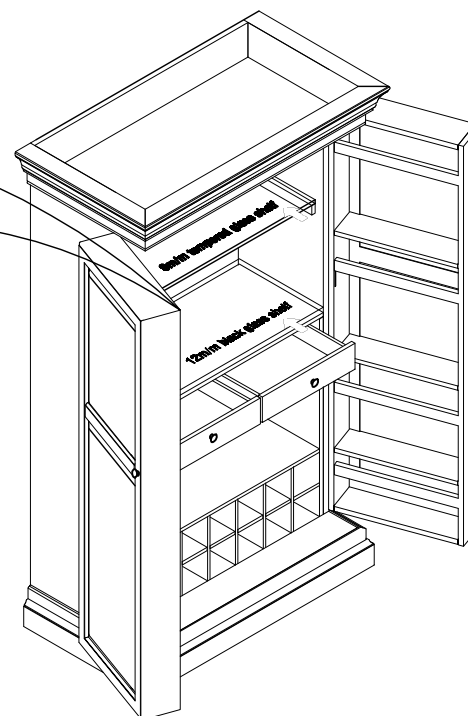
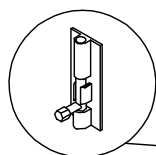

Adjustable Levelers

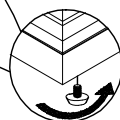

1. Please adjust the leveling glides on the underside of the front two legs as needed to ensure the doors close square.

2. 12mm THICKER black glass shelf is to be placed on top of the wood solid shelf surface as shown in the diagram(Lower)

3. 8mm THICKER clear glass shelf is to be used as an upper shelf and placed onto the wood trimmed edge(Upper)

4. DO NOT USE the heavy,thick glass piece as the upper shelf—it can only be used on top to the wood solid surface

5. When locking the cabinet ,make sure to secure the slide bolt lock in to the can light opening
Once the slide bolt lock is secured,close the right hand door and use the use the provided keys to turn and latch the front lock

6. Please note the lights intentionally shut off when the doors are closed