

ASSEMBLY INSTRUCTIONS 2 DRAWER 5' BED

IMPORTANT: READ THESE INSTRUCTIONS CAREFULLY BEFORE ASSEMBLING OR USING YOUR 2 DRAWER 5' BED FRAME.

PLEASE KEEP THESE INSTRUCTIONS FOR FUTURE REFERENCE.

HEALTH & SAFETY:

DO NOT jump on this bed frame.

DO NOT use this bed frame if any parts are missing, damaged or worn.

DO NOT use this bed frame unless all fixings are secured.

Please keep small parts out of reach of children.

Always use on a level, even surface.

WARNING: If this bed is placed on a non-carpeted floor you must place some protection under all legs to stop the bed frame from moving. If this is not adhered to there is no guarantee if the bed frame collapses.

CARE & MAINTENANCE:

Assemble in the room of use.

Periodically check all screws & fixings to ensure they are secure.

DO NOT push the bed frame as this will damage the legs.

Always lift the bed with two people to reposition.

Keep any sharp objects away from the frame.

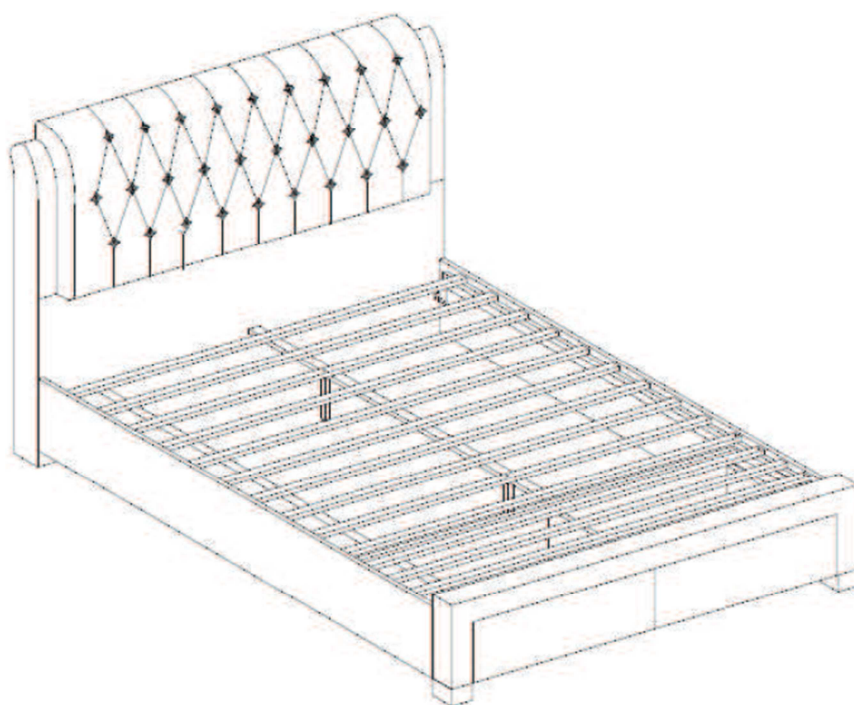

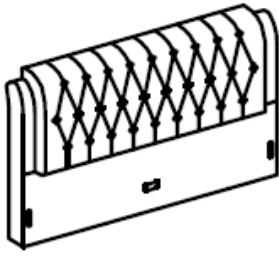

1



2



3

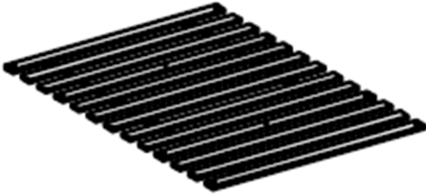

4



5

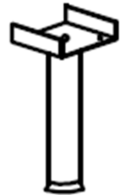

6

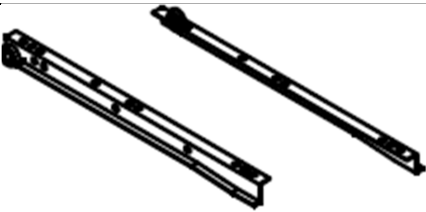

7

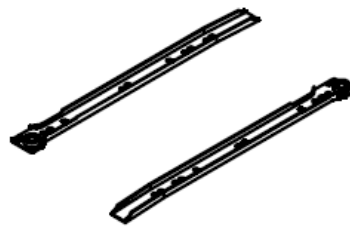

8

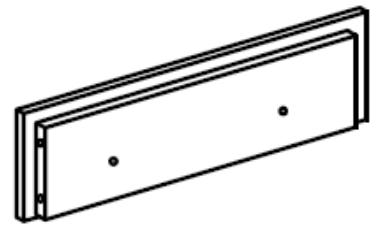

9



10

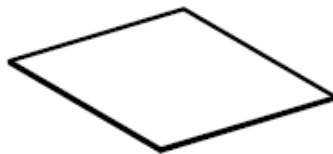

11

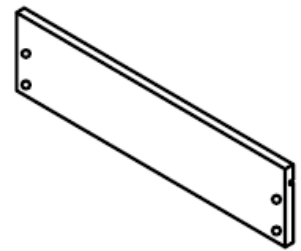

12

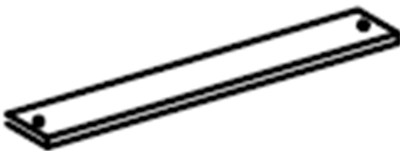

13

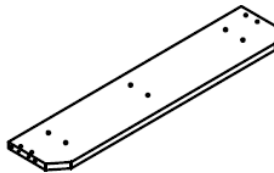

14



15



16





17

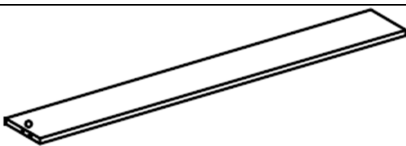

18

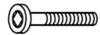
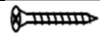

19

Parts List				Hardware List (Found in box 3)		
Part	Description	Box	Qty	Part	Description	Qty
1	Headend	1	1	A	8 x 25 mm Plastic Dowel 	15
2	Footend	1	1	B	M6 x 40 mm JCBC 	9
3	Side Rail	2	2	C	M6 x 40 mm JCBC 	10
4	Solid Slats	4	1	D	M6 x 60 mm JCBC 	2
5	Centre Rail	2	1	E	M3.5 x 16 mm CSK 	24
6	Support Leg	3	2	F	M4 x 25 mm CSK 	1
7	Drawer Runner Pack 1	3	4	G	M4 x 32 mm CSK 	18
8	Drawer Runner Pack 2	3	4	H	M4 x 50 mm CSK 	16
9	Drawer Front	3	2	I	M6 Flat Washer 	2
10	Drawer Back	3	2	J	Mini Fix Bolt 	6
11	Drawer Base	3	2	K	Mini Fix Housing 	6
12	Drawer Side	3	4	L	Mini Fix Cap 	6
13	Drawer Support	3	4	M	6/8 Tack 	24
14	Drawer Frame Back	3	1	N	White Nail 	9
15	Left Drawer Frame Side	3	1	O	Allen Key 	1
16	Right Drawer Frame Side	3	1	**You will need a screwdriver and a small mallet (not provided)		
17	Drawer Frame Divider	3	1			
18	Left Drawer Frame Support	3	1			
19	Right Drawer Frame Support	3	1			

Step 1: Join together the drawer front (9), drawer back (10) and drawer sides (12) using hardware part H and a screwdriver (not provided). Repeat for the remaining drawer.

DO NOT use any power tools as this may damage the frame and will invalidate any claim.

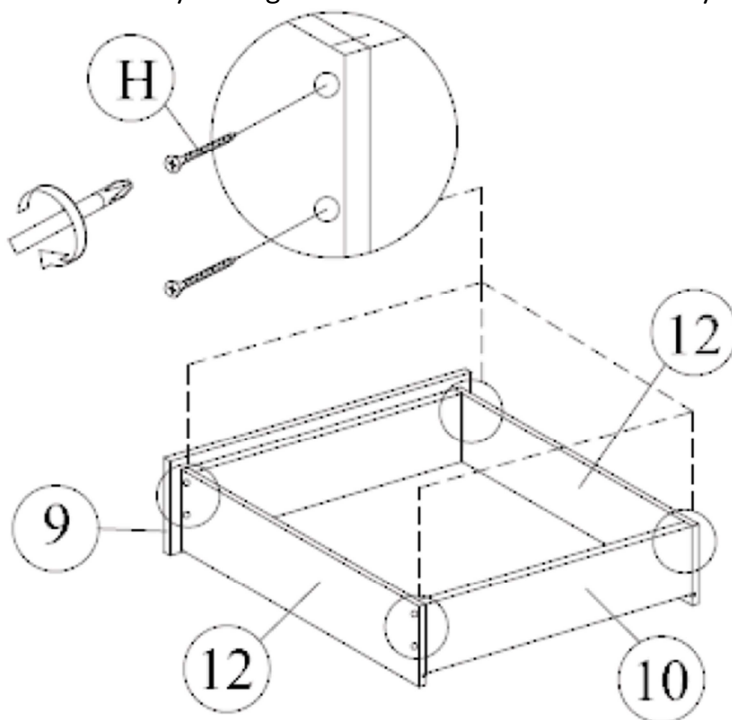

Step 2: Slide the drawer base (11) into position on both drawers. Secure with hardware part M and a small mallet (not provided).
DO NOT use any power tools as this may damage the frame and will invalidate any claim.

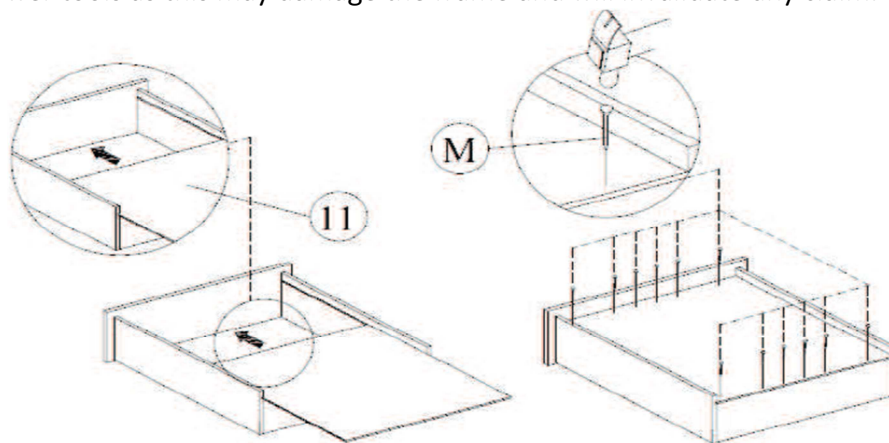

Step 3: Secure the drawer supports (13) using hardware part G and a screwdriver.
DO NOT use any power tools as this may damage the frame and will invalidate any claim.

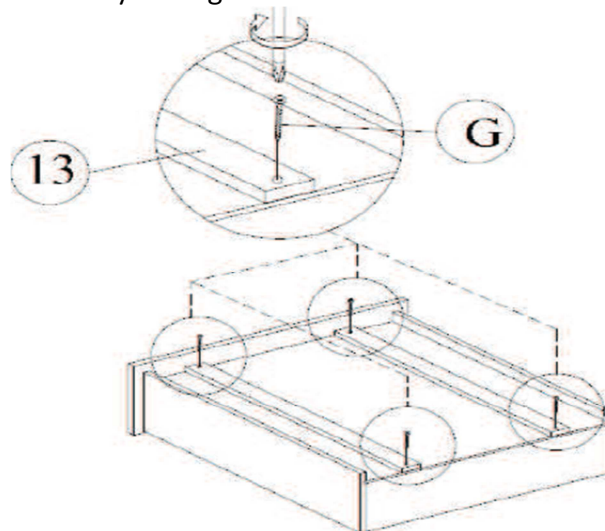

Step 4: Attach the drawer runners from pack 1 (7) using hardware part E and a screwdriver (not provided).
DO NOT use any power tools as this may damage the frame and will invalidate any claim.

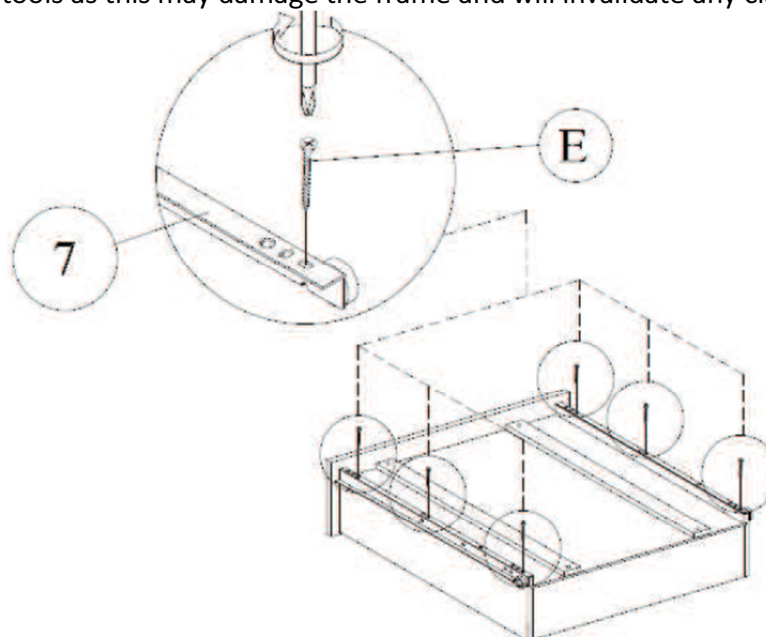

Step 5: Insert hardware parts A and N to the drawer frame back (14) using a small mallet (not provided). DO NOT use any power tools as this may damage the frame and will invalidate any claim.

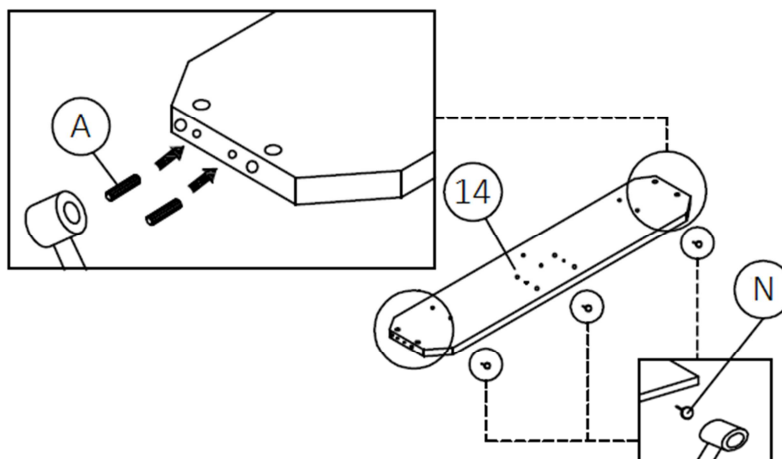

Step 6: Attach the drawer runners from pack 2 (8) to the left drawer frame side (15) using hardware part E and a screwdriver (not provided). Insert hardware parts A and N using a small mallet (not provided). DO NOT use any power tools as this may damage the frame and will invalidate any claim.

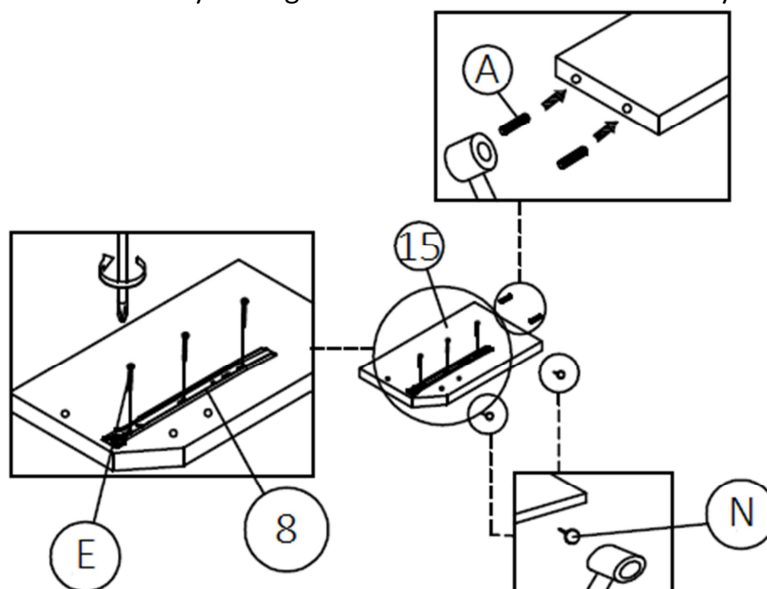

Step 7: Attach the drawer runners from pack 2 (8) to the right drawer frame side (16) using hardware part E and a screwdriver (not provided). Insert hardware parts A and N using a small mallet (not provided). DO NOT use any power tools as this may damage the frame and will invalidate any claim.

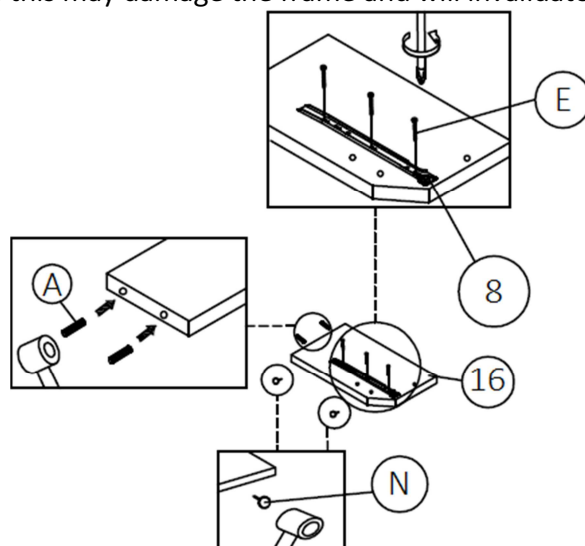

Step 8: Attach the drawer runners from pack 2 (8) to both sides of the drawer frame divider (17) using hardware part E and a screwdriver (not provided). Insert hardware parts A and N using a small mallet (not provided).

DO NOT use any power tools as this may damage the frame and will invalidate any claim.

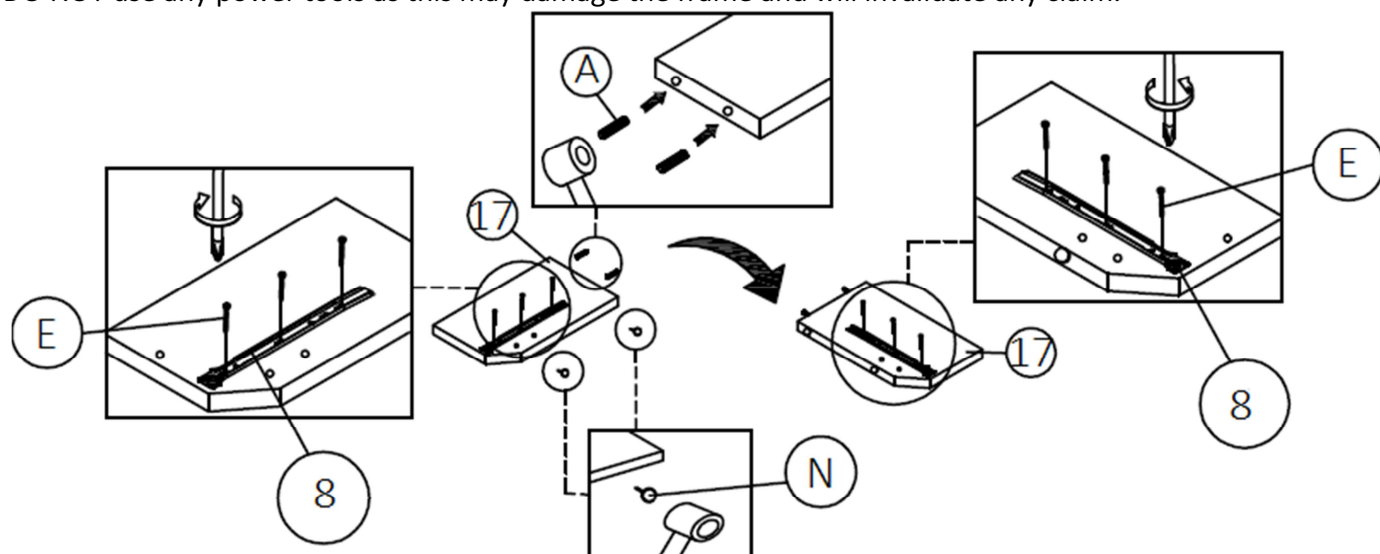

Step 9: Insert hardware part A to the left drawer frame support (18) using a small mallet (not provided).

DO NOT use any power tools as this may damage the frame and will invalidate any claim.

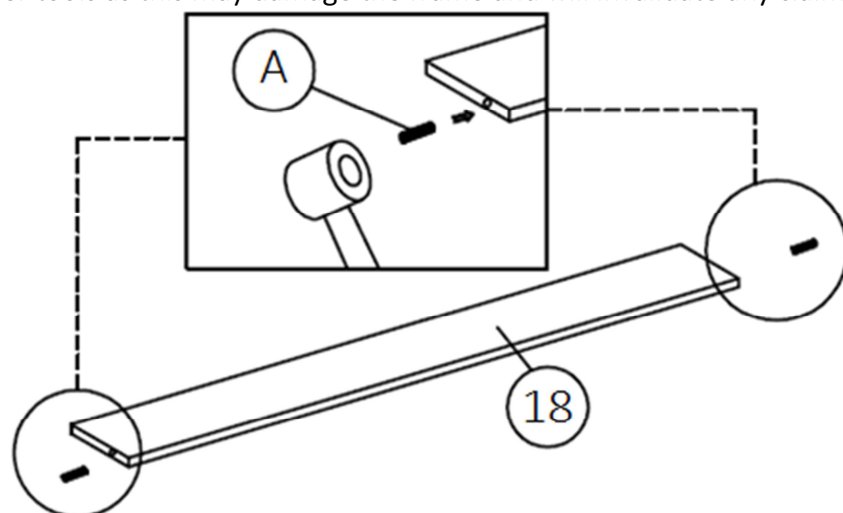

Step 10: Insert hardware part A to the left drawer frame support (19) using a small mallet (not provided).

DO NOT use any power tools as this may damage the frame and will invalidate any claim.

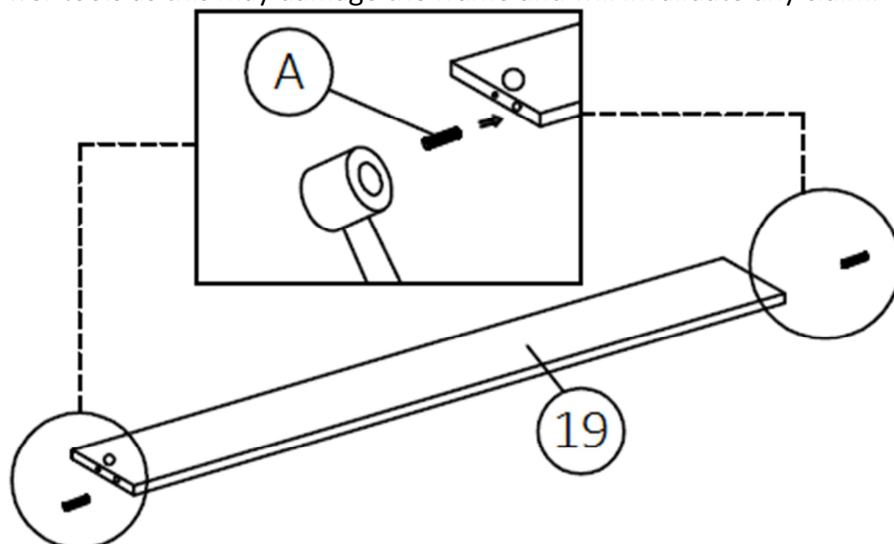

Step 11: Insert the left drawer frame side (15), right drawer frame side (16) and drawer frame divider (17) to the drawer frame back (14).

DO NOT use any power tools as this may damage the frame and will invalidate any claim.

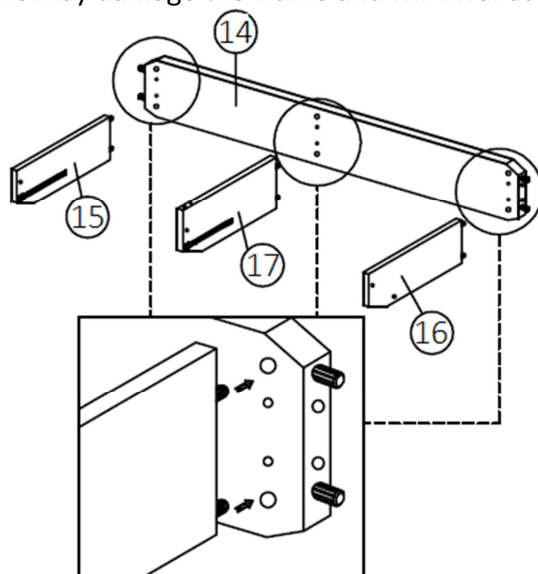

Step 12: Secure using hardware parts B and O.

DO NOT use any power tools as this may damage the frame and will invalidate any claim.

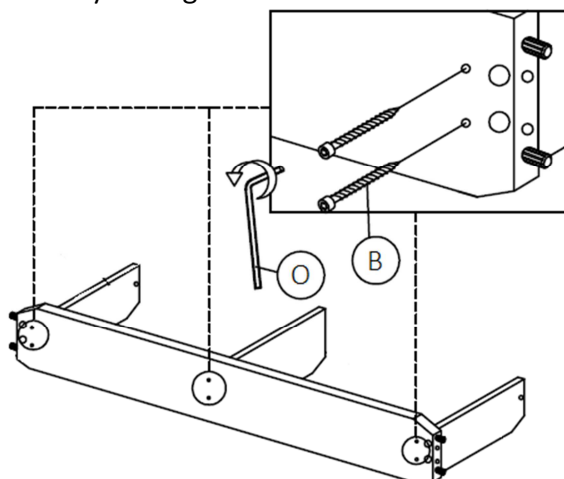

Step 13: Insert and secure the left drawer frame support (18) using hardware parts B and O.

DO NOT use any power tools as this may damage the frame and will invalidate any claim.

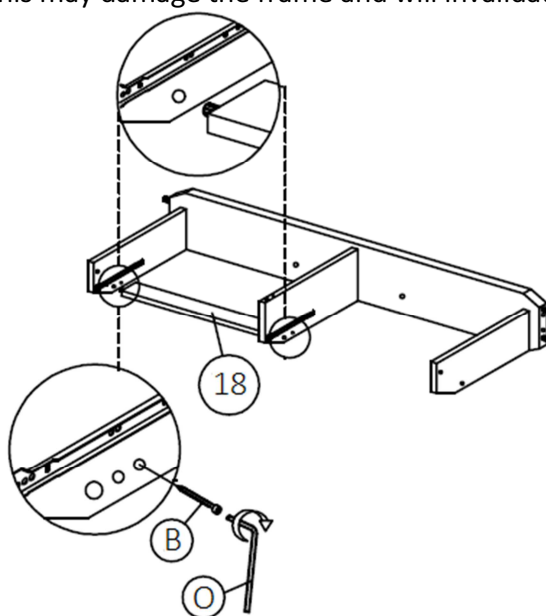

Step 14: Insert and secure the right drawer frame support (19) using hardware parts B and O. Secure the supports in the centre using hardware parts A, K, J and O.

DO NOT use any power tools as this may damage the frame and will invalidate any claim.

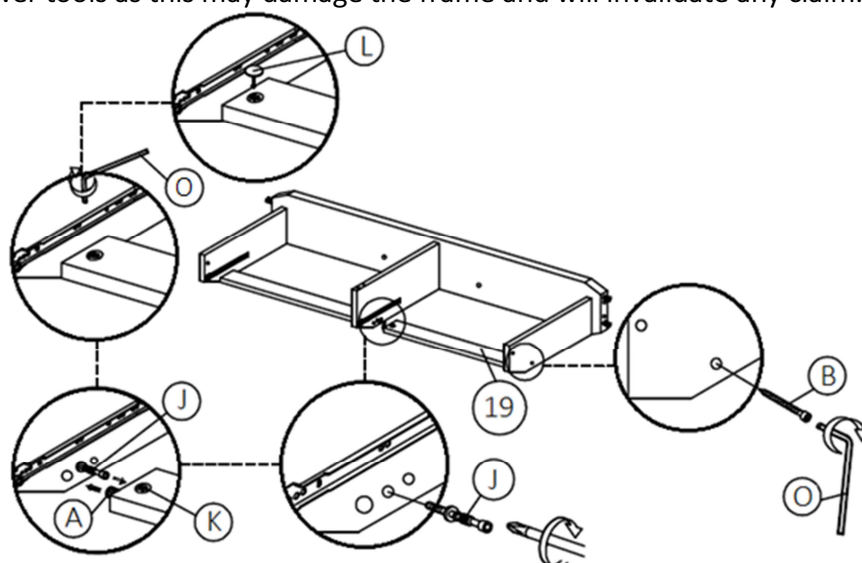

Step 15: Insert hardware part A to the footend (2) using a small mallet (not provided), then insert hardware part J using a screwdriver (not provided).

DO NOT use any power tools as this may damage the frame and will invalidate any claim.

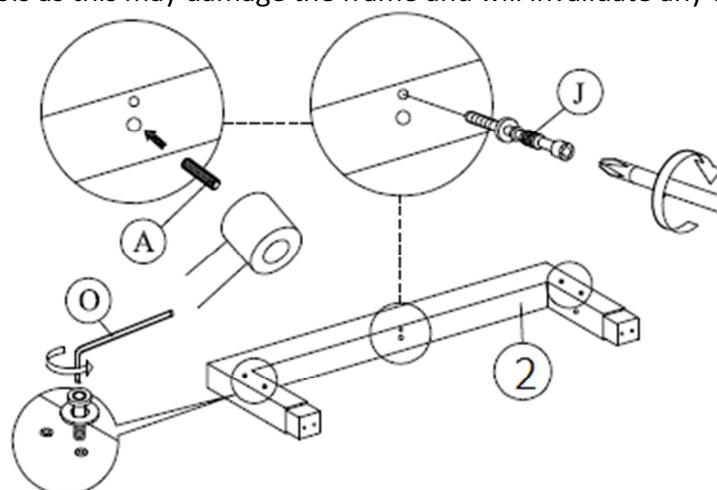

Step 16: Undo the screws and washers in the headend (1) and footend (2), then attach them to the frame using the screws, washers and hardware part J.

DO NOT use any power tools as this may damage the frame and will invalidate any claim.

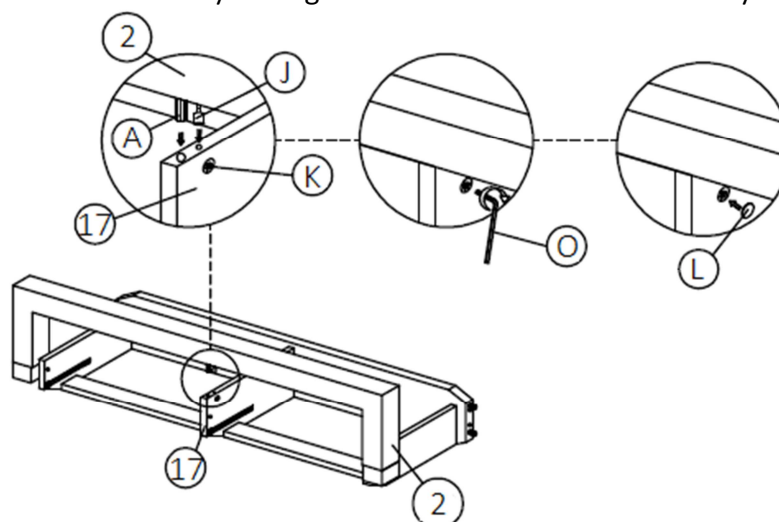

Step 17: Secure the frame using hardware parts C, G, I and O with a screwdriver (not provided).
DO NOT use any power tools as this may damage the frame and will invalidate any claim.

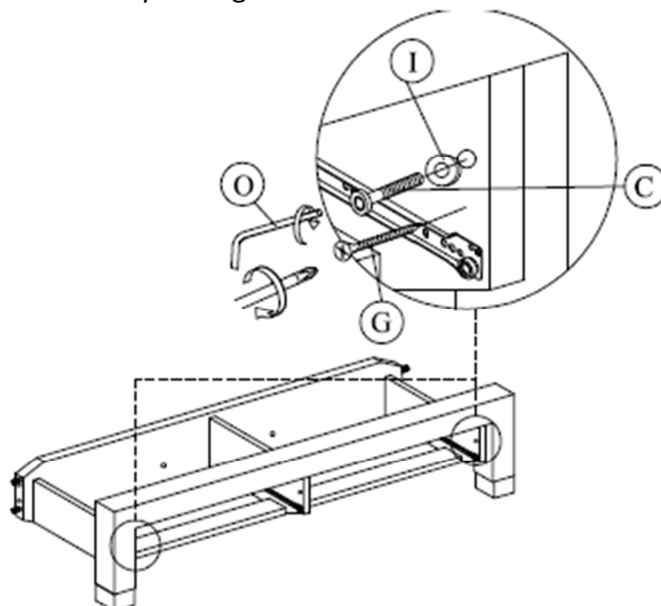

Step 18: Insert hardware part J to the side rails (3) using a screwdriver (not provided).
DO NOT use any power tools as this may damage the frame and will invalidate any claim.

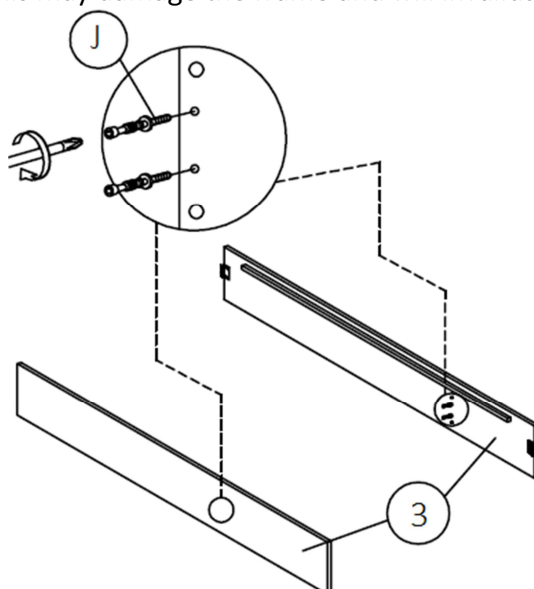

Step 19: Secure the frame using hardware parts C and J. DO NOT use any power tools as this may damage the frame and will invalidate any claim.

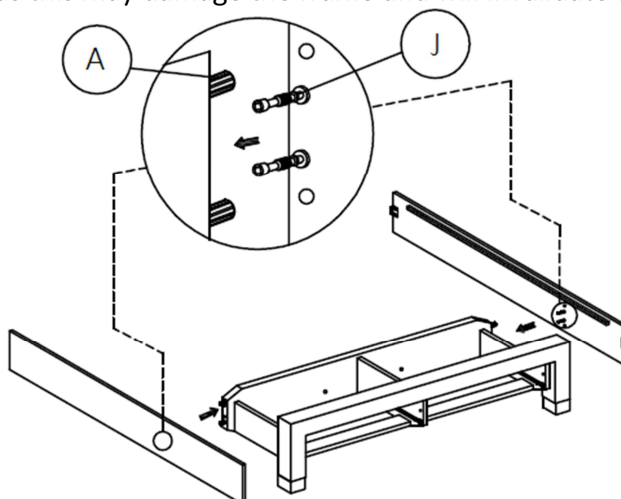

Step 20: Loosen the pre-inserted screws on the headboard (1) using hardware part O.
DO NOT use any power tools as this may damage the frame and will invalidate any claim.

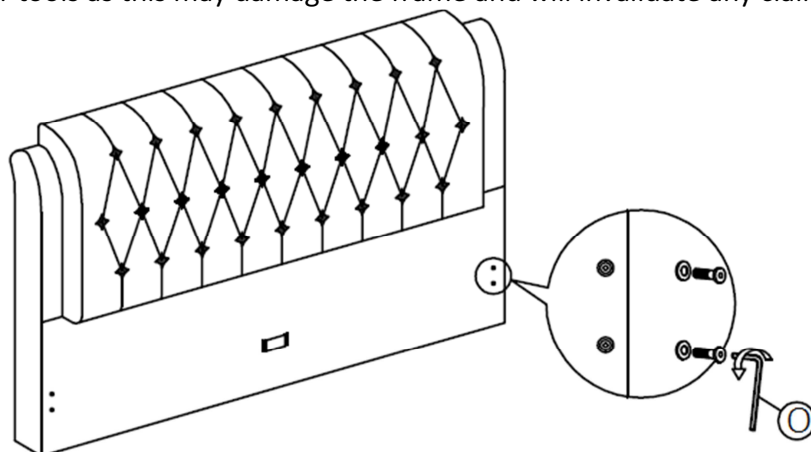

Step 21: Secure the frame using hardware parts L, K and O.
DO NOT use any power tools as this may damage the frame and will invalidate any claim.

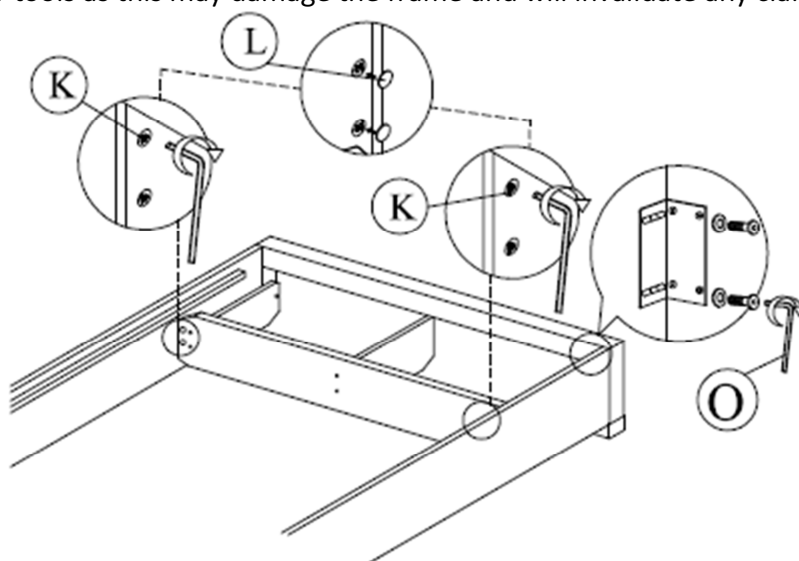

Step 22: Attach the headend (1) using the pre-assembled screws and hardware part O.
DO NOT use any power tools as this may damage the frame and will invalidate any claim.

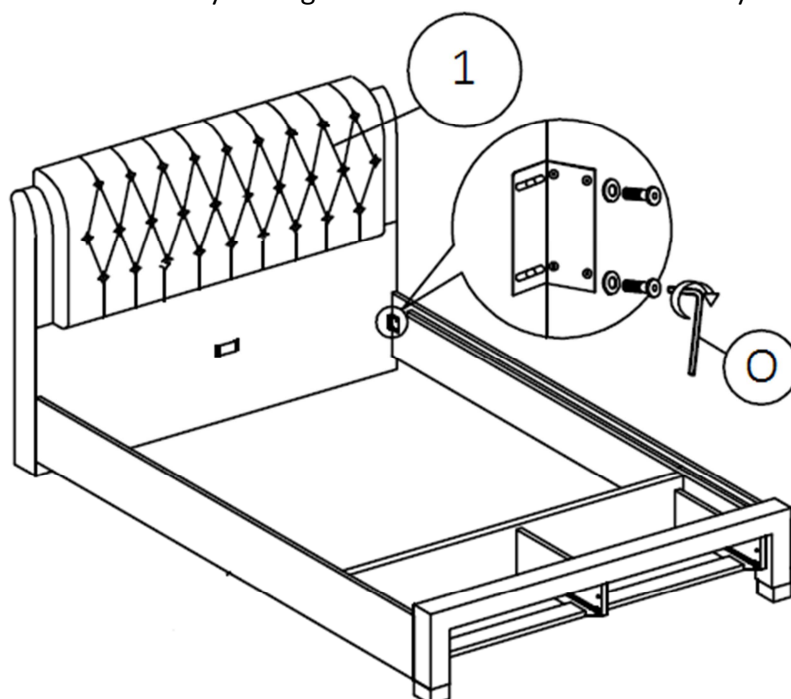

Step 23: Attach the support legs (6) to the centre rail (5) and solid slats (4) using hardware parts D and O. **DO NOT** use any power tools as this may damage the frame and will invalidate any claim.

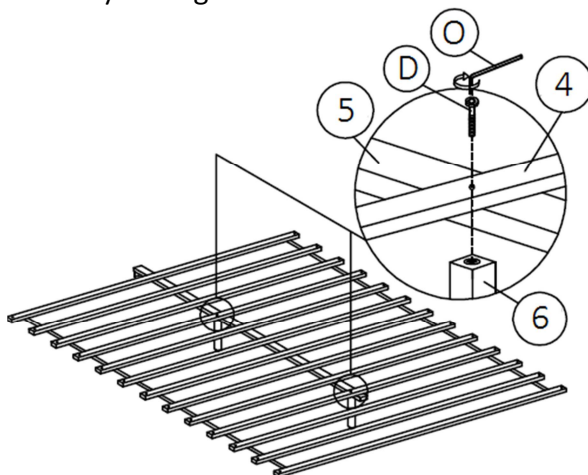

Step 24: Place the slat section into the assembled frame and secure to the headend (1) using hardware part F and a screwdriver (not provided). Secure the solid slats (4) using hardware part G and a screwdriver (not provided).

DO NOT use any power tools as this may damage the frame and will invalidate any claim.

