

# INSTRUCTION MANUAL

---

**11 Ft x 11 Ft Pop Up Canopy With Netting**

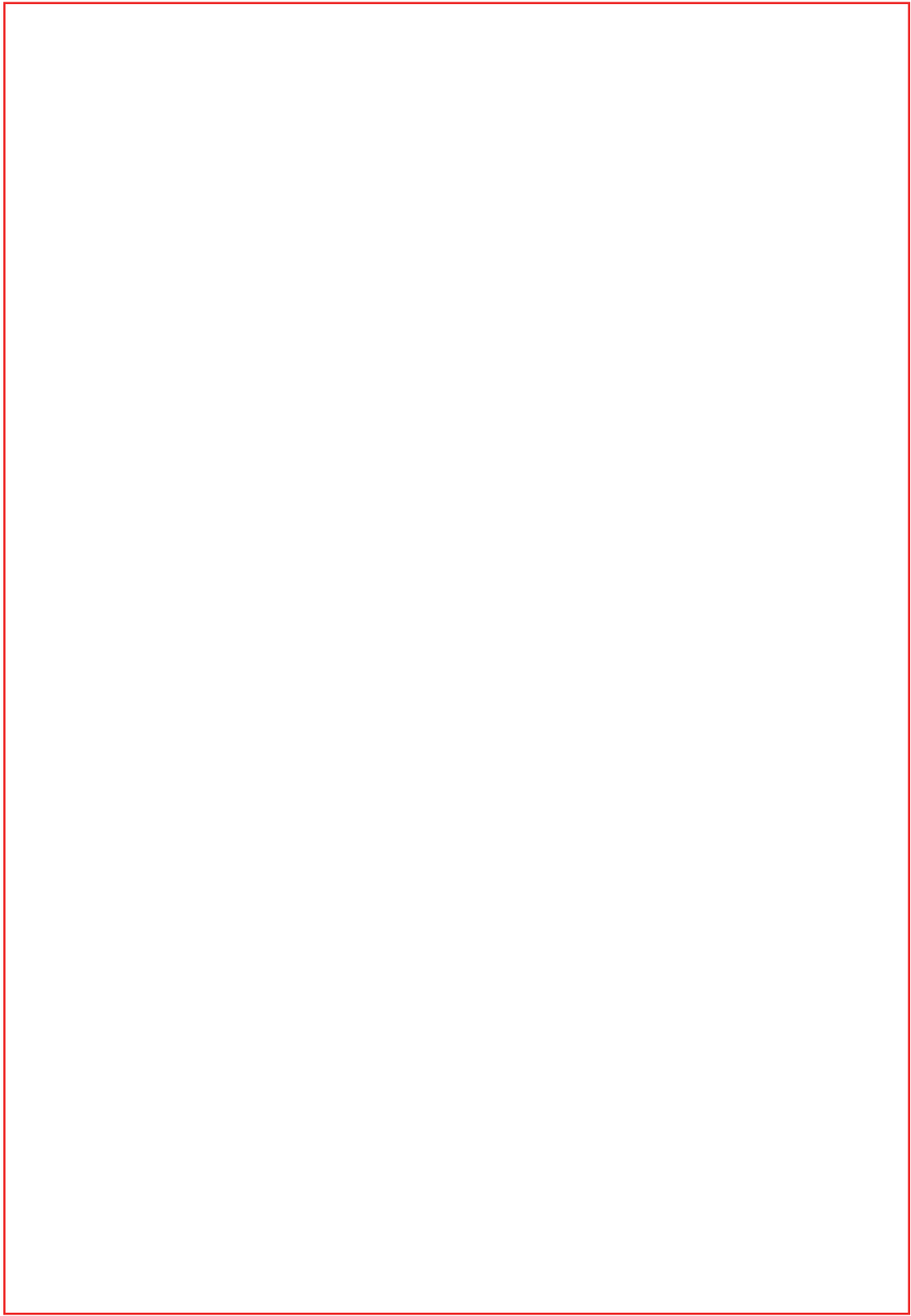

---

## WARRANTY

**Please read and save these instructions before attempting to set up this canopy.**

### 1 Year limited warranty

We warrants for a period of 1 year from the original date of purchase, this product against any defects in materials or workmanship. At its discretion, We may provide replacement parts to original purchaser. Original receipt or proof of purchase as well as proof of defect is required. We will not be responsible for shipping costs incurred outside the continental USA. Warranty is valid for the original purchaser for 1 year from the date of purchase and is not transferable. This warranty does not cover any product purchased through non authorized dealers and/or on-line auction websites.

### This Warranty Does Not Cover

This 1 Year Limited Warranty does not cover normal wear and tear, abuse or misuse of this product including damage from inclement weather conditions, such as wind, snow, rain, or hail. In case of inclement weather, take down and store the canopy, remove and store valuables, and seek appropriate shelter.

### Under no circumstances, we will be liable or responsible for any incidental or consequential damages.

This product is designed and intended for commercial and recreational usage. Pro-longed exposure to UV rays will cause any fabric to fade or deteriorate is NOT covered by this 1 Year Limited Warranty.

All replacement products or parts will assume the remaining warranty of the original product. This warranty gives you specific legal rights. You may also have other rights, which vary from state to state.

### It is your responsibility to read and save these instructions before attempting to set up your commercial canopy. We would also like to suggest that you follow these safety precautions, care and maintenance tips when using your canopy.

1. Never set up or continue to use in any rain, wind or storm conditions, especially lightning storms. Damage can occur to your canopy and put you and others in potential danger.
2. We suggest that you take your time in order to avoid bending the frame or pinching your fingers or hands while opening and closing the frame.
3. Avoid setting up your canopy on steep inclines.
4. Do not use your canopy for permanent shelter. It is designed for temporary use only.
5. Keep your canopy away from heat and flames at all times. Do not barbecue or build fires under your canopy.
6. Never leave your canopy unattended.
7. Hand wash the canopy using only mild soap and water. Never use harsh detergents, abrasives or bleach. Do not machine wash fabric components.
8. Never fold or store your canopy when it is wet or damp. Let it dry completely to avoid mildew.
9. The frame MUST be staked or properly weighted down at all times.
10. For best results in keeping your top clean and avoid small rips and tears, it is recommended that the top be removed from the frame and stored in the carry bag after each use.

## OPEN THE CANOPY FRAME

### Step 1

You will need:

Canopy Frame

1X

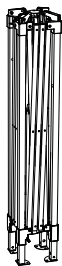

- Working with a partner pull on opposite corners of the frame to extend slightly.
- Remove protective wrap from center arms. Pivot plastic arms up.

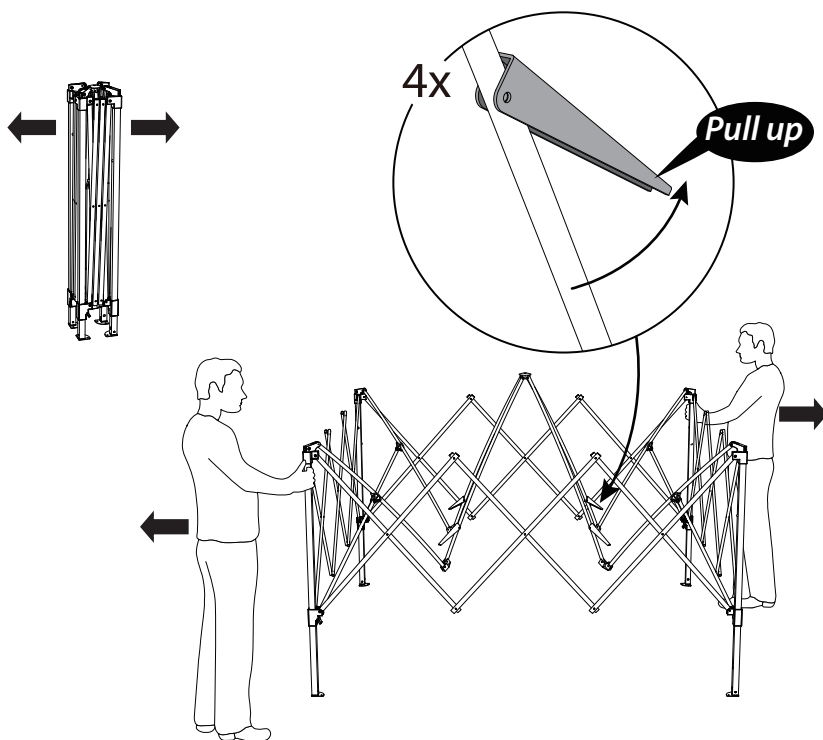



# ATTACH THE SMALL CANOPY TOP

## Step 2

You will need:

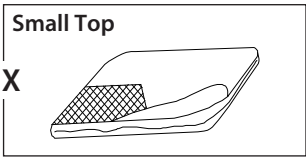

- Place small canopy top on the frame and insert ends of plastic arms into corner pockets of top.

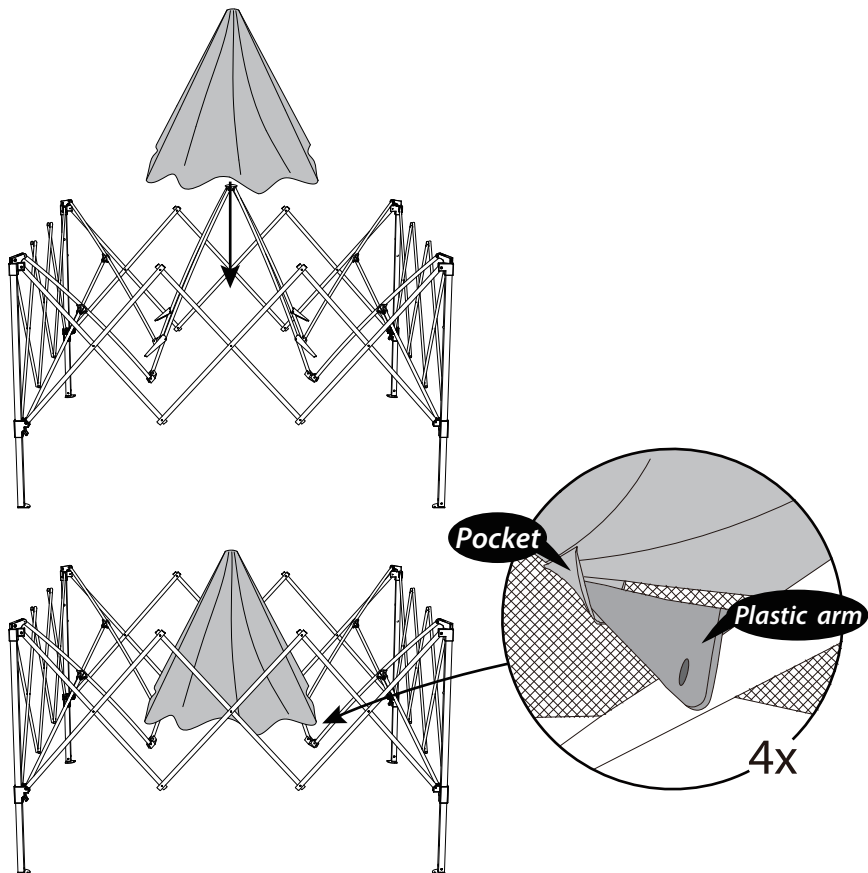

## ATTACH THE BIG CANOPY TOP

### Step 3

You will need:

Big Top

1X



Eave Extender

4X



- Place the big top on the frame, and pull the triangle holes on each corner of the top towards the leg cap and position over the corner of the frame.
- Pass the eave extender through the corner hole in the large canopy top and insert into the leg cap at each corner of the frame. Make sure all the eave extenders are clicked into place.
- Pull the corner of the big top over each eave extender tube, making sure the tube goes inside the top pocket.

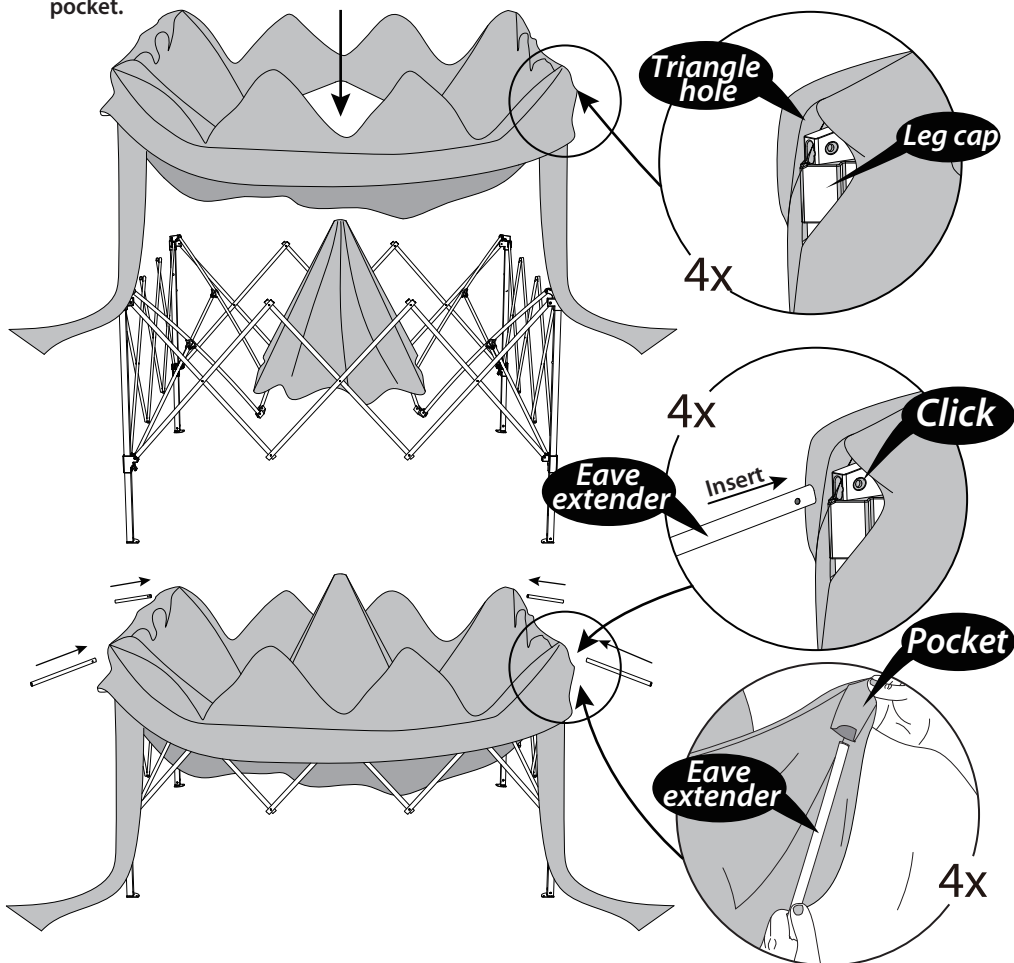

## LOCK THE CANOPY FRAME

### Step 4

- Finish attaching the big top by tying the ropes from the small top to the big top.
- Working with your partner, grasp the canopy frame at opposite corners and walk backwards to extend the frame. Then lift up on the lower eave near the leg while pushing down on the top of the leg. The leg slider will move up and lock into place.

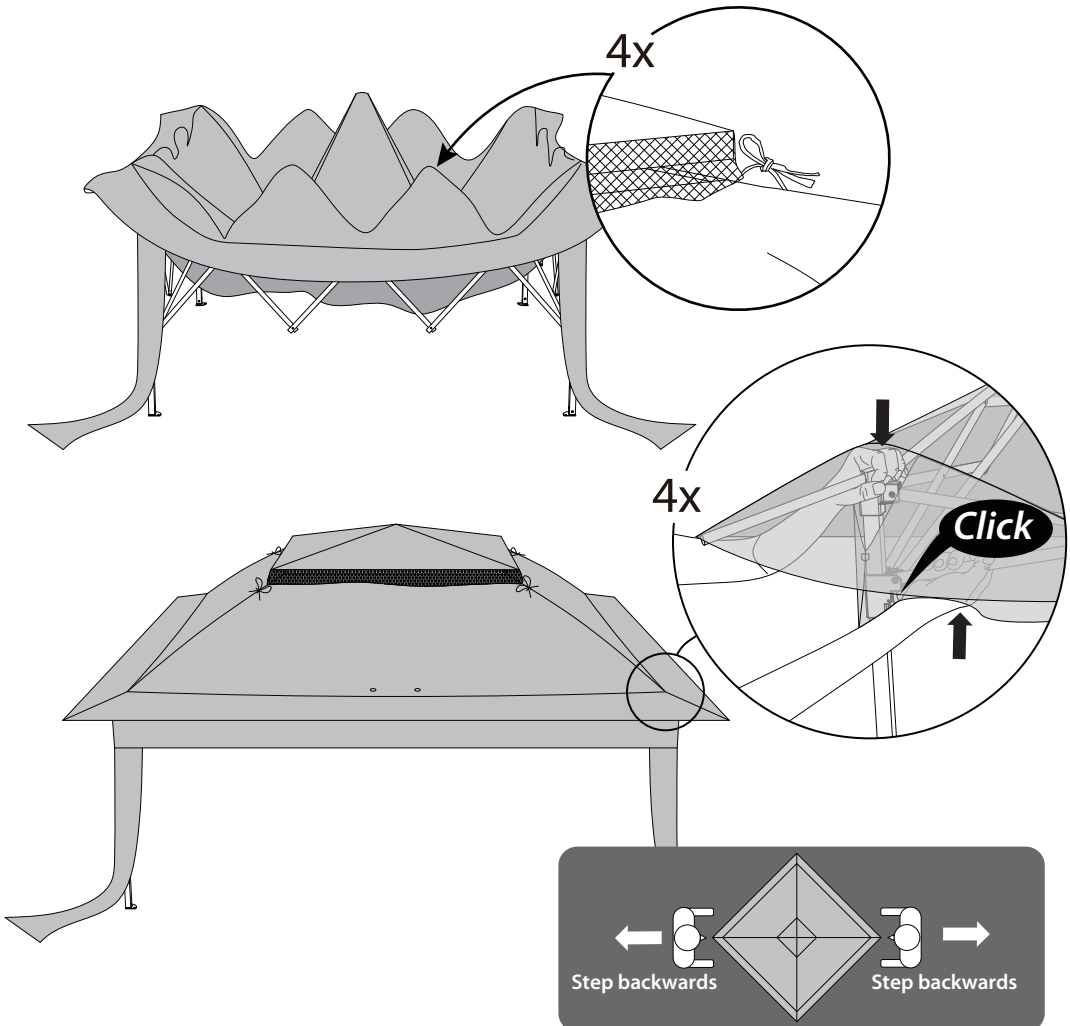

## ADJUST THE CANOPY HEIGHT

### Step 5

- Lift two adjacent legs, press the push pin on both legs and raise or lower to adjust the canopy heights.
- Attach the big top to ceiling assembly by using Velcro connections from inside.
- Extend the other two legs, press the push pin on both legs and raise or lower to adjust the canopy height.

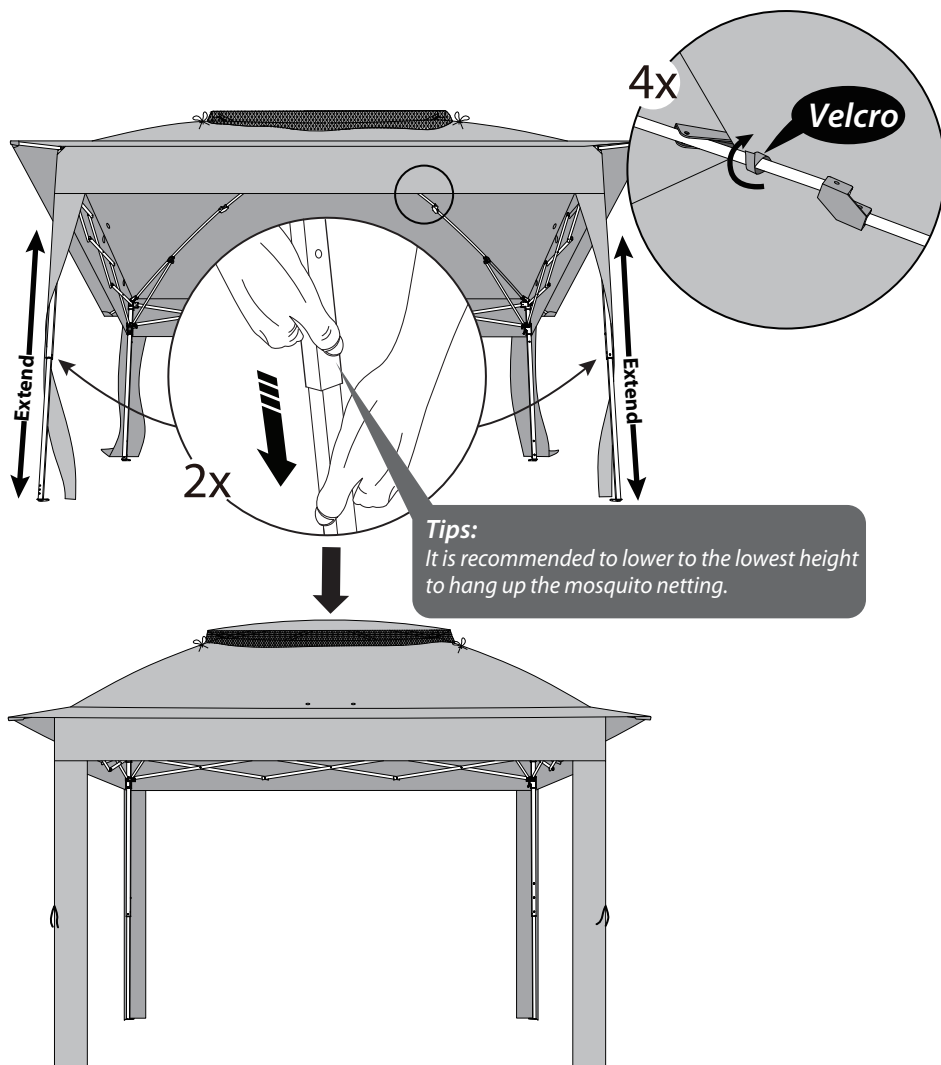

## ATTACH THE NETTING ROPES

### Step 6

You will need:

Netting Rope

2X



- At the corner (A), thread one netting rope through the loops sewn into the canopy top from Corner (A) to Corner (B) to Corner (C). Make sure the rope positions are between the frame and the leg skirt.
- Repeat attaching the another rope form Corner (A) to Corner (D) to Corner (C).
- Status 1: Tie the ends of ropes together in a knot and make it circle around the frame keeping the ropes tight.
- Status 2: Tie each end of ropes to the leg cap at Corner (A) & Corner (C).

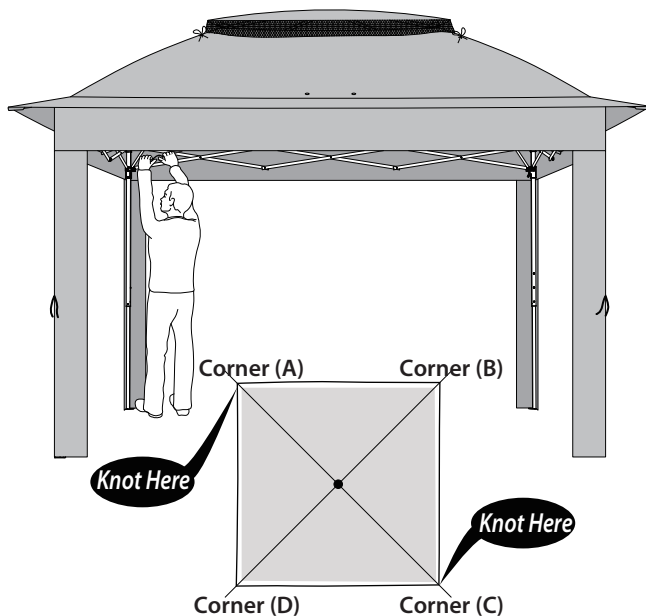
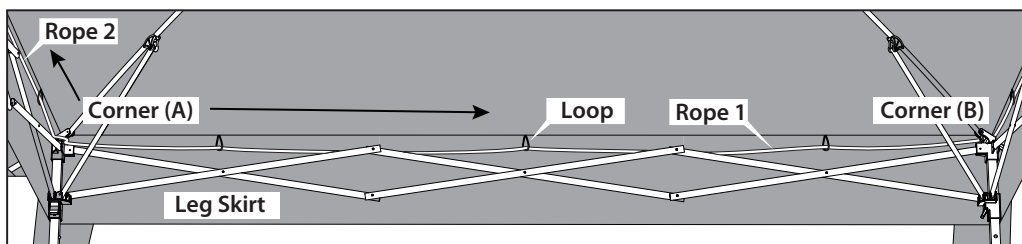

## ATTACH THE MOSQUITO NETTING

### Step 7

You will need:

Mosquito Netting

4X

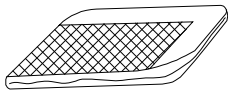

Q Ring

32X



- Loop the Q rings through the sewn in loops at the top edge of the mosquito netting. (Fig. 1)
- Hang up the mosquito netting to the ropes by using the Q rings. Make sure the zipper of the mosquito netting is located at the middle of the eave assembly, and the mosquito netting is between the on the outside of the frame, between the leg and leg skirt..

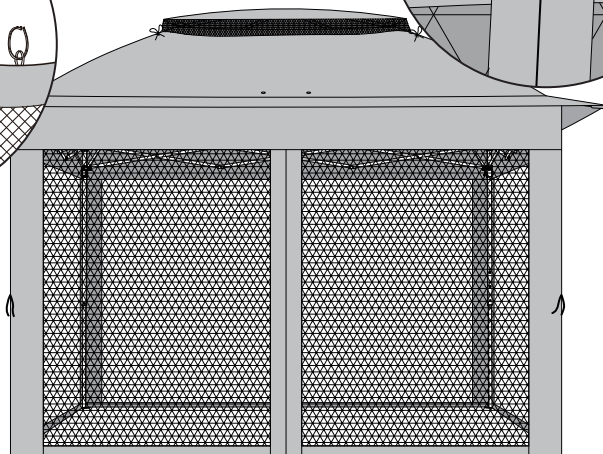
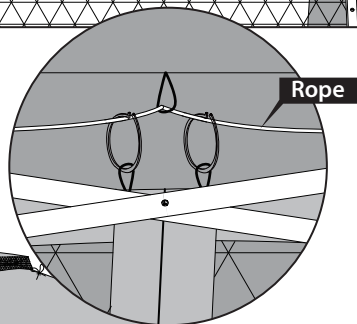
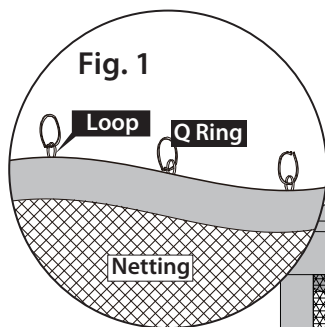
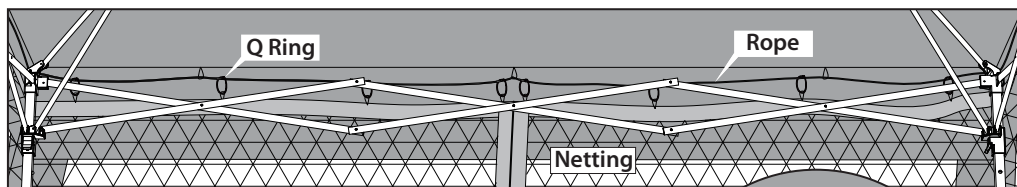

## TIE BACK THE SKIRT & MOSQUITO NETTING

### Step 8

- Tie back the leg skirt without the mosquito netting.
- Tie back the leg skirt and the mosquito netting together using ties sewn into the leg skirt..

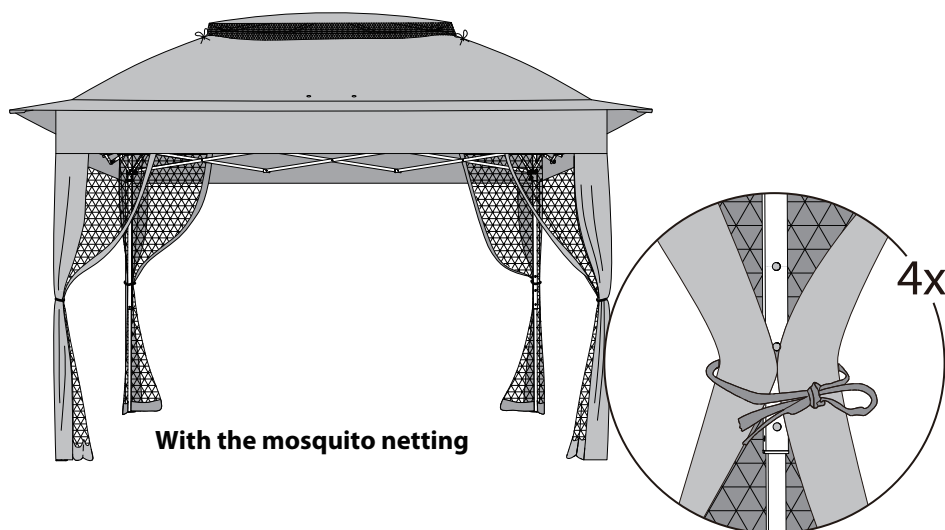
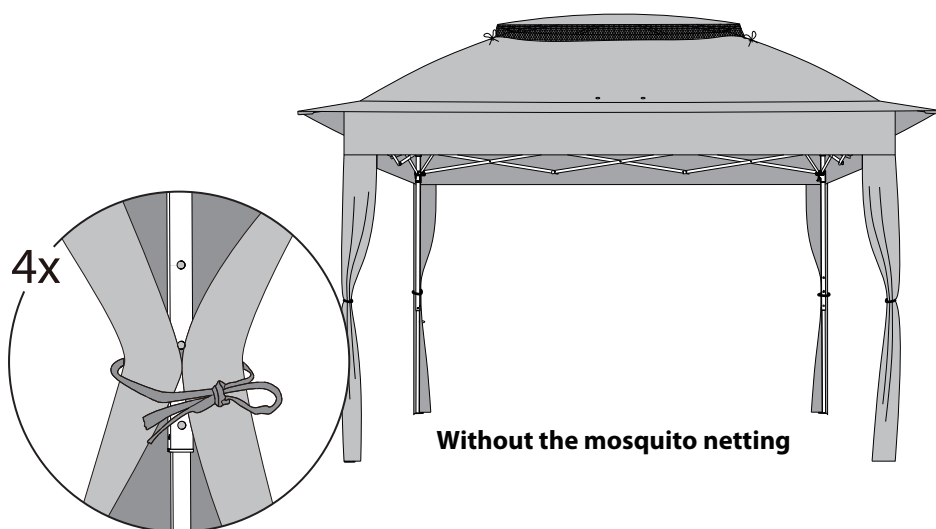

## SECURE THE CANOPY IN PLACE

### Step 9

You will need:

Stake

8X



- Insert the hooks sewn in the leg skirts into the bottom holes of the canopy legs.
- Insert two stakes into each footpad to secure your canopy in place .

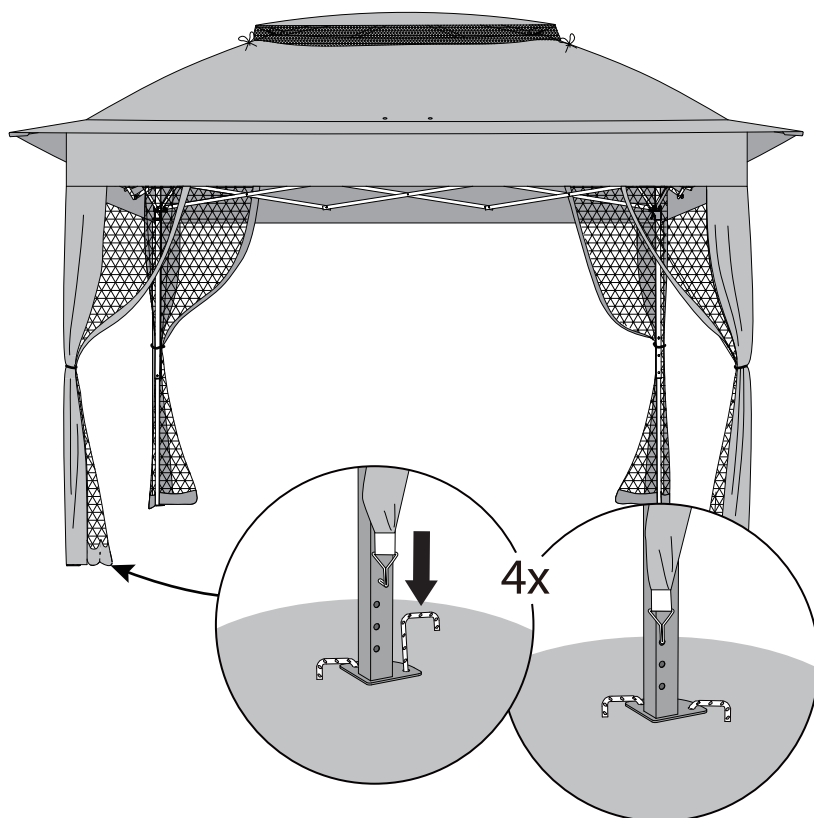



## SECURE THE CANOPY IN PLACE

### Step 10

You will need:

Big Stake

4X



Guy Rope

4X



- Attach the guy ropes to the plastic rings sewn in corners of the canopy top.
- Use the guy ropes to measure the proper distance from each leg to secure four stakes in the ground. Ensure the ropes have the proper tension.

4x

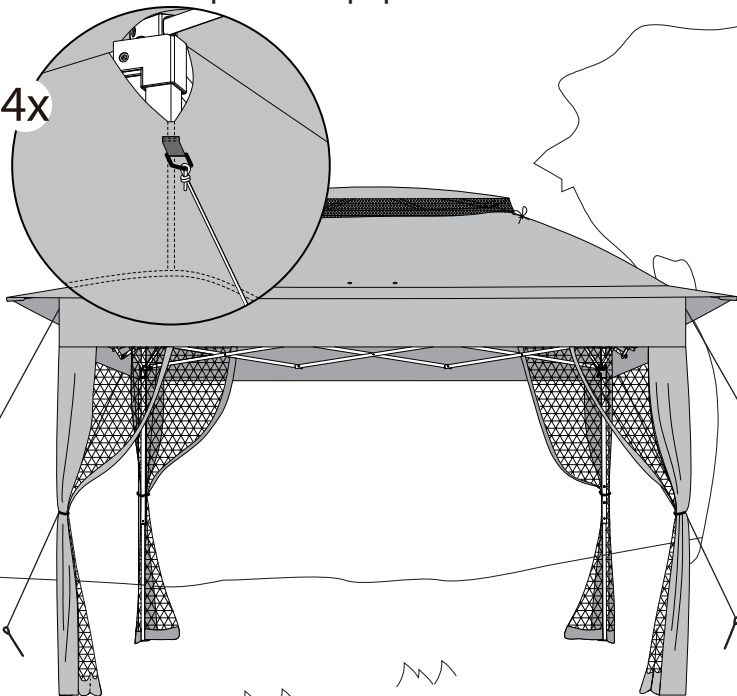

4x

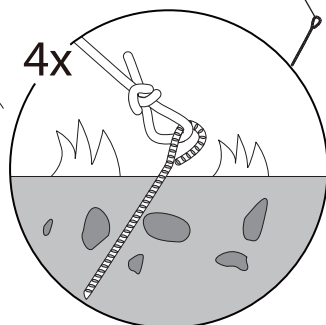

## TAKE DOWN THE CANOPY

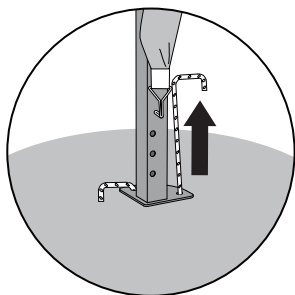

- 1** Pull up all stakes, release the hooks, remove the guy ropes.

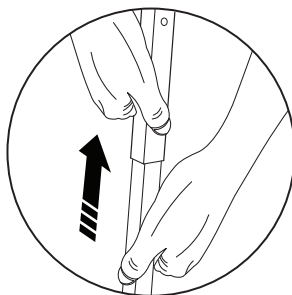

- 2** Retract the legs to the original height by pushing the push pin.

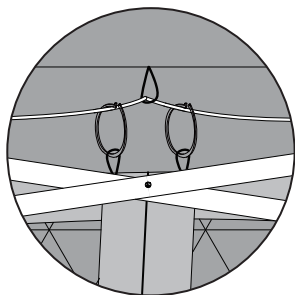

- 3** Remove the mosquito netting if attached.

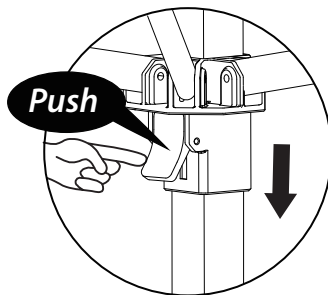

- 4** Push the push button on each slider to unlock the frame.

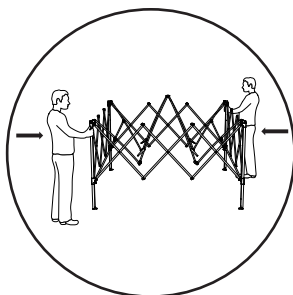

- 5** Push inward until the frame is fully closed.

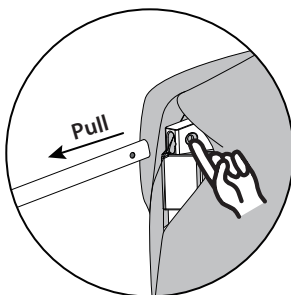

- 6** Remove the eave extender.

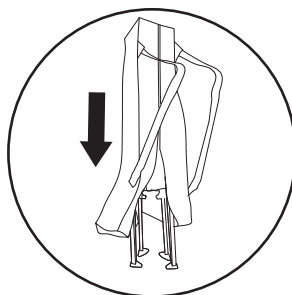

- 7** Put the closed gazebo and mosquito netting into the carry bag.

# REPLACEMENT PARTS

## Spare Parts

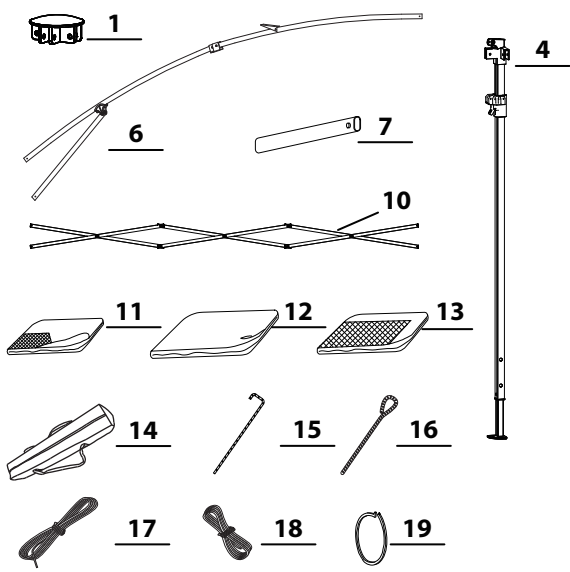
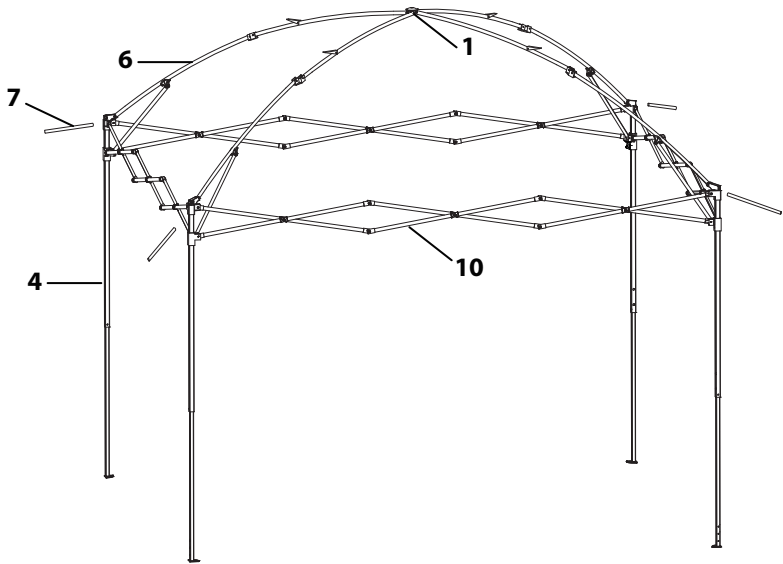

Part	Description
1	Central Cap
4	Leg Assembly
6	Ceiling Assembly
7	Eave Extender
10	Eave Assembly
11	Small Top
12	Big Top
13	Mosquito Netting
14	Carry Bag
15	Stake
16	Big Stake
17	Guy Rope
18	Netting Rope
19	Ring

