

ASSEMBLY INSTRUCTION

1020-431 THREE DRAWER NIGHTSTAND

BEFORE YOU START ASSEMBLING,
PLEASE MAKE SURE ALL PARTS & HARDWARE ARE INCLUDE IN BOX :

NO	PARTS	QTY
1	THREE DRAWER NIGHTSTAND	1 PC

NO	HARDWARE	QTY
A	SCREW $\varnothing 8 \times 2"$	1 PC
B	SCREW $\varnothing 8 \times 5/8"$	1 PC
C	RESTRAINT STRAP	1 PC
D	BRACKET	2 PCS
E	PLASTIC ANCHOR	1 PC

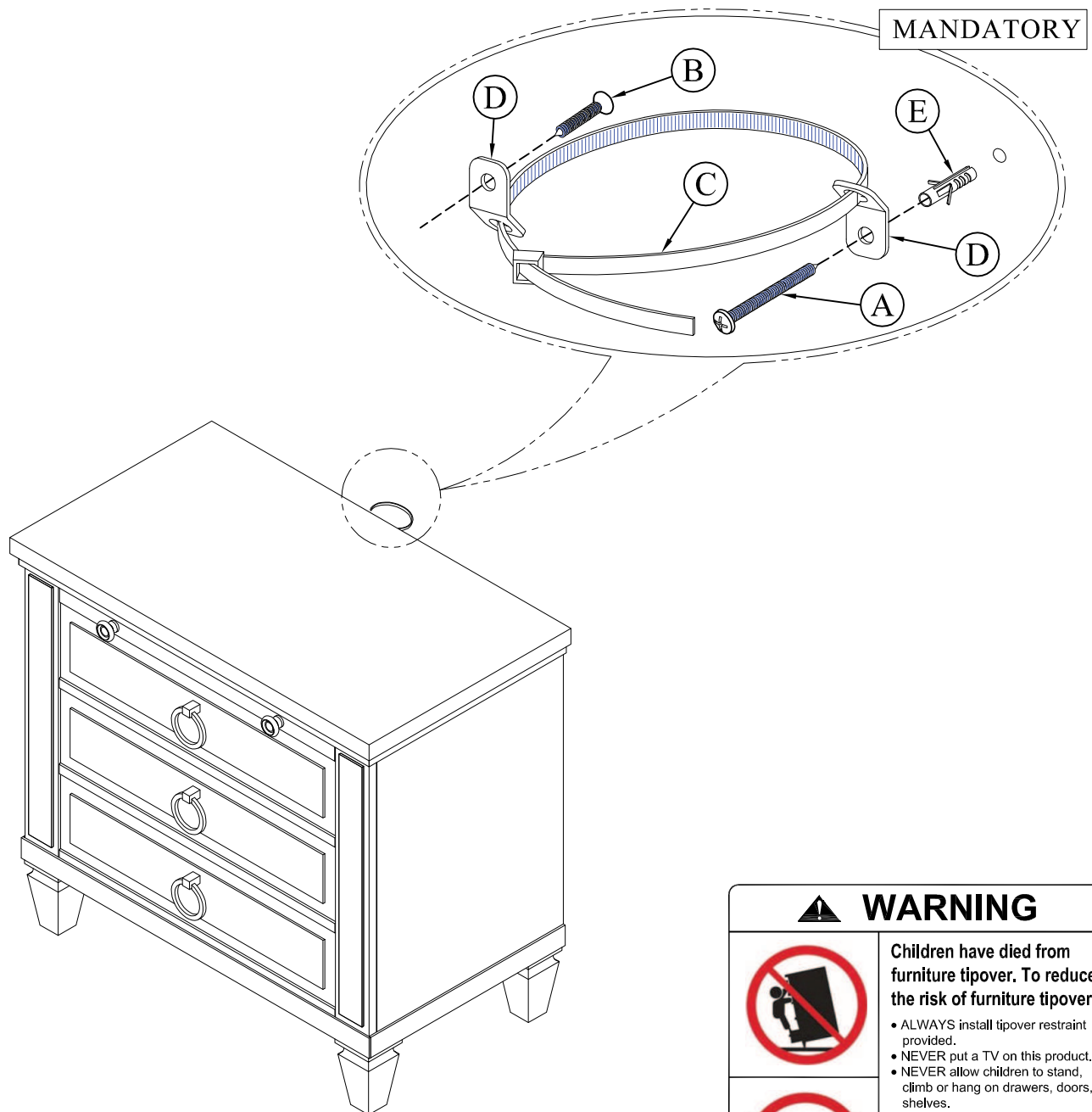

⚠ WARNING



Children have died from furniture tipover. To reduce the risk of furniture tipover:

- ALWAYS install tipover restraint provided.
- NEVER put a TV on this product.
- NEVER allow children to stand, climb or hang on drawers, doors, or shelves.
- NEVER open more than one drawer at a time.
- Place heaviest items in the lowest drawers.



This is a permanent label. Do not remove!