

# Media Cart

Congratulations on the purchase of your Media Cart. This media cart has been crafted to the highest standards of quality and safety and will give you many years of enjoyment and practical use.

Since this media cart is a natural wood product, there will be variations in color and grain, and minor checking may occur. This is normal and does not compromise the integrity of your media cart. In fact, variation in character of solid hardwood is integral to the beauty and appeal of hardwood furniture, and distinguishes it from prefabricated, synthetic and composite materials.

On this insert you will find a list of the hardware and parts included as well as detailed assembly instructions. Assembly is quite simple and requires only a Phillips head screwdriver. Assembly will be most easily accomplished if you take the time to carefully sort the hardware and familiarize yourself with the function of each piece.

If you need assistance with assembly, part replacement, or any other matter, please contact the toll-free Customer Service Team. You may also email your request or comments and a customer service representative will respond.

## Thank you and Enjoy

### HARDWARE LIST

10 Camlock connectors pins 

2 Caster wheels with locks 

2 Caster wheels 

10 Camlocks 

29 15mm wood screws 

2 Hinges pins 

6 40mm bolts 

30 wooden dowels 

1 Key 

### PARTS

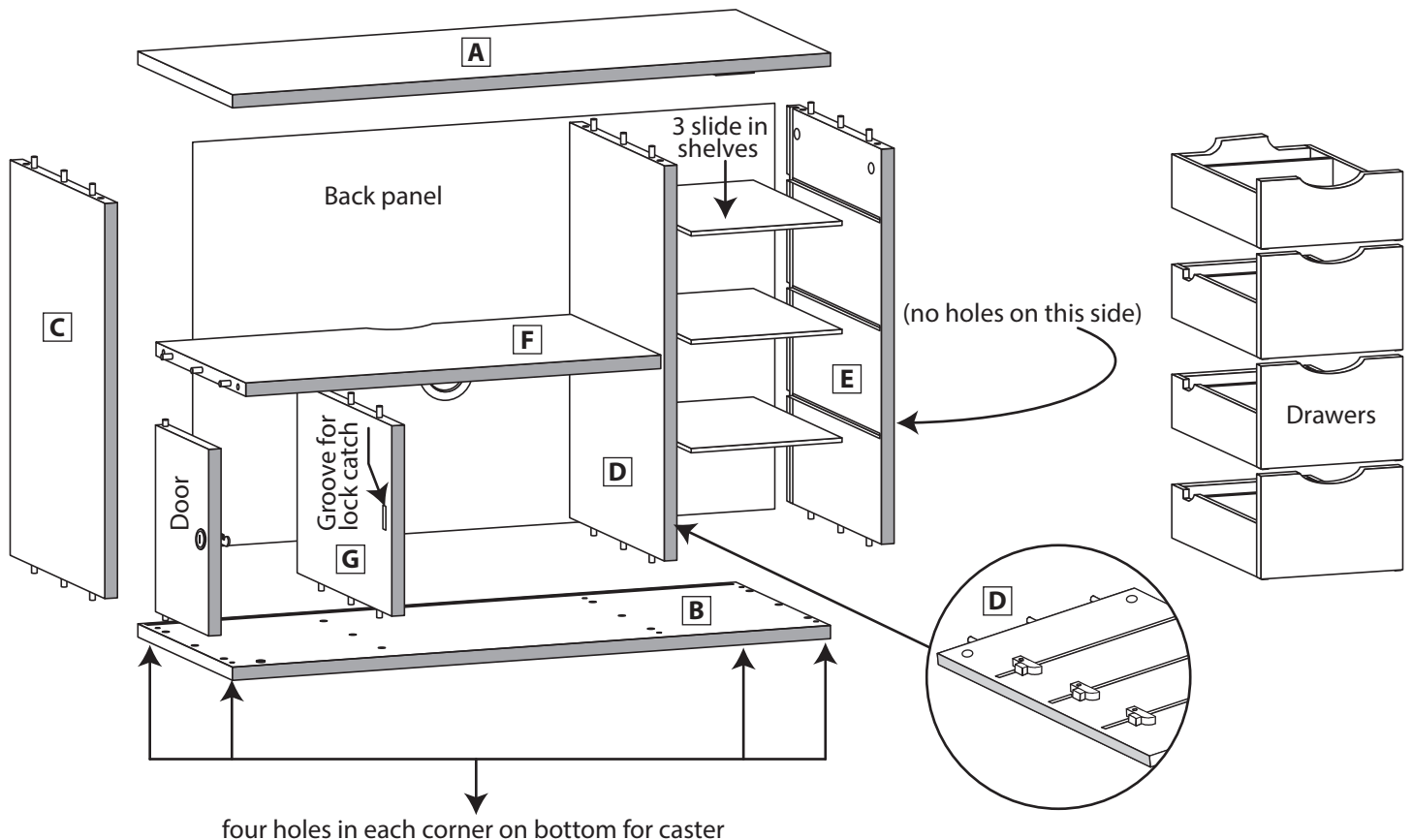

1) Locate panels **A** **C** **D**. Insert camlock connector pins into the threaded insert.

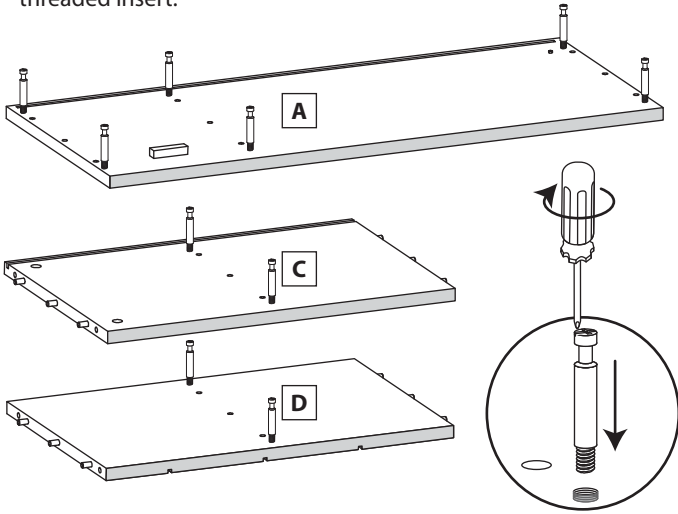

2) Attach the wooden dowels on **C** **D** **E** **F** **G**.

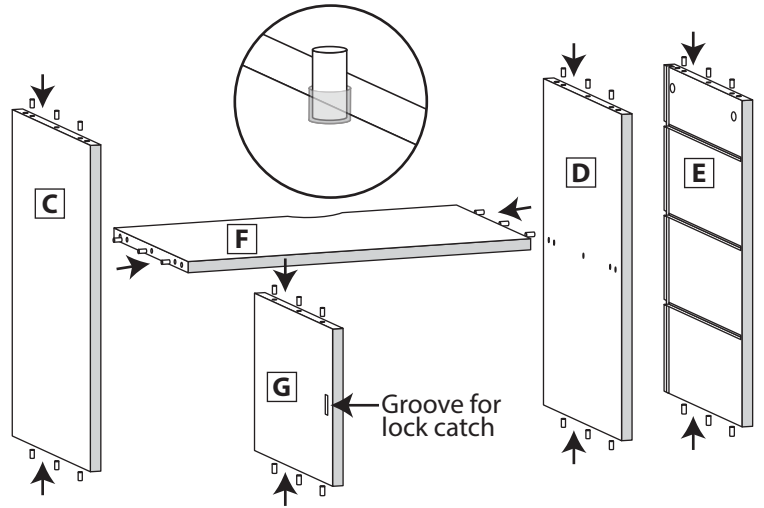

3) Place panel **D** on soft surface and locate panel **F**. **Attach each panel so the finished edges match up.** Insert the pins into the corresponding holes in the panel **F**. Secure panels by inserting one camlock into each of two corresponding holes on panel **F**. Turn each camlock about 1/4 turn or until gap between panels is gone. **Do not over-tighten.** It will damage the material.

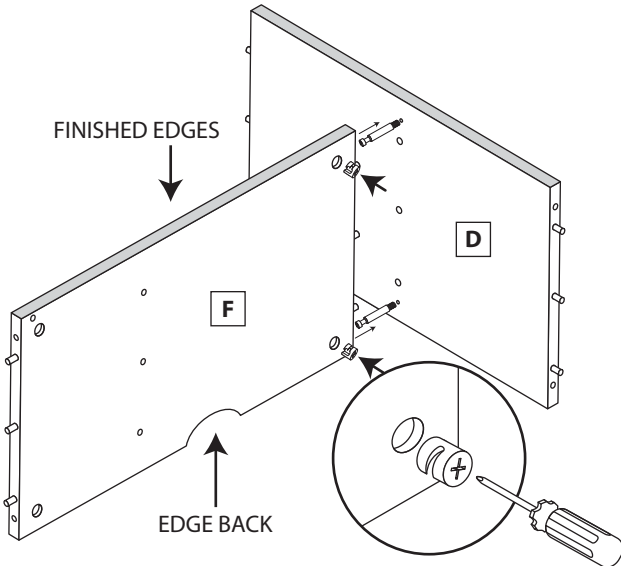

4) Locate panel **C** and attach with camlocks. **Be sure the finished edges are on the same side.**

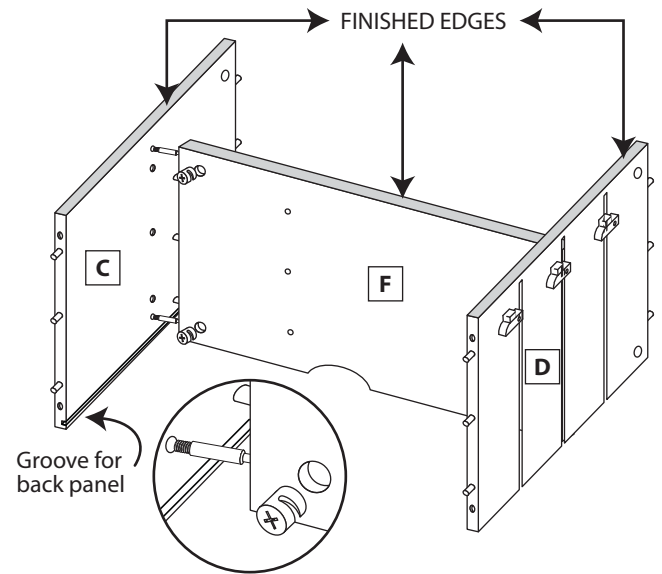

5) Locate panel **A** and join to the assembly using 4 camlocks

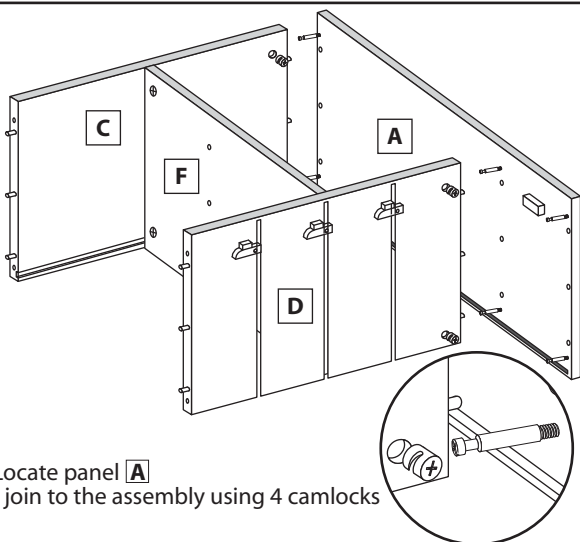

6) Attach panel **E** to panel **A** with camlocks and camlock connector pins.

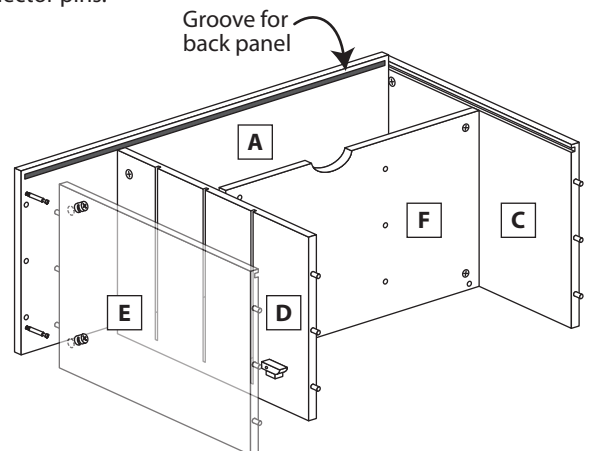

7) Attach panel **G** to panel **F**.

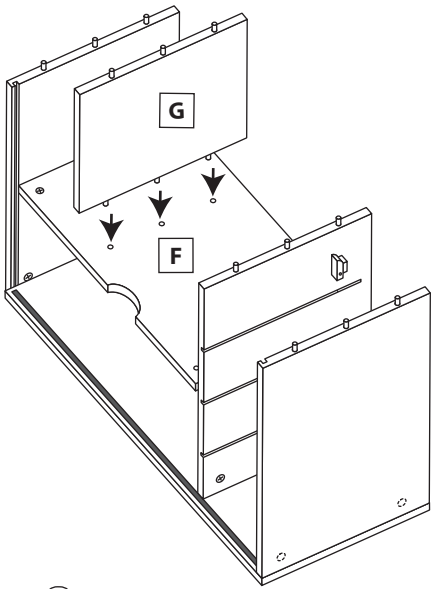

8) Slide the shelves into the slots cut on panel **D** & **E**.

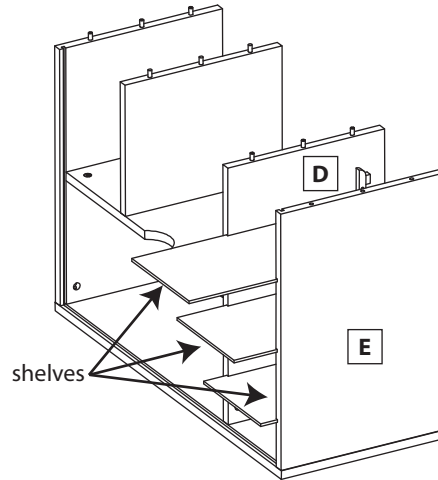

9) Slide the back panel into the groove on **C** & **E** with rubber ring closer to the "top".

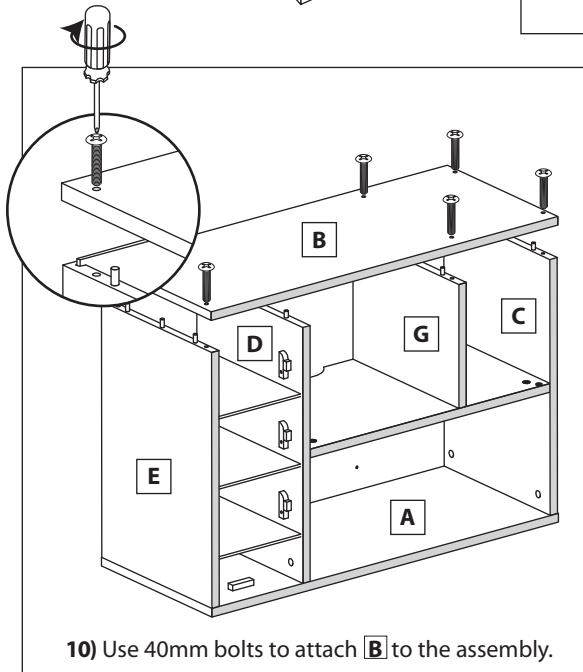
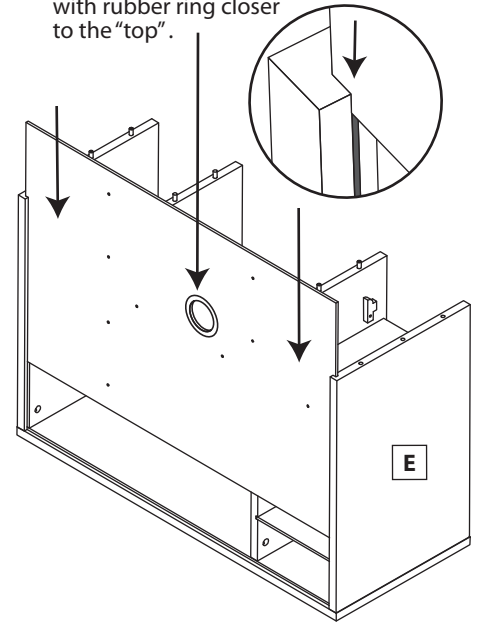

11) Use 15mm wood screws to secure the back panel.

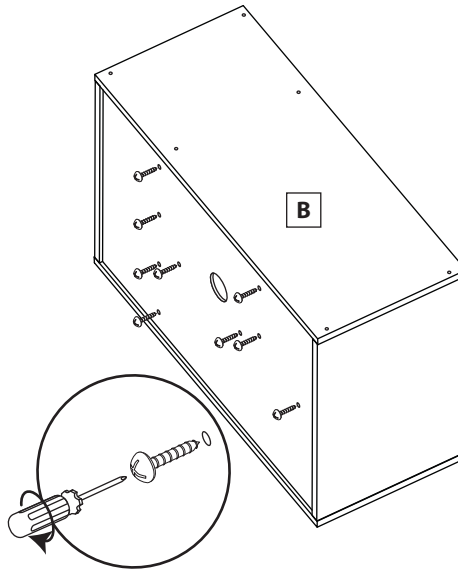

12) Use 15mm wood screws to attach the wheels to the bottom of the cart.

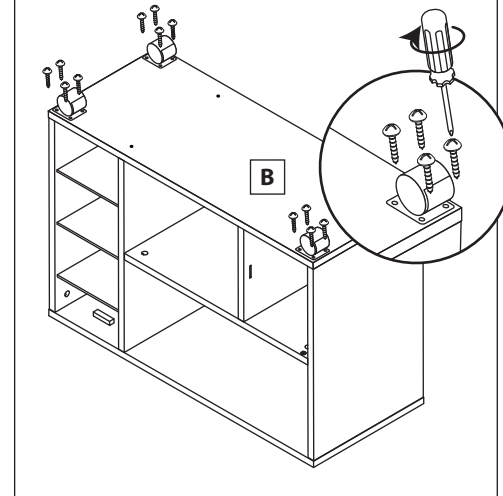

10) Use 40mm bolts to attach **B** to the assembly.

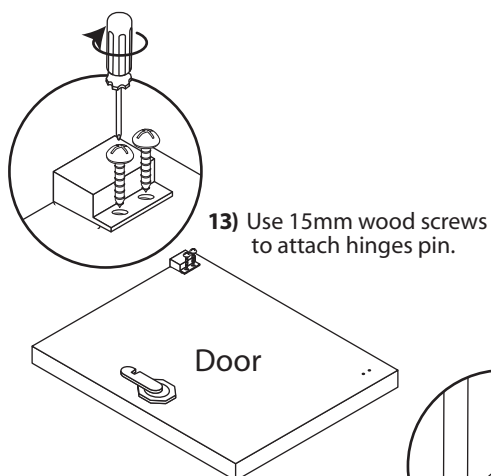

13) Use 15mm wood screws to attach hinges pin.

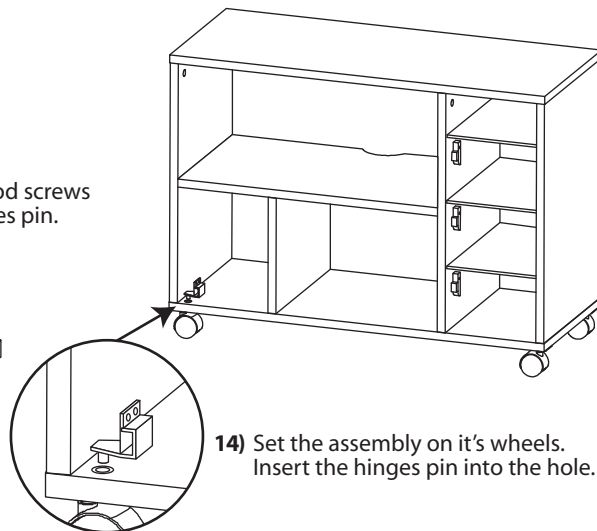

14) Set the assembly on it's wheels. Insert the hinges pin into the hole.

15) Attach the door by sliding the top hinges pin into the hole.

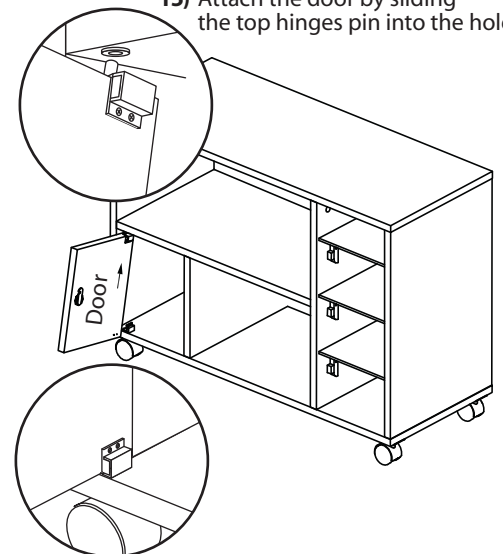

16) Use 15mm wood screws to attach the bottom hinges pin.

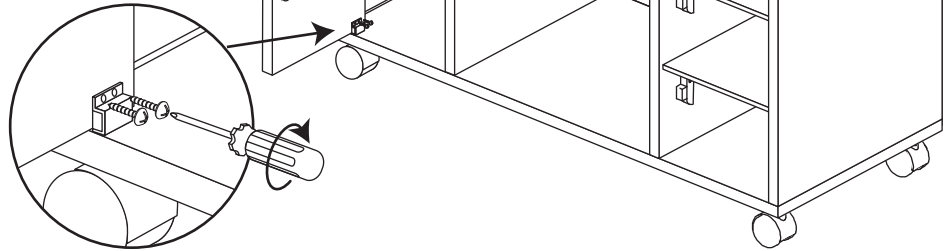

17) Insert the three drawers in the bottom three slots.  
**Note:** The wood drawers stops will swing out of the way when the drawers are inserted, you can slide them back into the down position once they've been fully installed.

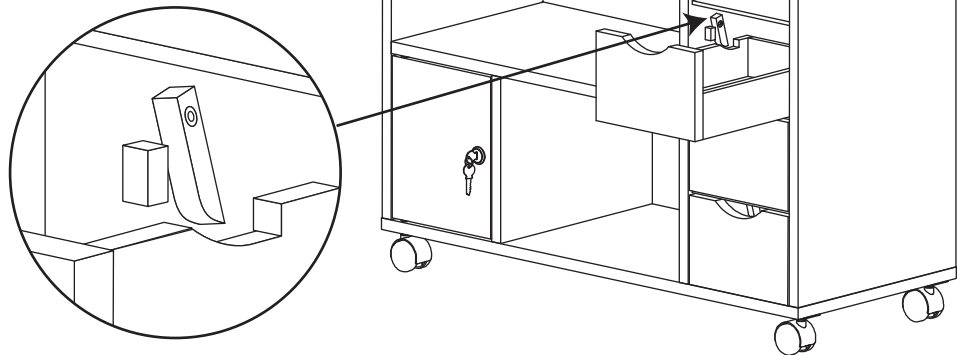

18) Locate the small drawer. It should be inserted at an angle so it will clear the wood block under the top panel. **Tip:** The drawer up and slide it in until the tab on the drawer clears the wood block. Return the drawer to horizontal and finish insertion.

