

ASSEMBLY INSTRUCTIONS

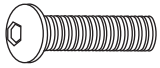

Ax6
(8x35mm)



Bx2
(Φ8mm)

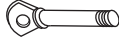

Cx4

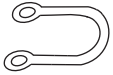

Dx4



Ex1
(5mm)



Fx1
(8mm)

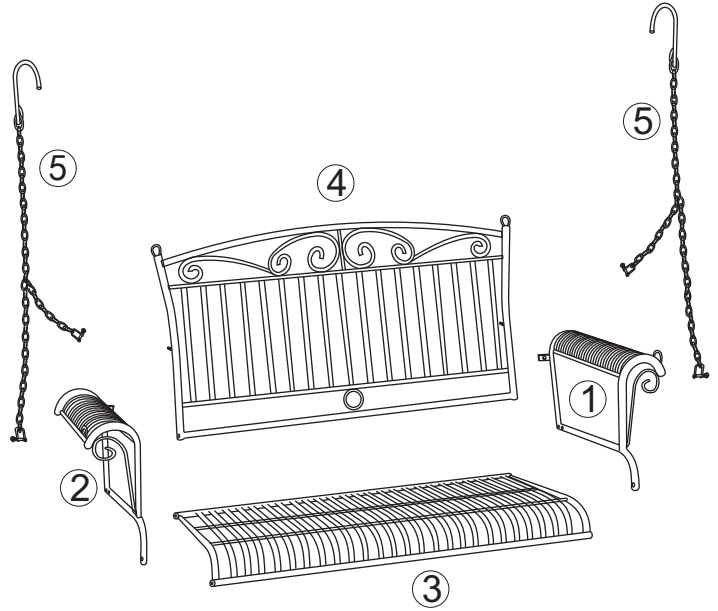

1

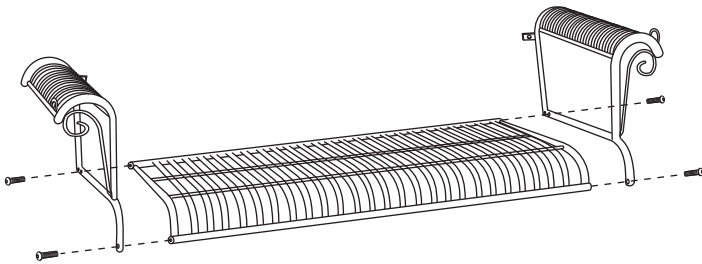

Ax4

2

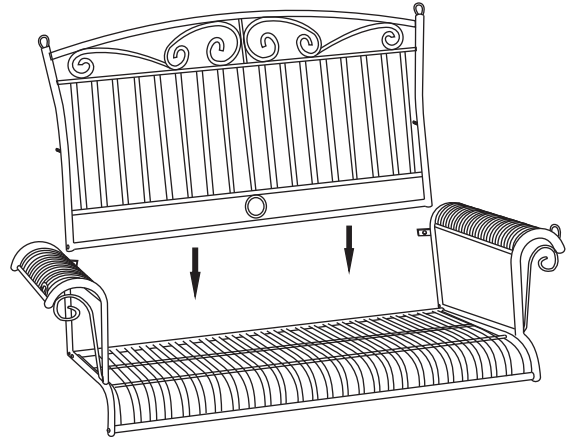

3

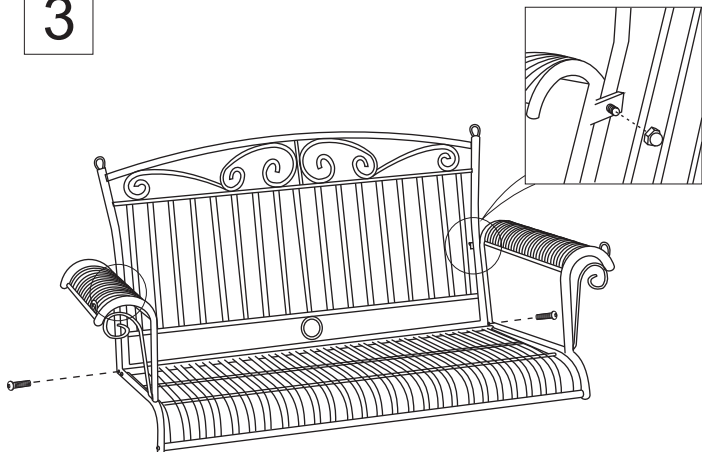

Ax2



Bx2

4

Please use pliers to fully tighten hook screw "C".

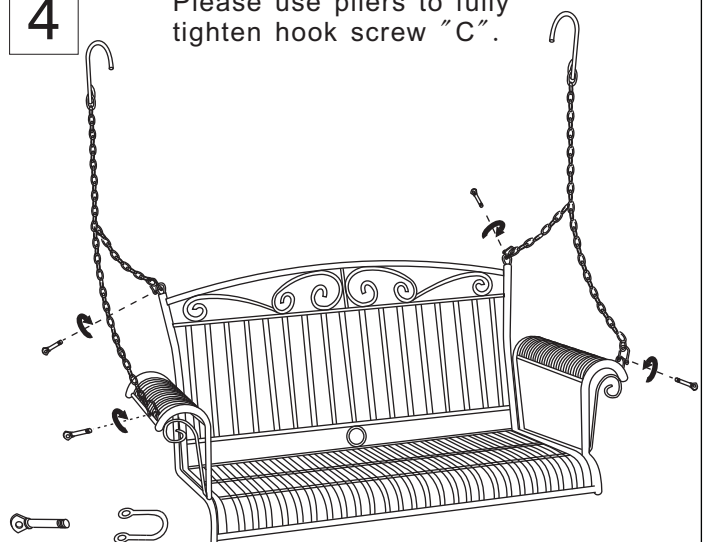

Cx4



Dx4