

SPECIAL FEATURE			
Product name	Chandelier		
Rated voltage	100V~120V,60Hz	Material	Aluminum+K9 Crystal
Lamp holde	G9	Style	Modern

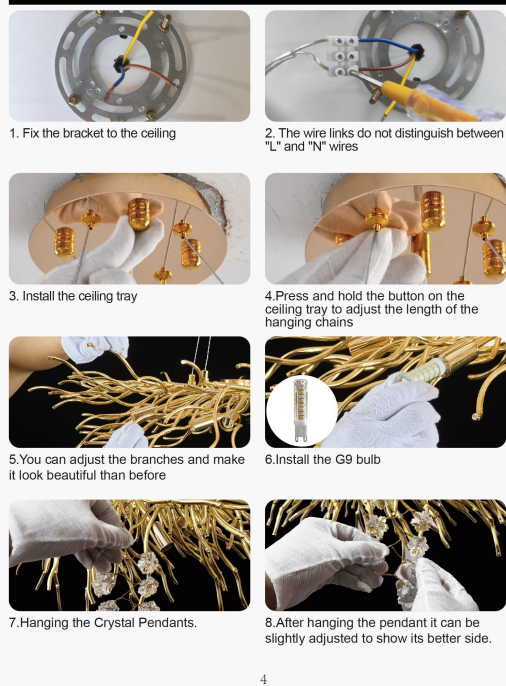

## INSTALLATION STEPS



## PLEASE NOTE:



Orders may be sent in multiple packages, and you may only receive some of them at this time.

Please don't worry, it is estimated that you will receive all the packages within two days, we will track and give feedback by email in time.

Thank you for your patience!

## Precautions:

1. If you find the crystals pendant broken or the mounting broken, please don't worry, we also have five percent free crystals pendant.
2. The lamps shall not be close to acid, alkali chemical objects and gases containing corrosive, shall not be cleaned with water, it is recommended to wipe with a clean soft cloth.
3. Wear white gloves for installation
4. Safe power supply: Before carrying out any electrical work, ensure that the relevant circuit is closed and use a voltage tester to verify that the wires are not charged. If necessary, turn off the power to the main new circuits or related circuits.
5. Wire Connections: Use the correct size wire and use the appropriate wire connectors to make the connections. Make wire connections in accordance with electrical codes to ensure proper insulation and protection of wire connection points.
6. Safe Spacing: Ensure that there is adequate safe spacing between the chandelier and combustible materials in accordance with the electrical code. This will avoid fire risks and overheating problems.
7. Test and Verify: Before reconnecting the power supply, double-check all wire connections and use a voltage tester to verify that the electrical connections are correct and safe. Make sure the pendant light switch and dimmer are working properly.



## 3 years warranty

If the goods have transportation and quality problems, free returns and exchanges.



If you have any questions, welcome to contact us by email, we will serve you wholeheartedly.