

LED Glass Semi Flush Mount

Caution: Please turn off power before installation and read the manual carefully, we advise you contact professional electricians to install for safety purpose.

Product Features

Style: Modern

Material: Metal, Glass

Base Type: Integrated LED

Light Source Included: Yes

Voltage: 120VAC

Wattage: 18W

Package includes

1 x Ceiling Light

1 x Accessories Kit

1 x User's Manual

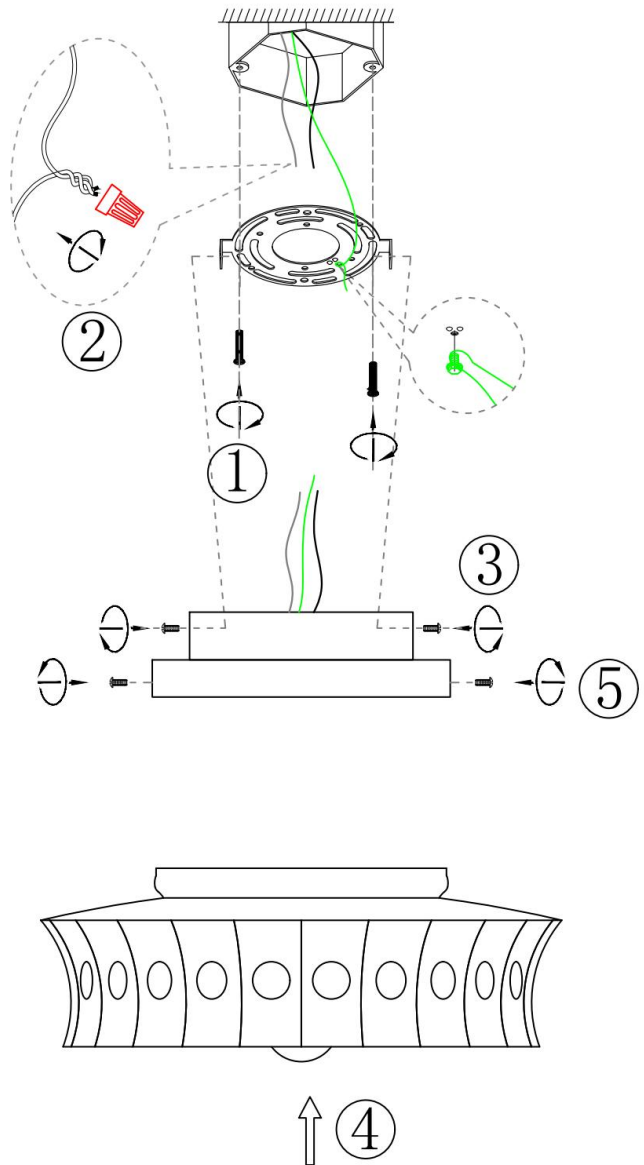

Installation Instructions

1. Fix the back plate to the junction box with screws
2. Connect the live wire and neutral wire of the lamp body with the wire reserved on the junction box using wiring cap
3. Cover the mounting plate onto the back plate and fix the mounting plate with screws
4. Insert the glass shade into the lamp body and fasten the glass shade using screws

Note: please use this product accordingly to its intended purpose, do not retrofit or remodeling the product. The warranty does not cover if the failure is caused by the third party product, or natural disasters.

Made in China