

ASSEMBLY INSTRUCTIONS

BED - king

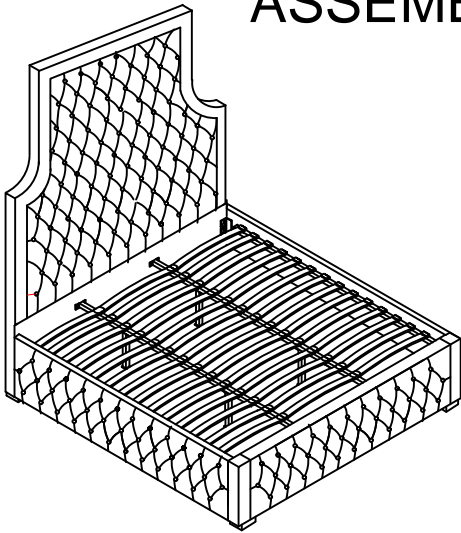

+ Parts Included

- ① Head Board(1pc) ② Foot Board (1pc) ③ Side Rails (2pcs)

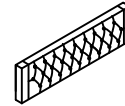
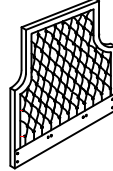

- ④ Double Plastic cap(30pcs) ⑤ Center Support Bar(2pcs) ⑥ Support Legs(4pcs)

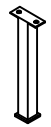
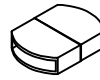

- ⑦ Slats (45pcs)

- ⑧ Single Plastic cap (30pcs)

- ⑨ Legs (4pcs)

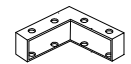
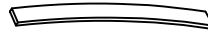

*Slats come packed in the bottom of headboard carton.

+ Do Not Use Power Tools



+ Suggested Adults

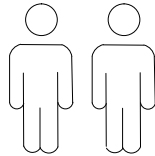

NOTE:

- 1 Read instructions cover to cover.
- 2 Save all packaging until assembly is completed.

1 IMPORTANT SAFETY INFORMATION

Do not assemble the product if any of the following parts arrived damaged:

- Part # ③ -Side Rails
- Part # ⑤ -Center Support Bar
- Part # ⑥ -Support Legs
- Part # ⑦ -Slats

2 IMPORTANT ASSEMBLY INFORMATION

Assembly Step ③ Ensure the side rail bracket is fully hooked onto bolt A loosely threaded with both washers on the OUTSIDE of the bracket first, then proceed to fully tightening all 4 corners.

Assembly Step ⑥ When installing slats, ensure that the curve is facing upwards. (↖) (↗)
*Slats come packed in the bottom of headboard carton.

+ Hardware Included

A Bolt M8*30mm (24pcs)

B Bolt M6*75mm (8pcs)



D Spring Washer (8pcs)

E Flat Washer $\phi 20$ (24pcs)

F M8 Allen Key (1pc)



H M6 Allen Key 1pc

I Nut M8*13mm (8pcs)



J Spanner (1pc)



ASSEMBLY INSTRUCTIONS

