

XMJH-V 1

FTBFBF-0008
FTBFBF-0046

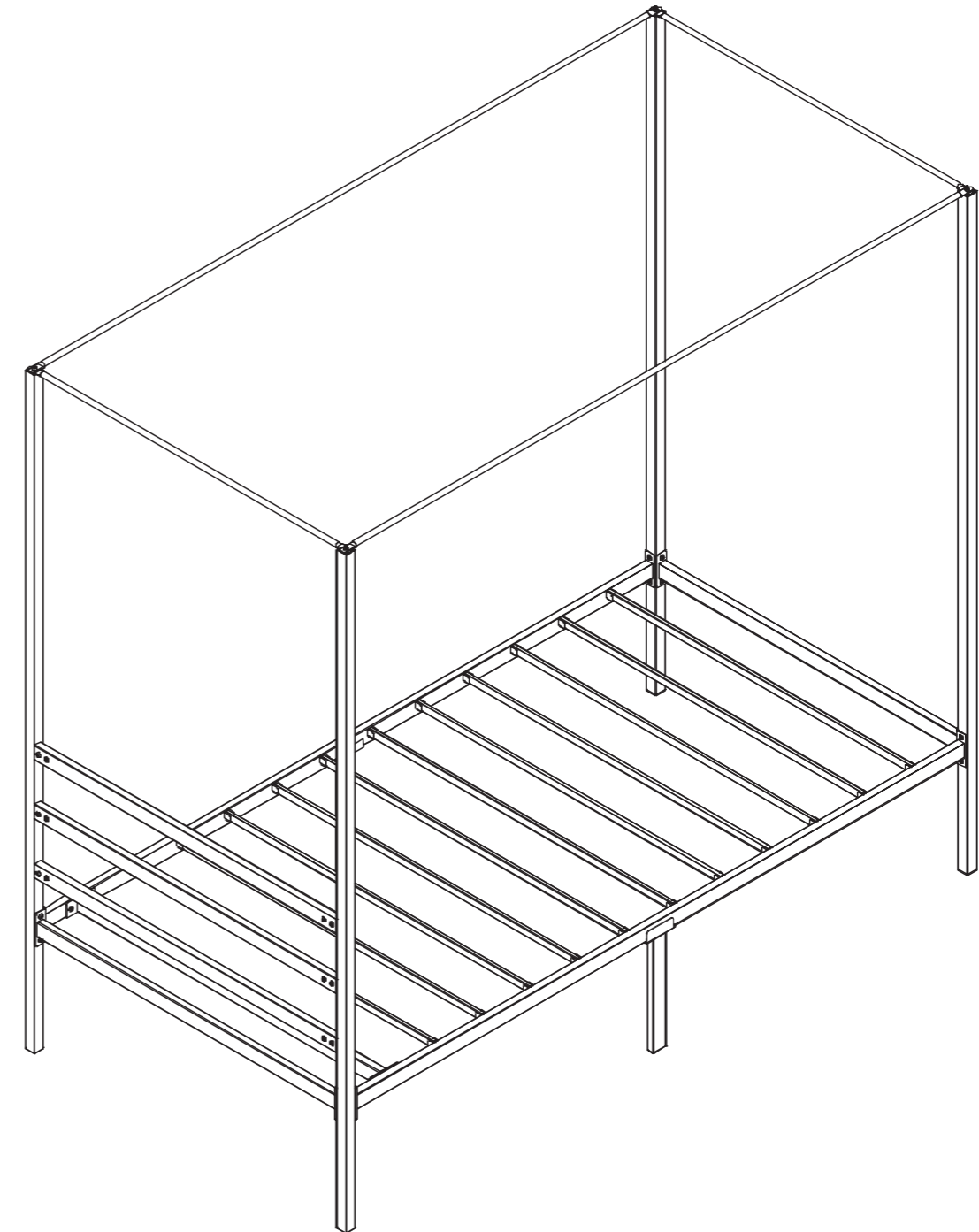

METAL CANOPY BED FRAME (TWIN)

CONTACT US:

If you have any questions about the installation of YITAHOME products, just contact us at +1 (888) 717-8084 from Mon-Fri 8:00 AM-4:30 PM PST / Sat. 8:00 AM-12:00 PM PST or e-mail us at after-sale.cs@hotmail.com

Alternative method to contact us (amazon.com orders only)

1. Log into your Amazon account
2. Go to "Your Orders" and find the purchase
3. Click on "Contact Seller"

- ⚠ 1. Two or more people are required for the assembly.
- 2. To avoid squeaking, fix the bolts tight until they can no longer turn. An electric drill is recommended for the assembly.

Tools Required For Assembly

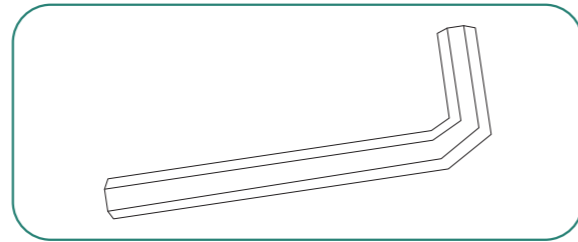

Item no.	Reference Image	Qty.
A		X 1
A1		X 1

Item no.	Reference Image	Qty.	Item no.	Reference Image	Qty.
B		X 2	C		X 2

Item no.	Reference Image	Qty.
D		X 1
E		X 3
F		X 1
G		X 40
H		X 1
I		X 10
J		X 2
O		X 2
P		X 2

Item no.	Reference Image	Qty.	Item no.	Reference Image	Qty.
M		X 1	N		X 1

1

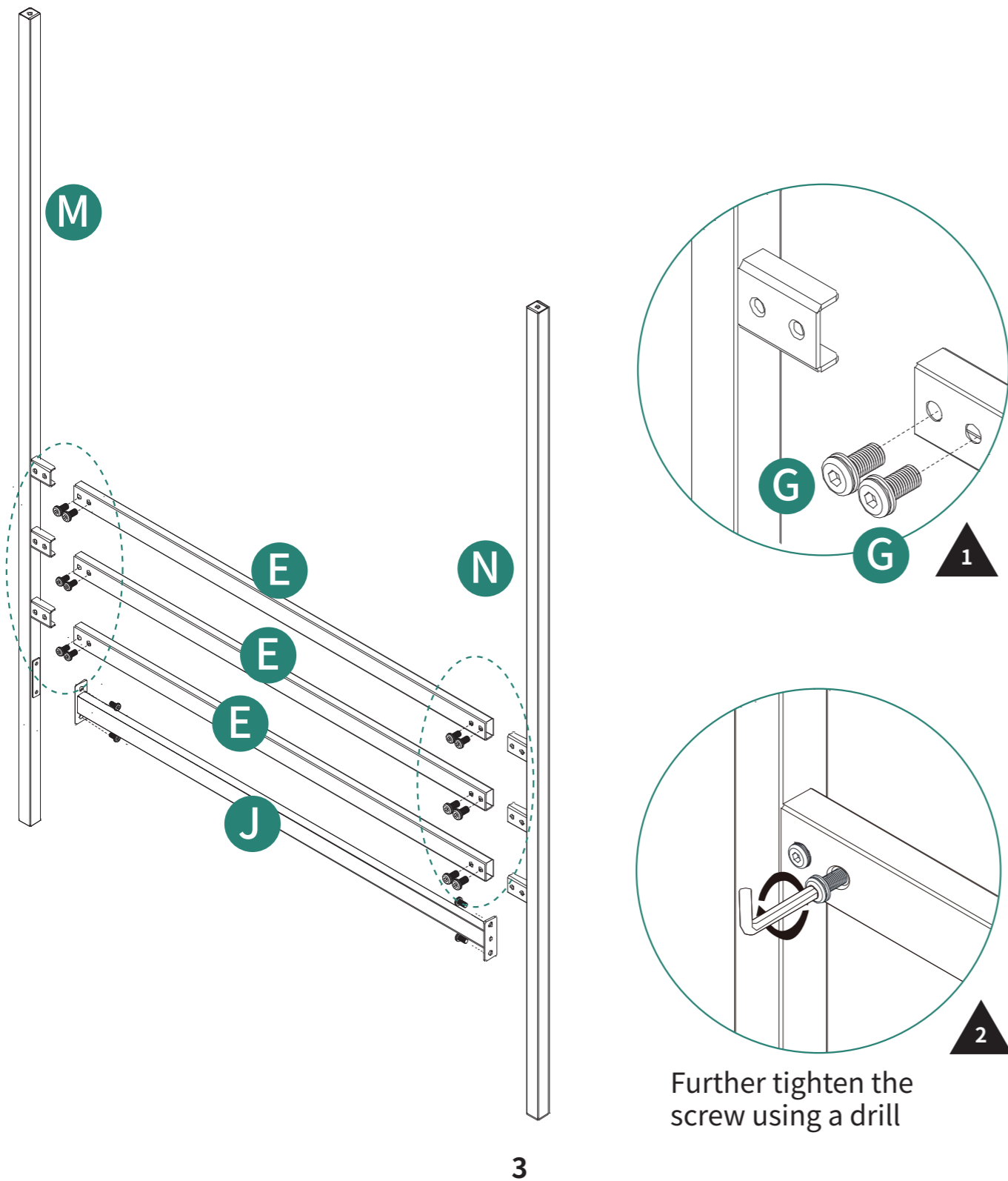
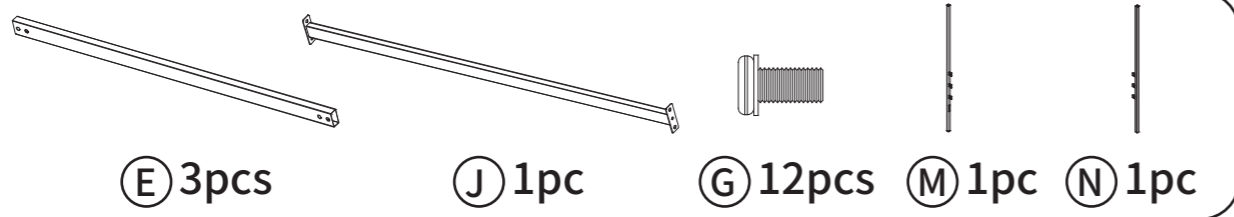

2

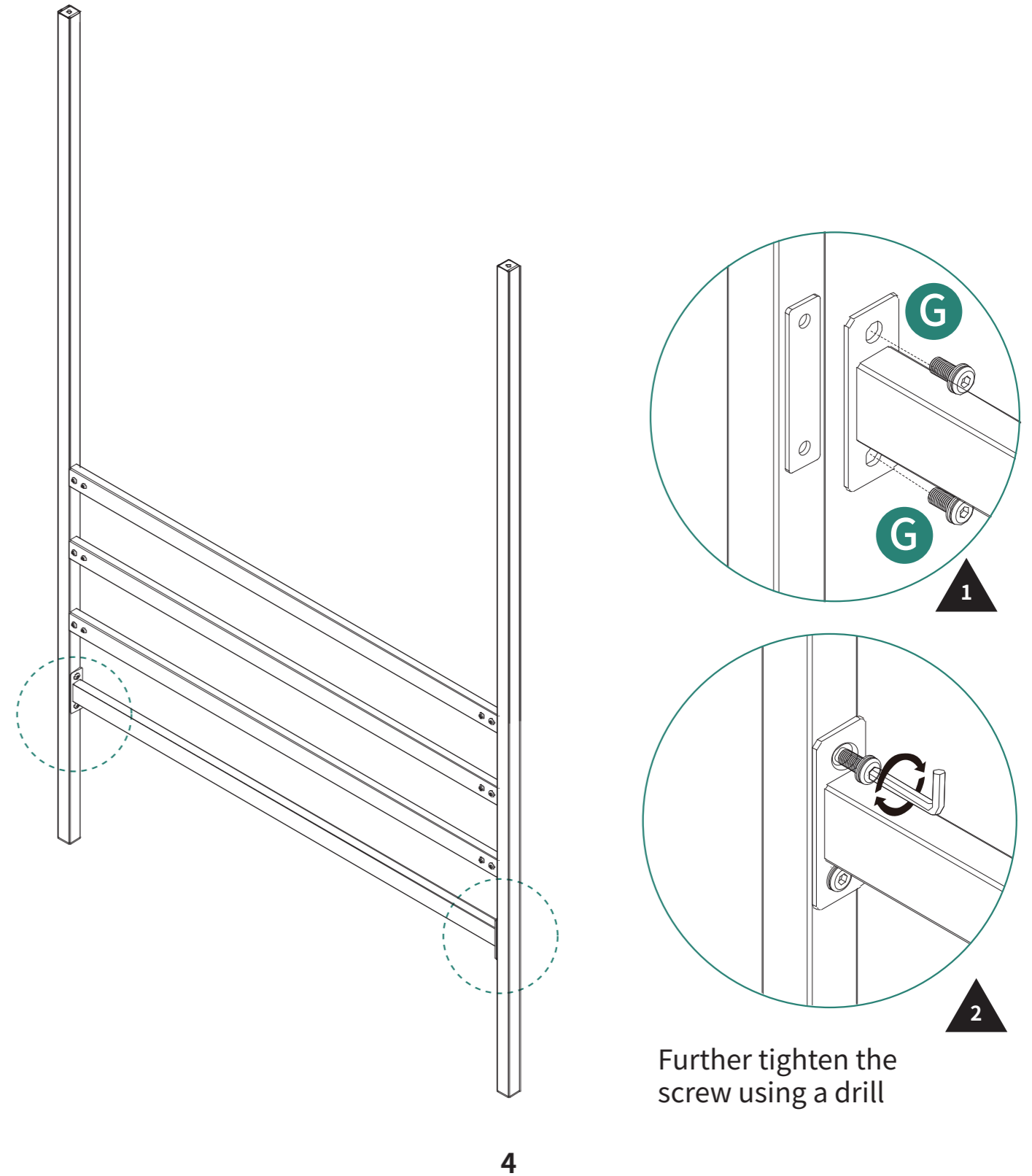

3

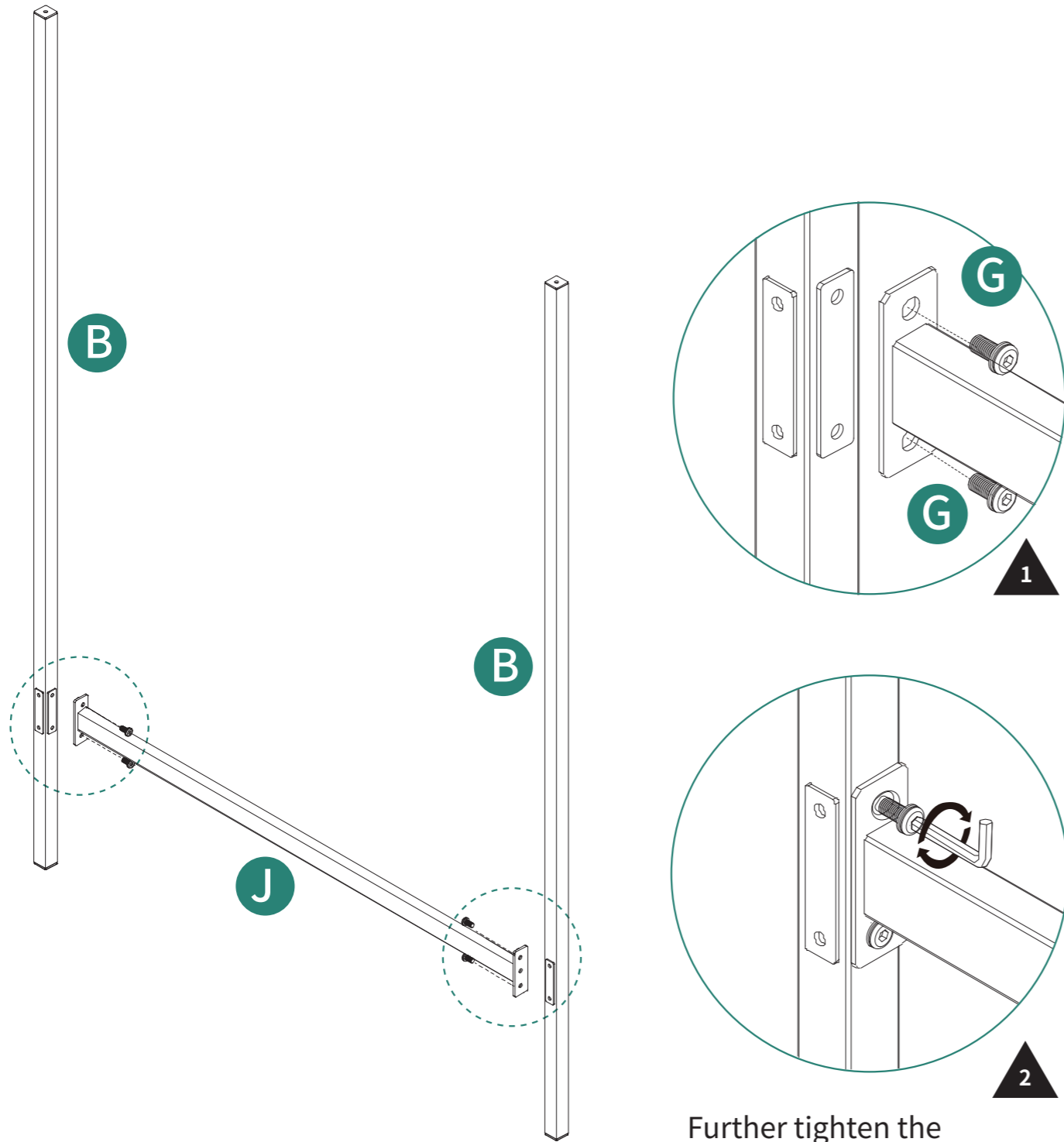
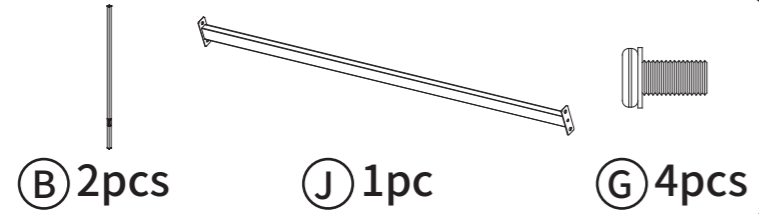

Further tighten the screw using a drill

5

4

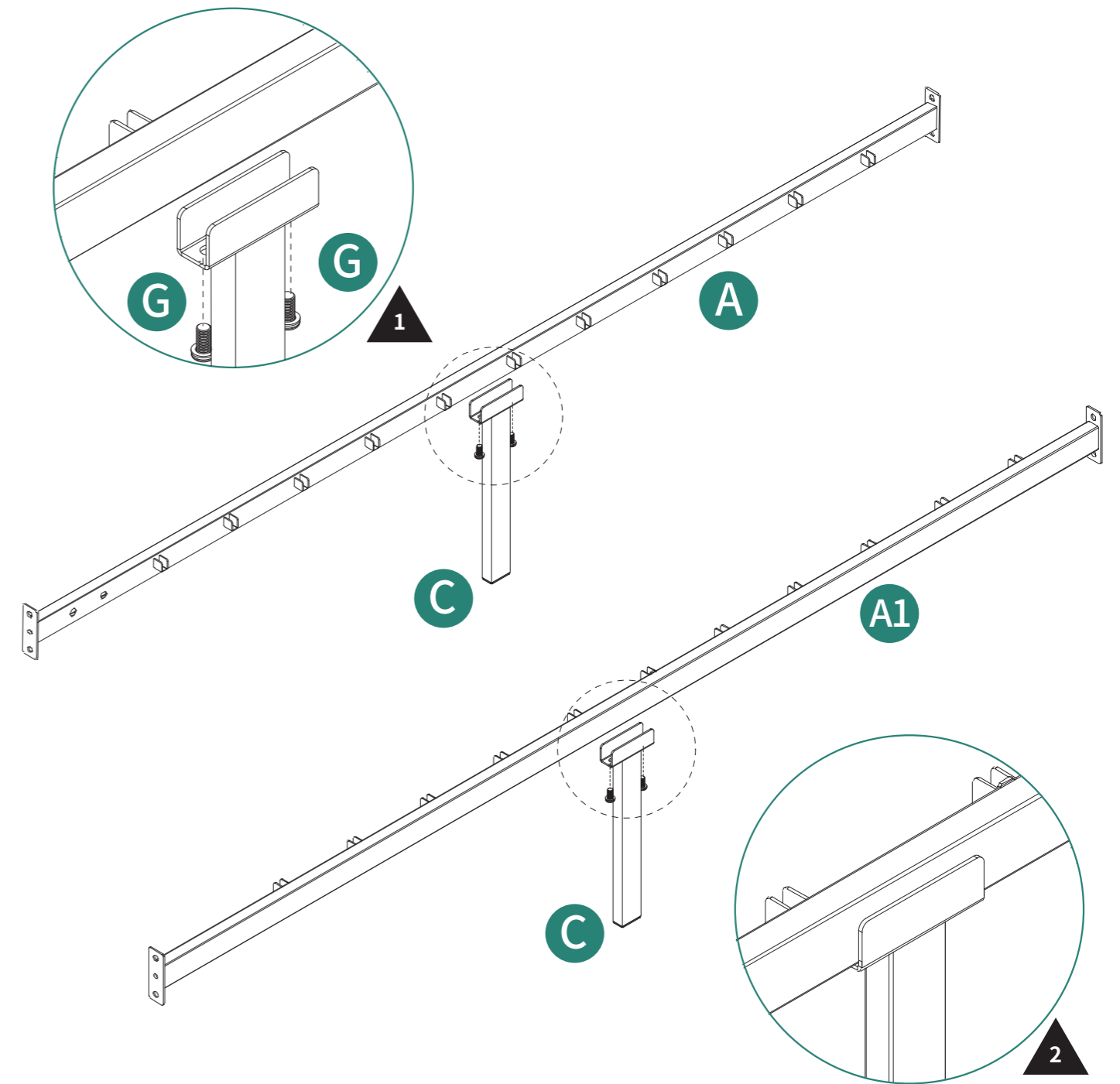
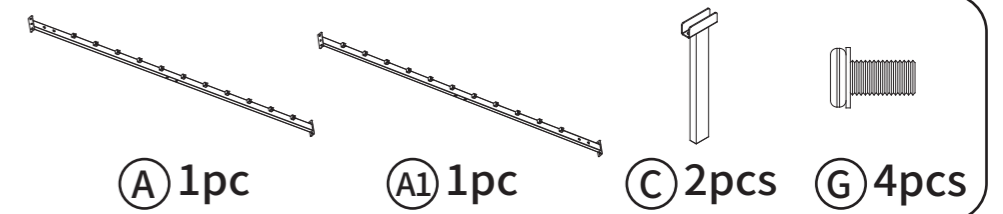

6

5

Ⓓ 1pc

Ⓔ 4pcs

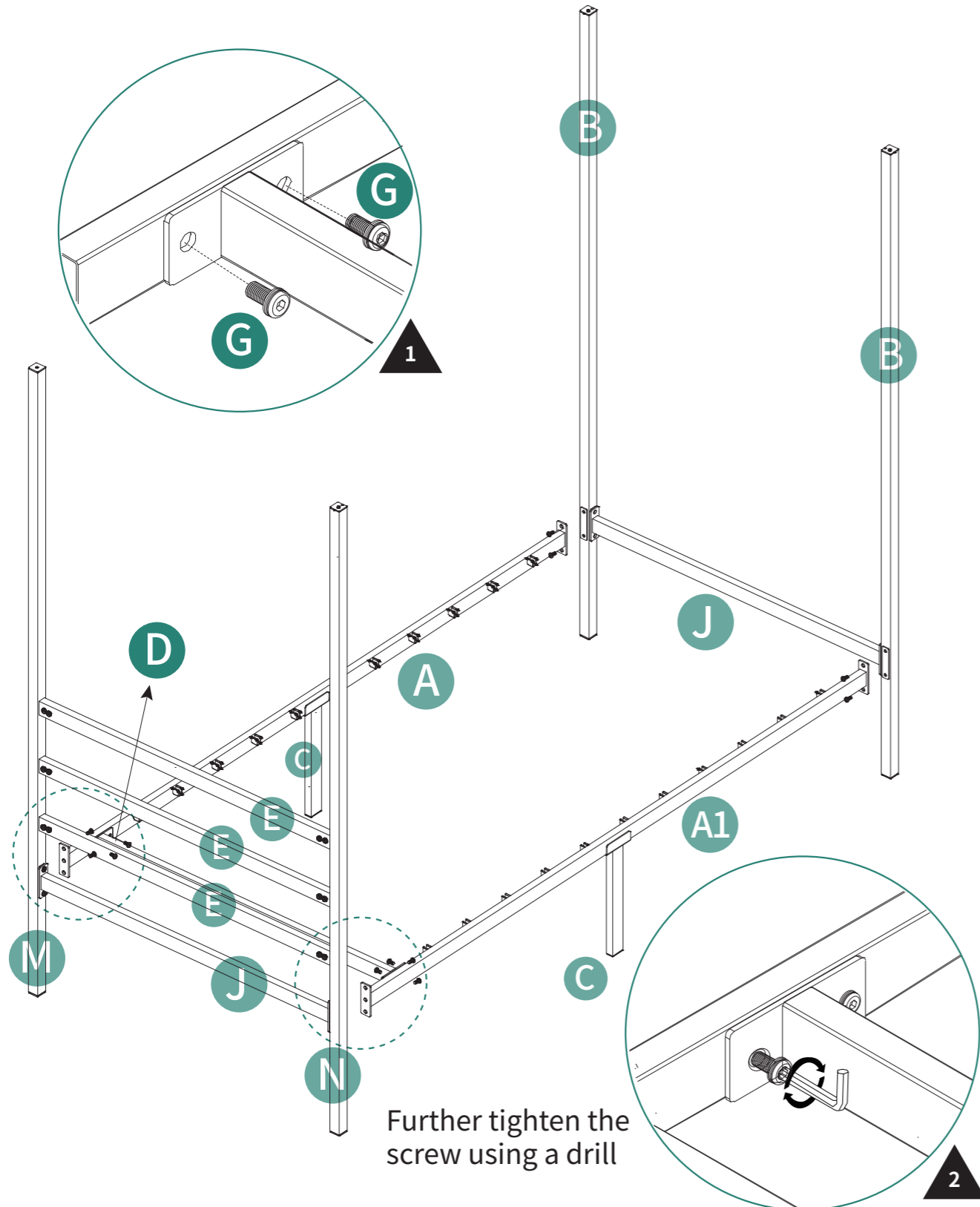

7

6

Ⓔ 8pcs

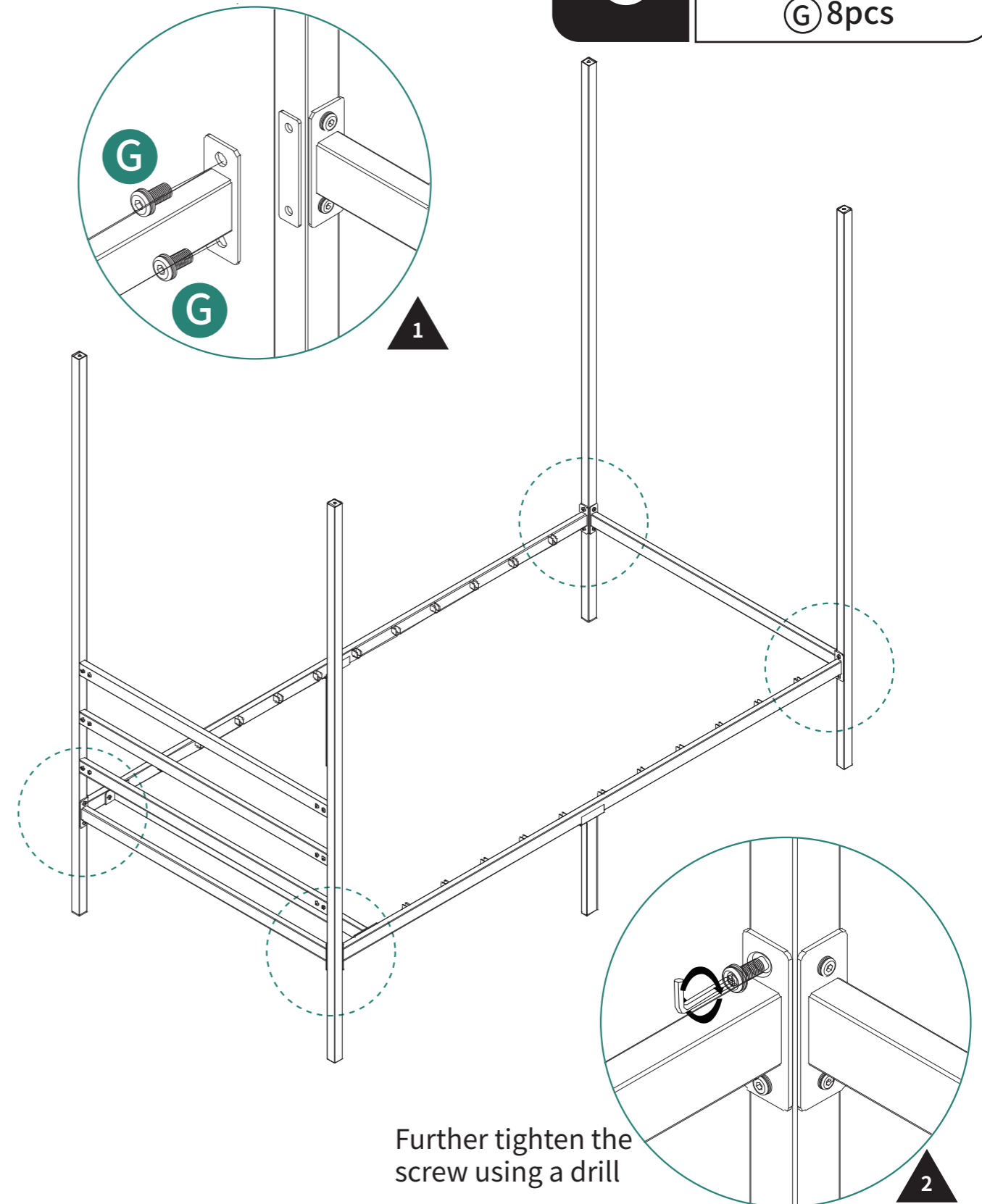

8

7

⊙ 2 pcs

Ⓟ 2 pcs

Ⓤ 4 pcs

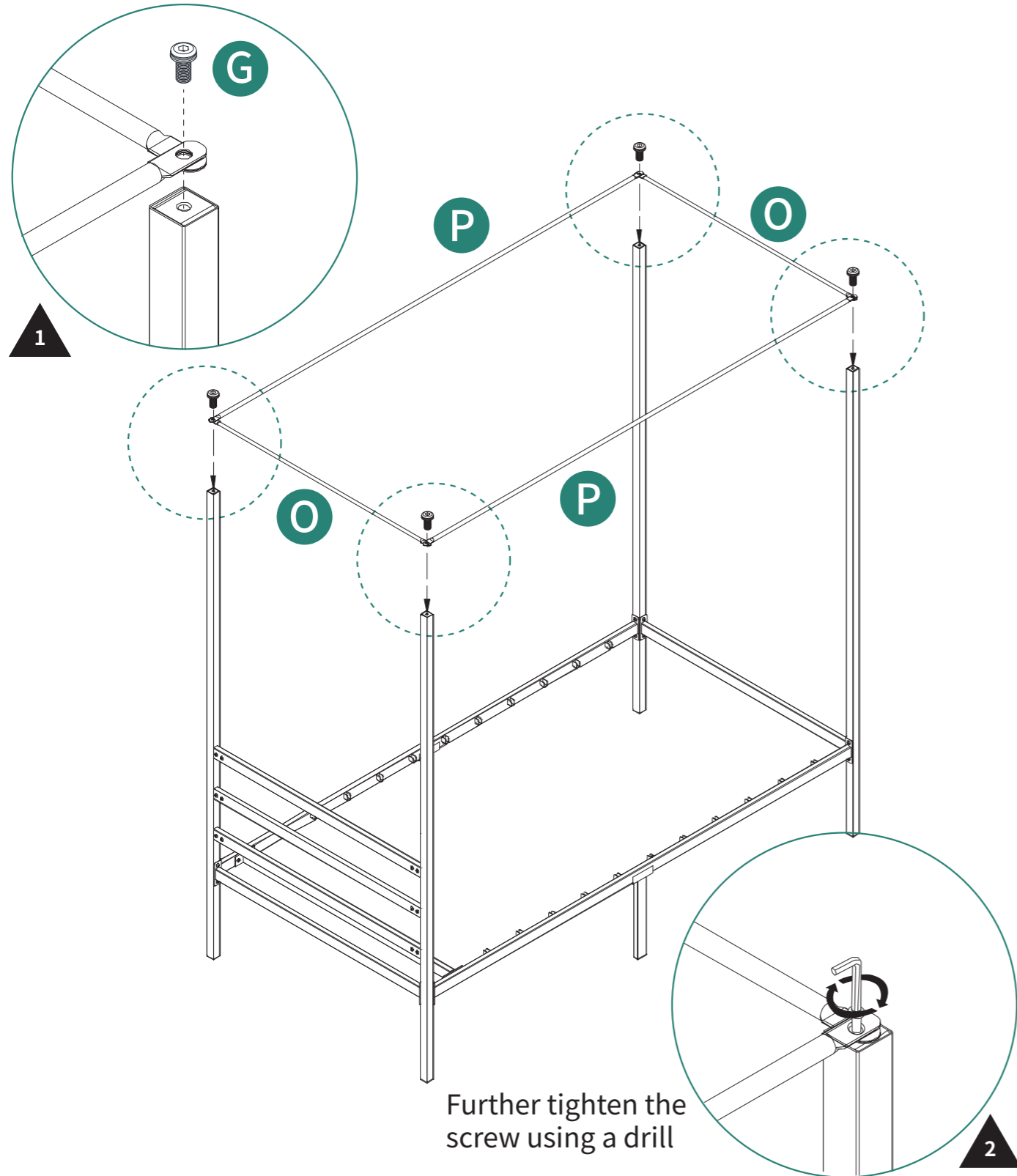

Further tighten the screw using a drill

9

8

Ⓜ 1 pc

Ⓛ 10 pcs

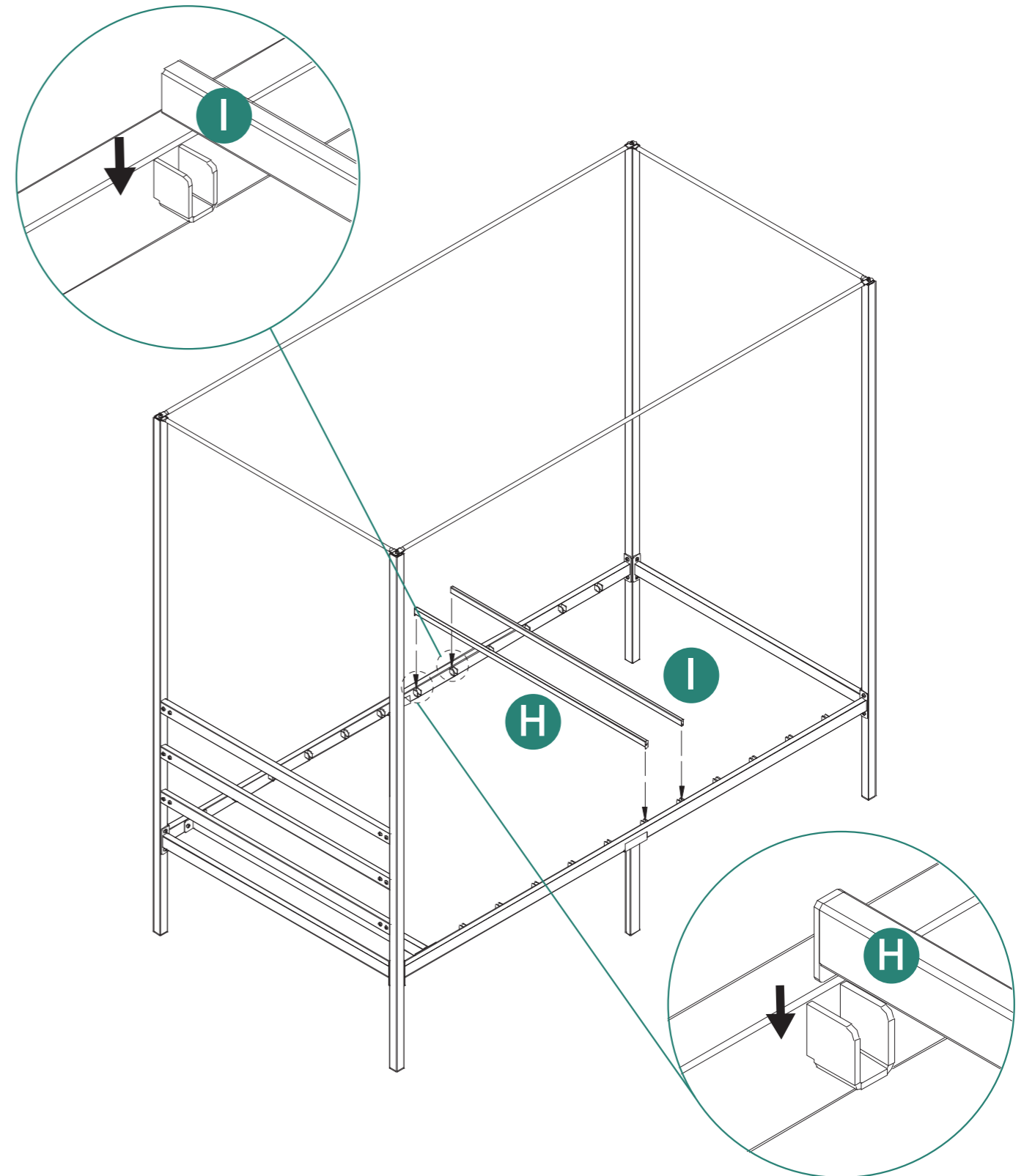

10

9

H-type steel slats can be installed into any side groove and provide solid support for the bed frame.

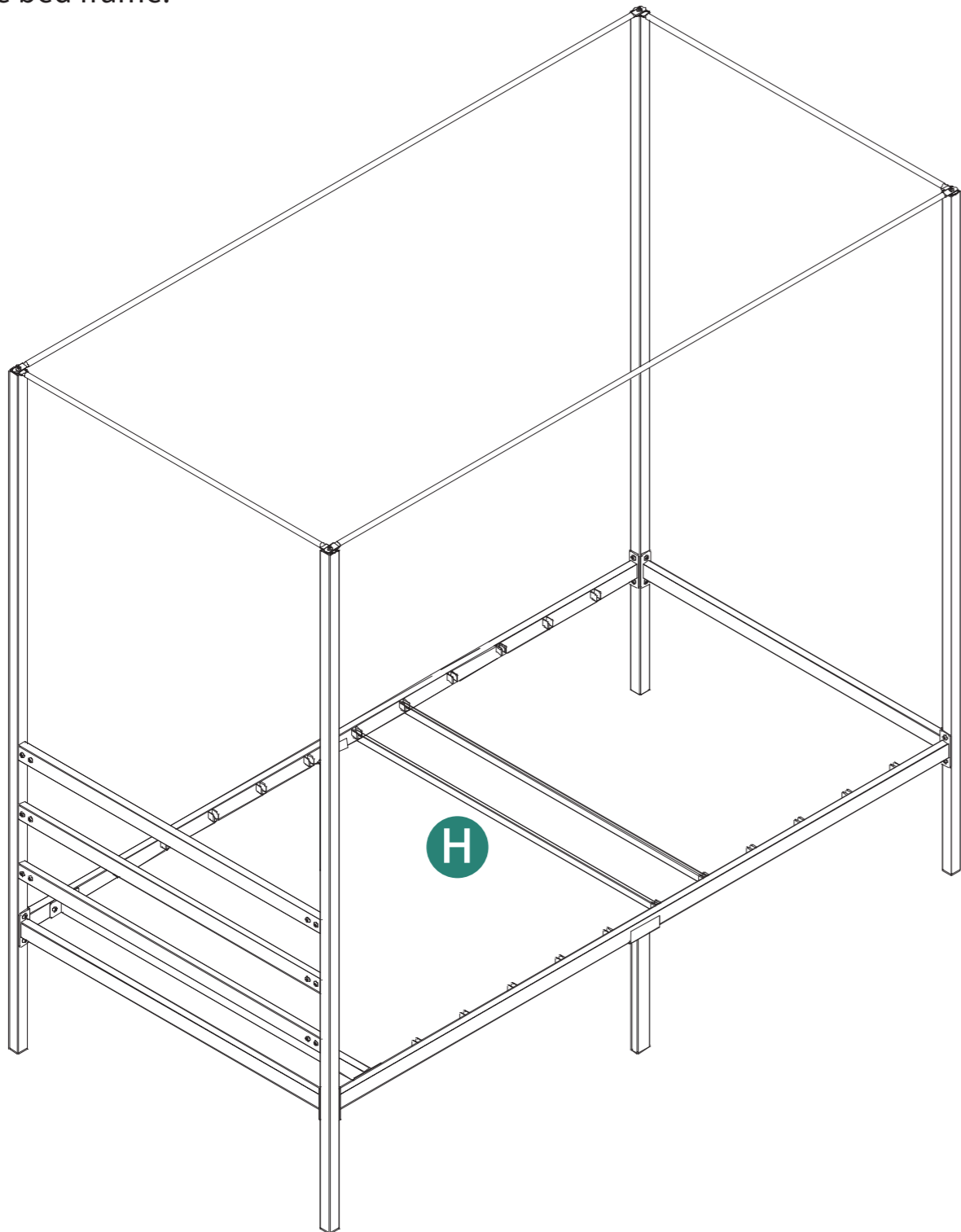

11

10



Complete Installation

12