

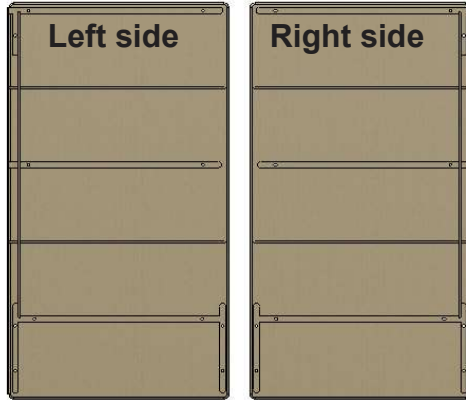

C21030 ASSEMBLY INSTRUCTIONS

Parts:

Set of sides



(2) Dividers

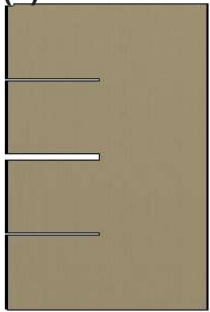

Front rail



Back rail w/o (3) holes



Top

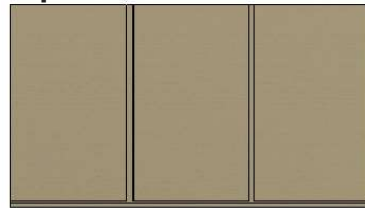

Bottom

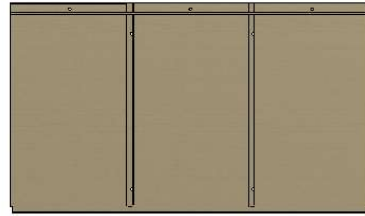

15mm Shelf

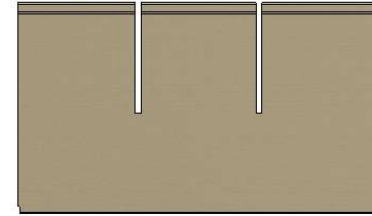

(2) 4mm thick shelves

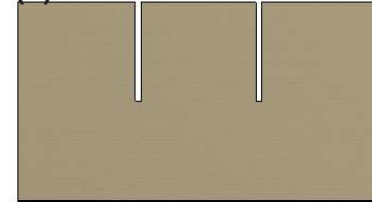

(2) Backs



Back Brace



Hardware:

(27) Hex screws



(1) Allen wrench

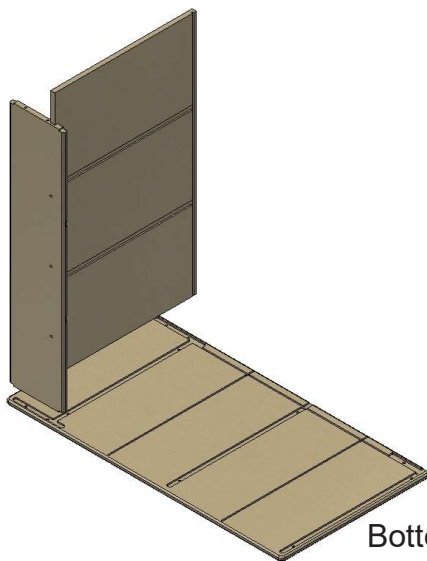

Bottom of left side

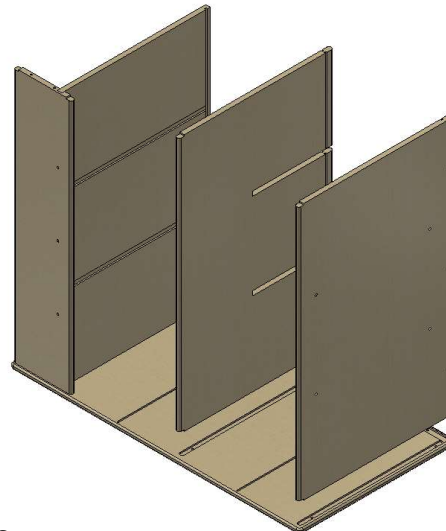

Step 1: Attach Top and Front rail to Left side.

Grooves in underside of top align with grooves in front rail. Attach each component to left side using (2) hex screws and allen wrench provided. Tighten down halfway. Back groove in top aligns with 3/8" deep back groove in left side.

Step 2: Attach Bottom and 15mm Shelf to Left side.

Back grooves in new parts align with 3/8" deep back groove in left side. Attach using (2) hex screws and allen wrench for each component.

For assistance, call: Customer Service 1-800-247-8465

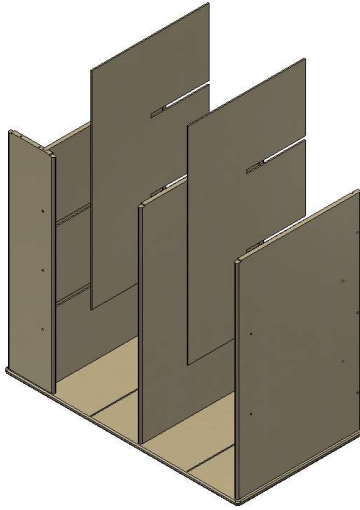

Step 3: Place **4mm Shelves** into grooves in **Left side**. No hardware is required in step. Slots in 4mm shelves align with slots in 15mm shelf.

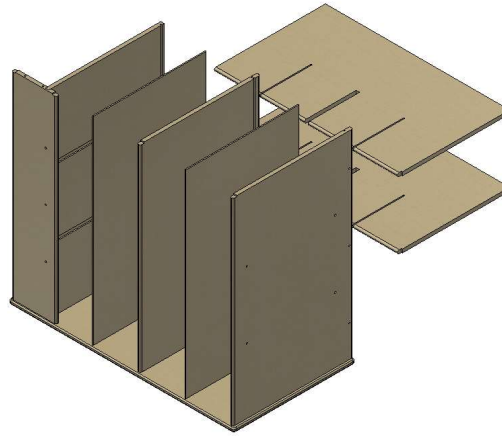

Step 4: Slide **(2) Dividers** into slots of all shelves and **dadoes of Bottom**. Attach each divider to Bottom using **(2) hex screws** and allen wrench. Tighten down halfway. Back face of dividers should sit flush with back face of 4mm shelves.

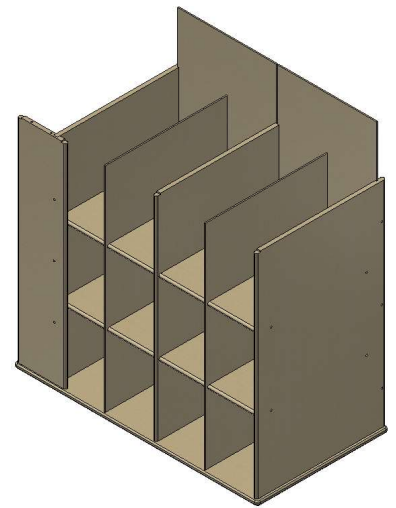

Step 5: Slide in **Backs** using grooves in top, 15mm shelf, and bottom. No hardware is required in this step.

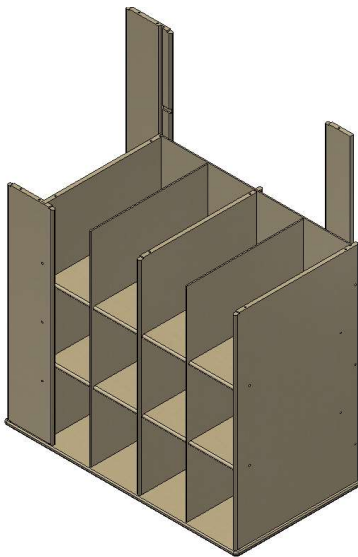

Step 6: Attach **Back rail and Back Brace** to **Left side**. Top fits into 3/8" deep groove in back rail. Notches in back brace overlap dado in left side. Tighten down halfway.

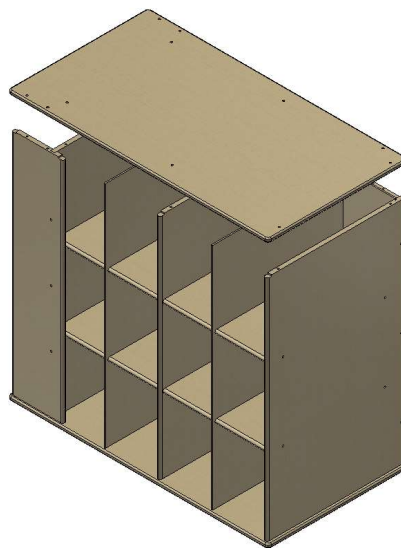

Step 7: Attach **Right Side** to **previously assembled components**. Align rest of assembly into grooves of right side. Attach using **(10) hex screws** and allen wrench.



Step 8: Set unit upright, resting edges of Sides on floor. Tighten all screws snugly. **DO NOT OVER-TIGHTEN. DO NOT DRILL.** Assembly is now complete.

For assistance, call: Customer Service 1-800-247-8465