

CHANDELIER

Assembly Instructions



CAUTION

- Inspect the wire insulation for any cuts, abrasions, or exposed copper that may have resulted during shipping. If there is a defect in the wire, do not attempt installation.
- Before starting installation of this fixture or removal of a previous fixture, disconnect the power by turning off the circuit breaker or by removing the fuse at the fuse box.

TOOLS REQUIRED



Ladder



Safety glasses



Electrical tape

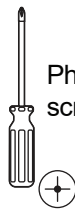

Phillips screwdriver

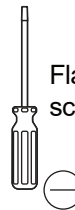

Flat blade screwdriver



Pliers

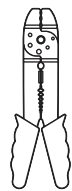

Wire strippers

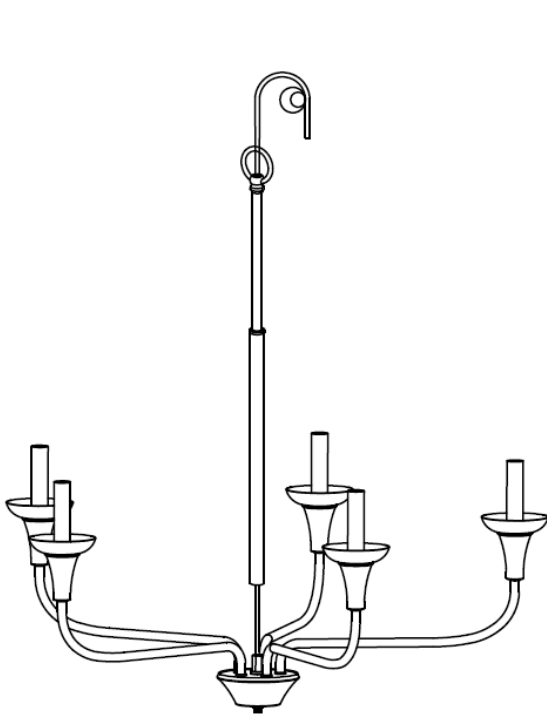

Fixture*1

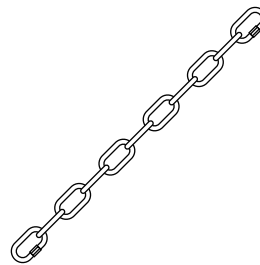

Chain (w/ quick connector)*1



Canopy*1



Mounting Unit*1



Collar (w/ ring)*1



Wire Nut*3



Finial*1

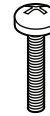

Mounting Screw*2

***PARTS SHOWN MAY DIFFER SLIGHTLY PER LIGHT FIXTURE**

CHANDELIER

Assembly Instructions

STEP 1

Straighten the fixture sockets.

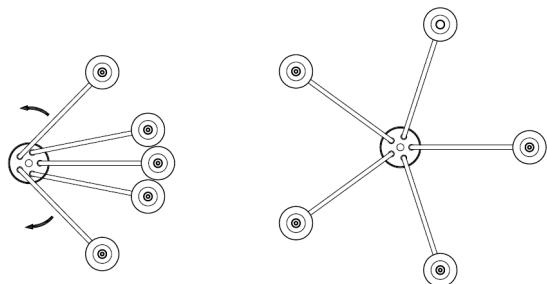

STEP 2

Assemble the decorative column to the top of the fixture. Secure the chain to the loop on the fixture. Secure the finial to the bottom of the fixture.

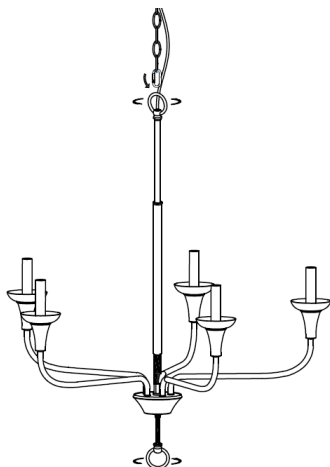

STEP 3

Attach the mounting unit to the junction box (not included) with the mounting screws and remove the preinstalled screw collar ring. Place the canopy over the preinstalled screw collar loop on the mounting unit. Turn the screw collar ring until 1/2 of the screw collar loop threads are exposed. Secure the chain to the screw collar loop on the mounting unit. Lower the screw collar ring and canopy over the chain. Weave the electrical wires, ground wires, chain, screw collar loop, canopy and through the center of the mounting unit.

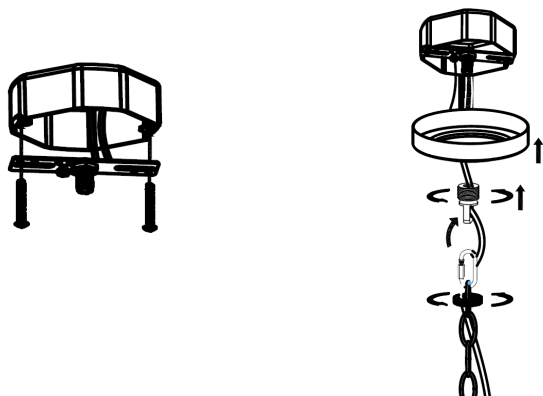

STEP 4

Make the electrical connection from the junction box to the fixture. Connect the ground wire to the mounting unit, using the preinstalled green ground screw. Then, connect the positive, negative and ground wires with the supplied wire nuts. Secure with electrical tape.

Connect Clear, Brown, Gold or Black Parallel Wire without tracer (round & smooth) or Black Fixture Wire to:

Black or Red Supply Wire or Insulated Wire (other than green) with copper conductor.

Connect Clear, Brown, Gold or Black *Parallel Wire with tracer (square & ridged) or White Fixture Wire to:

White Supply Wire or Insulated Wire (other than green) with silver conductor

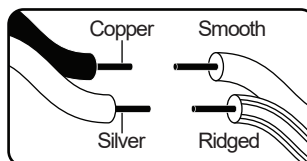
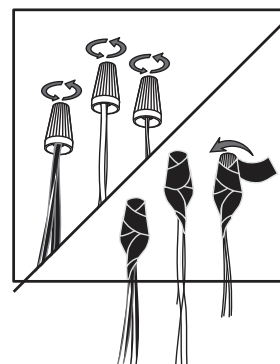

STEP 5

Secure the canopy to the mounting unit with the screw collar ring. Install E12*5*60W bulbs (not included).

