

DOOR OPENING RECORD QUERY

STEP1: The user enters a password, and the screen shows "OPEN". At this point, the user can press "0" or "8" to access the door opening records.

STEP2: DISPLAY FORMAT

FIRST SCREEN: The screen displays the password type (e.g., "PASS-1" for personal password, "PASS-2" for management password) and record number (e.g., "NO 01" or "NO 45").

SECOND SCREEN: After 1 second, the screen automatically switches to the date and time of the record.

STEP3: NAVIGATION THROUGH RECORDS

·Press "0" to scroll back to the previous record.

·Press "8" to move to the next record.

NOTE: The system stores up to 45 records for review.

SETTING THE SYSTEM DATE AND TIME

STEP1: In sleep mode, press "*" to enter the date/time adjustment mode.

STEP2: Enter the year, month, day, hour, and minute. Once all values are entered, the system will automatically adjust the weekday indicator to match the selected date. Then system will automatically return to sleep mode.

STEP3: If needed, press "*" to go back one step and re-enter the information before confirming.

VIBRATION ALARM FUNCTION

STEP1: In sleep mode, press the "0" key to activate the alarm, and the screen will display "BELL ON".

STEP2: If the safe detects vibration, the alarm will go off, and the screen will display an alarm icon along with "-----".

NOTE: Entering the correct password will stop the alarm and also cancel the alarm mode. If you need to reactivate the vibration function, repeat the above steps.

POWER AND VOLTAGE INDICATION

Power Source: The safe operates on four 1.5V alkaline batteries.

Low Battery Warning: If the battery voltage drops below $4.6V \pm 0.3V$, a half-empty battery icon will appear on the screen. Pressing "#" will display "LOBATTE", indicating low battery.

External Power Source: If the batteries are insufficient, the external power source can be used.

Operating Voltage: The safe operates within a voltage range of 4.3V to 6.8V.

ELITE GUARDIAN ELECTRONIC SAFE INSTRUCTIONS

! Please do not keep emergency keys in your safe!

Dear valued customer:

Thank you for choosing our products! You've taken an important step in organizing and protecting your most valued possessions. Every series of our safes is professionally made and designed to provide safety. Please take time to read and familiarize yourself with the proper operating procedures of your new safe presented on the following pages.

Again, thank you for choosing our products!

Schematic Drawing of the Safe Box

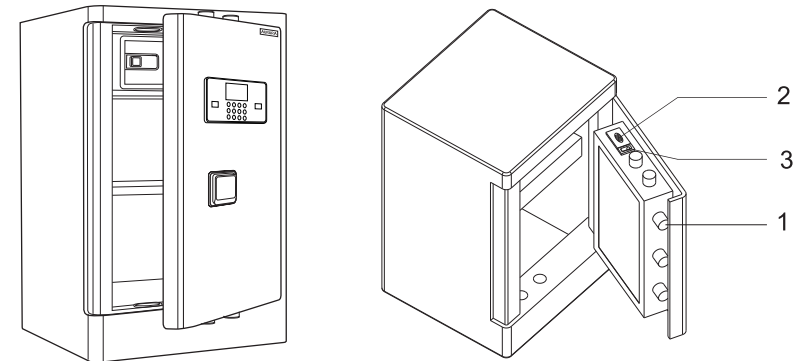

Schematic drawing of control panel

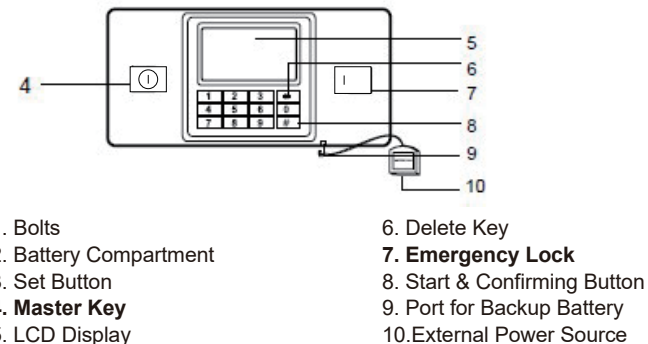

NOTE: The square emergency key cover (indicated by number 7) can be opened by pressing on its right side with your fingertip. Then the left side will pop out, revealing the keyhole underneath.

FACTORY DEFAULT SETTINGS

Factory Pre-set Parameters:

- 1.The **Initial Personal Password** is set to: 1234
- 2.The **Initial Administrator Password** is set to: 123456
- 3.The system clock is initialized to: January 1, 2000, 00:00:00 (Monday)
- 4.If no action is taken within 10 seconds of pressing a key, the system will automatically enter sleep mode.

Core Key Functions: “#” Button and “*” Button

Start Button (“#”):

- 1.When the device is powered on, the password lock will automatically scan.
- 2.After scanning, the screen will display “ALLREADY” and enter sleep mode.
- 3.Press the “#” button to activate the system and enter working mode.

Clear Button (“*”):

- 1.Each press of the “*” button will remove one digit from the entered password.
- 2.Pressing the “*” button before entering the password will hide the digits.
- 3.After unlocking, the system will automatically return to displaying the digits.

OPENING YOUR SAFE FOR THE FIRST TIME

Upon first use, you have two options to open the safe.

OPTION A:

STEP1: The safe is supplied with an external power box. Insert batteries into the power box, then plug into the jack on the bottom of the keypad, as shown in the picture below. Once powered on, the system will activate and enter standby mode.

STEP2: Press “#” key to activate the electronic lock.

STEP3: Enter the preset user code “1234” or the master code “123456”, then press the “#” key.

STEP4: Insert the master key into the master key keyhole. (**Turn the master key clockwise until it reaches the horizontal position.**) Then turn the **knob** clockwise to open the safe.

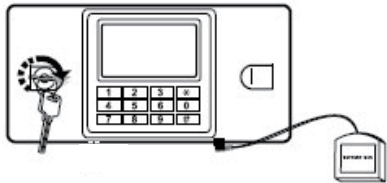

OPTION B:

STEP1: Insert the emergency key into the emergency keyhole. Turn it anticlockwise to unlock.

STEP2: Slide open the master key cover and insert the key. Turn the master key in horizontal position. Then, turn the **emergency key** anticlockwise and the **knob** clockwise **simultaneously** to open the safe door.

CAUTION: There is no need to turn the master key if it is in the horizontal position. Simply enter the correct code and turn the knob clockwise to open the door.

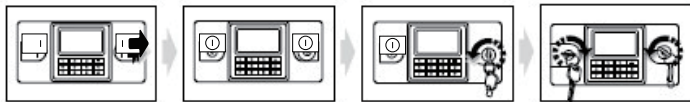

INSERTING THE BATTERIES

- Insert 4AA batteries into the battery compartment.
- The screen will then enter standby mode and display the year, month, date, and day.

CAUTION: Replace the batteries with fresh ones, ensuring they are aligned according to the “+” and “-” symbols.

SETTING THE USER CODE

STEP1: While the screen is in sleep mode, press and hold the blue **Set Button** beside the battery compartment.

STEP2: Then the screen displays “-----”, enter a new 1-8 digit password.

STEP3: Press the “#” key to confirm. The screen will display “INTO” to indicate the user’s code has been successfully updated.

SETTING THE MASTER CODE

STEP1: Wake up the system using the “#” key, then quickly **double** press the “0” key.

STEP2: Then press and hold the blue **Set Button** to enter the management mode. Then the screen displays “-----”, enter a new 1-8 master code.

STEP3: Press the “#” key to confirm. The screen will display “INTO” to indicate the master code has been successfully updated.

NOTE: If the code is not set successfully and no button is pressed within ten seconds, the screen will return to standby mode, keeping the previous code unchanged.

OPENNING THE DOOR WITH YOUR PASSWORD

STEP1: Press the “#” key. The LCD Display will show “-----”.

STEP2: Enter a 1-8 digit user code or master code, then press “#” to confirm. If the code is correct, the display will show “OPEN.”

STEP3: Turn the key clockwise to the horizontal position within five seconds while simultaneously rotating the knob clockwise to open the door.

NOTE: If the code is incorrect, the display will show “ERROR” and then return to “-----.” Please re-enter the correct code.

CAUTION: You can press the “*” key to delete any incorrect digits. Each press will clear one digit at a time.

CLOSING THE DOOR

Close the door, turn the knob counterclockwise, and rotate the master key until it reaches the vertical position.

Note: *Even if the master key is in the horizontal position, it can be removed. However, leaving it horizontal allows the safe to be opened next time using only the combination code and knob, without the master key. For enhanced security, always return the master key to the vertical position after locking.*