

变更单号	版本	变更内容	日期

基本尺寸	长、宽
公差值	+1/-2

A

A

CEILING FAN LIGHT USER'S MANUAL

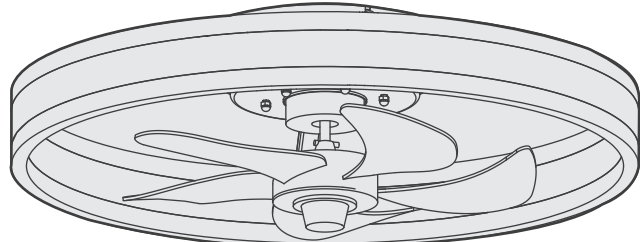
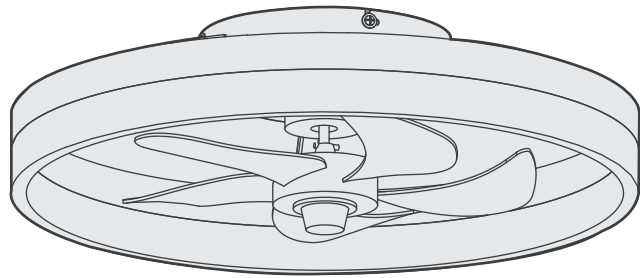

This user manual is applicable
to the above two products.

B

B

C

C

D	成型尺寸	148*210mm	材料	80g铜版纸			物料编码		比例	N/A	第一视角投影法
	印刷工艺	胶印	表面处理	哑油			物料名称	说明书	重量	kg	
	成型工艺	骑马钉	颜色	彩印					单位	mm	
	输出线	200 lpi	设计	Apple	日期	250224	产品名称	吊扇灯-圆形基础款 (单圈发光, 双圈发光)	版本	V1	共16张/第1张
	原材料及后处理工艺均需满足RoHS环保要求。		审核		日期						
		批准		日期							

CEILING FAN LIGHT USER'S MANUAL

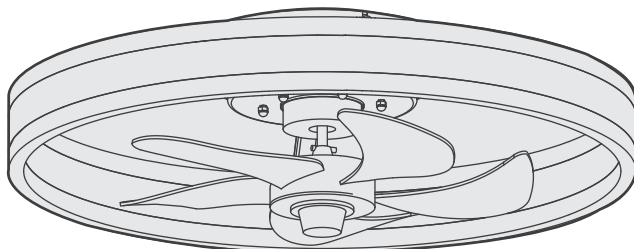
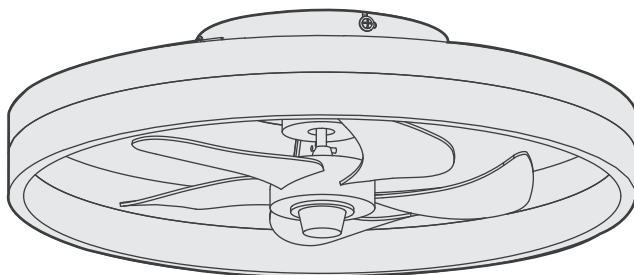

This user manual is applicable
to the above two products.

Important Safety Instructions

Warning

- Make sure all electrical connections comply with local law and the national electrical code. Please hire a qualified electrician or consult a do-it-yourself wiring handbook if you are unfamiliar with installing electrical wiring.
- All wiring must be in accordance with national and local electrical codes ANSI/NFPA 70. If you are unfamiliar with wiring, use a qualified electrician.
- The splices after being made should be turned upward and pushed carefully up into the outlet box.
- Instructions for supply connections: the white conductor of a fan identified as a grounded conductor to be connected to a grounded conductor of power supply, the black conductor of fan identified as ungrounded conductor to be connected to an ungrounded conductor of power supply, the green conductor of fan identified for equipment grounding to be connected to an equipment-grounding conductor.
- Make sure the installation site is roomy enough to allow fan blades to rotate. There are at least seven feet from the floor to fan blades' tips.
- If you are mounting the fan on a ceiling outlet box, please use a metal outlet box. Secure the box directly to the building structure. The outlet box and its support must be able to support the rotating fan (at least 15.9 kg (35 lbs)). Do not use a plastic outlet box. Attach the mounting bracket using the ceiling outlet box's hardware.
- When mounting directly to the building structure, ensure the installation does not expose combustible materials. Do not install the fan on a ceiling with a combustible finish. Ensure no wood rafters or thermal insulation are exposed to the room.

Risk Of Electric Shock

- To avoid possible electrical shock, before installing or servicing your fan, disconnect the power by turning off the circuit breakers to the outlet box and associated wall switch location. If you cannot lock the circuit breakers in the off position, securely fasten a prominent warning device, such as a tag, to the service panel.
- To reduce the risk of electric shock, this fan must be installed with an isolating wall control/switch.
- Before installing the fan, disconnect the power by removing fuses or turning off circuit breakers.
- Make sure all electrical connections comply with local law and the national electrical code. Please hire a qualified electrician or consult a do-it-yourself wiring handbook if you are unfamiliar with installing electrical wiring.
- **WARNING:** To reduce the risk of electrical shock and personal injury, do not install the fan on a sloped ceiling, and do not use this fan with any solid-state fan speed control device, or rheostat. You must install the outlet box using the two steel screws and lock washers coming with the fan.
- All wiring must be in accordance with national and local electrical codes ANSI/NFPA 70. If you are unfamiliar with wiring, use a qualified electrician.
- After making the wire connections, the wires should be spread apart with the grounded conductor and the equipment-grounding conductor on one side of the outlet box and the ungrounded conductor on the other side of the outlet box.
- The splices after being made should be turned upward and pushed carefully up into the outlet box.
- Instructions for supply connections: the white conductor of a fan identified as a grounded conductor to be connected to a grounded conductor of power supply, the black conductor of fan identified as ungrounded conductor to be connected to an ungrounded conductor of power supply, the green conductor of fan identified for equipment grounding to be connected to an equipment-grounding conductor.
- To reduce the risk of electric shock, disconnect the electrical supply circuit to the fan before installing light kit.

Risk Of Injury

- **WARNING:** To reduce the risk of personal injury, do not bend the blade brackets when installing the blade brackets, balancing the blades, or cleaning the fan. Do not insert foreign objects in between rotating fan blades.
- This appliance can be used by children aged from 8 years and above and persons with reduced physical, sensory or mental capabilities or lack of experience and knowledge if they have been given supervision or instruction concerning use of the appliance in a safe way and understand the hazards involved. Children shall not play with the appliance. Cleaning and user maintenance shall not be made by children without supervision. It is recommended that children be supervised to ensure that they are not using the appliance improperly.
- After installing the fan, make sure all the connections are secured so that the fan won't fall.
- Do not insert anything between fan blades while the fan is operating.
- Turn the fan off and wait for it to stop before reversing fan's rotating direction.

FCC Statement

1. This device complies with Part 15 of the FCC Rules. Operation is subject to the following two conditions:

- This device may not cause harmful interference.
- This device must accept any interference received, including interference that may cause undesired operation.

2. Changes or modifications not expressly approved by the party responsible for compliance could void the user's authority to operate the equipment.

Note: This equipment has been tested and found to comply with the limits for a class B digital device, pursuant to Part 15 of the FCC Rules. These limits are designed to provide reasonable protection against harmful interference in a residential installation.

3. This equipment has been tested and found to comply with the limits for a Class B digital device, pursuant to part 15 of the FCC Rules. These limits are designed to provide reasonable protection against harmful interference in a residential installation. This equipment generates, uses and can radiate radio frequency energy and, if not installed and used in accordance with the instructions, may cause harmful interference to radio communications. However, there is no guarantee that interference will not occur in a particular installation. If this equipment does cause harmful interference to radio or television reception, which can be determined by turning the equipment off and on, the user is encouraged to try to correct the interference by one or more of the following measures:

- Reorient or relocate the receiving antenna.
- Increase the separation between the equipment and receiver.
- Connect the equipment into an outlet on a circuit different from that to which the receiver is connected.
- Consult the dealer or an experienced radio/TV technician for help.
- This equipment should be installed and operated with a minimum distance of 20 cm between the radiator and your body.



Pre-installation Advice

Warning

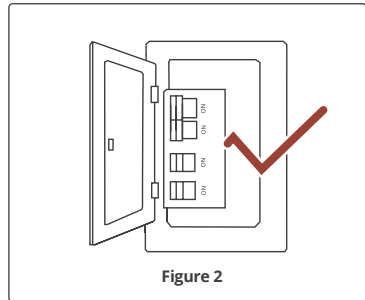
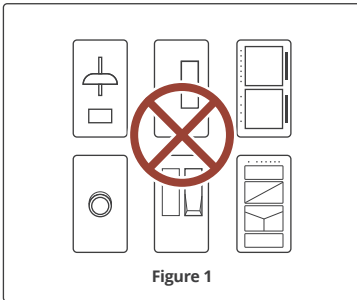
- To ensure safety and prevent potential electrical shock, it is not sufficient to simply turn off the wall switch. Prior to wiring, make sure to turn off the electricity at the main fuse box.
- All wiring should be done in accordance with national and local electrical codes. Additionally, it is important to properly ground the ceiling fan as a precautionary measure against possible electrical shock.
- Do not use a variable (rheostat) wall controller or dimmer switch to operate this fan. Doing so can cause damage to the ceiling fan remote control unit. It is recommended to only use the provided remote control.
- Using a full range dimmer switch to control fan speed will damage the fan. To reduce the risk of fire or electrical shock, do not use a full range dimmer switch to control the fan speed. (Figure 1).
- Only control light on/off via wall fan switch. Restore electrical power to the outlet box by turning the electricity on at the main fuse box.(Figure 2).

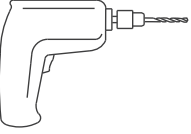

Prepare Tools Before Installation

			
Phillips Screwdriver	Ladder	Wire Stripper	Drill (Optional)

Installation Distance Reference

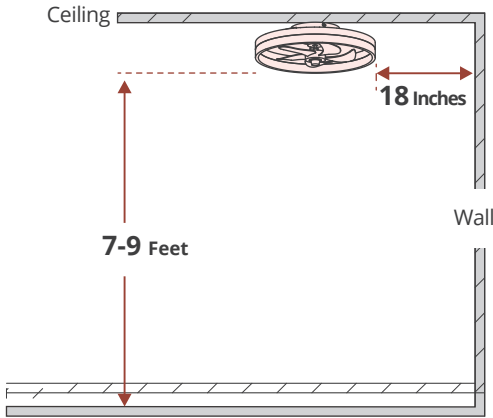

Install ceiling fans in the center of the room, ideally 7-9 feet above the floor and at least 18 inches from the walls for optimal airflow.

Energy-Saving Tips

Proper installation and use are key to maximizing your ceiling fan's performance and energy savings. Here are some tips for efficient operation:

- Unoccupied Rooms: Turn off the fan when the room is unoccupied to save energy.
- Summer Cooling: Operate the fan in a counterclockwise direction. This creates a wind-chill effect, making the room feel cooler. Use a lower fan speed for energy savings.
- Winter Heating: Reverse the motor to operate the fan at a low speed in a clockwise direction. This gently circulates warm air trapped near the ceiling down into the room.
- Thermostat Adjustment: Adjust your thermostat when using the ceiling fan for additional energy and cost savings.

Accessories List

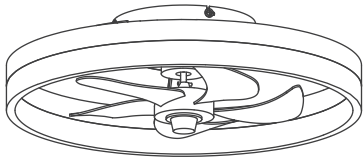

Single-circle luminous model

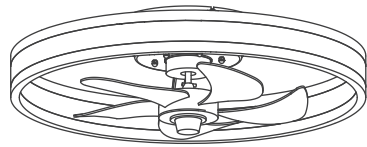

Double-circle luminous model

A



x4
Expansion screw



x4
Gasket



x2
Umbrella
head screw



x4
Pointed self
tapping screw



x2
Wire nut

B



x2
Expansion screw



x2
Pointed self
tapping screw

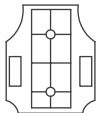

x1
Remote
control base

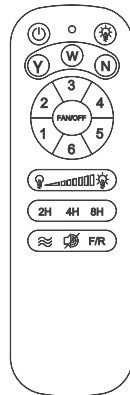
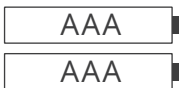

x1
Remote control

C

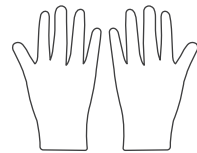

x1
Safety gloves



If any parts are missing or broken, please contact us.

Ceiling Fan Light Installation

Step 1



Remove 2 screws and loosen the remaining 2 screws by 5mm.

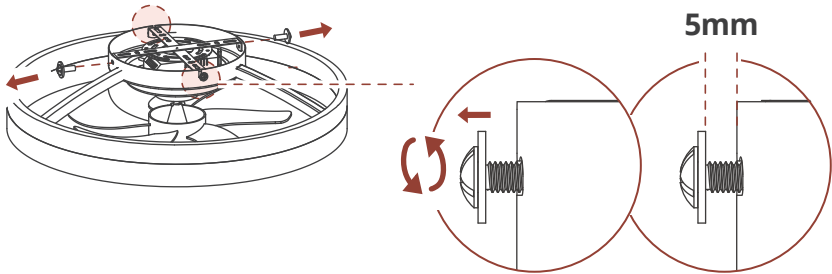

Step 2

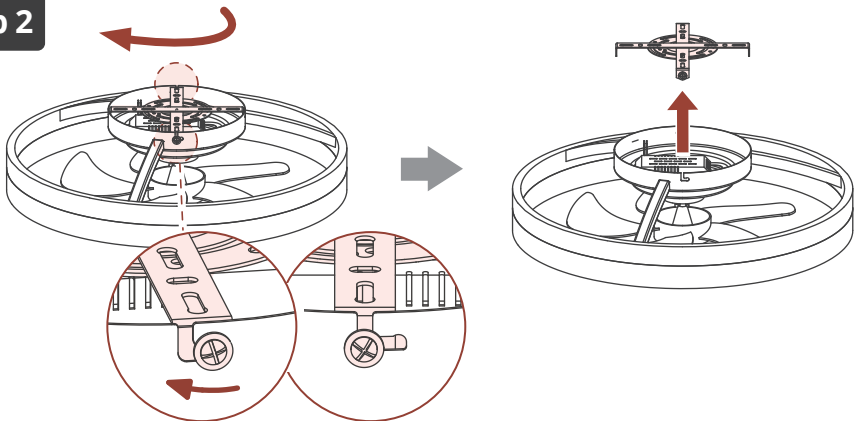

Let's move towards success with a relaxed start !

Step 3

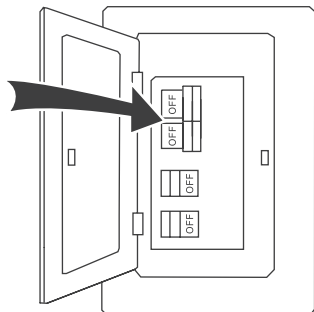

WARNING:

To prevent electrical shock, disconnect power before installing the fan. Turn off power at the circuit breakers or remove the fuses for the outlet box associated with the wall switch.

Step 4

Junction Box

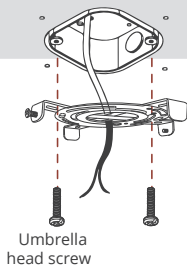

Umbrella head screw

Wood Ceiling

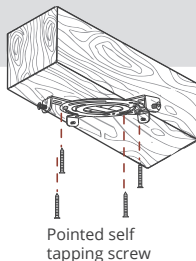

Pointed self tapping screw

Concrete Ceiling

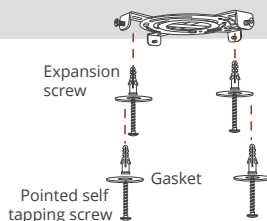

Expansion screw

Pointed self tapping screw

Gasket



According to the user's ceiling situation, choose the corresponding installation method.

Step 5

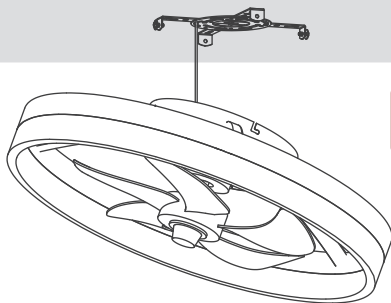

Use the safety rope(pre-installed) to hang the lamp to the bracket.

Step 6

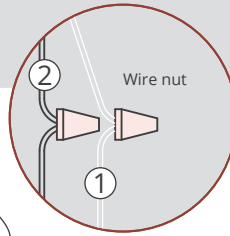
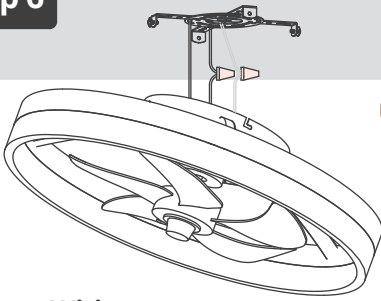

⚠ WARNING:

All wiring must be in accordance with national and local electrical codes ANSI/NFPA 70. If you are unfamiliar with wiring or in doubt, consult a qualified electrician.

Wiring :

- AC IN N I** 1. Connect the "Neutral wire" (white wire) from ceiling to the white wire.
AC IN L 2. Connect the "Live wire" (black wire) from ceiling to the black wire.

Step 7

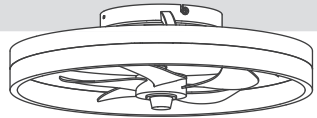
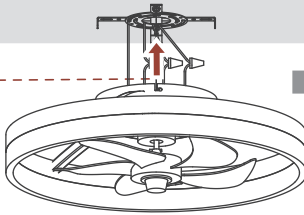
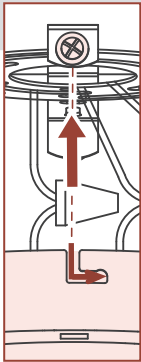

Step 8

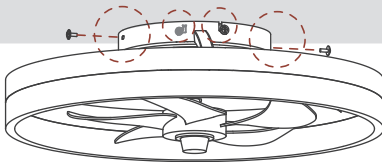

⚠ WARNING:

FAN FALL HAZARD

Make sure screws are tight.

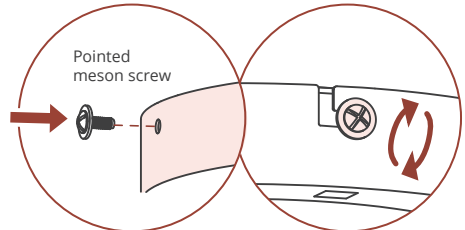

Step 9

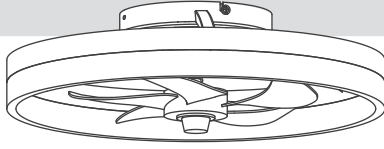

*Excellent!
Congratulations on becoming
a great DIYer! Now enjoy your Fan!*

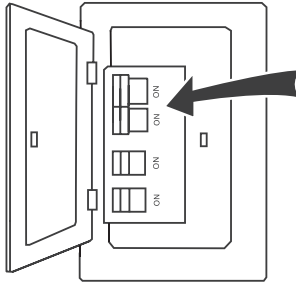

Finish installation. Turn on the electric power at the main fuse or circuit breaker box.

Remote Control

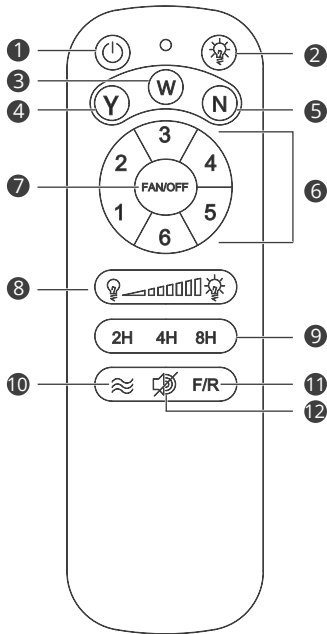

- 1 All off
- 2 Light on/off
- 3 Cool white
- 4 Warm white
- 5 Neutral light
- 6 Fan speed
- 7 Fan off
- 8 Brightness+ , Brightness -
- 9 All off after 2 hours / 4 hours / 8 hours
- 10 Natural wind
- 11 Forward/reverse
- 12 Sound on/off

Attach wall plate using
the two screws provided.

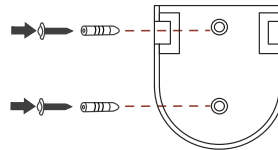

Remote Control Pairing



Important Notes:

1. Install 2*AAA batteries (included) in the remote control. Remove the batteries if the remote will not be used for an extended period to prevent damage.
2. Store the remote control away from extreme temperatures and high humidity.
3. One remote control can operate multiple fan/light units.

Pairing Instructions:

1. Turn off the main power to the ceiling fan(s) for at least 60 seconds.
2. Turn the main power back on, press and hold the FAN/OFF button on the remote.
3. If the fan light blinks when you release the button, pairing is complete. If not, repeat steps 1-3.

APP Control



NOTE:

Scan the QR code and install the app on your phone.

Search for and install "ZhiMei Smart Control" on Google Play, Apple App Store, or other app stores. Make sure your phone is connected to the internet and Bluetooth enabled.

Connect your ceiling fan:

1. Open the application, tap the plus icon below to add a fan light and enter any name;
2. Make sure your cell phone Bluetooth is on, power off the fan light for 10 seconds and then turn it on again, then tap the Pair code button, when the light starts to flash, it means the pairing is successful.

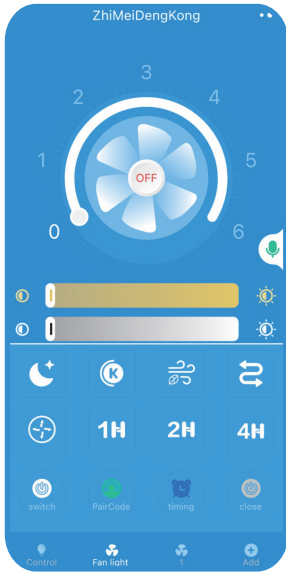

- Night light (10% brightness in neutral white)
- CCT
- Natural wind: fan speed will change automatically when use this function
- F / R rotation
- This feature is not available in this version
- Fan stop & light off after 1 hour / 2hour / 4 hour
- Fan speed
- Turn off
- Timer the fan
- Switch / Close
- Pair code button (make sure your phone has an internet connection, turn on Bluetooth, and then click the button click once to successfully pair.)

Troubleshooting

Problem	Suggested Remedy
<p>Fan Does Not Start</p>	<ol style="list-style-type: none"> 1. Check the main and branch circuit fuses or circuit breakers 2. Ensure that the wall control is turned "ON", do not use a dimmer switch. 3. Check line wire connections to the fan and switch wire connections in the switch housing. <p>Caution: Make sure to turn off the main power before making any electrical connections.</p>
<p>The Fan Sounds Noisy</p>	<ol style="list-style-type: none"> 1. Make sure all screws in the motor housing are snug (not over tightened). 2. Check that wire connectors in the switch housing are not rattling against each other or the interior wall of the switch housing. <p>Caution: Turn off the main power before entering the switch housing.</p> <ol style="list-style-type: none"> 3. Ensure that the securing screws are tight. Make sure the light bulb is tight in the socket and not touching the lamp frame or blades. 4. Note that some fan motors are sensitive to signals from solid-state variable speed controls. Do not use a solid-state variable speed control. 5. Allow a "break-in" period of 24 hours. Most noises associated with a new fan will disappear after this period. 6. Check if the fan blades are in contact with the light bulb. If so, adjust the angle of the light arm and tighten it again.
<p>Fan Wobbles</p>	<ol style="list-style-type: none"> 1. Make sure that the canopy and mounting plate are tightened securely to the ceiling junction box, and the junction box is mounted firmly to the ceiling joist. 2. Check if the fan blades are in contact with the light bulb. If so, adjust the angle of the light arm and tighten it again.
<p>Light Does Not Work</p>	<ol style="list-style-type: none"> 1. Check the black wiring of the motor to the receiver and the receiver to the AC input. 2. Check for loose or disconnected wires in the fan switch housing. 3. Check for loose light bulbs (this point is only for the bulbs version). 4. Check for faulty light bulbs; ensure the light bulb is AC120V and E26 medium base (this point is only for the bulbs version). <p>Caution: Make sure the main circuit is turned off before entering the switch housing.</p>
<p>Remote Does Not Work</p>	<ol style="list-style-type: none"> 1. If the battery is out of power or not installed correctly, change it for a new AAA battery and ensure it is well installed. 2. Turn off the wall switches at least 10s, then re-pair the remote by Long-pressing "Set up" within 5 seconds after the wall switches are on to pair.

Common Troubleshooting

30-Day Return Policy

- If you're not completely satisfied with your purchase, simply return the merchandise via Amazon Orders.
- Unused merchandise can be refunded or exchanged within 30 days from the original purchase date.

2-Year Warranty

- We take user experience very seriously. We provide you with good after-sales service, the motor warranty is guaranteed for a lifetime, and the whole fan warranty is guaranteed for two years.
- If your appliance fails to operate properly within our warranty period, we will arrange a new replacement free of charge and cover all the shipping costs.

Quick Response within 12 Hours

- We take user experience very seriously. We provide you with good after-sales service, motor is guaranteed for ten (10) years and the whole fan warranty for two (2) years.
- If your appliance fails to operate properly within our warranty period, we will arrange a new replacement free of charge and cover all the shipping costs.

Should you experience any issues while operating any of our products, you can directly reach out to our Customer Support via Amazon Orders Or you can send your inquiry to our Official Customer Support at: Support@yfs.life

Thank you letter

Dear customer.

I hope this message finds you well! I want to take this opportunity to express our sincere gratitude for your recent purchase of our product.

Hopefully, by the time you've read this, you've successfully completed the installation. We understand that every step can sometimes pose challenges, and we commend you for your achievement.

Your confidence in our product allows us to continue our mission of delivering innovative solutions that meet the needs of our customers. It is our goal to ensure that you have a seamless experience, and your satisfaction is what drives us forward.

If you have any feedback from your installation process or if there is anything you need assistance with regarding our product, please do not hesitate to reach out. We are always here to support you, ensuring you get the most out of your purchase.

Once again, thank you for choosing our product. We are excited to have you as a part of our community and look forward to serving you in the future. Enjoy all the benefits that ceiling fan brings to you.

