

810A : 290X210

Parts

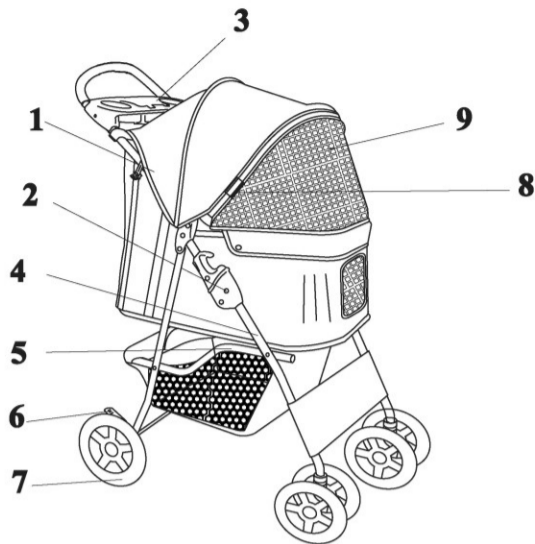

- 1.Safety lock
- 2.Side locks
- 3.Teacup tray
- 4.Main frame
- 5.Touch-fastening straps
- 6.Brakes
- 7.Rear wheels
- 8.Zip
- 9.Canopy

To open

1. Release the side safety lock (1) on the main frame (4)

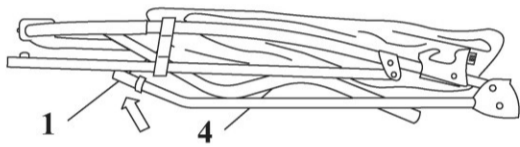

2. Unfold the pet stroller and lock into place. Ensure that both side locks (2) are properly secured

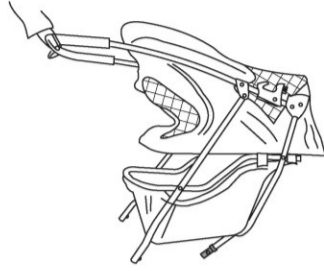

3. Insert the front wheels assembly onto the front wheel frame until the locking button of the front wheel frame spring out.

locking button

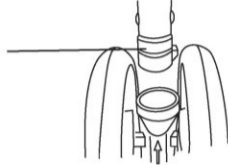

4. Push the rear wheels, gasket, clip, cover assembly into the axle. And then push it assembly into the frame until spring out on the assembly.

(To disassemble :press the spring on the rear wheel frame and remove the assembly.)

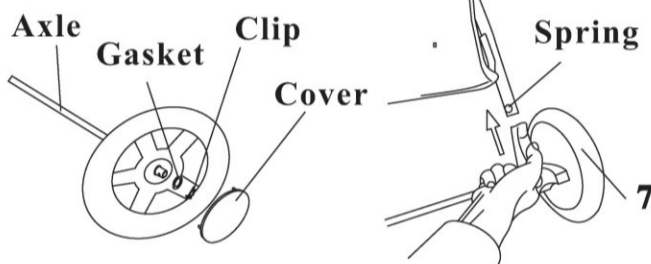

5. The zip on the basket should be zipped to the front.



Brakes

- 1.For your pet's safety, always apply the brakes (6) when the pet stroller is stationary

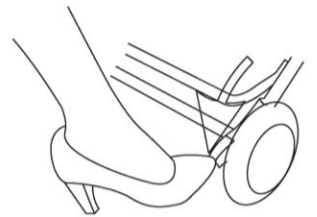

- 2.Lock the rear wheels by simply pushing down the brake levers on either side

To fold

- 1.Unzipped the zip on the basket.
- 2.Lift the canopy supports (3).
- 3.Pull up both side locks (2).
- 4.Fold the pet stroller.
- 5.Secure the side safety lock (1).

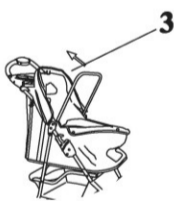

Cleaning and maintenance

- 1.Undo the touch-fastening straps (5) under the basket.
- 2.Unscrew the six screws of the canopy supports and remove the canopy from the main frame(4).
- 3.Slide off the lining.
- 4.Undo the touch-fastening straps (5) and remove the hard base.
- 5.Wipe clean the main cover with a damp cloth.
- 6.Unzip cushion cover, remove sponge inner and hand wash cover in lukewarm water.

WARNING:

For the safety your pet, please read the following and keep for future reference.



Caution

- 1.Do not lift up the stroller when the pet is in.
- 2.Never use the stroller on uneven place.
- 3.Never use the stroller near the fire or other dangerous area.
- 4.Must use the brakes when you stop moving your stroller.
- 5.Do not put two or more than two pets in one stroller.
- 6.Do not store or use this stroller in areas exposed to high or low temperature or humidity for a long time.
- 7.Maximum pet weight for this strollers 15kgs.

PawHut!

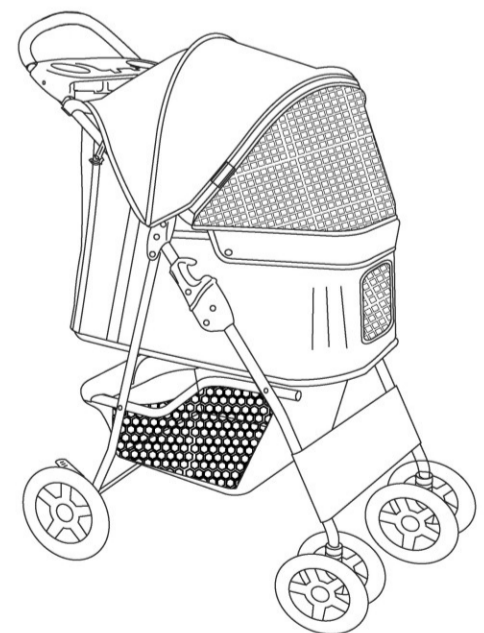

PACKING LIST

No	PARTS NAME	QTY.
1	Main frame	1
2	Front wheels	2
3	Axle component	1
4	Teacup tray	1
5	Sponge cushion	1
6	Bottom basket	1
7	Rear tire	2
8	Cover	2
9	Clip	2
10	Use instruction	1

The pet stroller has been specifically designed for taking pets to the vet and for taking elderly or nervous pets with hip or general mobility problems, on outings. The stroller is lightweight and easy to manoeuvre, and comes complete with a removable pet carrier.