

1. Install the arms 2 on the round plate 1 by lock nut and teeth lock washer 3.

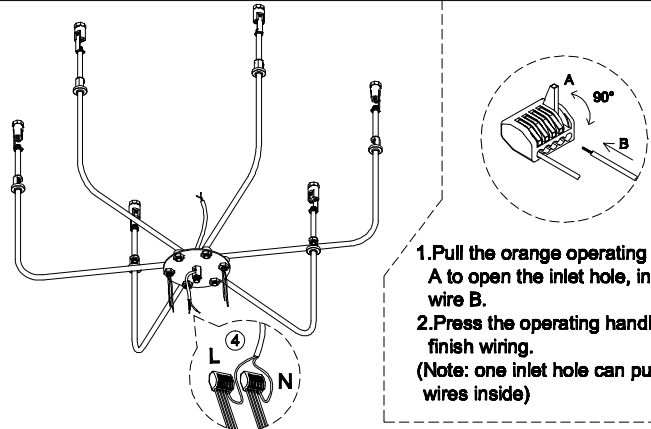

1. Pull the orange operating handle A to open the inlet hole, insert the wire B.
 2. Press the operating handle A to finish wiring.
 (Note: one inlet hole can put 2 or 3 wires inside)

2. Connect all the wires by parallel with connectors 4 (all live line-L use one connector, and neutral Line-N use another connector).

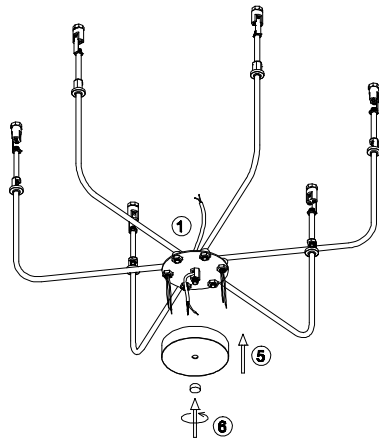

3. Install the cover box 5 on the round plate 1 with lock nut 6.

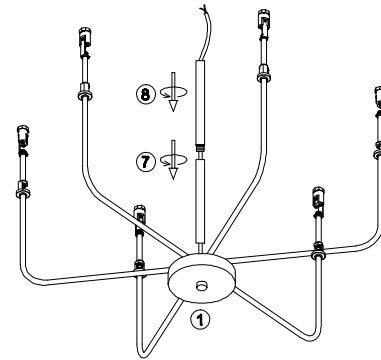

4. Let the wire go through the tube 7 and 8, turn to fasten the tubes on the fixture.

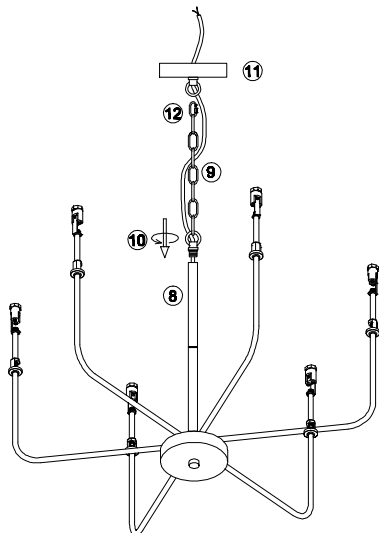

5. Let the wire go through the ring 10 of hanging chain 9, turn the ring 10 to fixed the chain 9 on the fixture, connect the chain 9 with canopy 11 with Carabiner hook screw connection 12, let the wire go through the chain 9 and canopy 12

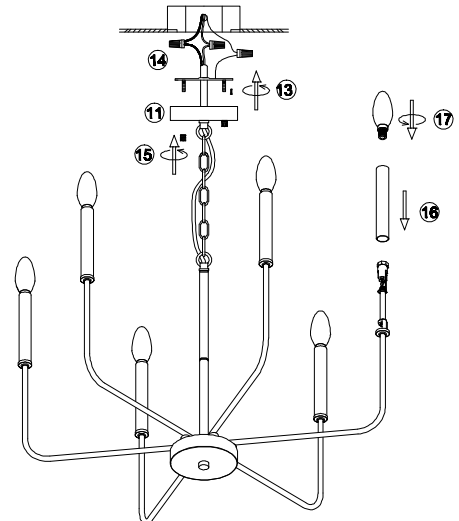

6. Install the bracket 13 on the junction box with expansion anchor and screw.
 7. Connect the wire with connector 14 to your home line.
 8. Install the fixture on the bracket with nuts 15.
 9. Put the cylinder tube 16 on the lamp holder and after that install the bulbs 17.

Please read carefully before installation!!!

Note : Please make sure that the electricity is powered off during installation !

Only a professional electrician should install this kind of product !