

# NatureFlow

Water Mineralization System (NF-Y60EC) User Manual

## THE HEALTH OF YOUR FAMILY IS THE GREATEST GIFT

LET THE NATUREFLOW WATER MINERALIZATION  
SYSTEM BE YOUR WAY OF SHOWING LOVE

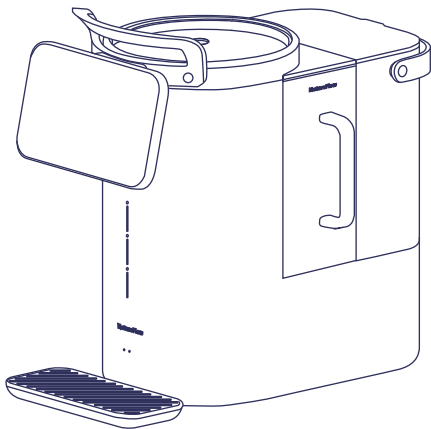

Due to ongoing product enhancements, the actual product may vary slightly in appearance, specifications, performance, and features from those described in this manual. The company reserves the right to make final interpretations

## IMPORTANT SAFEGUARDS

When using electrical appliances, basic safety precautions should always be followed, including the following

1. Read all Instructions.
2. Do not touch hot surfaces. Use handles or knobs.
3. To protect against fire, electric shock and injury to persons do not immerse cord, plugs, or (state specific part or parts in question) in water or other liquid.
4. This appliance is not intended for use by persons (including children) with reduced physical, sensory or mental capabilities, or lack of experience and knowledge, unless they have been given supervision or instruction concerning use of the appliance by a person responsible for their safety. Children should be supervised to ensure that they do not play with the appliance.
5. Unplug from outlet when not in use and before cleaning. Allow to cool before putting on or taking off parts, and before cleaning the appliance.
6. Do not operate any appliance with a damaged cord or plug or after the appliance malfunctions, or has been damaged in any manner. Return appliance to the nearest authorized service facility for examination, repair or adjustment.
7. The use of accessory attachments not recommended by the appliance manufacturer may result in fire, electric shock or injury to persons.
8. Do not use outdoors.
9. Do not let cord hang over edge of table or counter, or touch hot surfaces.
10. Do not place on or near a hot gas or electric burner, or in a heated oven.

11. Always attach plug to appliance first, then plug cord into the wall outlet. To disconnect, remove plug from wall outlet.
12. Do not use appliance for other than intended use.
13. **GROUNDING INSTRUCTIONS** - This appliance must be grounded. In the event of a malfunction or breakdown, grounding will reduce the risk of electric shock by providing a path of least resistance for electric current. This appliance is equipped with a cord having an appliance-grounding conductor and a grounding plug. The plug must be plugged into an appropriate outlet that is installed and grounded in accordance with all local codes and ordinances.
14. **WARNING** - Improper connection of the appliance-grounding conductor can result in a risk of electric shock. Check with a qualified electrician or service representative if you are in doubt whether the appliance is properly grounded. Do not modify the plug provided with the appliance; if it will not fit the outlet, have a proper outlet installed by a qualified technician.
15. Save these Instructions.

## **SAVE THESE INSTRUCTIONS**

## TABLE OF CONTENTS

- 01# ● Guide For Display Screen
- 04# ● Product Information
- 05# ● Product Specifications
- 06# ● Initial Cleaning Guide
- 09# ● Dispensing Water And Customizing Settings
- 12# ● Wastewater Replacement Guide
- 14# ● Cleaning Guide
- 16# ● Filter Replacement Guide
- 18# ● Placement Guide
- 18# ● Maintenance Guide
- 21# ● Warning
- 22# ● Troubleshooting
- 23# ● Natureflow Limited Warranty Policy



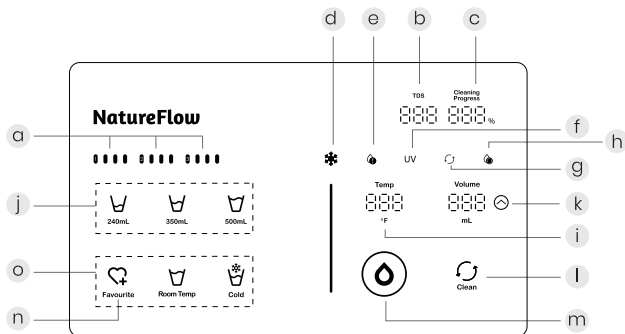







## GUIDE FOR DISPLAY SCREEN













## Filter Life Indicator Light

	White	Orange	Blue
<b>a</b>			
Normal status	1 0 0 0 0 1 0 0 0 0	2 0 0 0 0 2 0 0 0 0	3 0 0 0 0 3 0 0 0 0
Replace soon	1 0 1 0	2 0 2 0	3 0 3 0
Replace now	Red 1	Red 2	Red 3

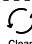
## GUIDE FOR DISPLAY SCREEN

Indicator	Status	Dispenser Status
<p>b</p>  <p>TDS Indicator</p>		Displays the TDS status of the filtered water
<p>c</p>  <p>Cleaning Progress Indicator</p>		Displays the progress of the cleaning
<p>d</p>  <p>Cooling Indicator</p>	Light On	In refrigeration
	Light Off	Not in operation
<p>e</p>  <p>Water Change Warning</p>	Flashes Slowly	indicating the tap water tank is short of water
	Flashes Rapidly	indicating the purified water jug is not installed properly
<p>f</p>  <p>UV Indicator</p>	Light On	The UV is in operation
	Light Off	Not in operation
<p>g</p>  <p>Cleaning Indicator</p>	Light On	Cleaning in progress
	Light Off	Not in operation
<p>h</p>  <p>Pump Indicator</p>	Light On	Filtering water
	Light Off	Not filtering water
<p>i</p>  <p>Temperature Display</p>	When  or  is selected, the real-time water temperature will be shown	

## GUIDE FOR DISPLAY SCREEN

Icon	Key & Functions
<p>j</p>  <p>240mL 350mL 500mL</p>	<p><b>Preset Water Volume</b> Gently tap to select your desired amount (240 mL, 350 mL, 500 mL) for one-touch precise dispensing</p>
<p>k</p>  <p>Volume mL</p>	<p><b>Volume Adjustment</b>   Touch to select the capacity of water.                      4 options: 240mL- 350mL- 500mL- --                      --: Manually control the capacity of water, touch  to stop dispensing</p>
<p>l</p>  <p>Clean</p>	<p><b>Dispense Water Button</b> Touch to dispense the water with current volume and temperature</p>
<p>m</p> 	<p><b>Cleaning System Button</b> Touch to initiate the internal cleaning of the water system</p>
<p>n</p>  <p>Favourite</p>	<p><b>One-Touch Dispense Setting</b> Press and hold the button for 3 seconds. After selecting your desired water volume and temperature, tap the button once or wait 3 seconds to save it as a new one-touch dispense option</p>
<p>One-Touch Button</p>	<p> Favourite</p>
<p>Default Water Temp</p>	<p> Room Temp</p>
	<p> Cold</p>
	<p>Preference setting</p>
	<p>210°F</p>
	<p>40°F</p>

## WATER TREATMENT PROCESS

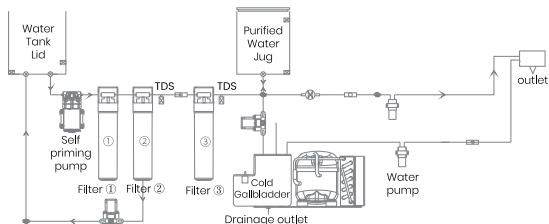

## PRODUCT INFORMATION

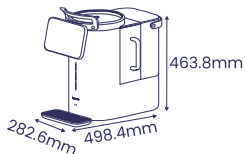
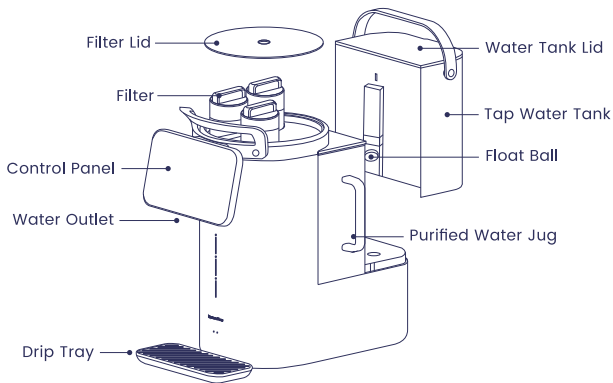

## PACKAGE CONTENTS

Water Mineralization System	1
User Guide	1
Drip Tray	1
Citric acid descaling agent	1

---

## PRODUCT SPECIFICATIONS

Product Name	Reverse Osmosis Cold Water Mineralization System
Model Number	NF-Y60EC
Cooling Capacity	≥0.8 Gal/h (≤50°F)
Refrigerant and Charge	R600a, 12g
Ambient Humidity	≤ 80%
Climate Type	ST/N/SN
Purified Water Flow Rate	8.8oz/min
Rated Total Pure Water	1056 Gal
Rated Power	150 W
Rated Voltage	110 V
Frequency	60 Hz
Standby Power Consumption	< 0.05 kW.h/24h
Inlet Water Pressure	0-0.4 MPa
Operating Pressure	0.4-0.6 MPa
Applicable Water Temperature	41-100°F
Ambient Temperature	39-104°F
Water Quality	Municipal Tap Water

\*The rated total net water volume may vary depending on the product's usage area, water quality, and season

## INITIAL CLEANING GUIDE

To ensure optimal performance of your water mineralization system, follow these steps: Connect the system to an electrical outlet. Let the system sit for at least 3 hours before use to ensure its cooling performance

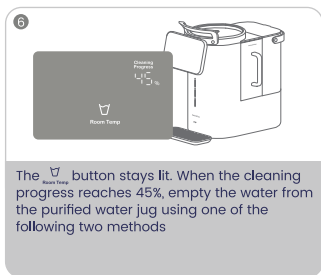
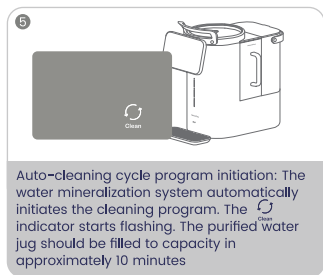
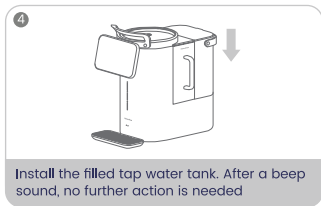
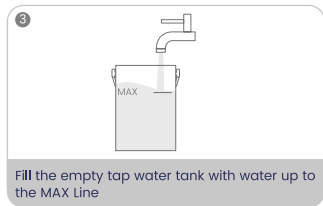
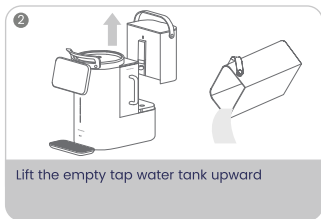
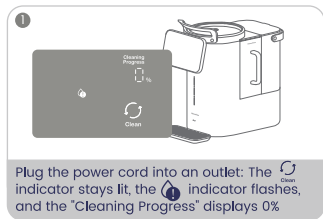

7

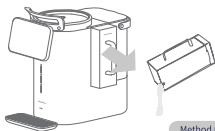

Method ①

Pull out the purified water jug, pour out all the water, reinstall the purified water jug, and no further action is needed after the beep sound

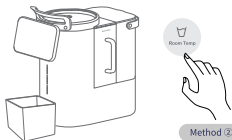

Method ②

Place a 3-liter basin/bucket under the water outlet, press the  button to empty the water from the purified water jug, and the system will automatically continue cleaning

8



Now that the purified water jug is empty, the water mineralization system will resume its auto-cleaning cycle. The  indicator starts flashing (expected duration: 10 minutes)

9

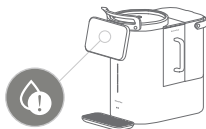

When the  indicator flashes, manually refill the tap water tank with water up to the MAX line

10

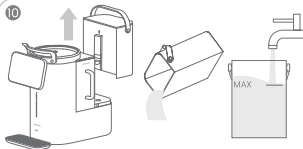

For a better drinking experience, it is recommended to pour out any remaining water from the tap water tank and refill it to the MAX line

11

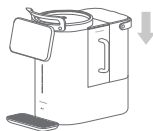

After installing the refilled tap water tank, no further action is required after the beep sound; the cleaning program will continue

12

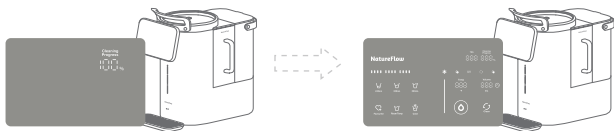

Once the purified water jug is full and the "Cleaning Progress" displays 100%, and all buttons are lit

13

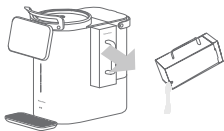

Pull out the purified water jug and pour out the water inside

14



After successfully installing the purified water jug, the device will beep, indicating that the cleaning process is complete and it can now be used normally

## 💡 Tips

When the new system is first plugged in, it undergoes an auto-cleaning process to flush out the food-grade protective liquid and air from the filter, ensuring optimal taste. It's recommended to wait until cleaning is complete before using. During this process, you may notice slight discoloration and bubbles, which are normal. After cleaning, the system can be used normally

The entire cleaning process for the new system is expected to take approximately 20 minutes and requires emptying the purified water jug twice

The new system or new filter will need to go through auto-cleaning cycle on first use. To ensure water quality, it is recommended to wait until the cleaning cycle is completed before consumption

\*Due to variations in product features, the panel display may differ from the actual product

# DISPENSING WATER AND CUSTOMIZING SETTINGS

Simple and Quick Drinking Guide

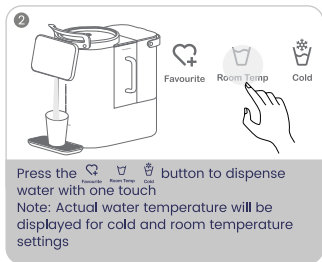
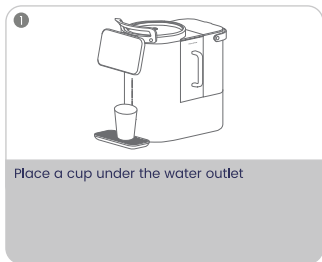

Setting the  Function

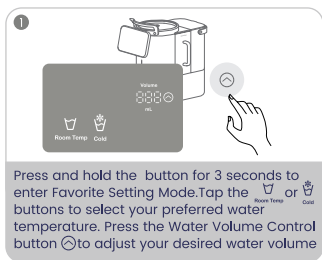

## DISPENSING WATER AND CUSTOMIZING SETTINGS



### Cold Water Function



The switch for the cold water function is located near the power cord at the back of product, where "I" is on and "O" is off

### ☼ Tips

When the cold water function is activated, the ☼ indicator light will illuminate when the cold water tank is refilling. A beeping sound will occur if the  button is pressed during this time. Please wait until the indicator ☼ light turns off <sup>Cold</sup> before using the cold water

When the cold water function is deactivated and there is still water in the cold tank, either press the  button or open the drainage outlet at the bottom of the water mineralization system to drain the water from the cold tank. This ensures that fresh cold water is available for future use. Once the cold tank is empty, the  button light will turn off

For further assistance, please scan the QR code to contact customer service, or reach out to us at [service@natureflow.io](mailto:service@natureflow.io) or (888)650-3797. Our service hours are Monday to Friday, 9:00 AM-5:00 PM US Central Time



## DISPENSING WATER AND CUSTOMIZING SETTINGS

Choose Water Output Based on the Size of the Water Cup

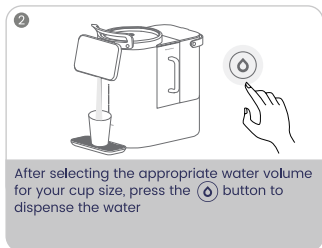
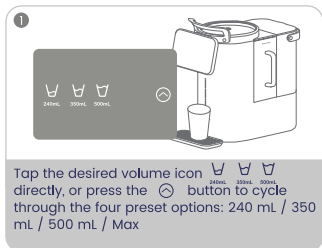

### ☼ Tips

240mL



350mL



500mL



MAX





240mL is approximately the volume of a small cup. 350mL is roughly the volume of a mug. 500mL is about the volume of a tumbler. The MAX setting allows for unlimited water dispensing. Press any button (except the volume buttons) during dispensing to stop the water flow

For better health management, it is recommended to drink at least 33.8 fluid ounces (1 liter) of mineral water daily

## WASTEWATER REPLACEMENT GUIDE

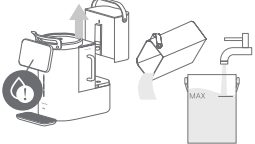
1



When the  indicator flashes on the screen, it's time to manually replace the water. Refill the tap water tank up to the MAX line. To ensure optimal water quality, lift the empty tap water tank and pour out any remaining water. Refill the empty tap water tank with tap water up to the MAX line.

2



After installing the filled tap water tank, you will hear a beep indicating proper installation. No further action is needed. Once the purified water jug is filled and the water purification and mineralization process is complete, the system is ready for use.

### Tips

It is not recommended to frequently add water directly into the tap water tank without first emptying the remaining wastewater. After filtration, wastewater flows back into the tank. Adding tap water directly increases impurity concentration, which gradually reduces the filter's lifespan. For optimal durability, it is advised to discard wastewater and use fresh tap water instead.

Avoid adding unknown liquids or water of uncertain quality to the tap water tank, as this can shorten the filter's lifespan. It is best to use municipal tap water.

For further assistance, please scan the QR code to contact customer service, or reach out to us at [service@natureflow.io](mailto:service@natureflow.io) or (888) 650-3797. Our service hours are Monday to Friday, 9:00 AM-5:00 PM US Central Time.



---

## WASTEWATER REPLACEMENT GUIDE

### Suggestions

The wastewater from the tap water tank can be reused for various purposes such as watering plants, flushing toilets, and refilling steamers, floor cleaners, or robotic vacuum cleaners

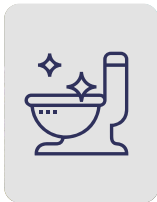

flushing toilets



refilling steamers



floor cleaners, or robotic  
vacuum cleaners

To maintain water taste and prolong the filter lifespan, it is recommended to change the tap water daily and regularly clean the tap water tank to ensure optimal performance of your water purification system

Filling the tap water tank up to the MAX line reduces the frequency of water replacement. Adjust the amount of water added based on your needs

## CLEANING GUIDE

If you haven't used the product for an extended period or have been away on a trip, it is recommended to manually clean it 1-2 times

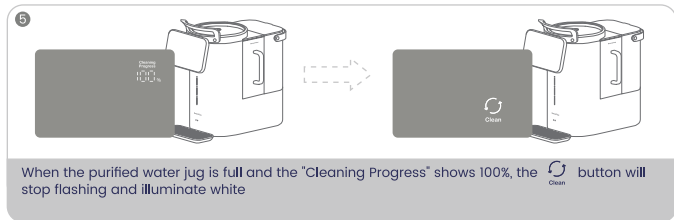
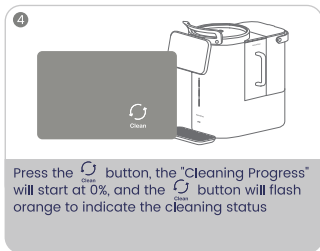
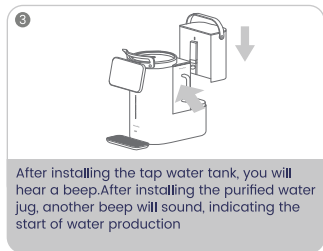
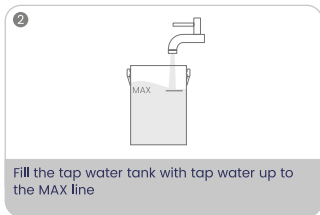
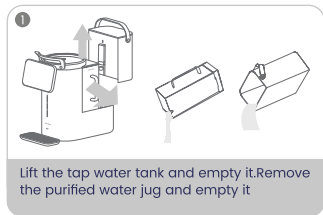

## CLEANING GUIDE

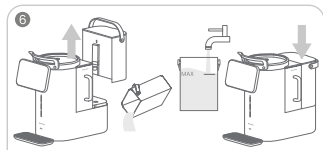

Lift the tap water tank, empty any remaining wastewater, and refill it to the MAX line. After reinstalling the tap water tank, you will hear a beep.



Pull out the purified water jug and empty it. Reinstall the purified water jug; after a beep, water production will commence, and the system will be ready for normal use.

### 💡 Tips

You can increase the cleaning frequency by 1-2 times depending on the actual situation



The manual cleaning function cannot be activated when the  indicator is flashing or when the purified water jug is full

For further assistance, please scan the QR code to contact customer service, or reach out to us at [service@natureflow.io](mailto:service@natureflow.io) or (888) 650-3797. Our service hours are Monday to Friday, 9:00 AM-5:00 PM US Central Time.



## FILTER REPLACEMENT GUIDE

When you see the filter indicator on the screen turn red or flashes, please replace the filter as soon as possible

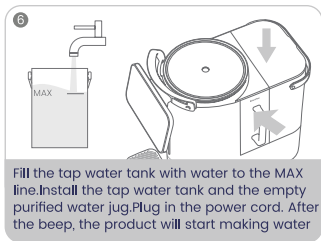
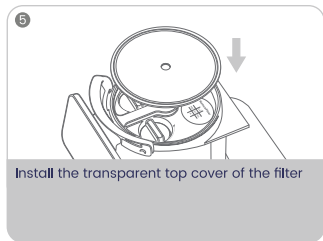
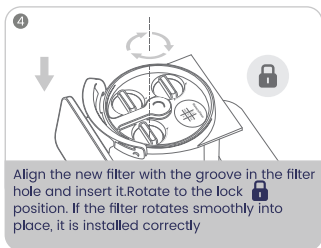
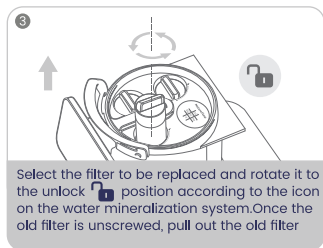
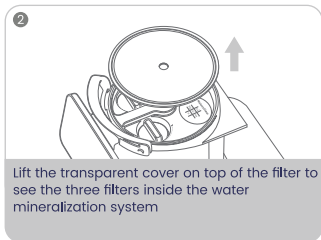
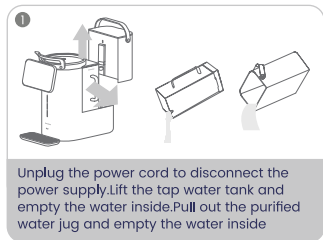

## FILTER REPLACEMENT GUIDE

7

Filter ①  
Life Reset Button



Filter ②  
Life Reset Button



Filter ③  
Life Reset Button



Filter ①&③  
Life Reset Button

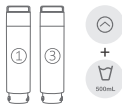

Filter ①&②&③  
Life Reset Button

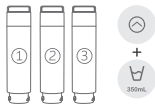

Please come to the front of the screen and reset the corresponding filters according to the instructions above. To reset, press and hold down both corresponding buttons simultaneously for more than 3 seconds. Once you hear the beep confirmation sound, the reset is successful. The water mineralization system will enter the cleaning mode, automatically cleaning the pipelines and filters to ensure safety of your drinking water

### 💡 Tips

After the filter reset is successful, the product will enter cleaning mode to automatically clean the pipelines and filters, ensuring safety and taste of your drinking water

For further assistance, please scan the QR code to contact customer service, or reach out to us at [service@natureflow.io](mailto:service@natureflow.io) or (888) 650-3797. Our service hours are Monday to Friday, 9:00 AM-5:00 PM US Central Time



## PLACEMENT GUIDE

The water outlet and screen can rotate 180 degrees, featuring a patented appearance design that allows flexible placement in various positions around the house

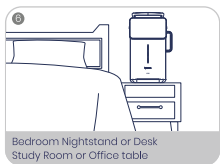
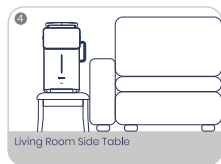
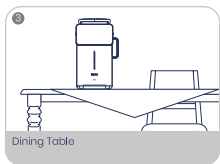
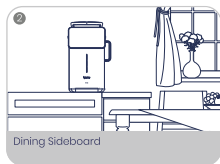

## MAINTENANCE GUIDE

### Wastewater Replacement Precautions

It is not recommended to frequently pour water directly into the tap water tank. After filtration, waste water returns to the tap water tank, and directly adding water can increase the concentration of impurities in the tank, gradually reducing the filter cartridge's lifespan. For durability considerations, it is recommended to discard waste water before refilling.

Each time you replace tap water, it is advisable to rinse the tap water tank multiple times to ensure cleanliness.

Avoid adding unidentified liquids or water sources of unknown quality to the tap water tank, as this may reduce the lifespan of your filter cartridge. It is recommended to use municipal tap water normally.

Using the product with an inlet water temperature below 41°F / 5°C or above 100°F / 38°C may damage the product.

### Recommendations Before Moving the Product or Extended Periods of Non-Use

Empty the tap water tank and the purified water jug.

Press and hold the  button for 5 seconds to drain any remaining water from the product.

Before using it again, refer to the Daily Cleaning Instructions, and clean the product 1-2 times.

## MAINTENANCE GUIDE

### Placement Precautions

It is recommended to place the product in a cool area, avoiding direct sunlight to prevent product aging and bacteria growth in the water tank.

Do not place the system on its side or upside down.

Do not store or place the product in environments below 39 °F /4°C or above 104 °F /40°C, as this may damage the product or filter cartridges.

Do not place the product in high-temperature or strong magnetic environments, as this may cause fire or circuit failure.

### Usage Precautions

In case of product malfunction or other abnormal situations, unplug the power cord immediately

Except for replacing the filter, do not arbitrarily open the product or dismantle internal components to avoid electric shock.

Ensure the product is plugged into a dedicated socket rated at least 14A (110V) and equipped with a grounding wire.

If the power cord is damaged, to prevent hazards, it must be replaced by the manufacturer, their service department, or a qualified professional.

When unplugging the power cord, do not pull on the cord directly to avoid breakage or damage.

Keep the power plug clean and dry. Do not plug or unplug the power cord with wet hands to prevent electric shock.

---

## MAINTENANCE GUIDE

### Warning

Each time the product is moved, it must be left stationary for 3 hours before being powered on to prevent compressor damage.

Ensure there are no obstacles around the appliance or in built-in structures to maintain smooth ventilation.

When placing product, maintain a 4-8 inch clearance between the product and the wall to ensure proper ventilation.

Do not use the product in the appliance's food storage compartment other than those recommended by the manufacturer.

To prevent hazards due to unstable fixture of the appliance, it must be installed and fixed according to the instructions.

Do not store explosives in the product, such as inflammable aerosols. This appliance is intended for household and similar use only.

### Care for Individuals with Special Needs

Please store the dismantled packaging properly and keep it out of reach of children to prevent them from touching or swallowing it.

Do not allow children to operate, touch, approach, pull, or climb on the product.

Children and individuals with intellectual disabilities should use the product under the supervision of a guardian. The product should be placed out of their reach to prevent risks such as electric shock or burns.

---

## WARNING

FAILURE TO FOLLOW THESE INSTRUCTIONS CAN RESULT IN DEATH, FIRE, OR ELECTRICAL SHOCK



### GROUNDING PRECAUTIONS

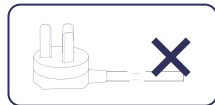
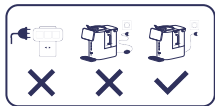
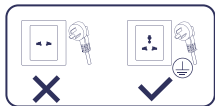

### GROUNDING INSTRUCTIONS:

**WARNING :**

If the wall outlet is a standard 2 prong outlet, it is your personal responsibility and obligation to have it replaced with a properly grounded 3-prong wall outlet.

**WARNING :**

DO NOT under any circumstances cut or remove the third (ground) pin from the power cord plug.

**WARNING :**

DO NOT use adapter plugs or extension cords with this appliance.

**WARNING :**

DO NOT use the appliance if the power cord becomes frayed or otherwise damaged.

---

## TROUBLESHOOTING

For further assistance, please reach out to us at [service@natureflow.io](mailto:service@natureflow.io) or (888) 650-3797. Our service hours are Monday to Friday, 9:00 AM - 5:00 PM US Central Time



Issue	Possible Causes	Solution
Cannot dispense water and filter light is flashing	Purified water jug is empty	Ensure the purified water jug is securely installed. Wait until the filter light stops flashing before dispensing water.
Temperature display area shows: E5	Filtering anomaly detected	Reconnect the power, check if the purified water jug and its lid are properly installed
	Poor tap water quality causes early filter blockage	Replace the filter *Please consult customer service
Water leakage	The drip tray is full	Empty the drip tray
	The filter is not installed properly	Remove and reinstall the filter
	The tap water tank is not installed properly	Remove and reinstall the tap water tank
	Water was spilled on the tap water tank base during the installation process	Wipe off the tap water tank base and place the tap water tank back into its original position

---

# NATUREFLOW LIMITED WARRANTY POLICY

NatureFlow provides this limited warranty (the "Limited Warranty") for our products ("Products")

**FOR DETAILED INFORMATION OF PURCHASED PRODUCTS, PLEASE VISIT THE WEBSITE [HTTPS://WWW.NATUREFLOW.IO/PAGES/SUPPORT](https://www.natureflow.io/pages/support) AND REFER TO THE INSTRUCTION MANUAL, AS IT IMPACTS YOUR LEGAL RIGHTS.**

## 1. WARRANTY PERIOD

For Products You purchased, the Limited Warranty period is as follows:

LIMITED WARRANTY PERIOD	REMARKS
One (1) Year	Replacement Products or parts are warranted for the remaining period of the original limited warranty period or ninety (90) days, whichever occurs later.

\*The Limited Warranty Period commences from the date of original retail purchase.

## 2. WARRANTY COVERAGE

This Limited Warranty only covers product issues solely caused by defects in material or workmanship during ordinary consumer use.

If there is improper use or human damage, it will no longer be covered by this limited warranty. Please refer to the instruction manual for specific usage.

## 3. WARRANTY CLAIM

To submit a limited warranty claim, please contact our call centers as follows:

- For the United States, please call: (888) 650-3797
  - a. Monday-Friday: 9:00 AM-5:00 PM US Central Time
  - b. Saturday / Sunday: Closed
- Or email us at [service@natureflow.io](mailto:service@natureflow.io)  
Or scan the QR code below to fill out a service request form.



To obtain limited warranty service, your claim must be properly submitted during the valid Limited Warranty period and supported with the proof of original retail purchase (or rental agreement signed) and the evidence of the alleged defects for Limited Warranty validation.

# NatureFlow



Manufacturer: Jia Li Quan Health Technology (Suzhou) Co., Ltd.

Manufacturer Address: Room 101, 106-107, Science and Technology Building, No. 8 Weizheng Road, Suzhou Industrial Park, Suzhou City, Jiangsu Province.

For further assistance, please reach out to us at [service@natureflow.io](mailto:service@natureflow.io) or (888) 650-3797. Our service hours are Monday to Friday, 9:00 AM - 5:00 PM US Central Time.