

Power Spa®

AIR-TURBO LED
SHOWER HEAD WITH
PRESSURE-BOOST
TECHNOLOGY

Items 1491

1. Remove old shower head by turning it counter-clockwise. Remove any excess material left on Shower Arm threads. Use steel wool if necessary.

2. Make sure Washer is positioned FLAT and STRAIGHT inside Connection Nut and Shower Arm (Fig. 2). Hand tighten Connection Nut onto Shower Arm (Fig. 2).

IMPORTANT: Hand tighten connections ONLY.

DO NOT use wrench or pliers. DO NOT overtighten Connection Nut, this may cause washer to bend and be pushed into shower arm. Use plumber's tape ONLY if Washer fails to stop leakage.

NOTE: If your shower arm has a ball on the end of it instead of thread, it will not work with this shower unit and will need to be replaced with a standard shower arm available at most plumbing supply stores.

Cleaning Instructions Cleaning may be required when mineral deposits appear on jet tips. Clean flexible nozzles by rubbing with a finger or soft bristled toothbrush. Do not clean or rinse any part with harsh chemicals, heavy-duty cleaners or abrasives. This may damage parts or finish and may void warranty.

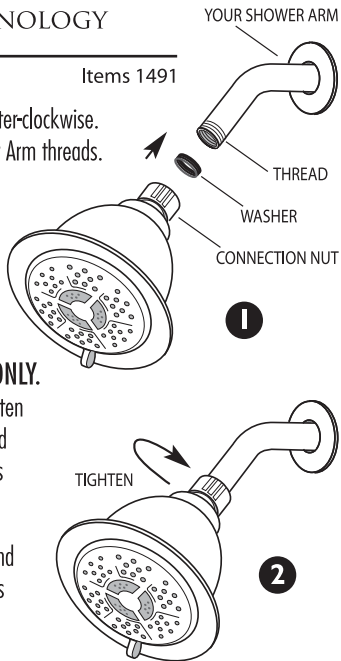

To Set 5 Shower Head Settings and Angle

Turn Dial Lever (Fig. 3) to select desired water pattern, while holding Shower Head with free hand to prevent loosening of its connection. To save water, turn Dial Lever to Economy Rain setting. Swivel Shower Head to set desired angle.

Hydro-Powered, No Batteries or Electricity!

LED lights are powered by running water, no batteries.

Full-Spectrum Multiple Colors Change Automatically

LED lights change color automatically while water is running.

Low Water Pressure? You can remove Water Flow Regulator.

As mandated by U.S. federal law, this shower is equipped with water flow regulator, located inside connection nut under the mesh washer, that limits maximum water flow to 2.5 gallons (9.5 liters) per minute at 80 psi water pressure.

In areas with extremely low water pressure causing the shower water flow to be unsatisfactory, the flow regulator may be removed. Using screwdriver point, long nose pliers or sharp-point tool, pull out Water Regulator located underneath Washer inside Connection Nut (Fig. 4).

If you have installation problem or missing parts, please **DO NOT** return this product before calling us first. We can solve it on the phone or quickly send needed parts.

For Questions/Parts
Call Toll Free

1-888-869-4010

Monday - Friday
9:00 AM - 4:00 PM
Eastern Standart Time

www.ipshowers.com

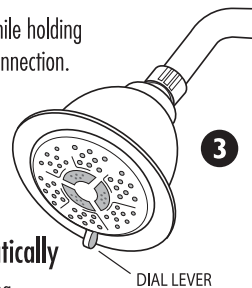

ONE YEAR WARRANTY

Interlink will repair or replace any of this product's parts that exhibit defects in workmanship or materials for above stated period from date of purchase. If malfunction occurs, send only defective part(s) with proof of purchase to Customer Service Department at the address listed below. Your warranty does not cover malfunction or damage due to accident, misuse, or failure to follow any written instructions accompanying this product.

Made in China **Interlink Products** 1315 E. Elizabeth Ave., Linden, NJ 07036