

# Assembly Instructions

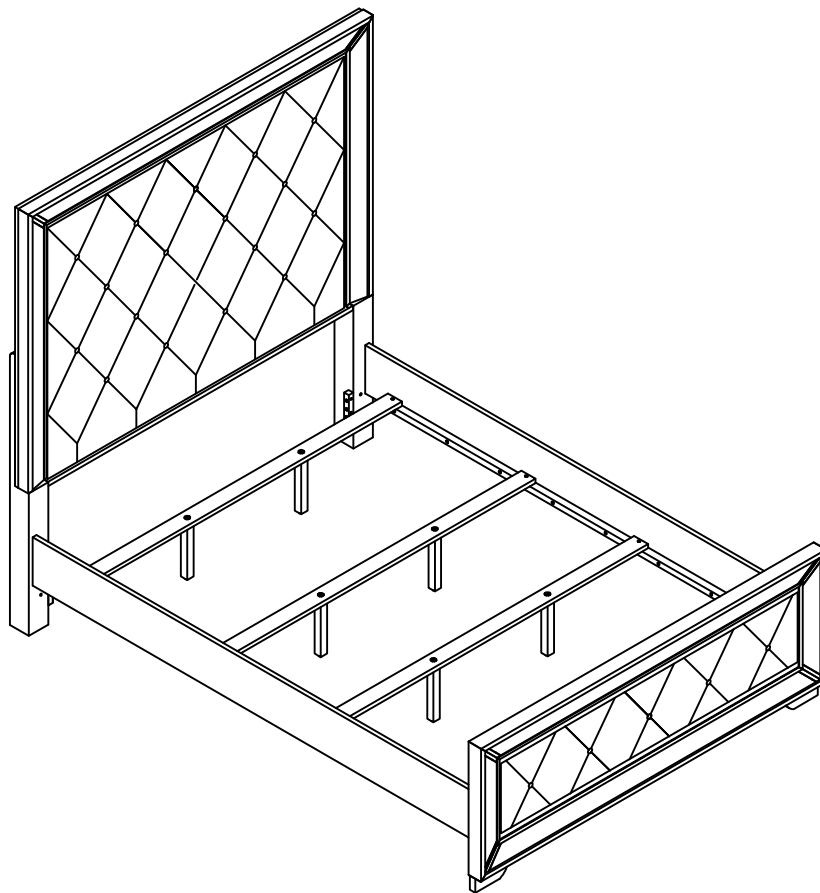

## ASSEMBLY RATING

The Assembly Rating is a 5-point system that shows the degree of effort needed in assembling a specific product (with 1 being easy and 5 being difficult). For some products, two persons are recommended.

EASY



DIFFICULT

## Tools Required For Assembly:

Allen Wrench

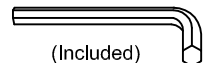

(Included)

Phillips Screwdriver



(Not Included)

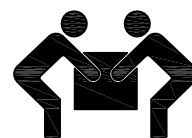

2 PERSONS RECOMMENDED

# ASSEMBLY & CARE ADVICE

FOR YOUR FURNITURE TO LAST, CORRECT ASSEMBLY AND PROPER MAINTENANCE ARE NECESSARY. PLEASE FOLLOW THE INFORMATION PROVIDED BELOW TO FULLY ENJOY YOUR FURNITURE.

## BASIC ASSEMBLY TECHNIQUES

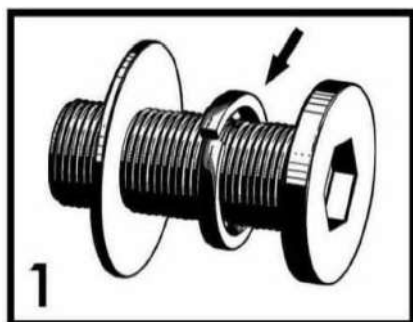

When lock or spring washer is used in an assembly, please make sure the lock or spring washer is placed between the larger flat washer and the head of the screw or bolt.

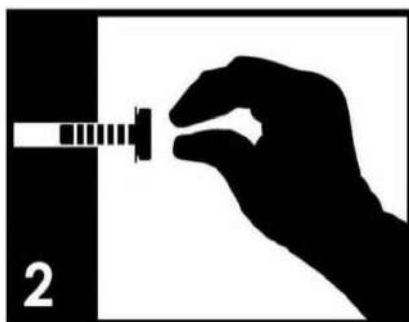

Position each part correctly and insert screws or bolts into their respective holes by hand tighten or using the proper hand tool. Only tighten when step is completed or when instructed to do so.

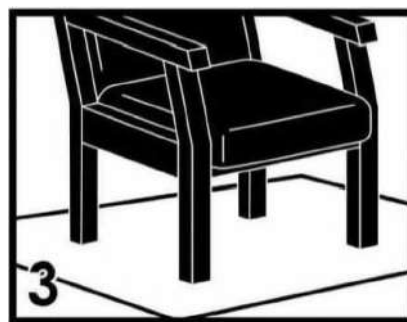

Use cardboard or carpet area when assembling furniture to prevent scratches. Make sure the furniture rests on a flat and level surface with each leg evenly touching the floor.

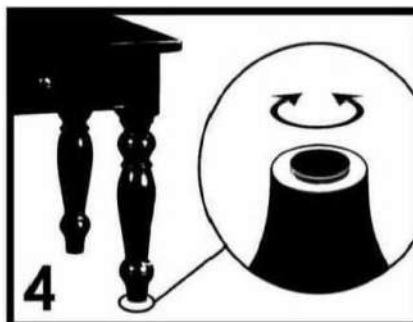

Some furniture comes with height adjustment knobs underneath each leg. To lower or to raise each leg, you need to turn clockwise or counterclockwise, respectively.

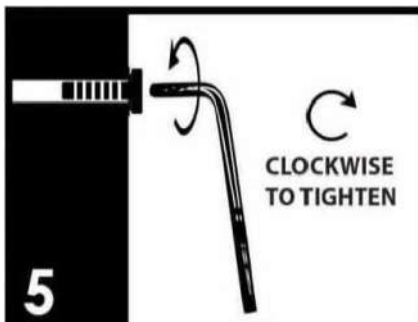

Make sure all parts are properly aligned, then use the appropriate hand tool to completely tighten the bolts or screws. Do not use power tools and do not overtighten.

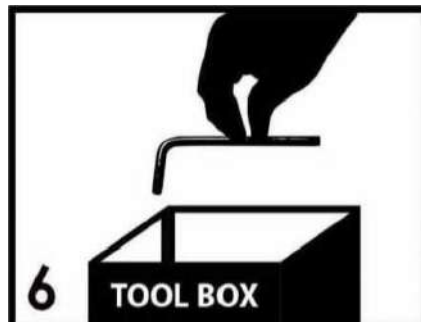

Save the instructions and store the Allen wrench or any supplied tool for later maintenance. After two weeks, check and tighten any loose hardware and repeat again every six months thereafter.

IT IS THE USER'S RESPONSIBILITY TO MAINTAIN THE FURNITURE. THE HARDWARE MAY LOOSEN OVER TIME AND MAY CAUSE THE FURNITURE TO BE WOBBLY AND UNABLE TO SUPPORT ITS INTENDED WEIGHT CAPACITY. THIS MAY LEAD TO COLLAPSE AND MAY CAUSE SERIOUS INJURY.

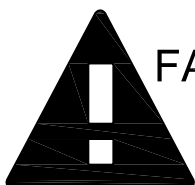

FAILURE TO FOLLOW THE GUIDELINES ABOVE MAY RESULT IN INJURY AND/OR PROPERTY DAMAGE.



Before you begin, please read Page 2 of "Assembly and Care Advice".

And remember, do not tighten until each step is completed or instructed.

## Parts List

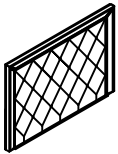

#1 x 1pc  
Headboard



#2L x 1pc  
Headboard Left Leg



#2R x 1pc  
Headboard Right Leg

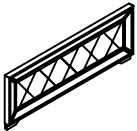

#3 x 1pc  
Footboard

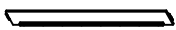

#4 x 2pcs  
Side Rails



#5 x 4pcs  
Slat

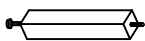

#6 x 8pcs  
Slat Support leg



#I x 4pcs  
Flat Washer Ø1/4"

## Hardware List



#A x 6pcs  
Bolt 5/16"X1-3/8"



#B x 6pcs  
Lock Washer Ø5/16"



#C x 6pcs  
Flat Washer Ø5/16"

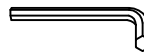

#D x 1pc  
Allen Wrench

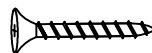

#E x 8pcs  
Screw #4X22mm



#F x 2pcs  
Metal Bracket



#G x 4pcs  
Bolt 1/4"X5/8"



#H x 4pcs  
Lock Washer Ø1/4"



#A x 6pcs  
#B x 6pcs  
#C x 6pcs  
#G x 4pcs  
#F x 2pcs  
#H x 4pcs  
#I x 4pcs

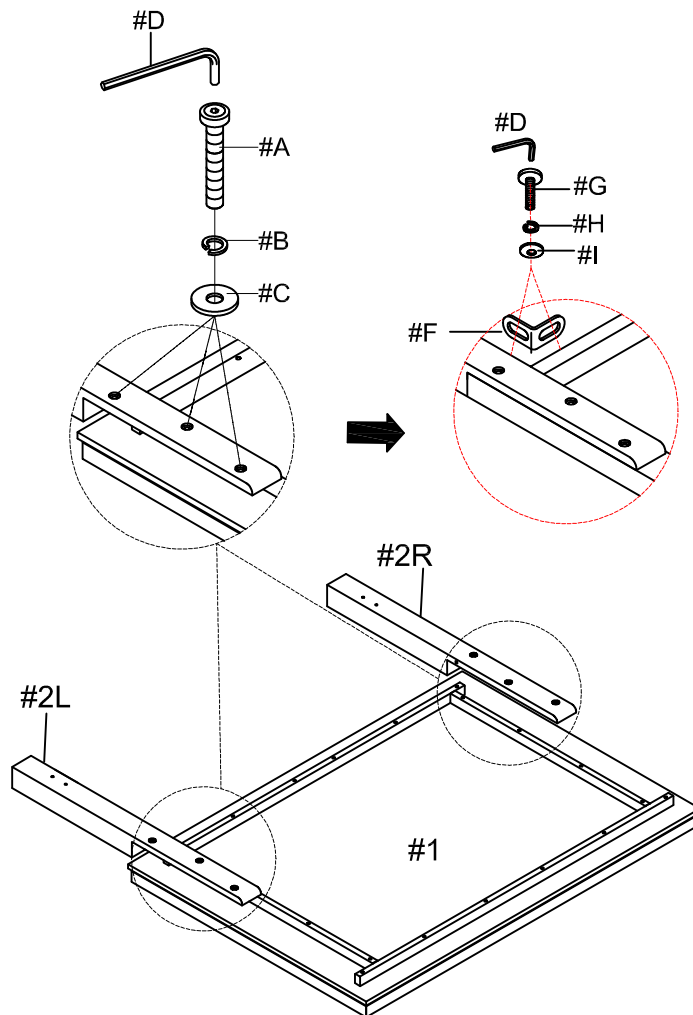

- I. Carefully place the headboard on a protected surface.
- II. Align the right and left legs (#2L/R) to the pre-drilled holes along the sides of the headboard (#1).
- III. Prepare 6 bolt assemblies by FIRST inserting the lock washer (#B) onto the bolt (#A) then the flat washer (#C) onto that SAME bolt (#A), in that order. Insert into the top of the legs and secure using the Allen wrench (#D).
- IV. Prepare 4 bolt assemblies by FIRST inserting the lock washer (#H) onto the bolt (#G) then the flat washer (#I) onto that SAME bolt (#G), in that order. Align a metal bracket (#F) to each corner connecting the headboard to legs then insert the bolt assemblies and secure using the Allen wrench (#D).



Insert the side rails (#4) into the designated slots along the the headboard (#1) and footboard (#3).

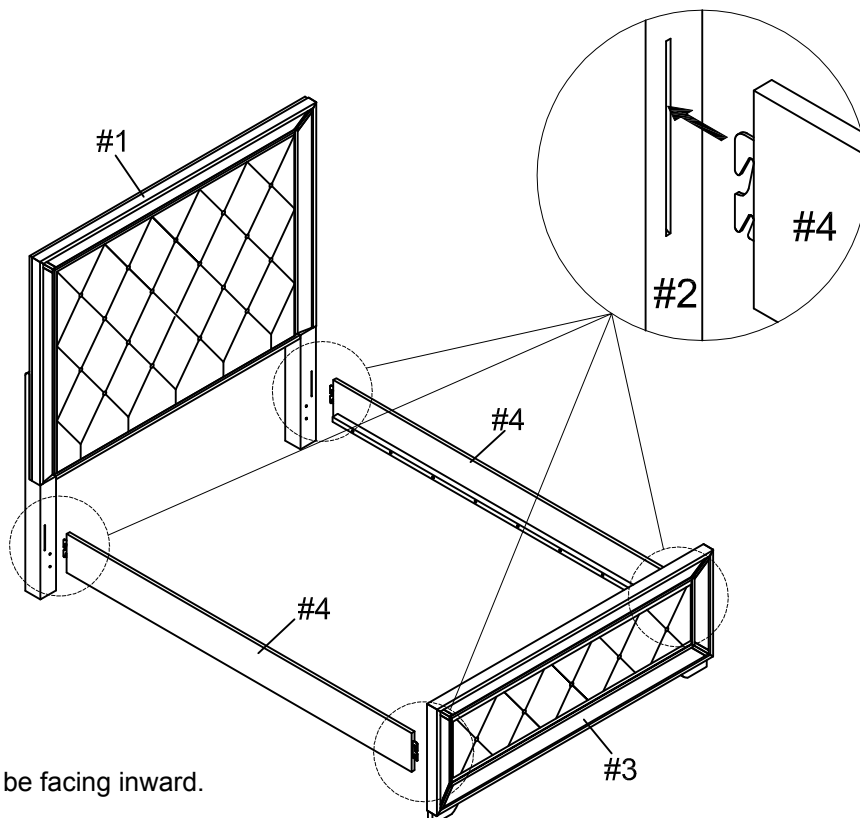

Note: Rails should be facing inward.



Align 2 slat support legs (#6) to each slat (#5). Insert threaded end into the pre-drilled holes. Turn right to tighten and level to ground accordingly.

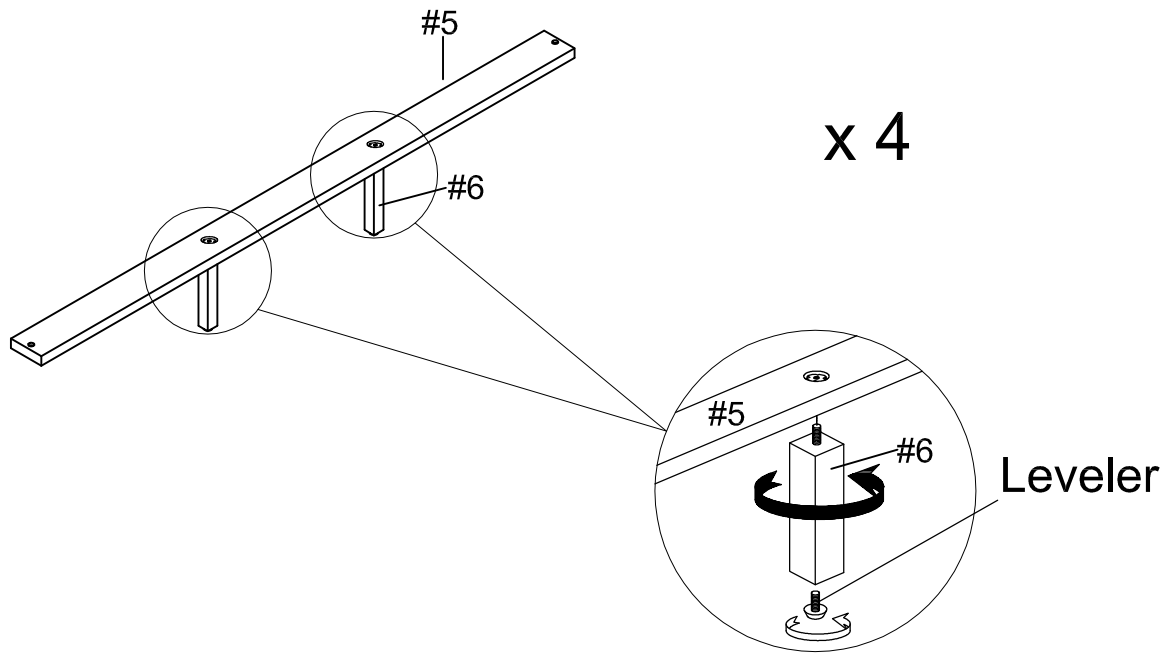

#E x 8pcs

Align the slats (#5) to the side rails (#4). Insert screws (#E) and secure using a Phillips screwdriver.

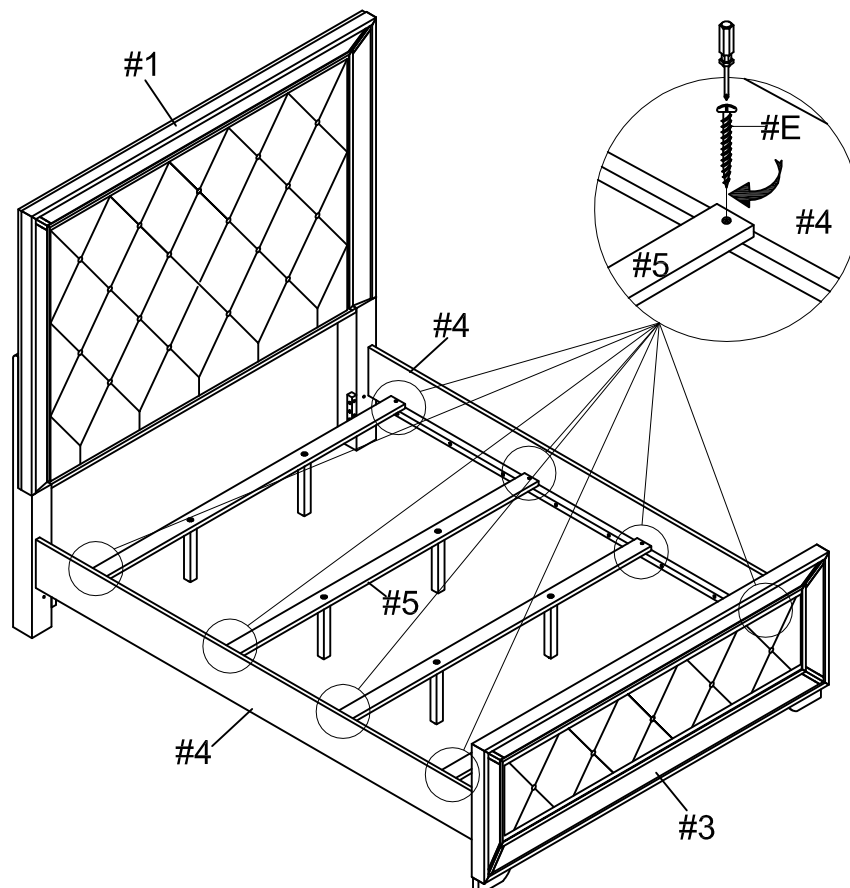

ASSEMBLY IS COMPLETED