

## Important:

1. It is recommended that customers use an electric screwdriver to install, it will be easy to assemble.
2. The metal frames have certain degrees of elasticity. Please DO NOT over tighten the screws during assembly. An over tightened screw can cause bent metal frame.
3. For a smooth assembly process, we suggest you keep a lite tightness for all the screws during assembly, after the whole dresser is aseembled , firmly tightening all the screws.

## Exploded Drawing

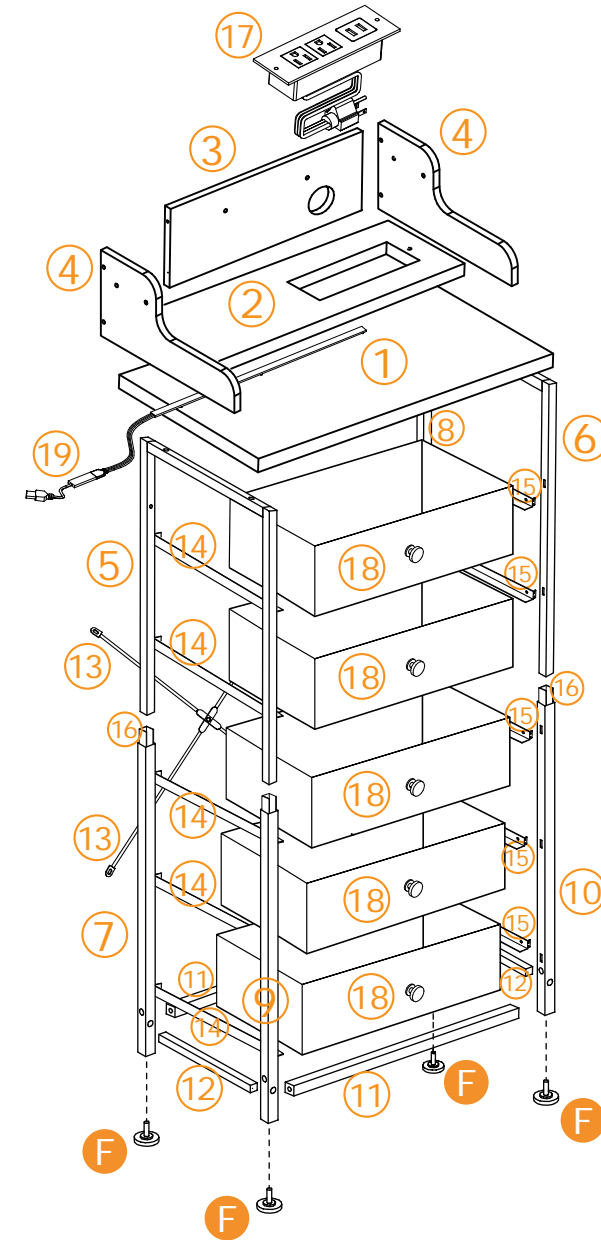

## Parts:

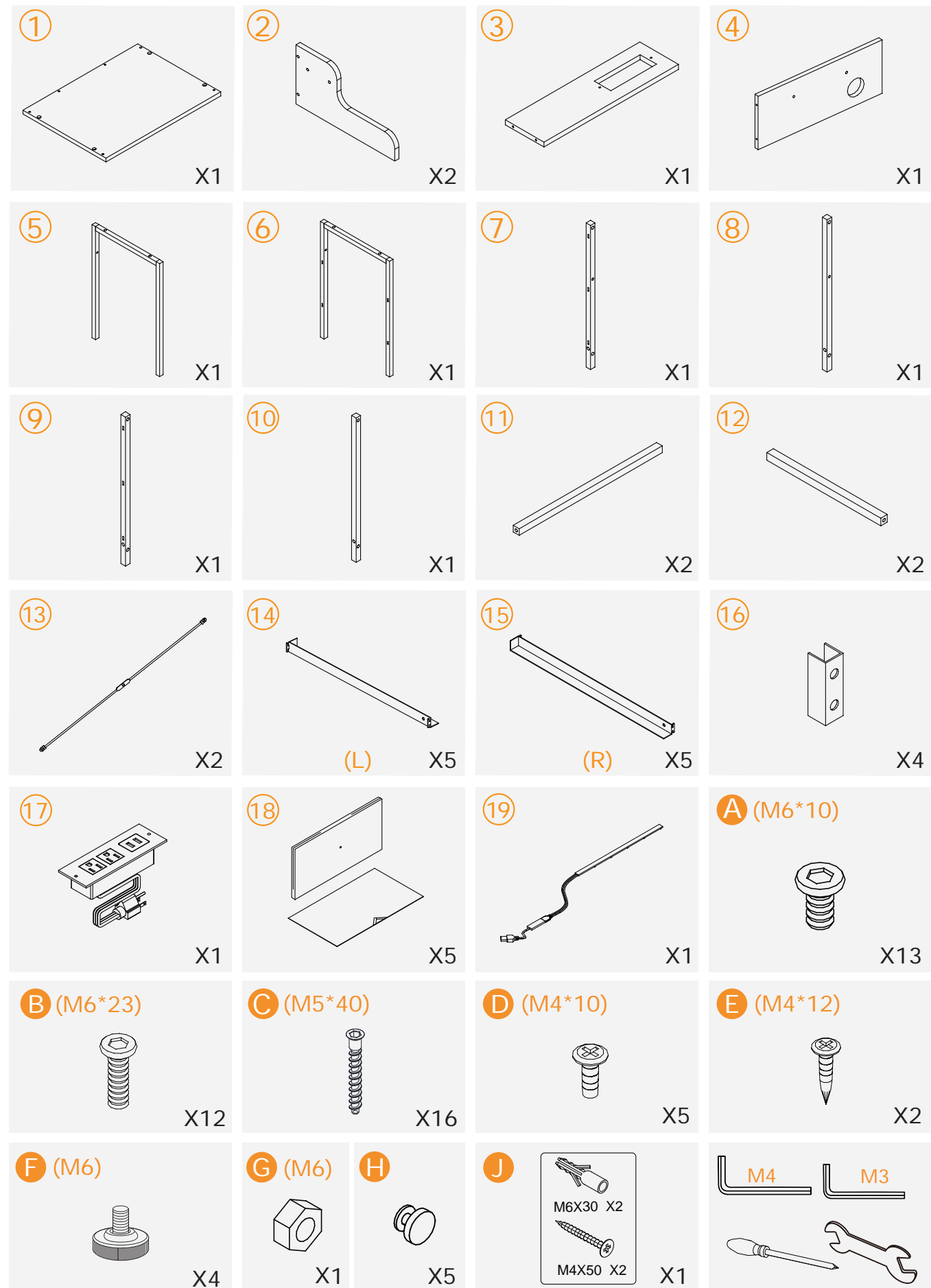

## Assembly Instruction:

### STEP1

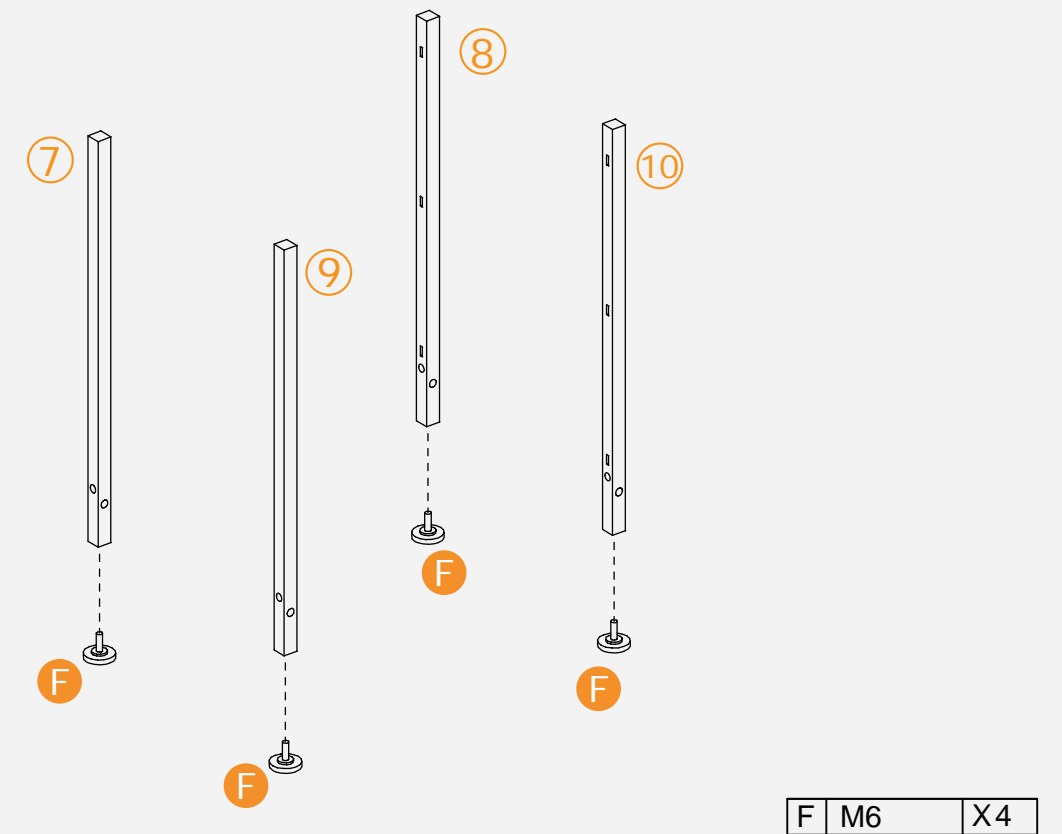

### STEP2

Pay attention to the direction

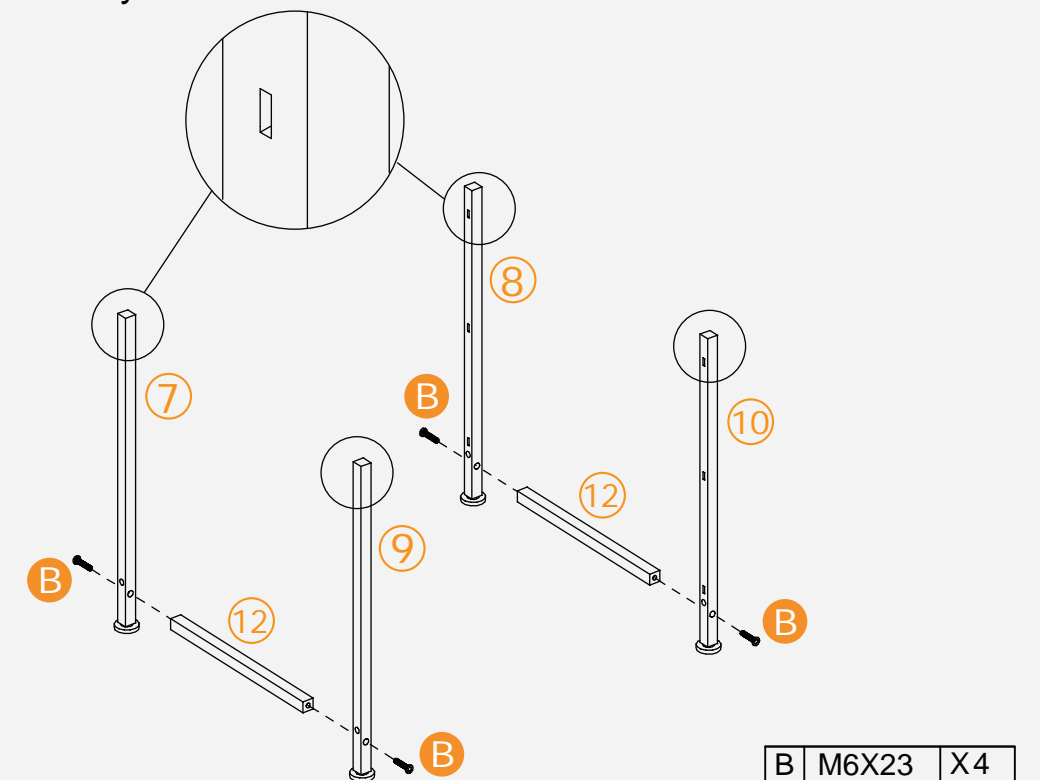

# Assembly Instruction:

## STEP3

Towards the inside

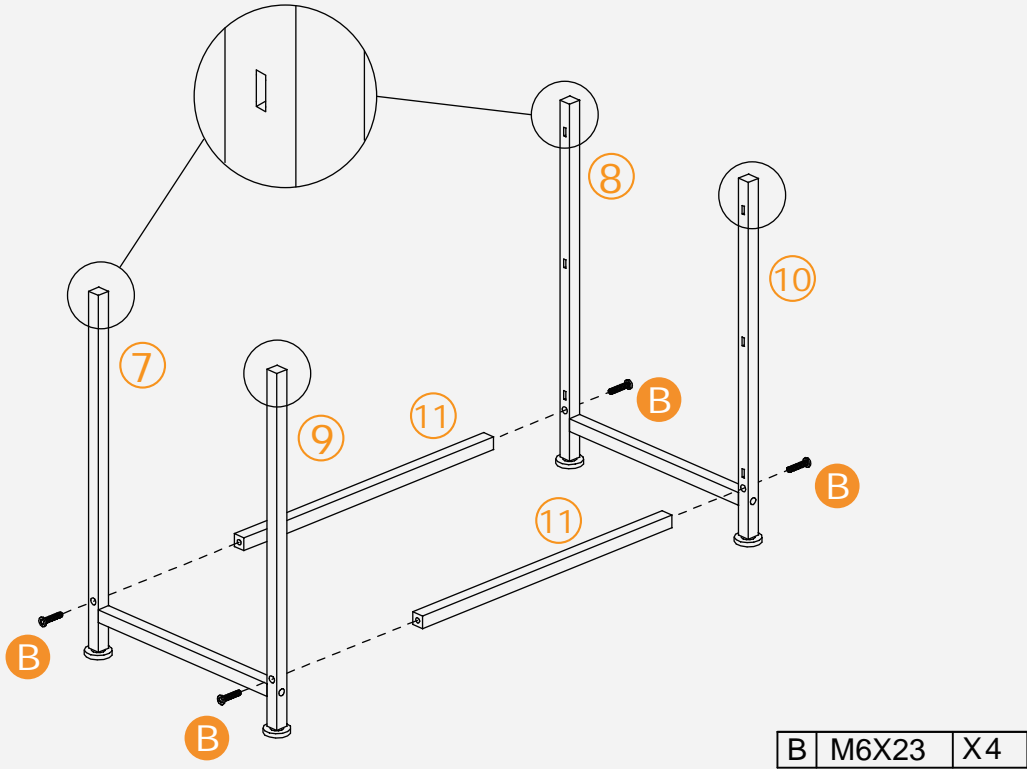

# Assembly Instruction:

## STEP5

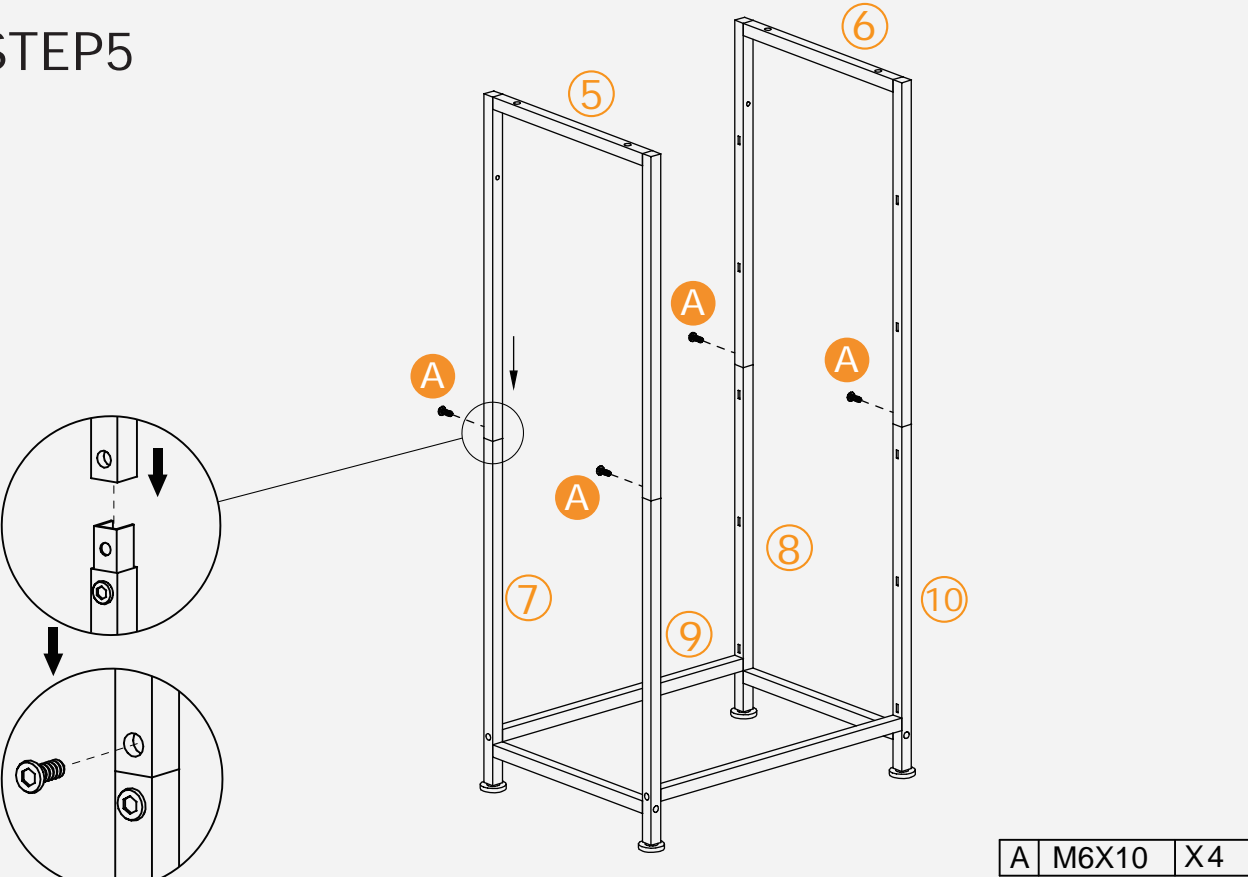

## STEP4

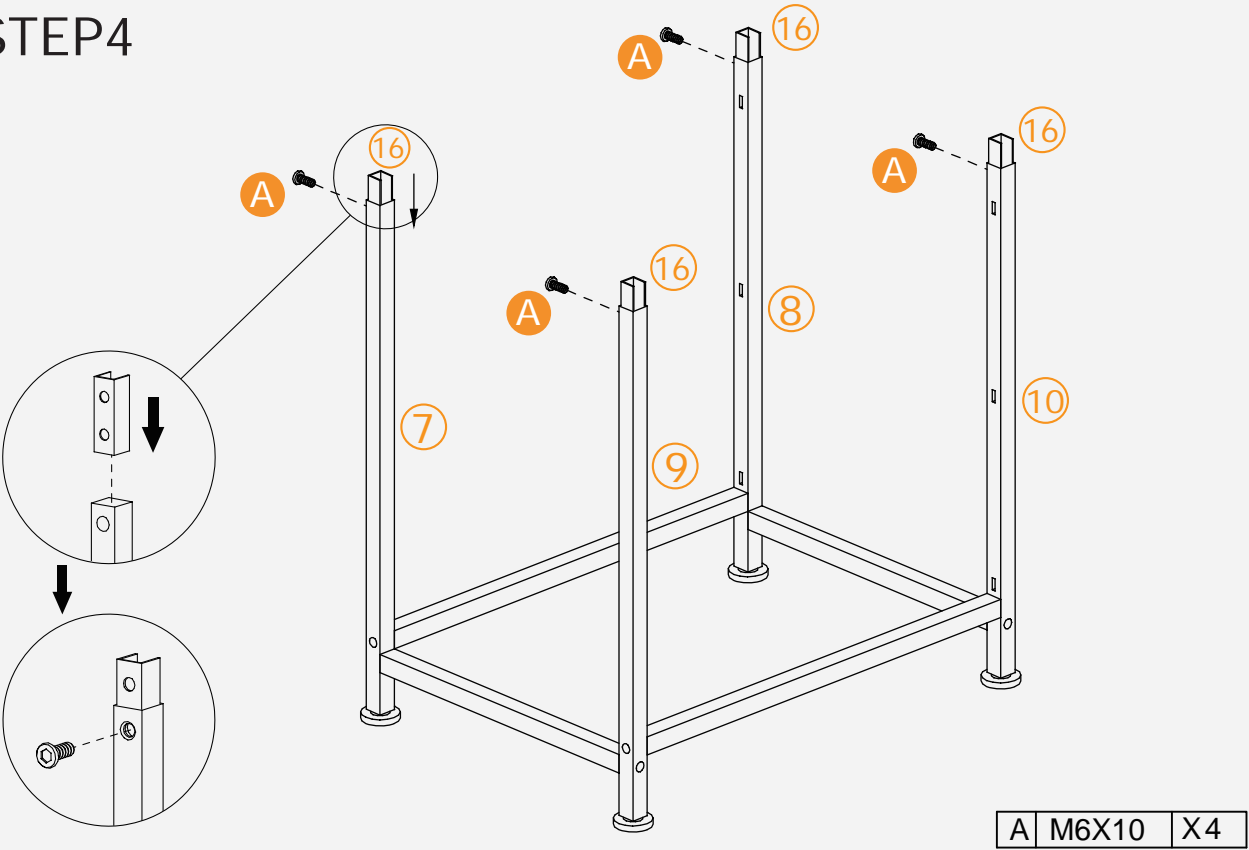

## STEP6

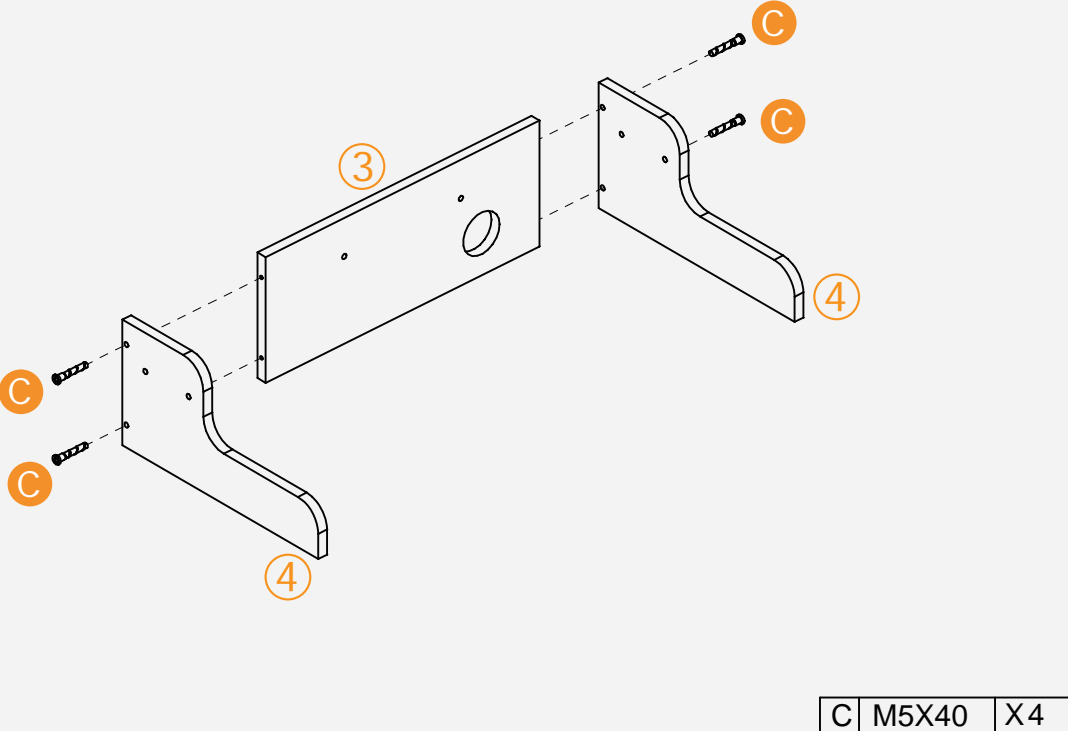

# Assembly Instruction:

STEP7

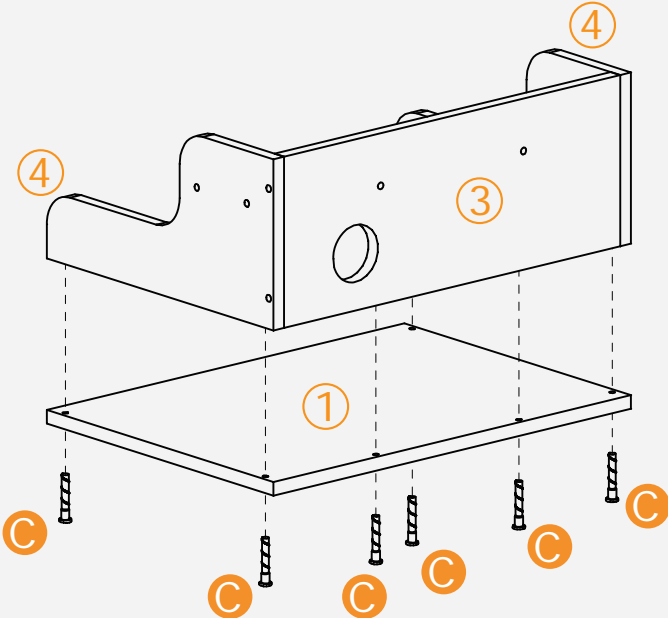

C	M5X40	X6
---	-------	----

STEP8

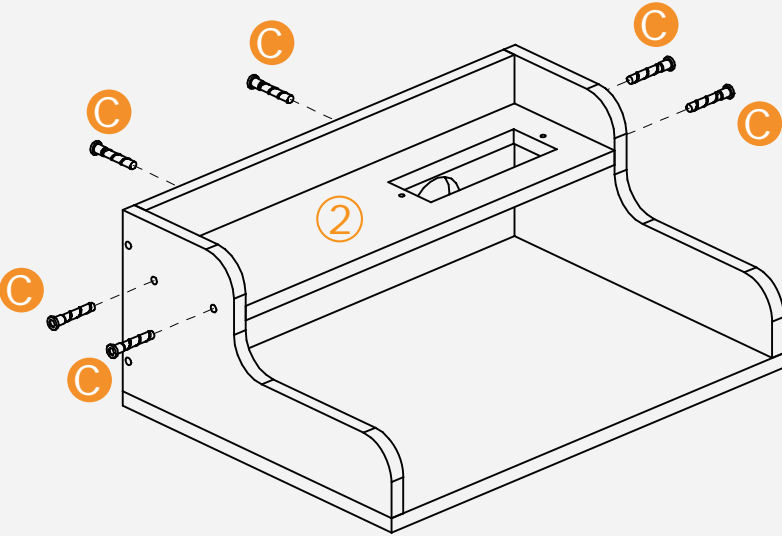

C	M5X40	X6
---	-------	----

# Assembly Instruction:

STEP9

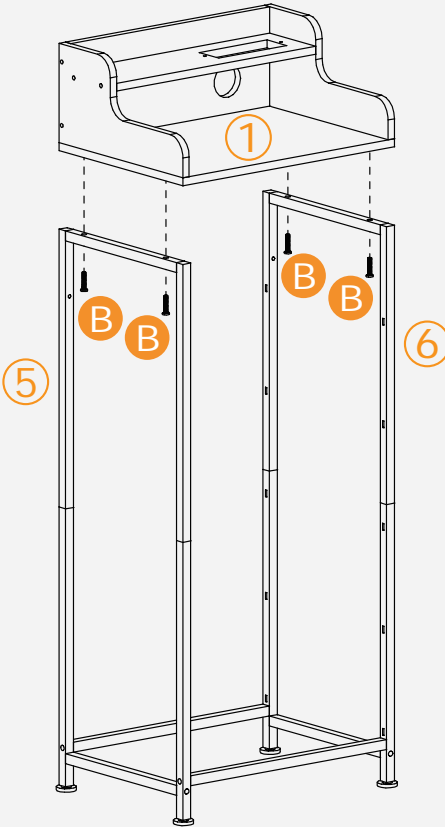

B	M6X23	X4
---	-------	----

STEP10

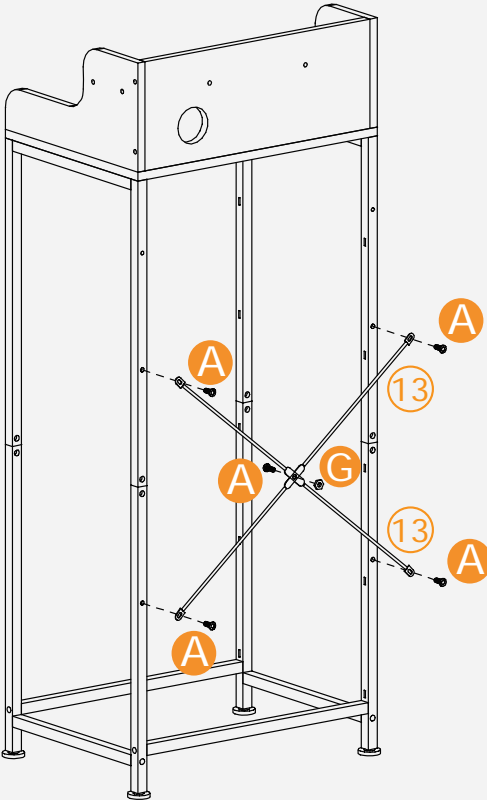

A	M6X10	X5
G	M6	X1

## Assembly Instruction:

### STEP11

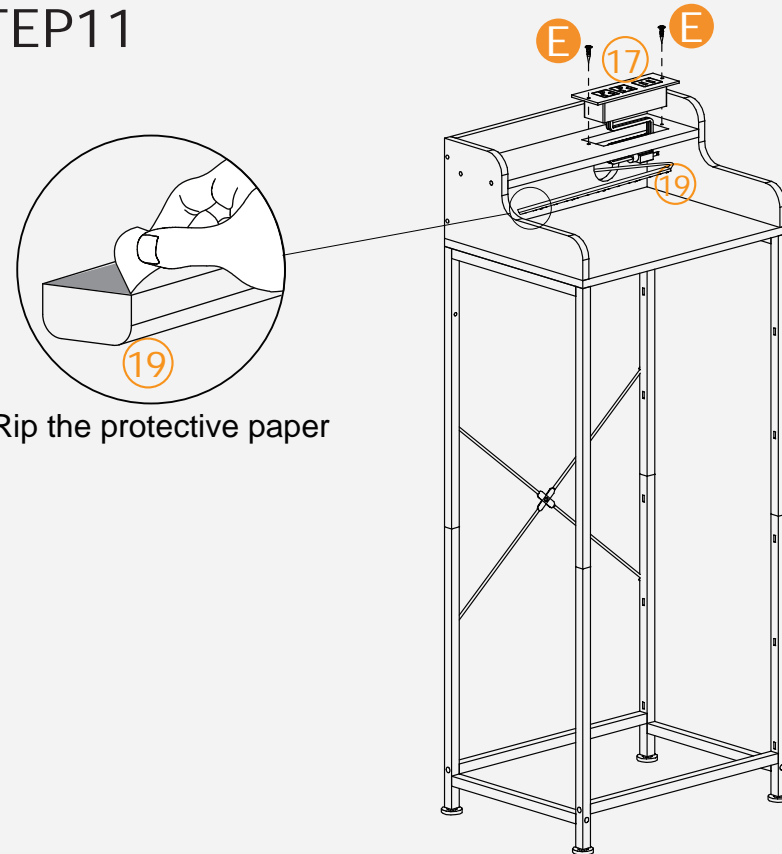

E	M4X12	X2
---	-------	----

## Assembly Instruction:

### STEP13

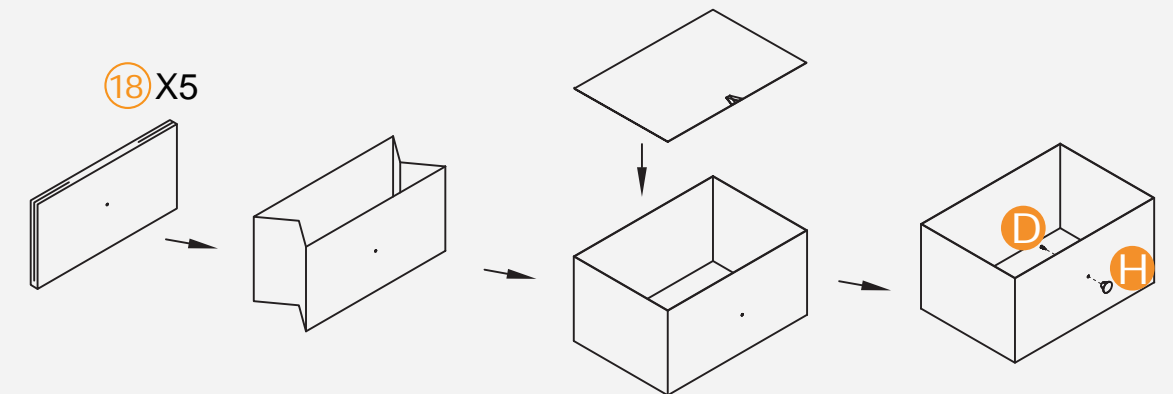

D	M4X10	X5
H		X5

### STEP12

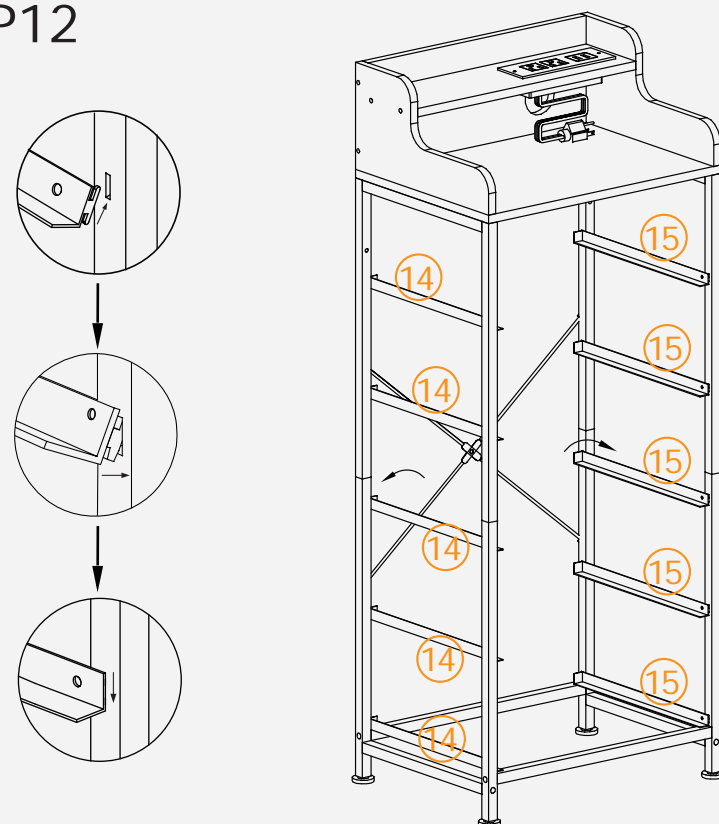

### STEP14

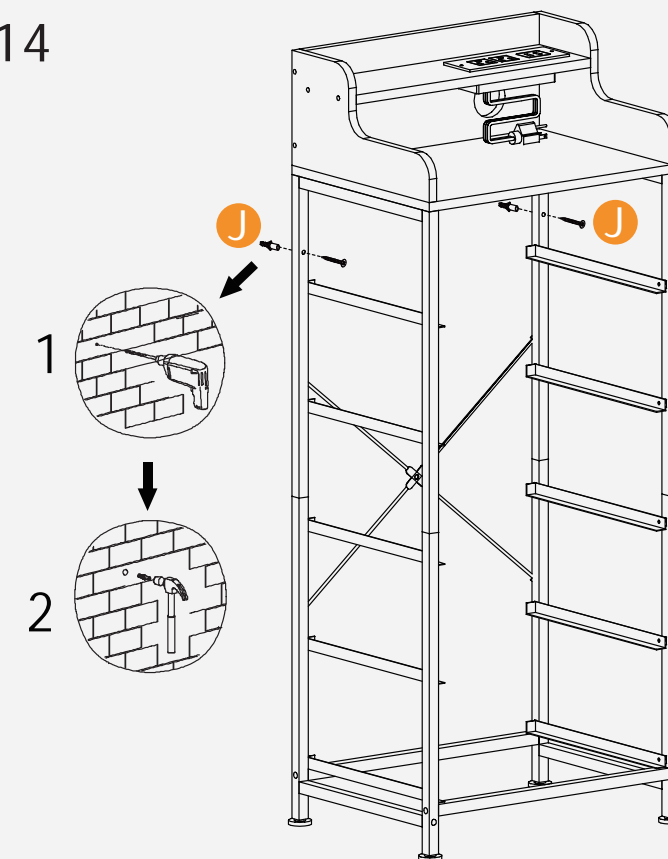

J		X1
---	--	----

## Assembly Instruction:



## More Options:



3-Drawers Rustic Nightstand 1PCS  
40X39X68cm  
15.75"X15.35"x26.77"



3-Drawers Rustic Nightstand 2PCS  
40X39X68cm  
15.75"X15.35"x26.77"



3-Drawers Nightstand 1PCS  
40X39X68cm



3-Drawers Nightstand 2PCS  
40X39X68cm



## More Options:



4-Drawers Rustic Dresser  
100X30X52cm  
39.37"X11.81"x20.47"



4-Drawers Rustic Nightstand  
55X30X67.5cm  
21.65"X11.81"x26.57"



8-Drawer Ladder Shapen Dresser  
95.5X29X106.5cm  
37.6"X11.4"x41.9"



10-Drawer Dresser  
100X30X98cm  
39.4"X11.8"x38.6"

## GENERAL GUIDELINES:

- Please read the following instructions carefully and use the product accordingly.
- Please keep this instruction and hand it over when you transfer the product.
- This summary may not include every detail of all variations and considered steps.
- Please contact us when further information and help are needed.

## NOTES:

- The product is intended for normal use only. The seller does not assume any responsibility or liability with respect to any damage caused by incorrect assembly or improper use.
- Keep away from exposure and heat sources. Place it in a dry area to avoid peeling or fading.
- Please check if there is any welding spatter or debris when you receive the product.
- If there are defective or missing parts after unpacking, please contact us immediately.
- Use soft cloth and neutral detergent to wipe it clean, then wipe dry. Do not use an abrasive agent to wipe the product.

## WARNINGS:

- During assembly, keep small parts out of the reach of children. It may be fatal if swallowed or inhaled.
- To avoid potential danger of suffocation, keep all parts and packaging (films, plastic bags and foam, etc.) away from babies and children.
- Keep away from sharp or corrosive items to avoid potential product damage or bodily injury.