

Bed Frame

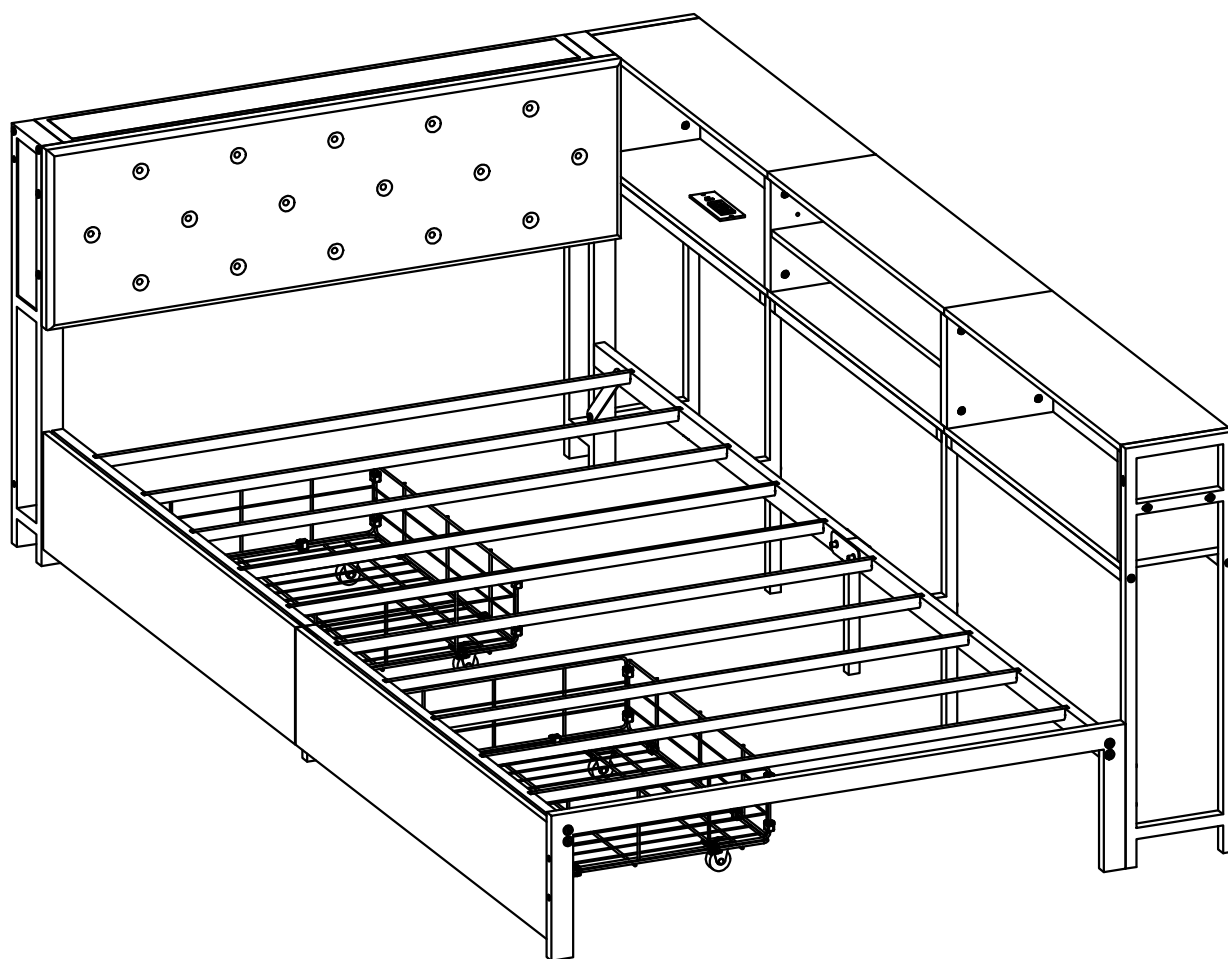

PRODUCT GUIDE AND INSTALLATION MANUAL

Parts List:

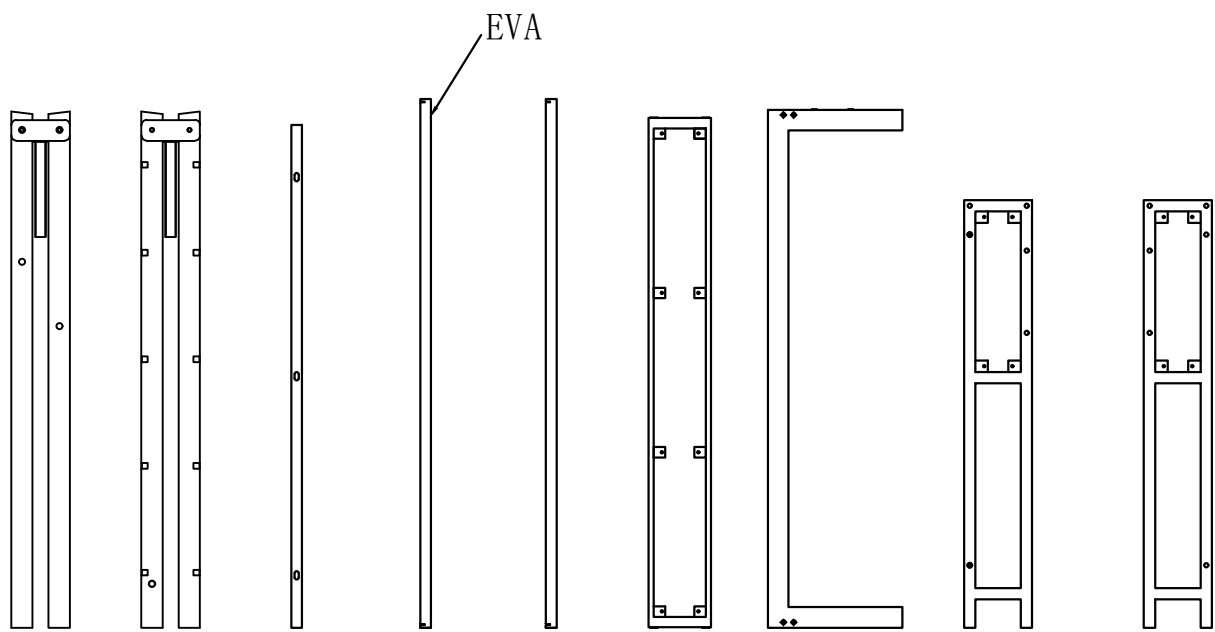

A1	A2	B	B1	B2	C1	C2	D1	D2
1pcs	1pcs	2pcs	4pcs	6pcs	1pcs	1pcs	1pcs	1pcs

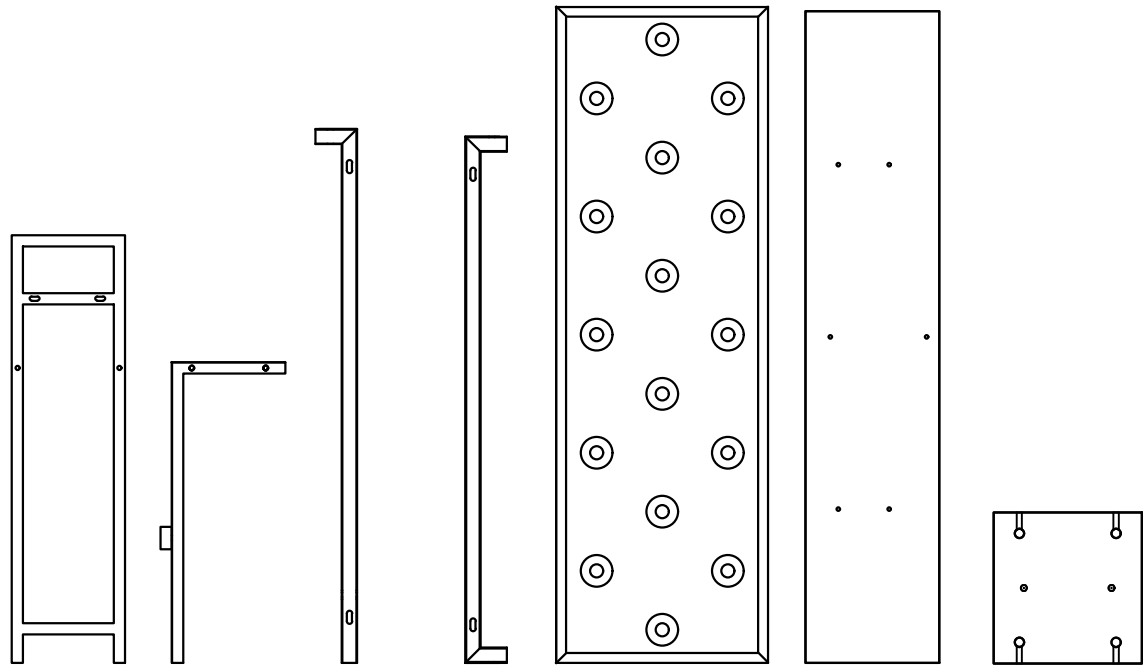

E1	E2	F	F1	H1	H2	I
2pcs	2pcs	4pcs	2pcs	1pcs	2pcs	2pcs

Parts List:

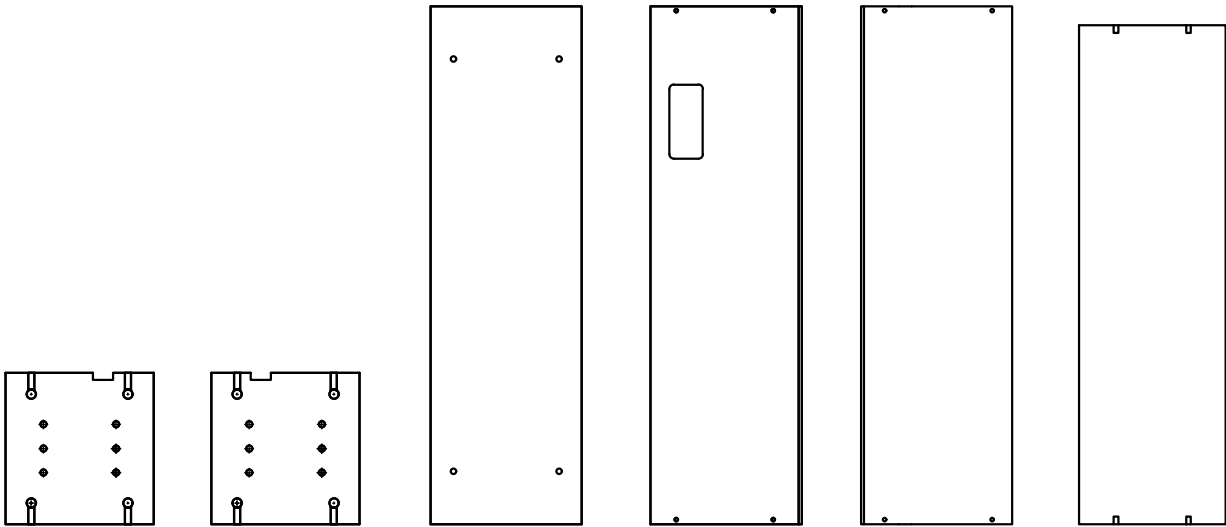

I1	I2	K	K1	K2	K3
1pcs	1pcs	2pcs	1pcs	3pcs	1pcs

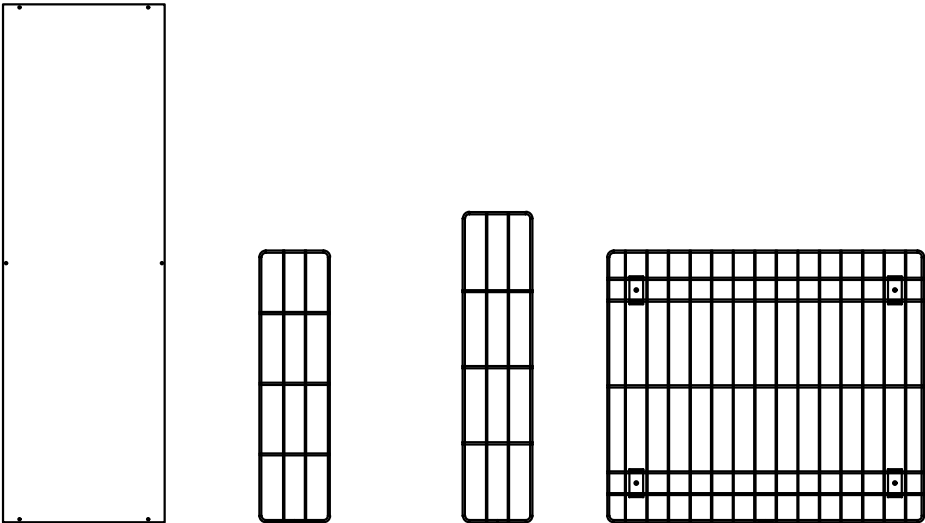

L	T	T1	T2
3pcs	4pcs	2pcs	2pcs

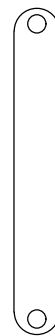
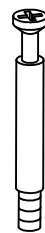
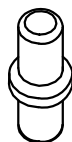

O	P	R	V	V1	V2	V3
1pcs	1pcs	1pcs	4pcs	24pcs	24pcs	2pcs

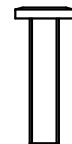

Z1	Z2	Z3	Z4	Z5	Z6	Z7	Z8	Z9
2pcs	10pcs	22pcs	8pcs	14pcs	24pcs	8pcs	4pcs	8pcs
M6x10mm	M6x10mm	M6x30mm	M6x35mm	M6x55mm	M3x10mm	M8x35mm	M8x15mm	M4x6mm

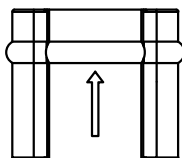
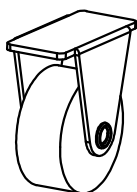

U	Q
8 pcs	20 pcs

ASSEMBLY

Step 1

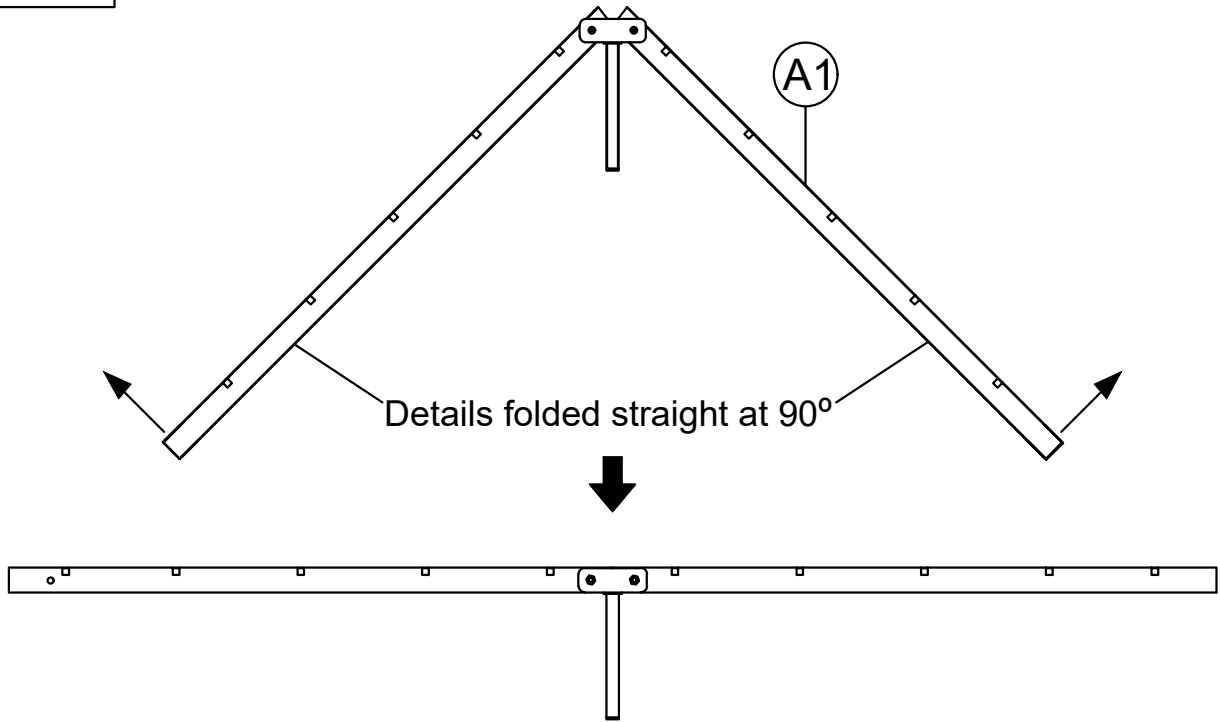

Step 2

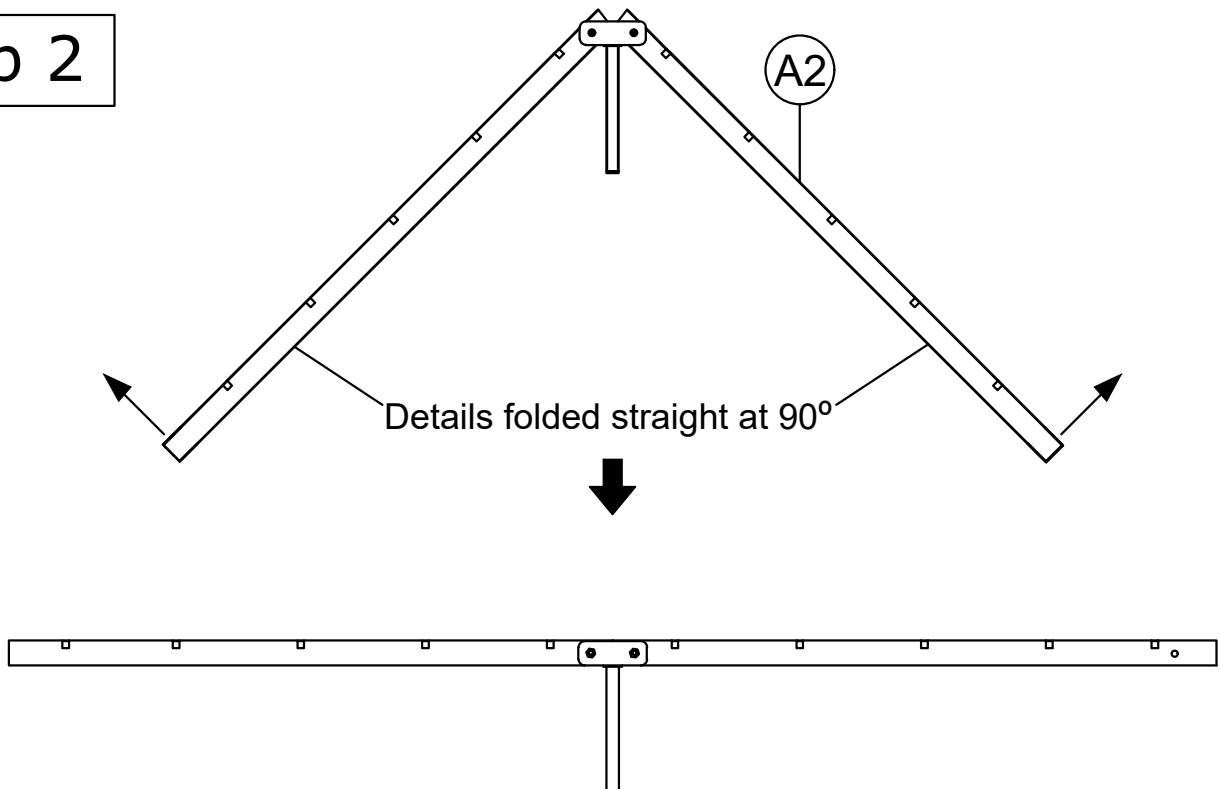

Step 3

Z7	04pcs
Z5	04pcs

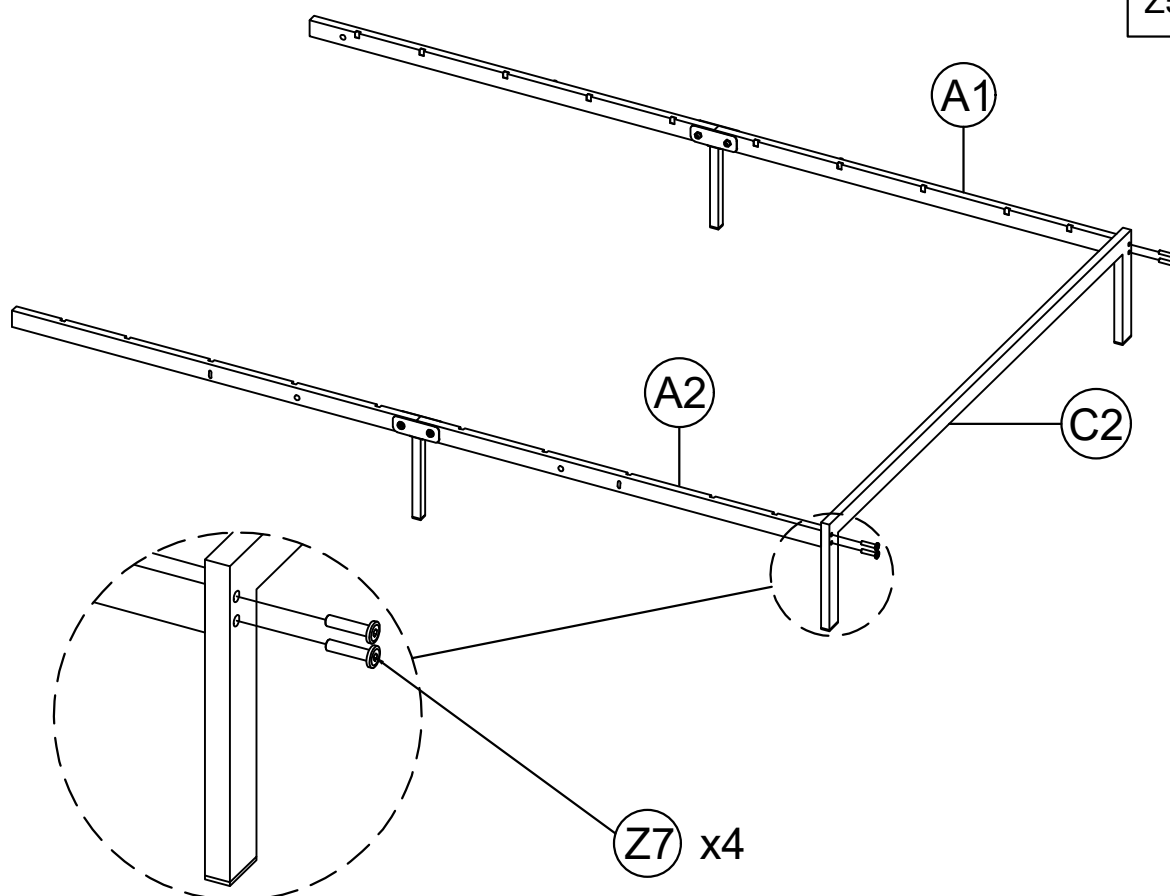

Step 4

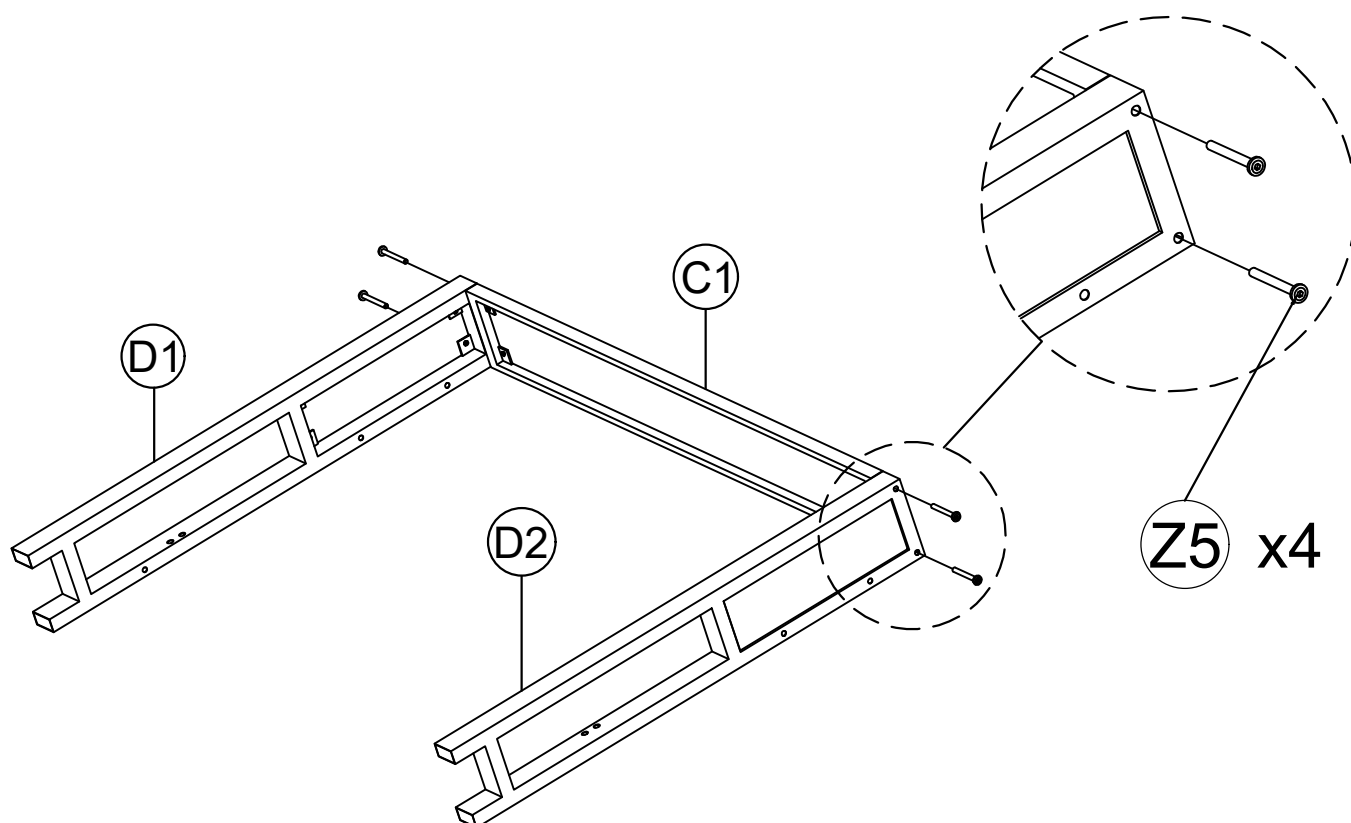

Step 5

Z3	06pcs
Z5	04pcs

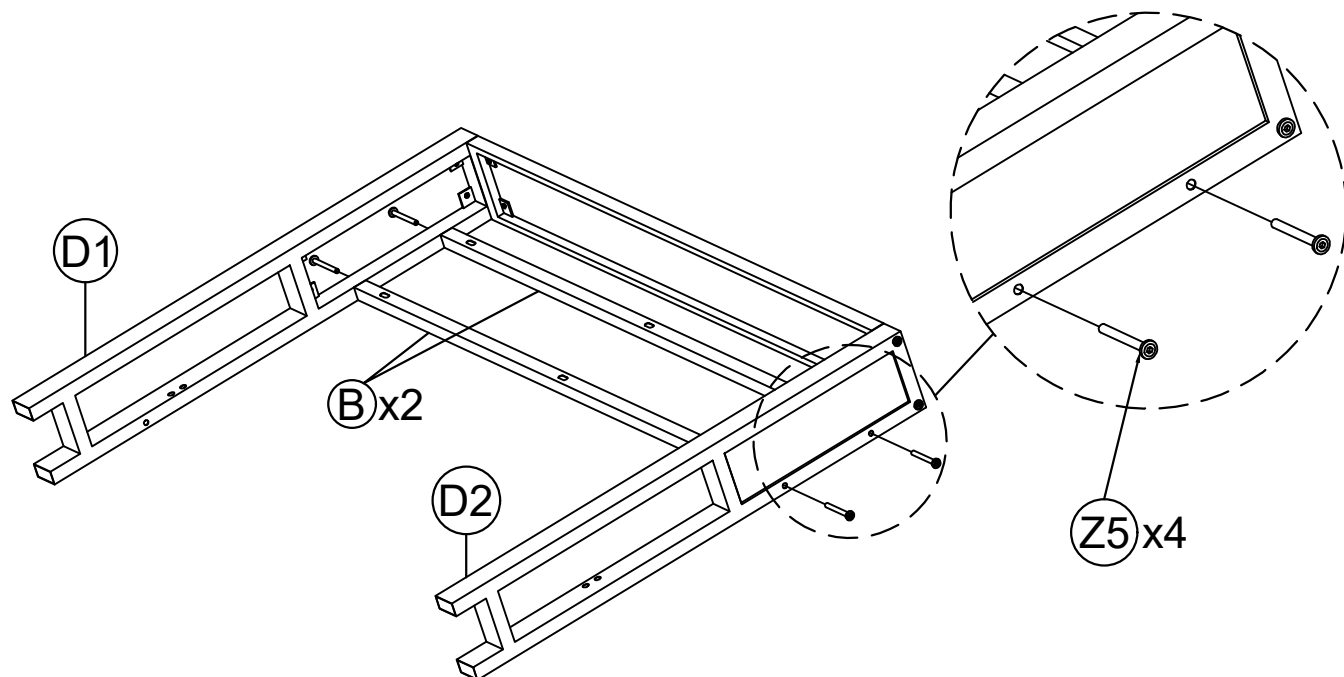

Step 6

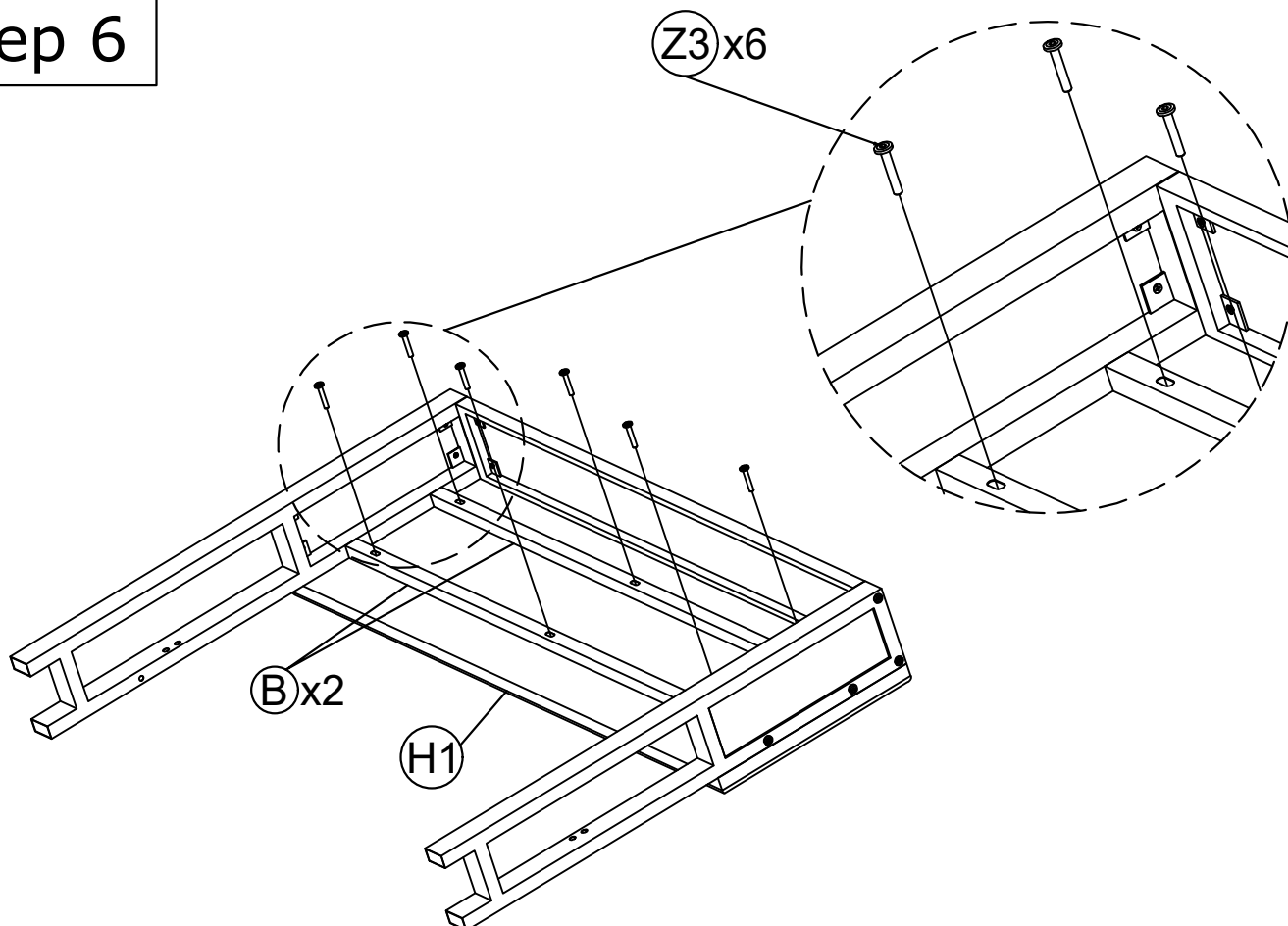

Step 7

Z4	02pcs
Z7	04pcs
Z8	04pcs

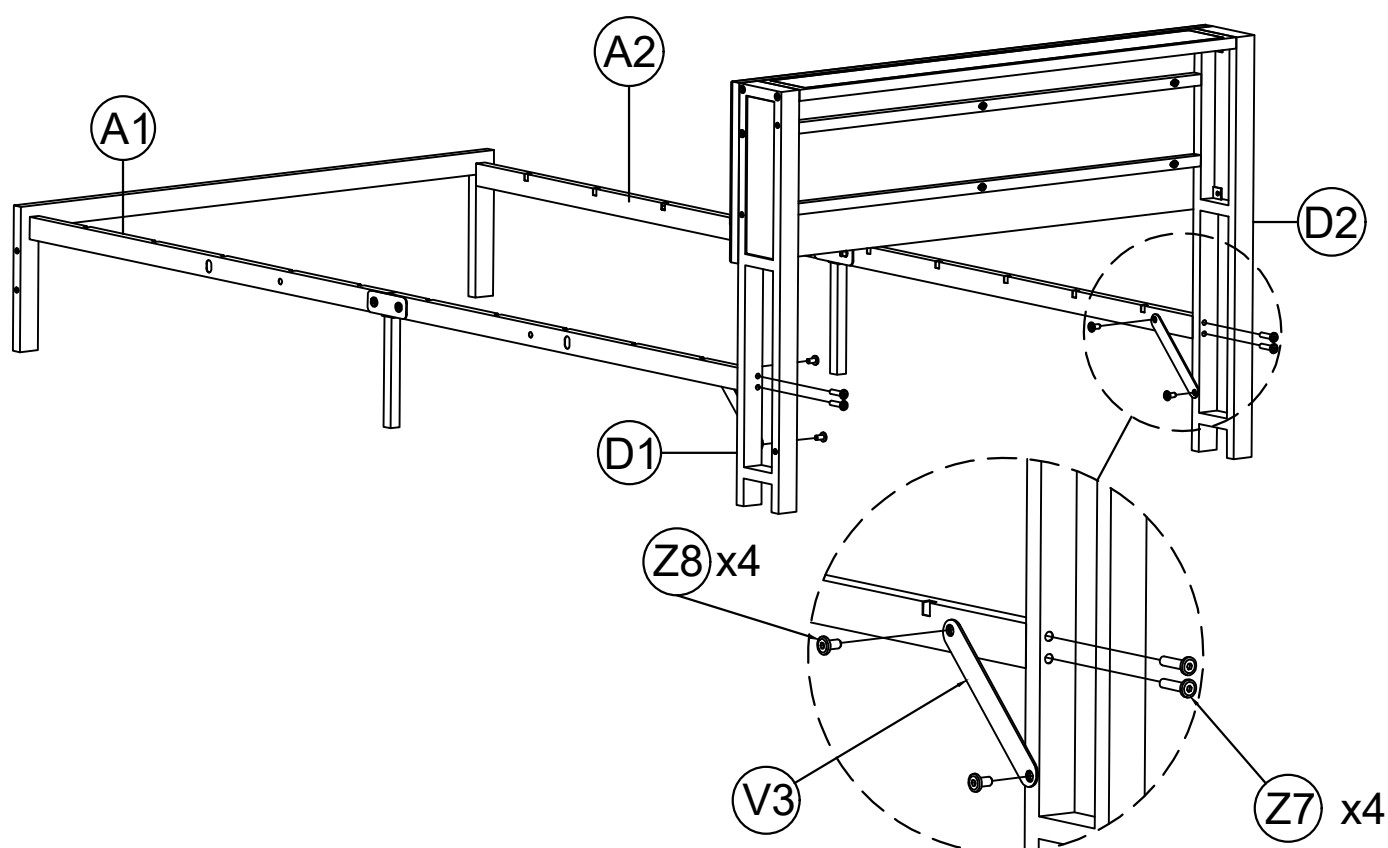

Step 8

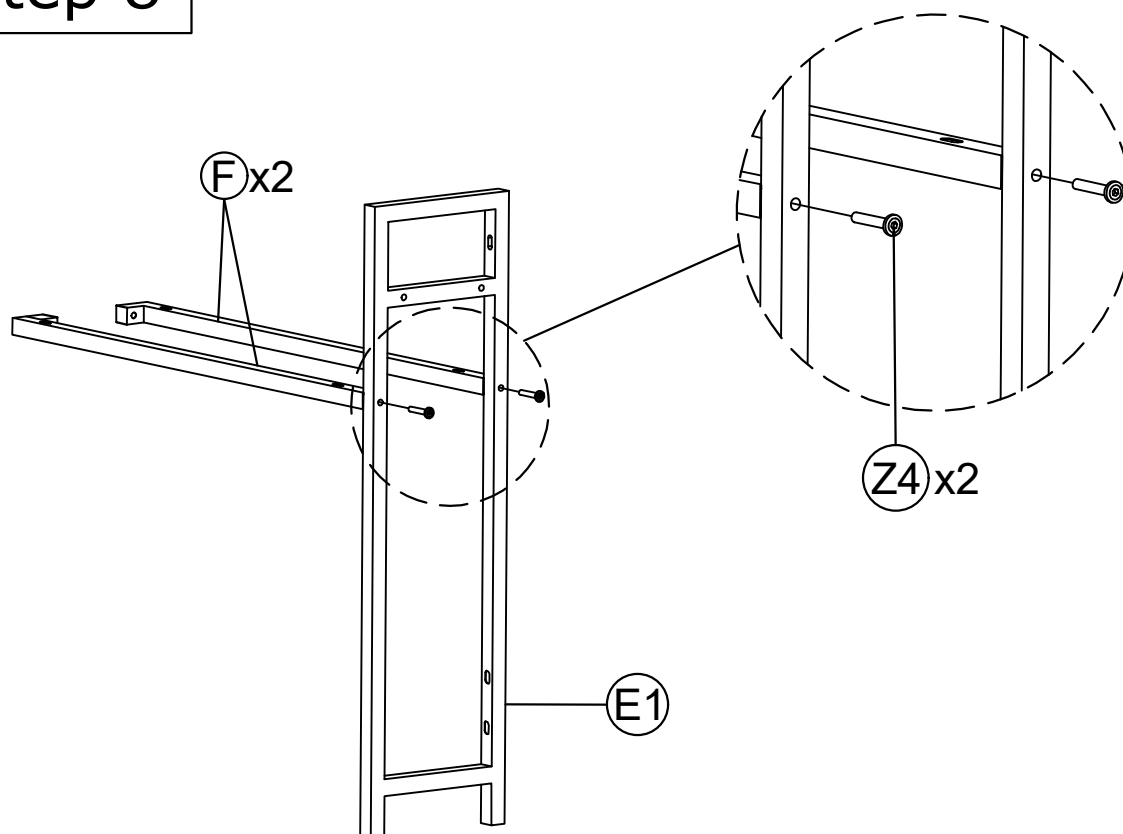

Step 9

Z5

04pcs

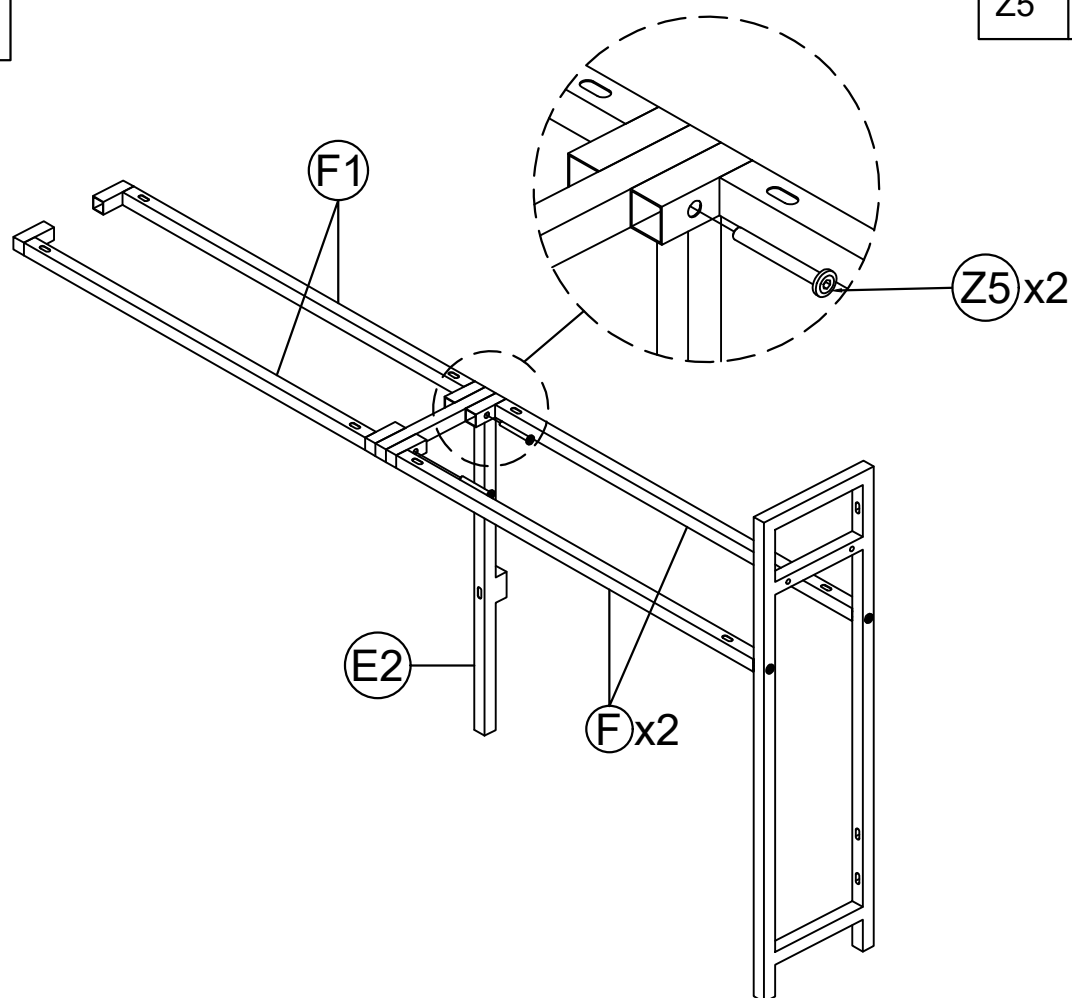

Step 10

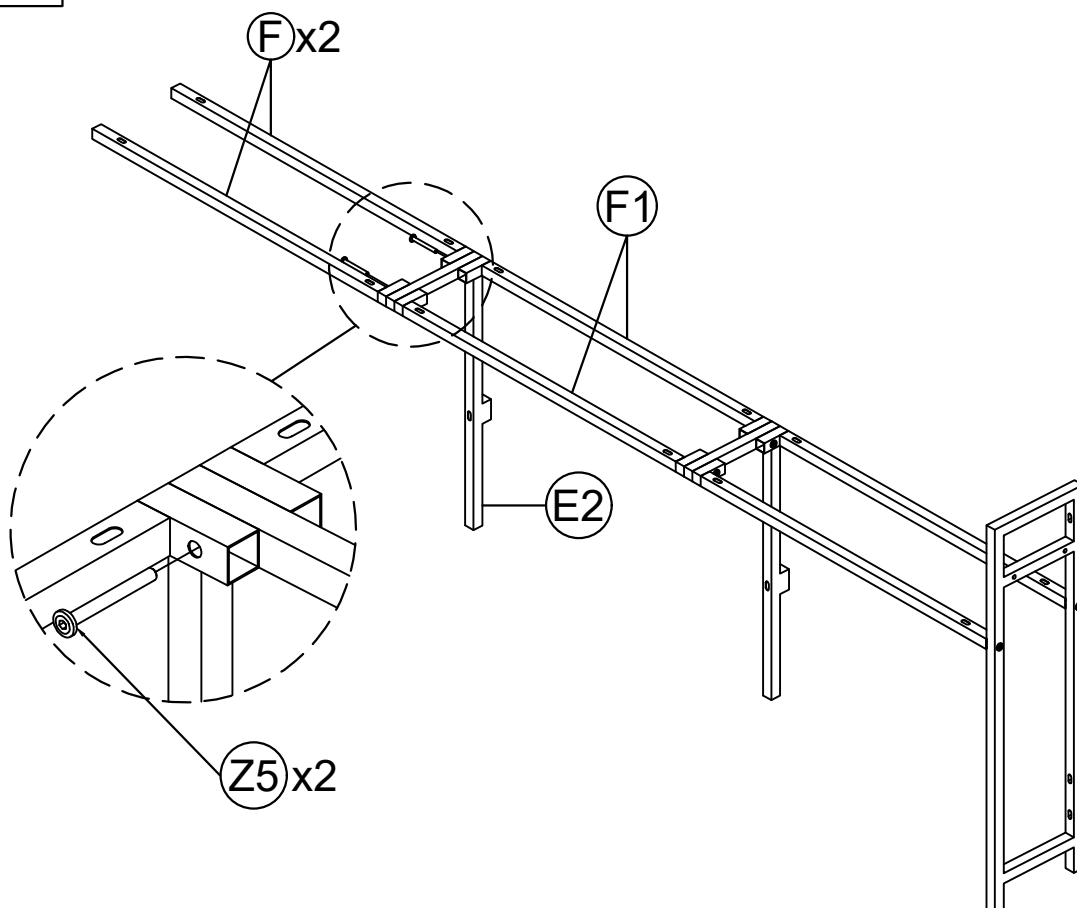

Step 11

Z3	04pcs
Z4	02pcs

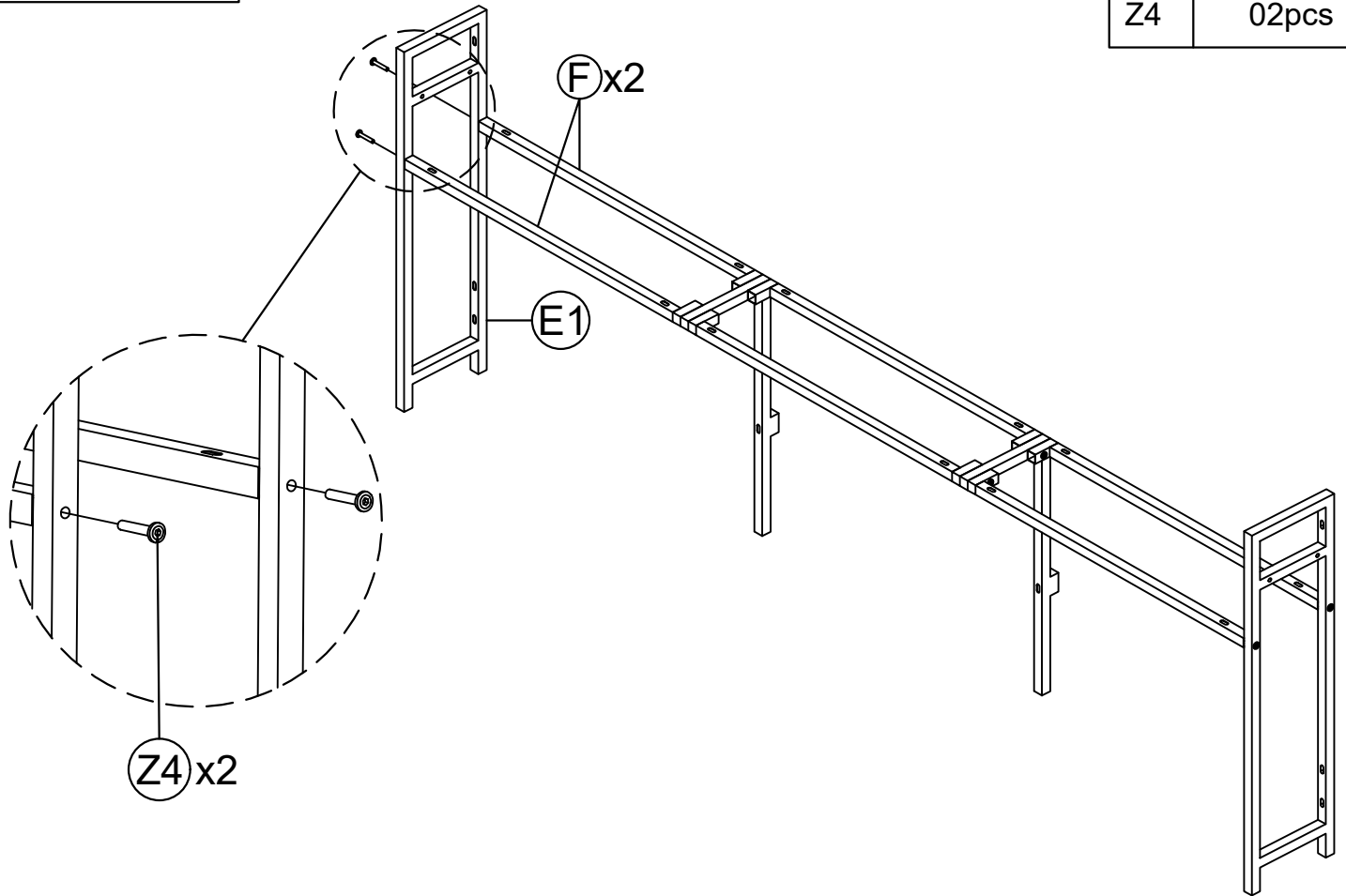

Step 12

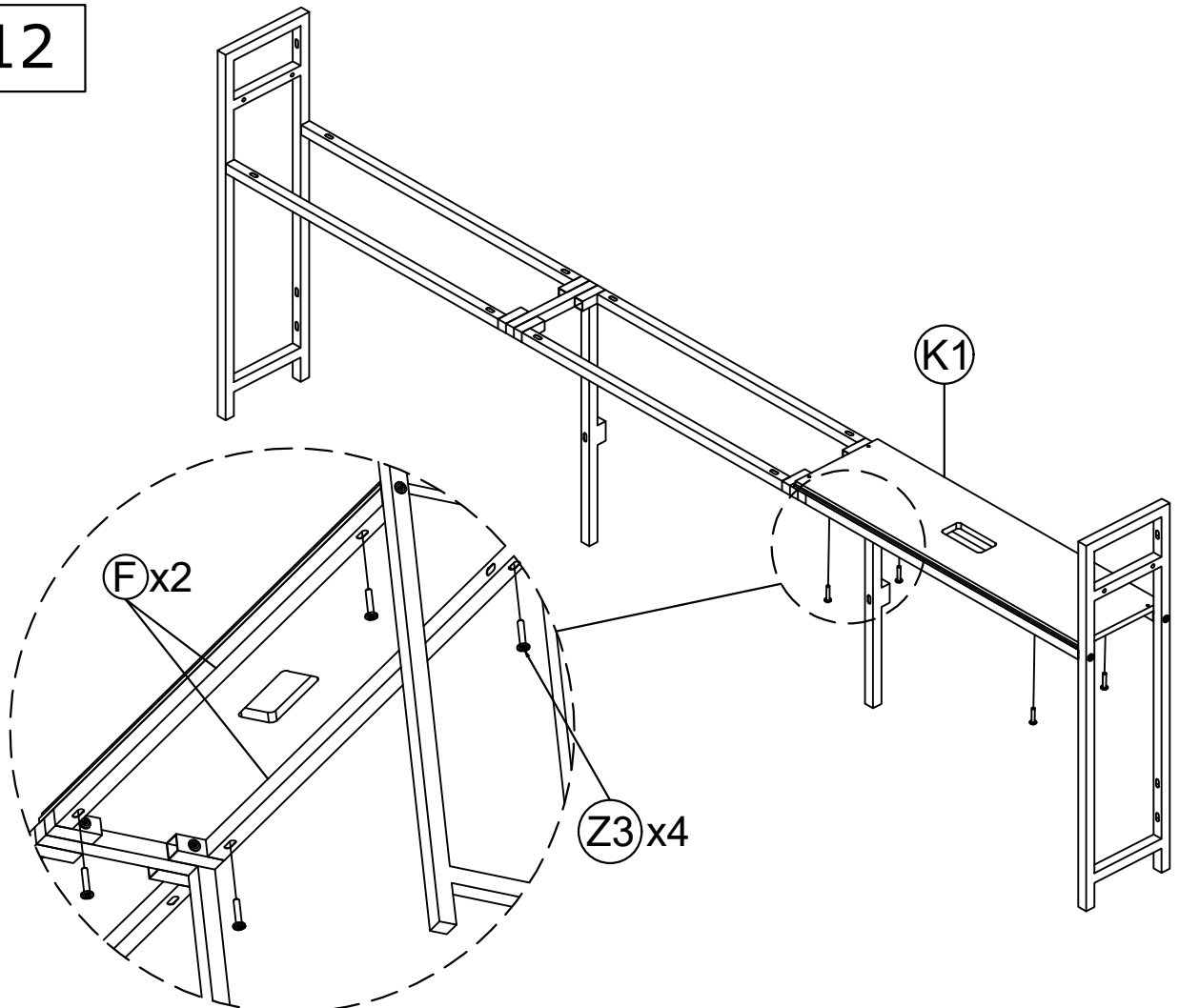

Step 13

Z3	04pcs
Z6	02pcs

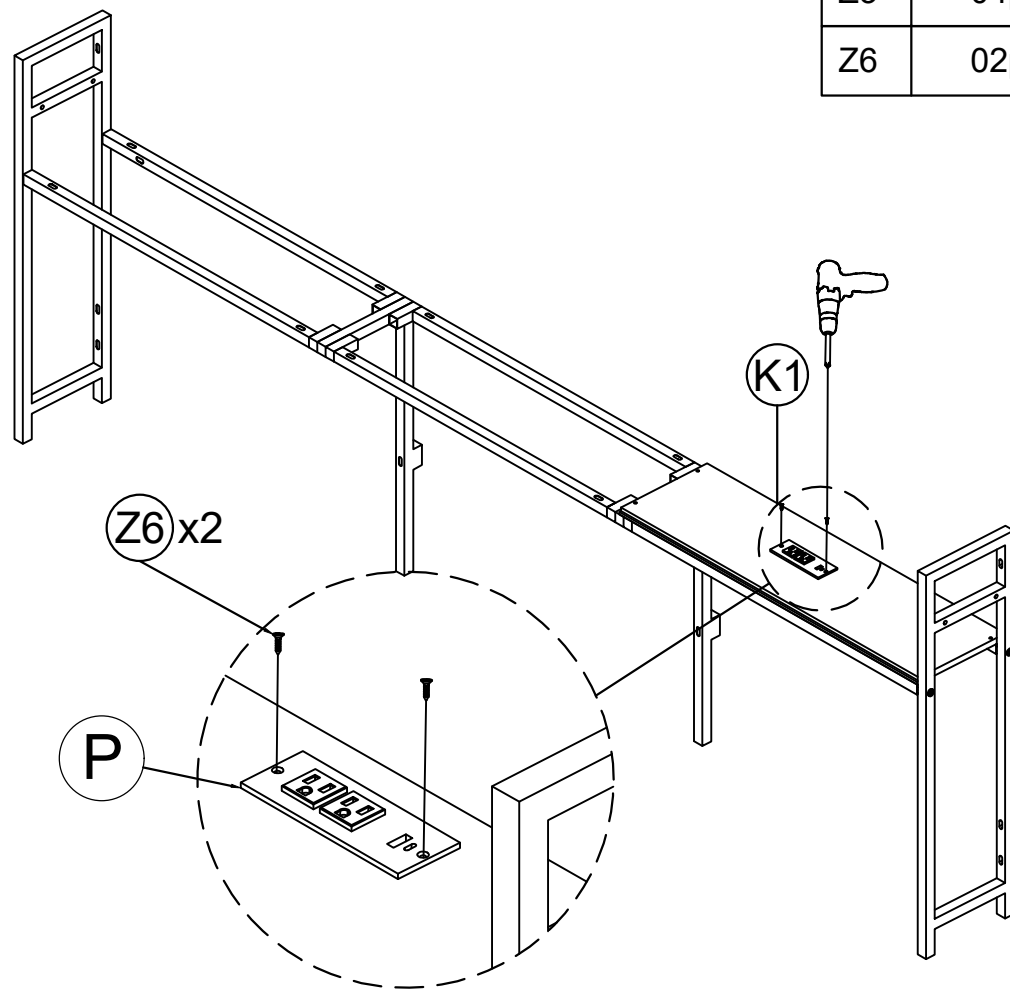

Step 14

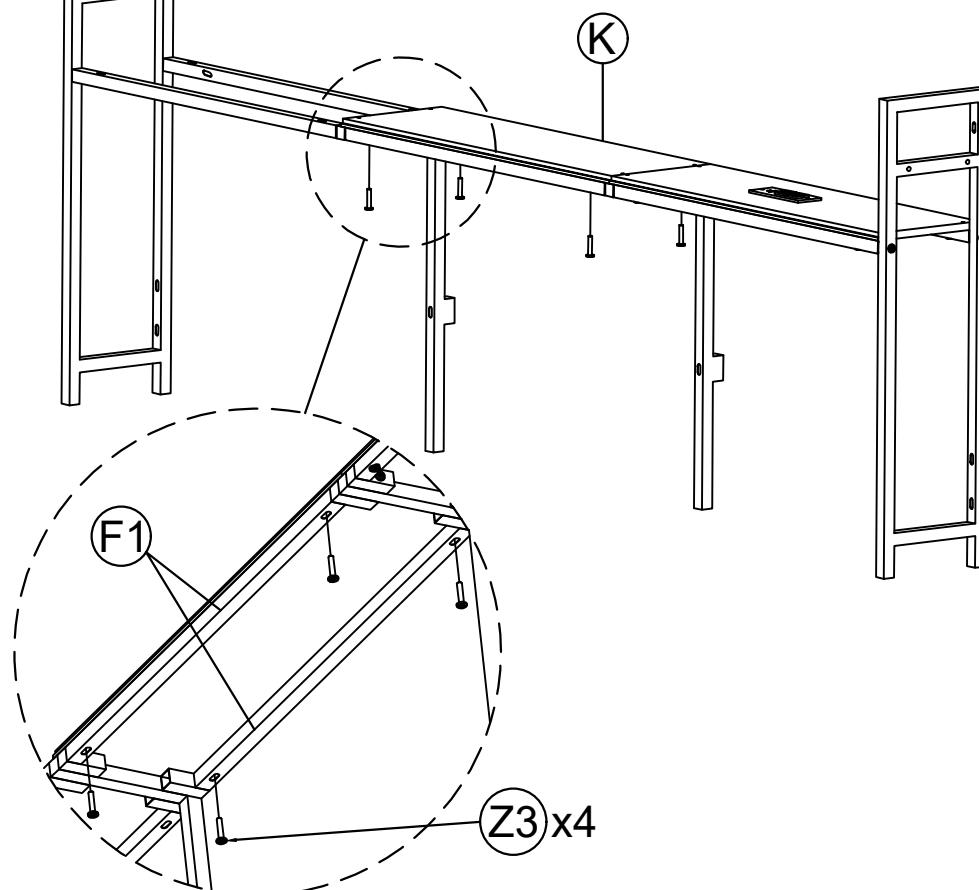

Step 15

Z3	04pcs
V2	12pcs

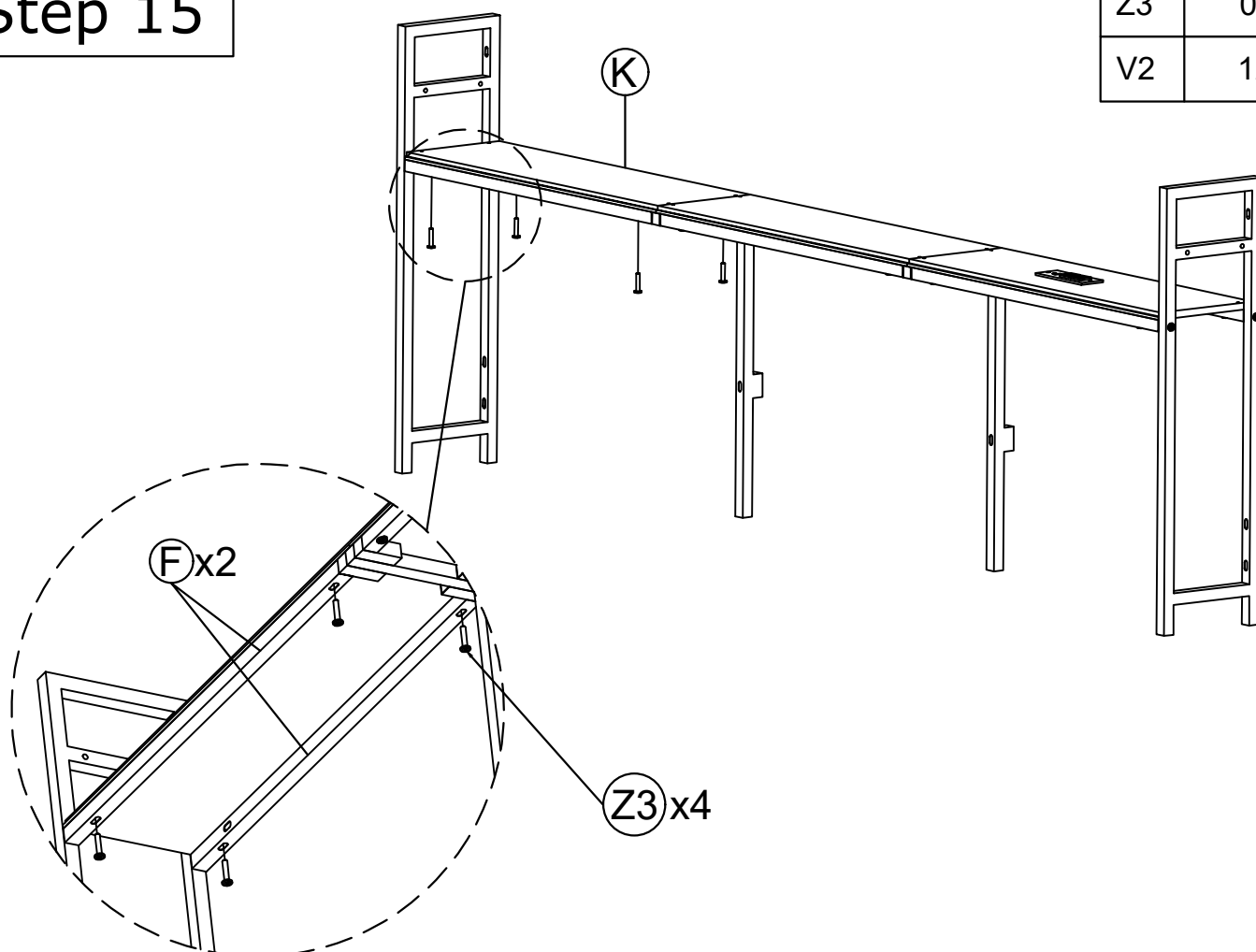

Step 16

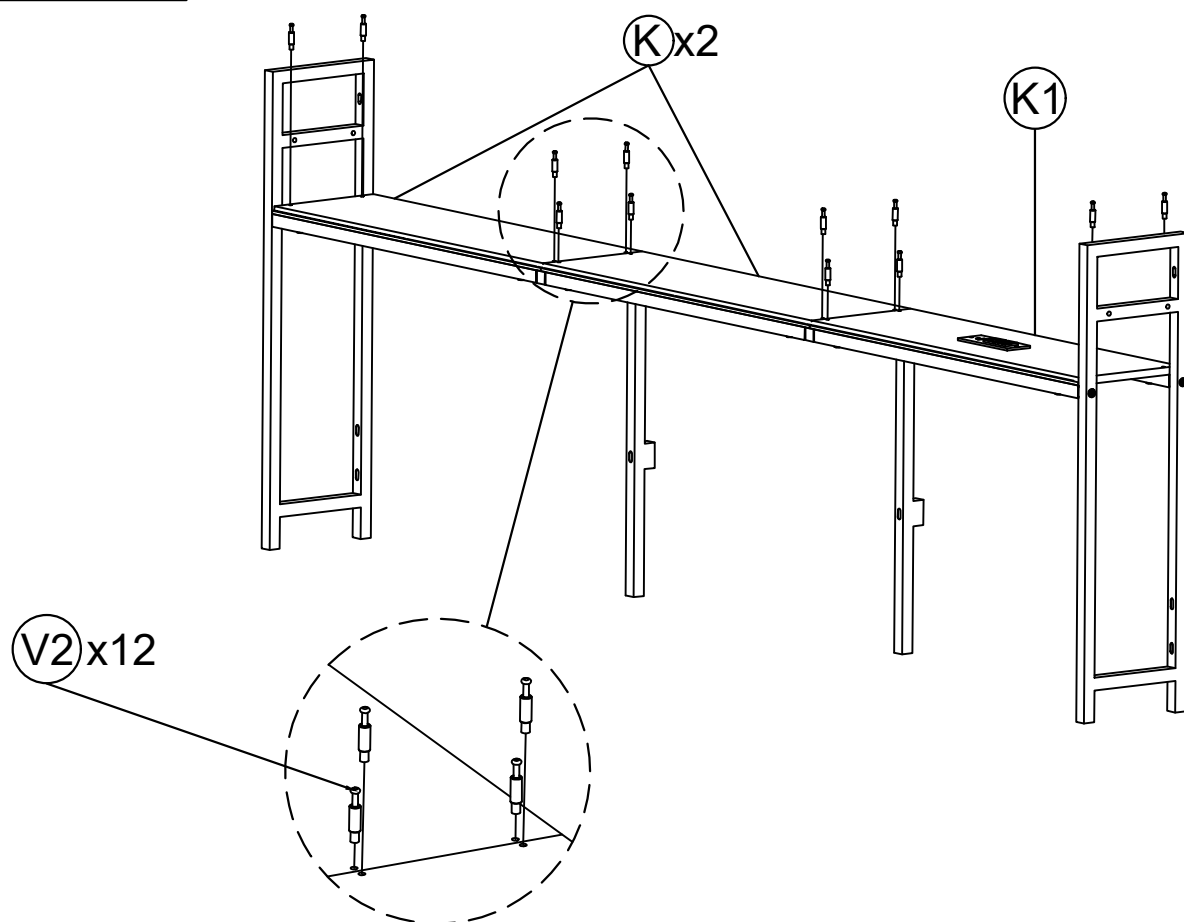

Step 17

V	04pcs
V1	12pcs

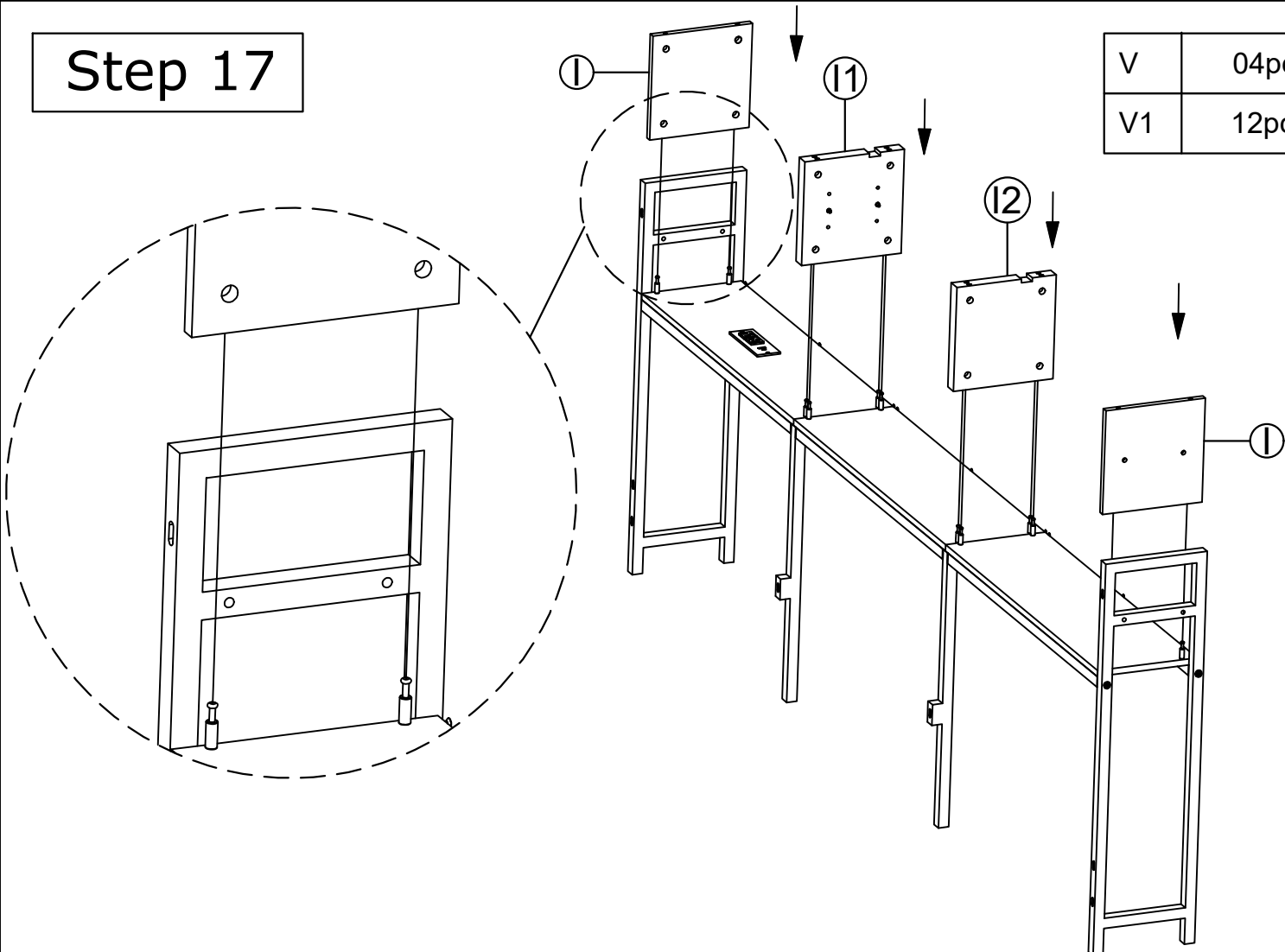

Step 18

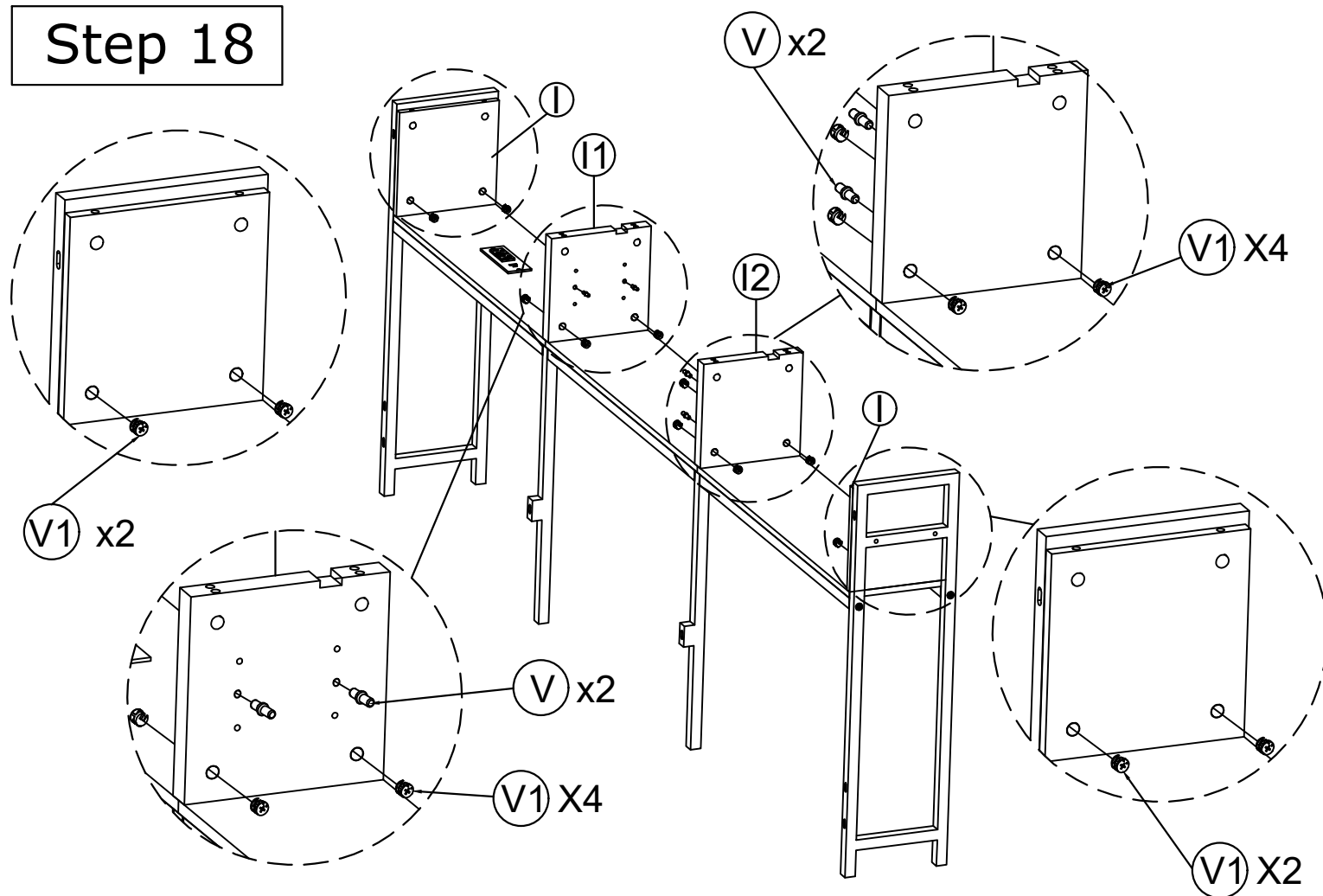

Step 19

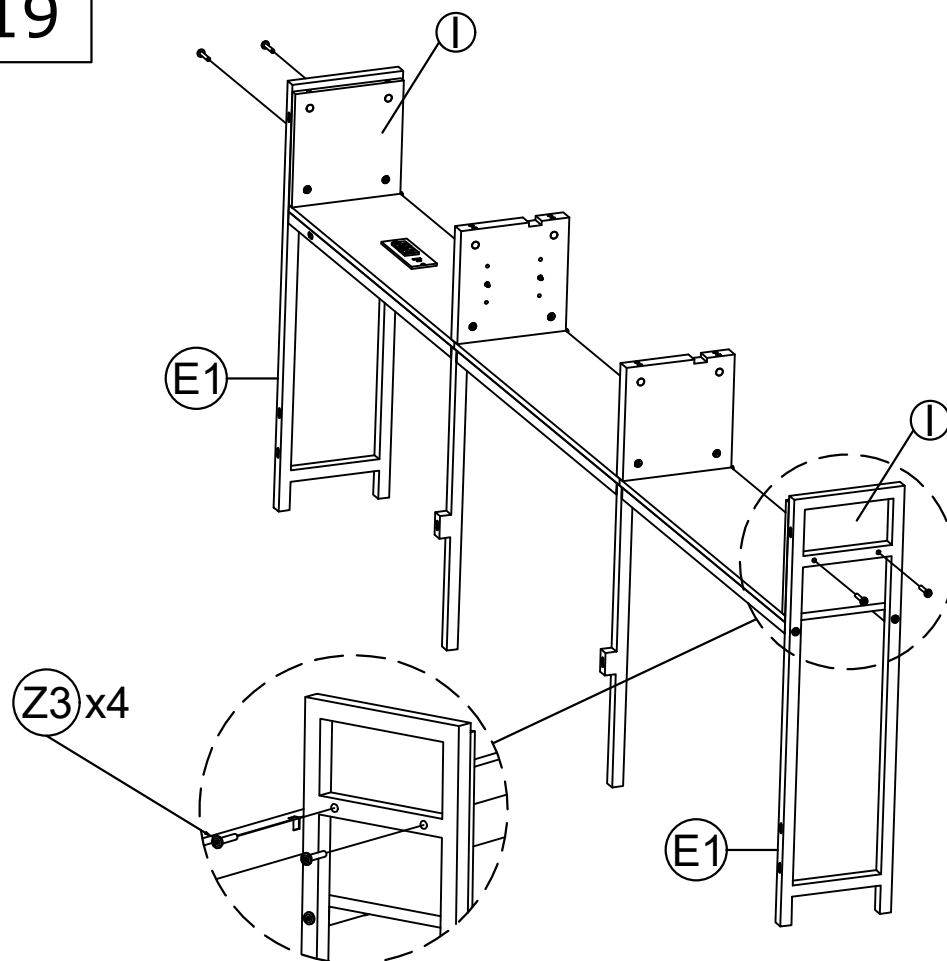

Z3	04pcs
V2	12pcs

Step 20

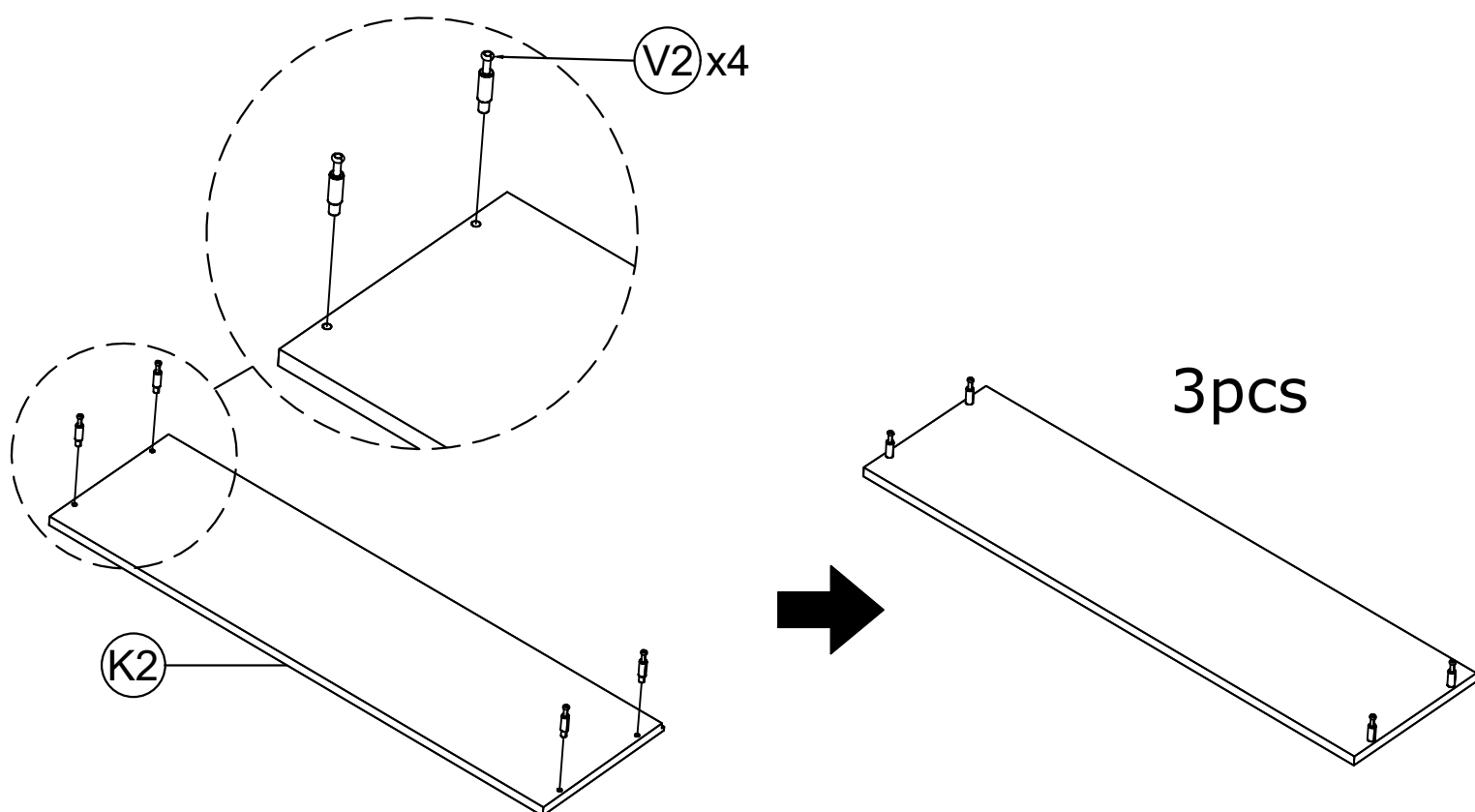

Step 21

Z6

04pcs

REMOVE GLUE AND PUT THE LED LIGHT ON THE WOOD

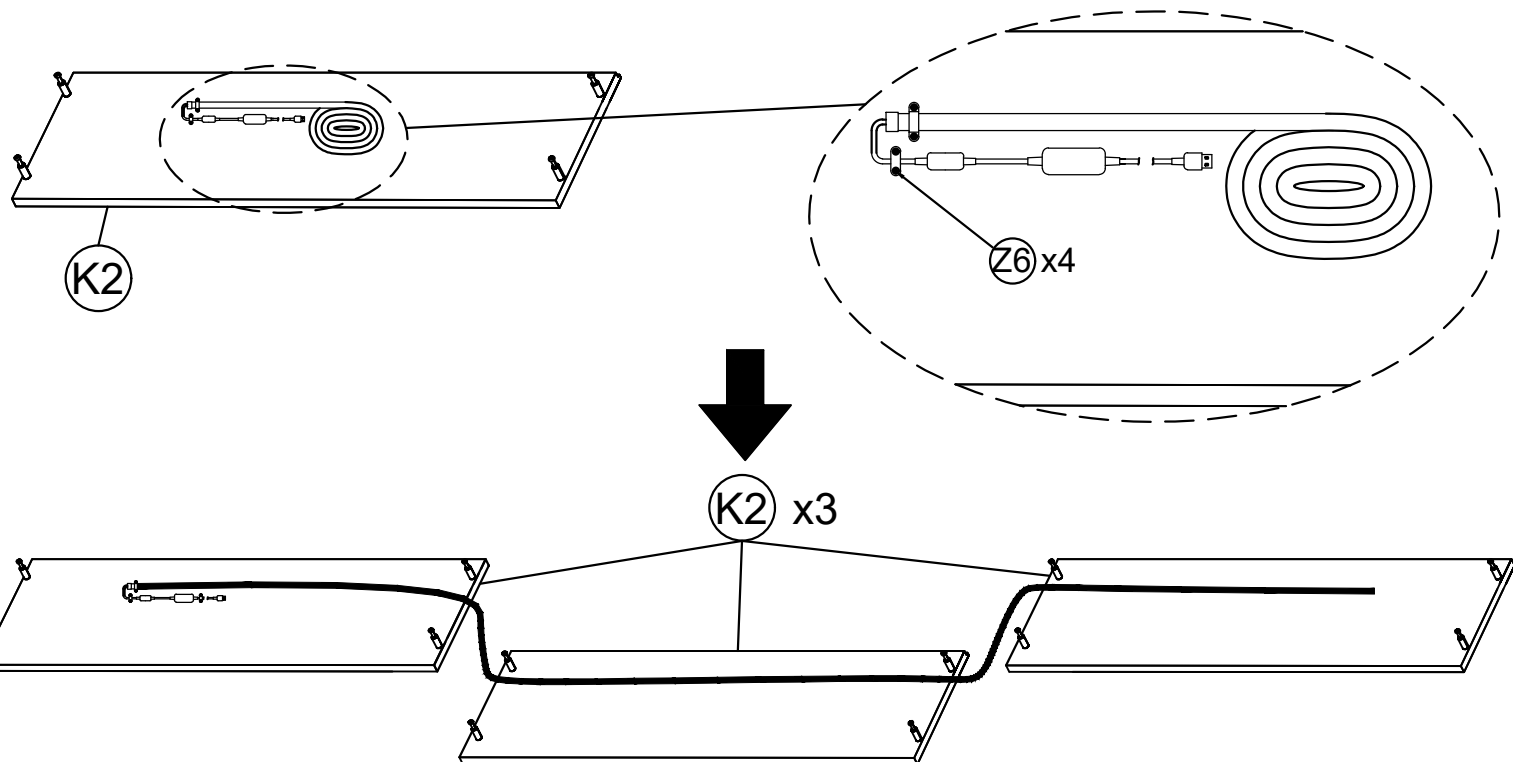

Step 22

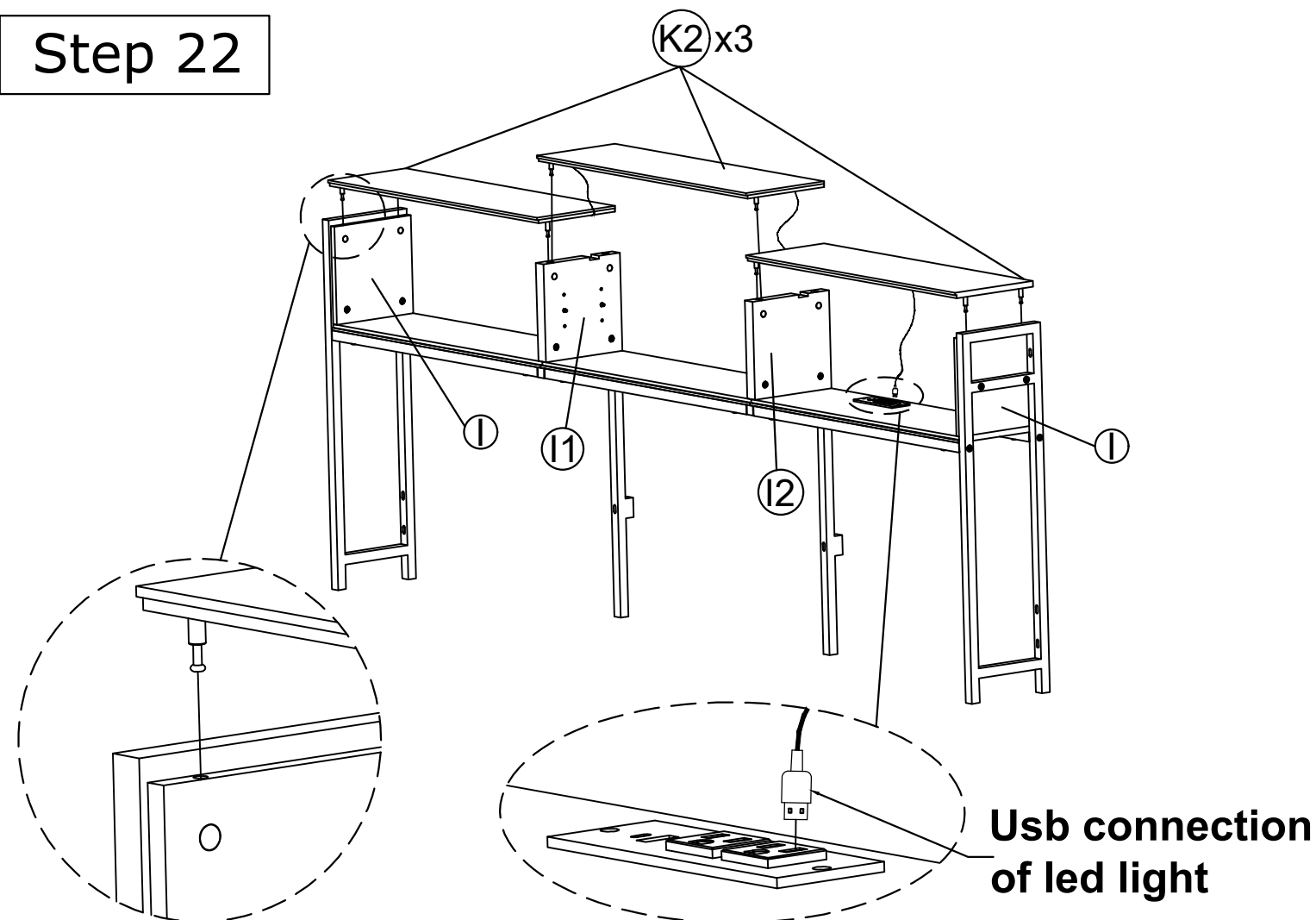

Step 23

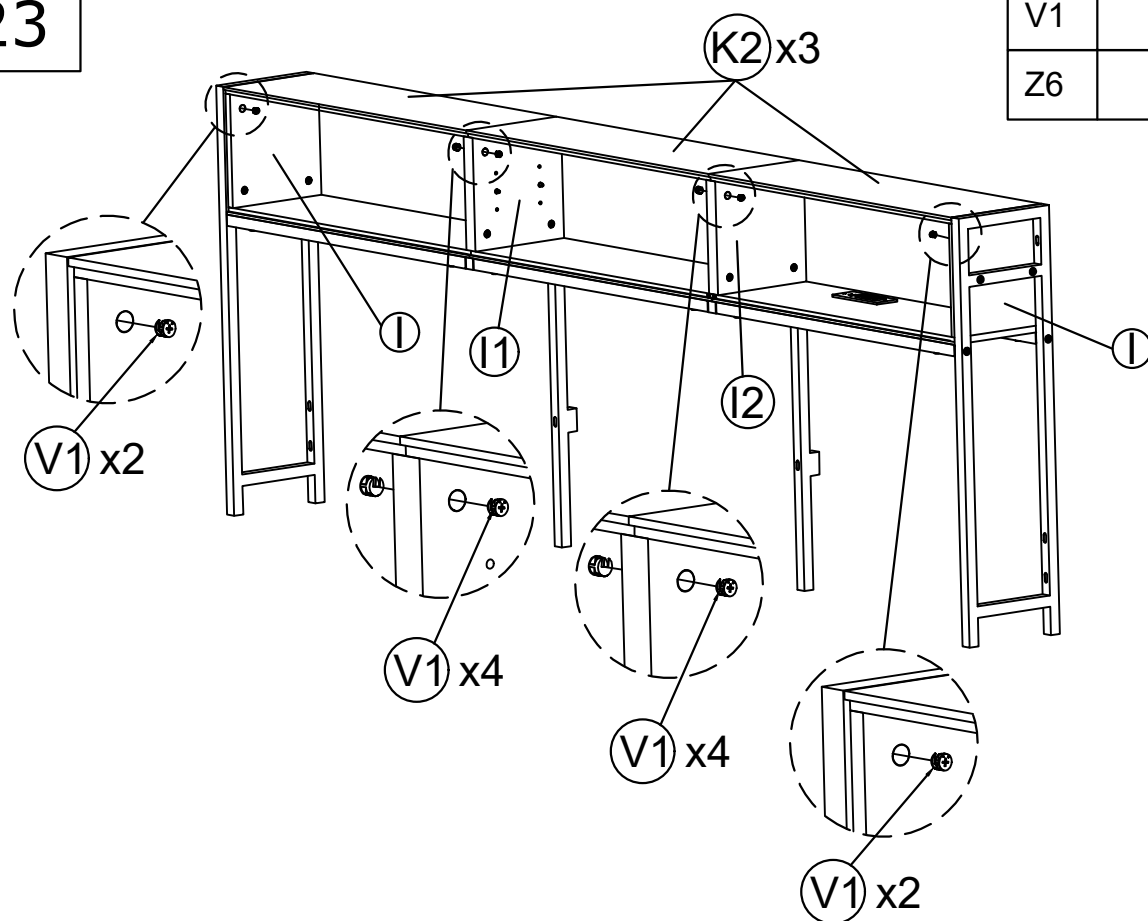

V1	12pcs
Z6	18pcs

Step 24

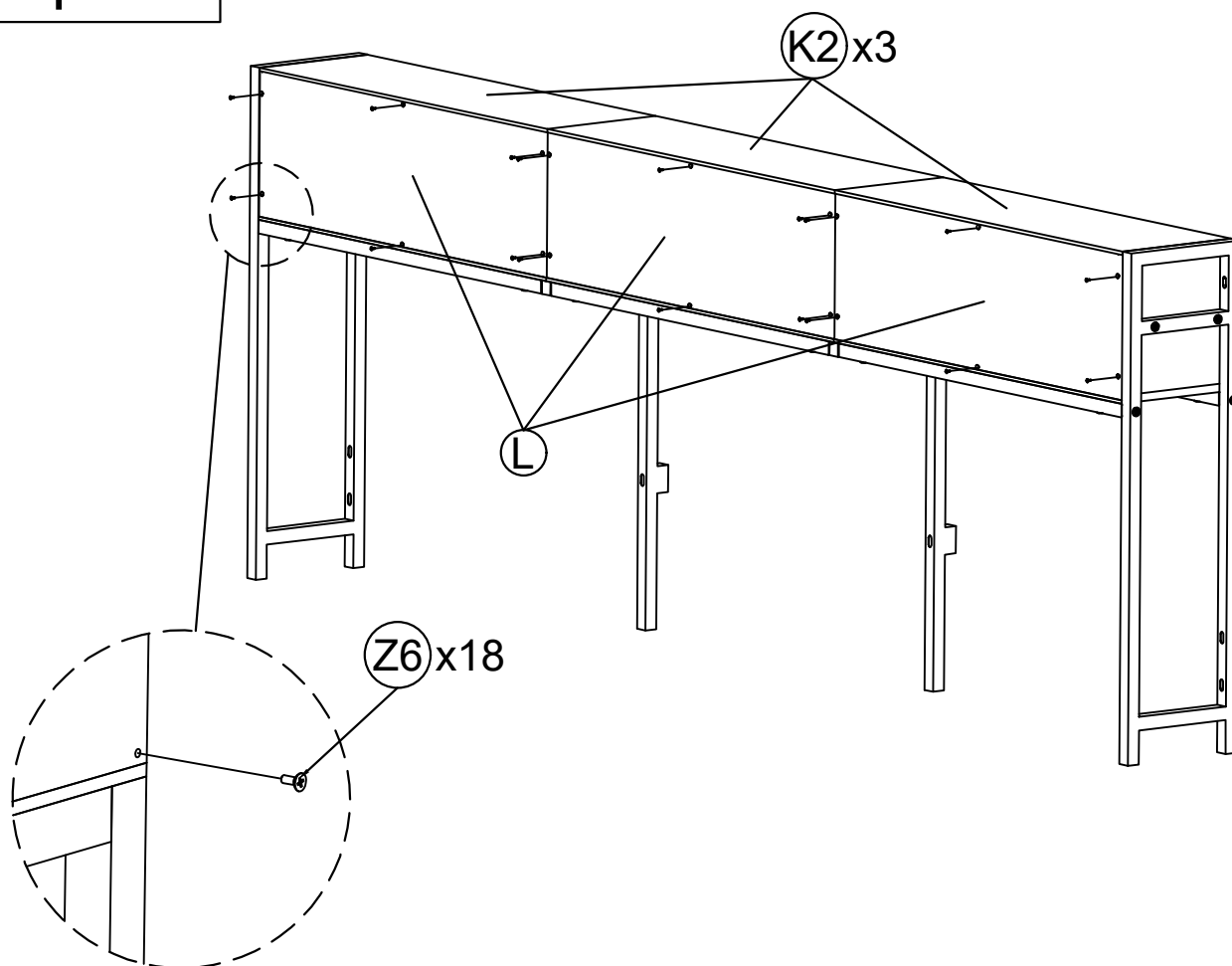

Step 25

Z4	04pcs
Z5	02pcs

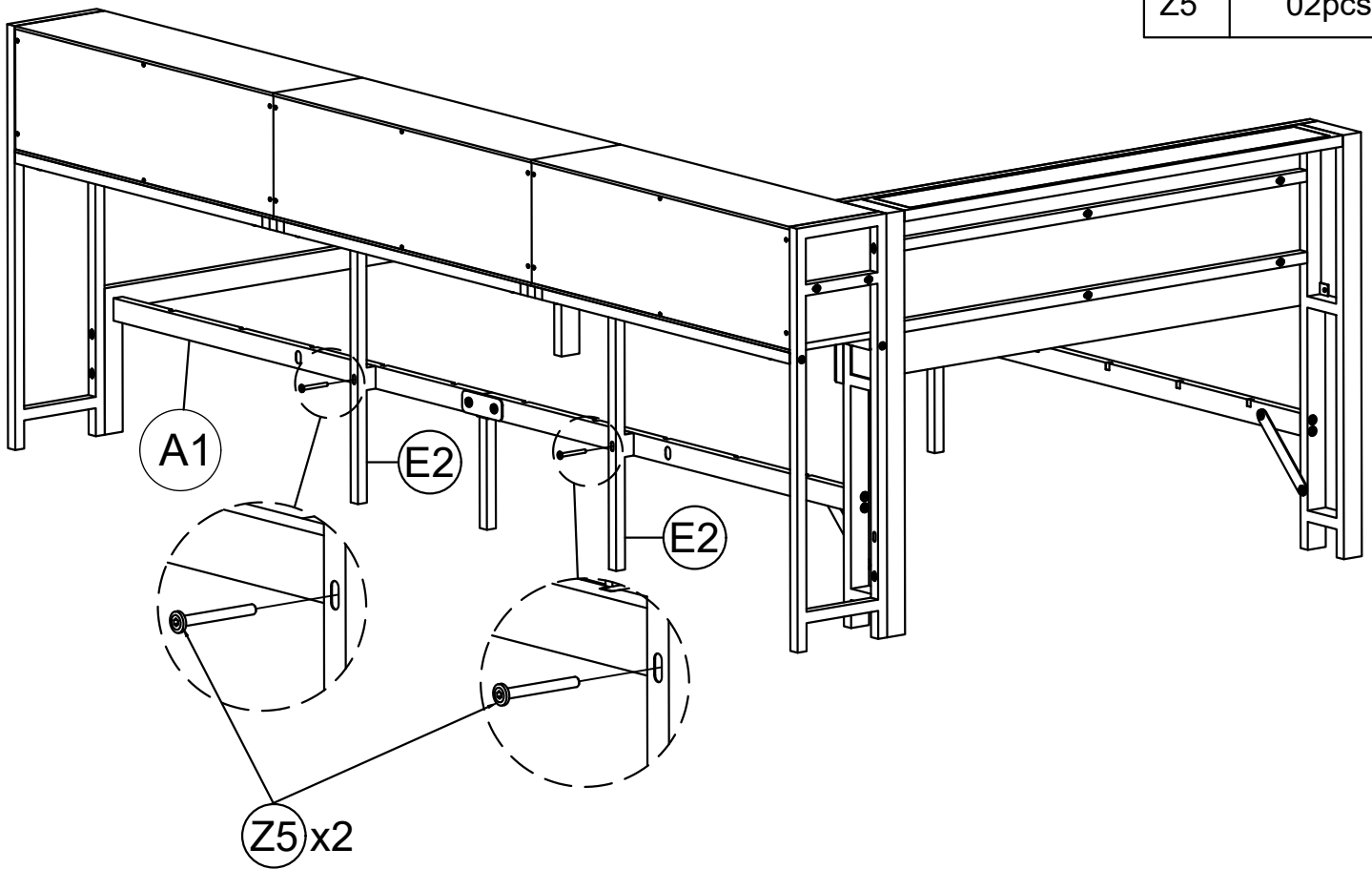

Step 26

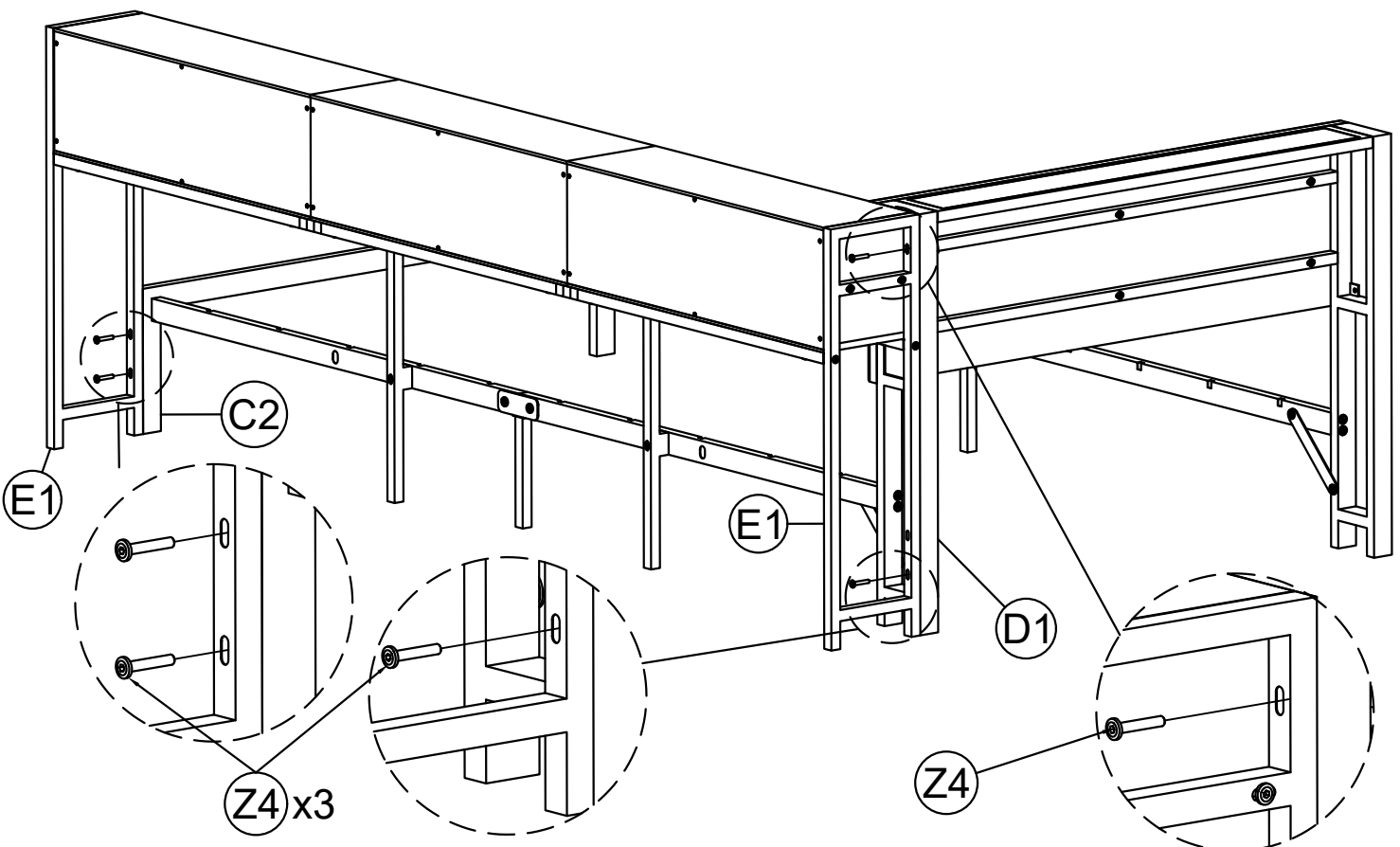

Step 27

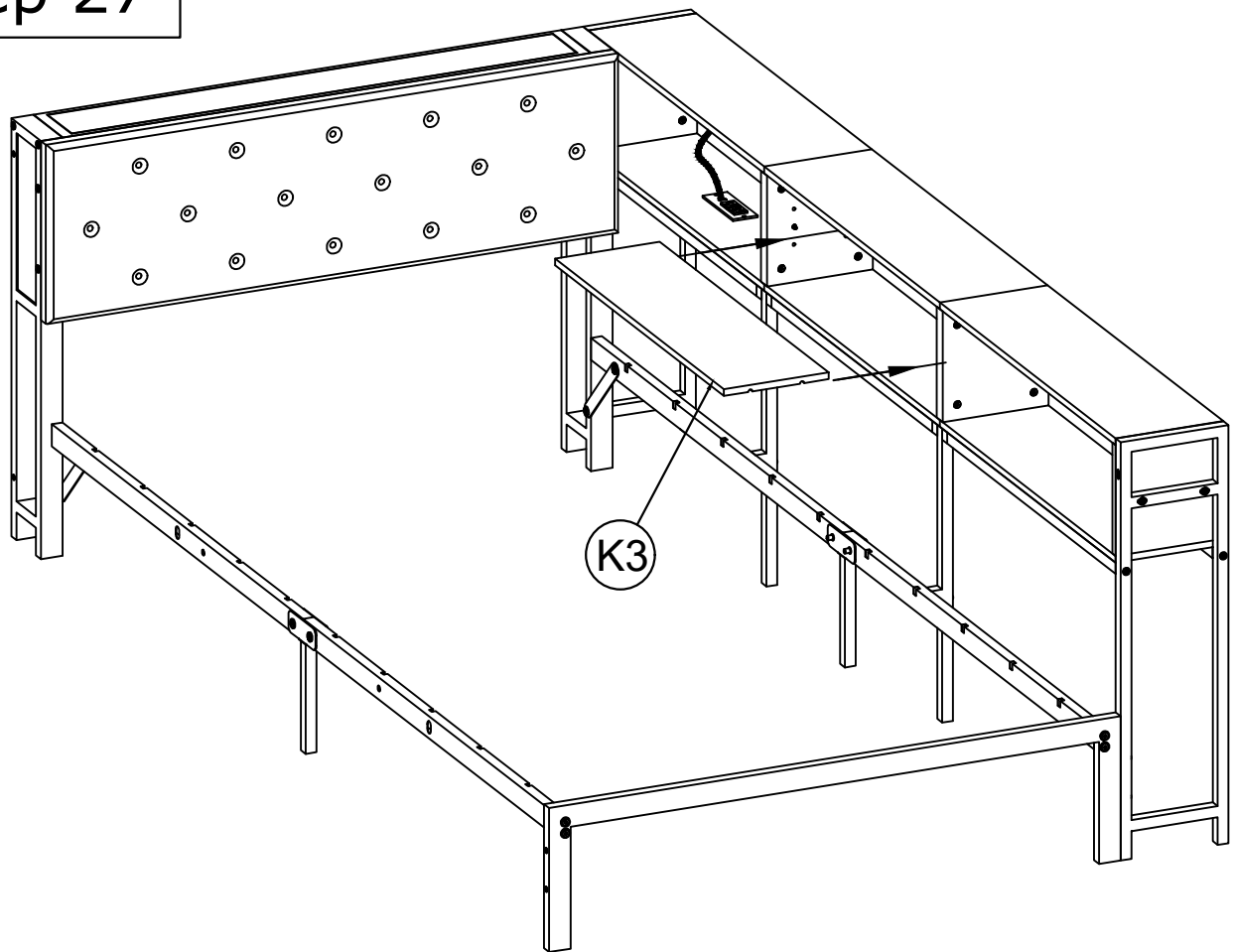

Step 28

Option 1

Power outlet at the head of the bed when the cabinet is installed on the right side of the bed

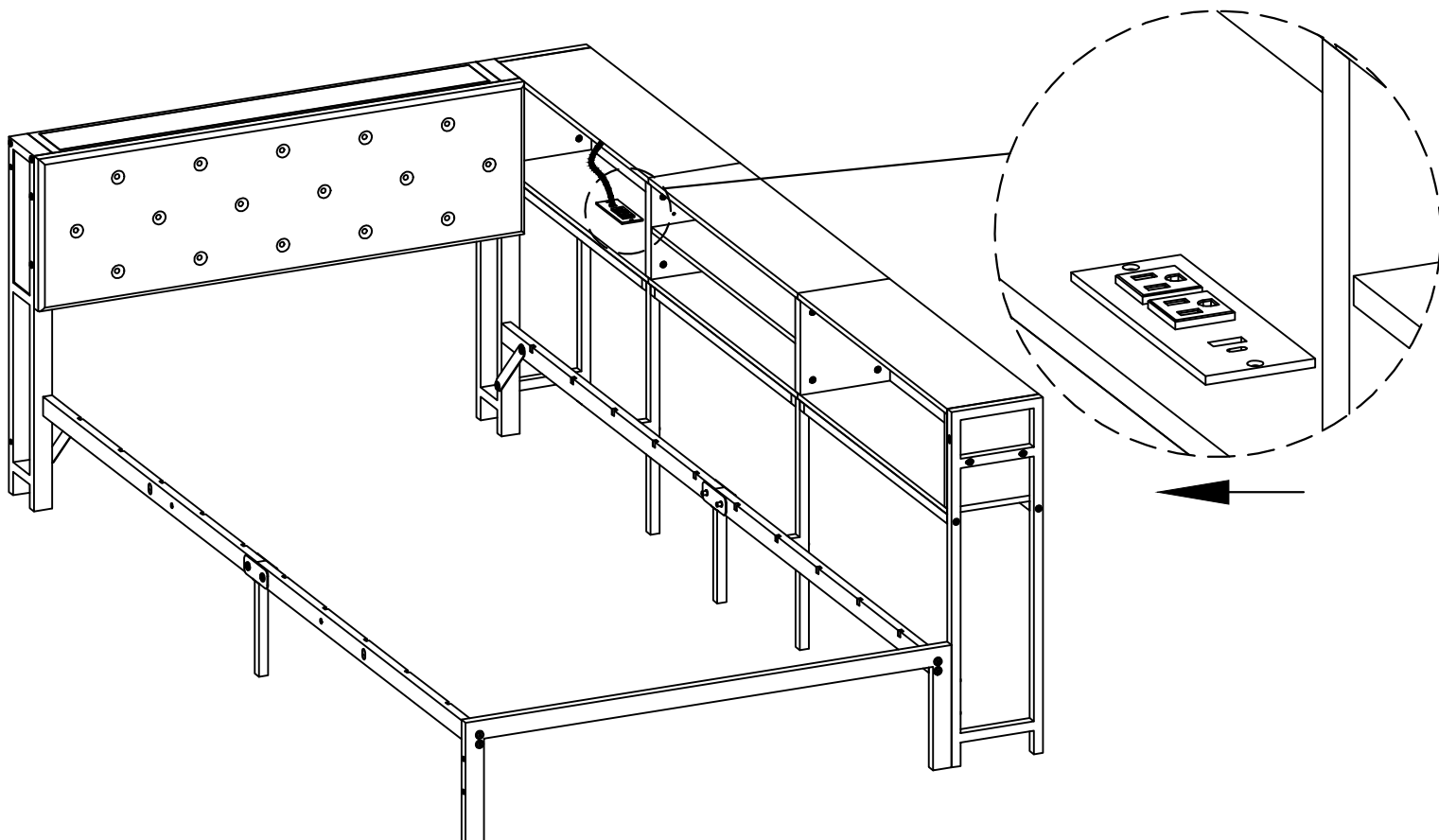

Step 29

Option 2

Move the wooden panel with led and the wooden panel with power outlet in reverse

With led

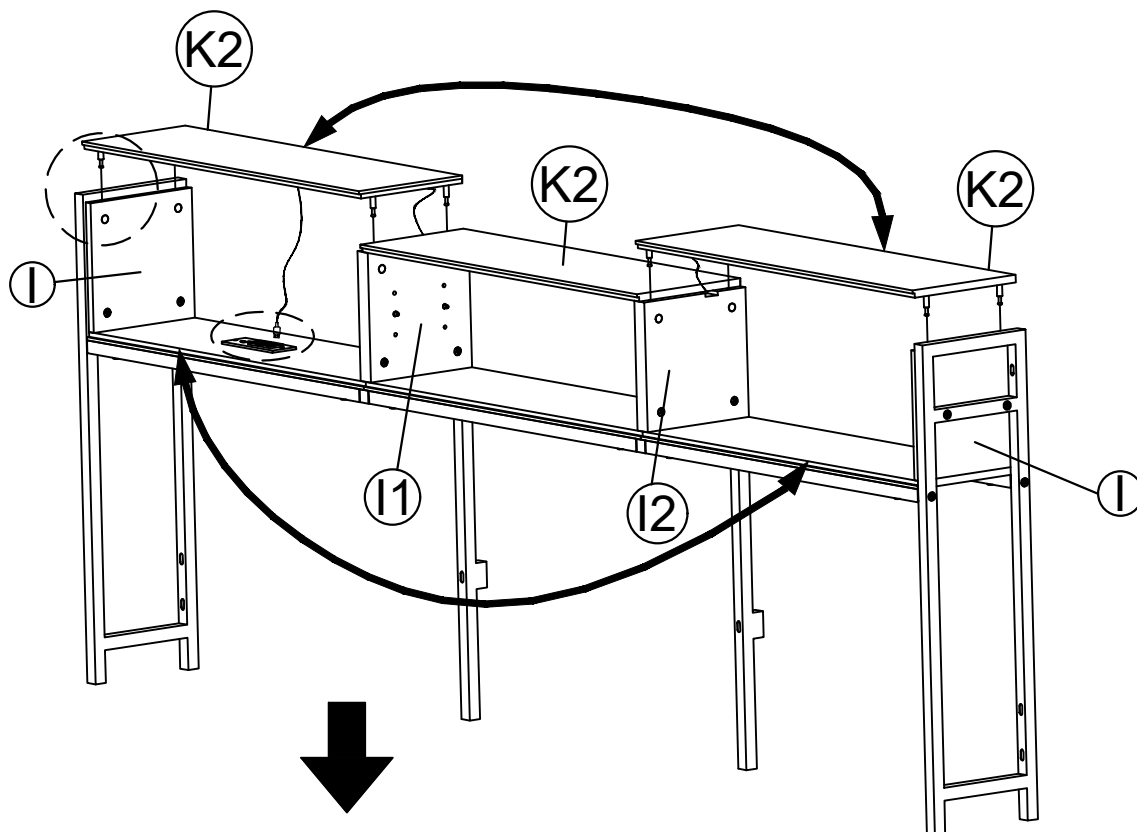

Power outlet at the head of the bed when the cabinet is installed on the left side of the bed

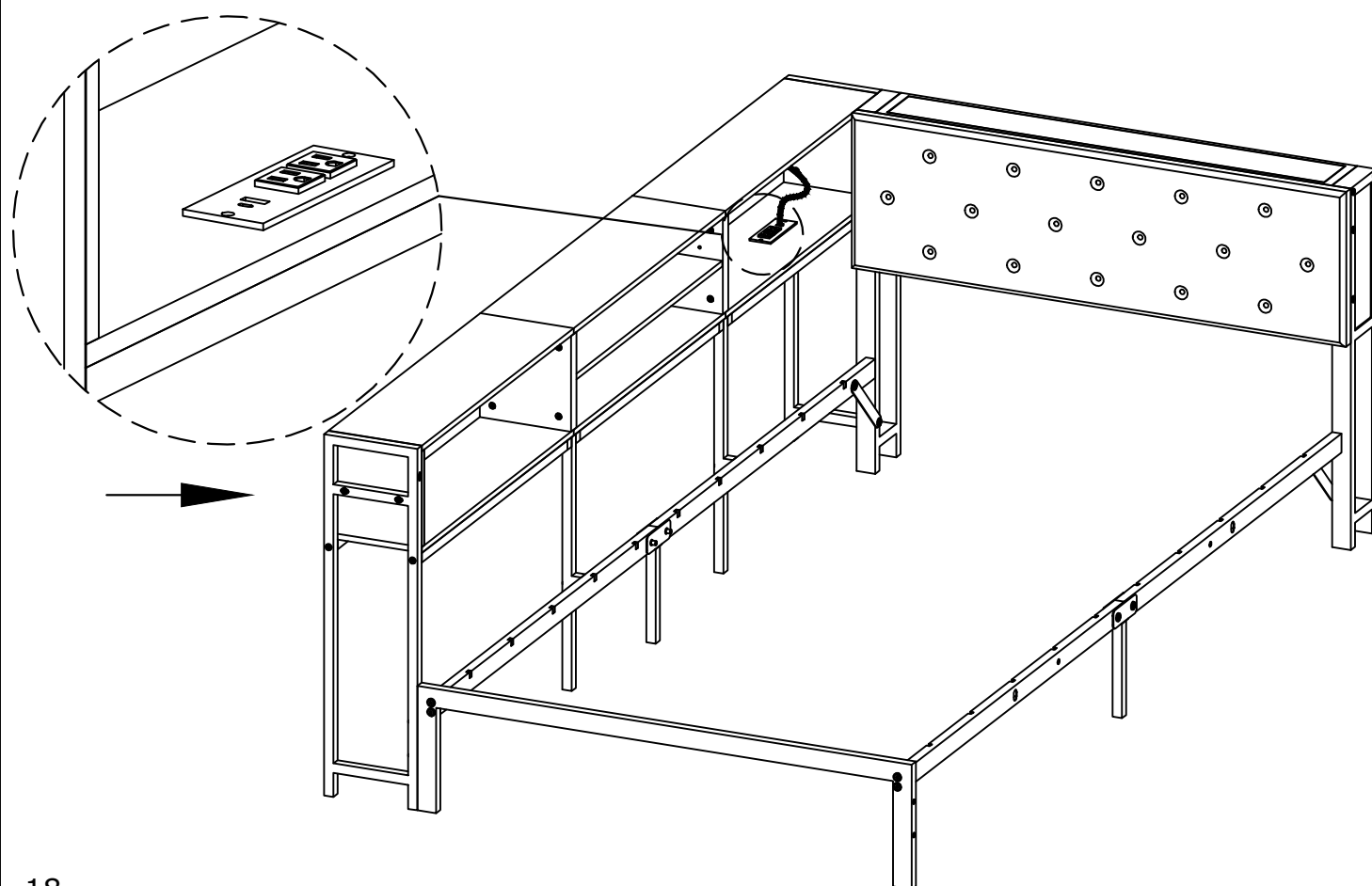

Step 30

Z9

8pcs

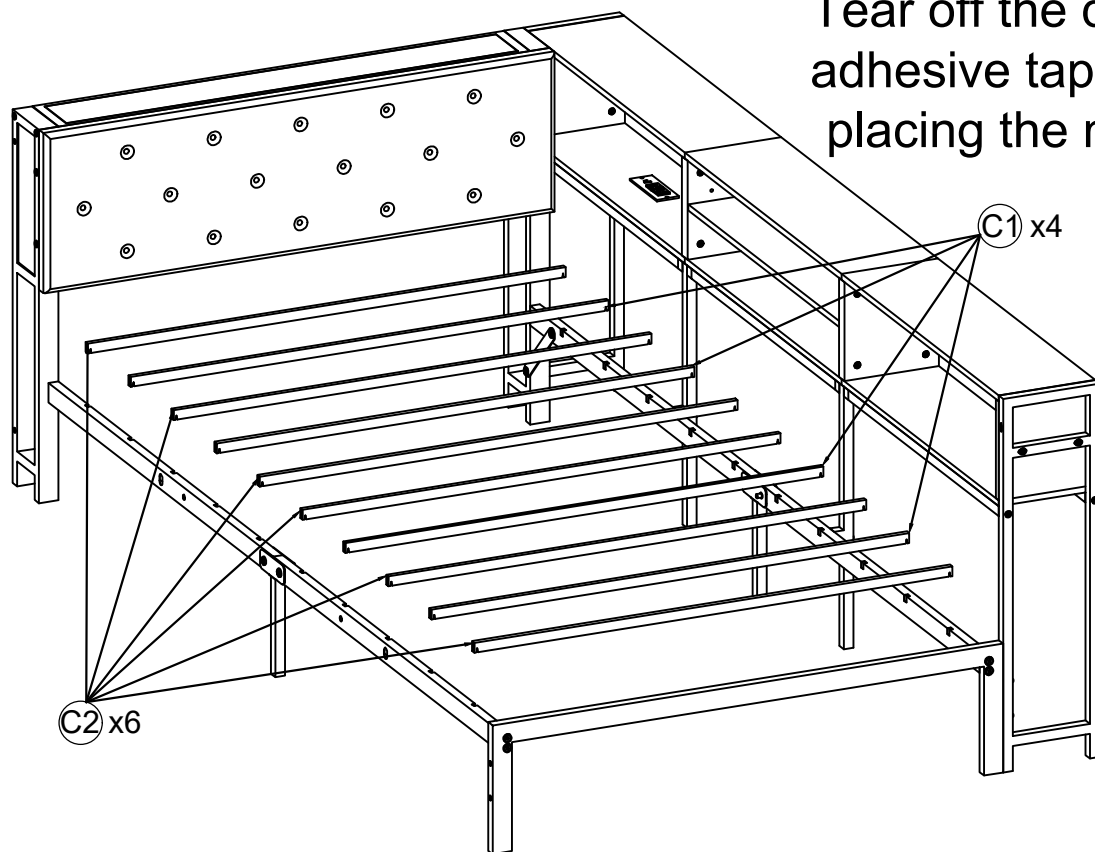

Tear off the double-sided adhesive tape before placing the mattress.

Step 31

Put all the screw in but not tighten, don't let the screws get through all the wheel's holder

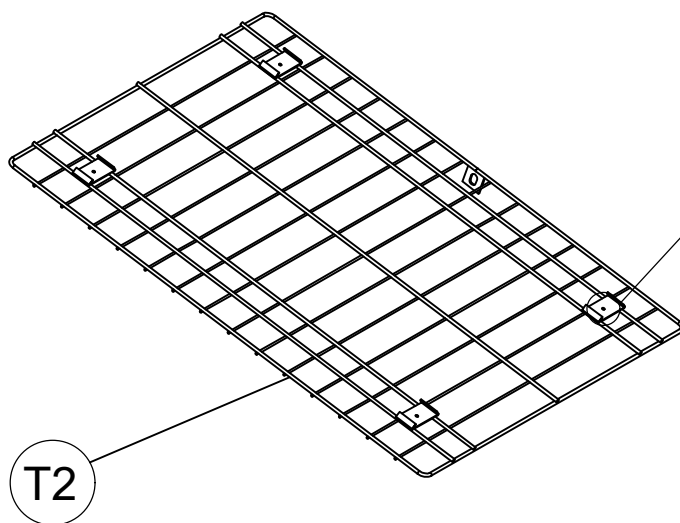

2pcs

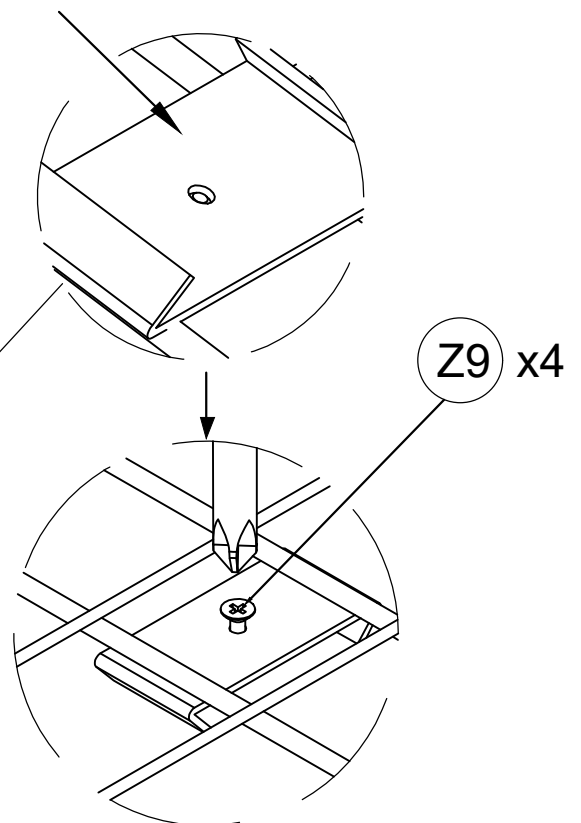

Step 32

U

8pcs

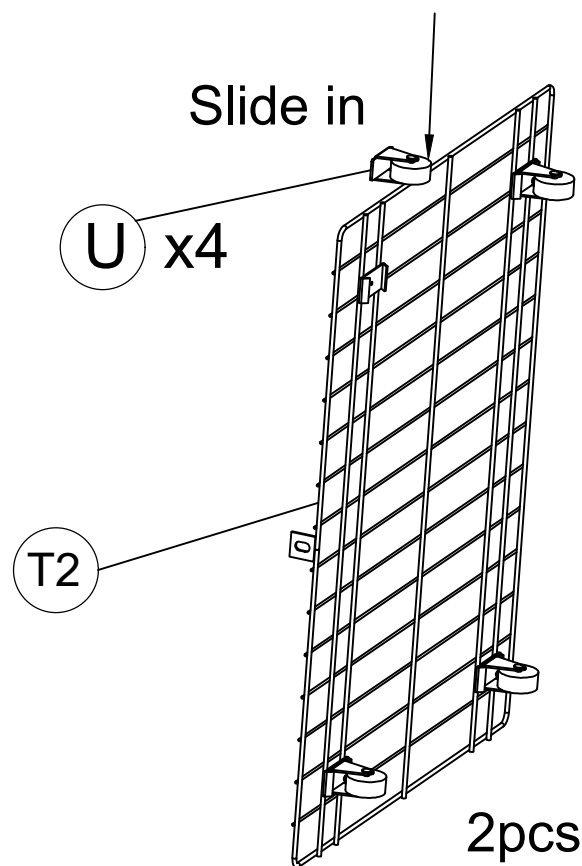

Step 33

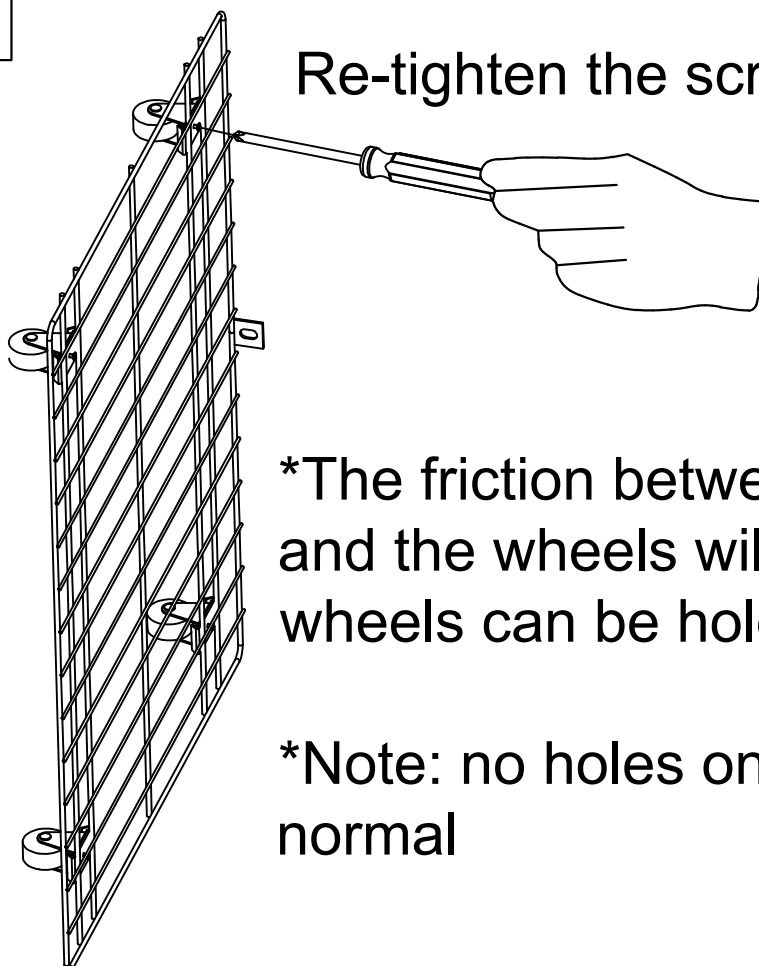

*The friction between the screw and the wheels will make the wheels can be holded

*Note: no holes on the wheels is normal

Step 34

Detailed assembly instructions Q

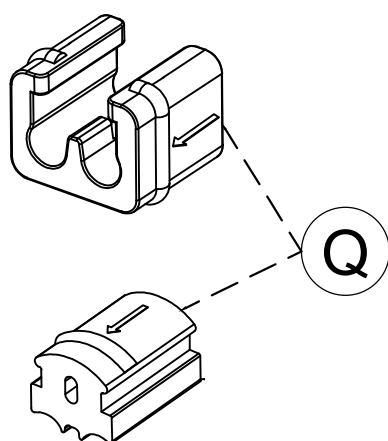

these two lines
on Q need to
be matched

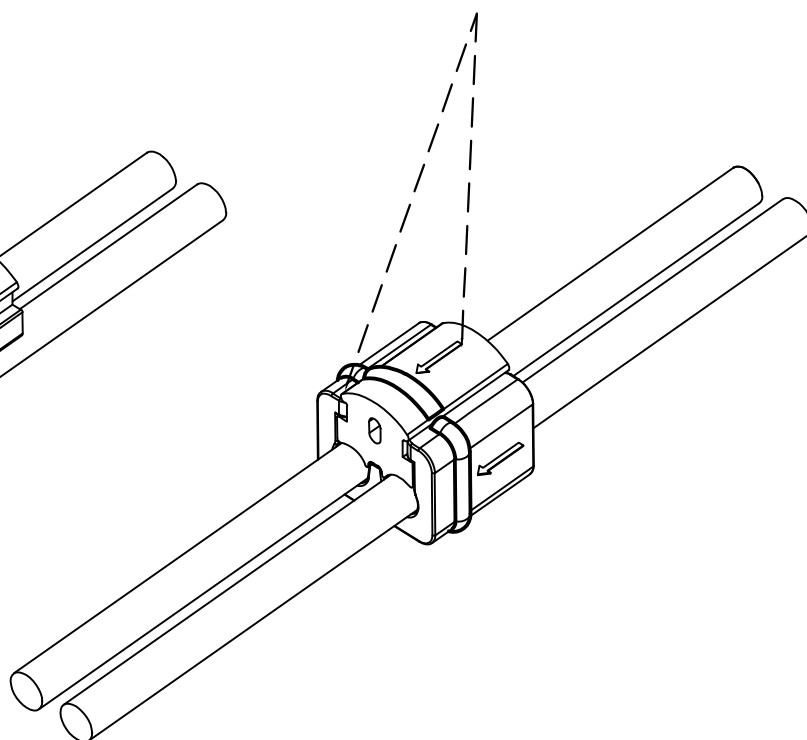
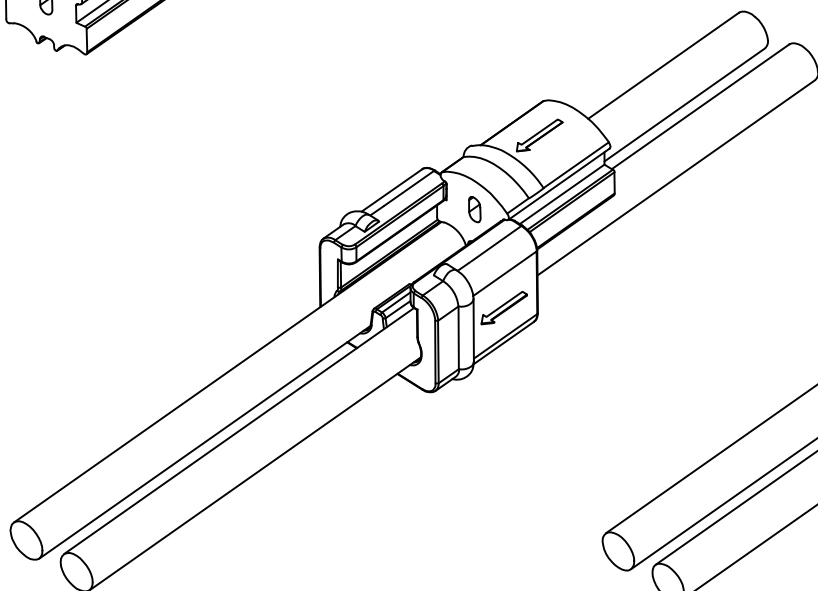

Step 35

Q

20pcs

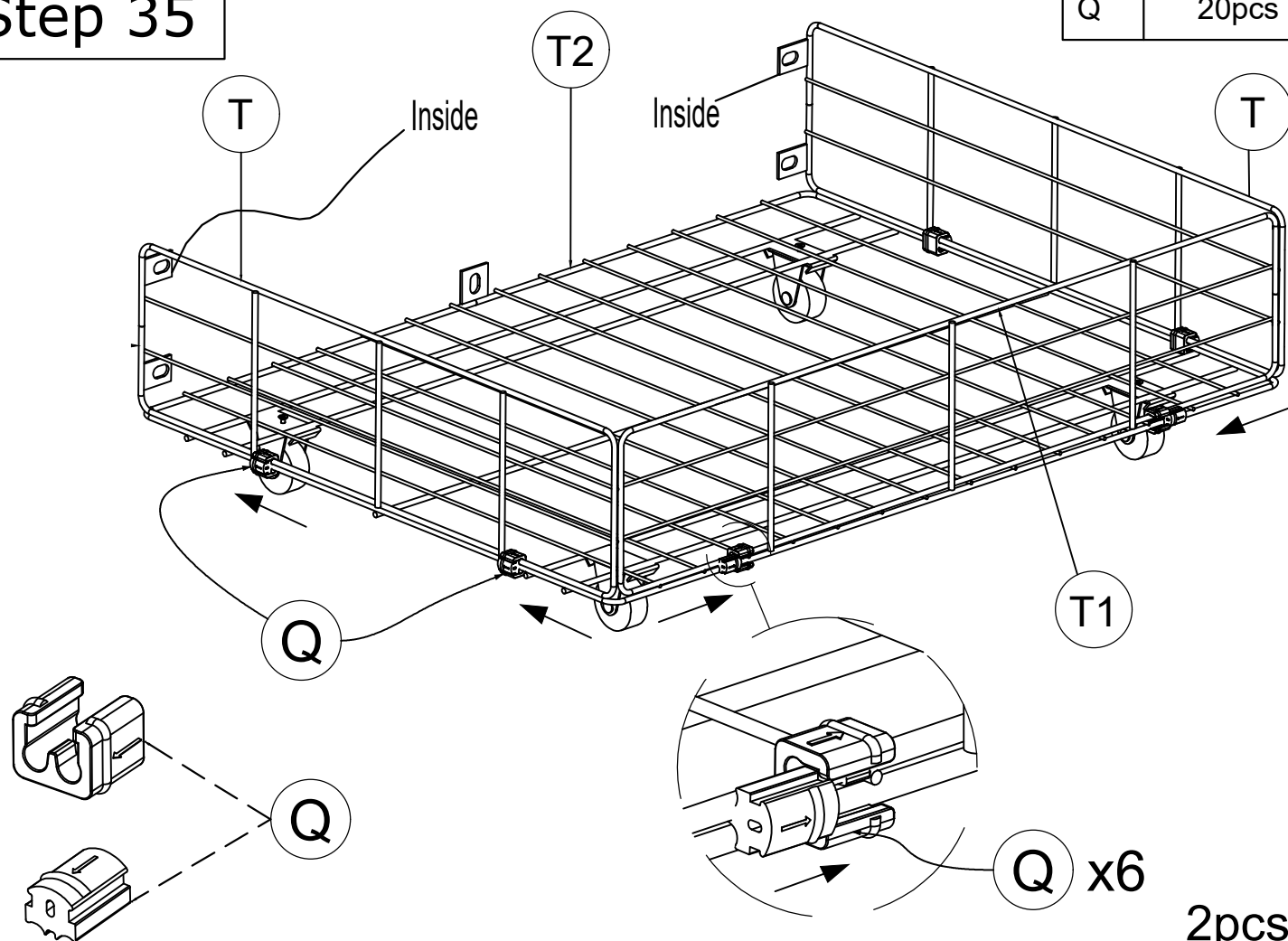

Q x6

2pcs

2pcs

Step 36

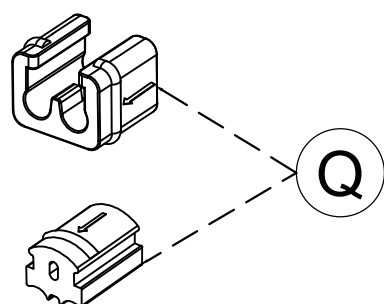

Q

Q

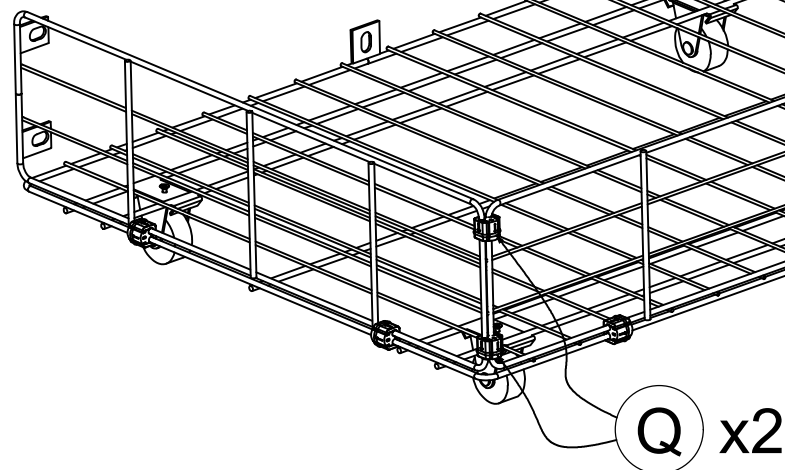

Q x2

Q x2

Step 37

Z1	02pcs
Z2	10pcs

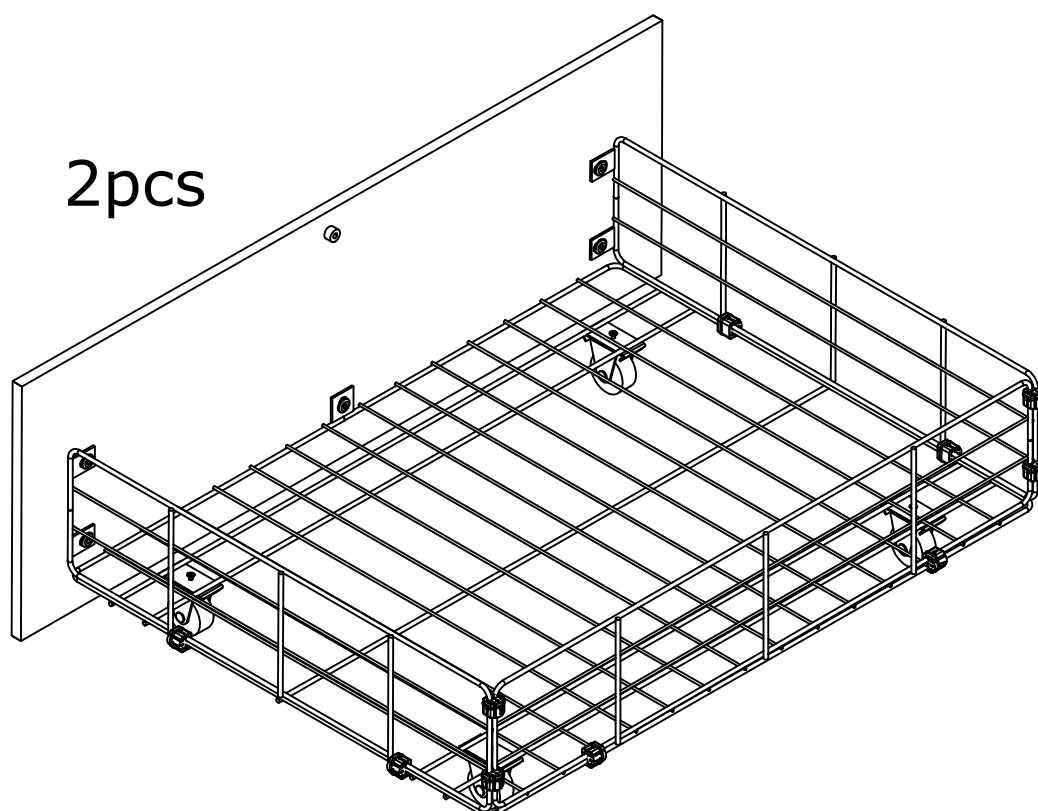
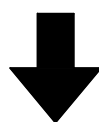
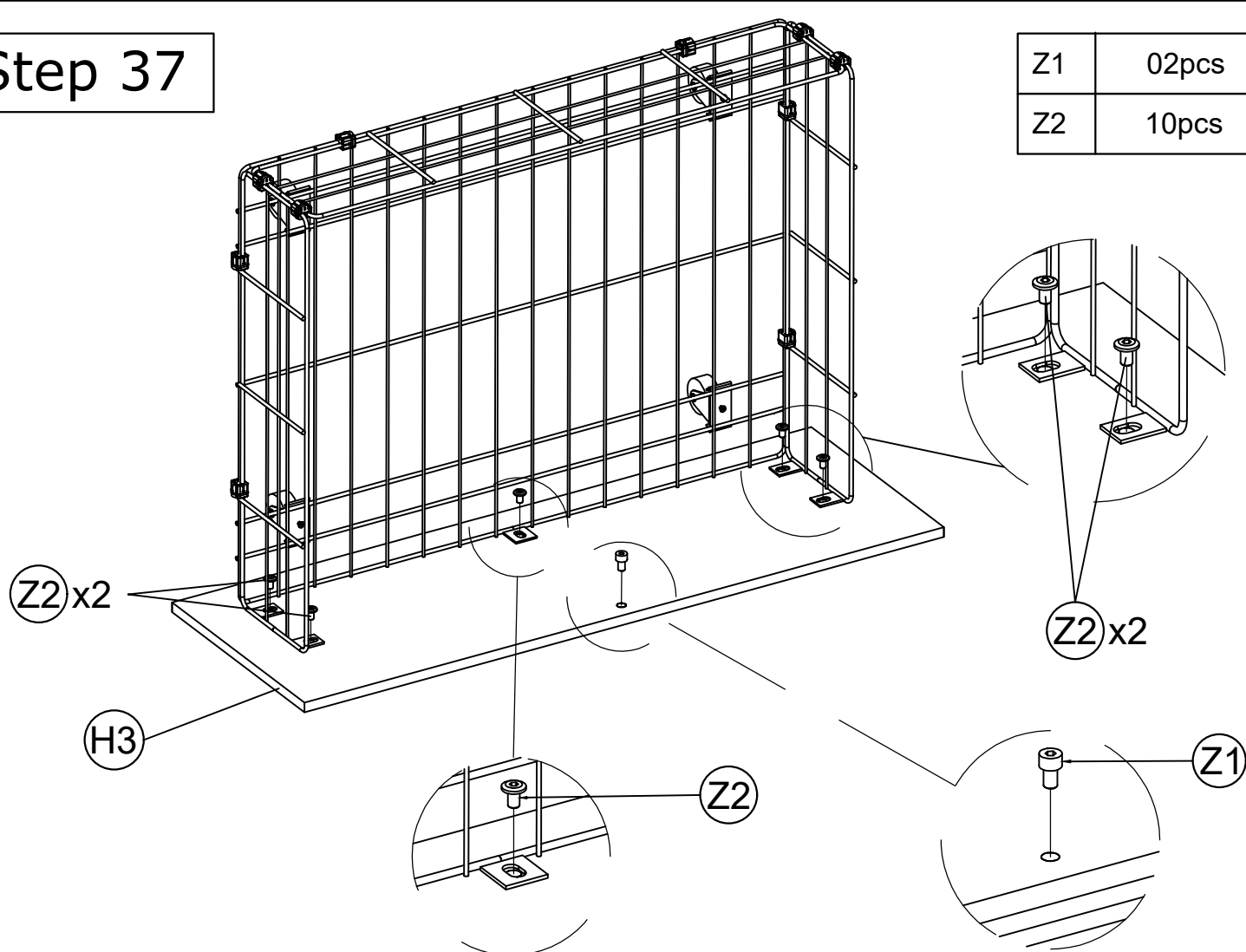

Step 38

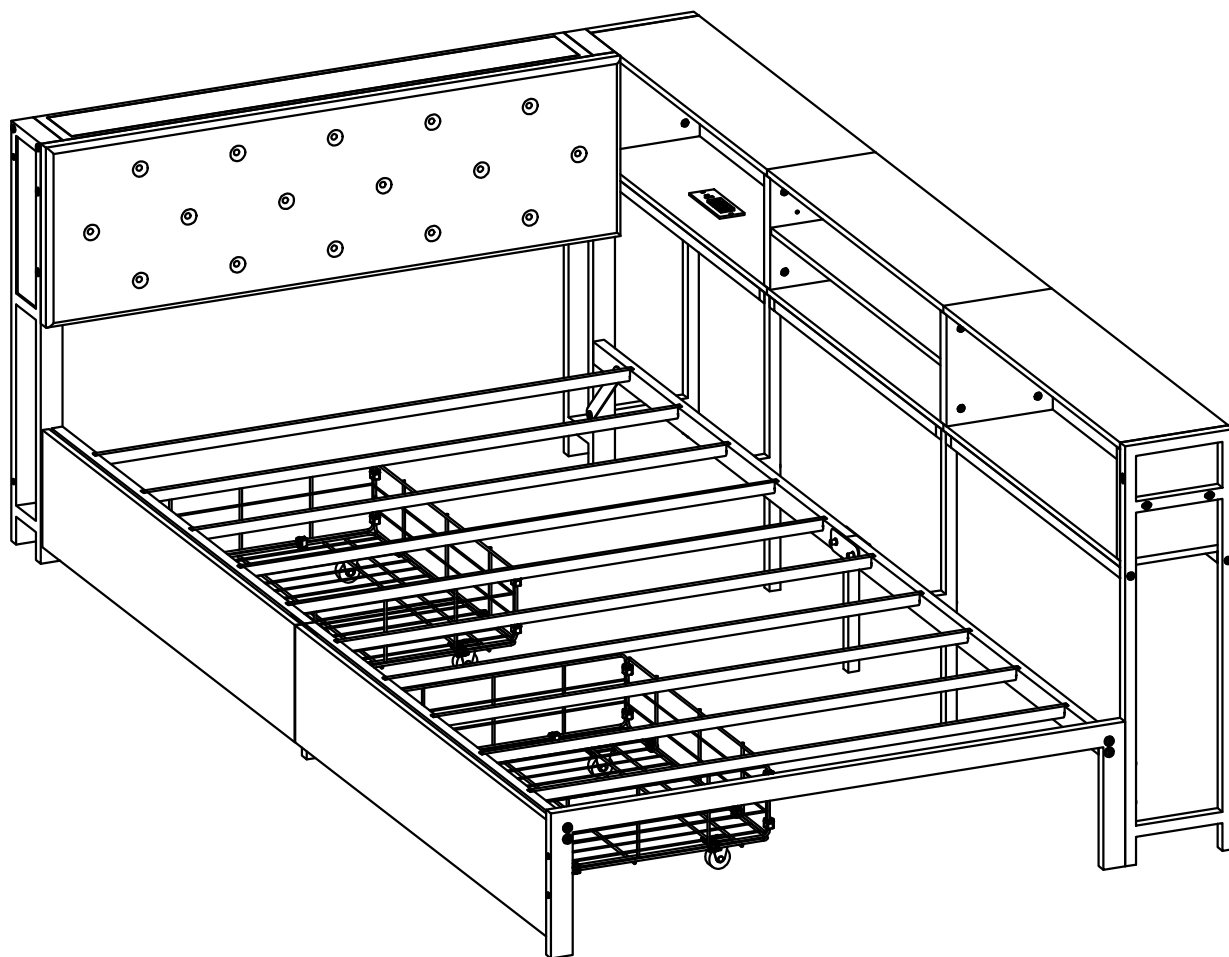
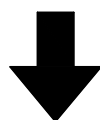
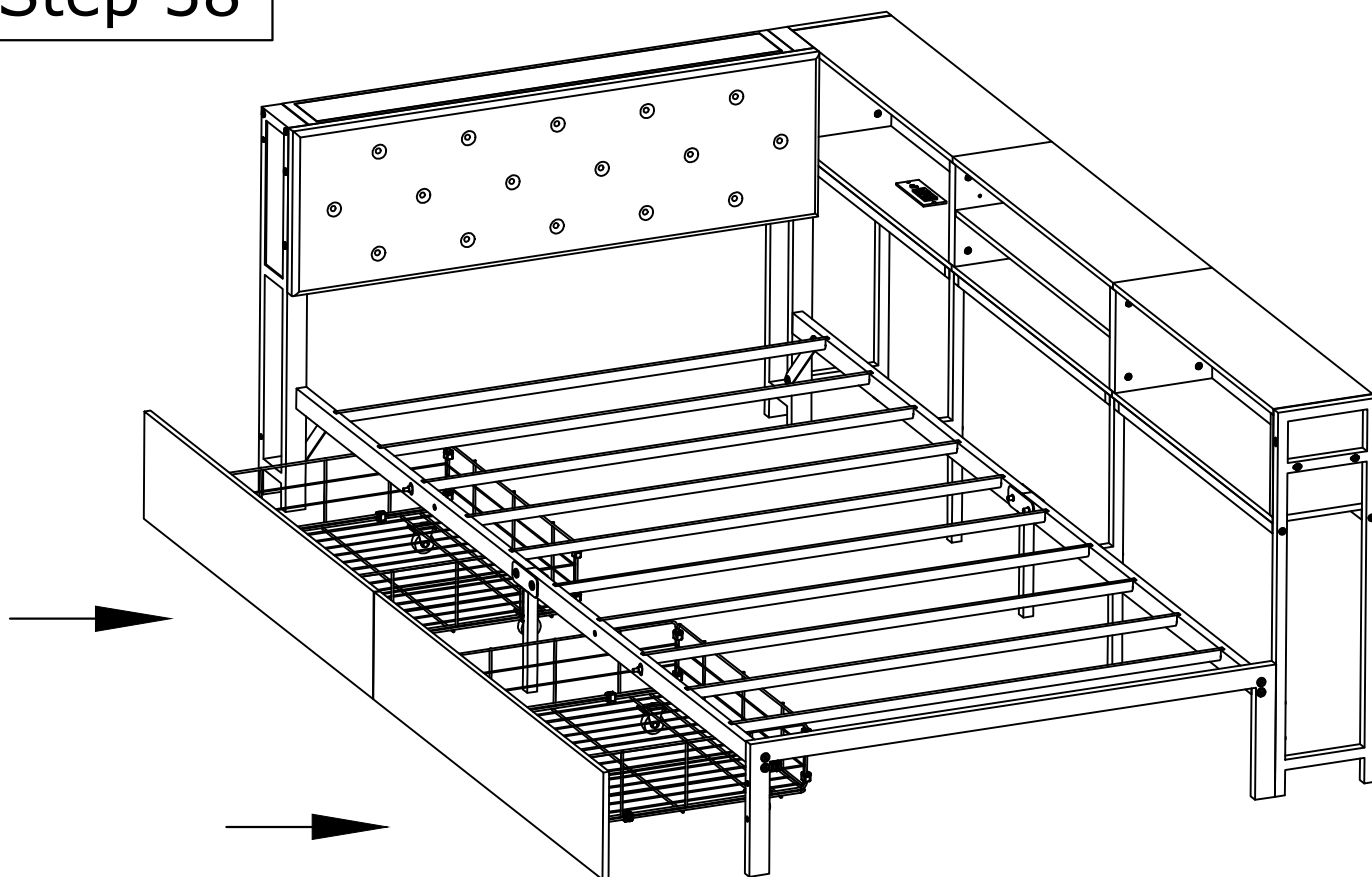

REMOTE CONTROL

