

CHAIR

ASSEMBLY INSTRUCTION



ASSEMBLY INSTRUCTION

ASSEMBLY TIPS:

- 1: Remove legs from box and sort by size.
- 2: Please check to see that all hardware and parts are present prior to start of assembly.
- 3: Please follow attached instructions in the same sequence as numbered to assure fast & easy assembly.



warning

- 1: Don't attempt to repair or modify parts that are broken or defective please contact the store immediately.
- 2: This product is for home use only and not intended for commercial establishment.

ASSEMBLY TIME PER UNIT: 15 MINUTES

PARTS IDENTIFICATION:

(A) SEAT



1 PC

(B) FRONT LEG



2PCS

(C) RIGHT REAR LEG



1PC

(D) LEFT REAR LEG



1PC

(E) BOTTOM COVER



1PC

Z. HARDWARE PACKAGE:

NO	DESCRIPTION	FIGURE	Q'TY
1	BOLT FOR FRONT LEG M8*60MM		6 PCS
2	BENT WASHER 8MM		12 PCS
3	WASHER (Φ8*Φ22)*2MM		12 PCS
4	ALLEN WRENCH M8		1 PC
5	BOLT FOR REAR LEG M8*50MM		6 PCS

STEP 1:

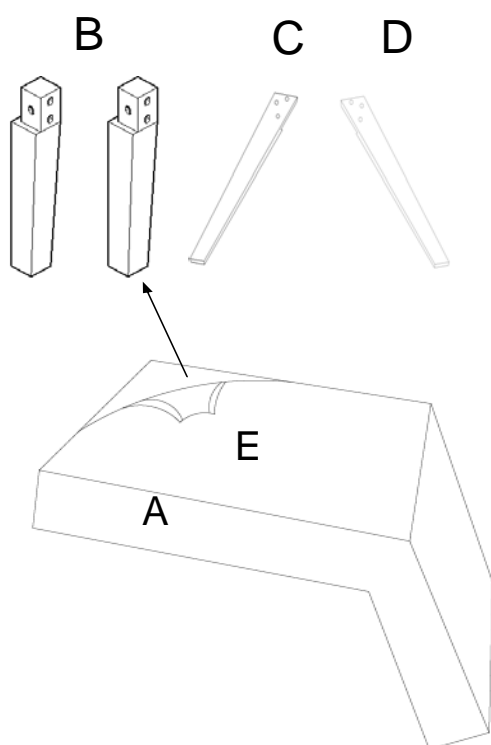

STEP 2:

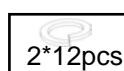
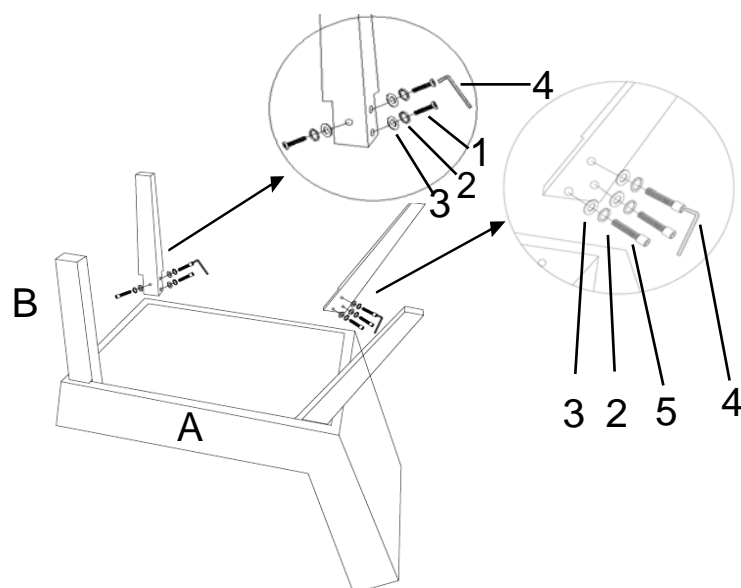

STEP 3:

