

INSTALLATION

Product Manual



IMPORTANT INFORMATION!

please read the entire manual before starting to assemble and/or using this product. follow the manual thoroughly and keep it for further reference.



AVOID SCRATCHES!

In order to avoid scratching this furniture should be assembled on a soft layer-could be a rug.



IMPROVE EFFICIENCY !

Try to find a partner to install with you, which can speed up the installation efficiency and shorten the time.

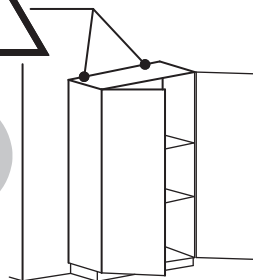

ANTI-TOPPLE WARNING !

Overturned furniture can cause serious or fatal crush injuries. To prevent tipping over, be sure to use the wall attachment, if not included with this product. Please purchase the wall attachment that fit your wall. If unsure, seek professional advice. Please read and follow each step of the instructions carefully.

IMPORTANT !

It is important that any product which is assembled using any kind of screw is re-tightened 2 weeks after assembly, and once every 3 months - in order to assure stability through-out the lifespan of the product.

For regular maintenance and cleaning of the product, for the frame, please use a rag dipped in neutral detergent to fully wipe it, and then dry it with a clean rag. For glass materials, wipe with a rag dampened with water glass cleaner, and then dry with a dry rag.

Do not use an electric screwdriver, and do not use too much force when installing, because the board is easy to break.

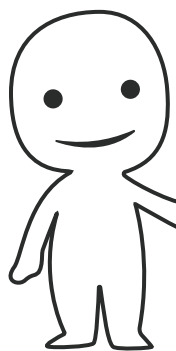

Please prepare the following tools

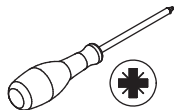

When installing, please carefully confirm whether each screw corresponds to the manual, accessories with similar shapes can be distinguished by size

A x 47



CRB1595A

B x 39

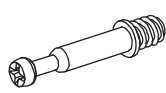

CRA0635A

C x 22

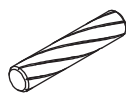

CRF0630A

D x 4

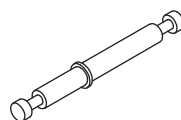

Ø6 x 67 mm

E x 32



CRD3512A

F x 36



CRD3514A

G x 12

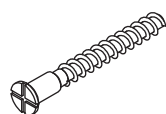

CRD0540A

H x 2

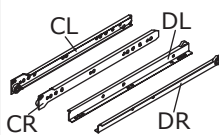

WX0812A

I x 12



J x 4

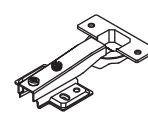

DGA861A

K x 4

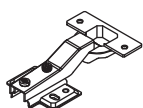

DGA861B

L x 28



M x 28



CRD0314A

N x 4



O x 4

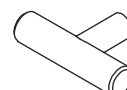

P x 8



CRE0420A

Q x 2

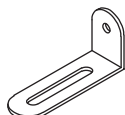

R x 2

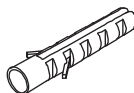

S x 2

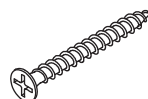

CRD3535A

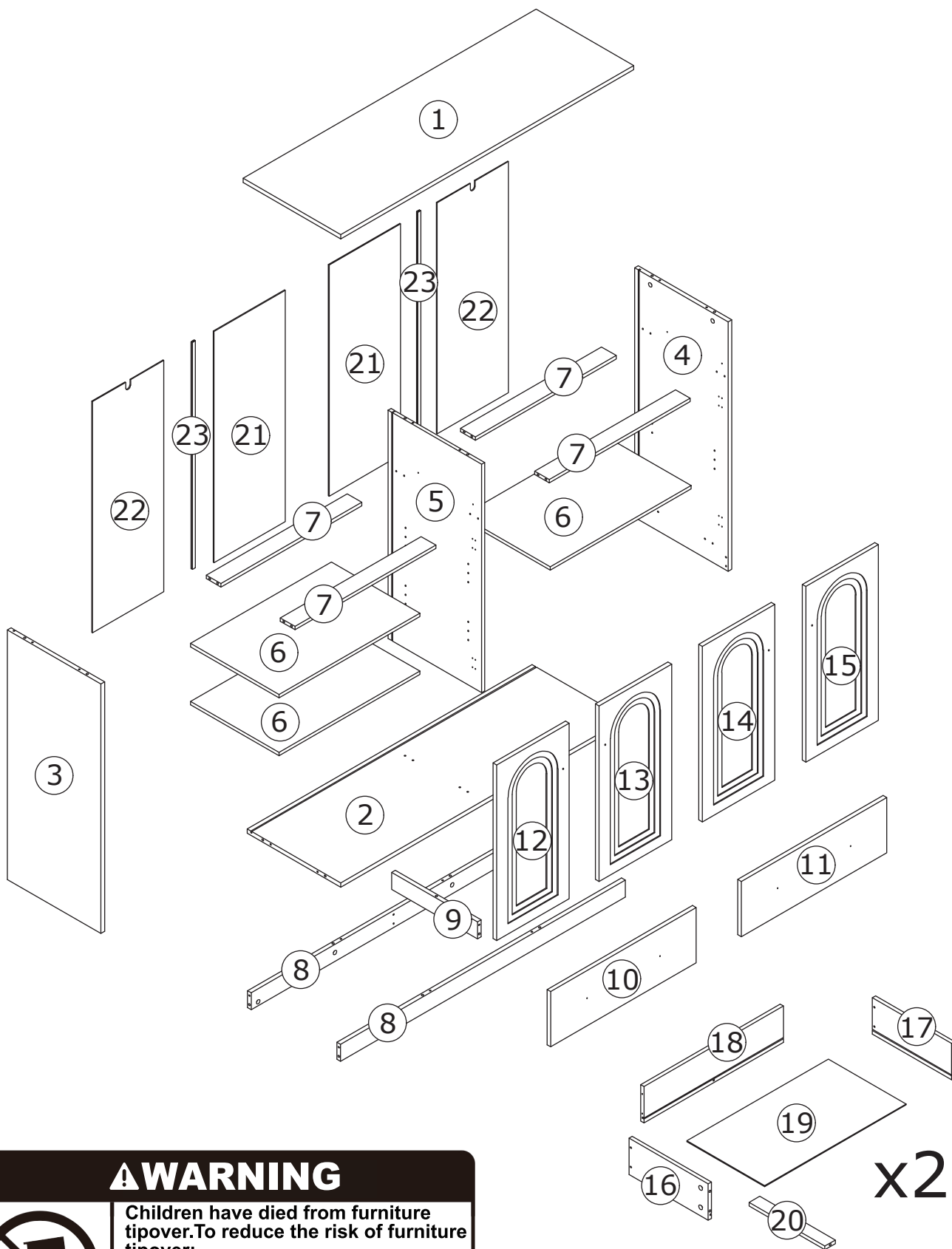

⚠ WARNING



Children have died from furniture tipover. To reduce the risk of furniture tipover:

- ALWAYS install Anti-tip device provided.
- NEVER put a TV on this product.
- NEVER allow children to stand, climb or hang on drawers, doors, or shelves.
- NEVER open more than one drawer at a time.
- Place heaviest items in the lowest drawers.

*This is a permanent label.
Do not remove!*

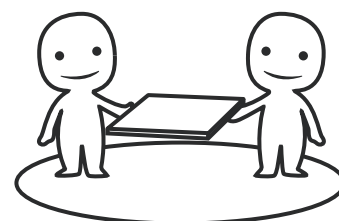

ASSEMBLED BY 2 ADULTS

1

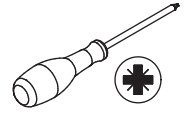
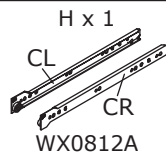

Fix rail(CL) to panel 5 with screw(E) at first.
Flip to back, fix rail(CR) as shown.
 Screw eccentric rod(B) into panel 2 as shown.

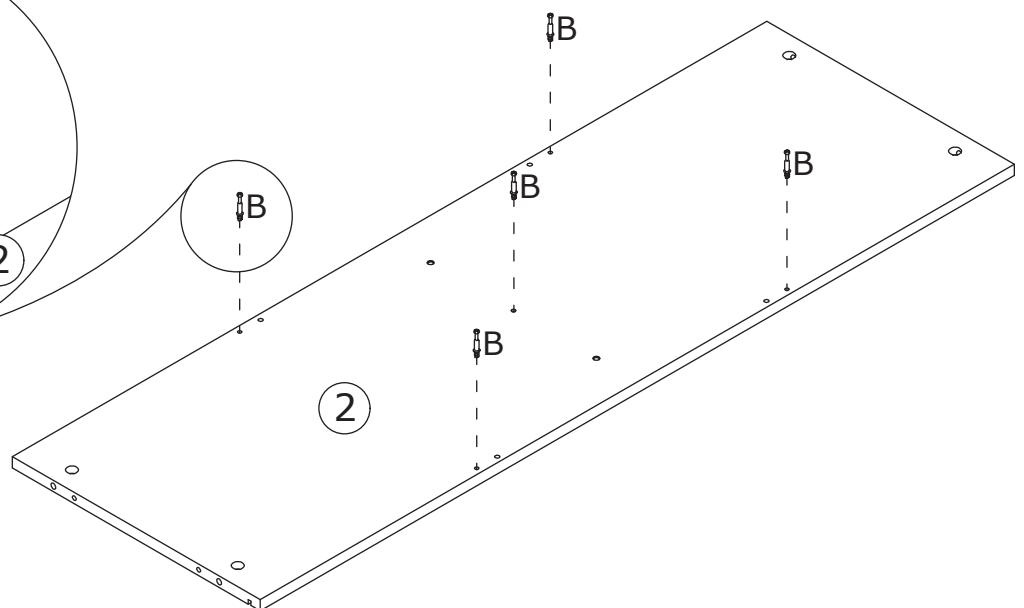
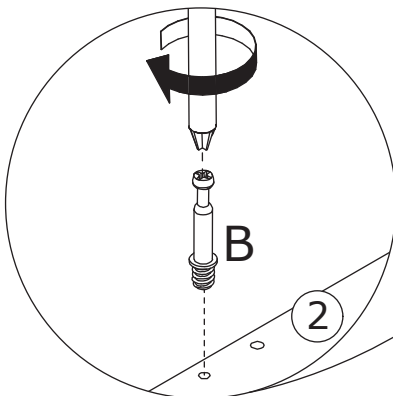
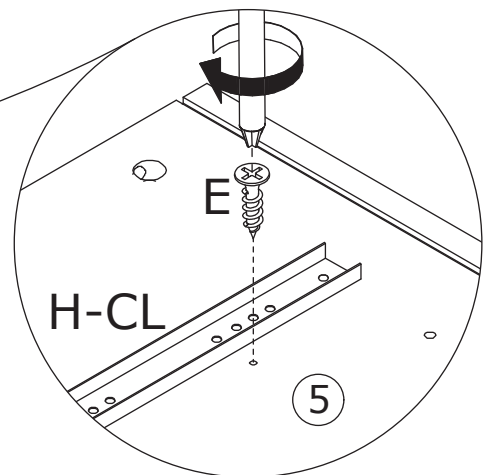
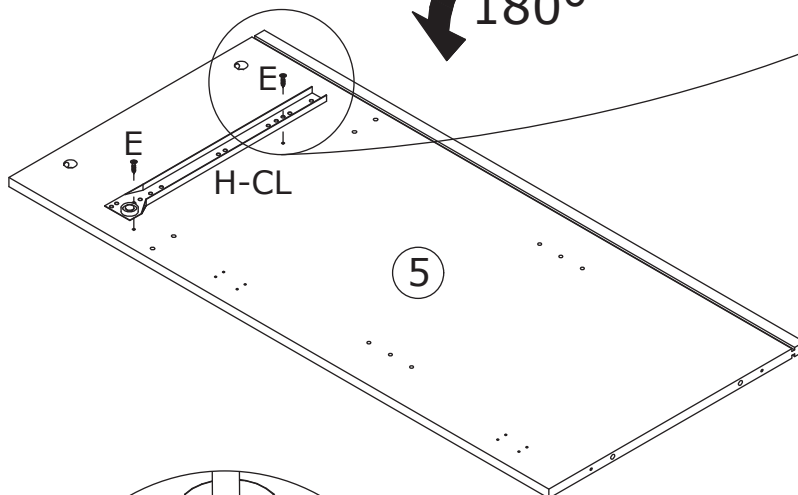
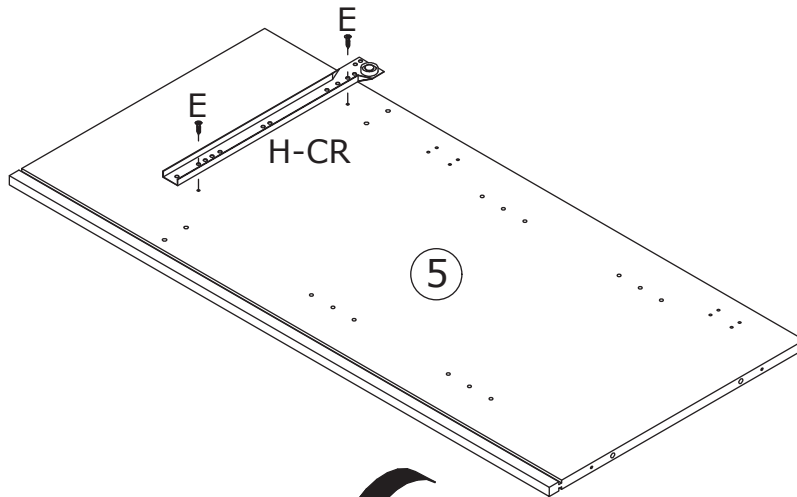
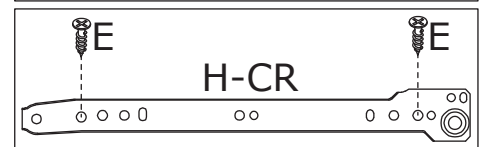
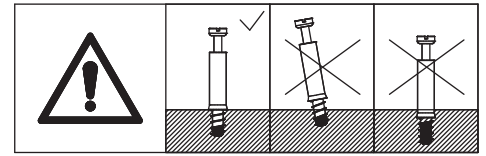

2

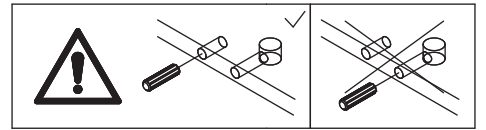

Attach panel 5 to panel 2 using wooden dowel(C), and fix with screw(G) as shown.

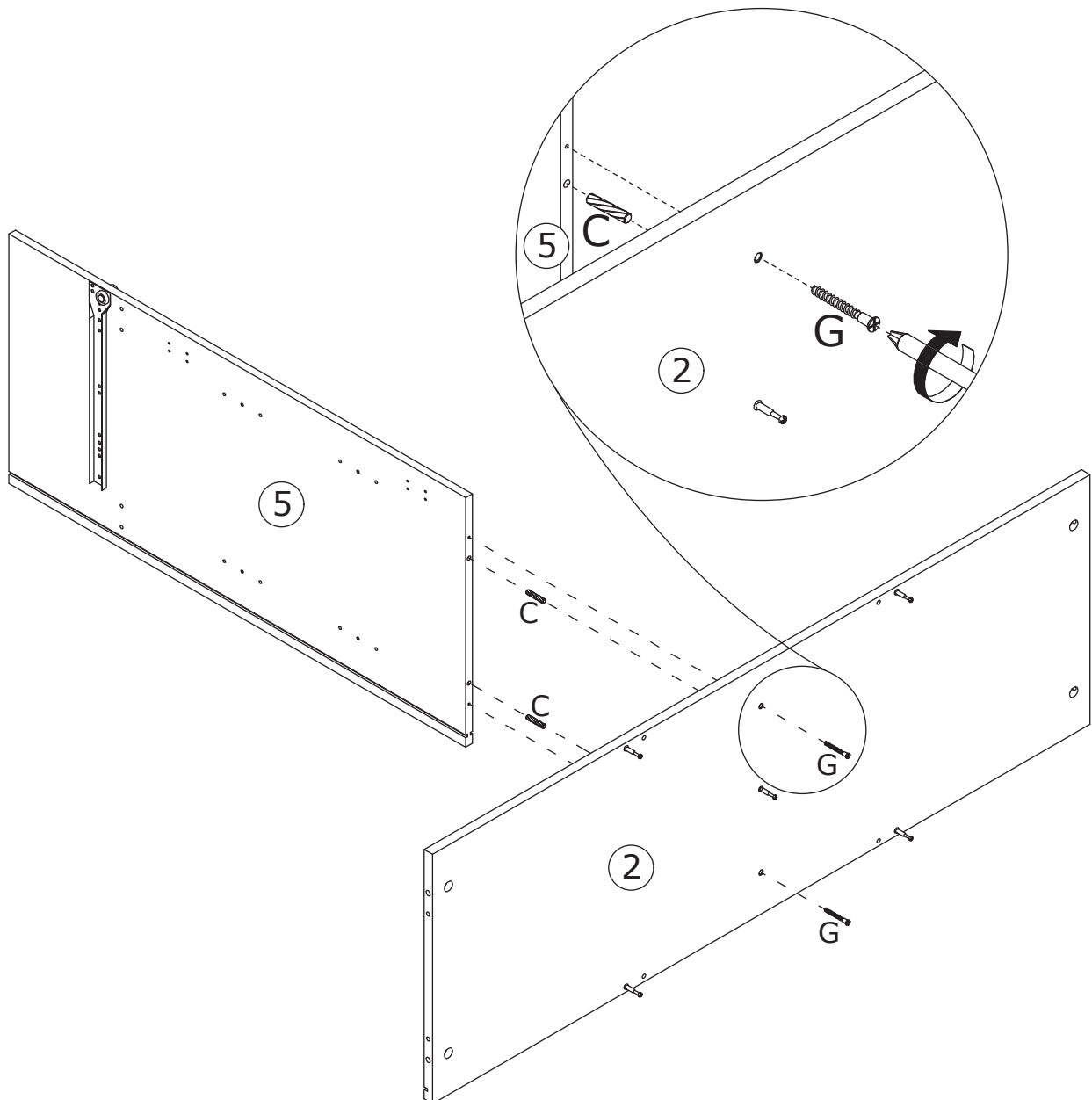

3

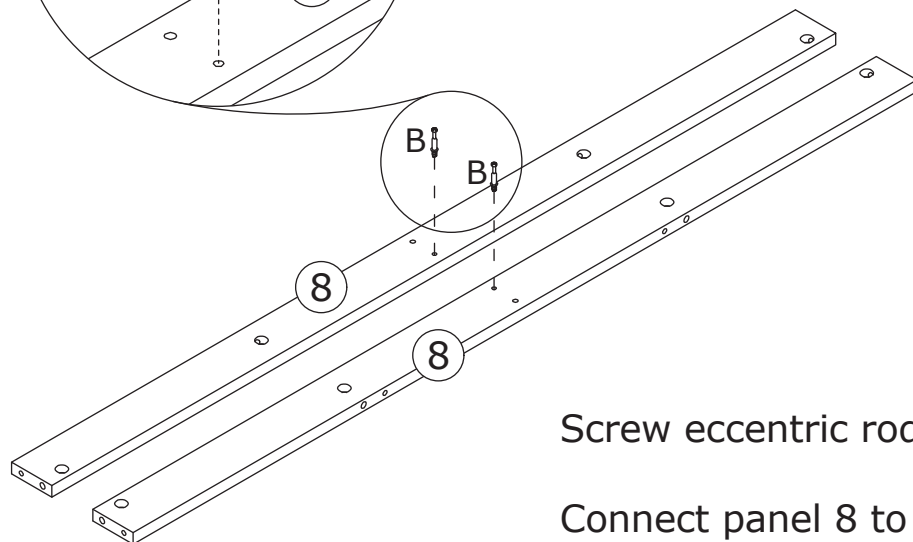
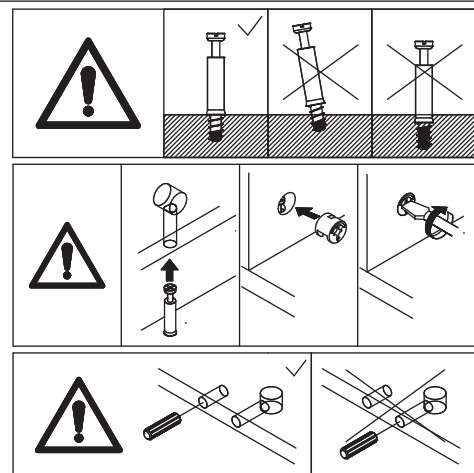
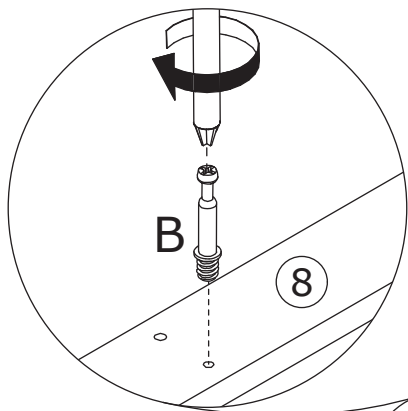
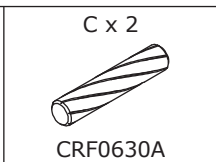
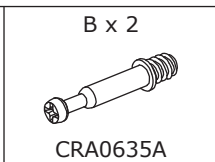
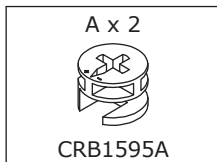

Screw eccentric rod(B) into panel 8 at first.

Connect panel 8 to panel 9 using wooden dowel(C), add cam lock(A) into panel 9 and turn clockwise to tighten as shown.

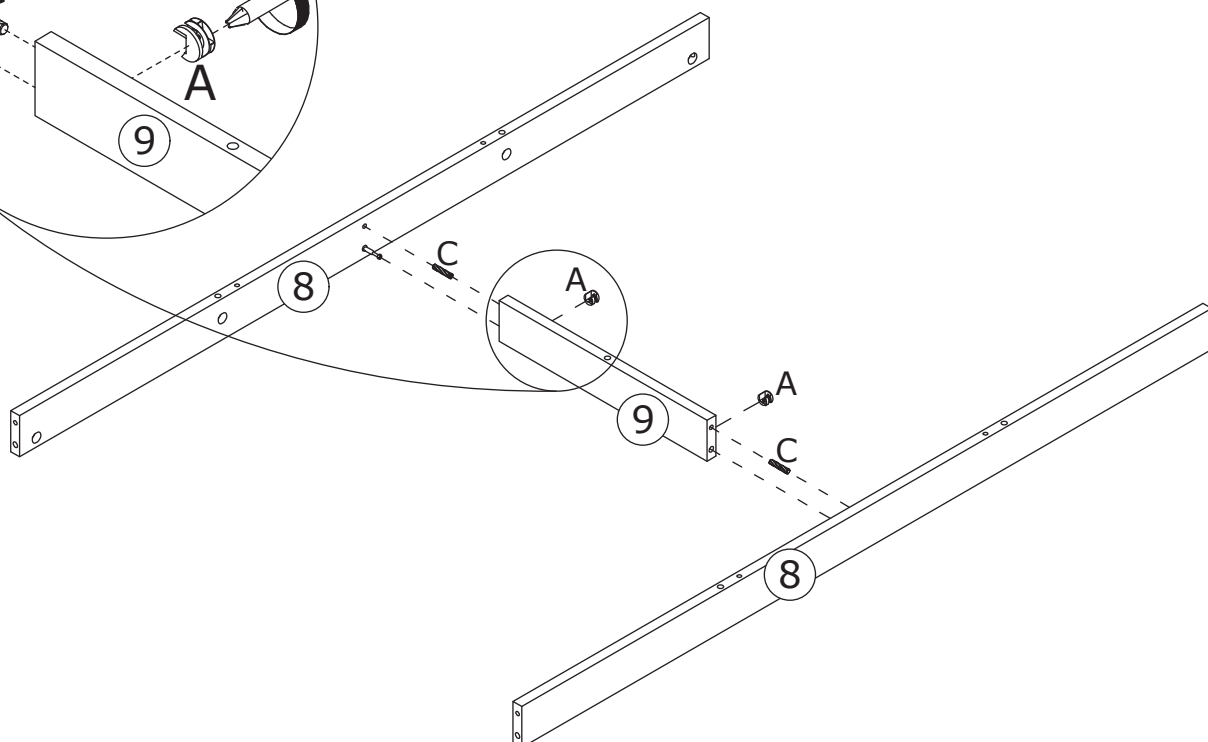
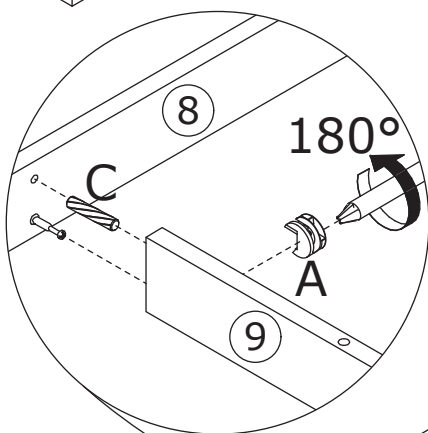

4

A x 5
CRB1595A

C x 4
CRF0630A

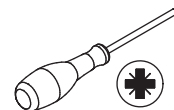

Attach panel 8 and 9 to panel 2 using wooden dowel(C), add cam lock(A) into panel 8,9 and turn clockwise to tighten as shown.

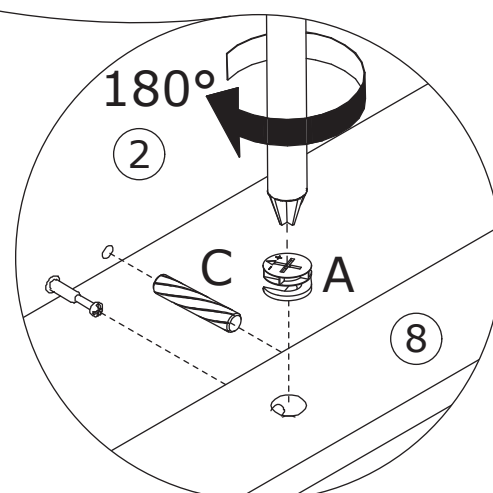
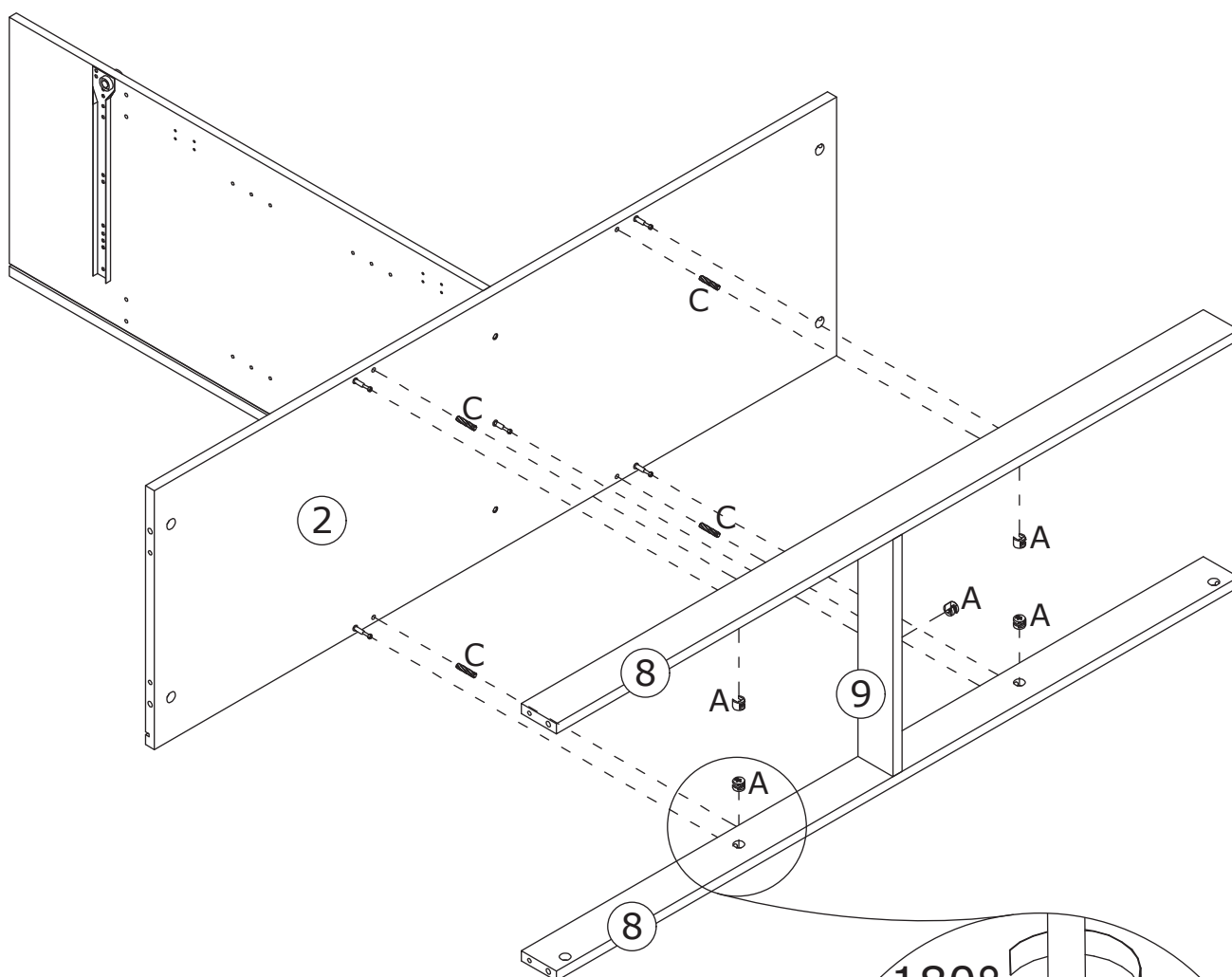
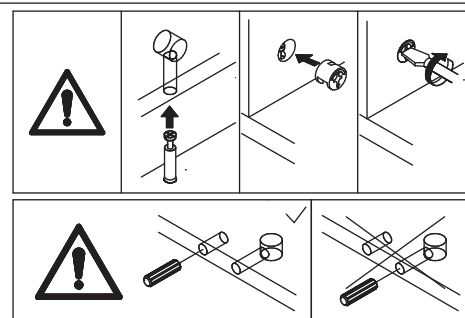

5

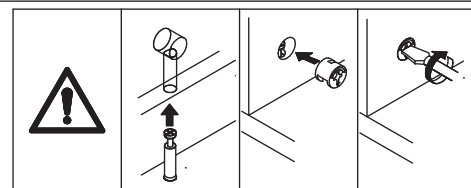

Thread rod(D) through the holes at first.
Attach panel 7 to panel 5, add cam lock(A)
into panel 7 and turn clockwise to tighten
as shown.

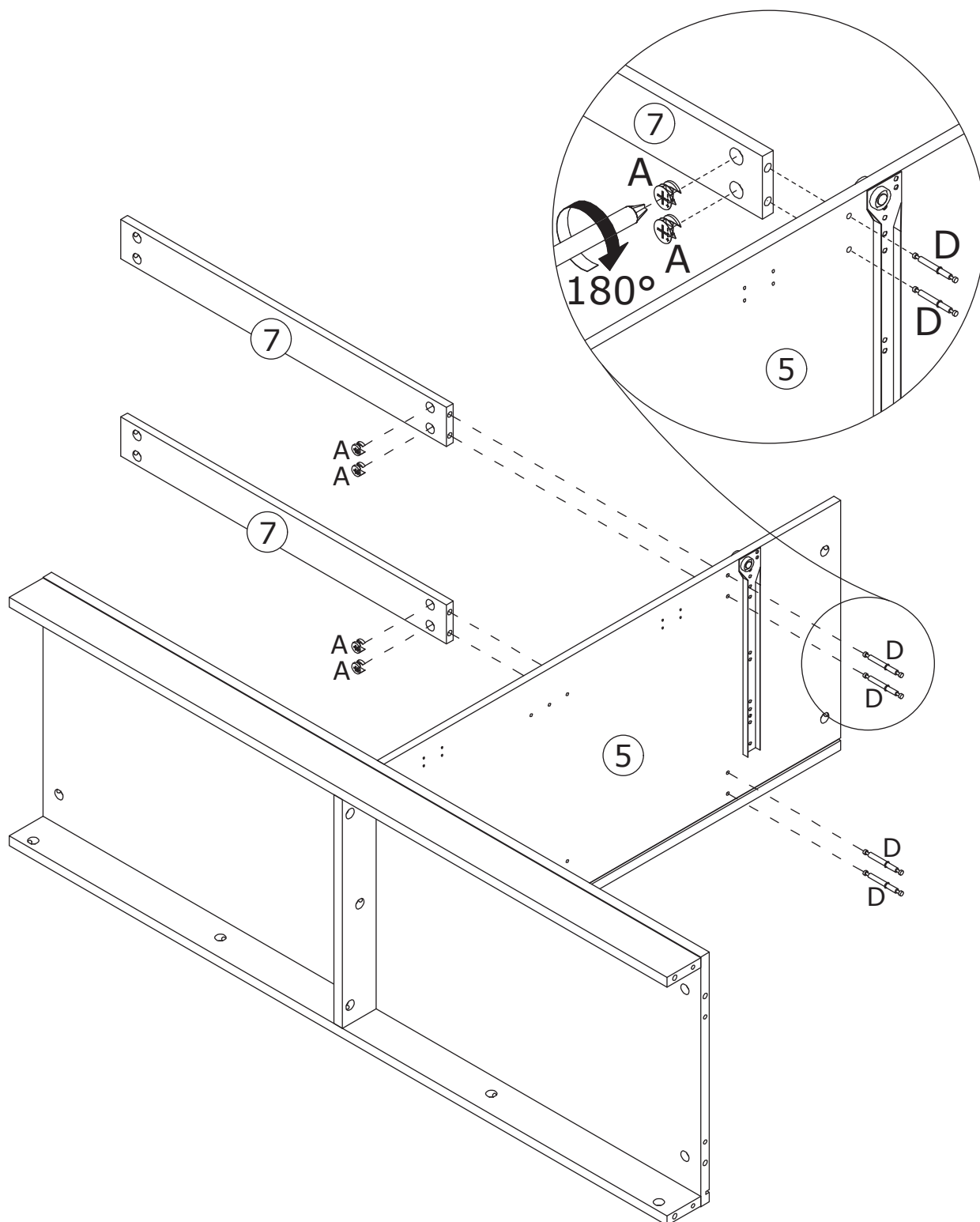

6

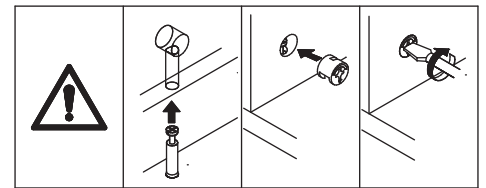
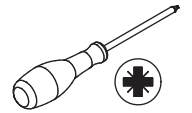
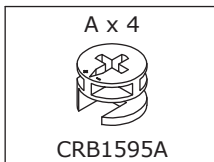

Attach panel 7 to panel 5, add cam lock(A) into panel 7 and turn clockwise to tighten as shown.

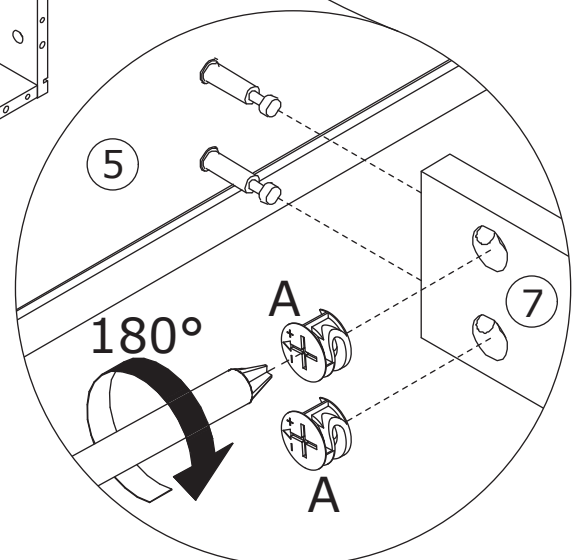
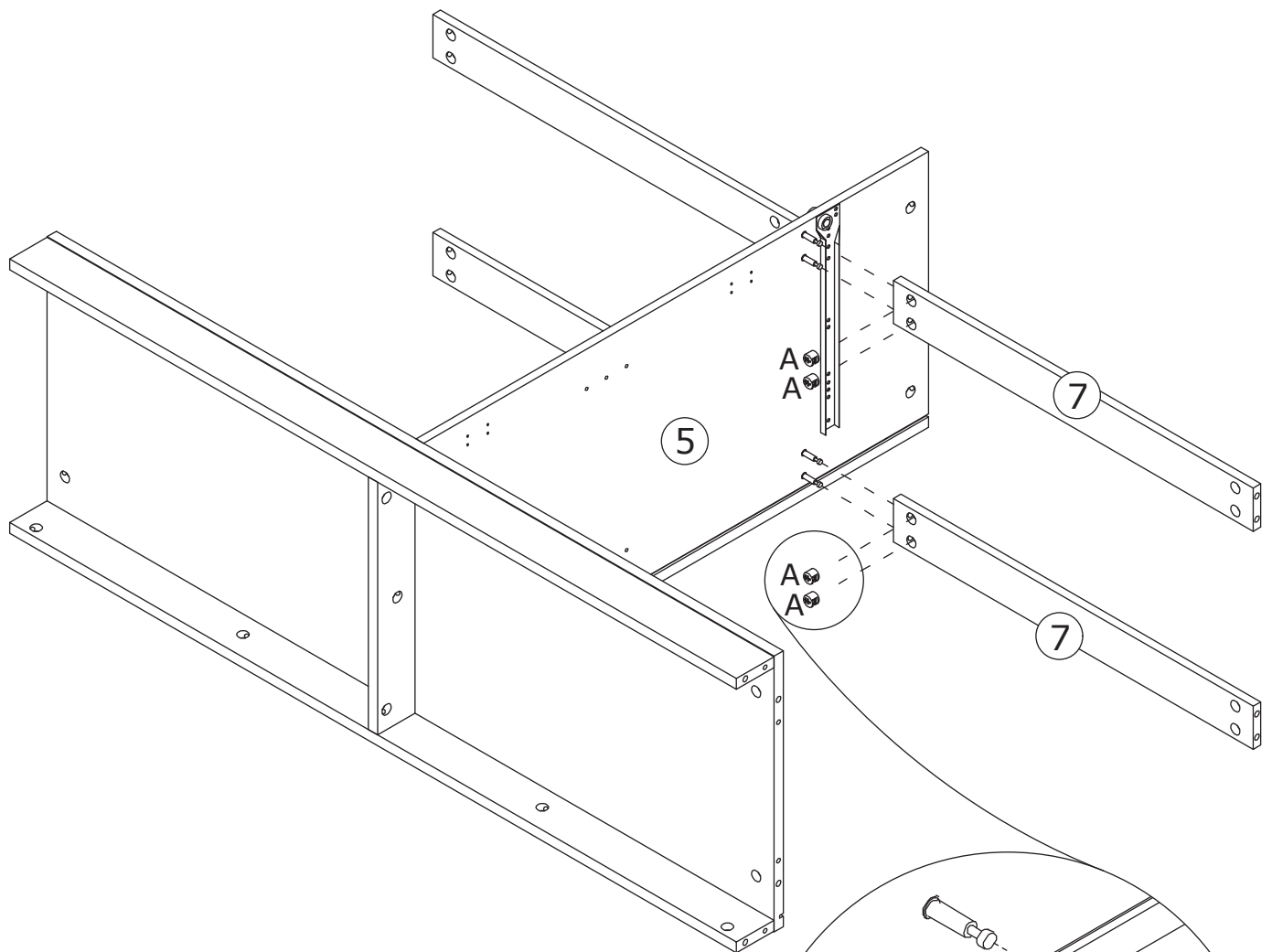

7

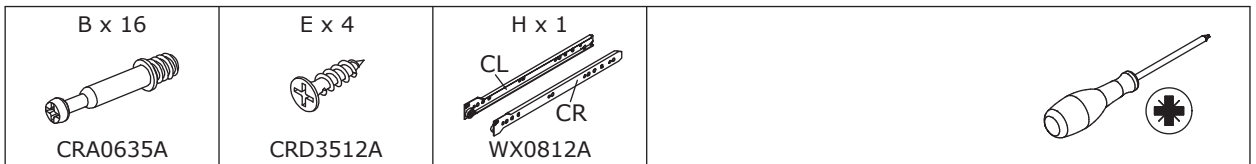

Screw eccentric rod(B) into panel 3 and 4 at first.

Fix rail(CL) and (CR) to panel 3 and 4 with screw(E) as shown.

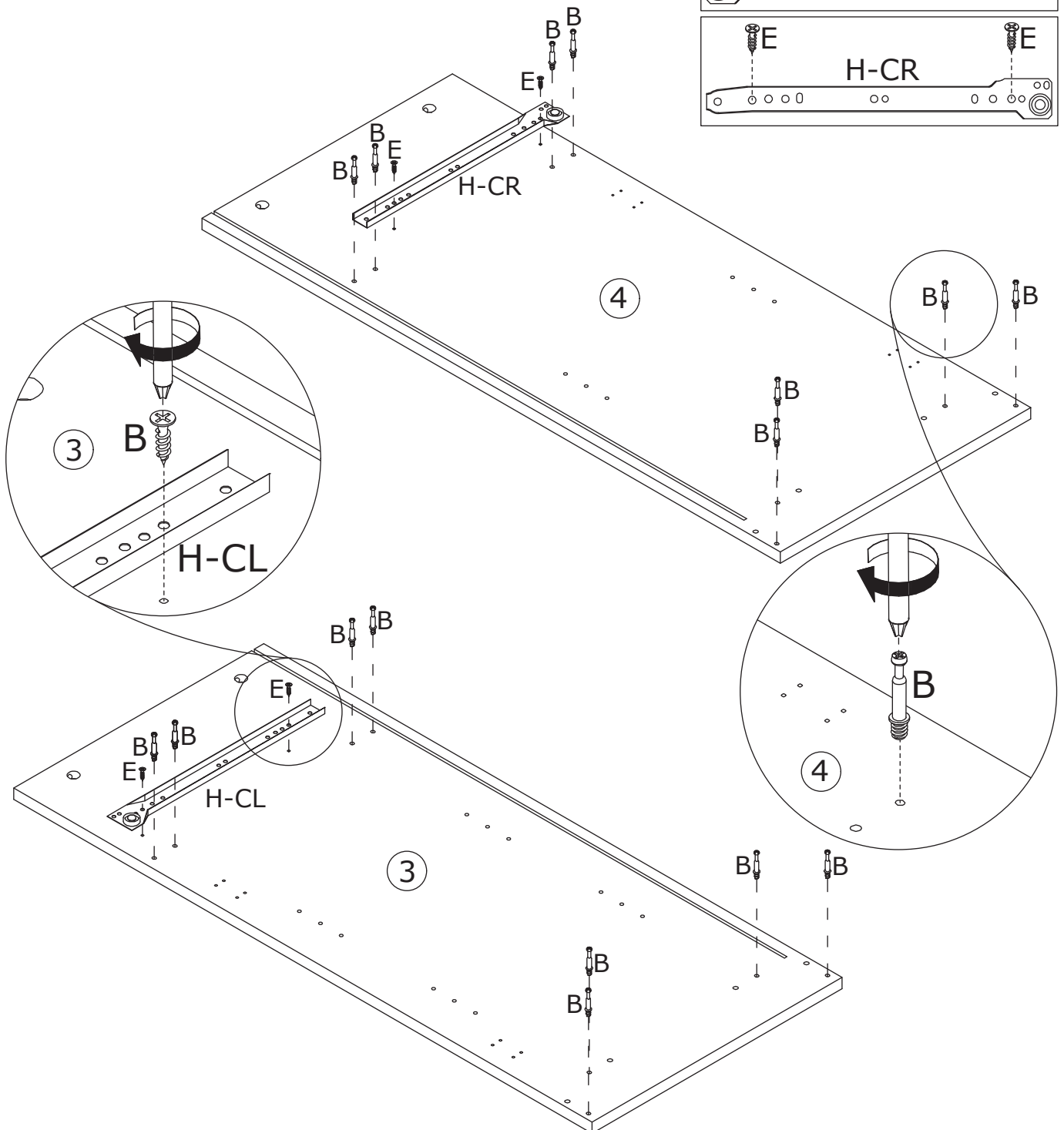
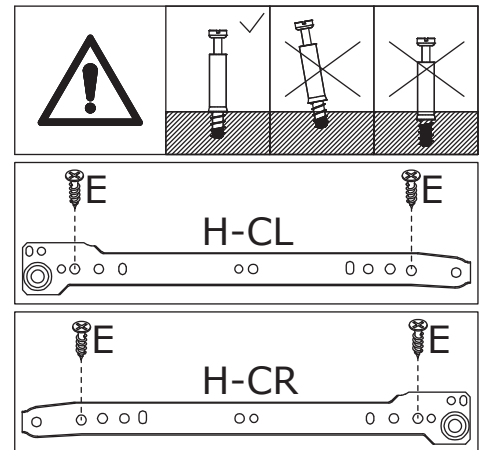

8

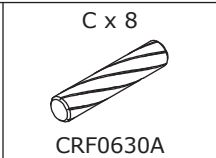
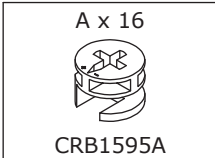

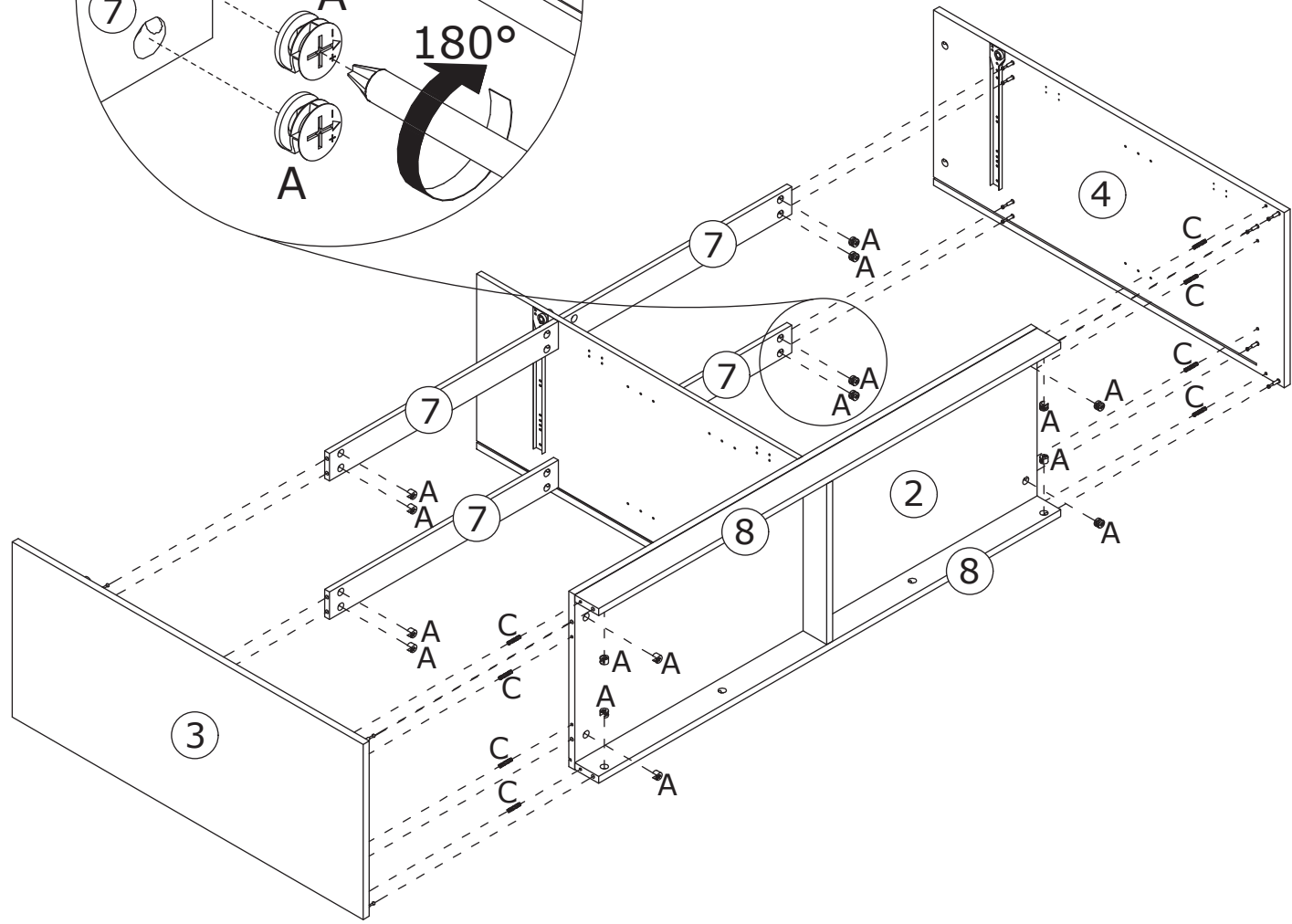
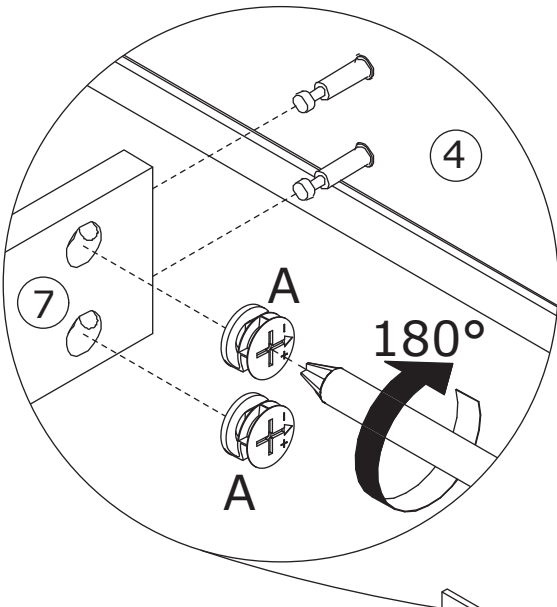
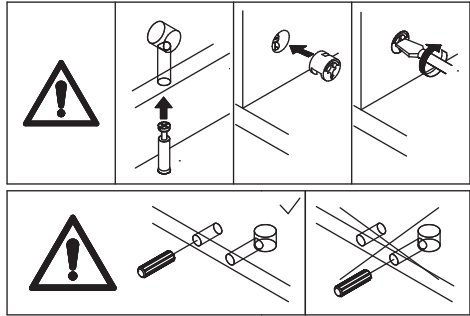

Connect panel 3 and 4 to panel 7, 2 and 8 using wooden dowel(C), add cam lock(A) into and turn clockwise to tighten as shown.

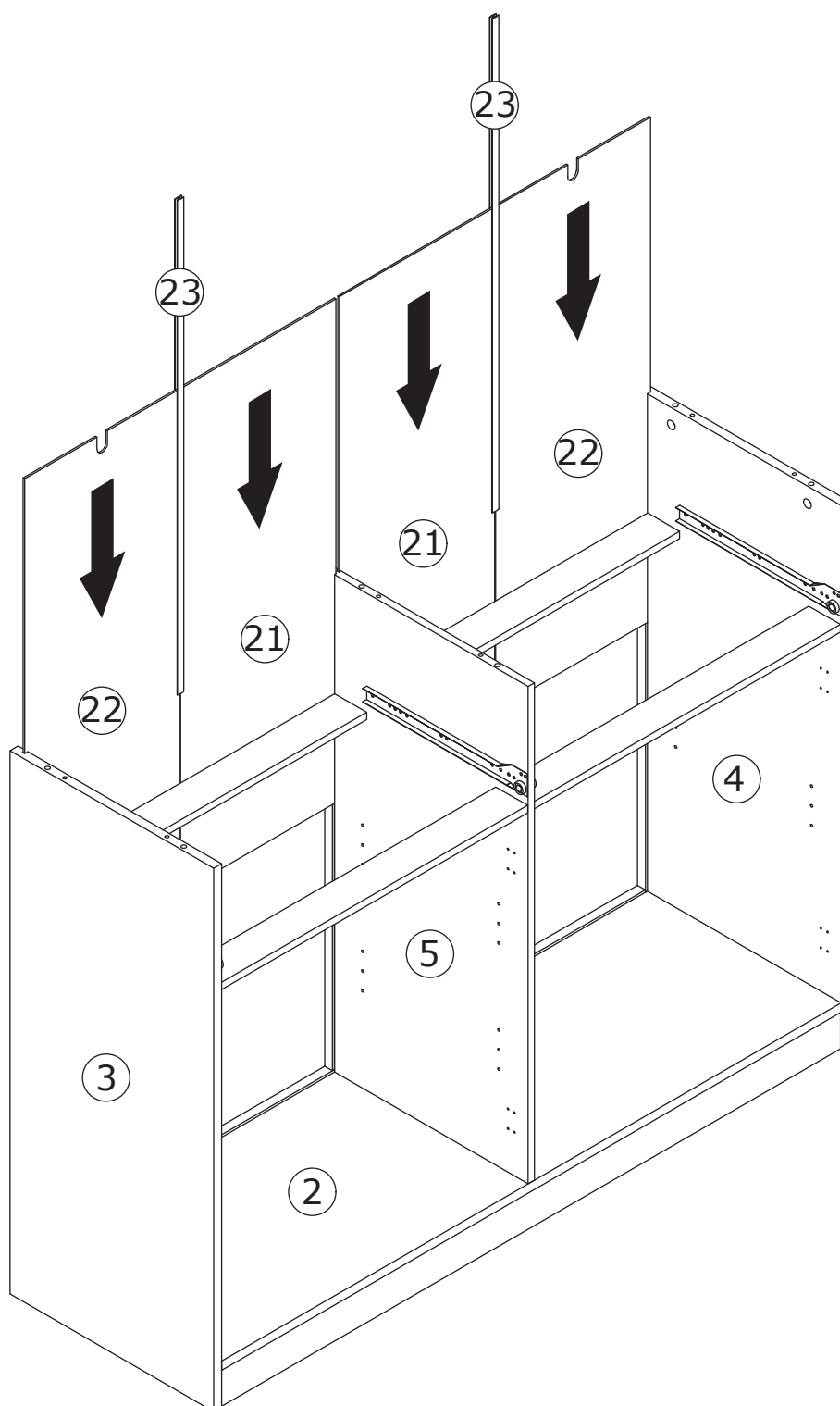

Insert bak panel 21, 22 and plank 23 along available grooves as shown.

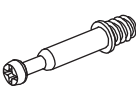
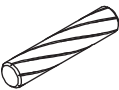

10

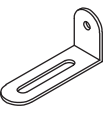
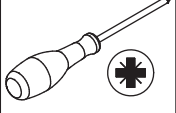
<p>A x 6</p>  <p>CRB1595A</p>	<p>B x 6</p>  <p>CRA0635A</p>	<p>C x 6</p>  <p>CRF0630A</p>	<p>F x 4</p>  <p>CRD3514A</p>	<p>Q x 2</p> 	
--	--	--	---	--	---

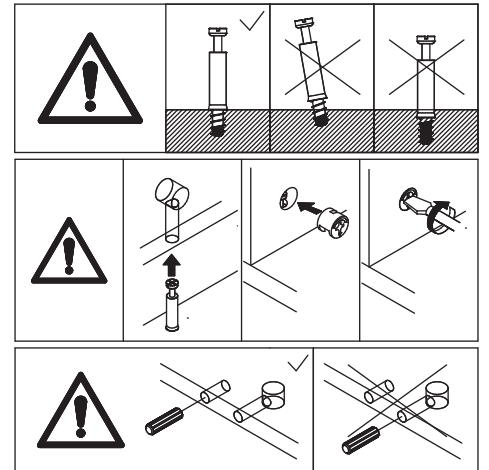
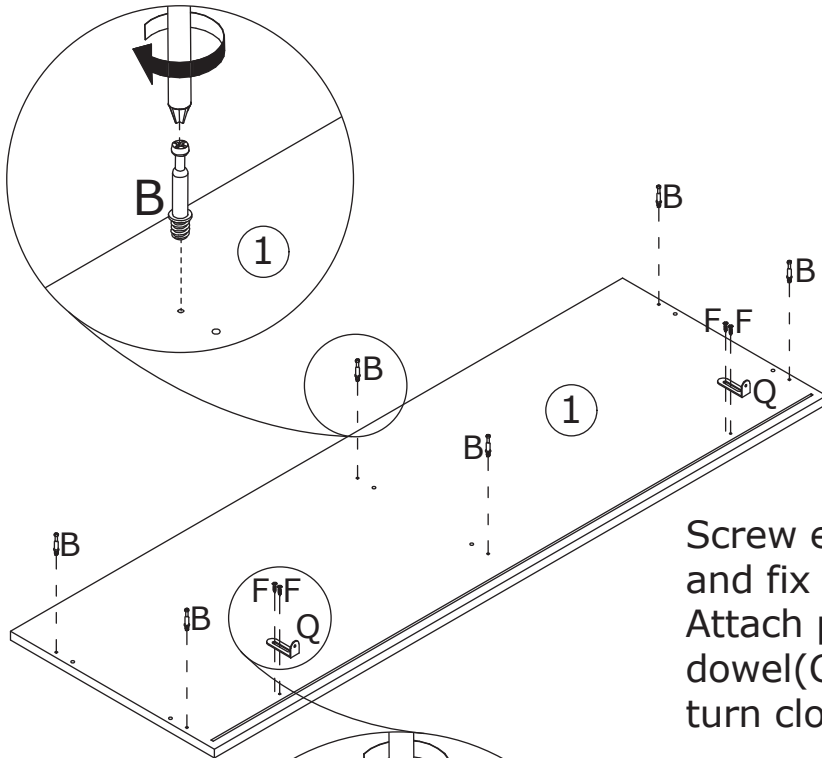

Screw eccentric rod(B) into panel 1 and fix part(Q) with screw(F) at first. Attach panel 1 to top using wooden dowel(C), add cam lock(A) into and turn clockwise to tighten as shown.

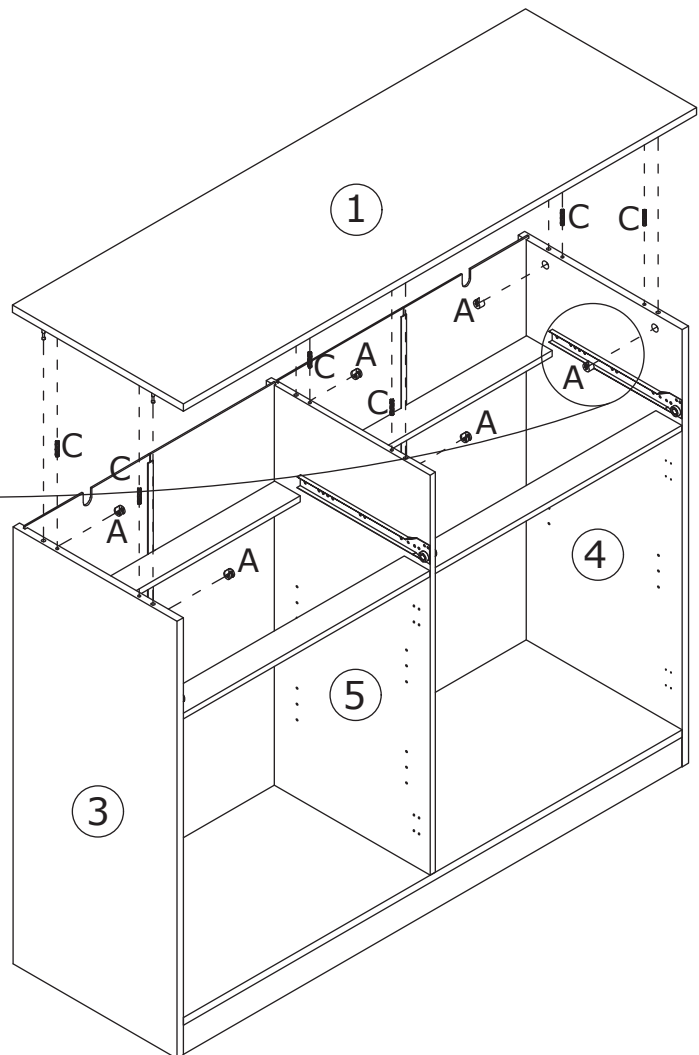
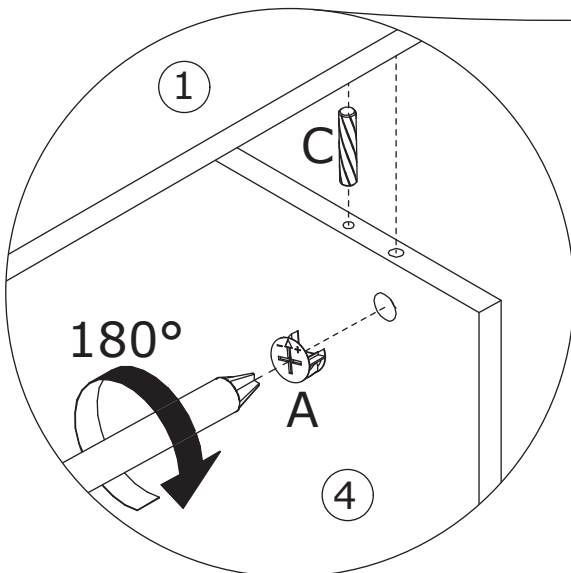
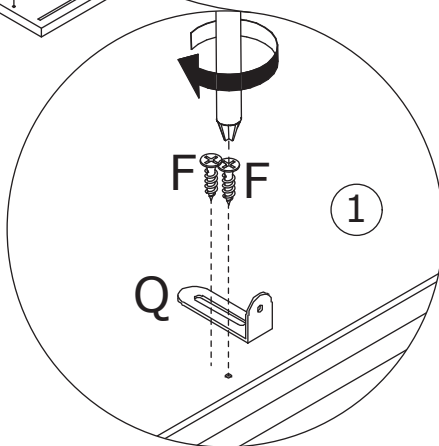



Pay attention to the difference between the middle parts of the two types of door hinges.

- The full coverage door hinges(J) are used on the outermost door plates.
- And the curved door hinges(K) are used on the door panel in the middle of the cabinet.

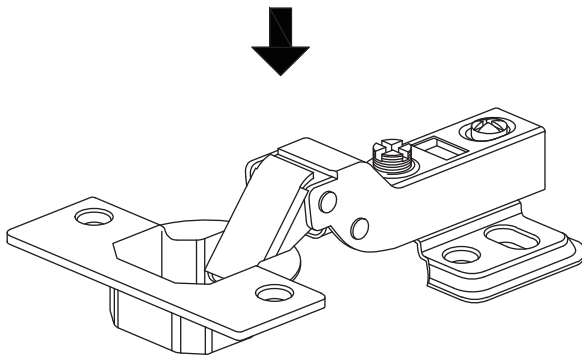

K

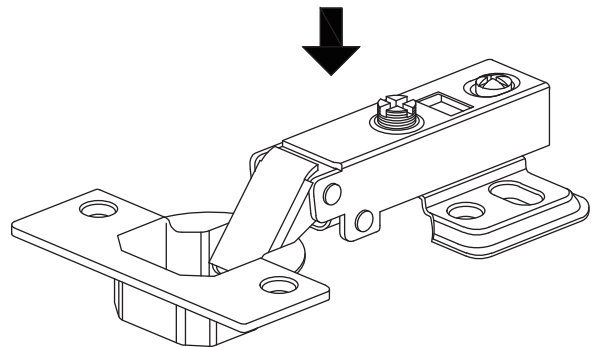

J

12

F x 8



CRD3514A

J x 4

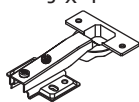

DGA861A

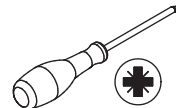

J

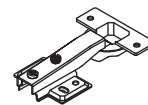

K

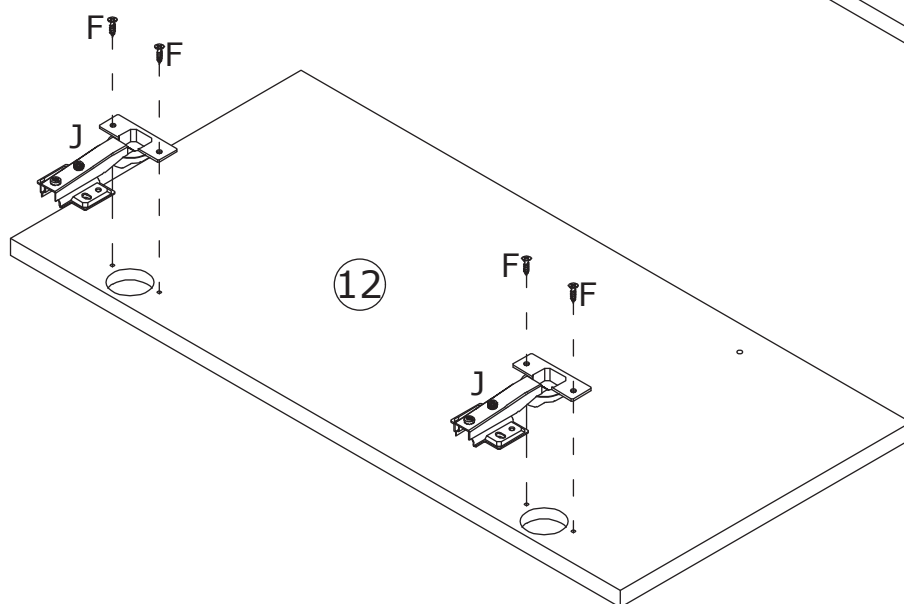
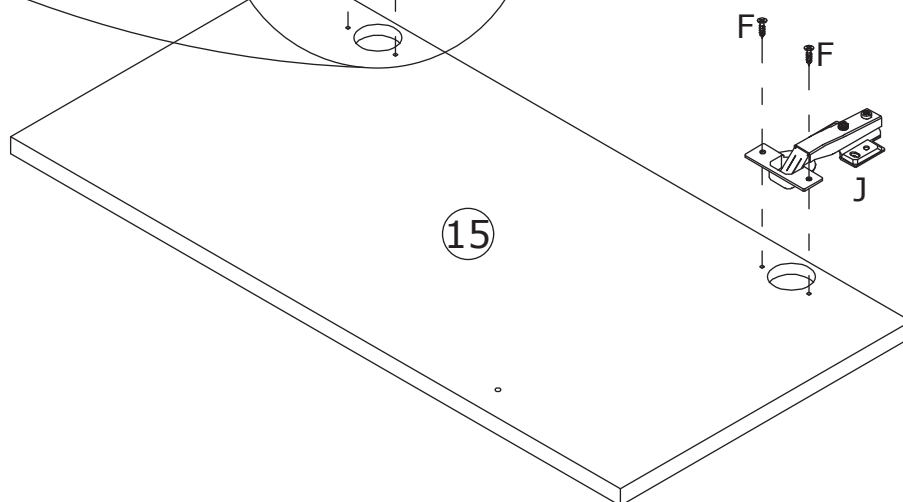
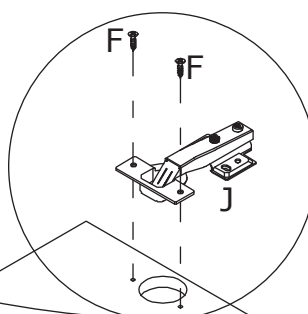
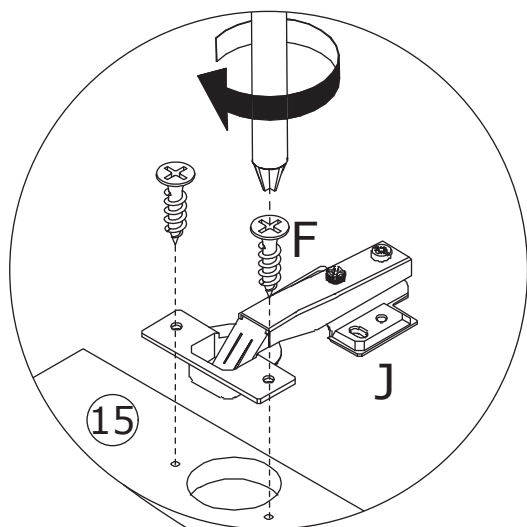
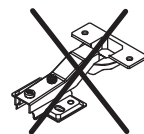

Fix hinge(J) to panel 12 and 15 with screw(F) as shown.

13

F x 16



CRD3514A

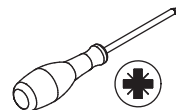

J

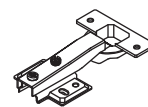

K



Assemble door panel 12 and 15 to panel 3 and 4 by fixing hinge with screw(F) as shown.

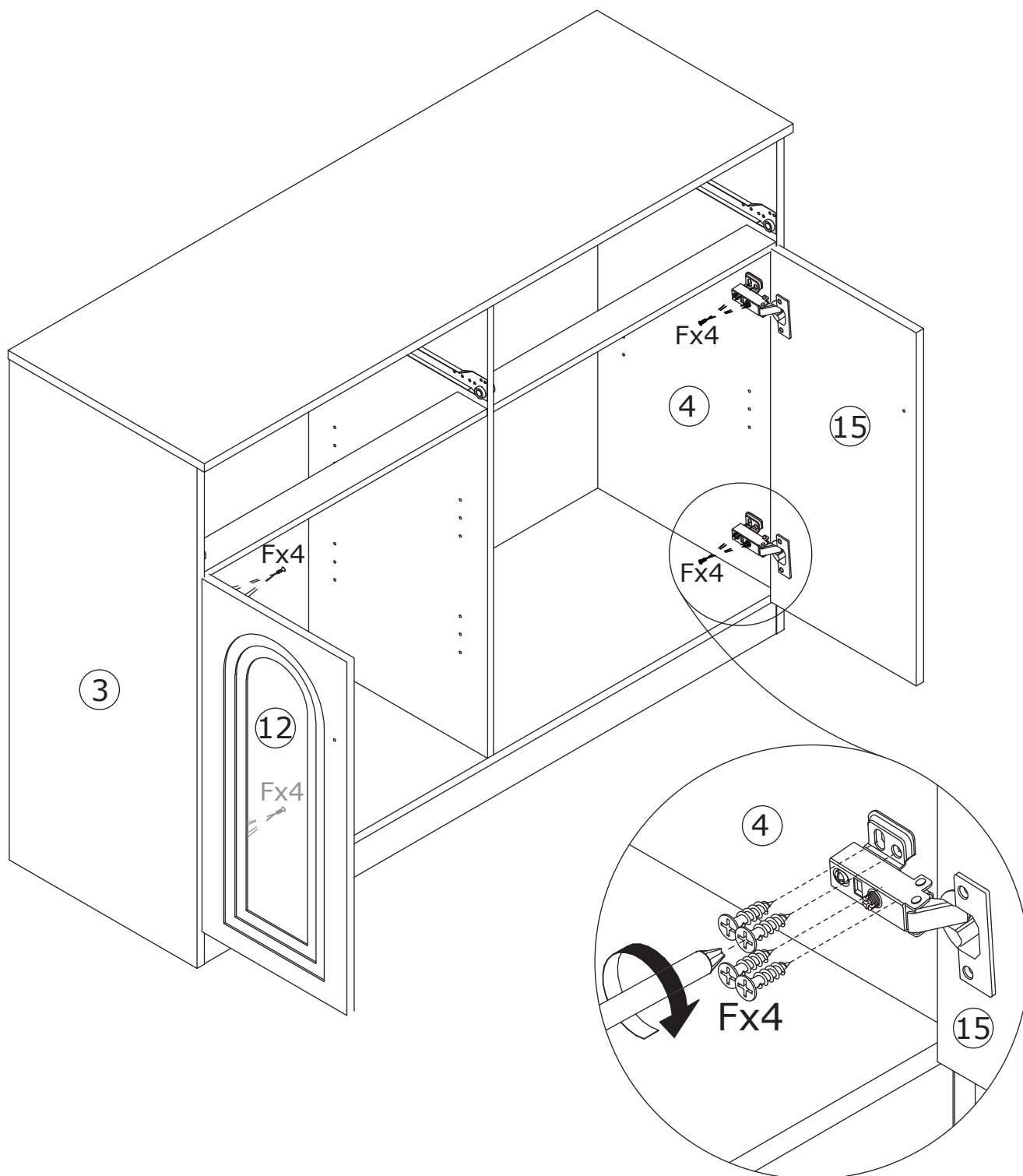

14

F x 8



CRD3514A

K x 4

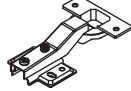

DGA861B

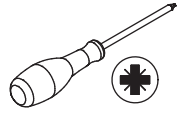

J

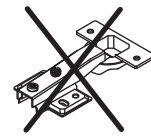

K

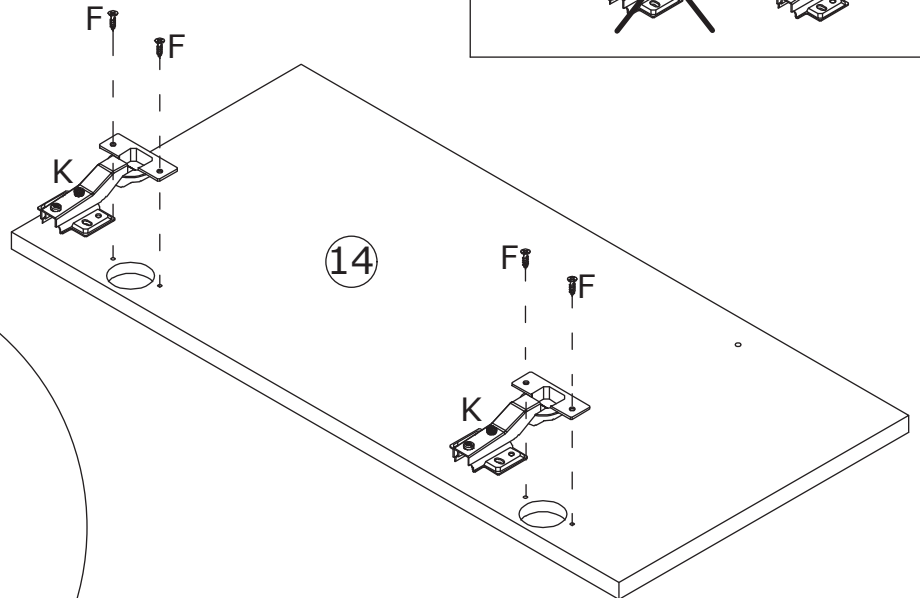
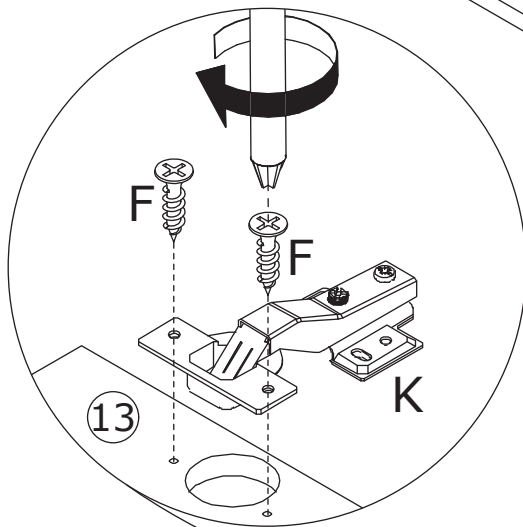
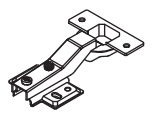

Fix hinge(K) to panel 13 and 14 with screw(F) as shown.

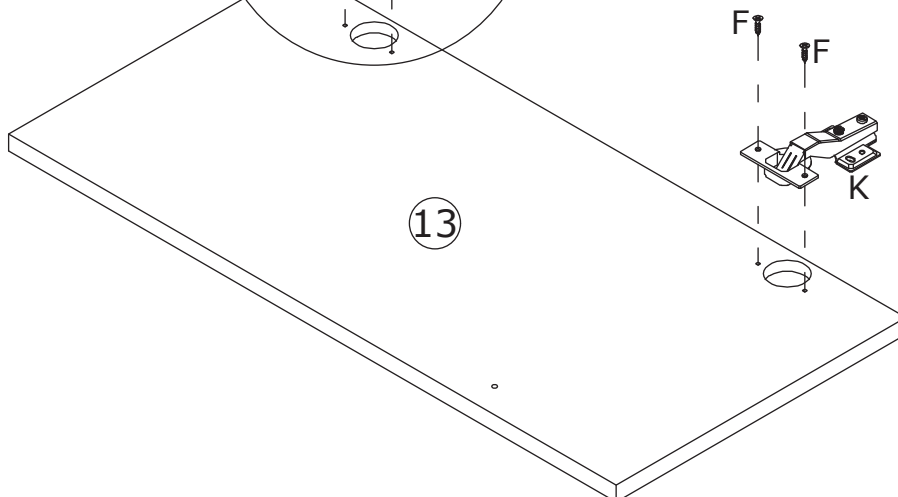
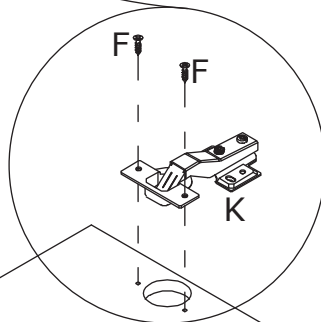

15

E x 16



CRD3512A

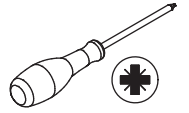

Assemble door panel 13 and 14 to panel 5 by fixing hinge with screw(E) as shown.

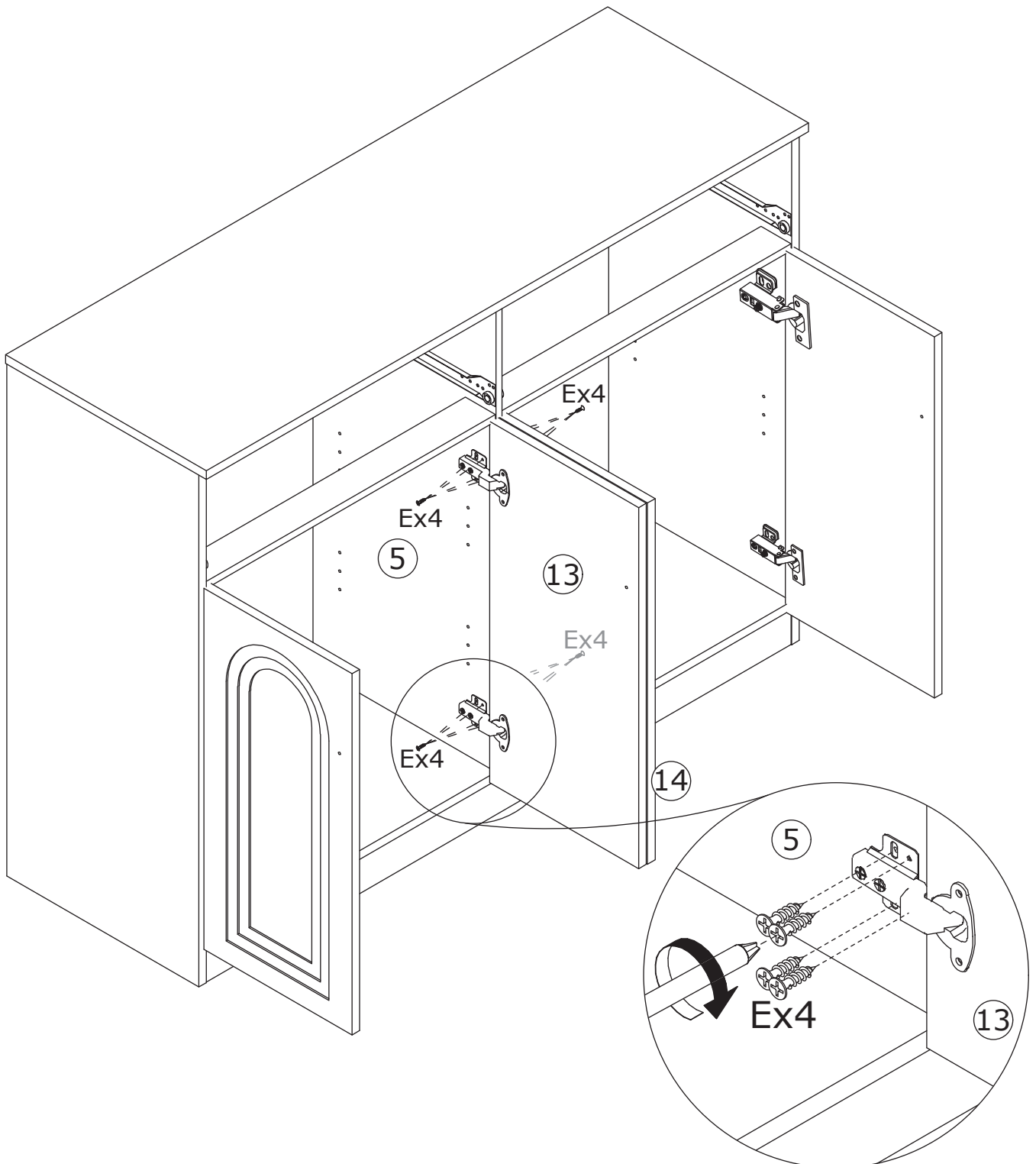

16

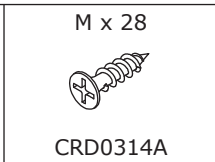
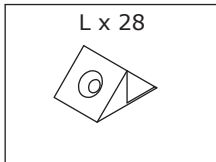

Insert buckle(L) into back slots and fix with screw(M) as shown.

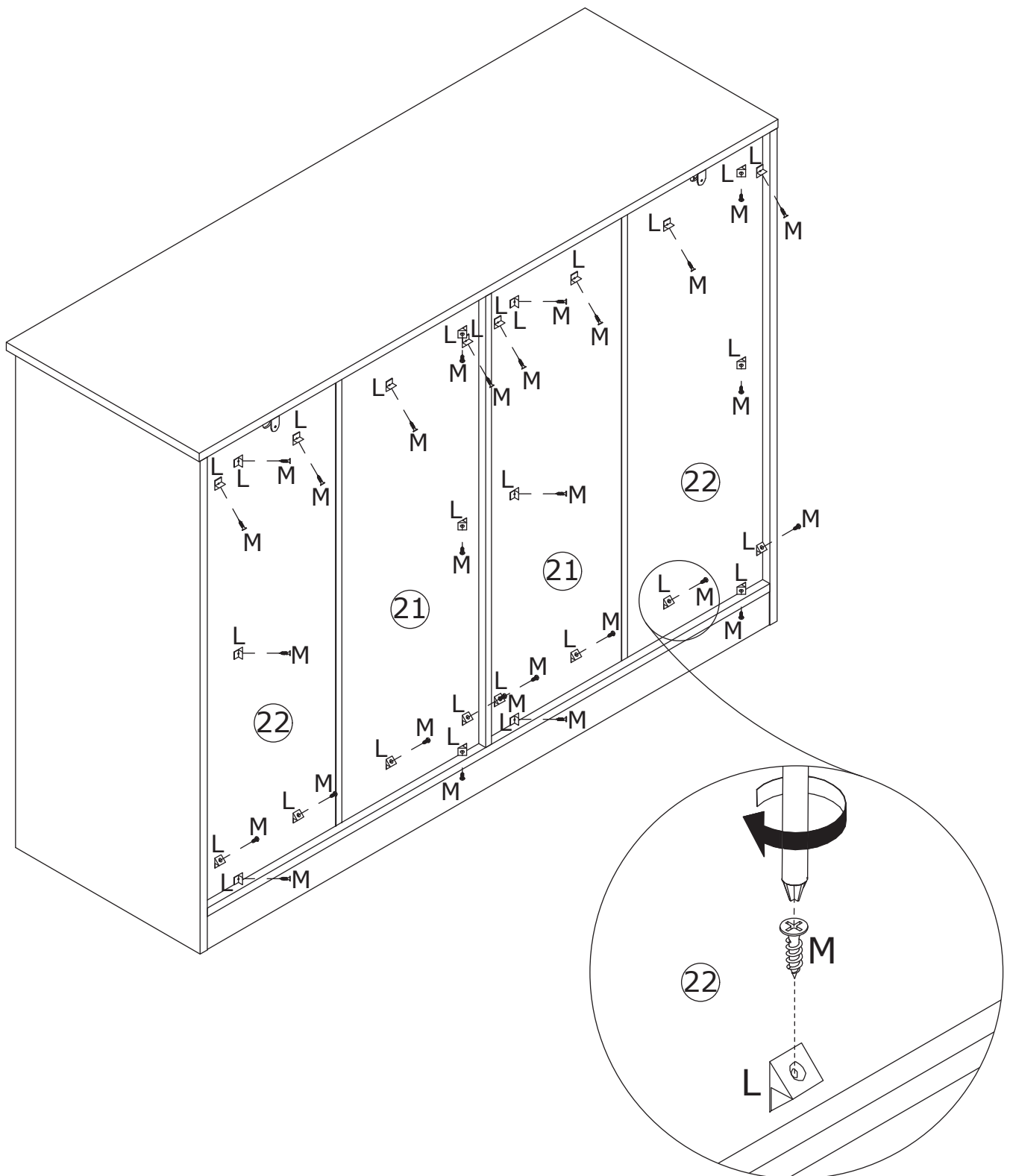

17

R x 2

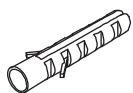

S x 2



CRD3535A

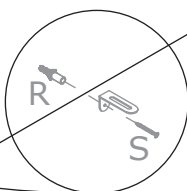
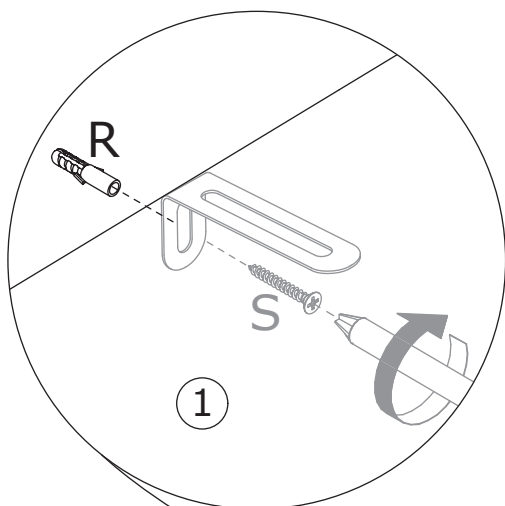
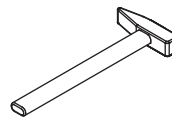
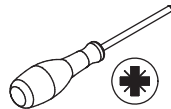
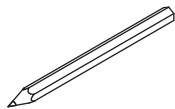

1.

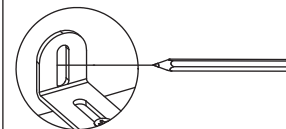

2.

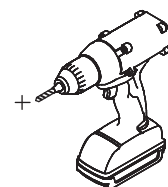

3.

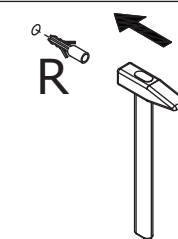

4.

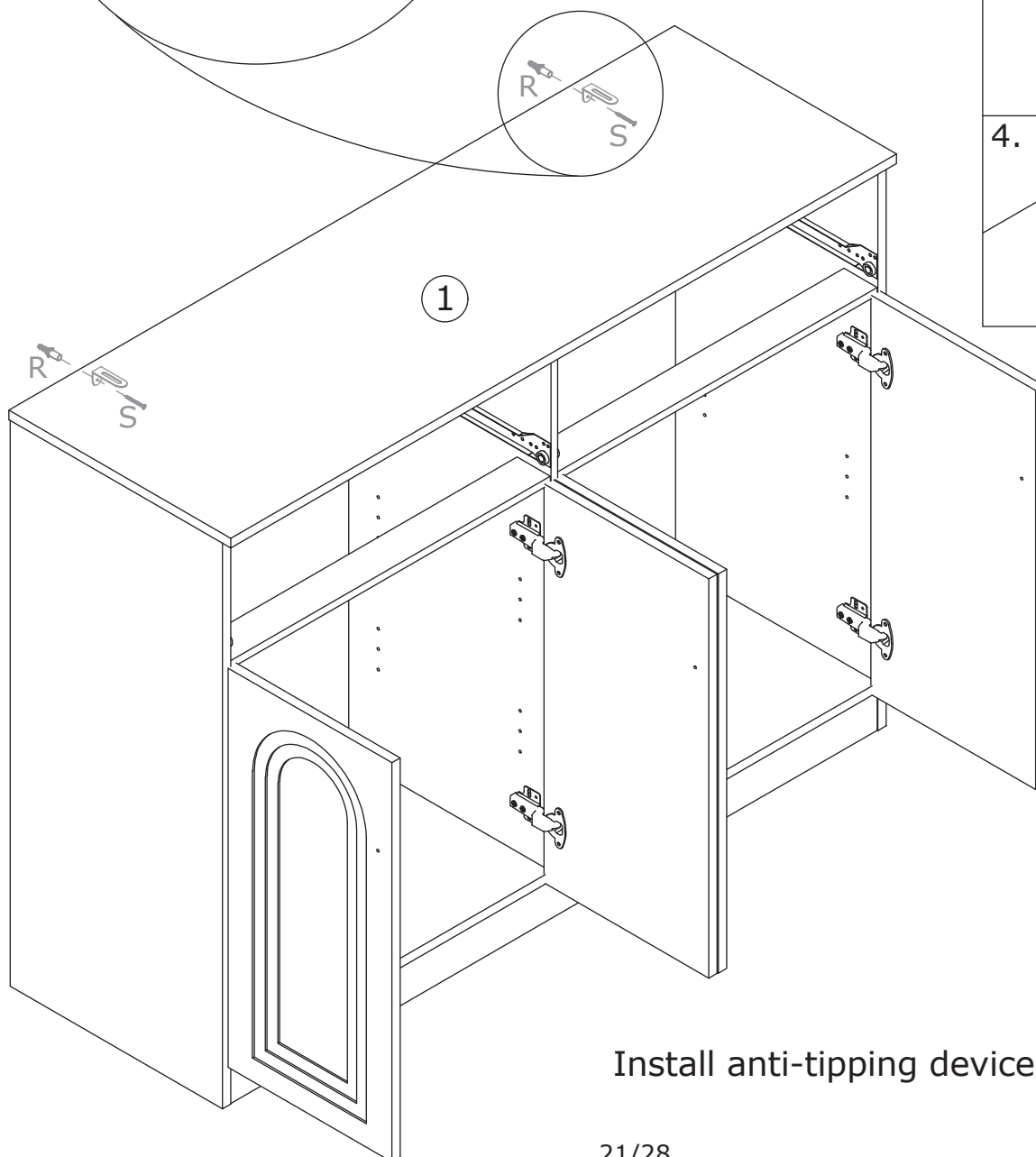
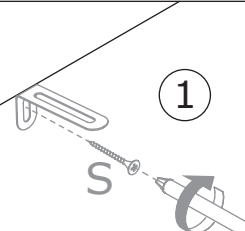

Install anti-tipping device as shown.

18

I x 12

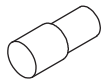

Insert layer pin(I) into panel 3 ,5 and 4.

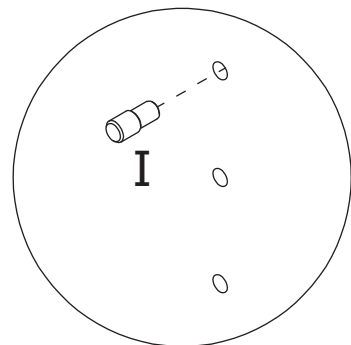
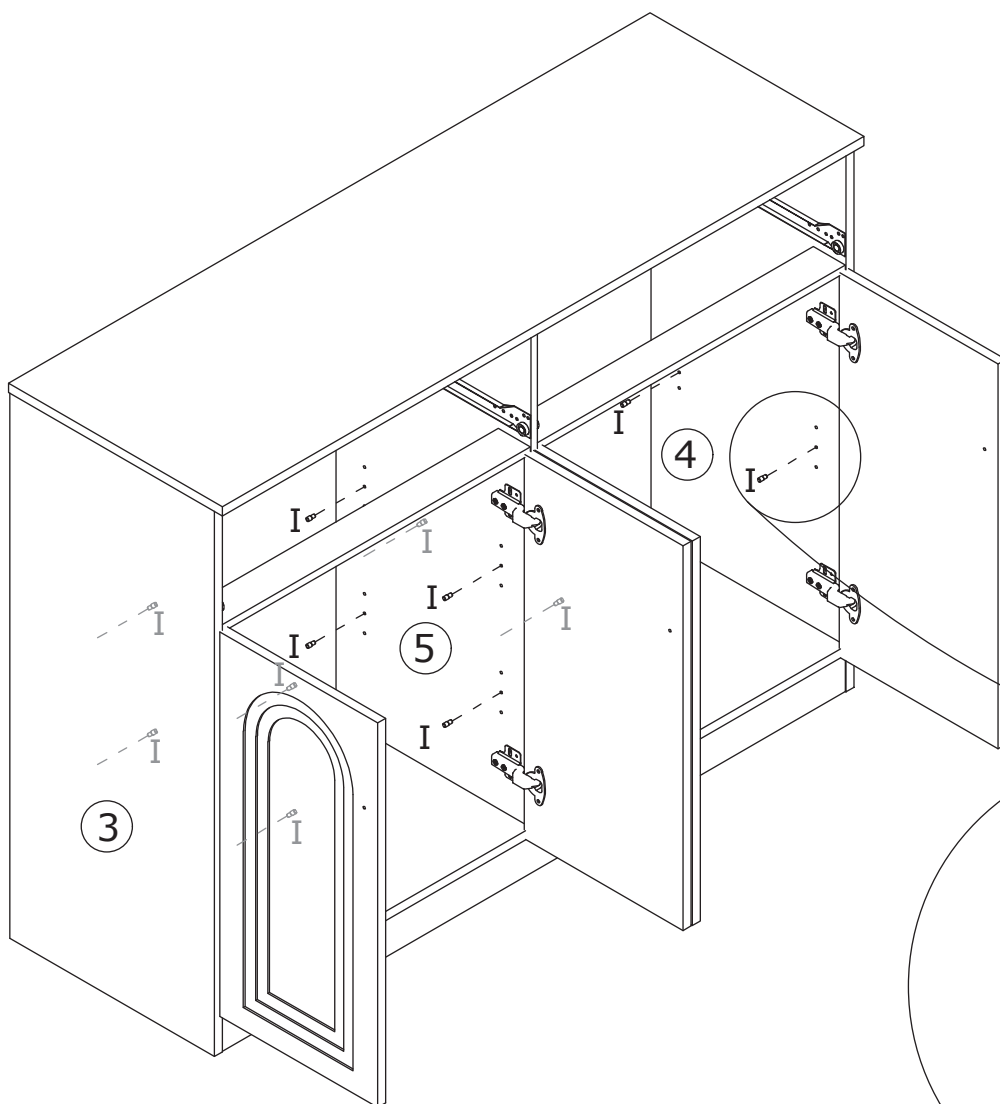

OR

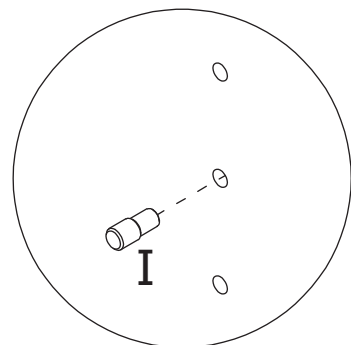

OR

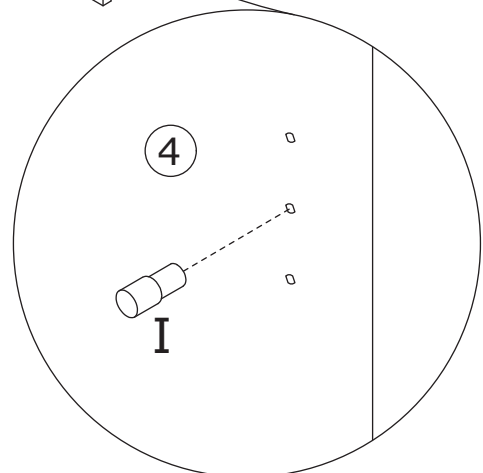
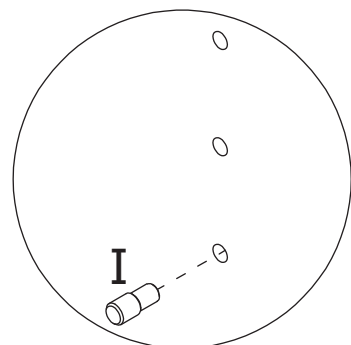

19

Place shelf panel 6 on.

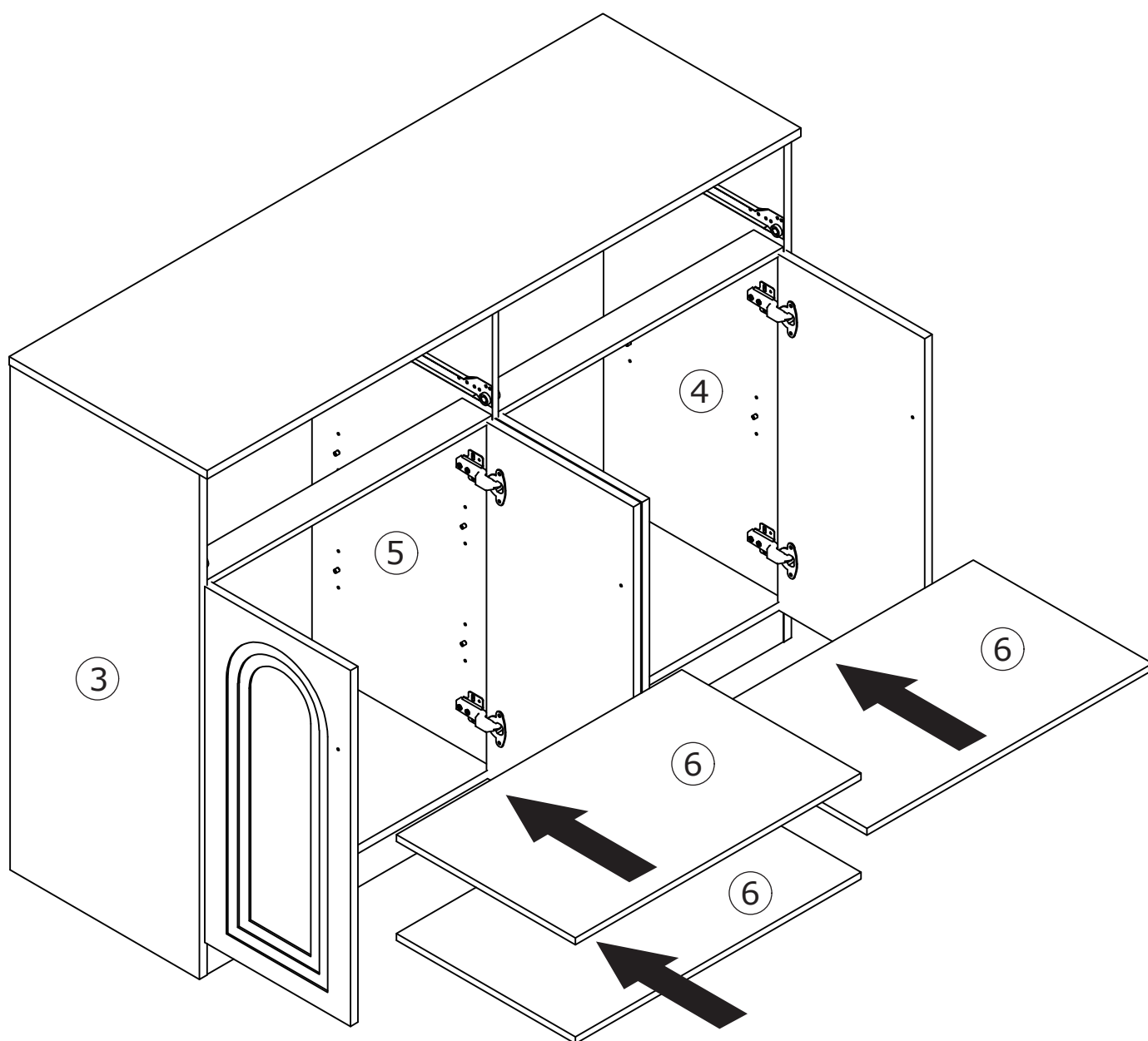

20

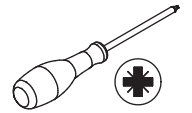
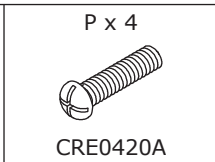
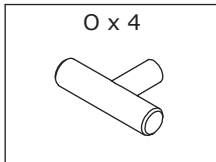

Fix handle(O) with screw(P) as shown.

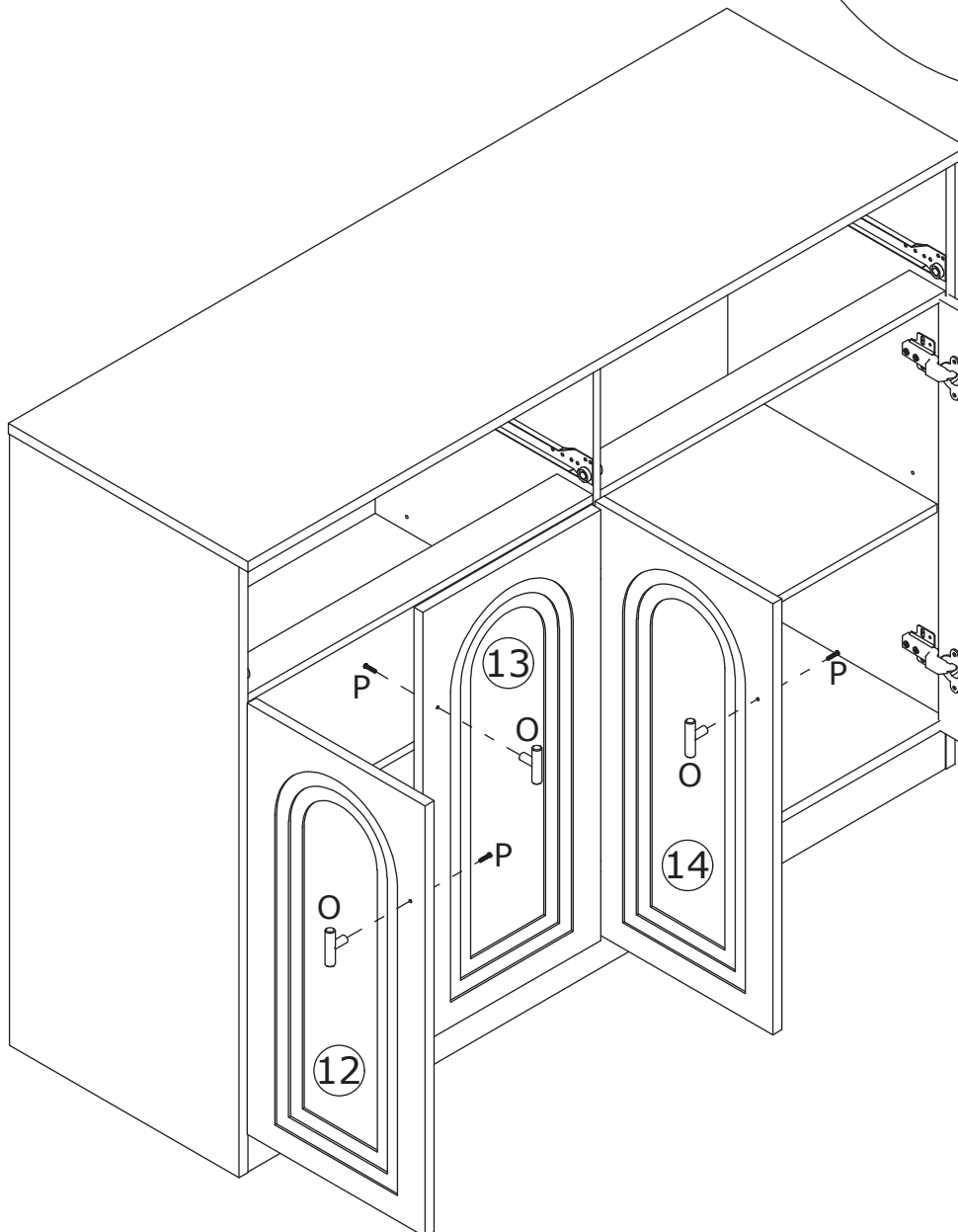
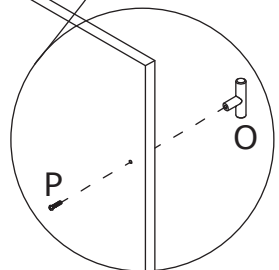
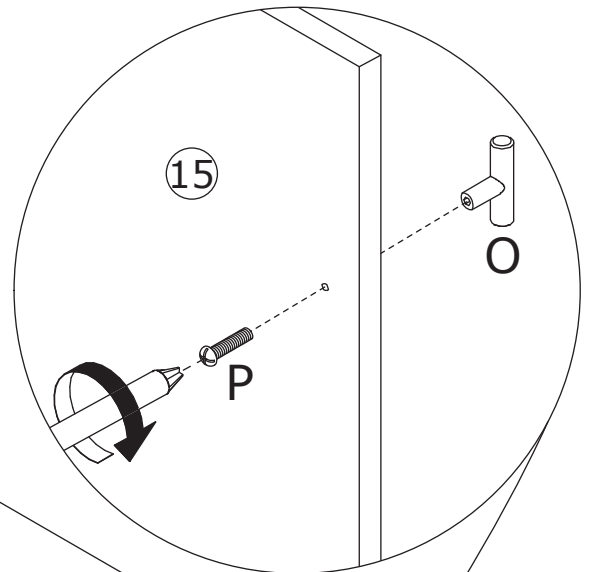

21

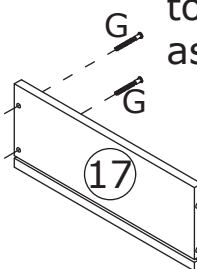
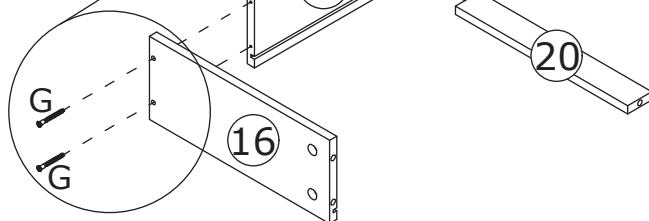
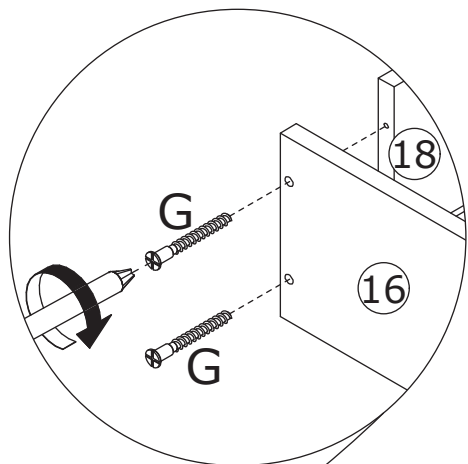
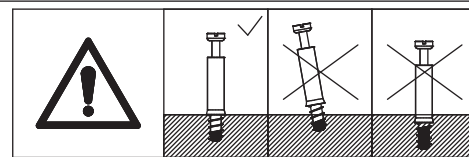
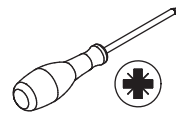
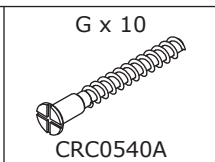
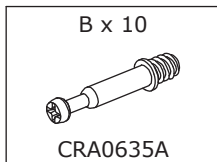

Fix panel 16, 20 and 17 to panel 18 with screw(G) as shown.

x2

Insert panel 19 along available grooves.

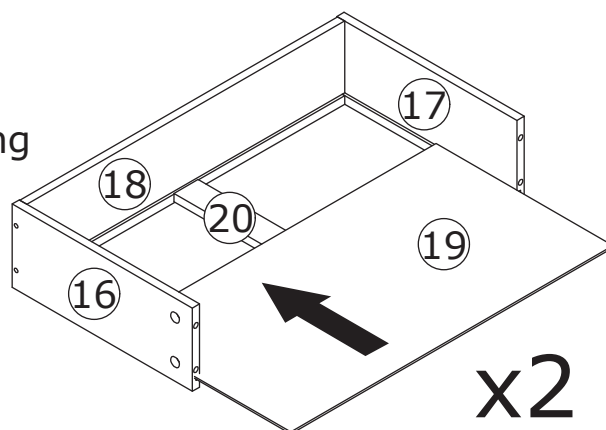

x2

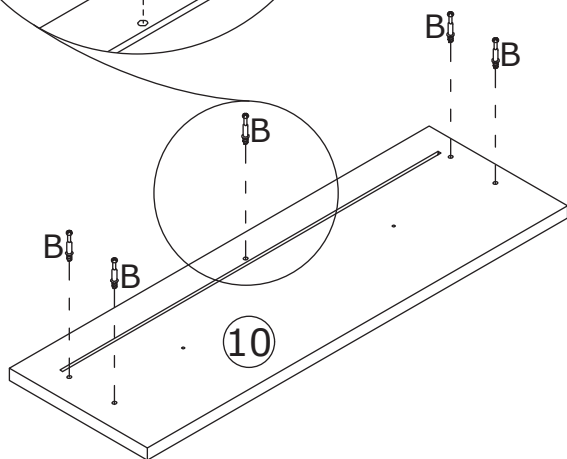
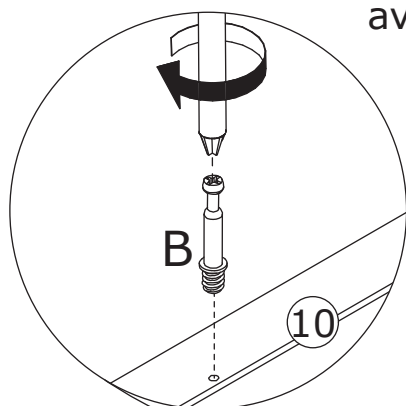

Screw eccentric rod(B) into panel 10 and 11 as shown.

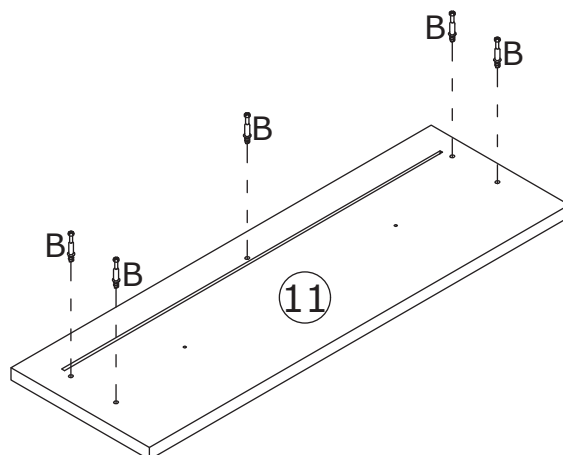

22

A x 10



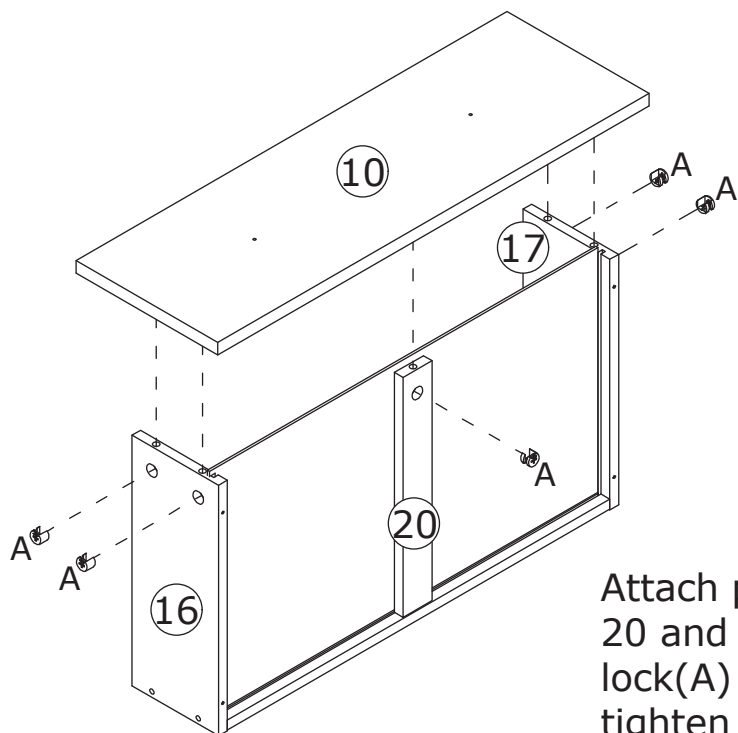
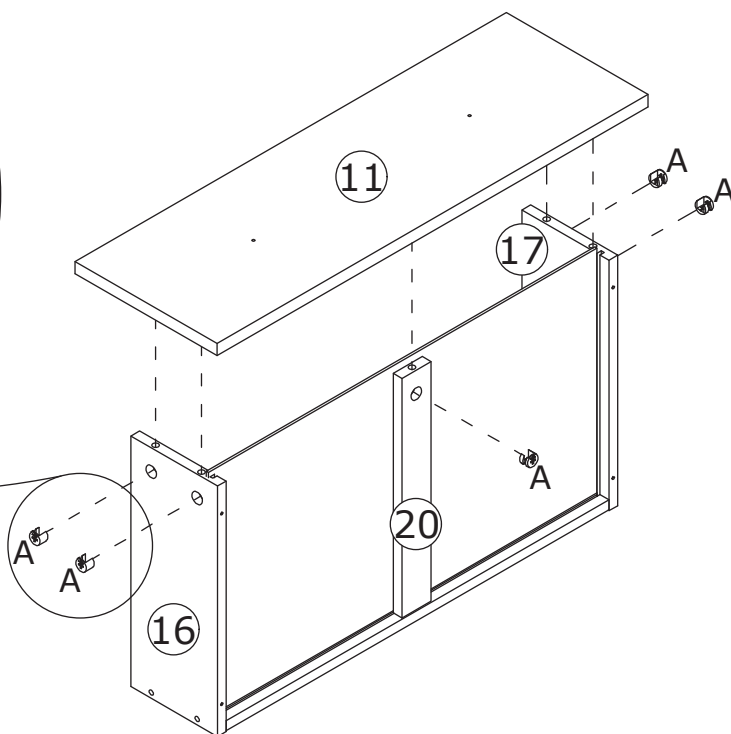
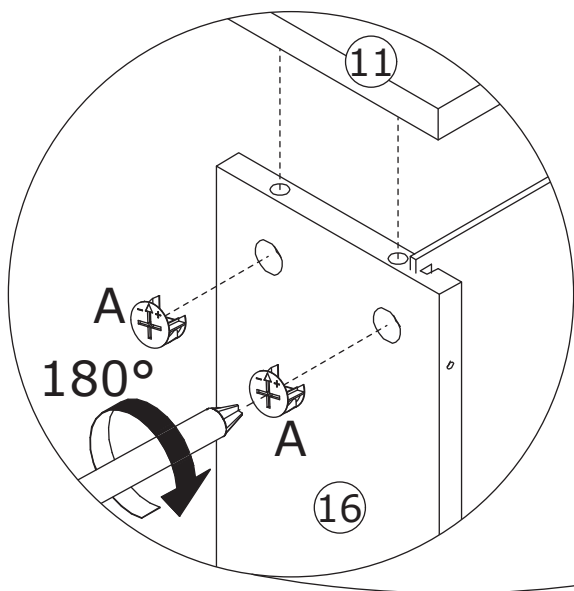
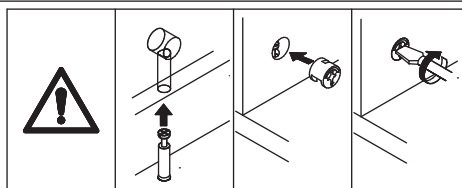
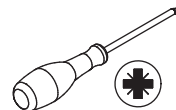

CRB1595A



Attach panel 10 and 11 to panel 16, 20 and 17 respectively, add cam lock(A) into and turn clockwise to tighten as shown.

23

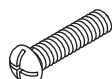
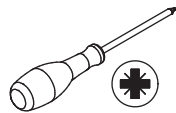
<p>E x 8</p>  <p>CRD3512A</p>	<p>H x 2</p> <p>CL</p>  <p>CR</p> <p>WX0812A</p>	<p>N x 4</p> 	<p>P x 4</p>  <p>CRE0420A</p>	
--	---	--	---	---

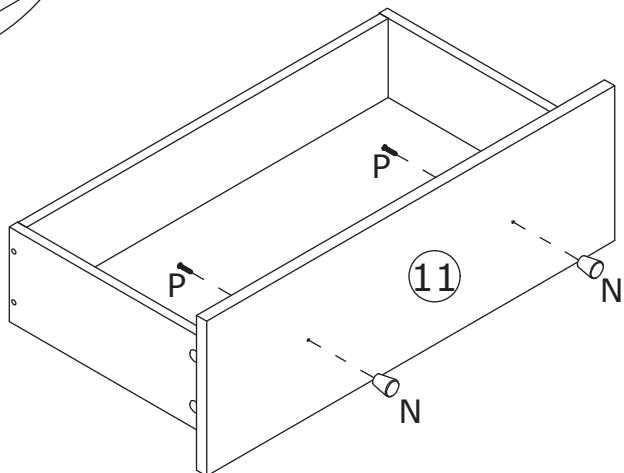
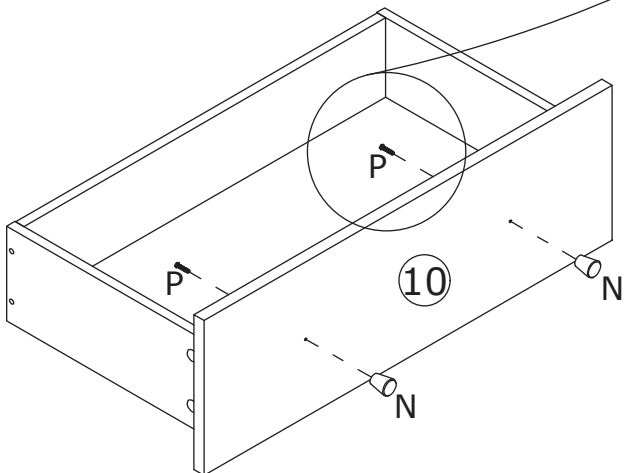
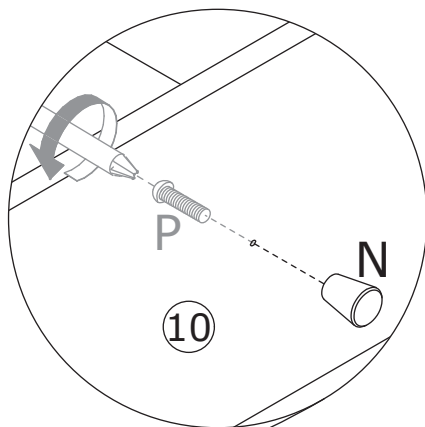

Fix knob(N) with screw(P) as shown.
Fix track(DL) and (DR) to panel 16 and 17 with screw(E) as shown.

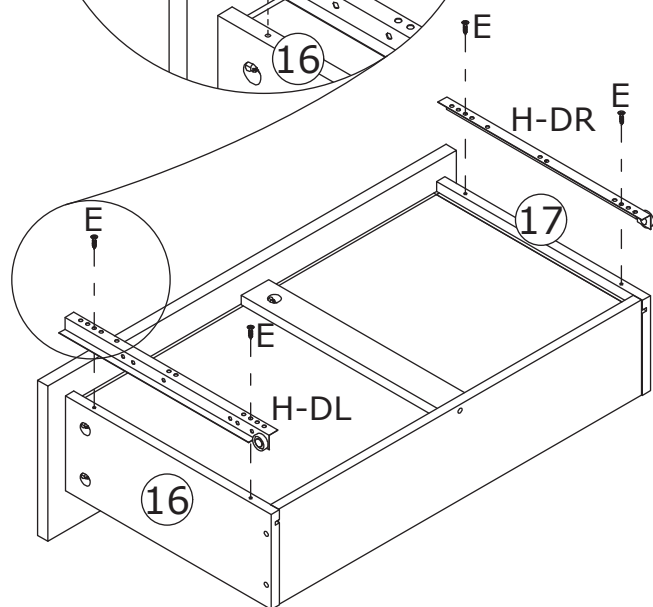
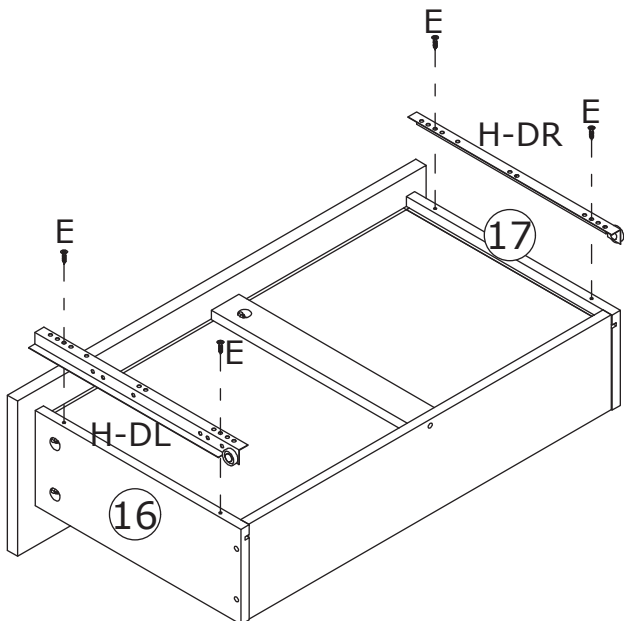
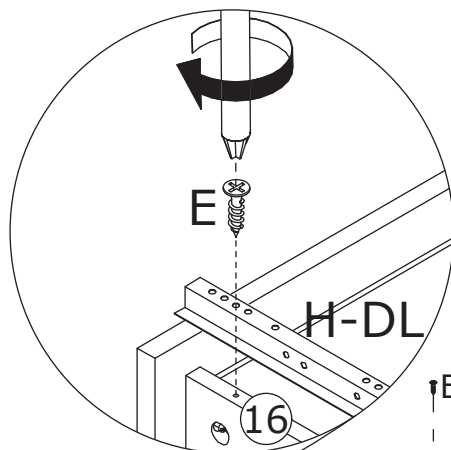

24

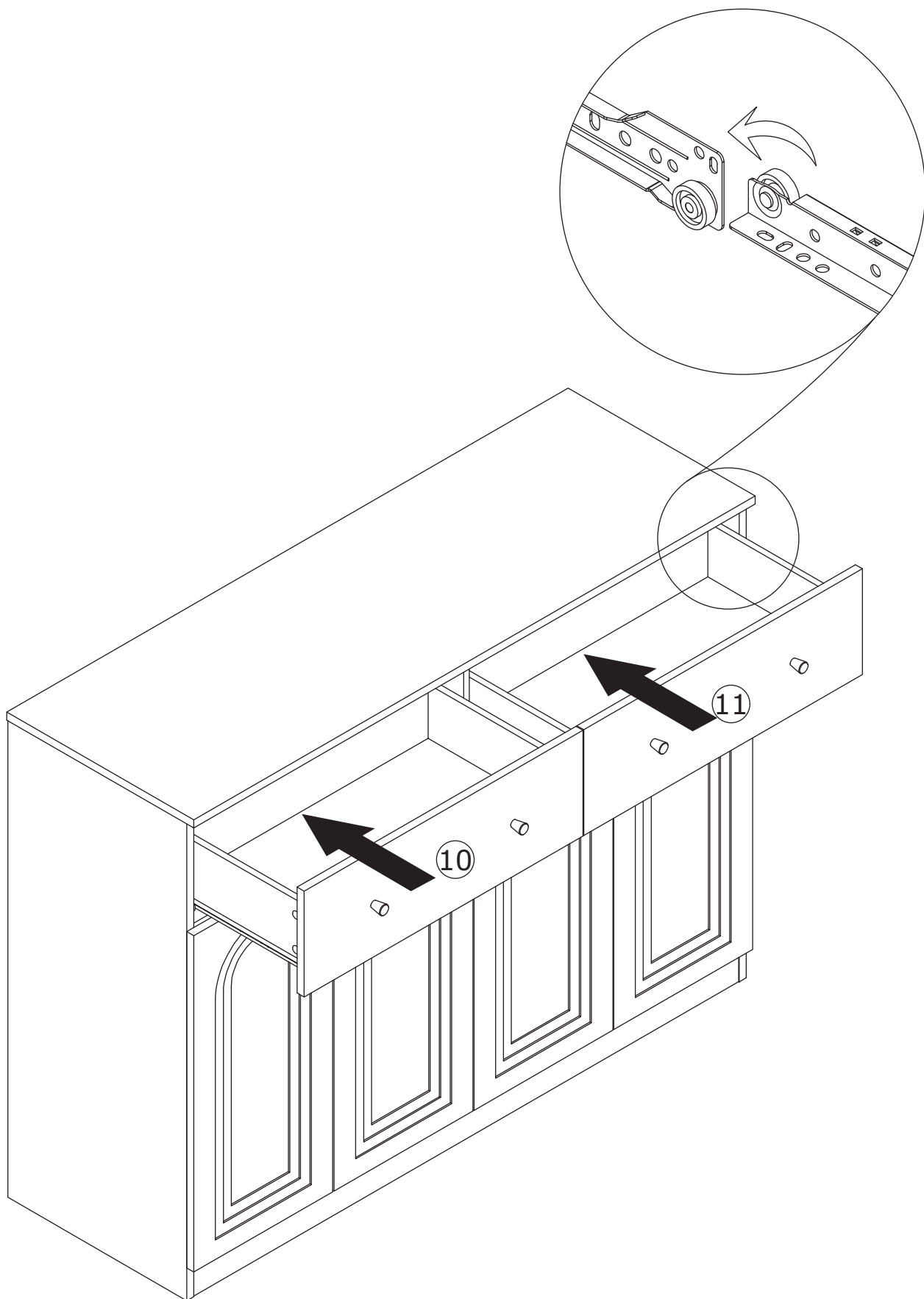

WARRANTY

WARRANTY CLAIMS

- There is a 30-day warranty for broken furniture or any other problems that do not work properly. The warranty will start from the date of purchase which must be verified by proof of purchase.
- Before making a claim, we may be able to answer your query, simply call us. Please leave your purchase order number, along with some details of the problem, if you want a replacement part. We will arrange within 48 hours. If there is out of stock, we will reply with a shipping date.
- The product must be used in accordance with the instructions provided. For health reasons.
- For other reasons, if the furniture needs to be returned, it must be cleaned and dried and operated within 30 days of receipt.

Type of Warranty Claim

- Failure to follow the furniture instructions will invalidate the warranty. Attention please.
- Does not include damage during installation, but includes damage during transportation.

Scope of responsibility

- Shall not bear any responsibility for misuse or user damage and / or loss of parts during the installation of furniture.
- After using, the damage and scratches of the furniture are not covered by the warranty.

The Warranty Relates to All Bought in The Us and Covers The Following Areas

- Sheet parts: 1 month from the date of purchase.
- Electrical parts: 1 month from the date of purchase.