

User Manual

Thanks for purchasing Dreamvan heat press machine. This machine adopts microprocessor program control, featuring high precision in parameter memory and control, comes with digital dual display control box, more steady and accurate.

It can bake and fabricate colorful logos, portraits & photos, as well as scenery patterns, etc. It is applicable for baking cup, baking tray, baking hat, heat transfer clothing T-shirt, mouse pad, pillow and metal ornaments, and metal ornaments, etc. It also can be used as the individualized article, integrating artistic appreciation and utility.

Please read this user manual carefully and keep it in a safe place for future reference. If you need any assistance, please contact Dreamvan customer support by email at dreamvan_suport@yeah.net.



NOTE: Heat Press Machine 1 in 1 Package Include:
A x Heat Press Machine (telfon-coated)
(T-shirts, cups and hats are NOT included.)

NOTE: Heat Press Machine 5 in 1 Package Include:
A x Heat Press Machine (telfon-coated)
D x Hat press 5.5"x 3"(14*8cm);
C x Mini Mug Press (3"-3.5" diameter, 11OZ);
E x Plate Press 6"/8"
1 x User Manual

NOTE: Heat Press Machine 8 in 1 Package Include:
A x Heat Press Machine (telfon-coated)
D x Hat press 5.5"x 3"(14*8cm);
E x Plate Press 6"/8";
B x Mug Press(3"-3.5" diameter , 11OZ);
H x Mug Press(Aluminum bottle heating pad)
F x Mug Press 9oz mug
G x Mug Press 12oz latte mug(cone)
1 x User Manual

Transfer Parameter(for reference)

T shirt (sublimation)	T shirt (PU flex film)	Pillow	Cap	Rock photo	Crystal	Aluminum sheet
200°C(392°F) 60S	170°C(338°F) 25S	200°C(392°F) 60S	200°C(392°F) 40S	190°C(374°F) 400S	190°C(374°F) 720S	170°C(338°F) 100S
Mug	Magic mug	Plate	Sport bottle	Aluminum sheet	Glass frame	
180°C(356°F) 60S	180°C(356°F) 60S	200°C(392°F) 420S	180°C(356°F) 60S	170°C(338°F) 100S	180°C(356°F) 300S	

Features:

- 1.Digital dual displays are controlled with microprocessor, which brings higher accuracy, real-time display.
- 2.Auto timer & alarming clock.
- 3.It's heating more even and can make the printing effect better through the double heating tube design, as the temperature difference is only about 5 degrees from the Central and the edge,and the old machine design difference can be 10 more degrees.
- 4.360°swivel design for easy transport.
- 5.Place a heat-resistant silicone rubber foam mat and High temperature sponge pad on the base,
- 6.The plate heating pad adopts the latest design, The plate is better in color and the pattern size is larger.
- 7.Easy to switch between degrees Celsius and Fahrenheit

Main spare parts:

1. Pedestal
2. Placement
3. Heating plate
4. Handle
5. Aviation connector
6. Button
7. Lift knob
8. Overload protector
9. Power socket
10. Power switch
11. Column

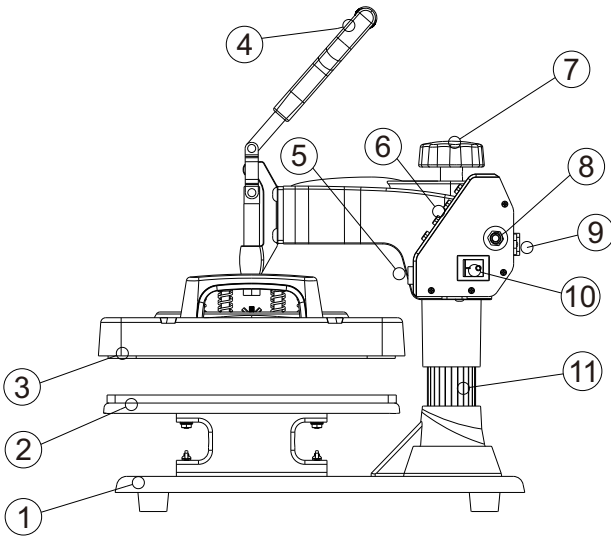

Control box introduction:

- + Plus
- Minus
- ⚙ Setup
- 👤 Mode

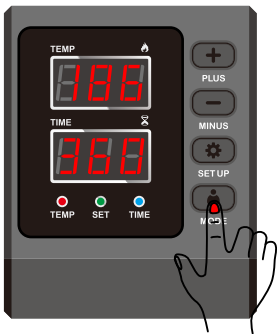
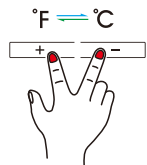

Note: Press (+/-) to switch Fahrenheit and Celsius

How to set the control box

1,How to turn on/o f fand how to start?

- 👤 Press the switch button on the side of the thermostat to start the machine.
Press once to count down and press again to reset.

2,How to set the temperature/time?

- ⚙ Press once to set the temperature, press twice to set the time and press again to exit. (It will automatically exit the temperature/time setup state in case of on operation within 5s.)

3,How to set the temperature/time to increase or decrease?

- + Set the temperature/time increase
- Set the temperature/time decrease

4,How to change the temperature unit from °C to °F?

In the power-on state, press “+” and “-” at the same time to change the temperature unit between °C and °F.

5,How to set auto shutdown time?

- 👤 Press and hold for 5s, to set the auto shutdown time.
(The factory default is 60min and the range is from 10min to 120min)

6, How to do temperature correction?

- ⚙ Press and hold for 5sec to enter the tempertature correction setting. (Range ±30°C (86°F). initial value is 0)
(If the machine temperature and strength temperature do not conform to the situation)

7, How to turn on/off the beep sound?

In the shutdown state, press “-” to turn o ffthe sound and OFF is shutdown; Press again to turn on the sound and shown.

8, Tips:The max, set temperature of this machine is 210°C (410°F) and the longest time is 999sec.

Heat Press Machine Users' Guide

Thank you for purchasing our product, We appreciate your business. It is a multi-purpose heat press machine with which you can apply it on T-shirts, caps, mugs and Aluminum Bottle. however, It does require different attachment to make it compatible with different tasks.

I, Attachment for T-shirts

The machine is defaulted to T-shirt mode, The default temperature is 200°C (392°F) while the timer is set to 60s.

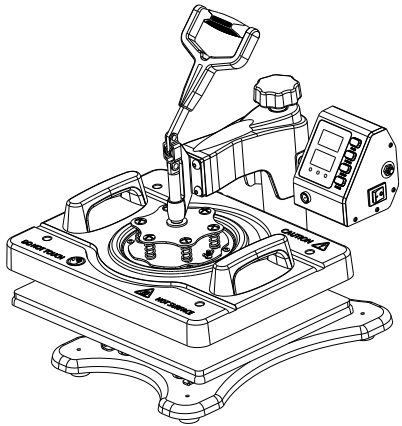

2,Attachment for caps/hats installation.

The whole attachment easily slides in/out , after taking out the previous attachment, insert the attachment for caps/hat and slide it in, fix it with screws.

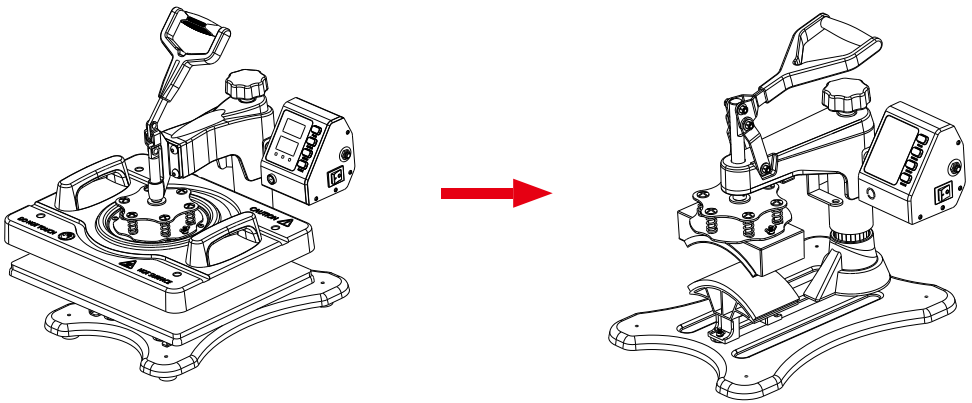

3.Attachment for cups and cylindrical objects installation

This attachment do not need to install and just need to plug in the control box, then it will work, If you want to replace the cup, looser the clamp and replace the cup.



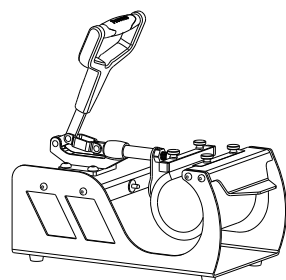

4.Ceramic plate installation

The new baking plate mat does not need to disassemble the machine. Paste the picture on the plate. Take out the sponge plate mat and put it on the pasted picture .Set the temperature to 200°C (392°F) Fahrenheit and the time to 900s.

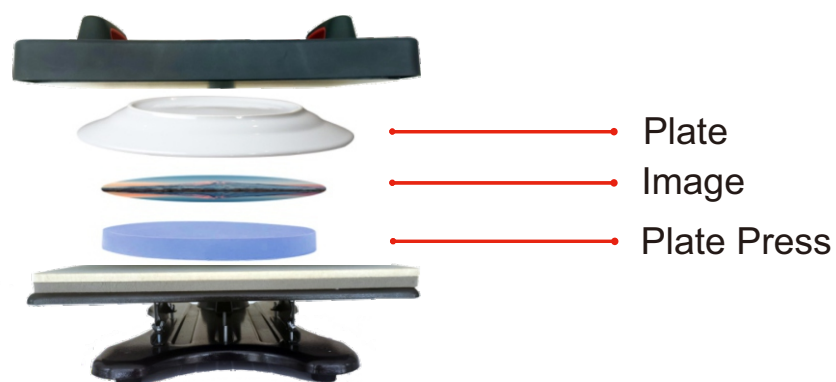

Note:

- 1,Different heating press material, time and temperature will be different.
2. Please try a sample to test the right temp and time before large quantity of printing.
3. Clothing require temp about 200°C/392°F, Fabric clothing use with sublimaton paper:60 sec, 100% coton clothing use with PU flex film: 25sec.

	Problem	Cause	Handing methods
1.	Picture burning	Too much time or temp	Adjust time or temp
2.	Fails to heat up, but display well.	Heating plate or relay broken.	Check the heating plate or relay.
3.	Lack of color, faded image.	Insufficient temperature or press time.	Adjust the temperature and/or increase the heating time.
4.	Darkened, deep color; blurred image.	Pressed for too long, temperature too high.	Adjust the temperature and heating time
5.	No action after turn on power.	Plug whether touch well Fuse whether burn.	Check the plug and fuse
6.	The real temp pass over setting temp.	Relay broken.	Replace the relay.

Kindly Prompts:

To print and make individualized DIY products, it is also necessary fou you to prepare the following equipments and materials.

- 1.Like jet printer/ six colors printer (For example: Epson R-230/ R-270/ R-290/ Rt50)
- 2.CISS (Continuous ink supply system)
- 3.Sublimation ink/ Heat transfer ink;
- 4.High-temperature resistant tape;
- 5.Sublimation paper / Heat transfer paper (for Ceramic and fabric)
- 6.Paper cutter;
- 7.Press mug/ cup and plate: Normal mug and plate will can not use for press, Only sublimation mug and plate can be use.

Safety instruction: Before operating this unit, please read these instructions completely and save them.

NOTICE

- △ keep unplug when moving the machine
- △ keep unplug when installing accessories
- △ Place on a flat and stable platform and operate under ventilated conditions
- △ Wear special protective equipment when operating machine.

WARNING improper use may result in electric, fire, personal injury and other damage.

- ⊗ Do not use this machine in a hazardous location.
- ⊗ Do not use when the machine is not working properly.
- ⊗ Do not allow children or adults who do not understand this manual to operate to this machine.
- ⊗ Do not disassemble and repair machine.
- ⊗ Do not use an unsuitable AC outlet.
- ⊗ Do not touch the heating plate when the machine heating.



WARNING