

ASSEMBLY INSTRUCTIONS

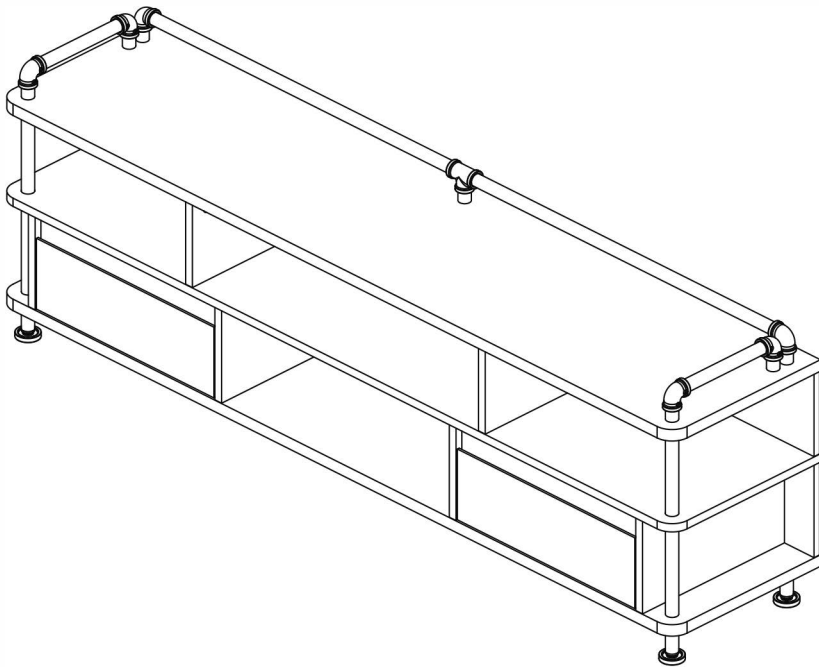

TOOLS REQUIRED



Hammer

(Not Included)



**Philips
Screwdriver**

(Not Included)



**2 - People
Recommended**

ASSEMBLY RATING



EASY —————> DIFFICULT

The Assembly Rating is a 5-point system showing the level of effort needed to assemble a specific product.

PRE ASSEMBLY INTRODUCTION

We understand building ready-to-assemble furniture can be a challenging experience for some. To help avoid confusion, we have provided some helpful tips that may speed up the process.

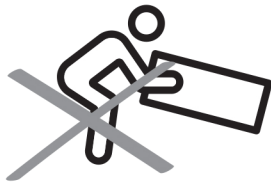

Teamwork

ALWAYS have at least two people to help with transporting and assembling the product to avoid potential injury and/or damage.

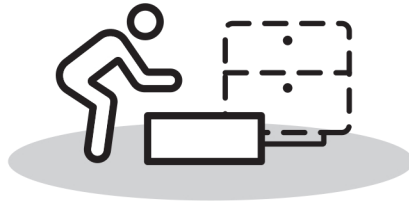
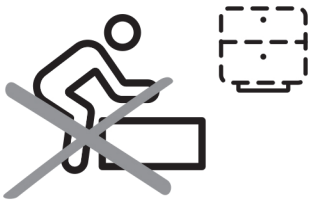

Suitable Location

Assembling near the area of the intended location is highly recommended.



Sufficient Space

Make sure you have enough space to move around during the assembly.



Avoid Scratches

Use cardboard, blankets or a carpeted area while assembling furniture to prevent scratches.

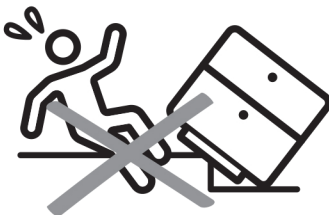

Flat Surface

Make sure the furniture rests on a flat and level surface with each leg evenly touching the floor.

ASSEMBLY AND CARE ADVICE



FAILURE TO FOLLOW THE GUIDELINES BELOW MAY RESULT IN INJURY AND/OR PROPERTY DAMAGE.



Position each part correctly and insert screws or bolts into their respective holes.

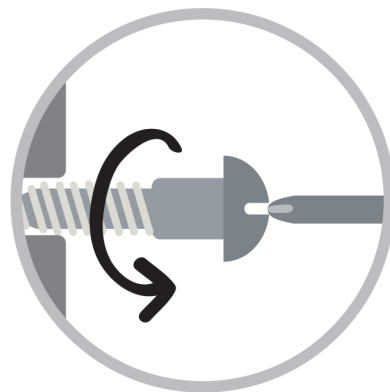

Turn clockwise to tighten and only tighten when step is completed or when instructed to do so.



Use the appropriate hand tools or power tools for assembly. Select steps, such as tightening screws and/or bolts, may require hand tools to avoid causing damage during assembly.



Save the instructions and store any supplied tools for later maintenance.

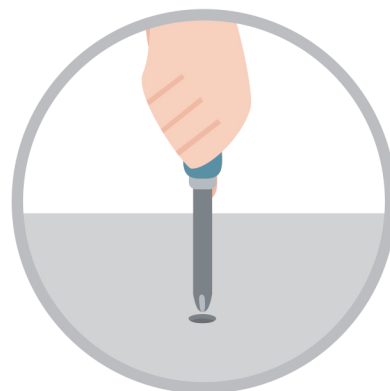

After two weeks, check and tighten any loose hardware and repeat again every six months thereafter.

IT IS THE USER'S RESPONSIBILITY TO MAINTAIN THE FURNITURE. THE HARDWARE MAY LOOSEN OVER TIME AND MAY CAUSE THE FURNITURE TO BE WOBBLY AND UNABLE TO SUPPORT ITS INTENDED WEIGHT CAPACITY. THIS MAY LEAD TO COLLAPSE AND MAY CAUSE SERIOUS INJURY.

CAM LOCK FASTENER ASSEMBLY INSTRUCTIONS

Note :

Every cam lock bolt must have a cam lock connector in order to fasten the parts together.

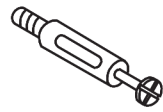

cam bolt



cam lock

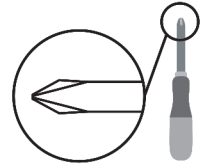

screwdriver

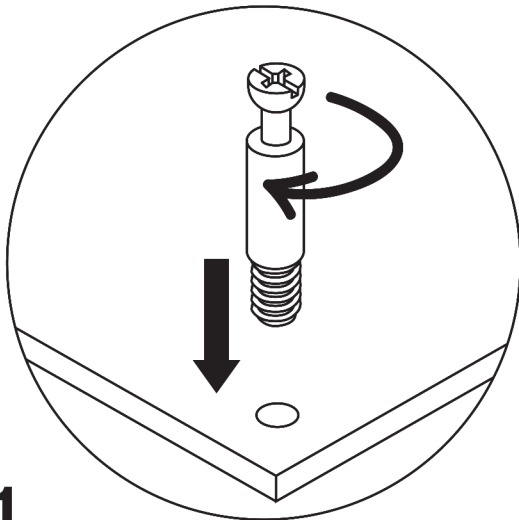

1

Screw the cam bolt into panel.

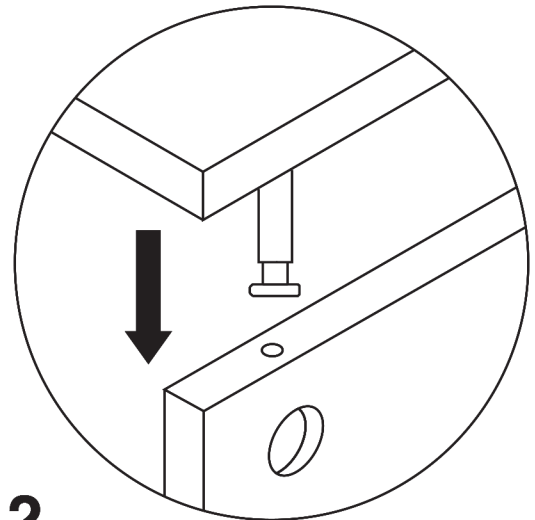

2

Insert the cam bolt into the bolt hole of joint panel.

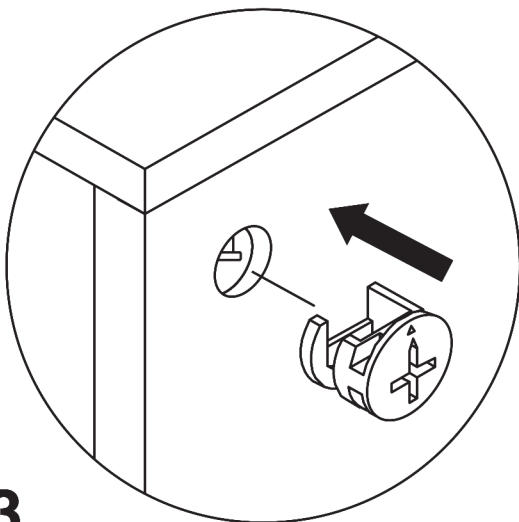

3

Align the cam lock with its side opening (or arrow) pointing to cam bolt.

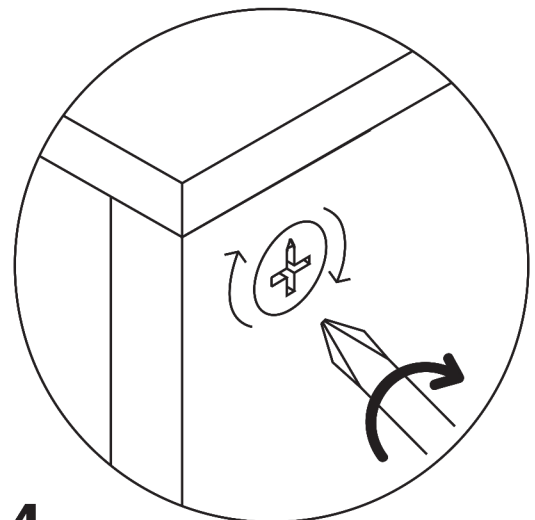

4

Turn the cam lock clockwise gently until it will not turn any more.

TV STAND

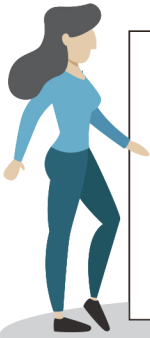

- Please keep instructions for future reference.
- Check the quantity and irregularity of parts and hardware before you start.

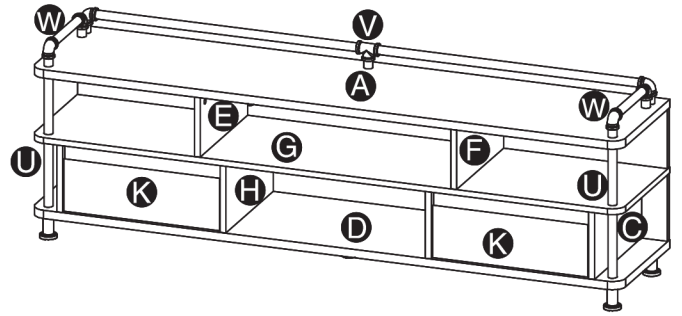

PARTS

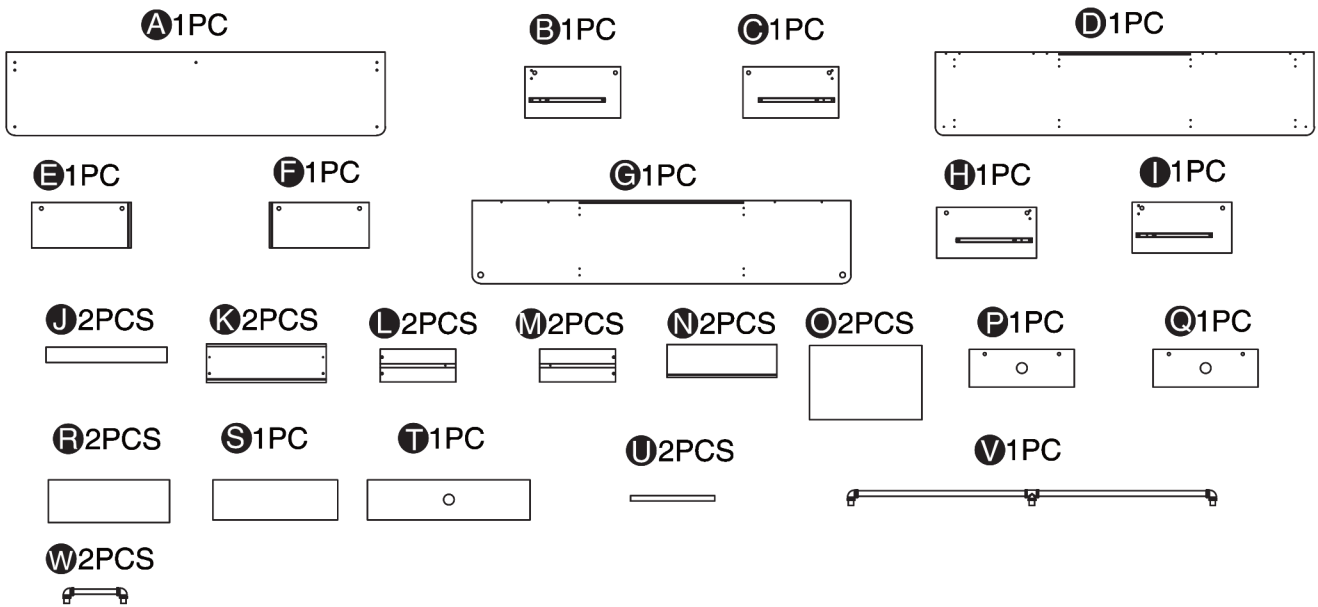

HARDWARE

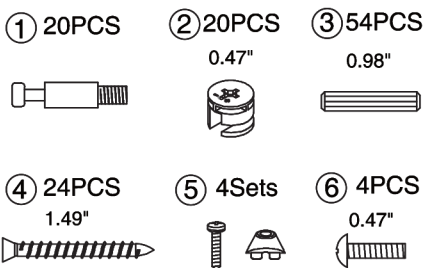

ACCESSORIES

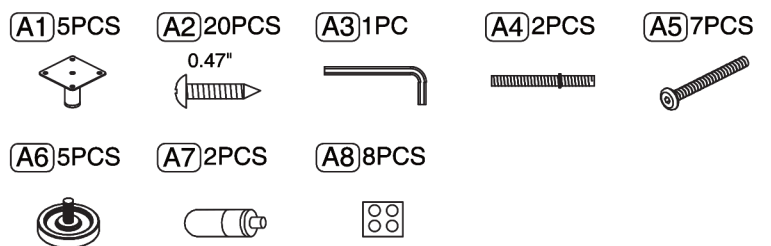

GET READY

Please group boards as below.

L 2PCS



M 2PCS



N 2PCS



O 2PCS



K 2PCS



Drawer

A 1PC



E 1PC



F 1PC



P 1PC

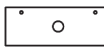

Q 1PC

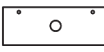

T 1PC

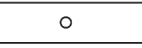

G 1PC



B 1PC

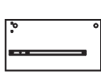

H 1PC

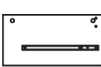

J 2PCS

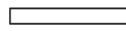

C 1PC



I 1PC



R 2PCS



S 1PC



D 1PC



V 1PC



W 2PCS



U 2PCS



Body

ASSEMBLY INSTRUCTIONS

1

- Hardware ① x 4PCS
- Hardware ③ x 4PCS
- Accessory (A7) x 1PC

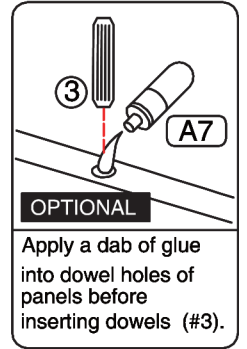
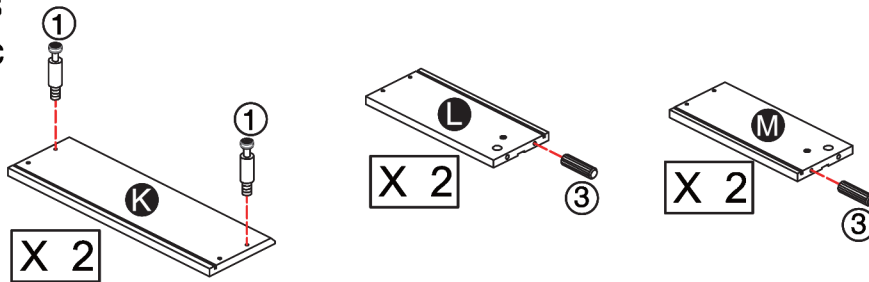

2

- Part (K) x2PCS
- Part (L) x2PCS
- Part (M) x2PCS
- Part (N) x2PCS
- Part (O) x2PCS
- Hardware ② x 4PCS
- Hardware ④ x 8PCS

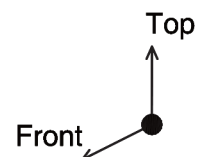
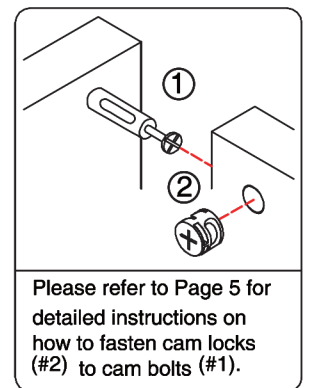
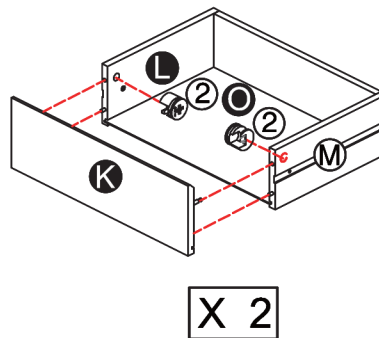
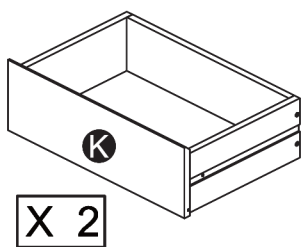
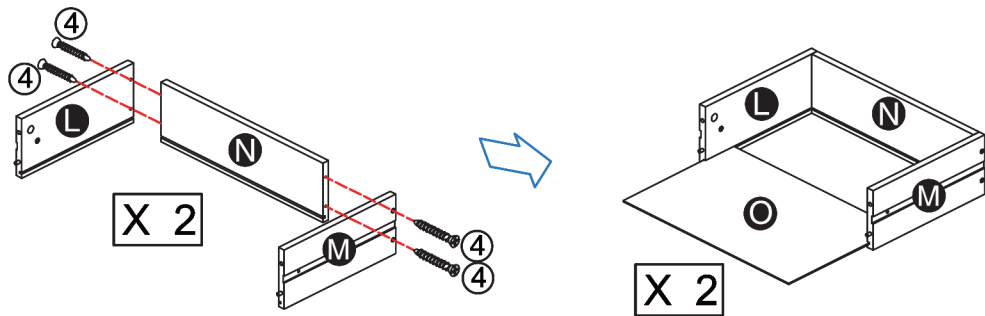

ASSEMBLY INSTRUCTIONS

3

Hardware ① x 16PCS

Hardware ③ x 16PCS

Accessory A7 x 1PC

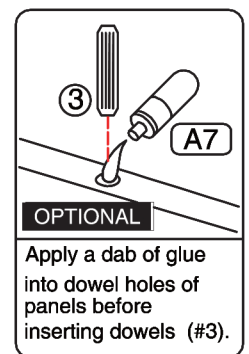
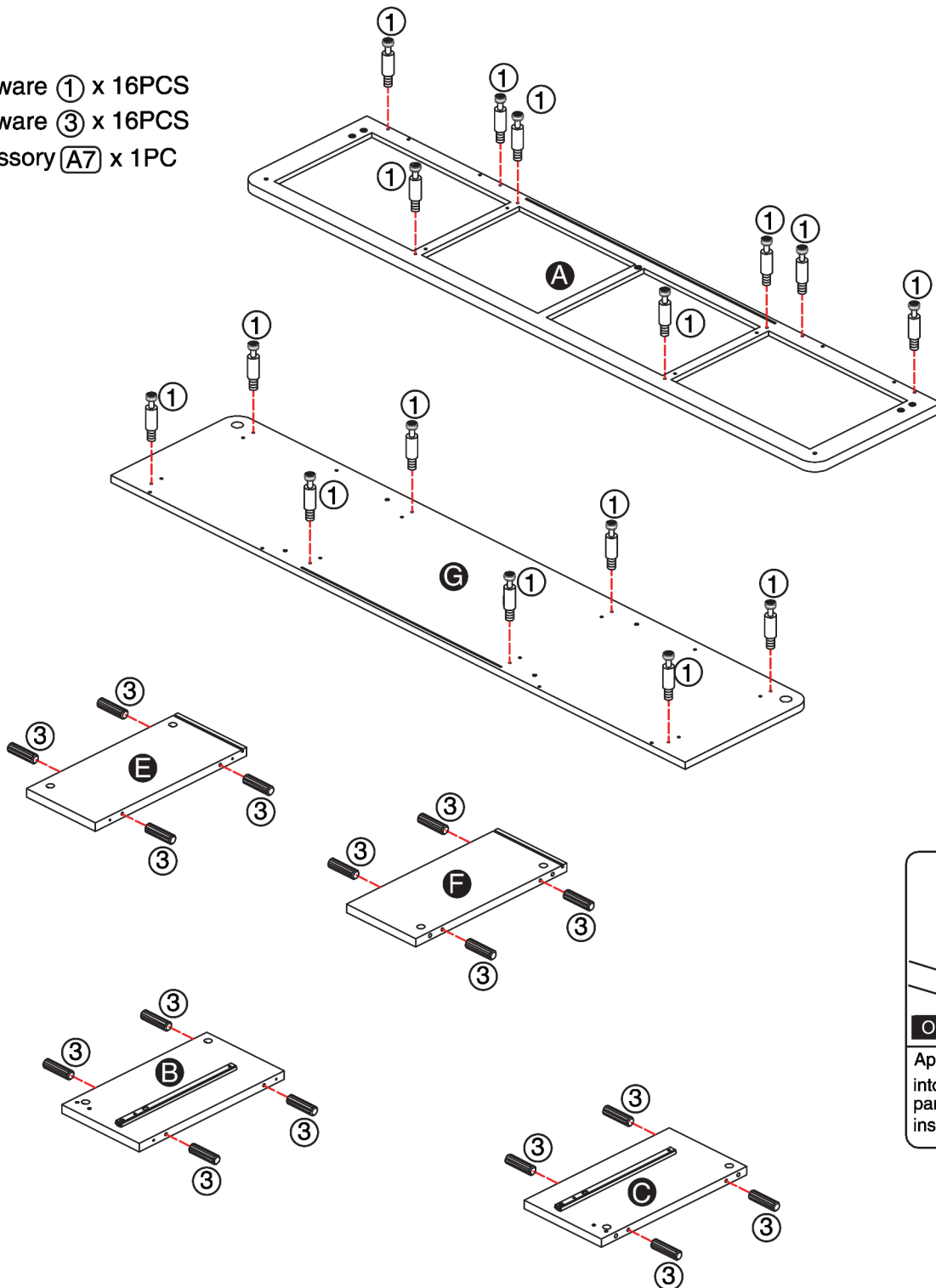

ASSEMBLY INSTRUCTIONS

4

Hardware (3) x 34PCS

Accessory (A7) x 1PC

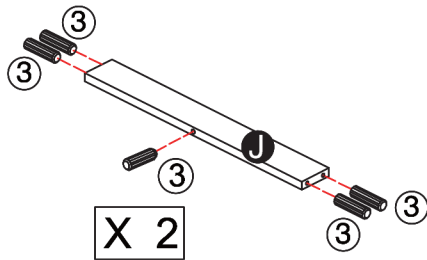
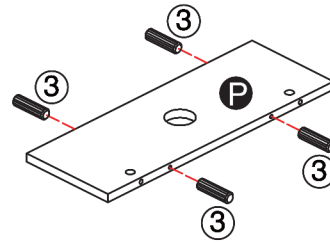
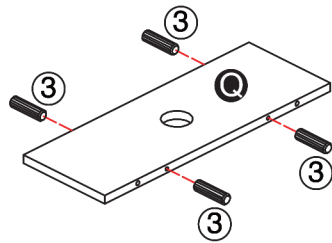
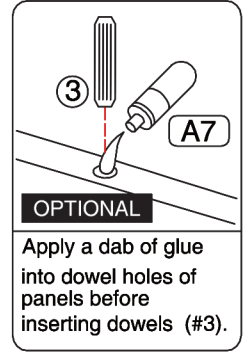
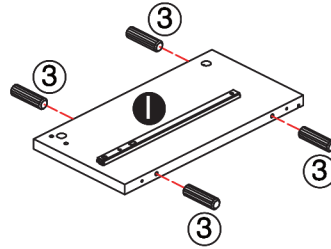
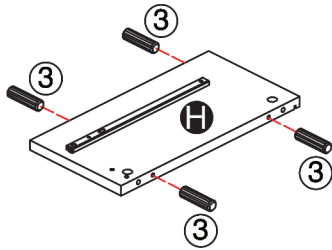

X 2

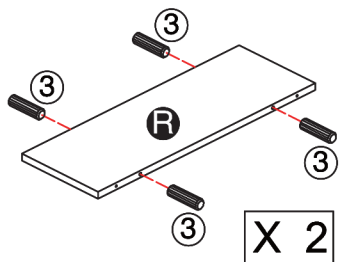

X 2

ASSEMBLY INSTRUCTIONS

5

- Part **B** x1PC
- Part **C** x1PC
- Part **H** x1PC
- Part **I** x1PC
- Part **J** x2PCS

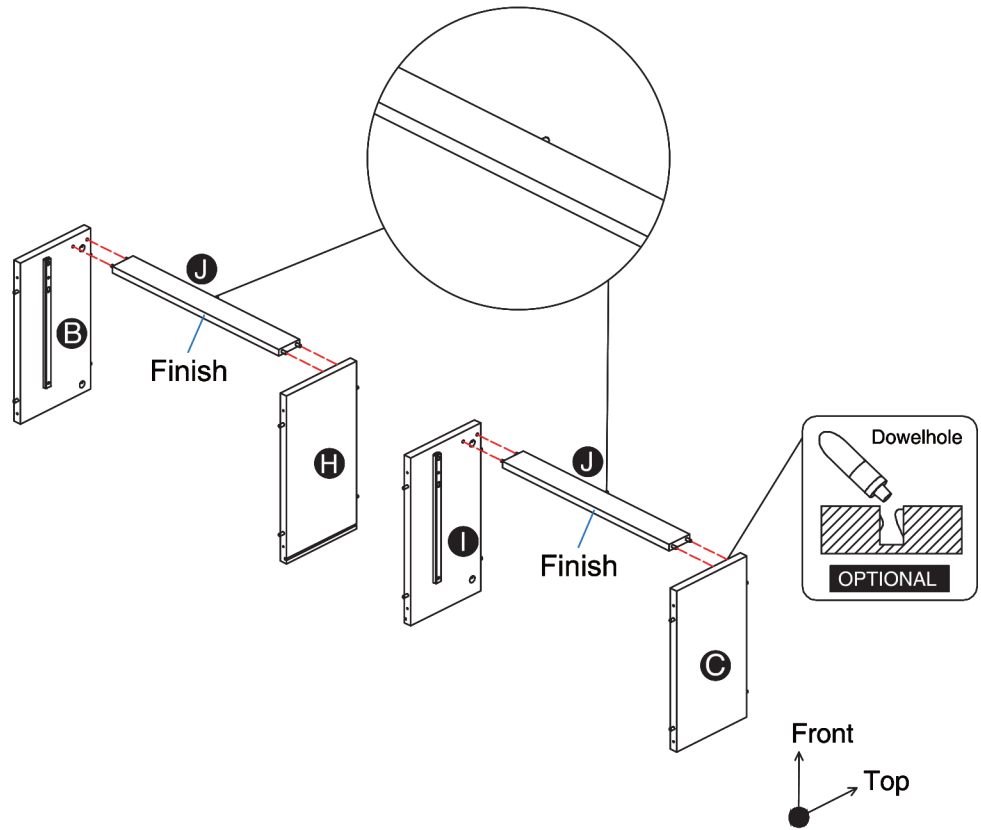

6

- Part **A** x1PC
- Part **V** x1PC
- Part **W** x2PCS
- Accessory **A3** x 1PC
- Accessory **A5** x 5PCS

or

A3

RECOMMEND

Recommend using a power tool to only tighten hardware (#A5) faster. Accessory (#A3) could also work for hardware (#A5) if a power tool is not present.

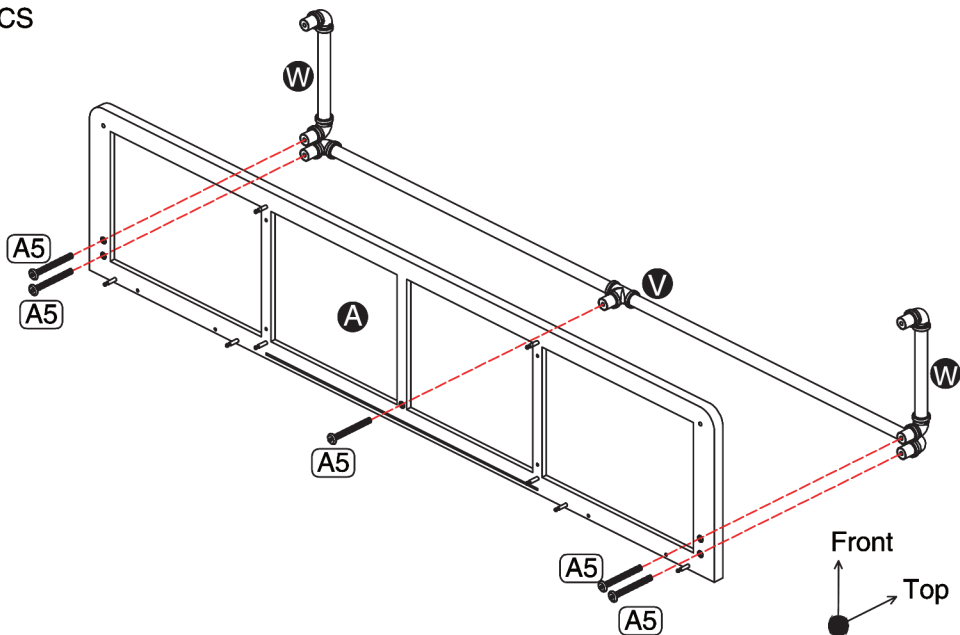

ASSEMBLY INSTRUCTIONS

7

- Part **E** x1PC
- Part **F** x1PC
- Part **P** x1PC
- Part **Q** x1PC
- Hardware **2** x 8PCS

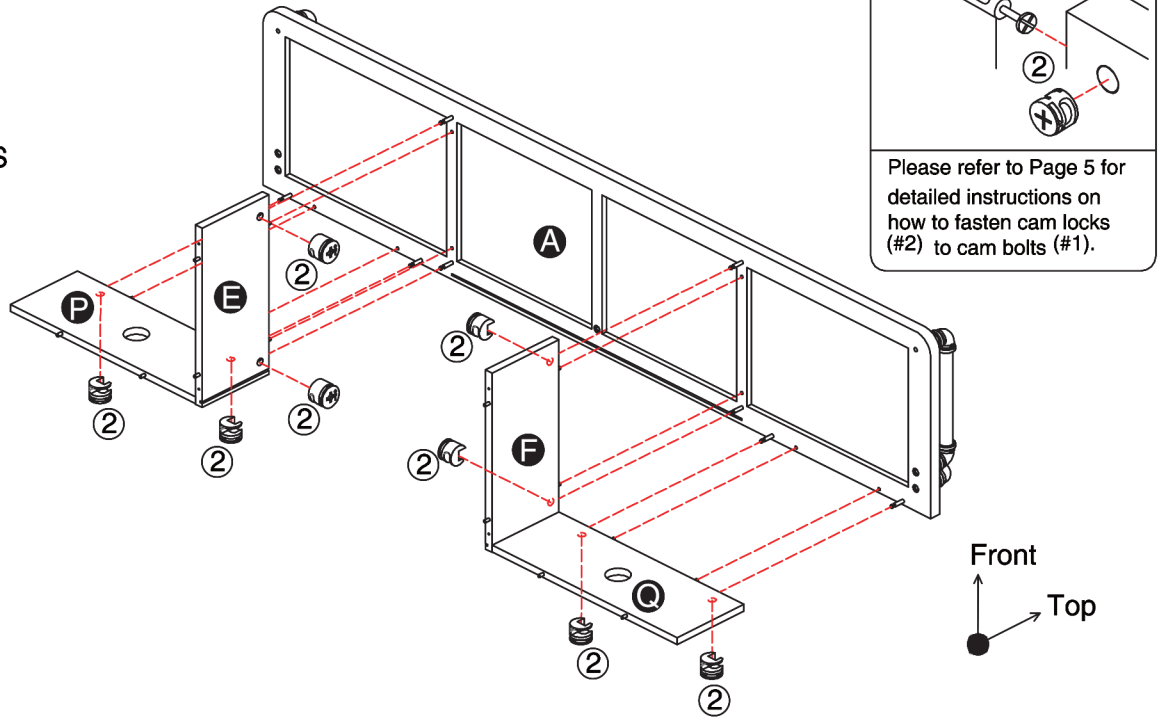

8

- Part **T** x1PC
- Accessory **A8** x 4PCS

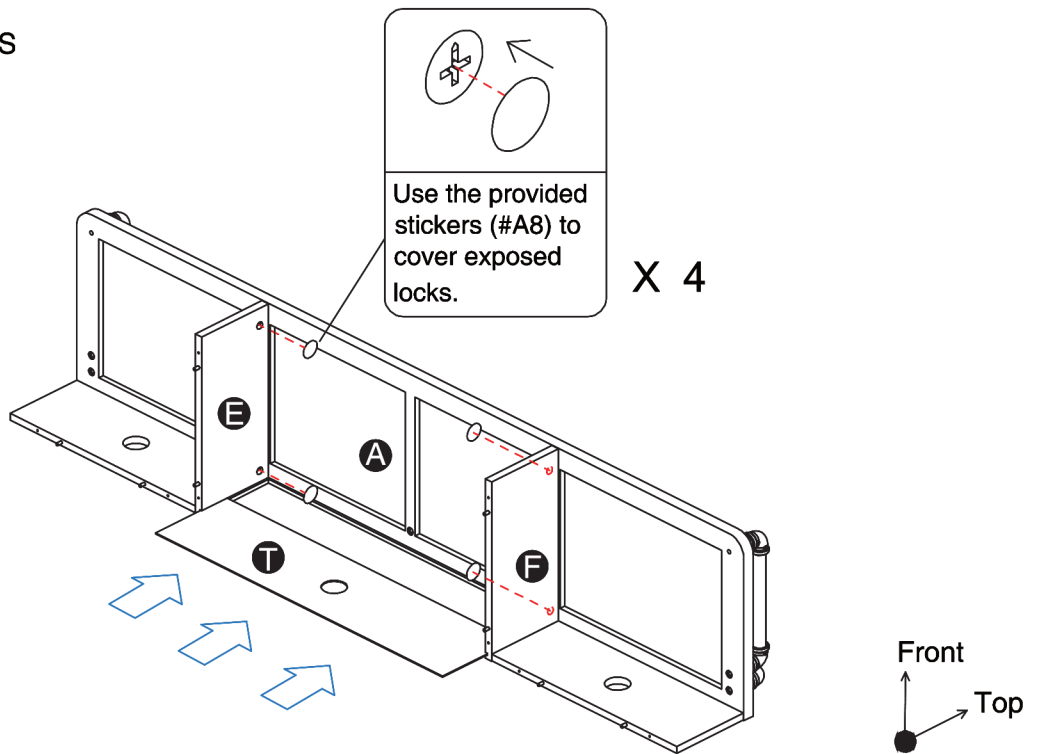

ASSEMBLY INSTRUCTIONS

9

Part **G** x1PC
Hardware **4** x 4PCS

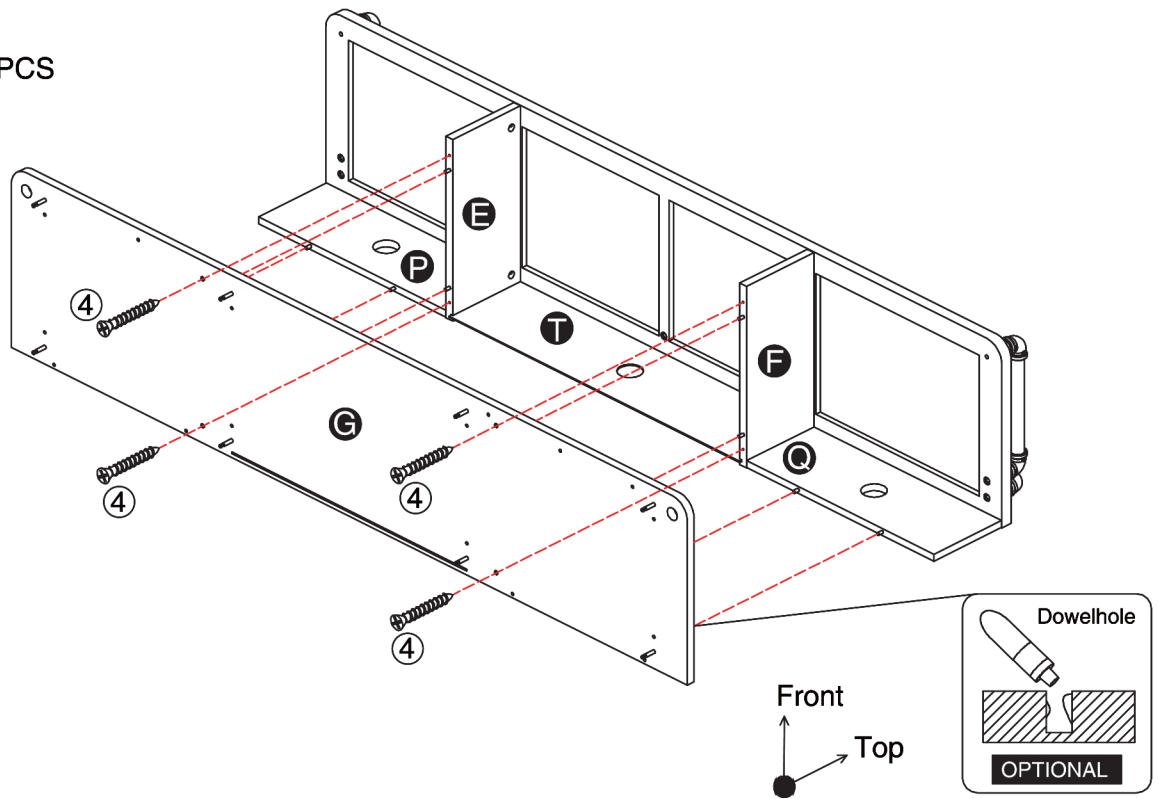

10

Part **U** x2PCS
Accessory **A4** x 2PCS

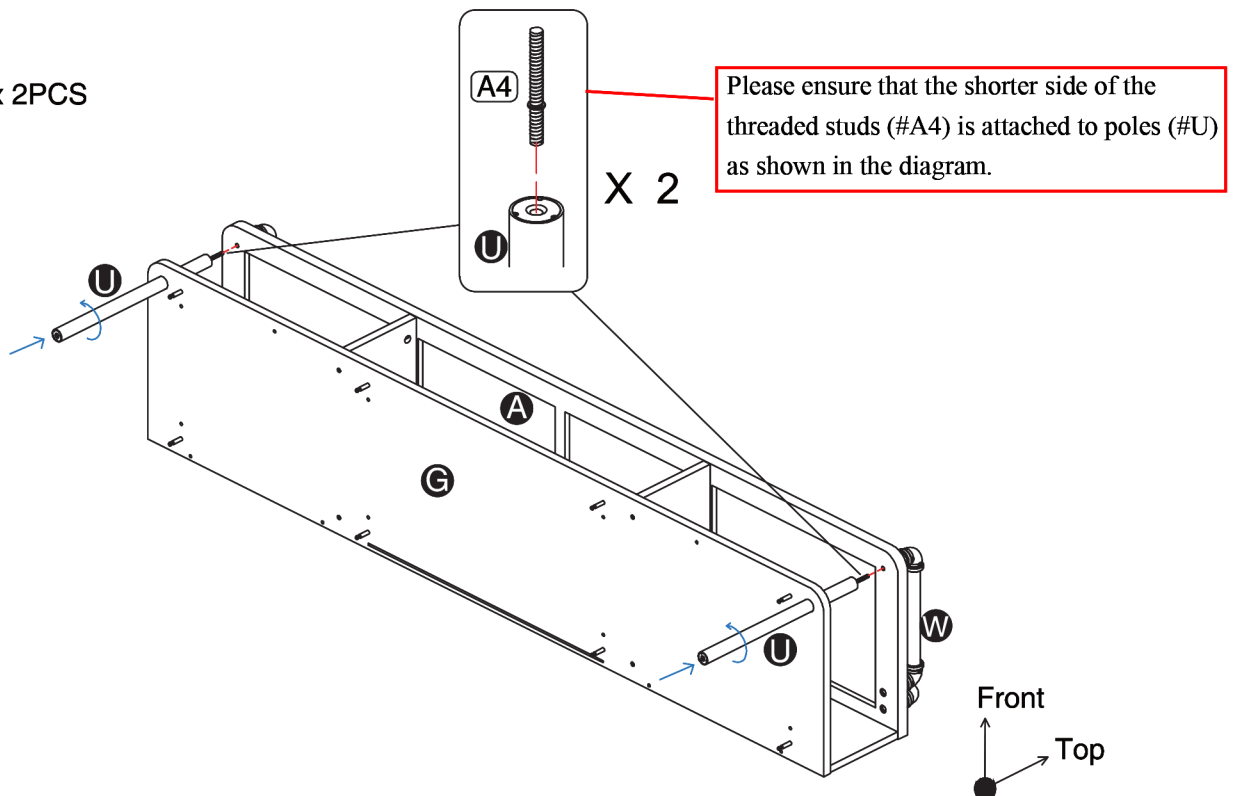

ASSEMBLY INSTRUCTIONS

11

Hardware ② x 8PCS

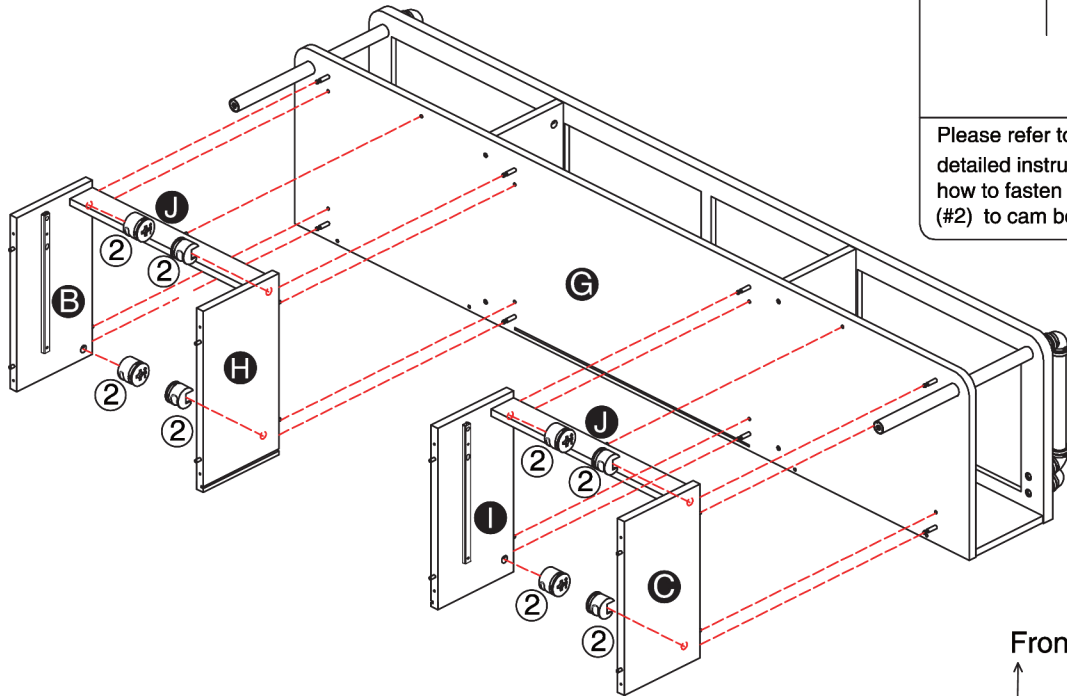

12

Part R x2PCS

Part S x1PC

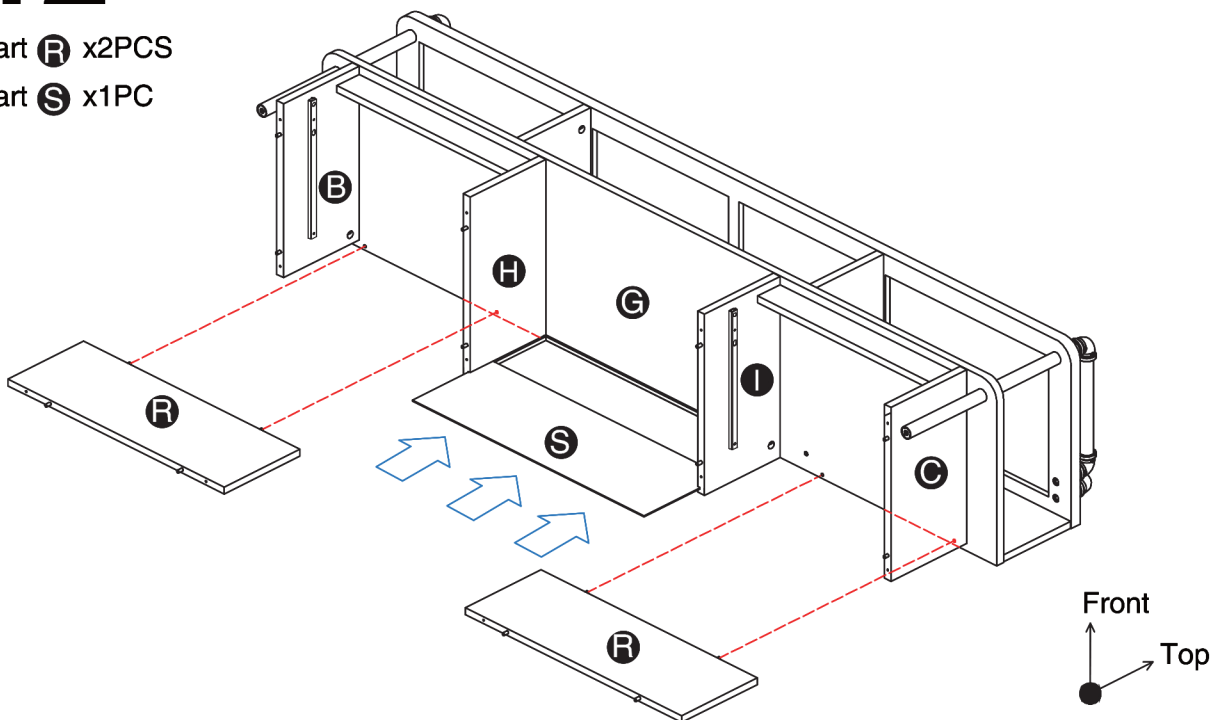

ASSEMBLY INSTRUCTIONS

13

Part **D** x1PC

Hardware **4** x 12PCS

Accessory **A5** x 2PCS

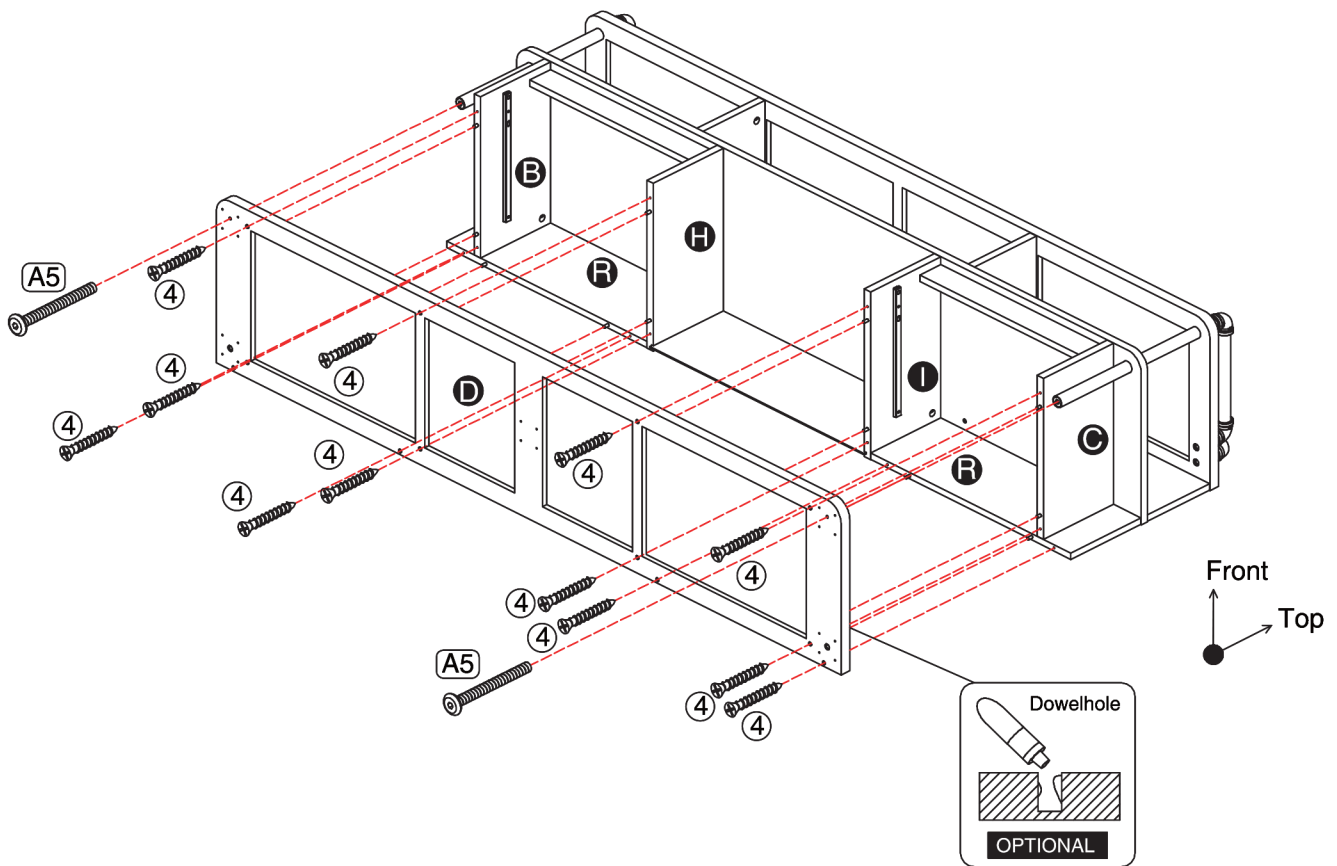

ASSEMBLY INSTRUCTIONS

14

Accessory (A1) x 5PCS

Accessory (A2) x 20PCS

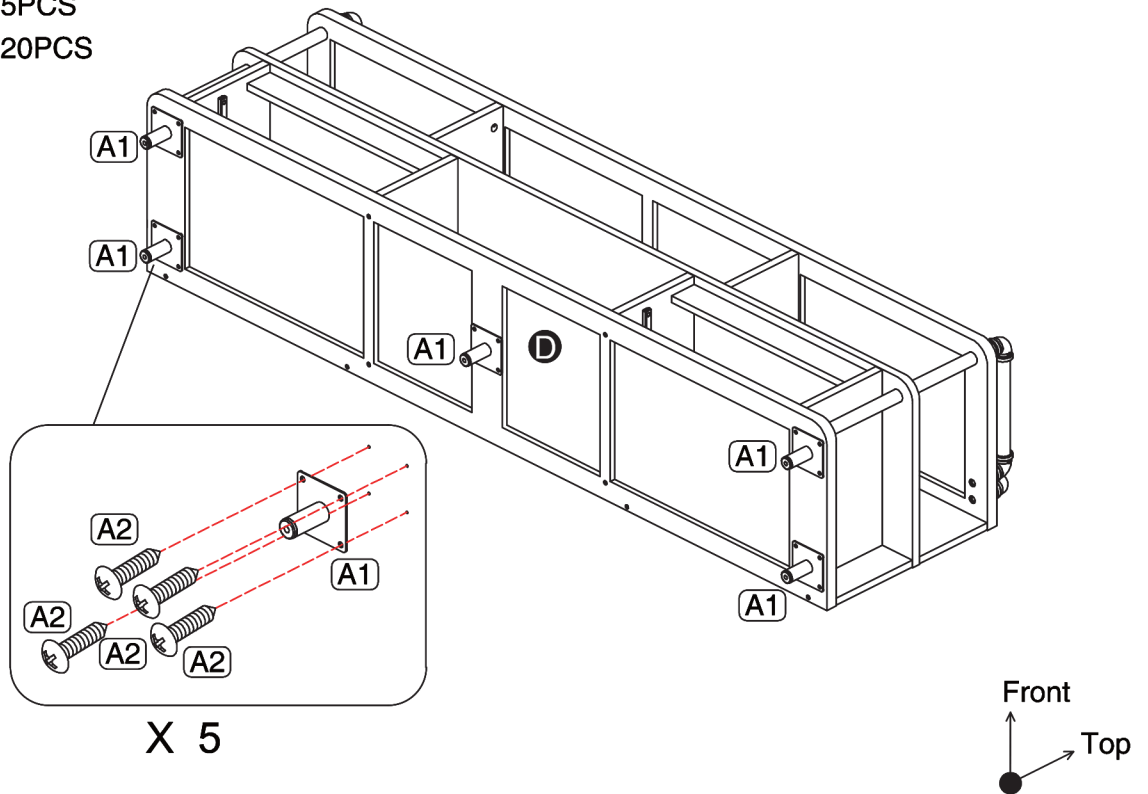

15

Accessory (A6) x 5PCS

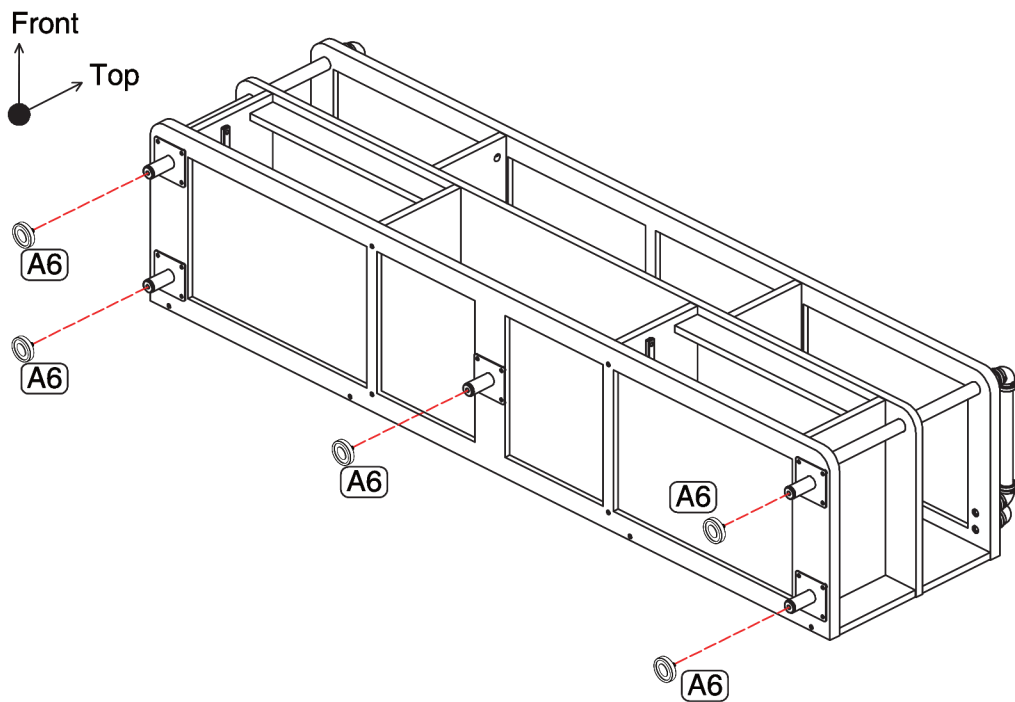

ASSEMBLY INSTRUCTIONS

16

Hardware ⑥ x 4PCS

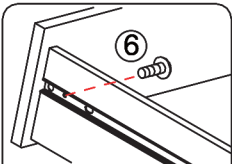
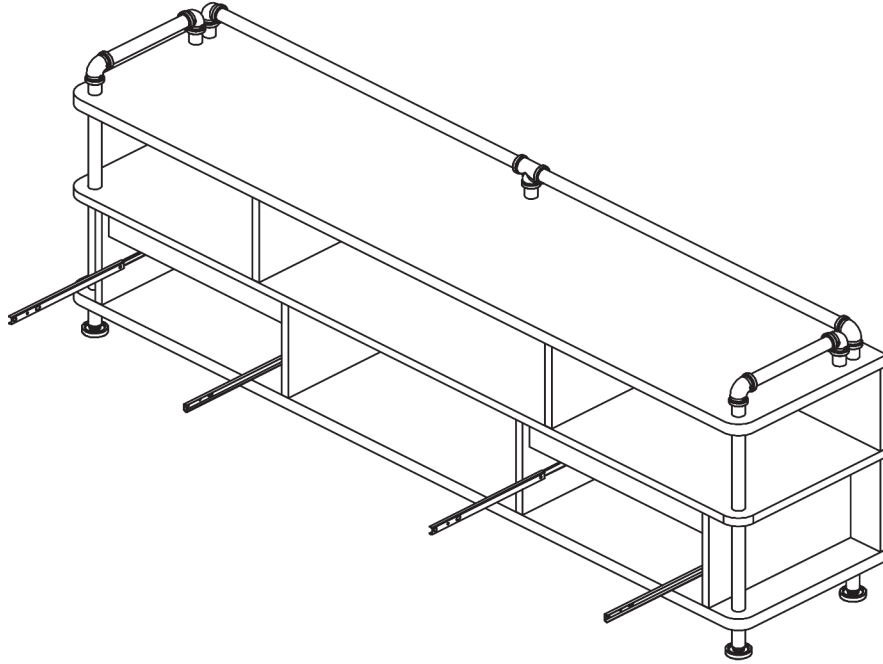

Fully extend drawer rails then align the rail's smallest hole to the drawer side panel's holes. Secure with bolts (#6).

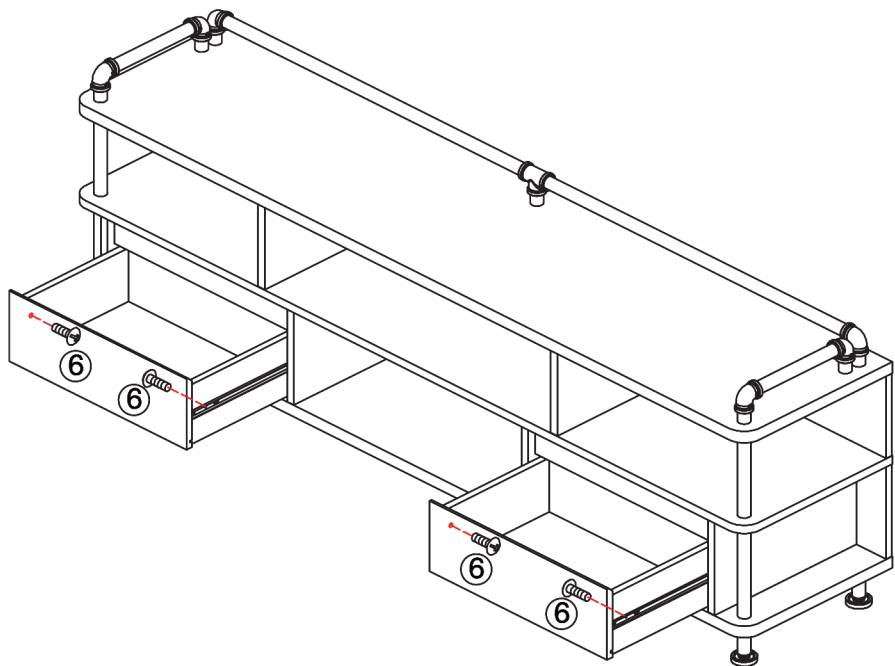

ASSEMBLY INSTRUCTIONS

17

Hardware (5) x 4Sets
Accessory (A8) x 4PCS

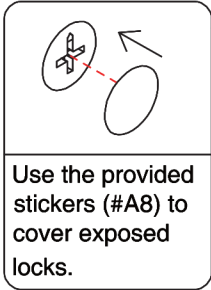

X 4

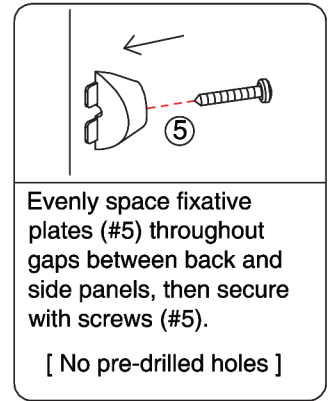
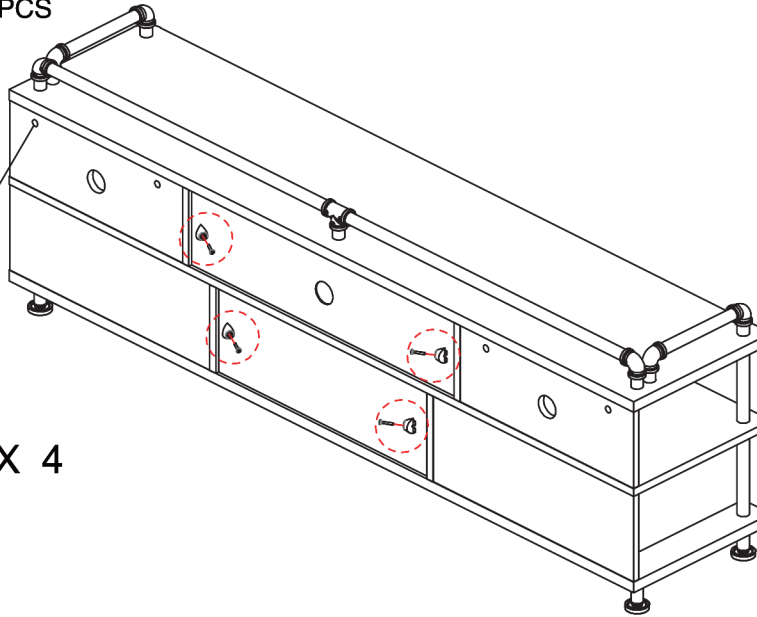

X 4

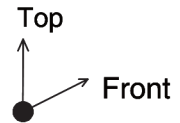

18

ASSEMBLY COMPLETED



Please ensure the furniture rests on an even and flat surface. If the product wobbles or feels loose, double-check all bolts and/or screws are properly tightened and secured.

✓ Keep this handy!

Please retain this instruction manual and any order-related information for future reference.

✓ Lift, don't drag!

To avoid damage to product please always LIFT the product when transporting or adjusting the placement.

