

# CEILING FAN LIGHT

---

## *INSTALLATION MANUAL*

### *NOTE*

If you found the Damaged Accessories  
please contact us for Free Replacement.

# ABOUT US

## Company Profile

We are a leading manufacturer of lighting products, we have our own R & D base and production base. Our products are involved in commercial LED lighting, indoor and outdoor lighting and other fields. The company's products have been recognized and used by many countries, providing people with high-quality, energy-saving, beautiful artificial lighting products.

## Contact Details

E-Mail: [lightingservice01@outlook.com](mailto:lightingservice01@outlook.com)

Whatsapp: +86 18676388370

**Whatsapp**



# CATALOG

<b>ABOUT US</b>	<b>.01</b>
<b>CATALOG</b>	<b>.02</b>
<b>INSTALL</b>	<b>.03</b>
<b>REMOTE CONTROL</b>	<b>.09</b>
<b>FAQ</b>	<b>.11</b>
<b>WARRANTY</b>	<b>.13</b>

Dear Customer

Thank you very much for your support for our products. It's a great honor that our products can meet your needs. Every ceiling fan is made by workers hand working, If you are satisfied with our products, Could you please kindly help leave us a positive evaluation. Your positive evaluation is a great encouragement for us and can encourage us to do better in the future. If you have any questions about our products, please feel free to contact us. Finally, I sincerely wish you and your family a happy life.

# INSTALL

## 1.Components and parts verification

Before you installation, please checking the parts one by one as below :



Hanging bracket

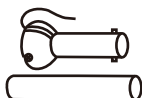

Down rod



Hanging cup



Bottom decorative cup



Motor body



Lampshade



LED Light Board



One of the crystal



LED driver



Spare parts for  
balance sticker



Pair of gloves



Wiring caps



Remote controller



Wood crews



Spare parts of  
stick light source  
magnetic column



Retaining screws  
for lamp shade  
and crystal frame



U-shaped needle

## 2.Choose a way to install the hanging bracket

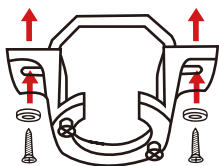

### Installed on the wooden ceiling

Use a wood screw to fix the hanging bracket on a batten or beam. For safety, wooden ceiling thickness should exceed 0.42 inch, avoid loosening of wood screw.

## 3.Install bottom decorative cup/hanging cup/hanger

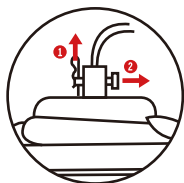

### STEP 1

Pull out the R pin and side pin on the down rod

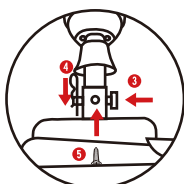

### STEP 3

Insert the side pin and fix it with R pin

### STEP 2

Make the down rod go through the bottom decorative cup, hanging cup, as shown in the drawing. Then let power cord go through the down rod from the bottom to the top. Insert the down rod into the motor interface. Tighten both sides screws to avoid fan light shaking.

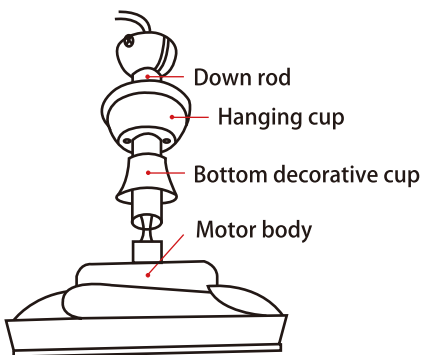

# INSTALL

## 4. Install LED light board and LED driver

Place the LED light board on the bottom of the motor. (magnetic adsorption) Connect the LED driver to the light board and motor.

1. LED driver has two types of wires. Respectively connect with LED light board & motor. Firstly, connect the same color wires between driver and motor (tighten it with wiring cap)

2. Secondly, connect the other wire between LED light board and driver.

3. Put the LED driver and LED light board on the bottom of the motor.

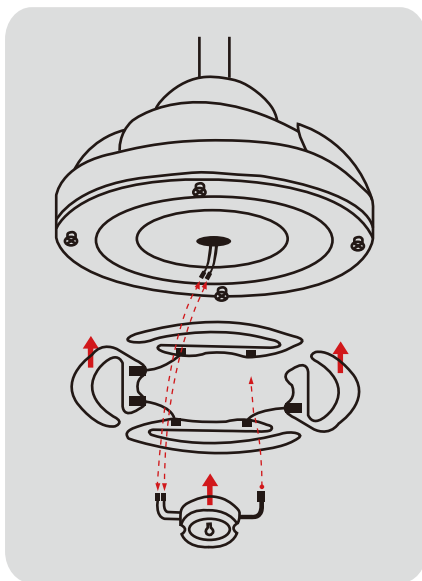

**Normal**

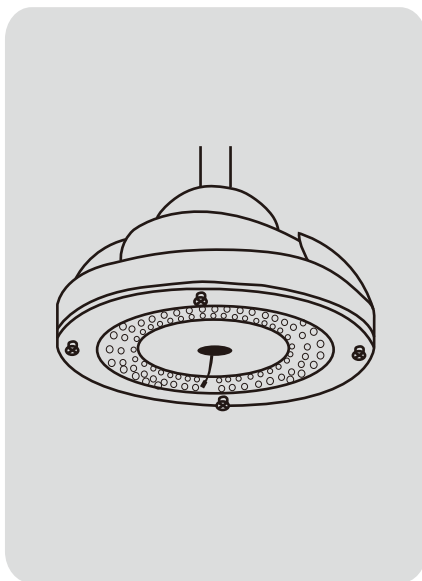

**Dimmable**

**NOTE:** If the LED light is not on, please check that the wiring here is properly connected. The LED you receive depends on your model.

## 5. Install the lampshade

First, unscrew the four screws on the motor, then align the holes on the lampshade and motor, use the screws through the two holes, and tighten. Please check the drawing for reference.

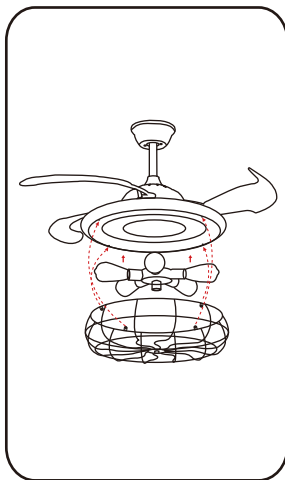
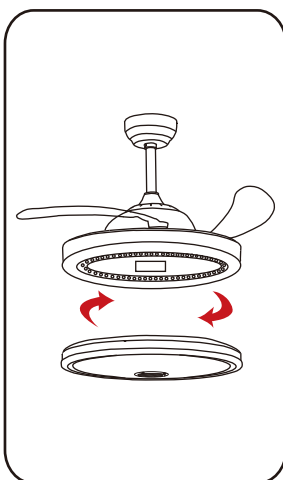
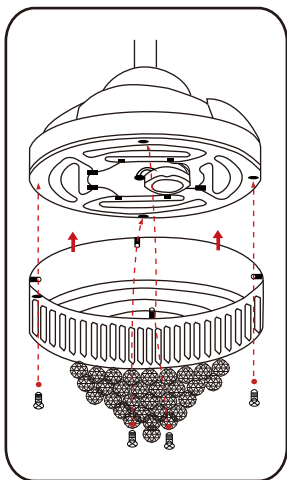

## 6. Install hanging all or finished (No crystal Ball)

Place the hanging ball in the hanging bracket and turn the boom until the groove of the ball mesh with the lug of the plate (inside the bracket).

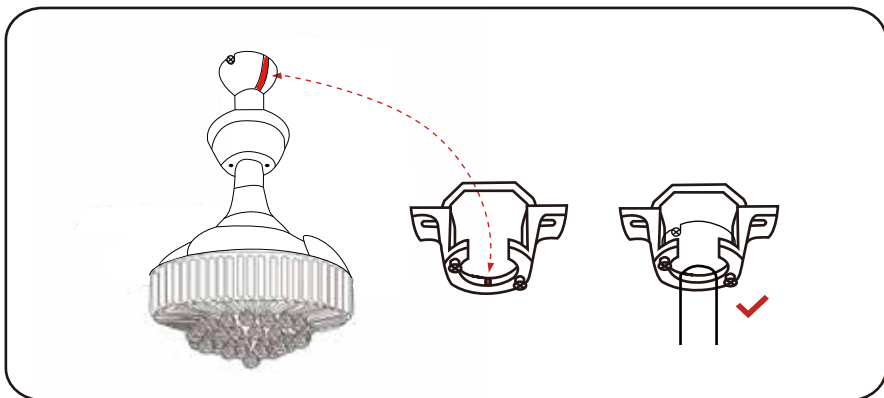

# INSTALL

## 7. Connect the home power cord

Connect the wire in the down rod to the home power. For safety, please tighten the wiring caps.

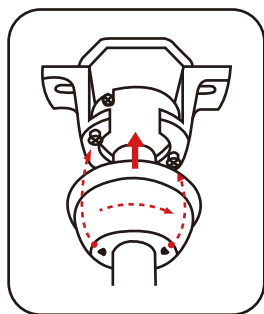

Please connect the green ground wire on the fan light to the ground wire at home (No need to connect if no ground wire at your home).

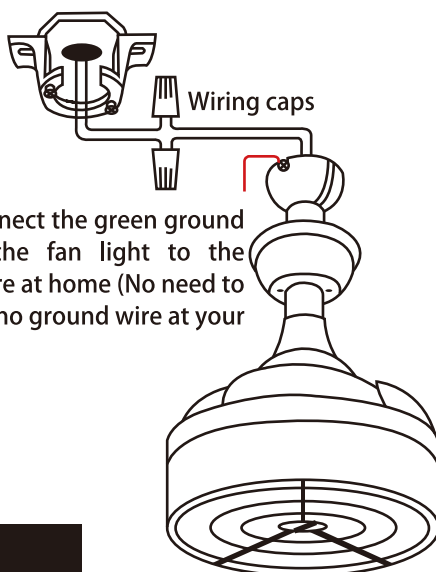

## 8. Fix the hanging cup

Pull out more than half of the two screws on the hanging bracket. (Don't pull out completely). Lift the hanging cup, let the screw pass through the notch of the hanging cup. Rotate the hanging cup to make it stuck and tight.

Please check drawing for your reference.

**Warning:** The LN line of the product must correspond to the LN line of the power supply during installation, otherwise it will cause luminescence abnormality.



## 9.hanging crystal(For Crystal Ceiling Fan Only)

Only the middle hole needs to hang crystal beads, and the length of the bead string can be adjusted as needed.(Except rectangular crystal model)

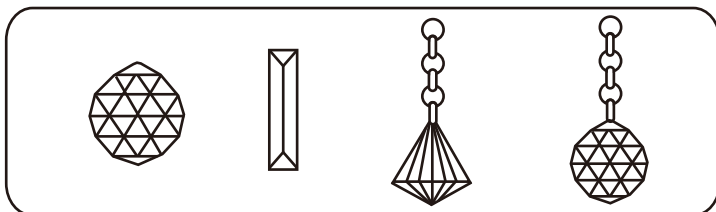

Hang the crystal with a U-shaped pin. Pass one end of the U shaped pin through the crystal. Bend or fold pin until the crystal does not fall. Pass the other end out of the small hole in the metal frame. Bend or fold pin to fix the crystal. Hang all crystals in this way.

(PS: Whatever ball crystal or Rectangular crystal)

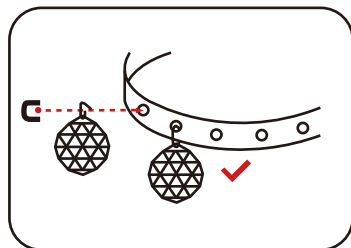
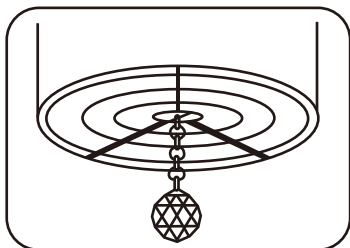

### External maintenance

Use dry or slightly wet clean soft cotton cloth to wipe the external surface of the lamp body, do not use chemical cleaning agents, solvents or rough abrasives to clean the lamp surface.

### Internal maintenance

Before cleaning the interior of the lamp, cut off the power supply first, and then use dry or slightly wet clean cotton cloth to wipe the interior surface of the lamp. For Blade cleaning, Please kindly contact for video guideline.

**TIP:** This manual is for normal crystal type installation, Please kindly contact us if this is not suitable for your model.

# REMOTE CONTROL

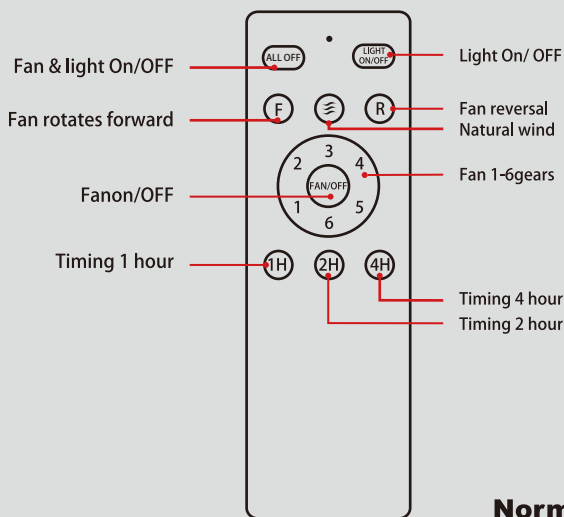
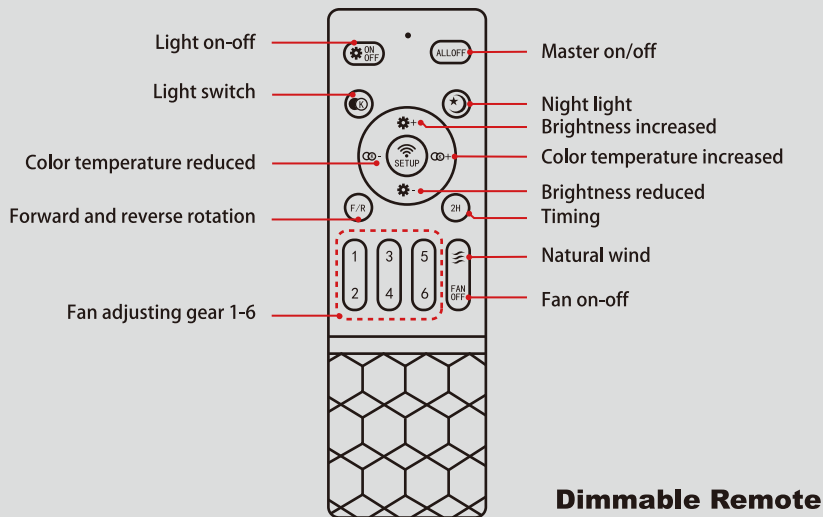

**Note:** The remote you receive depends on your model, Please kindly contact us if you want to make your fan dimmable.

**Color temperature + and - button:** Long-press “+” or “-” button, you can adjust the temperature (500K-6500K) free.

**Brightness + and - button:** Long-press “+” or “-” button, you can adjust the brightness free.

**Forward and Reverse rotation:**

- 1.Forward rotation is better for Summer, the air flow is up to down.Cool down quickly.
- 2.Reverse Rotation is better for Winter, the air flow is down to up. Indoor air circulation

**Remote need to be programmed, if you meet problems as following:**

- 1.The fan is woking, but light is not;
- 2.The light is working, but fan is not;
- 3.The fan / light can be turned on, but light brightness and fan speed can not be changed.

**How to programmed the remote?**

First turn off the wall switch or power off (Do not provide electric)

Then turn on the wall switch or power on(Provide electric), Long press the “ALL OFF (OR SET UP)” button in 3 sconds for 5 seconds, Need to push in 3 seconds, After 3 seconds to push, It will not work(Please start process again from begining). the light flashes and there is a buzzer, the remote can work normally Re-Programming finished.

# FAQ

Each product is strictly checked by professional QC before shipment. Some accessories may be damaged by repeated moving in transit. In order to you have more better using experience, there are some questions and answers for your reference.

## ❓ If you accessories broken

- ✔ All easy damaged accessories, we promise replacement for free. Just take photos to customer service Email is ok.
- 

## ❓ Fan working but light not working

- ✔ 1. Make sure the ceiling fan and home power are wired correctly.  
2. Make sure the driver and the light board are well connected.  
3. If driver or light board damaged, pls contact us for replacement.
- 

## ❓ Remote not working/Light working but fan not working

- ✔ Due to transport problems programmed might be deleted, so you have to Reprogrammed by yourself. There are 2 ways solve it as below:  
1. Pls checking install manual on page 7 for reference. (how to Reprogrammed)  
2. Try to contact customer service email.
- 

## ❓ Fan Noise

- ✔ 1. Check if the screws for fixing the fan blade and screws the lower rod are tight.  
2. Check if there are screws, washers, nuts and other debris.

### ? Fan Swings

- ✓ 1. Check if 2 screws of lower rod are tight.
  - 2. Pls checking and confirm hanging bracket with down rod hanging ball Bite (Concave and convex part) See page 6 for reference.
  - 3. Please use balance stickers to keep the fan balanced, if you don't know how to use, please contact us.
- 

### ? Down rods short or long

- ✓ 1. Contact customer service E-mail to get new one.
  - 2. Purchase on Amazon or hardware shop by yourself.
- 

### ? Light board Flashes

- ✓ The light board keeps blinking, mainly due to the unstable circuit or weak current. Please make sure the fan ground wire is connected to the home ground wire. Or connect the ground wire to the ceiling, then fix it with anti-electricity tape. If it still can't be solved, please contact us.
- 

### ? Remote Buzzer sound

- ✓ Remote Buzzer sound is standard for checking ceiling fan light is working well. It can not be silent. Otherwise remote can't work.

**HELP:** Whatever you meet any problems, you can contact us by Email or Whatsapp online service.  
We are sincerely help you deal with any questions.

# WARRANTY

Thanks for choose our product!

About Ceiling Fan, we will provide you promise and service as below:

## Warranty Time

- 1.LED Panel: Within 1 years for free replace from order date.
- 2.Fan Motor: Within 1 years for free replace from order date.
- 3.Remote: Within 1 years for free replace from order date.
- 4.Other Parts: Within 1 years for free replace from order date.

## Scope of warranty

The manufacturer warrants that the lamp can be repaired within 2 years from the date of purchase. During the warranty period, if there is any problem with the lamp, you can contact the relevant staff to repair or replace the product, The premise is that the failure of the product occurs under normal use, rather than the failure caused by man-made intentional damage. This warranty does not apply to the product failure caused by misuse, abuse, man-made damage, etc.

## Out of warranty

This warranty does not apply to any product that is found to be faulty due to improper installation, improper setting or use not in accordance with the instructions. This warranty does not apply to the product failure caused by human damage, artificial change, misuse, abuse or wrong installation. This warranty does not apply to the repair of the external surface of the product, such as scratch, wear, weathering, etc., which are considered as normal wear parts of the product.

## **Return/Replacement Policy**

We are sorry for you not satisfied on our product When you choose Return / Replacement,please checking policy carefully as following:

### **Period of Validity**

After you get package within 30 days.

### **Defect of Product**

Due to the product defect, you want to return it, we suggest you contact us first, we will replace parts you need for free.

### **Return Package Must Be**

- 1.Complete parts of the product.
- 2.Non trace of use or installation.
- 3.Original package and foam box.
- 4.No-influence second selling.

### **Privacy Protection**

All provide contact way for help only, we will promise protect your privacy.Thanks for your cooperation and support!

### **Contact Details**

E-Mail: [lightingservice01@outlook.com](mailto:lightingservice01@outlook.com)

Whatsapp: +86 18676388370

**Whatsapp**



# THANK YOU FOR USING!

---

E-Mail

lightingservice01@outlook.com

Whatsapp

+86 18676388370



**Whatsapp**

**Any problems during the installation and using, Please feel free to contact us!**