

Violent installation is prohibited

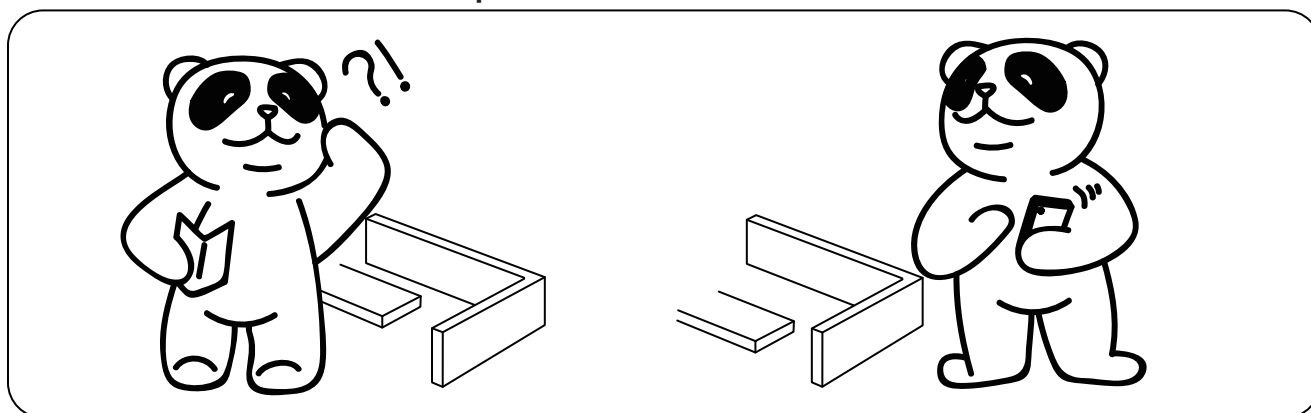

Please call if you need help

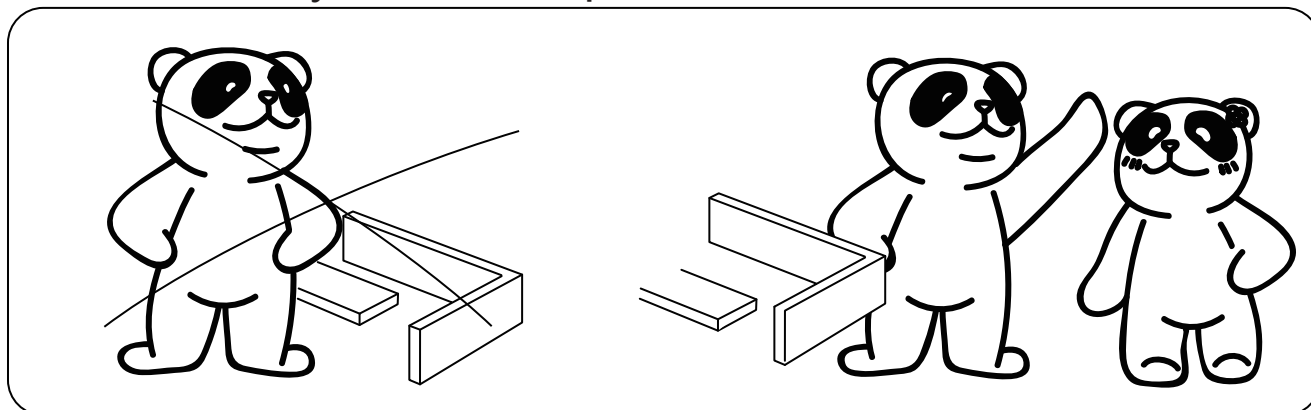

Multi-person cooperation is recommended

# Assembly Instruction

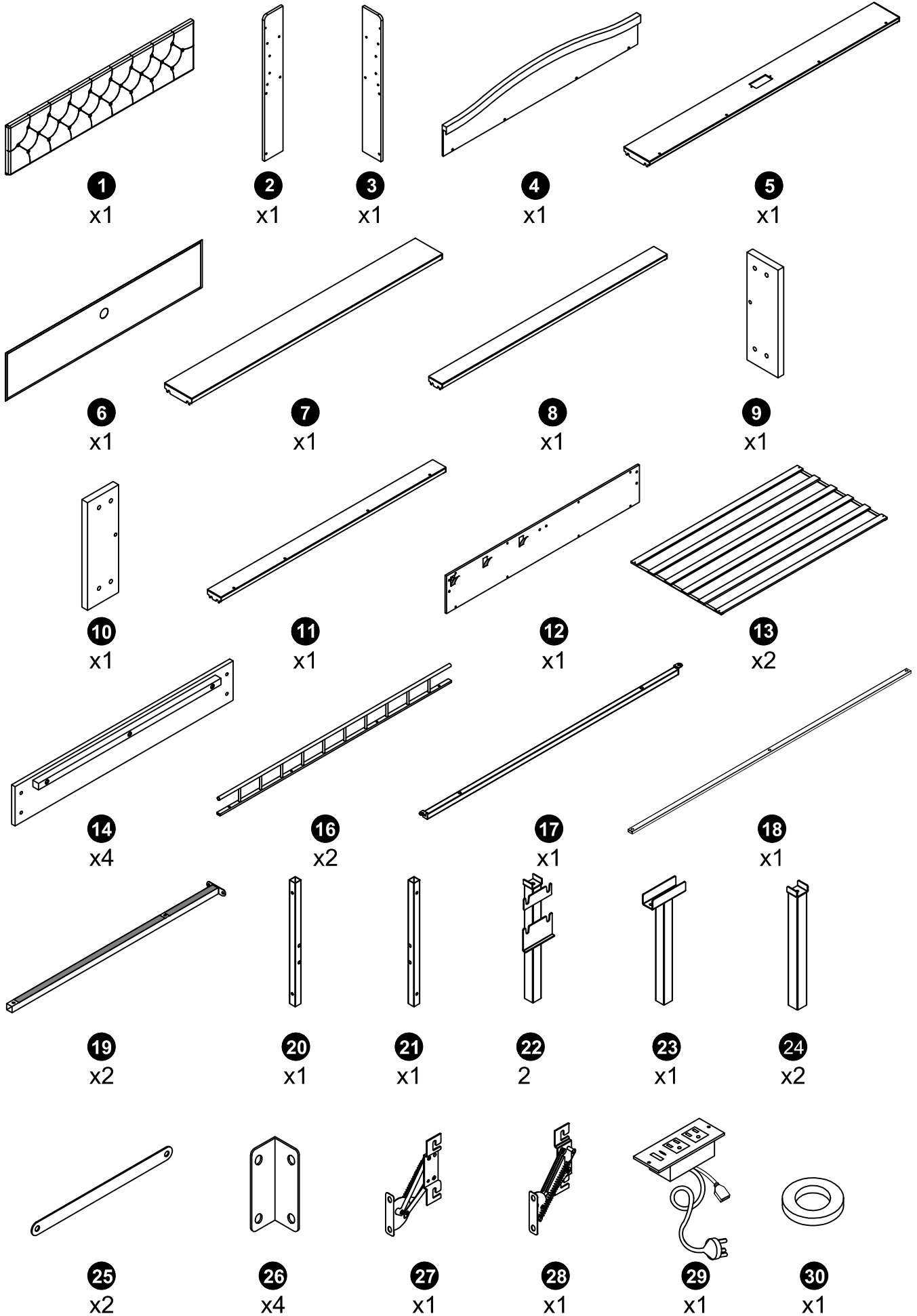

# Assembly Instruction



**A**

M6\*20  
x9

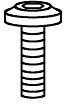

**B**

M6\*25  
x13

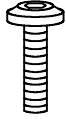

**C**

M6\*30  
x9

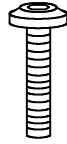

**D**

M6\*45  
x5

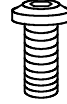

**E**

M8\*15  
x12

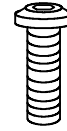

**F**

M8\*20  
x52

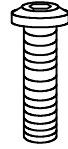

**G**

M8\*35  
x7

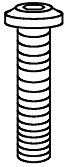

**H**

M8\*45  
x5

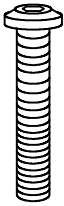

**I**

M8\*50  
x2



**J**

M3\*12  
x3

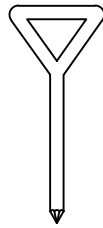

**K**

x1

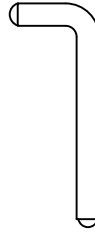

**L**

M6  
x1

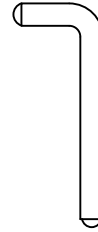

**M**

M8  
x1

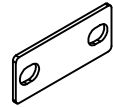

**N**

x2

# Assembly Instruction

## LED light strip electronic accessories list

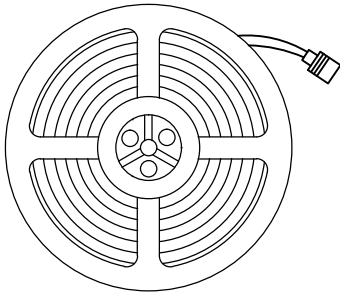

x2

Light strip

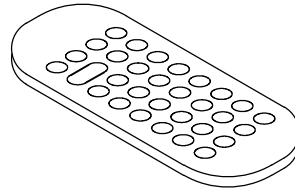

x1

Remote control

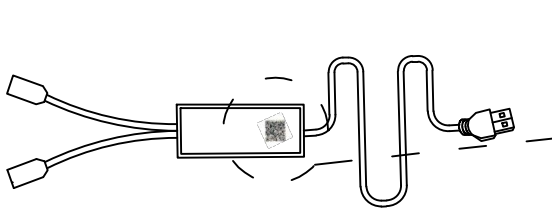

x1

Power cord

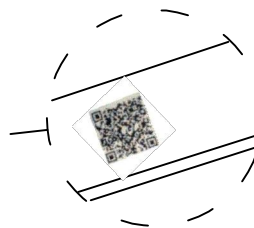

There is a two-dimensional code at the position of the power line. Scanning can download the APP for the control light

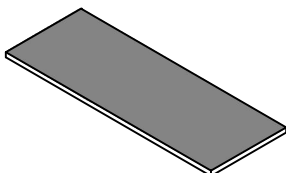

x8

Magic tape

**Note:**

1. Should be assembled on flat ground to keep balance.
2. Before completing the installation, do not tighten the screws.

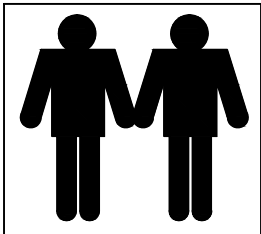

**It needs at least  
two people to install !!**



**Before starting the  
assembly, you must  
read the whole  
manual and follow  
the instructions**

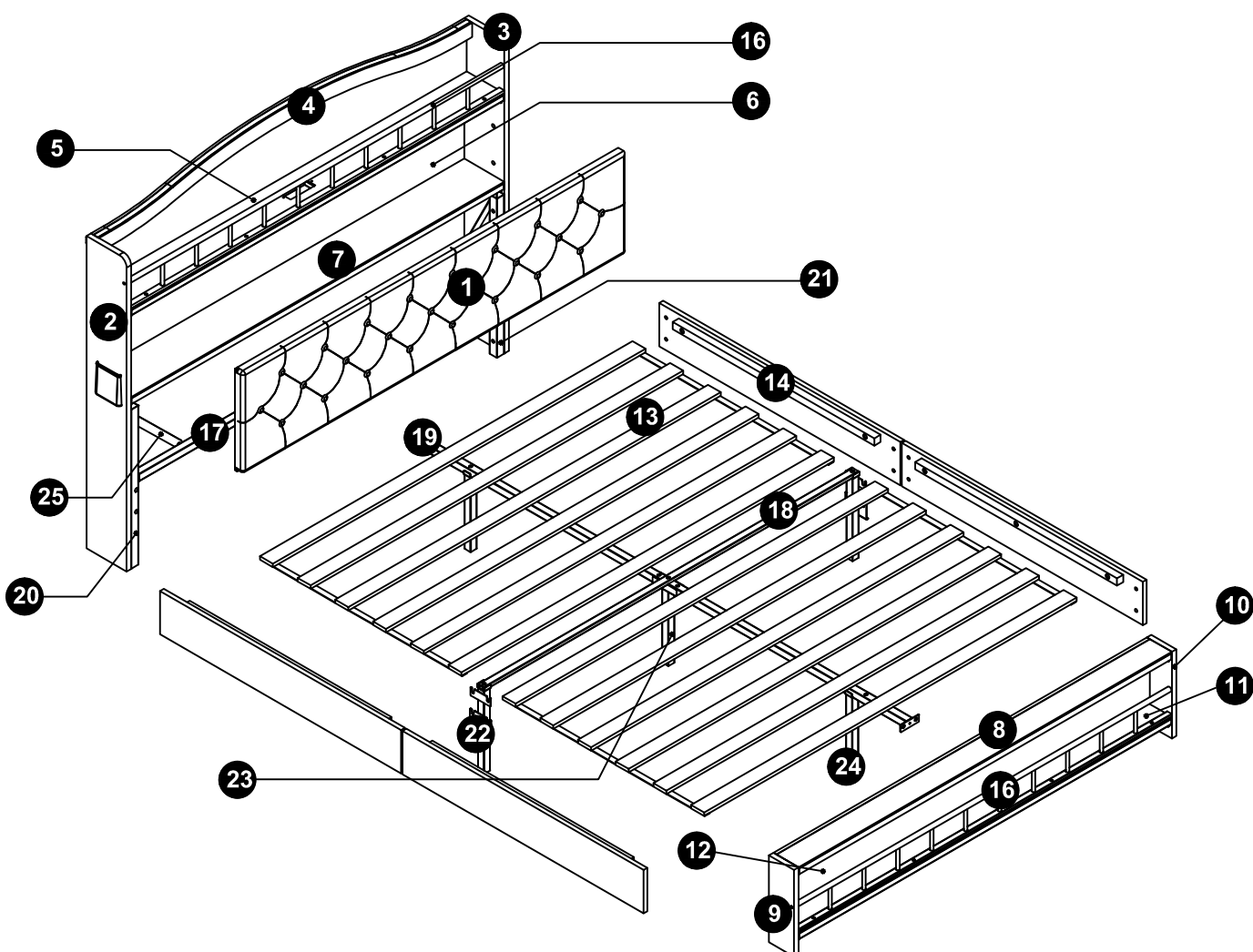

1

H M8\*45  
 x4

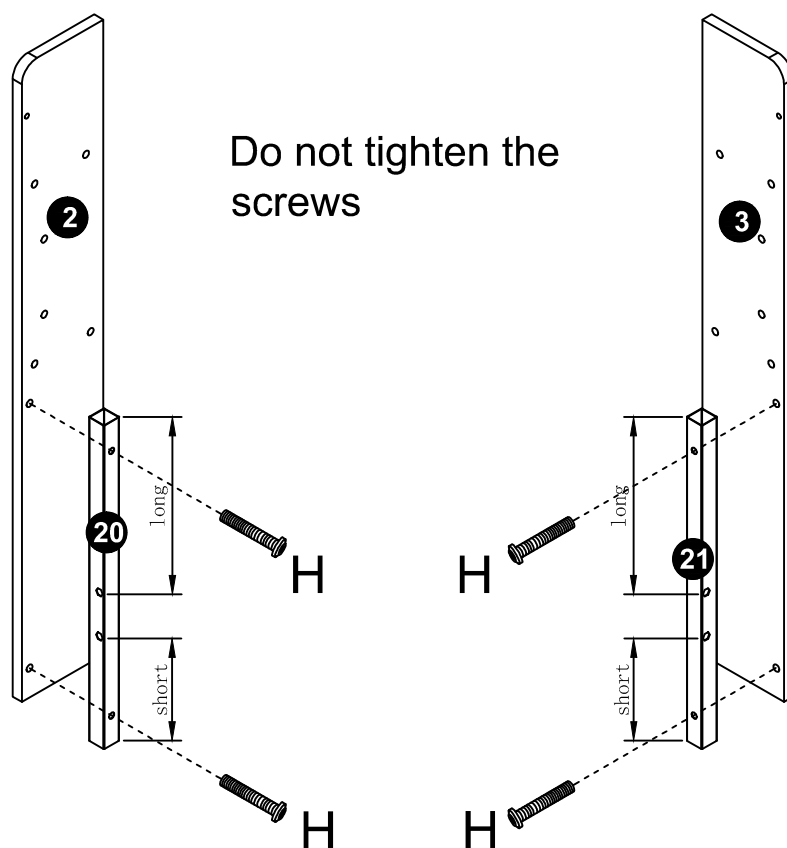

2

F M8\*20  
 x2

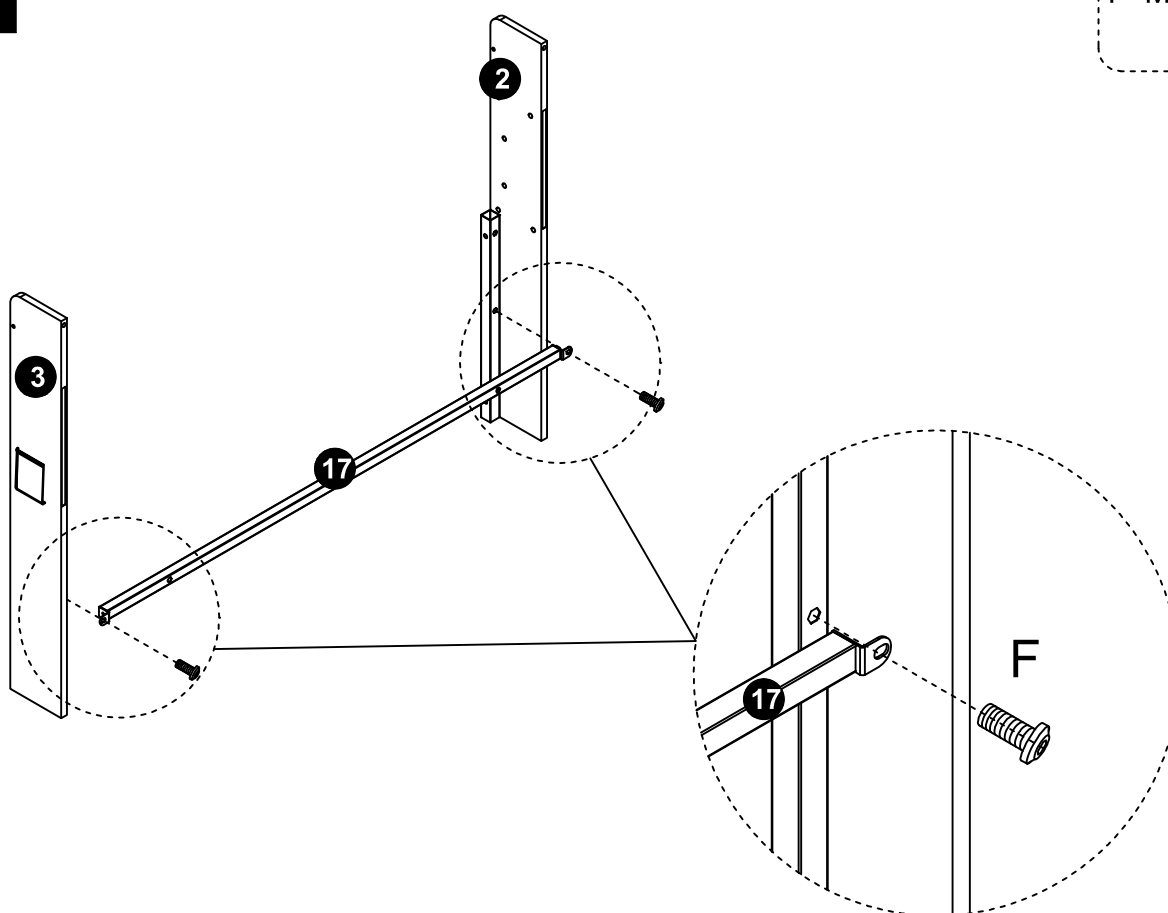

3

F M8\*20

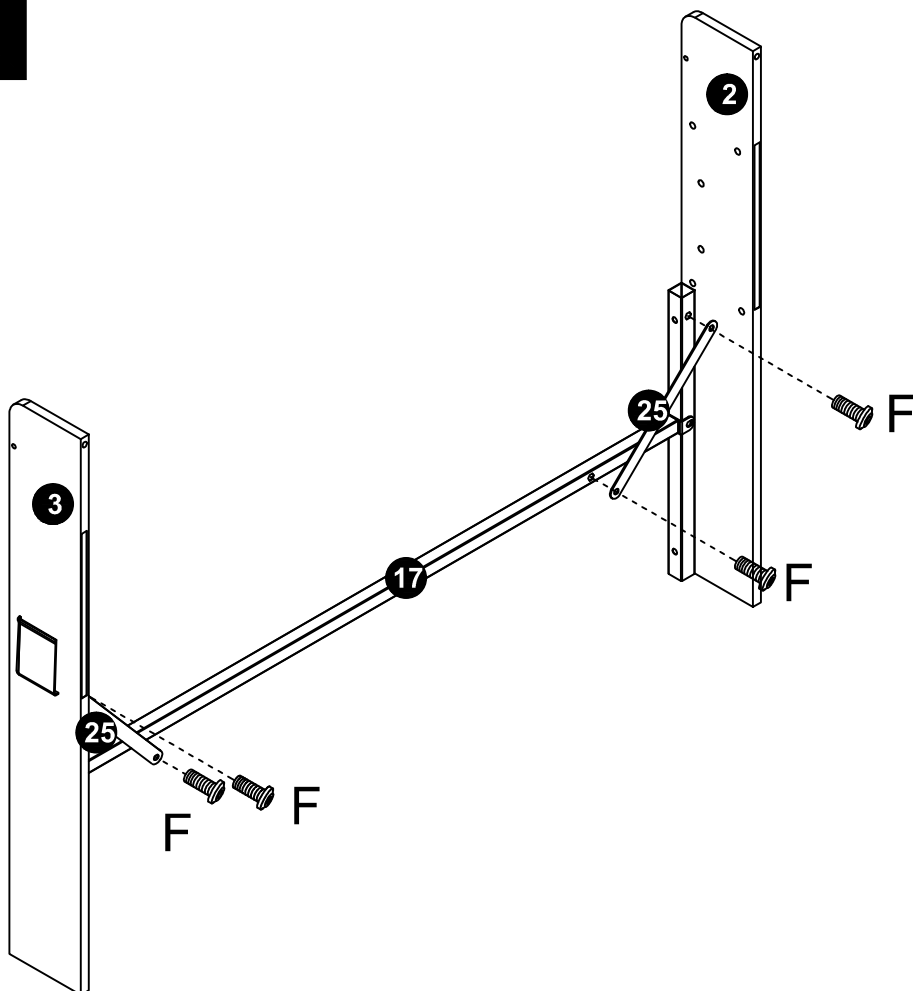
 x4

4

F M8\*20

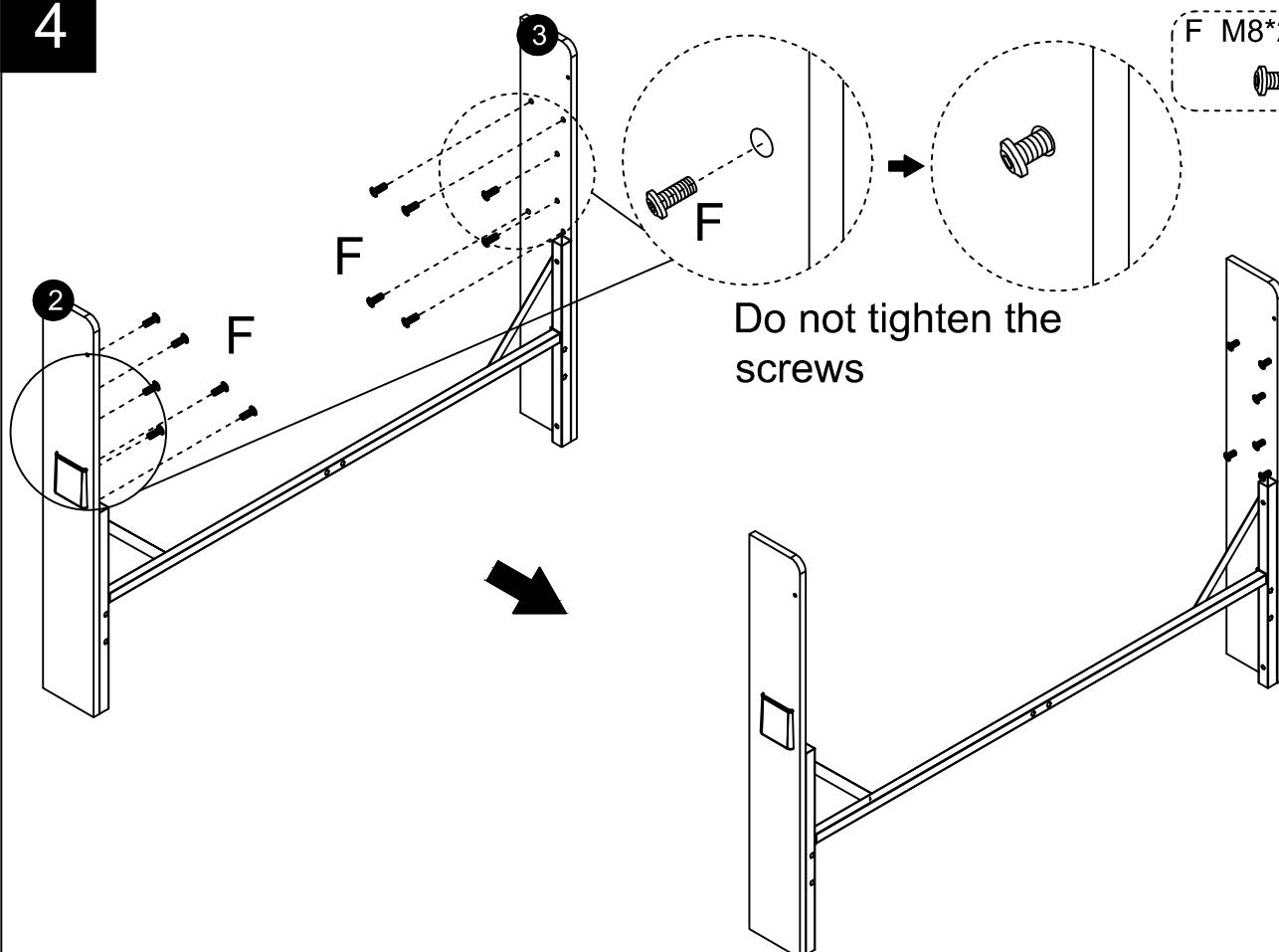
 x12



5

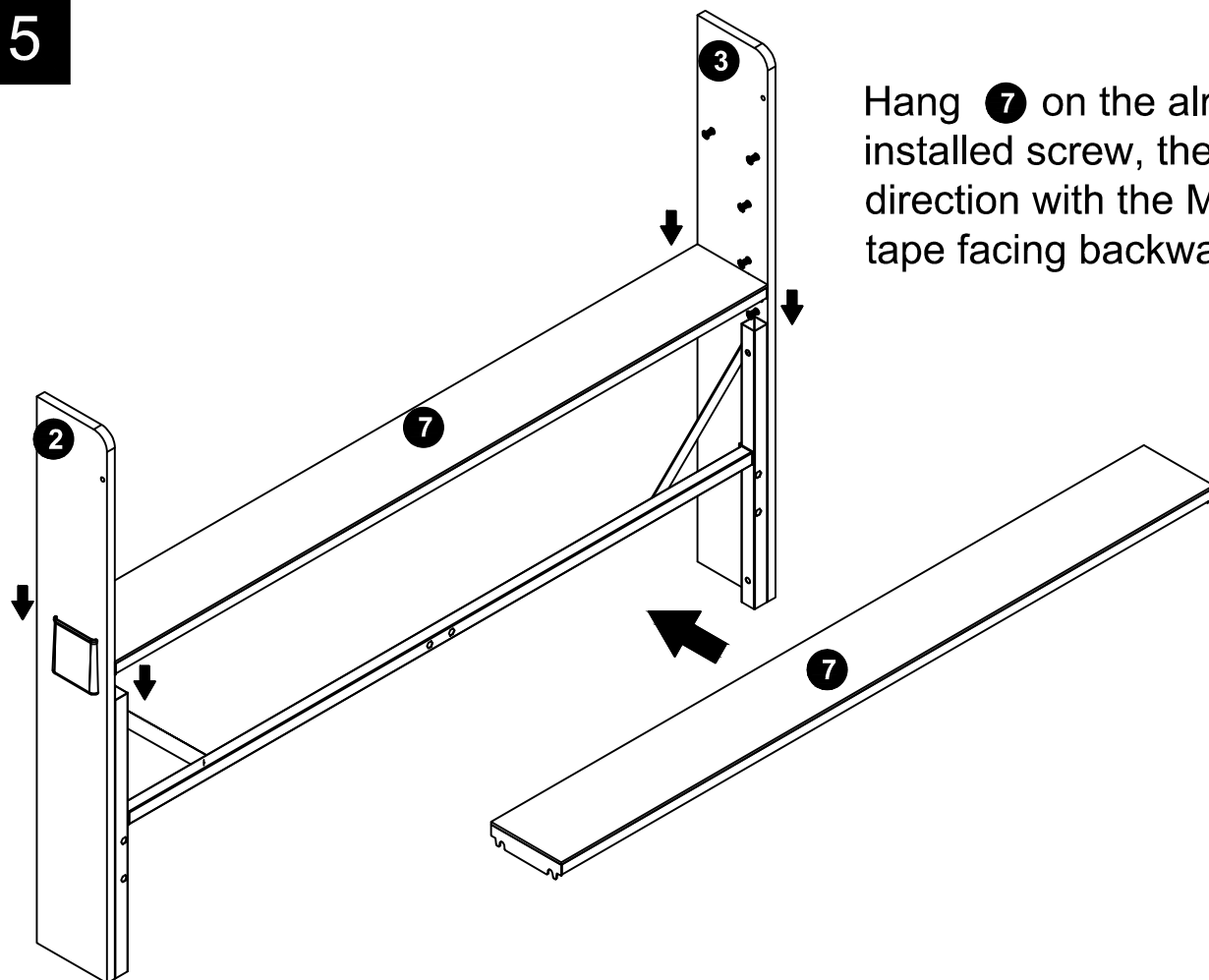

Hang ⑦ on the already installed screw, the direction with the Magic tape facing backwards

6

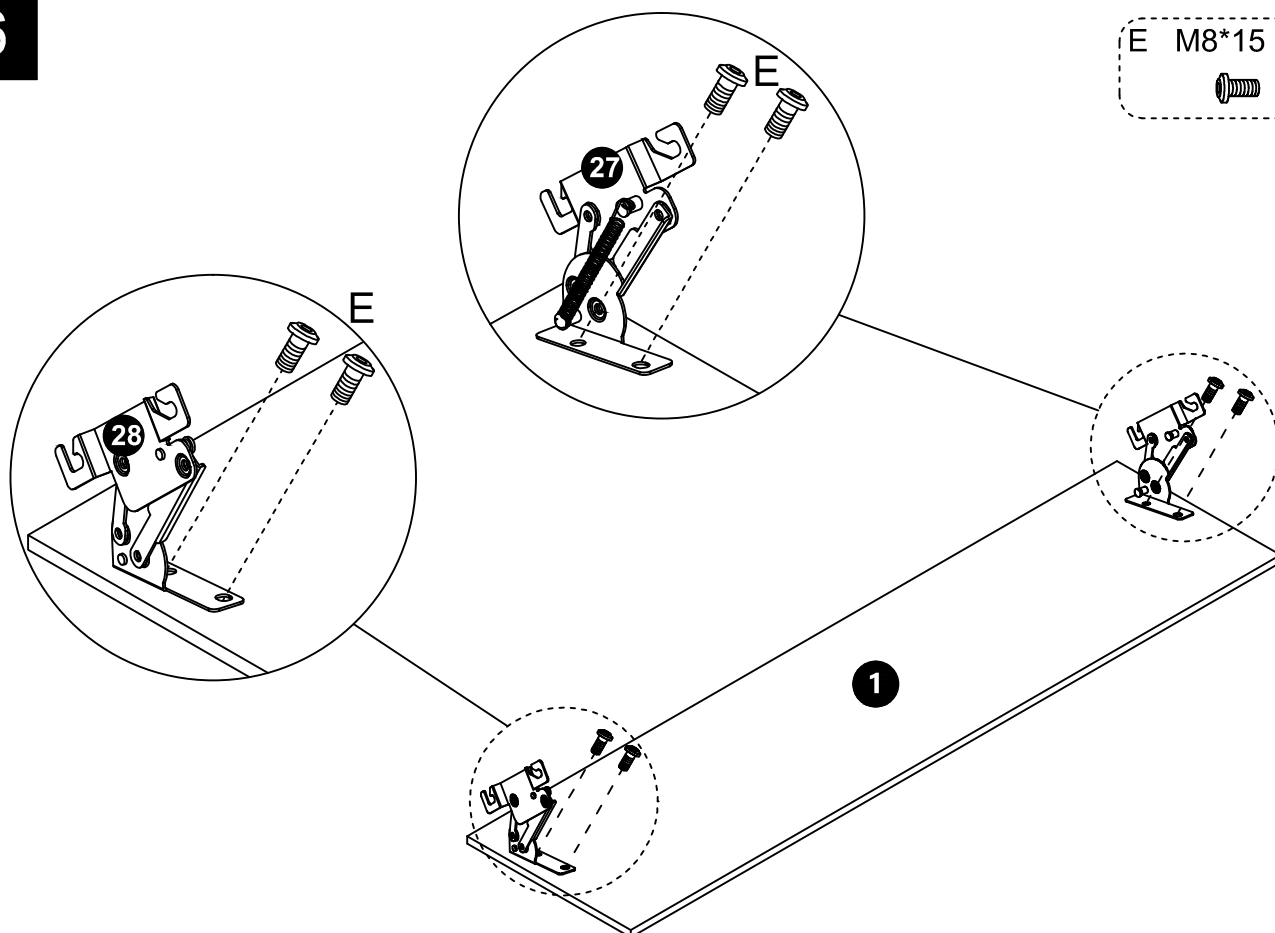

E M8\*15  
x4

7

Hang ❶ on the  
already installed  
screw

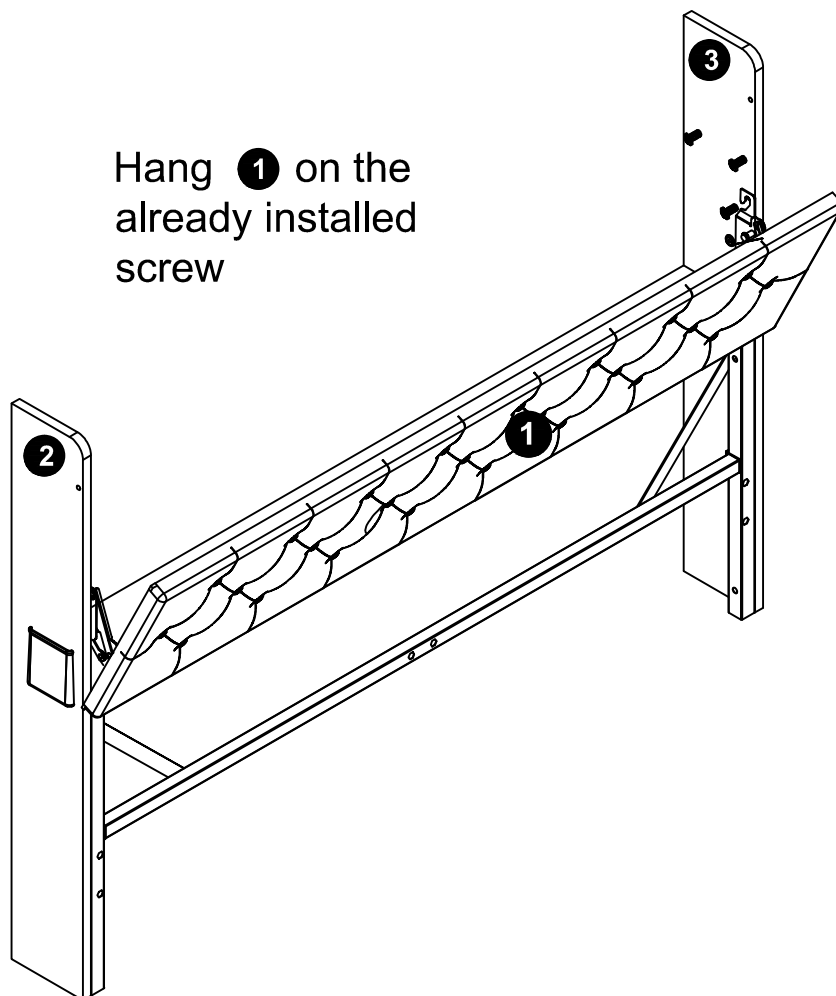

Hang it up first

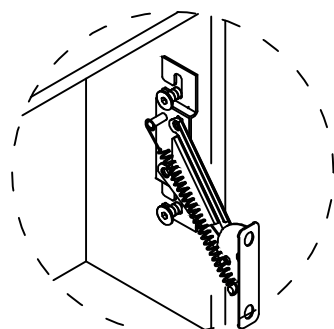
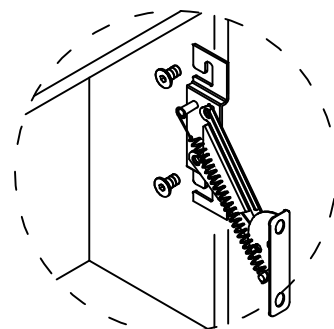

8

C M6\*30



x4

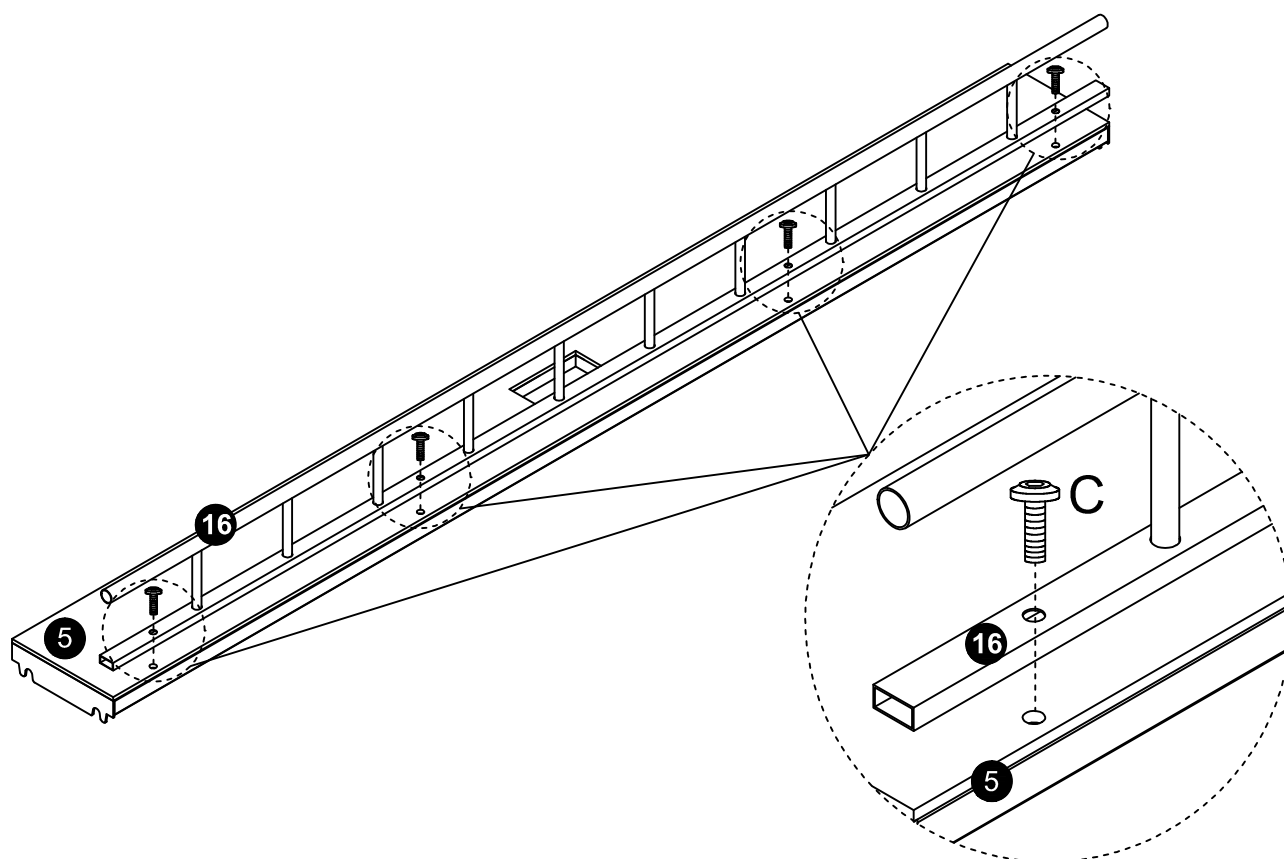

9

B M6\*25  
x4

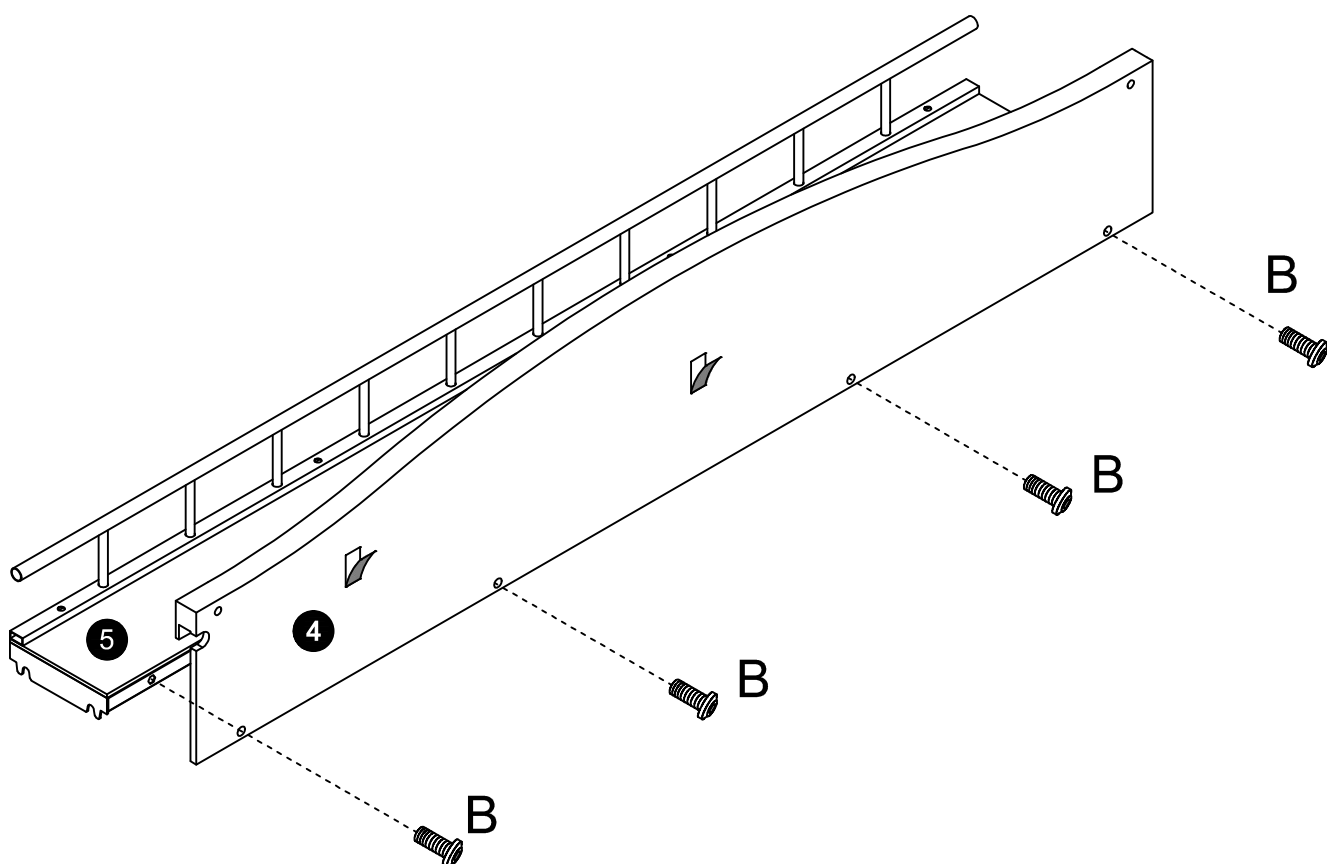

10

D M6\*45  
x2

Hang the components  
from step 3 onto the  
installed screws

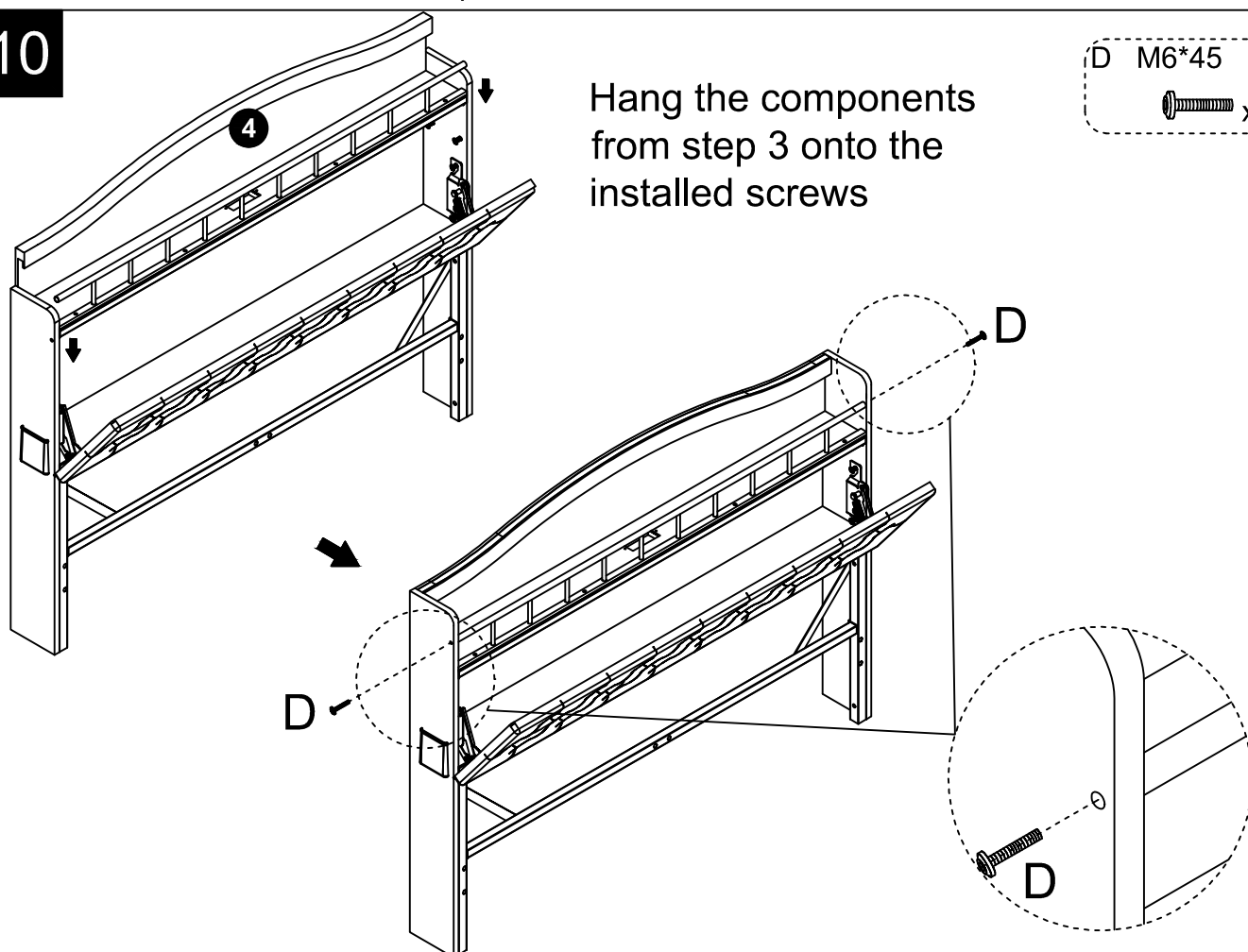

# 11

Tighten the screws of steps one and four before completing this step

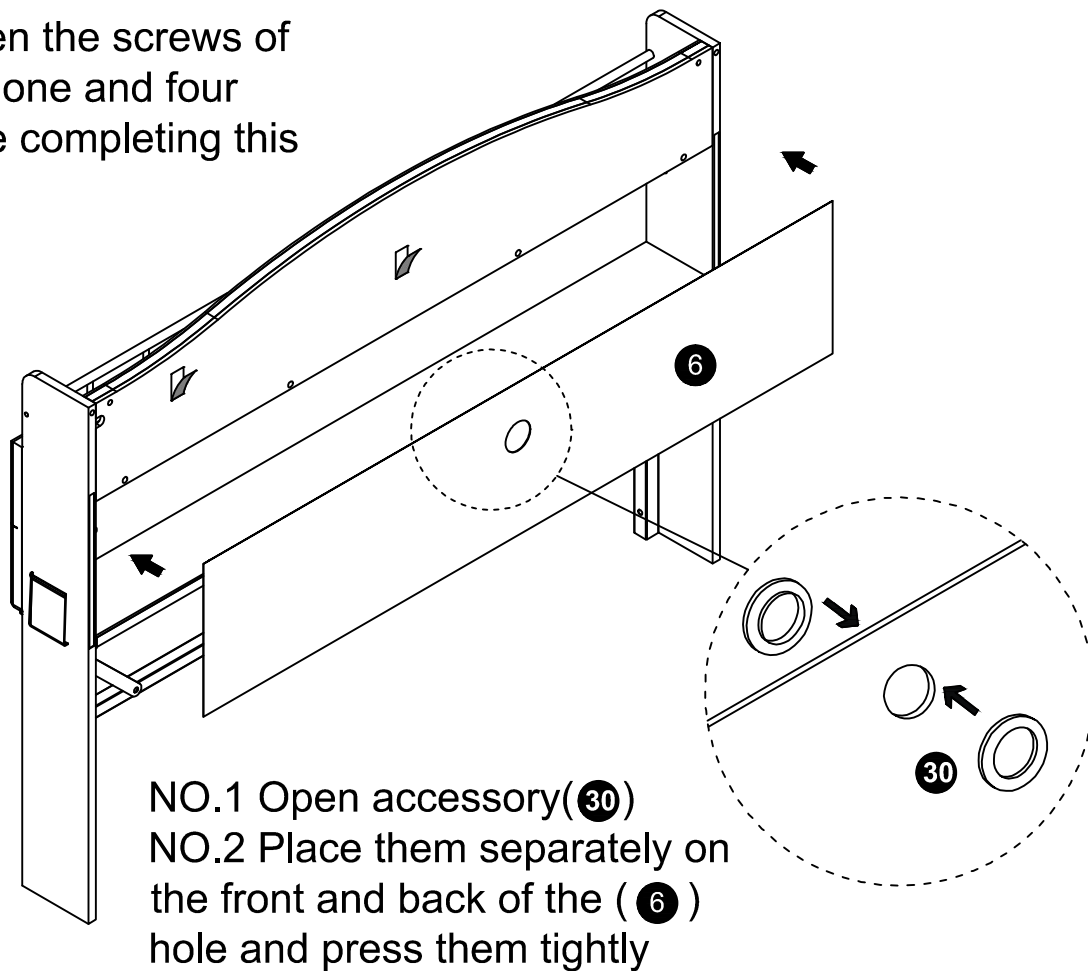

# 12

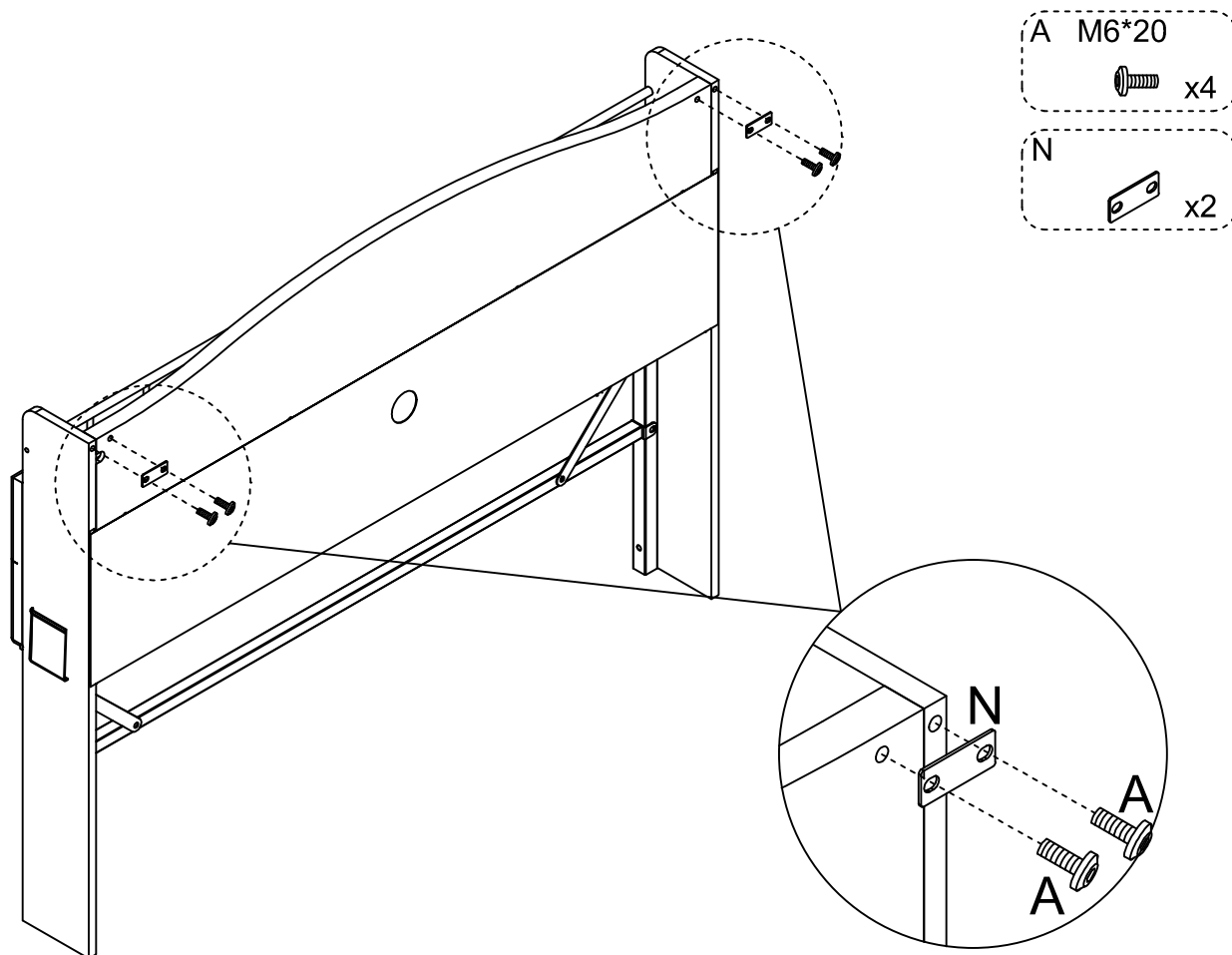

13

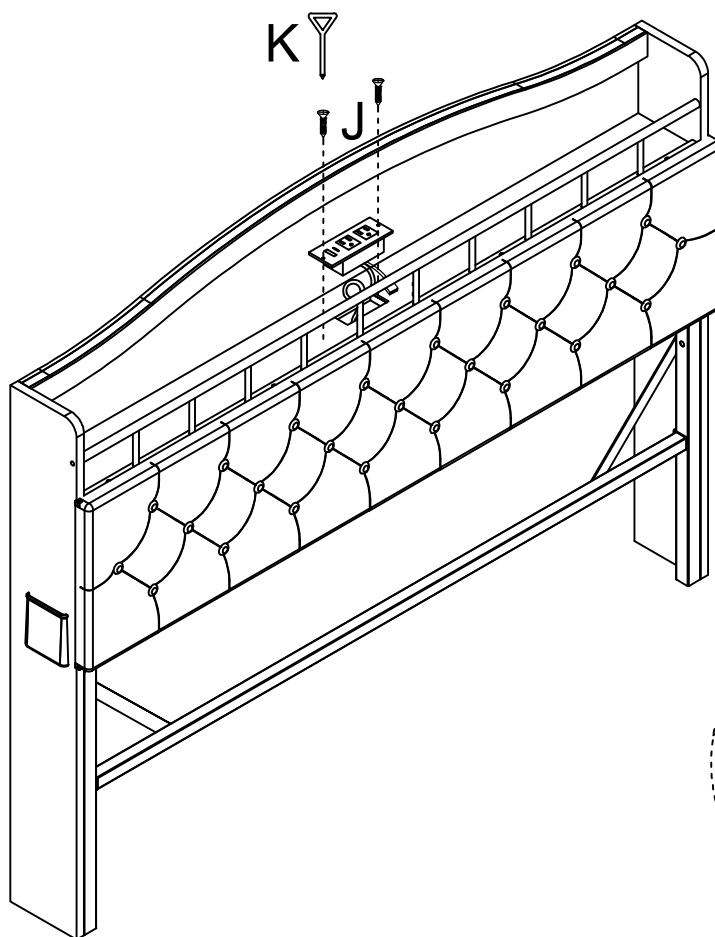

J M3\*12

x2

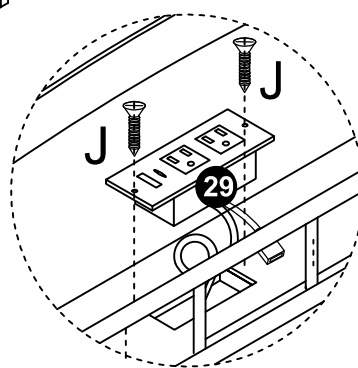

14

F M8\*20

x16

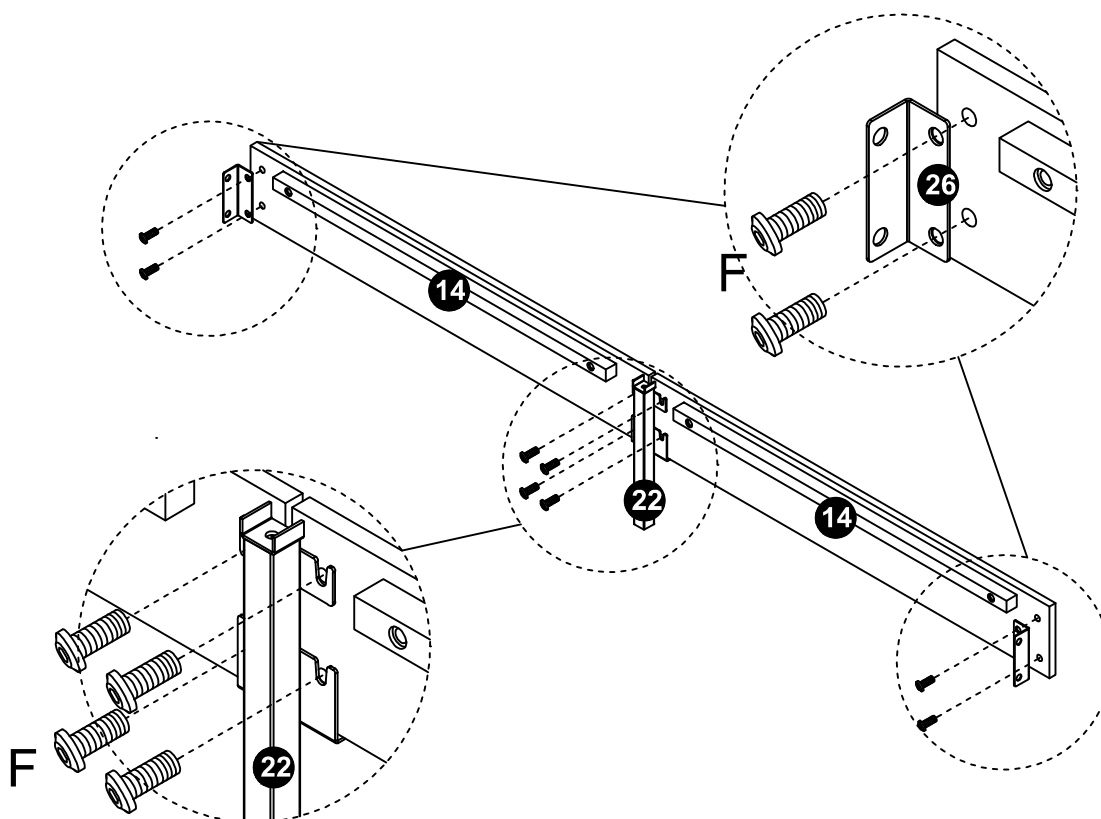

X 2

15

F M8\*20

x8

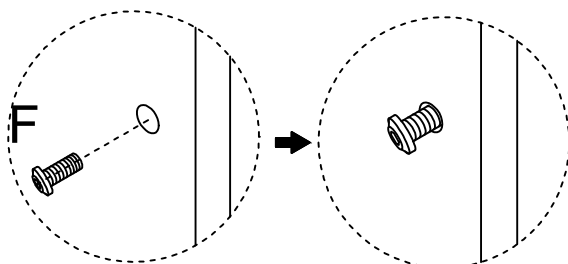

Do not tighten the screws

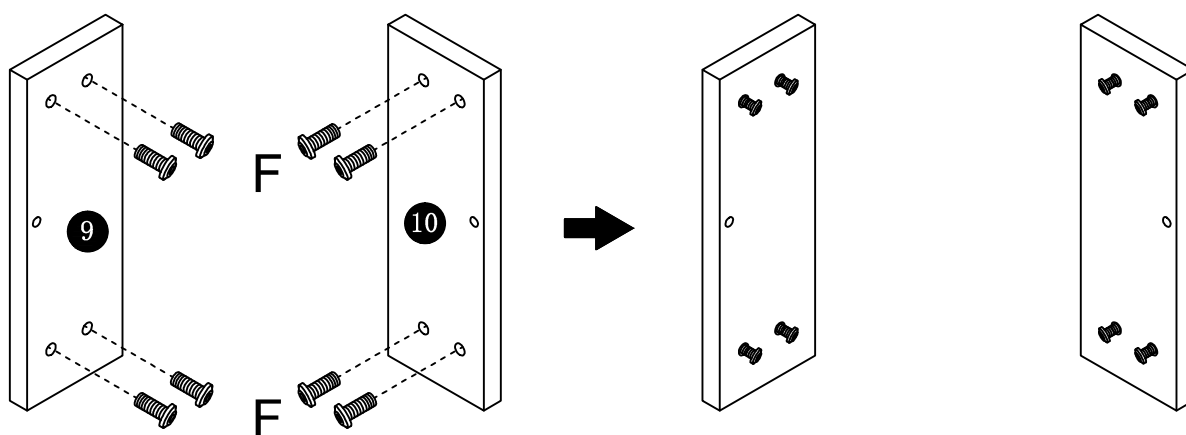

16

C M6\*30

x4

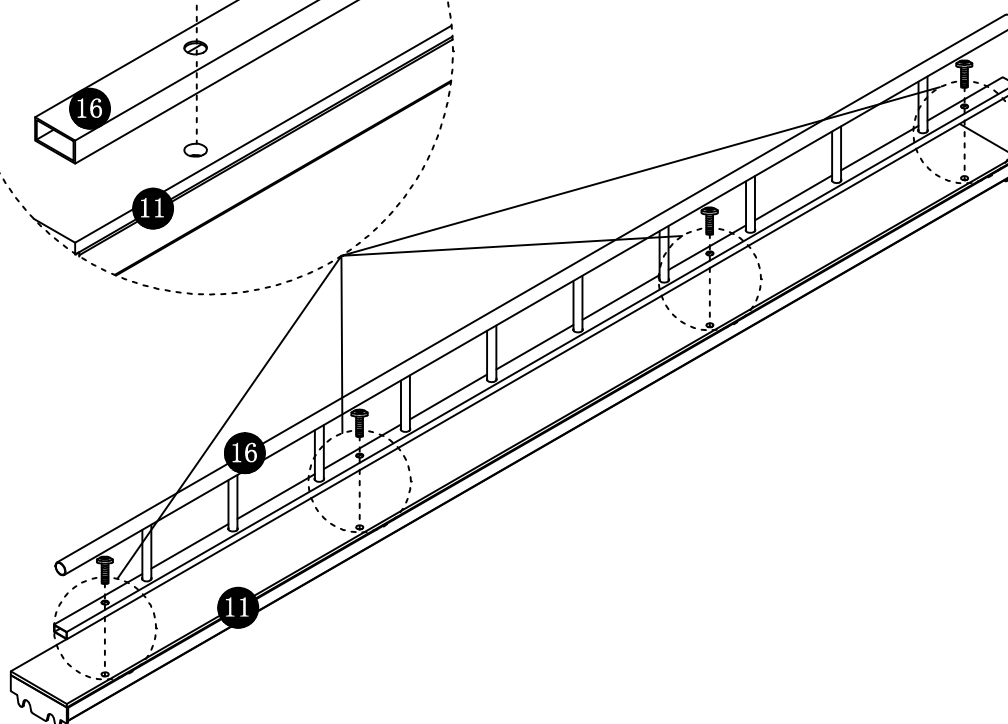
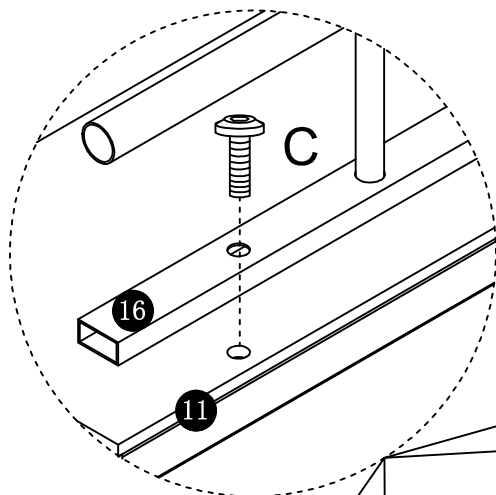

17

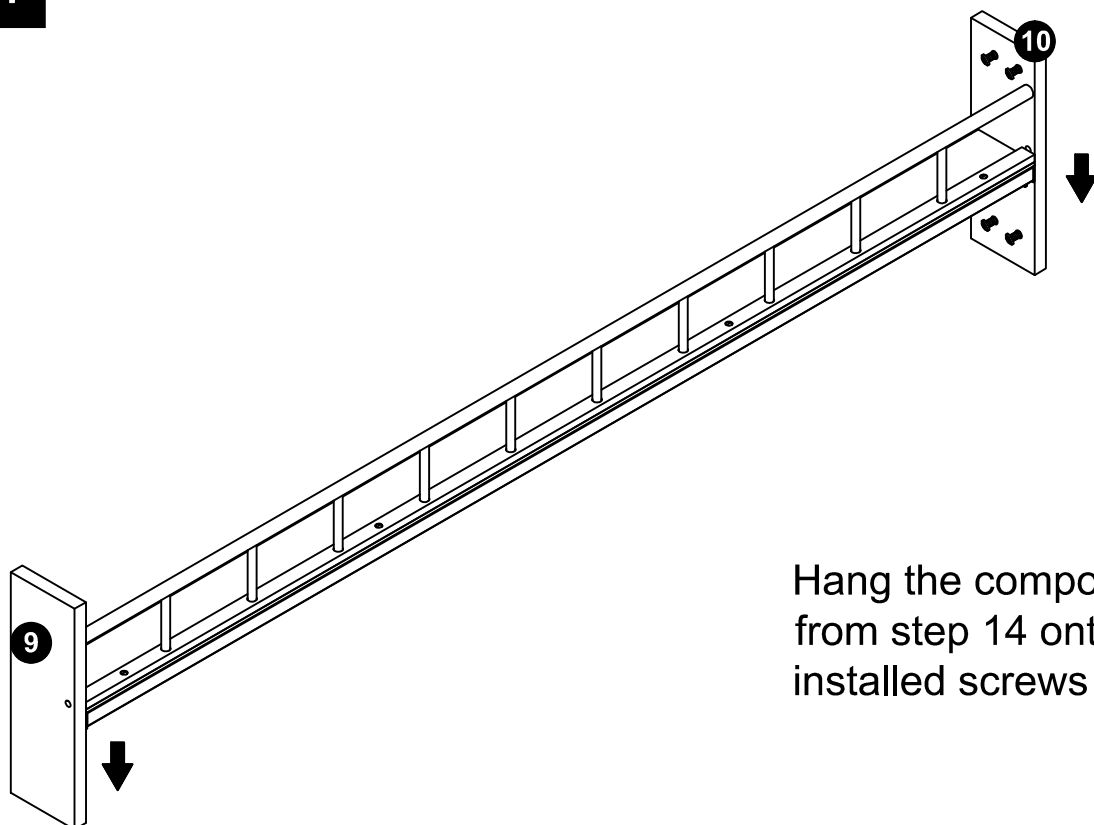

Hang the components from step 14 onto the installed screws

18

Pay attention to the direction of 8

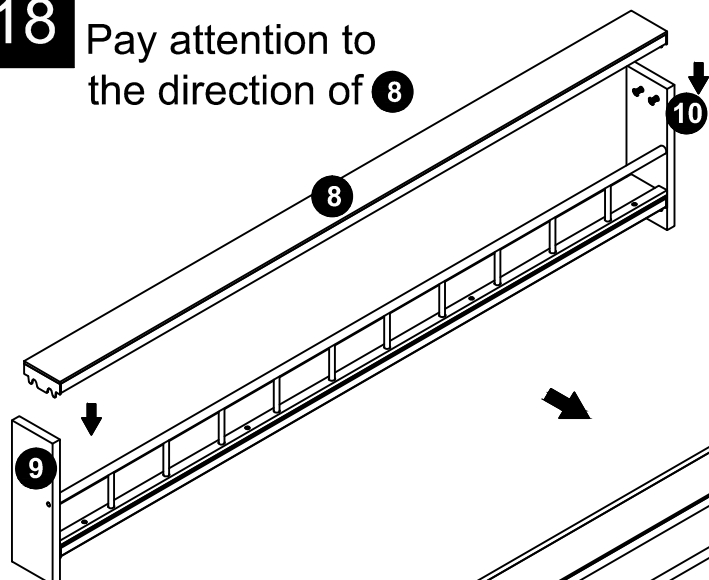

Hang 8 on the already installed screw

D M6\*45  
x2

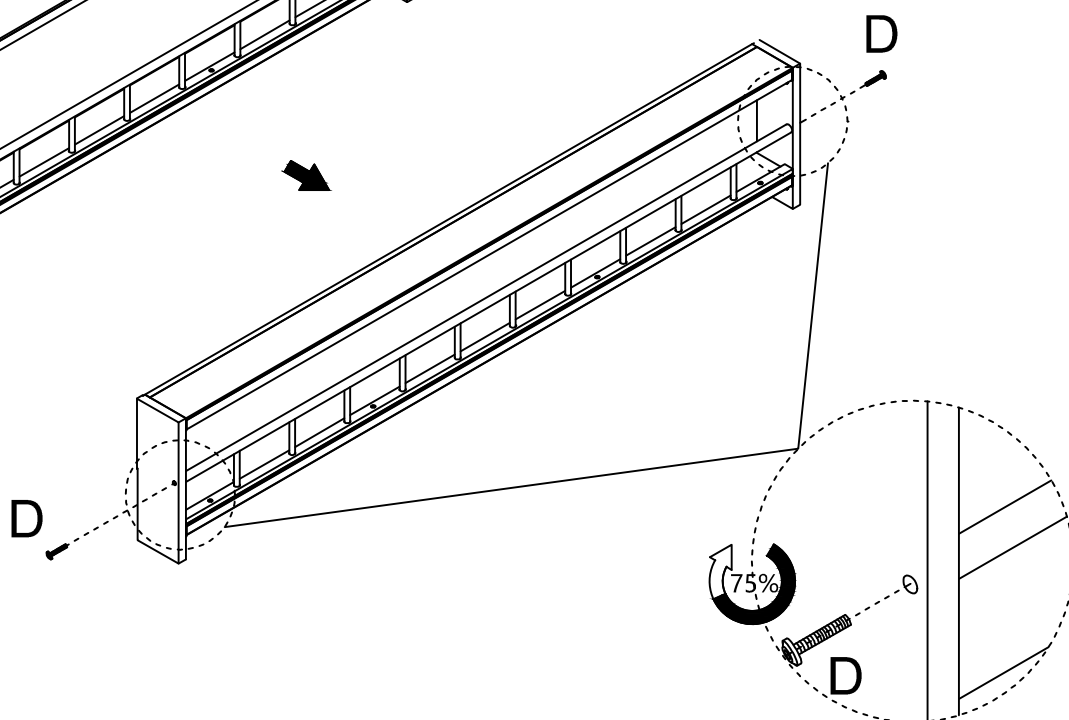

19

Step2

Tighten the D screw from the previous step

D

100%

B M6\*25 x8

B

B

B

B

B

B

12

Step1

This diagram illustrates the final assembly step for a component. It shows a perspective view of a long, narrow assembly with multiple internal channels. Eight screws, labeled 'B' and specified as M6\*25, are shown being inserted into pre-drilled holes along the length of the assembly. A circular inset labeled 'Step2' provides a close-up of a screw labeled 'D' being tightened, with a curved arrow indicating a 100% rotation. A callout box in the top right corner identifies the screws 'B' as M6\*25 and specifies that eight are required. A small square icon with the number '12' is also present on the assembly.

[illegible]



21

Please pay attention  
to the direction during  
installation

E M8\*15

x6

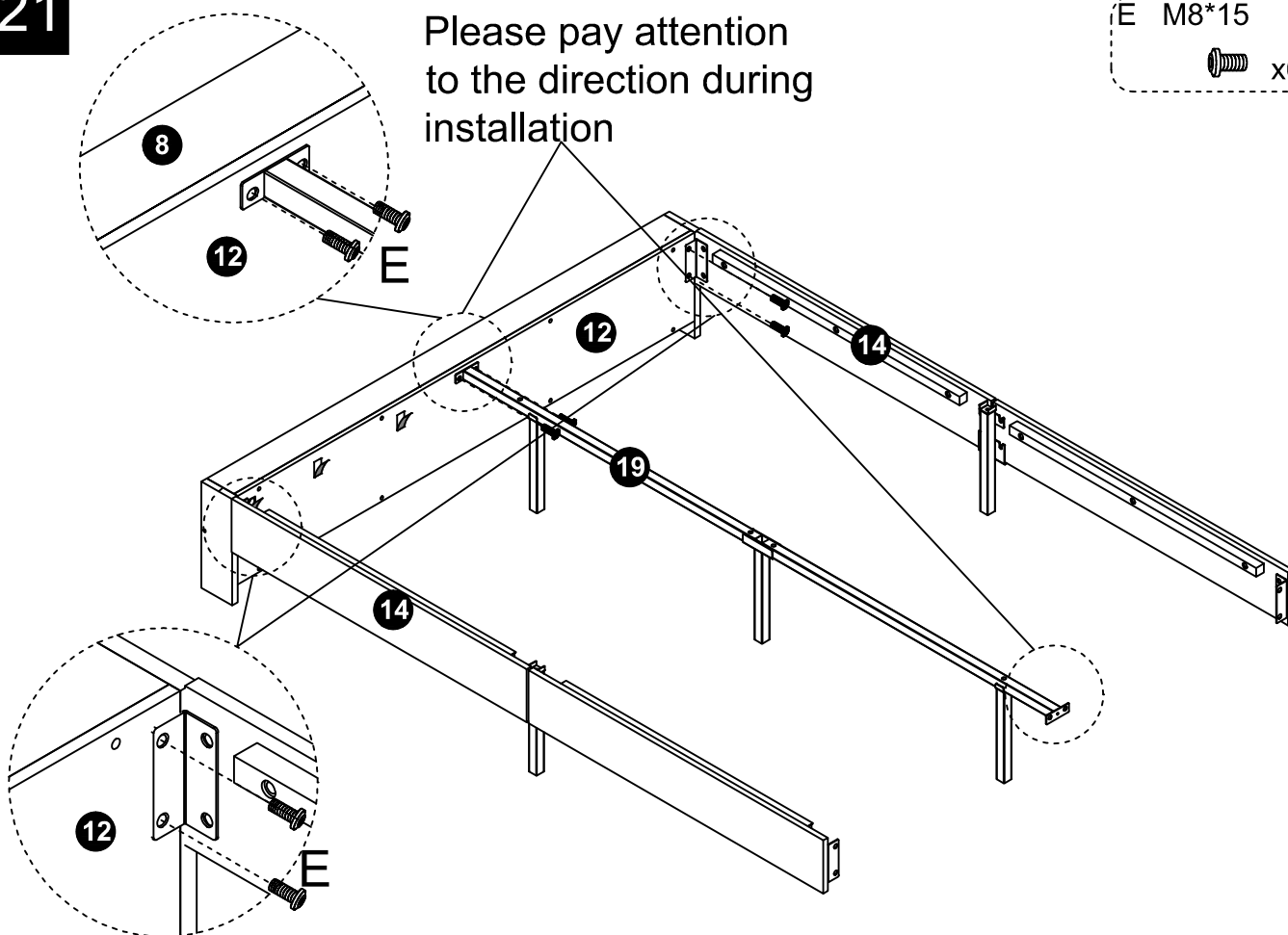

22

F M8\*20

x6

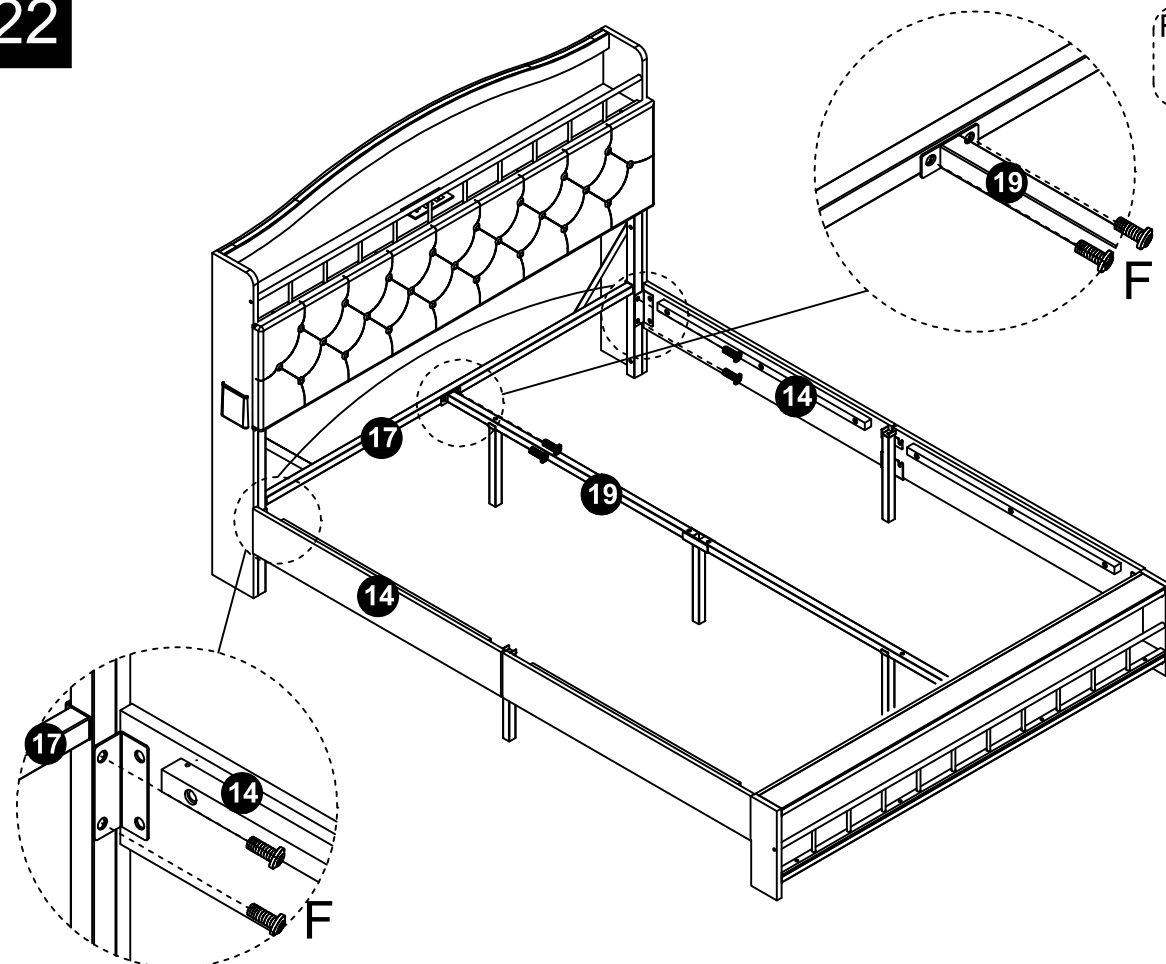

23

G M8\*35  
x2

I M8\*50  
x1

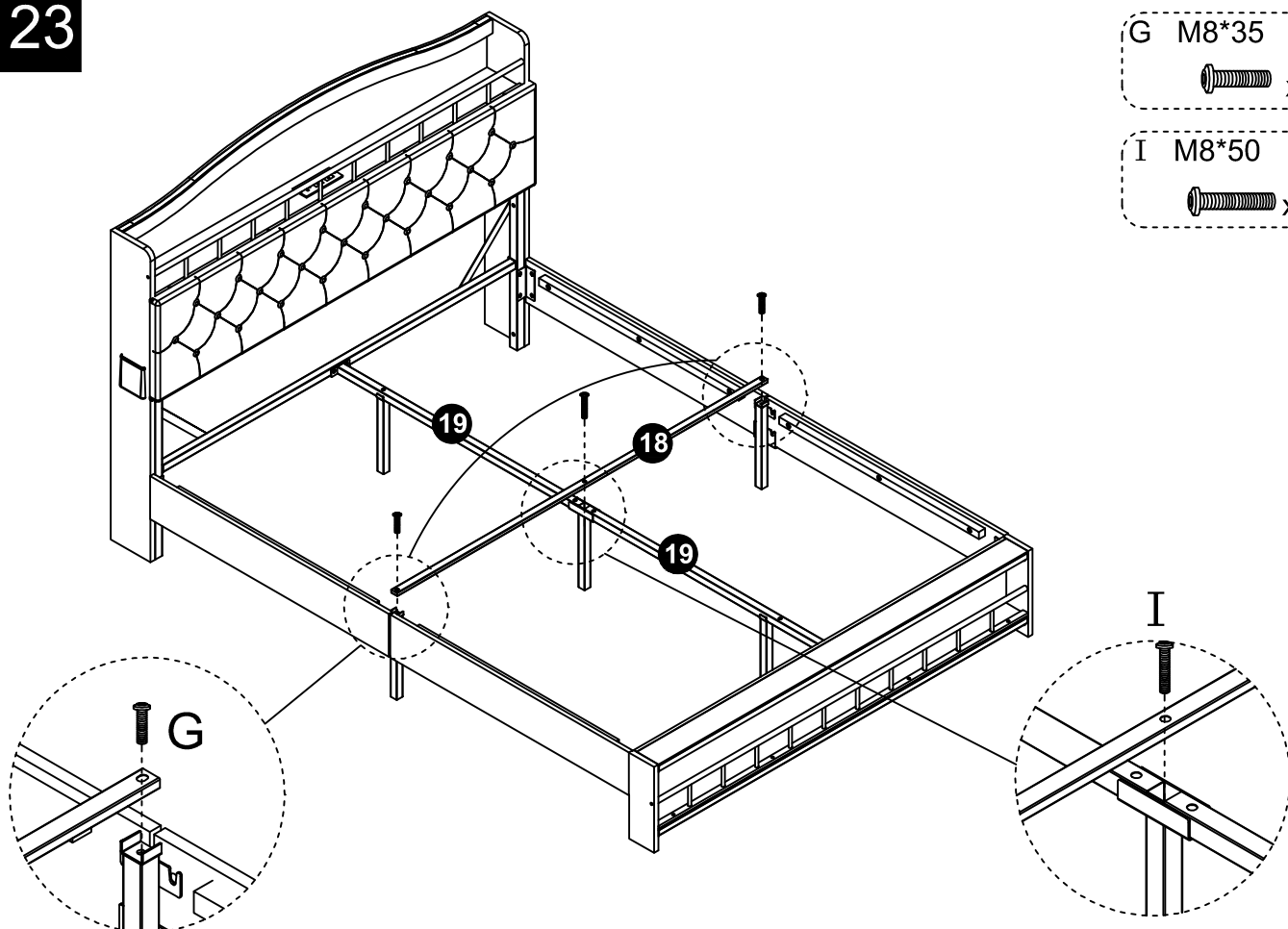

24

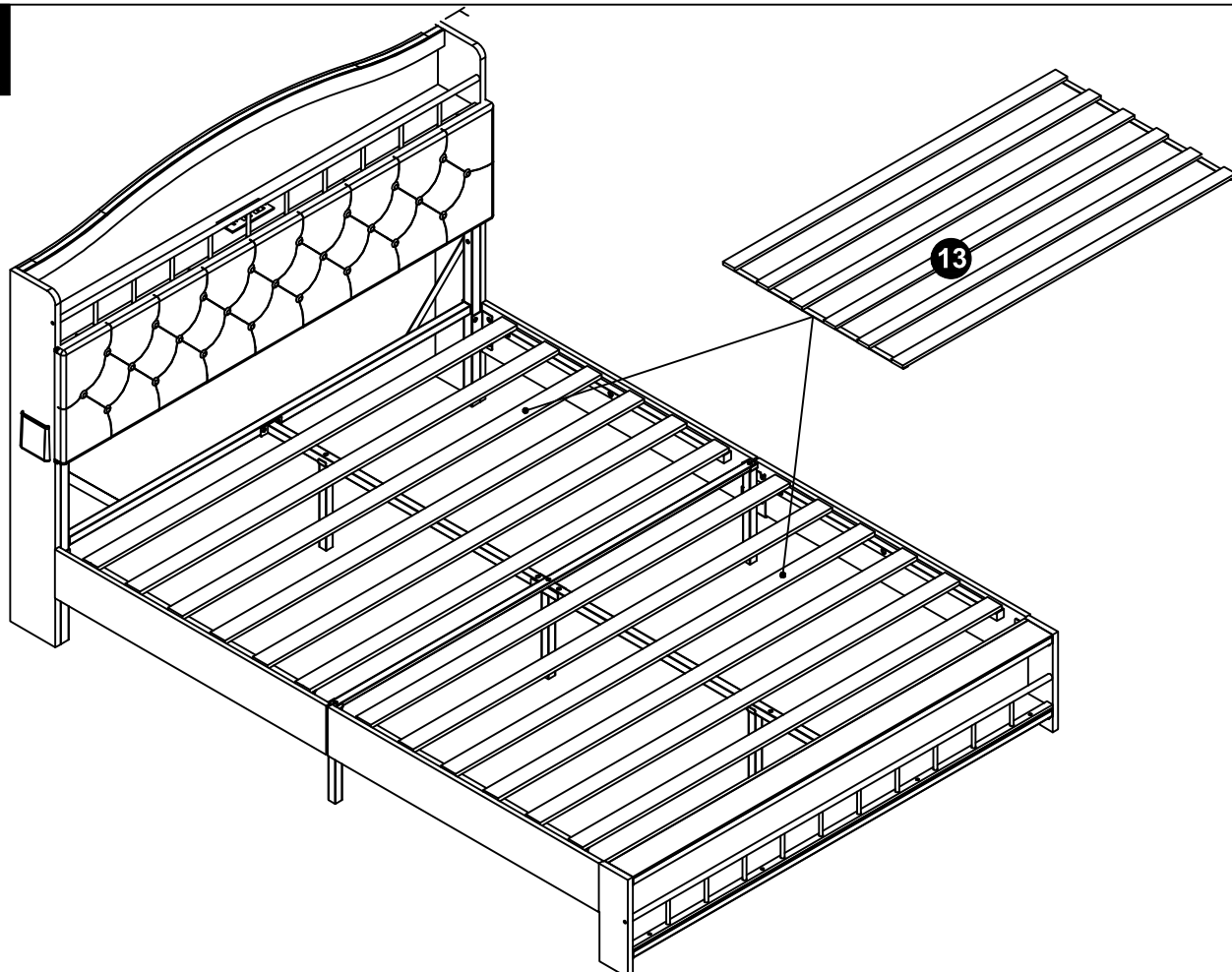

**LED related accessories**

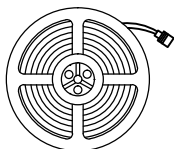

Light strip X2

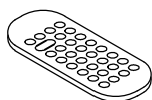

Remote control X1

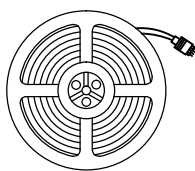

light strip  
2PCS



Pull out  
and unfold

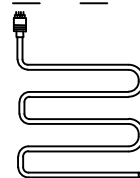

light strip

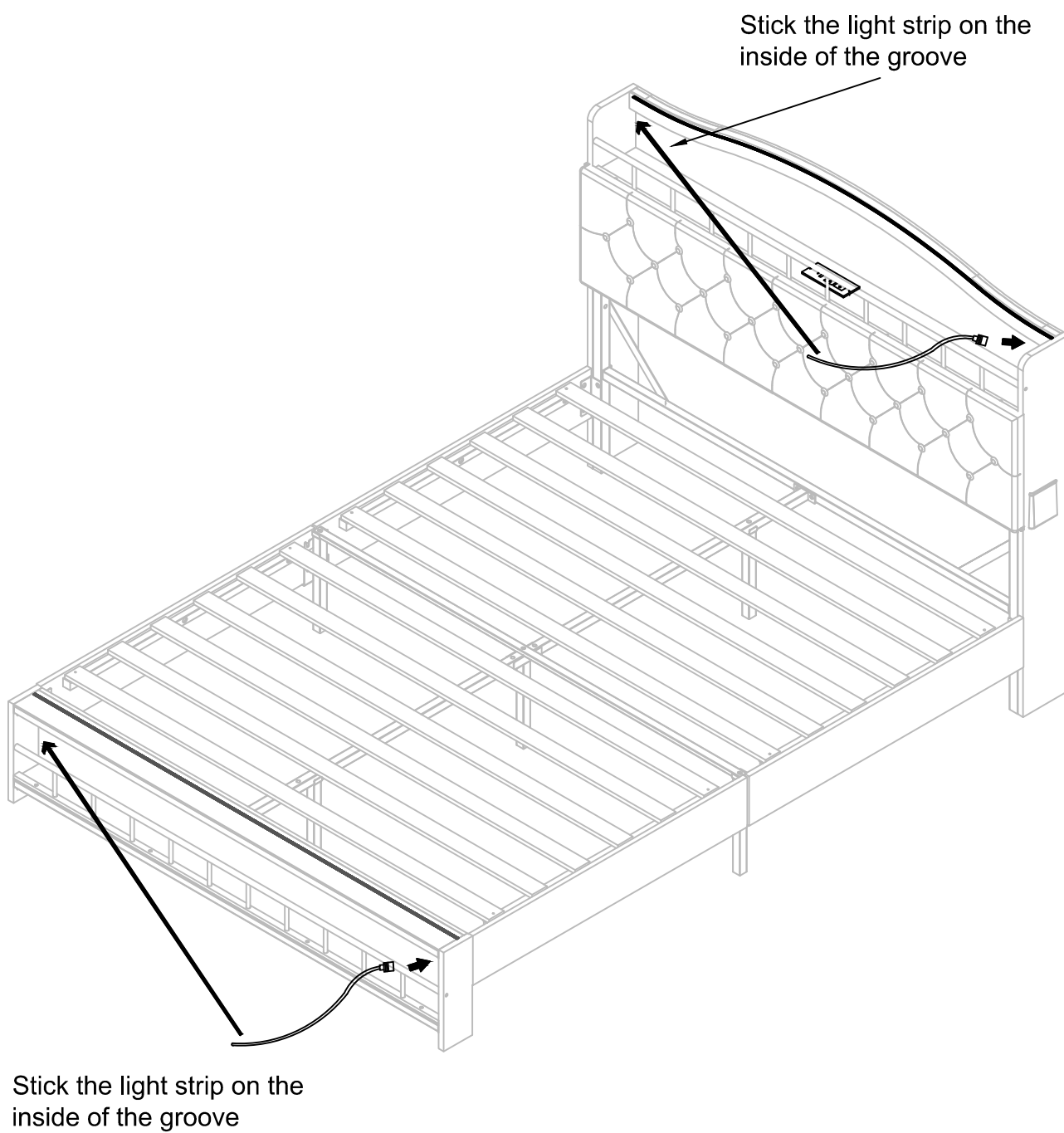

Stick the light strip on the  
inside of the groove

Stick the light strip on the  
inside of the groove

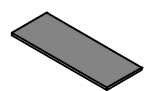

Magic tape  
8PC

You can use Magic tape to stick the connecting wire of the light strip anywhere

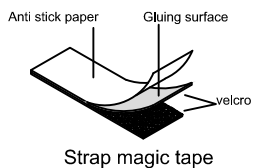

When the wires are disordered, tear off the anti stick paper, paste it on the place where the wires pass, and then bind the wires.

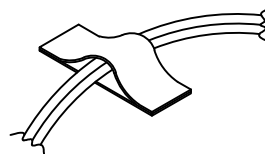

Use the Magic tape we provide to stick the connecting wire of the light strip onto the iron component

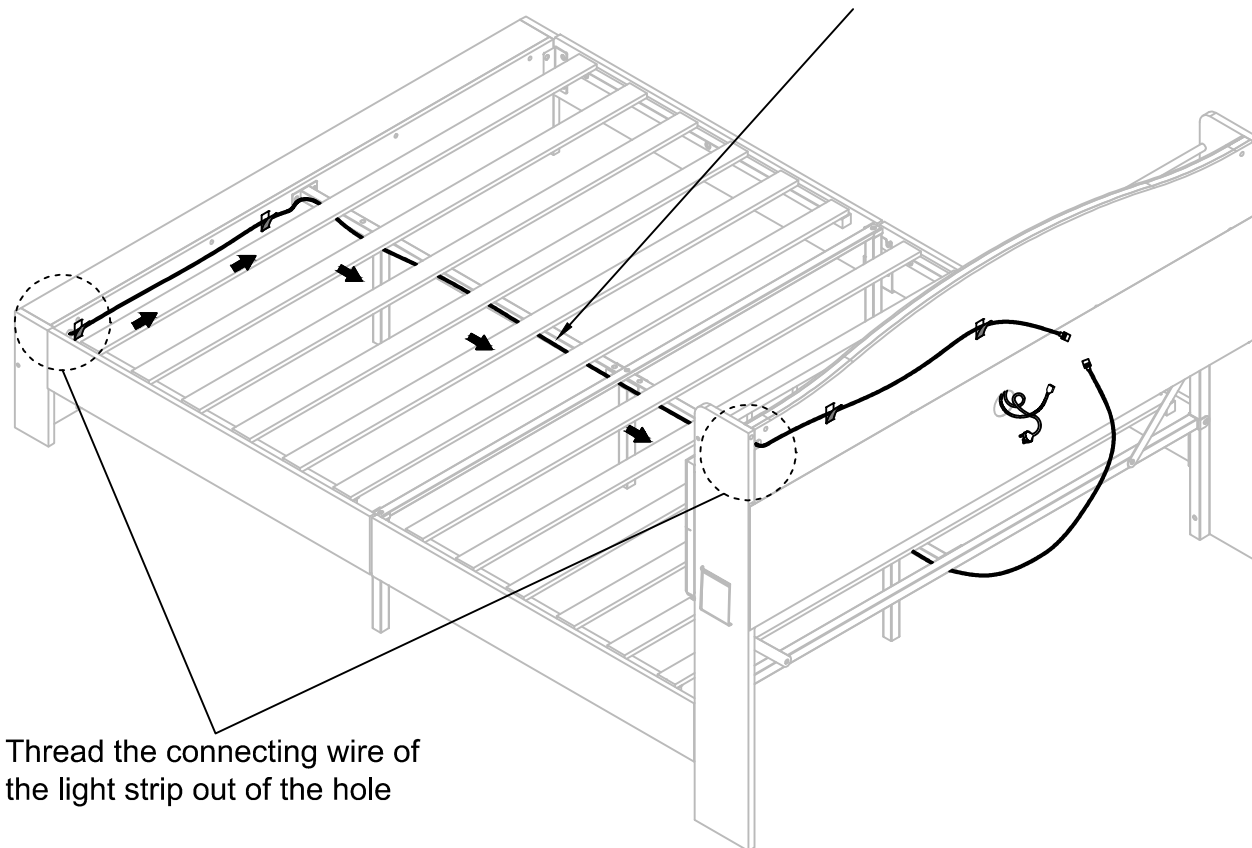

Thread the connecting wire of the light strip out of the hole

Clip in the harness  
Magic Band

Stick to

