

Lamp Wall Sconce

INSTALLATION SHEET

START FROM HERE

- Make sure power is completely off at the fuse box.
- Have your fixture installed by a qualified licensed electrician
- Prepare everything in a clear area.
- Wear gloves at all times during this installation.
- Read instructions carefully before you start assembly.
- Keep this instruction sheet for future reference.

Please Note:

- E26/E27 light source, not including light source.
- Unless otherwise instructed, do not touch any part of the lamp holder.
- For dimming, an ELV (Electronic Low Voltage) type of dimmer is required.

installation method

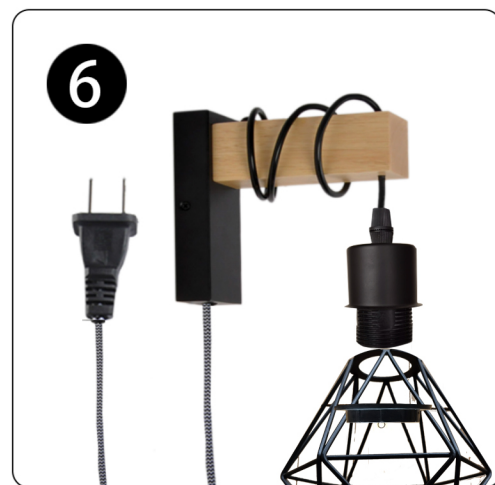
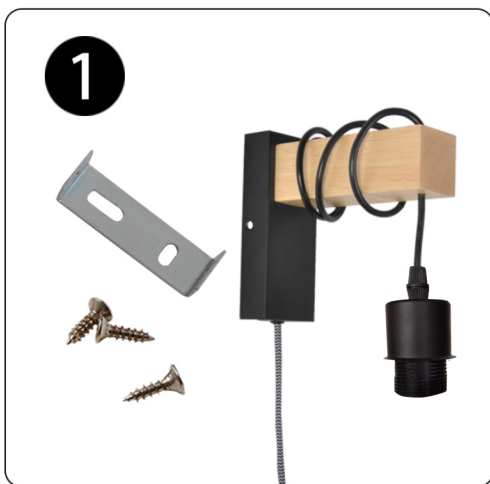

NOTE: this product just one hanging plate connect to the power box, so you need get the hanging plate from the base before you install it. For your safe, The installation must ensure that the line is powered off.

