

# 57" CARRIE ACRYLIC DOUBLE ROLL TOP TUB

Cat. No.  
ATDRNTD59B



L: 57"  
W: 31"  
H: 24"

Water depth: 18" to top of tub  
Water depth: 13-1/2" to overflow

## The following is recommended for ATDRN59B tubs:

- Faucets: #4602 or #4604 or 7082
- Freestanding Bath Supplies: #4502
- Freestanding Faucet: #7932, #7934 (Do Not Need Bath Supplies)
- Leg tub drain: part #5599LT or 5599TS



Overflow can be drilled .  
With overflow drilled this tub  
requires drain 5599.  
**Tubs that have been  
drilled with overflow are  
"special order" and  
are not returnable.**

Gallon Capacity : 45  
Shipping Weight: 217 lbs.  
Empty Weight: 107 lbs.  
Filled Weight: 483 lbs.

## Features:

- Interior and exterior walls 5mm acrylic sheets
- Space between walls completely filled with fiberglass & resin
- No faucet holes
- Tap deck
- No overflow
- Includes base
- IAPMO Certified
- Built-in adjusters included
- Tub is thoroughly inspected before shipment



WARNING: This product can expose you to chemicals, including Toluene and Styrene, which are known to the state of California to cause cancer and birth defects or other reproductive harm.  
For more information go to [www.P65Warnings.ca.gov](http://www.P65Warnings.ca.gov)

**Custom Colors Available** (inside of tub is always white enamel):  
Painted bathtubs are considered "special order" and are not returnable  
\$160 Bisque or Black \$250 Designer Color

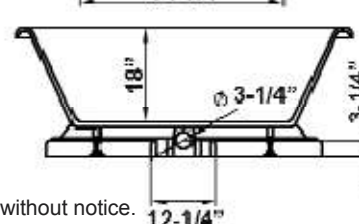
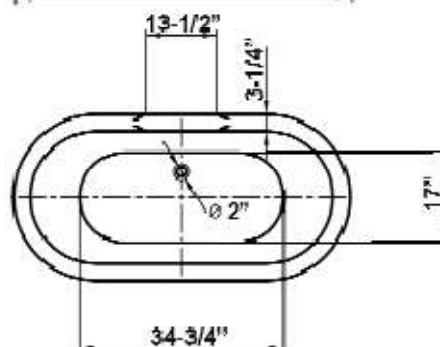
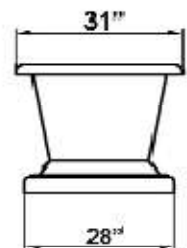
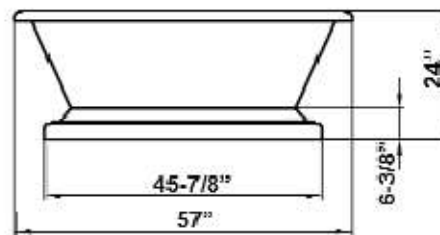

Dimensions of fixture are nominal and specifications subject to change without notice.