

MASSAGE CHAIR ASSEMBLY INSTRUCTION

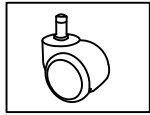

THANK YOU FOR PURCHASING MASSAGE CHAIR LCH-HHP-4 PARTS LIST



A 5×Wheels

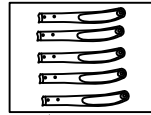

B15×Split base
tube

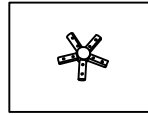

B2 1×Central
base tube

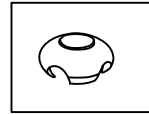

B31×base cover

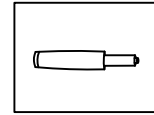

C1 1×gas lift

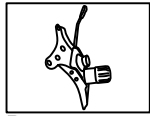

D1×mechanism

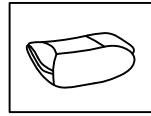

E 1×seat

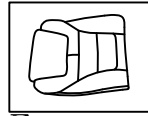

F 1×back

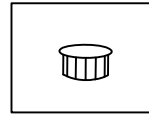

G 8×Plastic caps

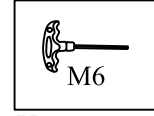

H 1×allen key
M6

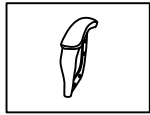

I1 Left armrests

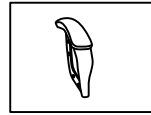

I2 Right armrests

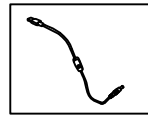

P31×Extension cord

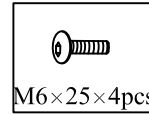

M6×25×4pcs
Z12 4×screws

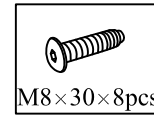

M8×30×8pcs
Y13 8×screws

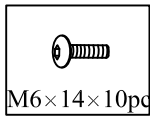

M6×14×10pcs
Z2 10×screws

WARNING

- Do not stand in this chair or use the chair as a step ladder use it as chair only.
- This chair is designed for one person to use at a time.
- This chair is designed for one person weighing up to 500lbs(226kgs).
- Do not use this chair unless all bolts, screws and knobs are firmly secured.
- Check all bolts,screws and knobs every 90days. Tighten if any are loose.
- Failure to follow these instructions may result in serious injury or death of yourself and people around you.
- Some of the part are heavy and/or has shape edge, please install it carefully to avoid hurt you and people around you.

1

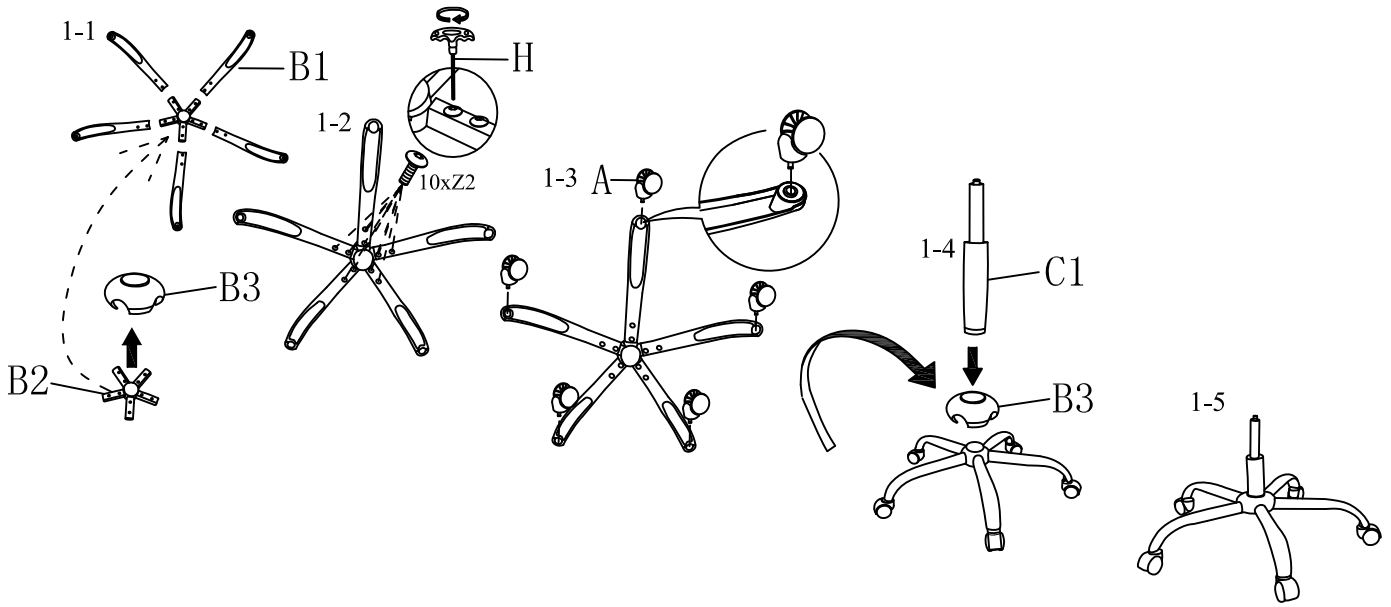

2

Tips: When not in use, the extension cord of massage can be put into this bag

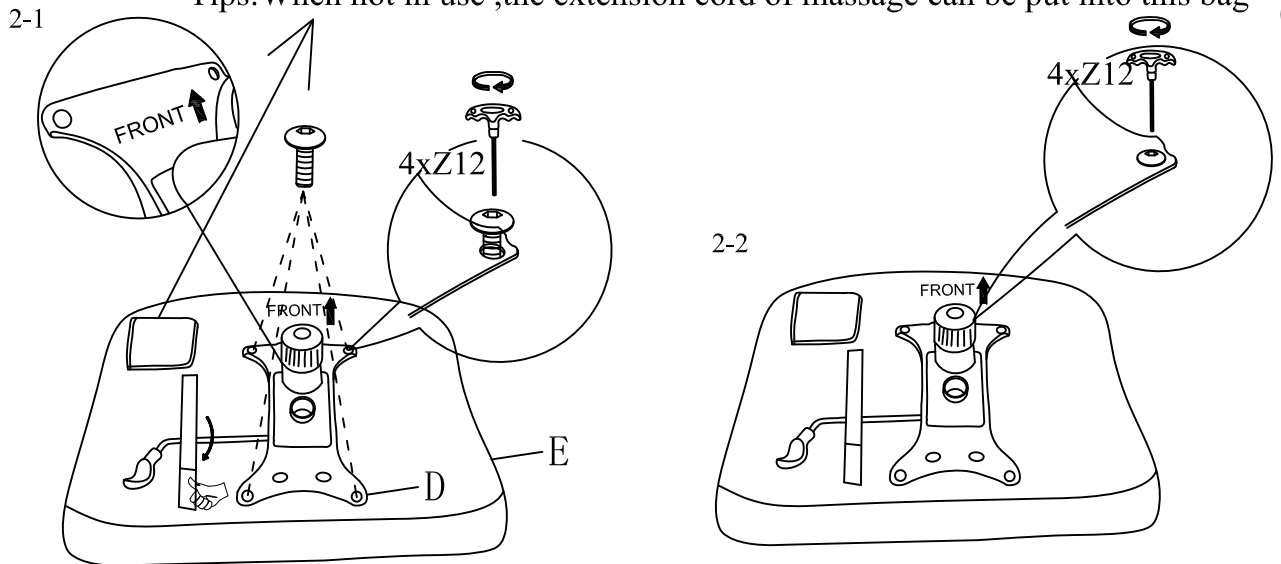

Please do not tight the screw until all screw lined up with hole and try to tight it loosely initially in all screws then tight a little bit more in all screws do not overnight one screws that will make other screw hard to tight but tight all screw firmly in the end

3

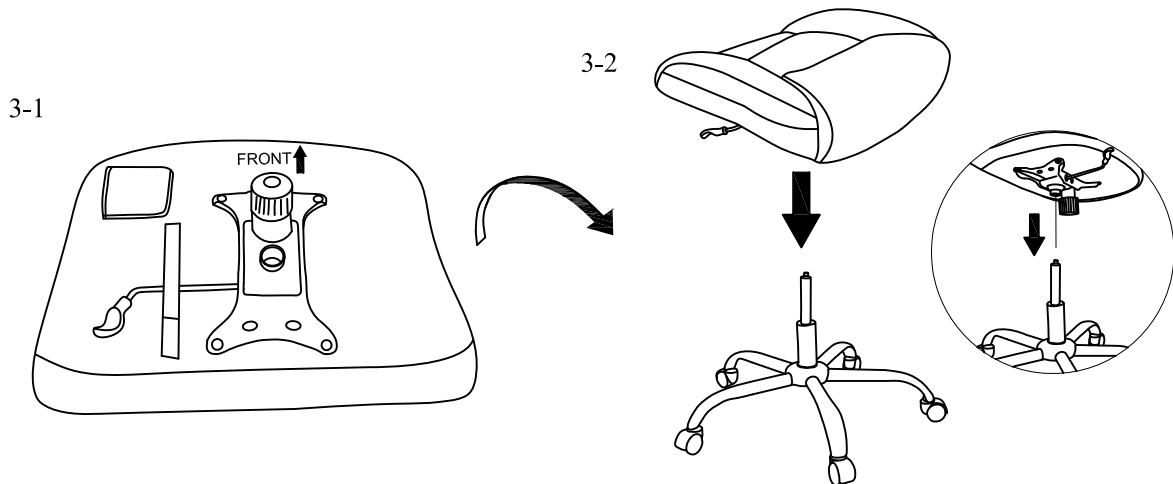

4

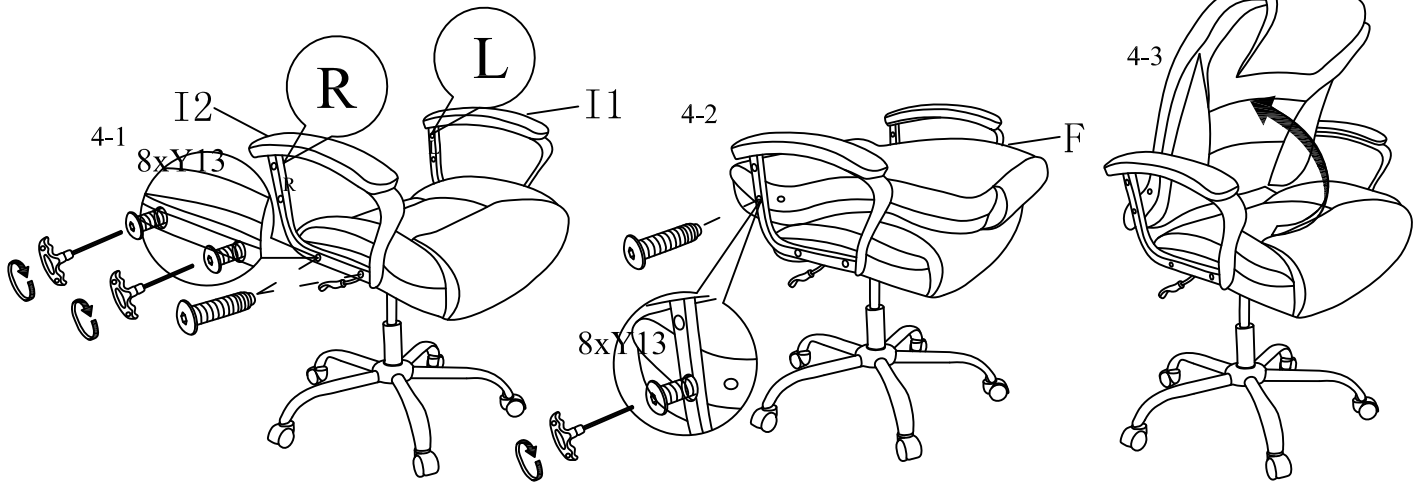

Please do not tight the screw until all screw lined up with hole and try to tight it loosely initially in all screws then tight a little bit more in all screws do not overnight one screws that will make other screw hard to tight but tight all screw firmly in the end

5

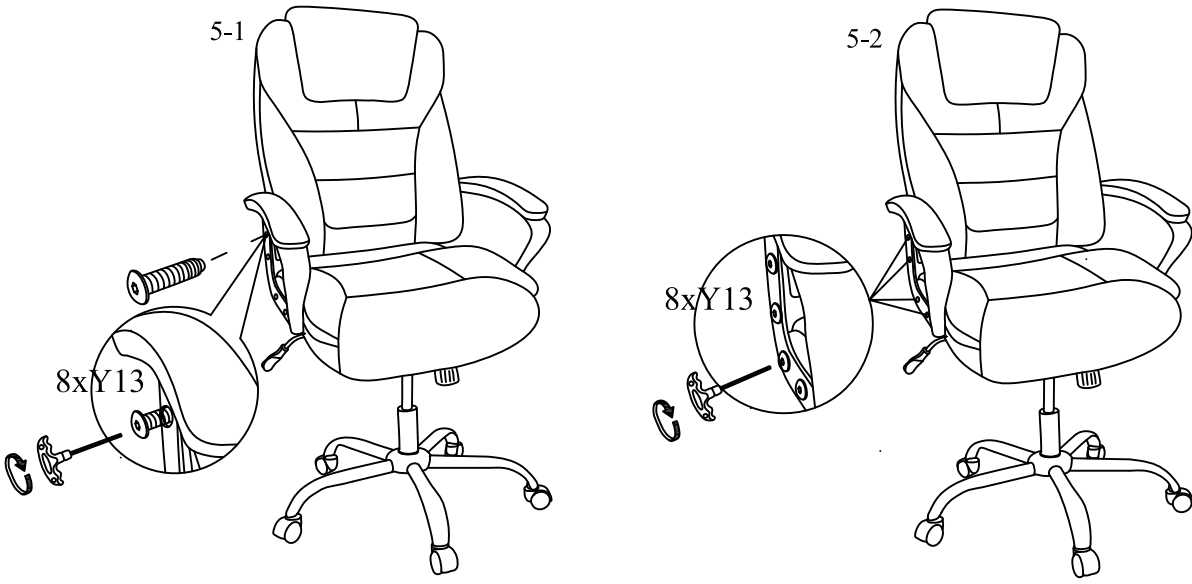

Please do not tight the screw until all screw lined up with hole and try to tight it loosely initially in all screws then tight a little bit more in all screws do not overnight one screws that will make other screw hard to tight but tight all screw firmly in the end

6

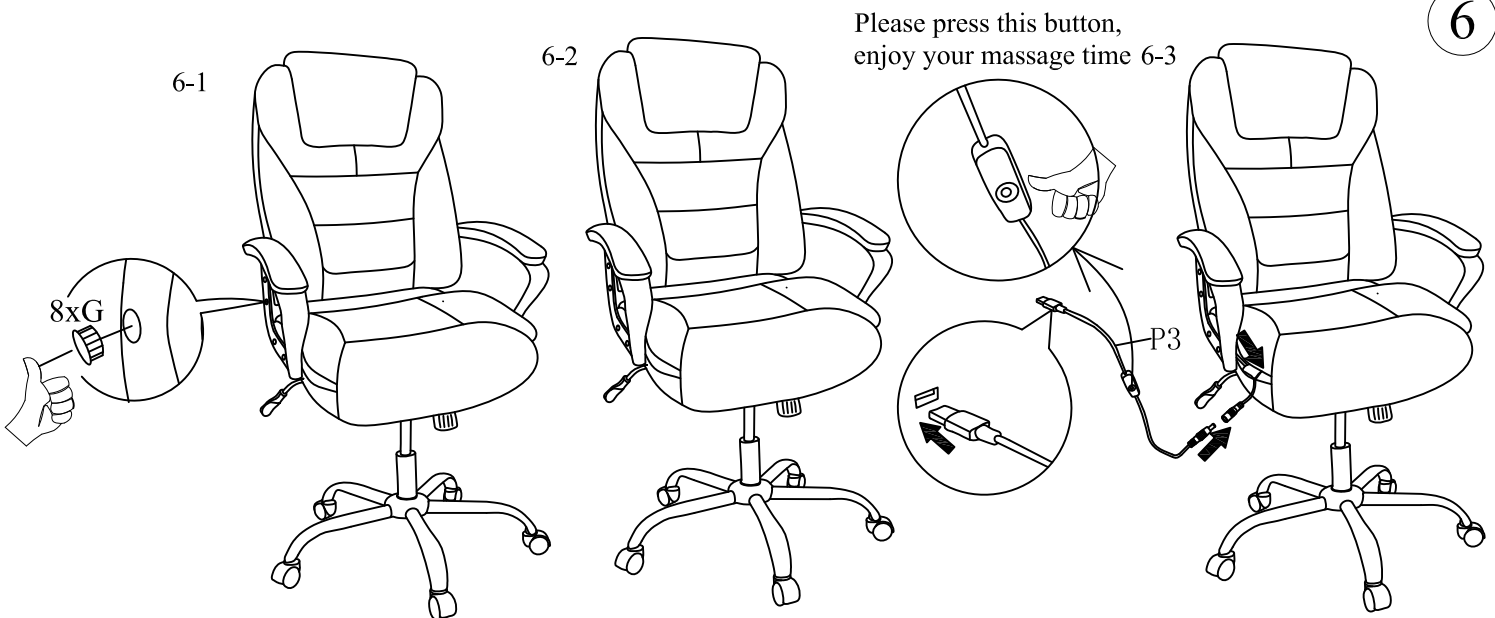

Please press this button, enjoy your massage time 6-3

Attention:when you swivel the chair,please be careful to dropped the computer.

7

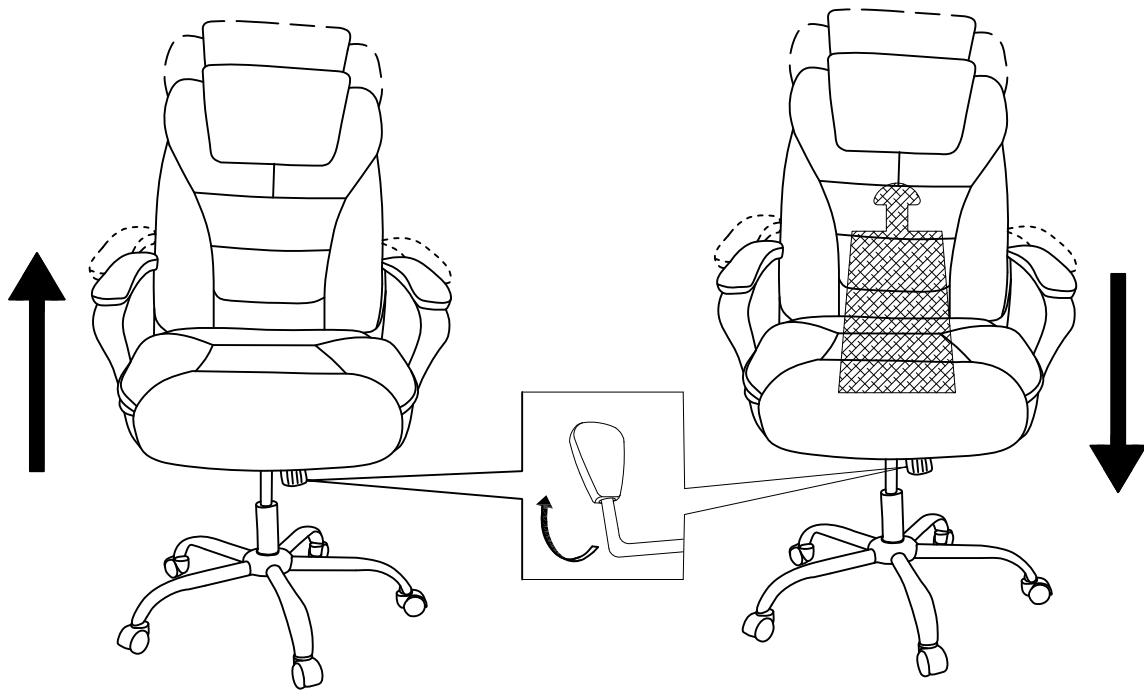

8

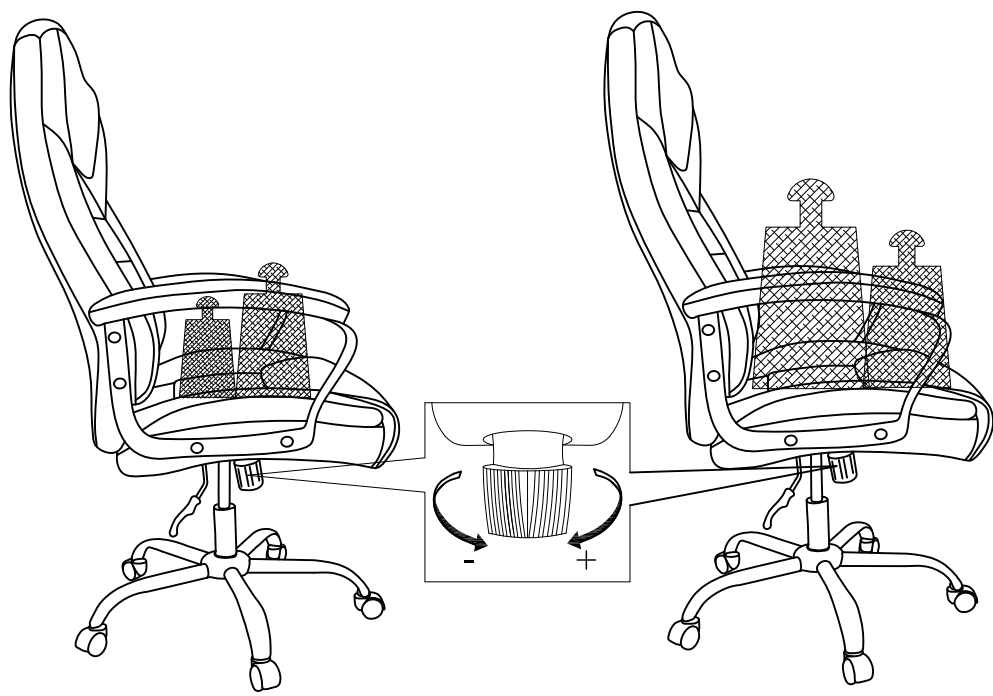

There's a circle under the chair if you turn it, it will lessen the force required to the lean back in the chair

9

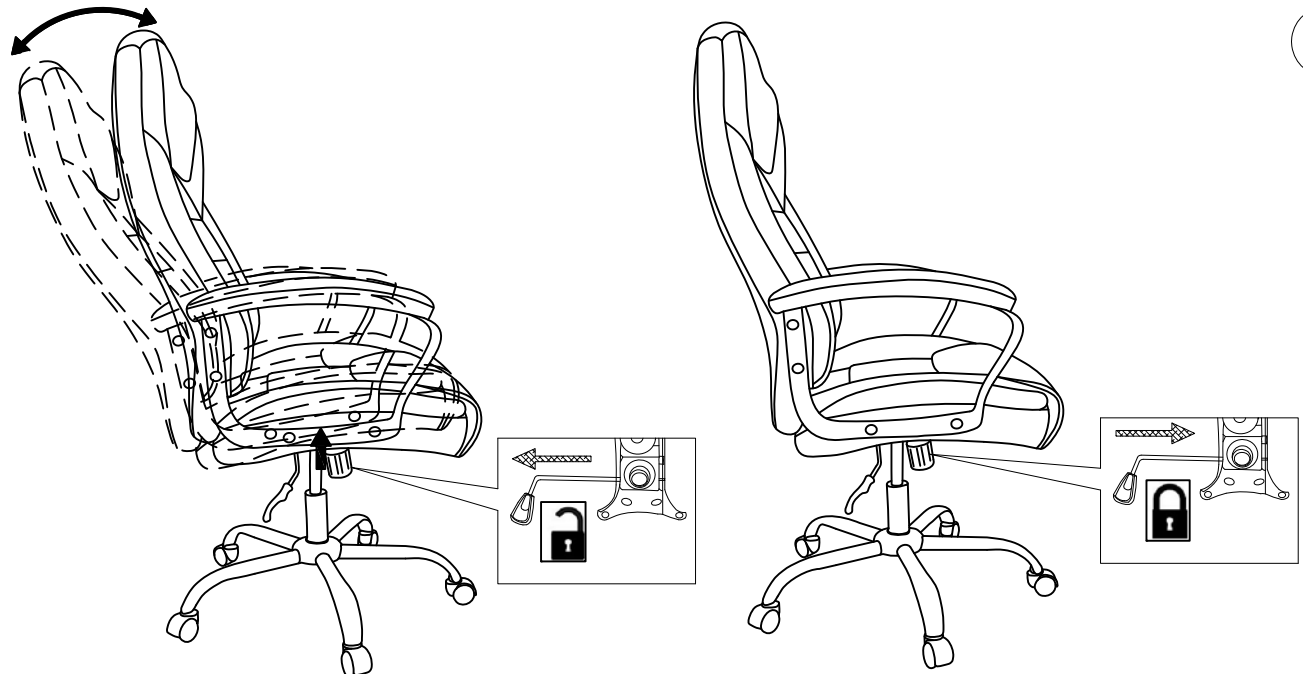

This chair will not lay flat but can recline, in order to recline, please pull the handle on the side out