

Installation & Assembly

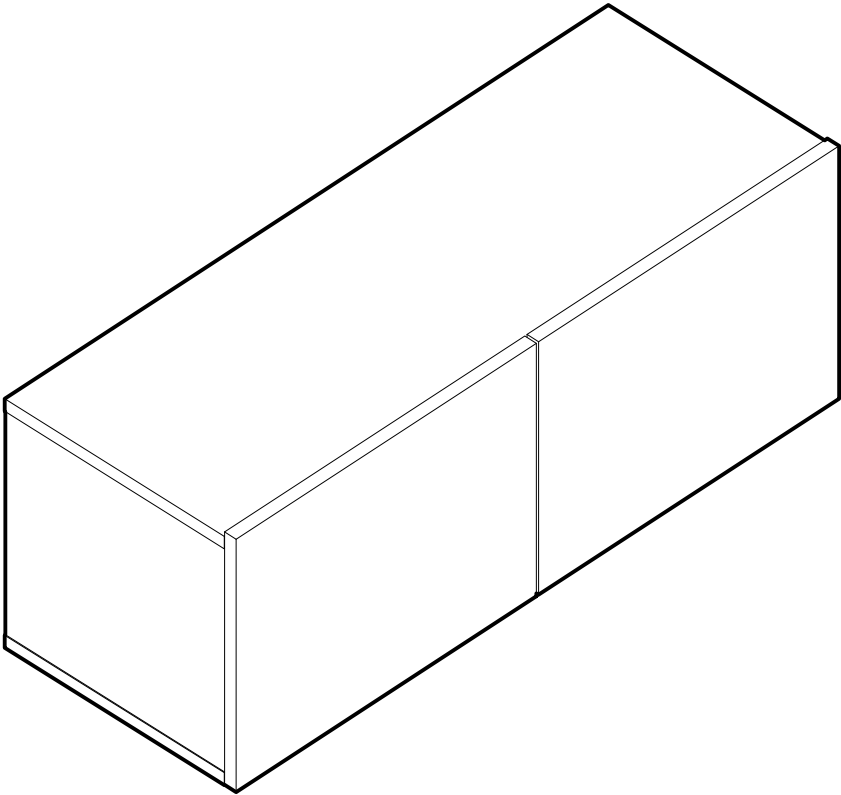

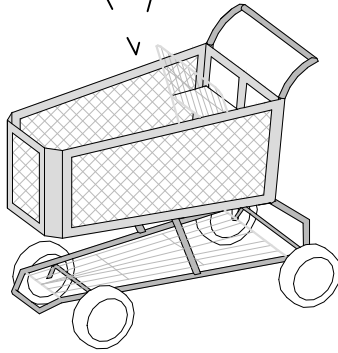

€ \$ £

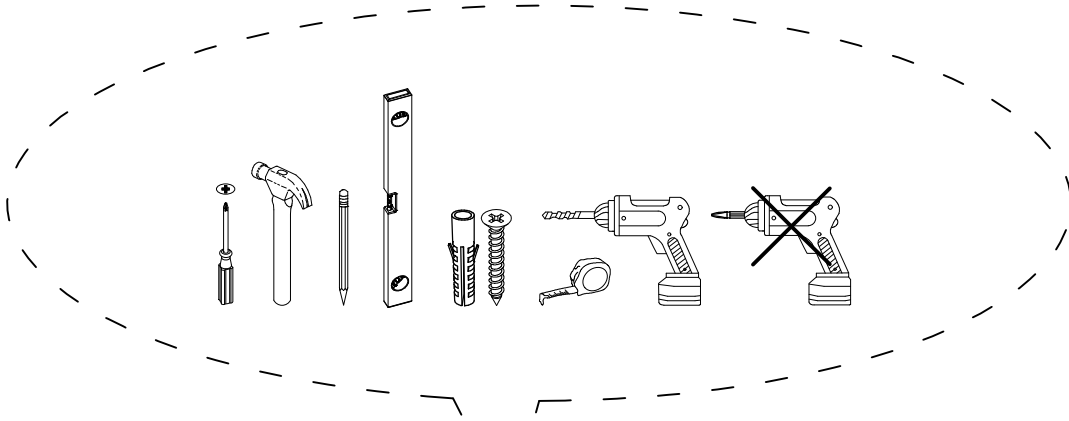
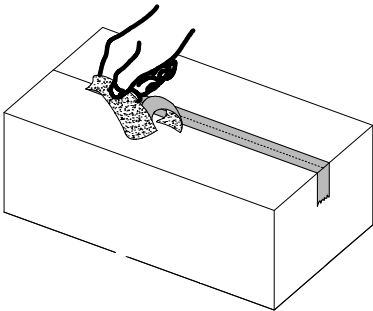

=

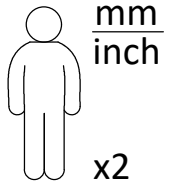
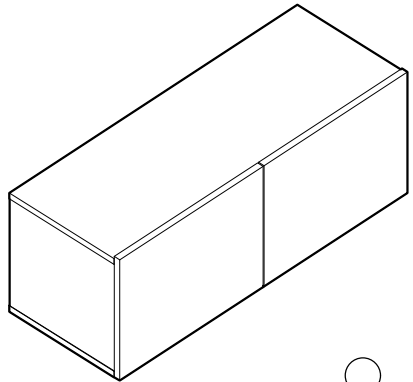

x2

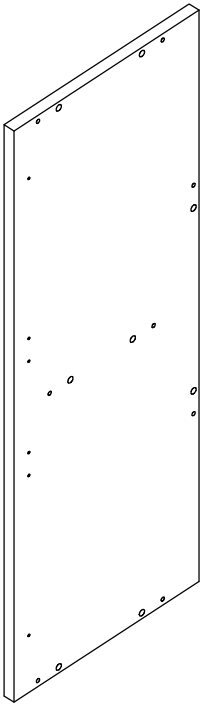

Ax1

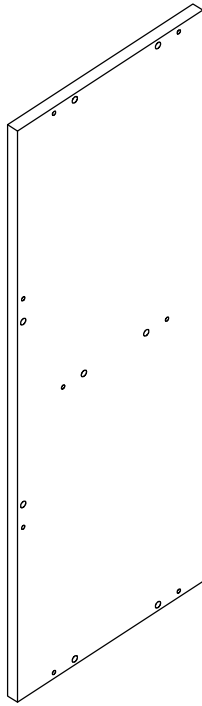

Bx1

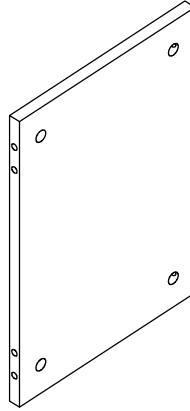

Cx1

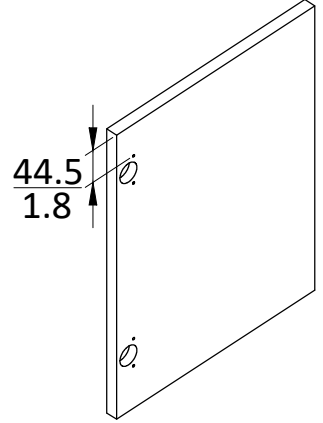

Dx1

270x400
10.6x15.7

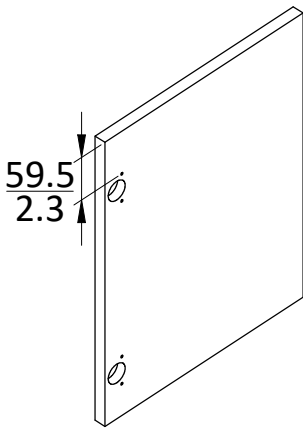

Ex1

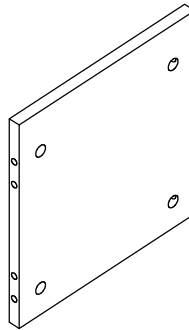

Fx2

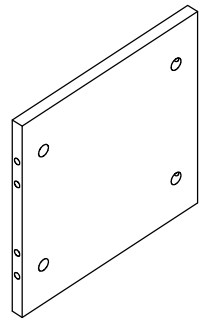

Gx1

270x285
10.6x11.2

270x268
10.6x10.6

PV201900002

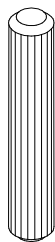

Hx16

PV201030008

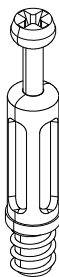

lx16

PV201900013



Jx17

PV201040002



M3.5x $\frac{12}{0.5}$

Kx10

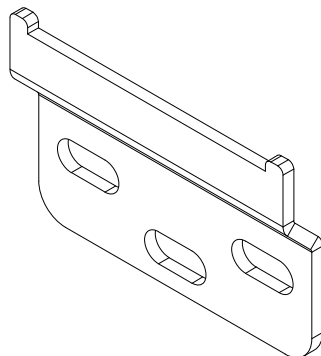

x2

PV201040005

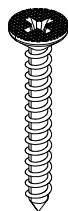

M3.5x $\frac{30}{1.2}$

Mx4

PV201900016

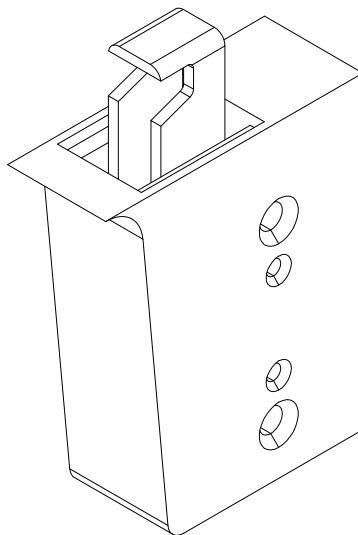

x2

Ox1

PV201900018

5

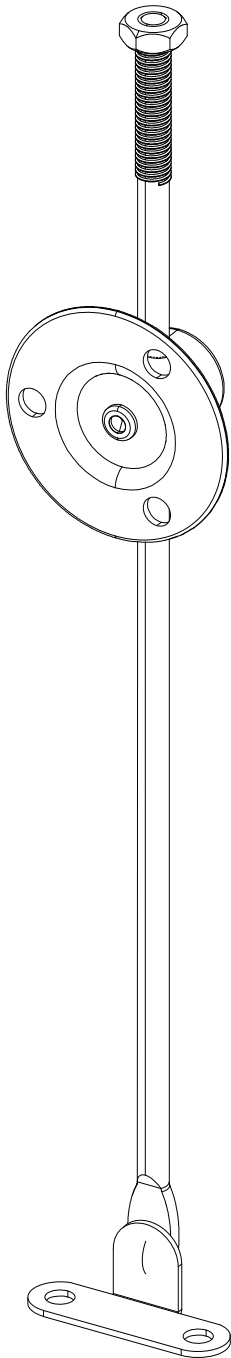

Px2

PV201010002

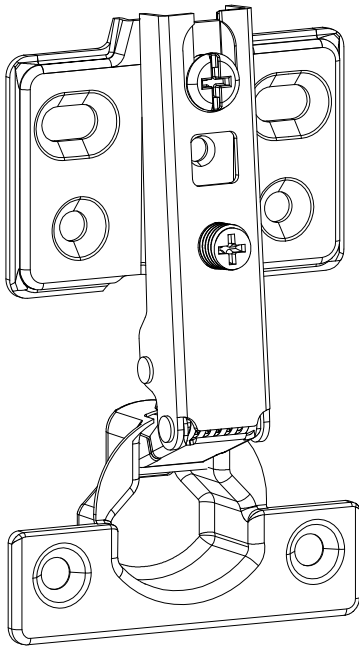

x4

Qx2



x24

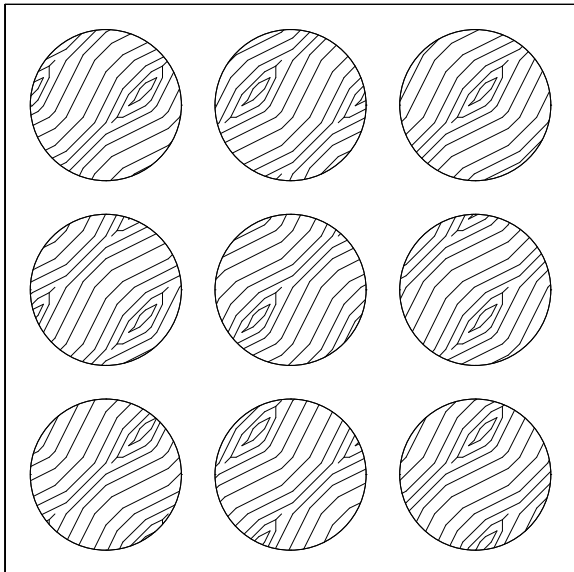

Rx2

1

A x1

Hx8

Ix8

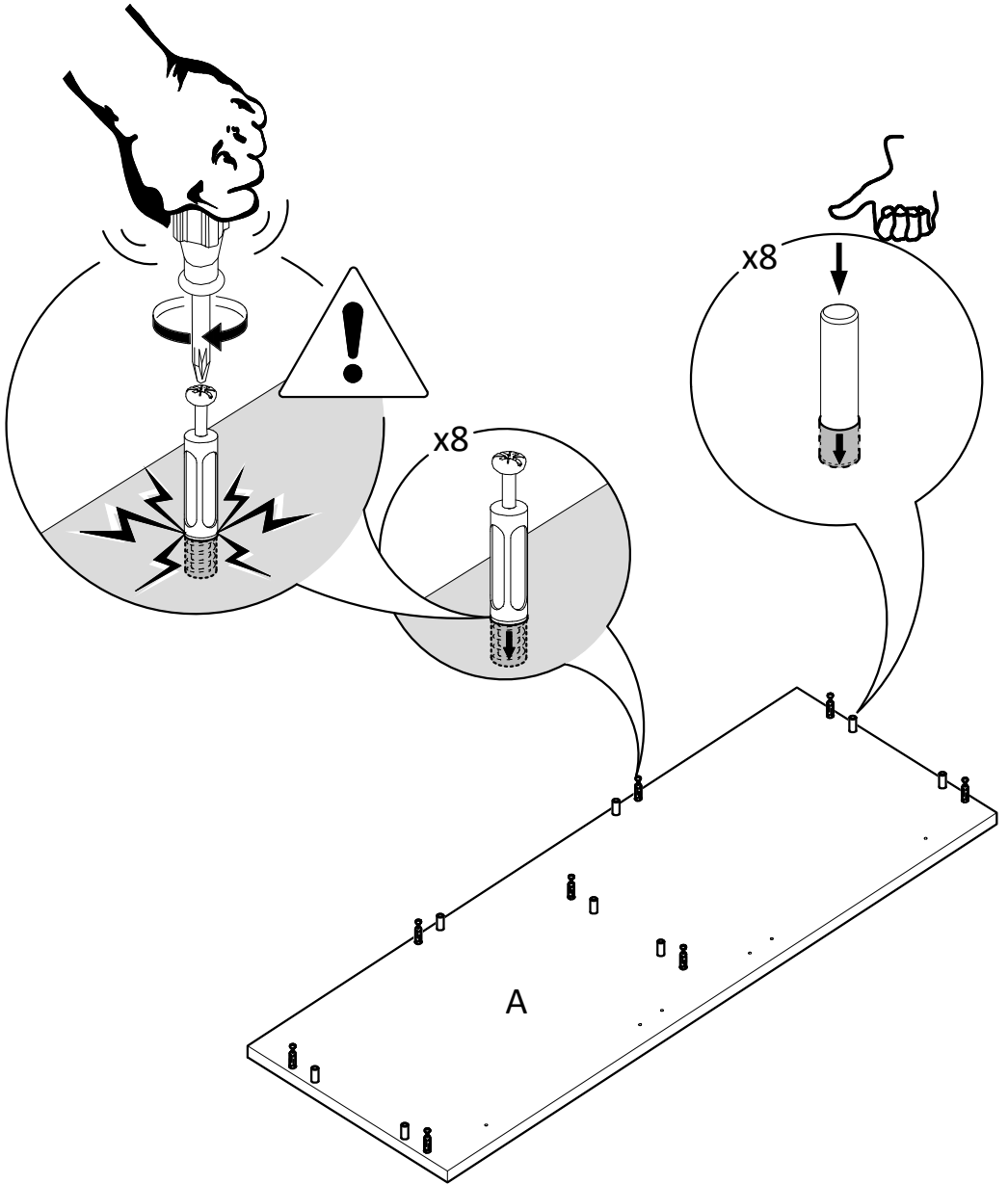

2

C x1 F x2 G x1

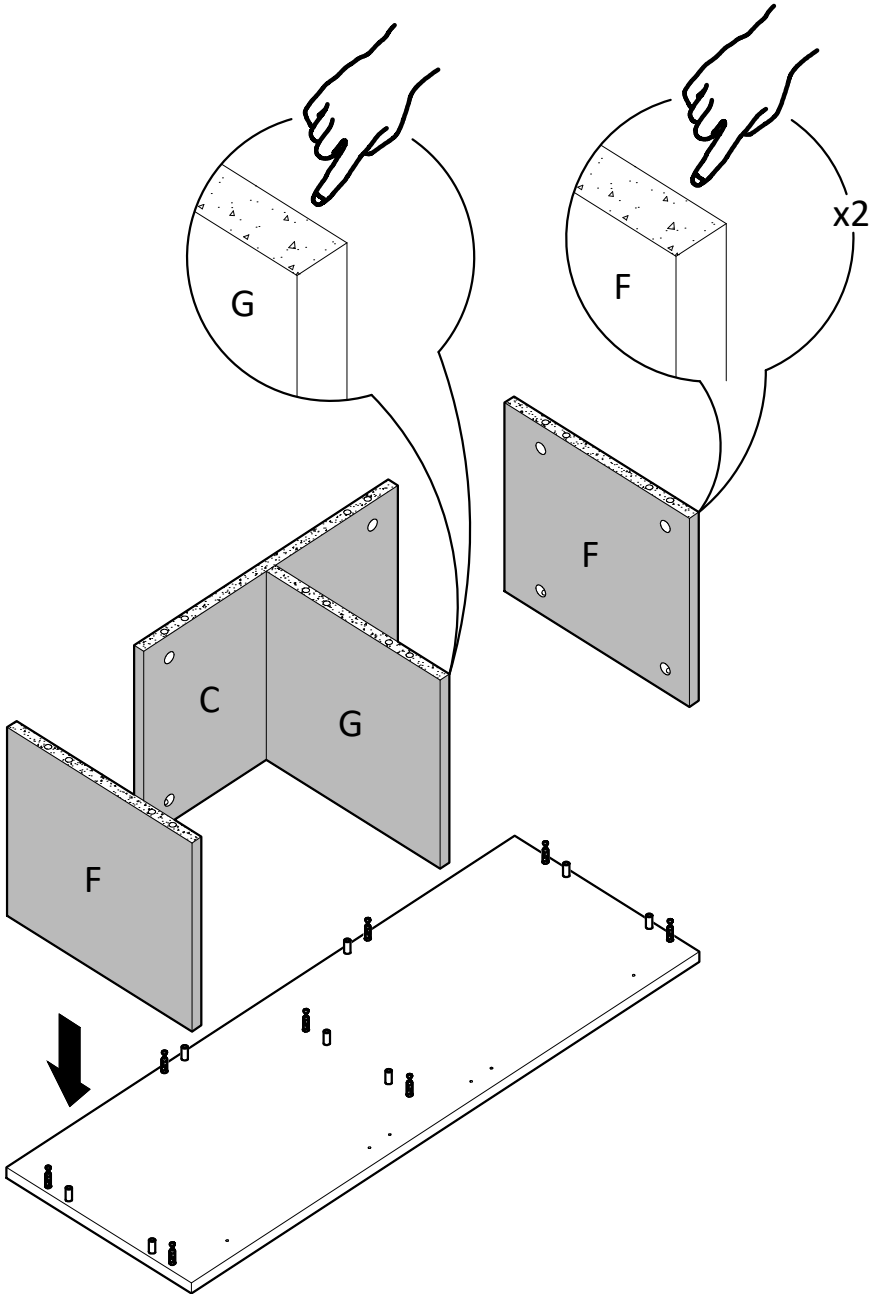

3

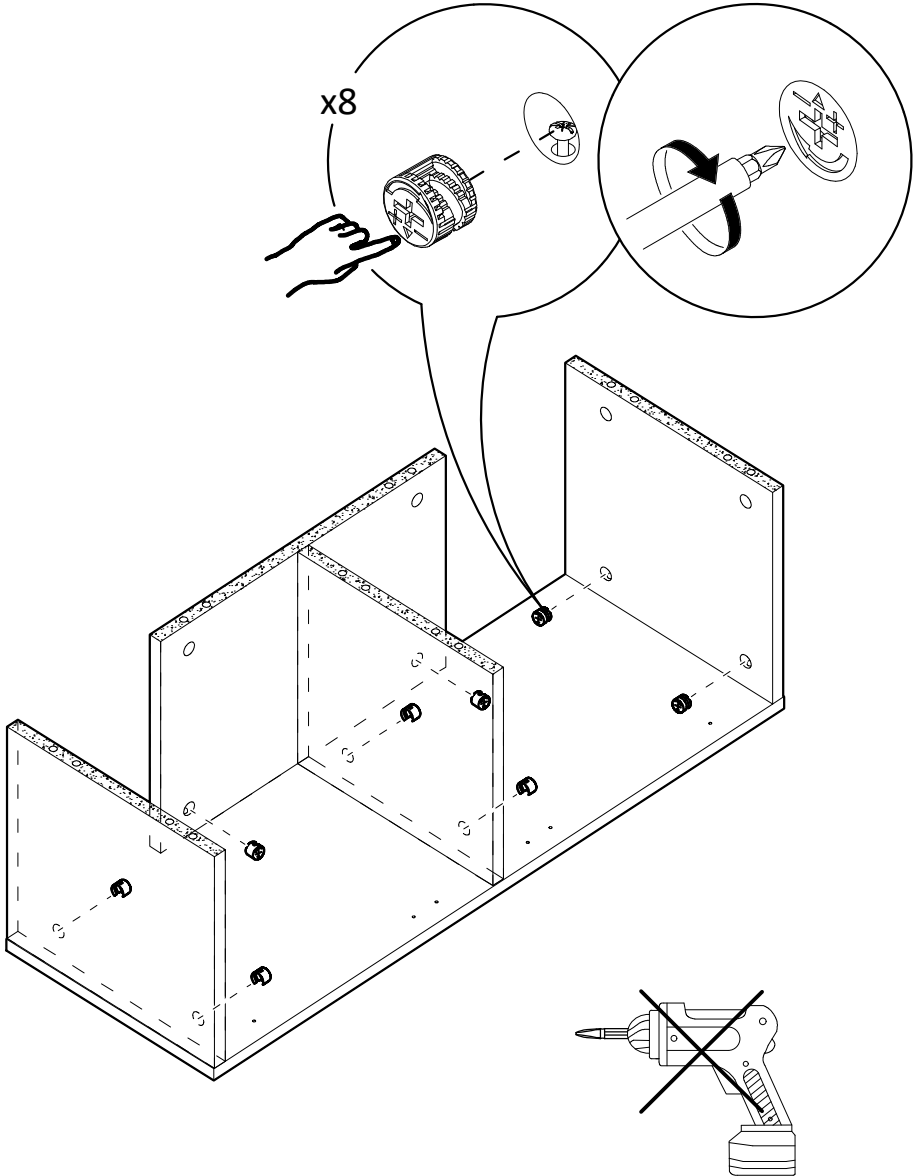

4

B x1

Hx8

lx8

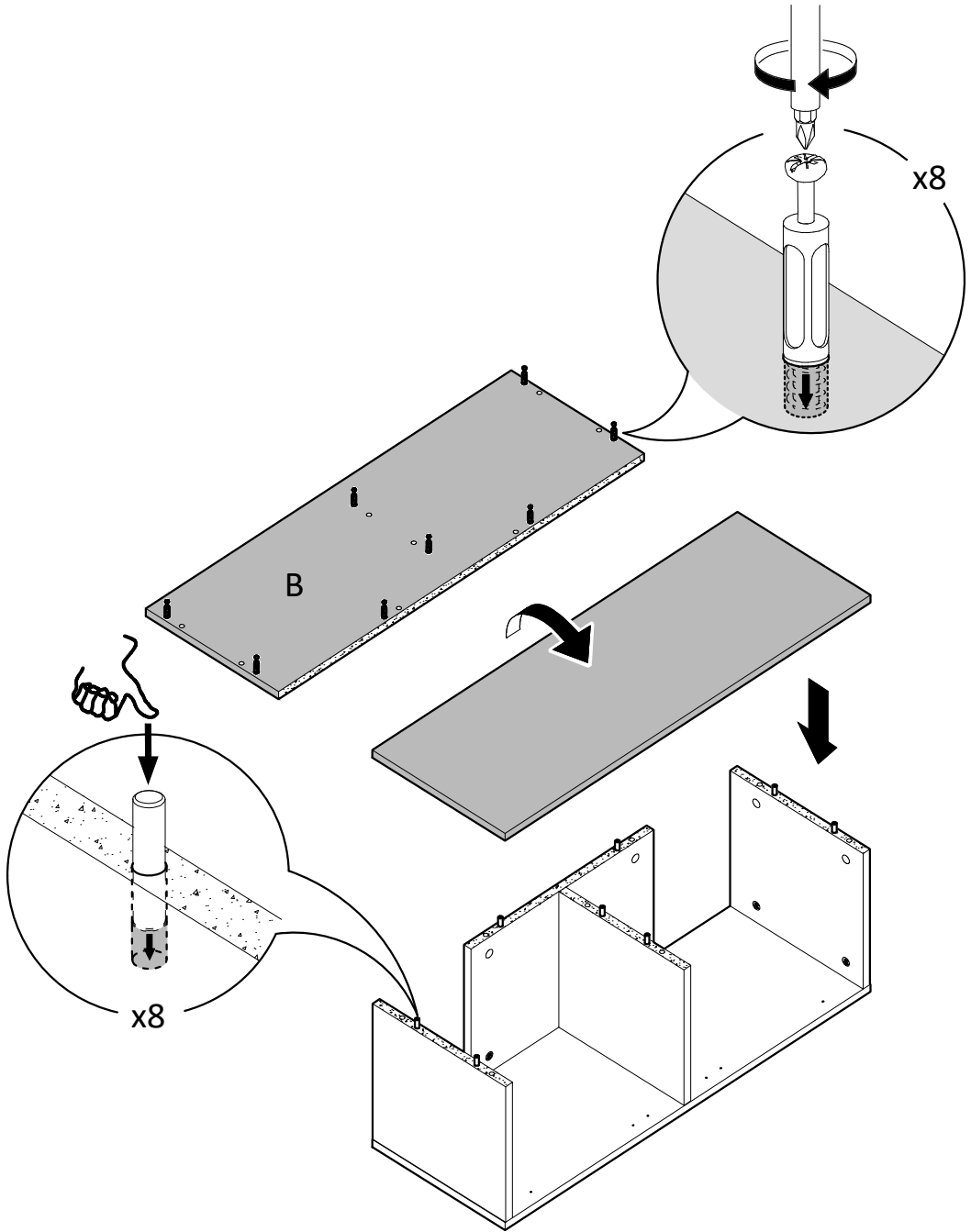

5

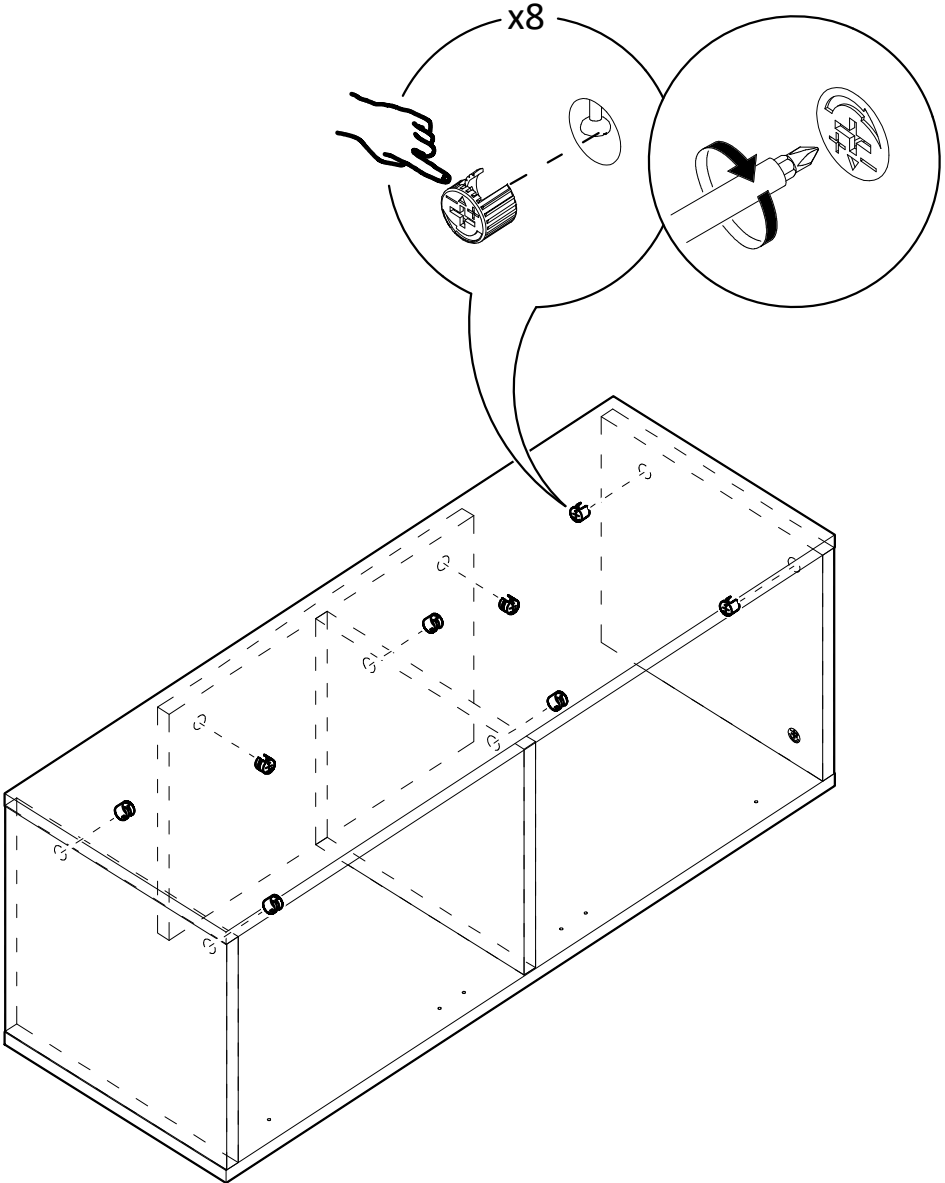

6

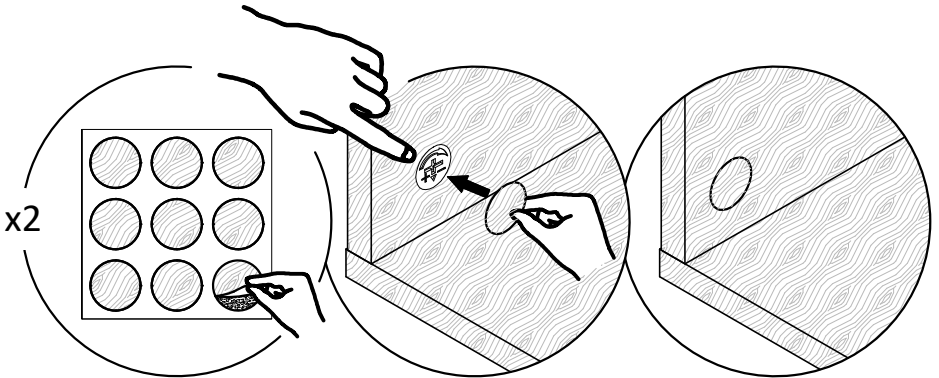
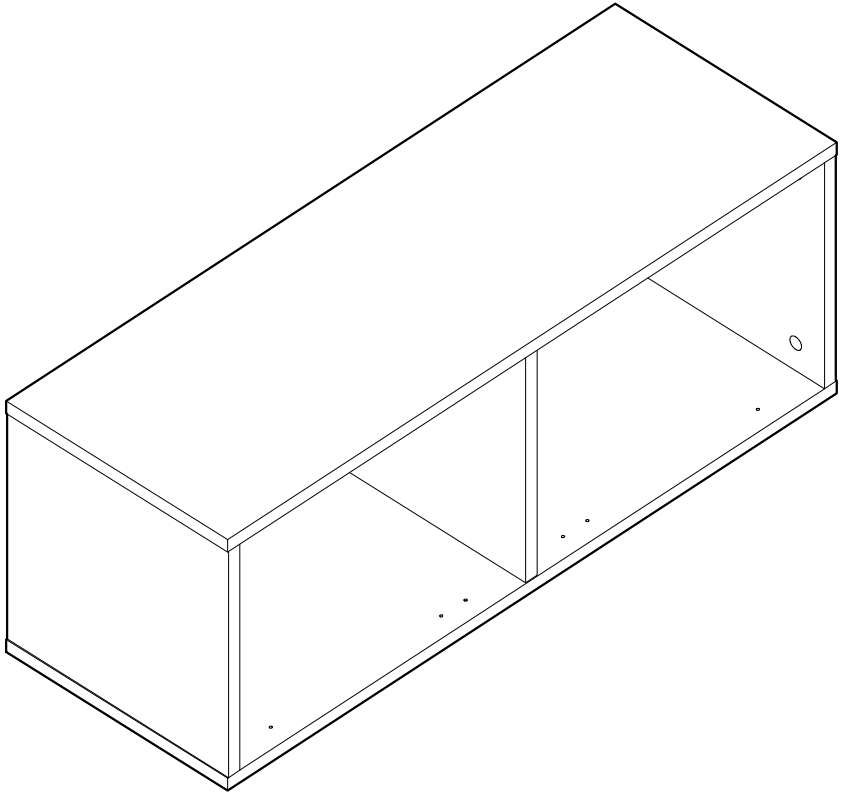
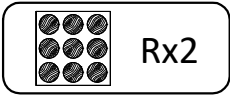

7

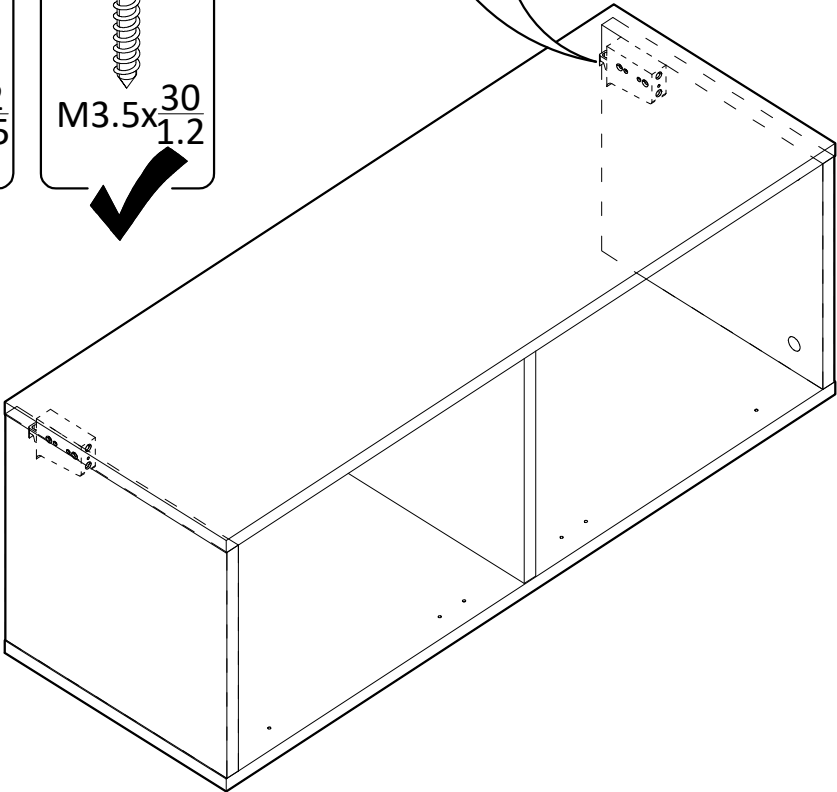
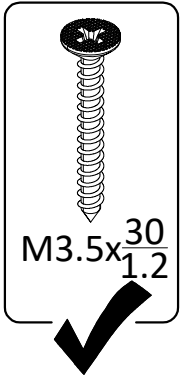
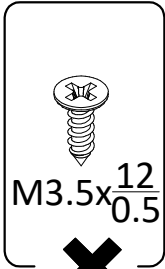
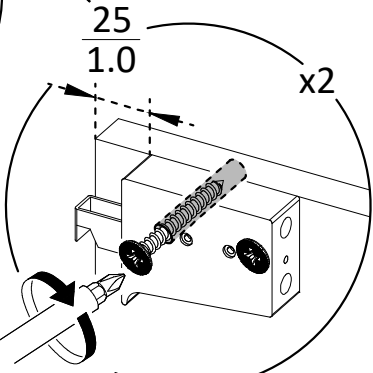
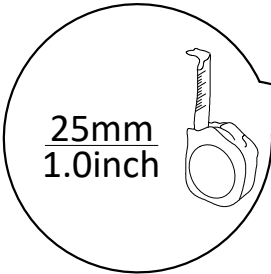
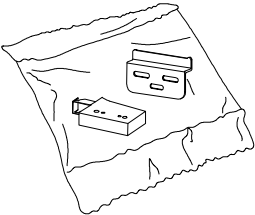
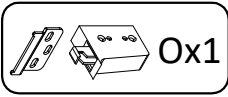
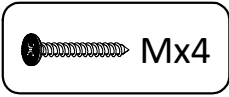

8

 Qx1

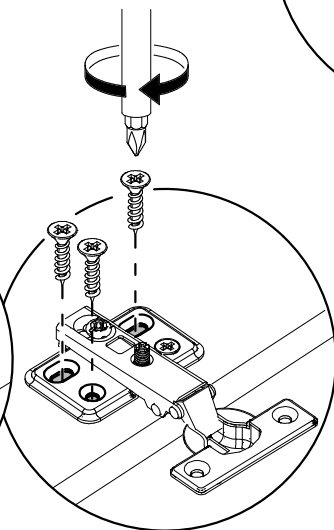
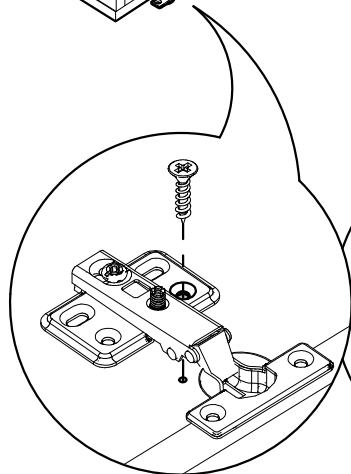
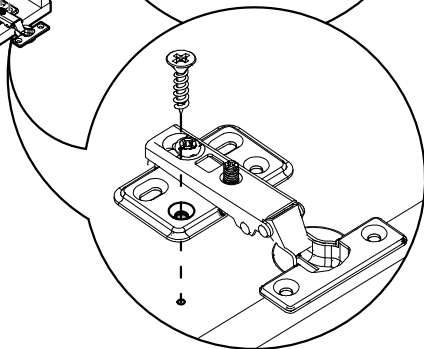
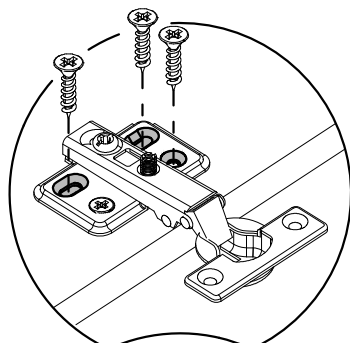
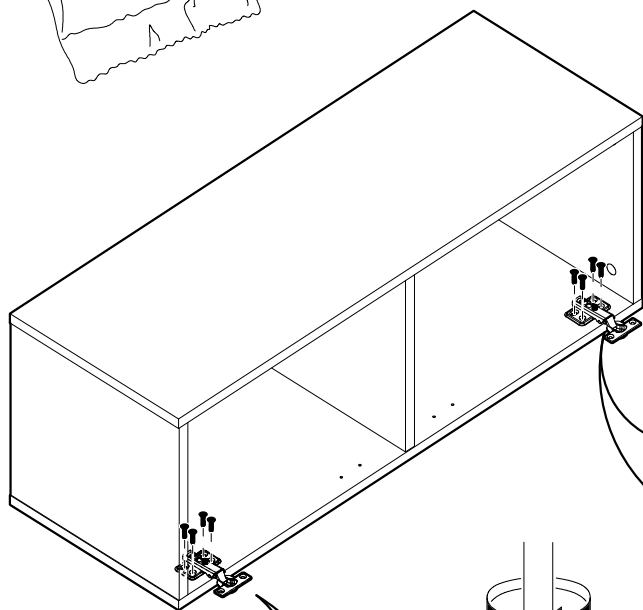
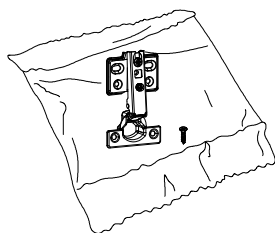

9

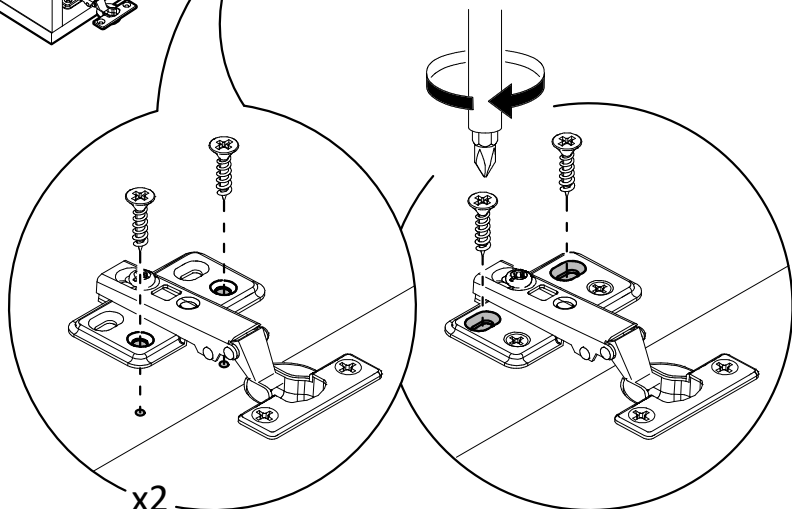
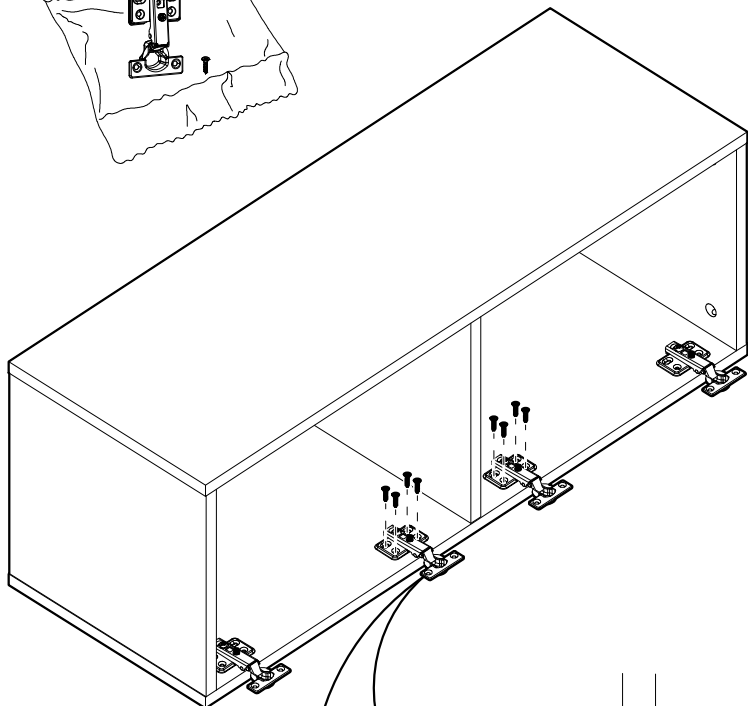
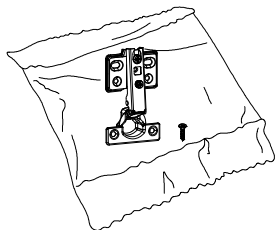
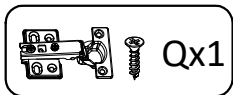

10

D x1 E x1

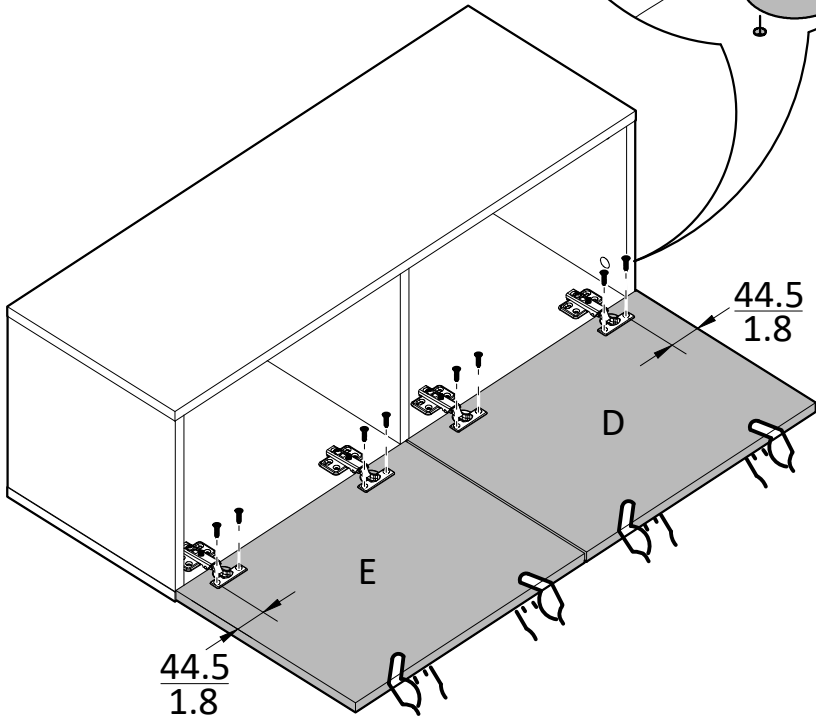
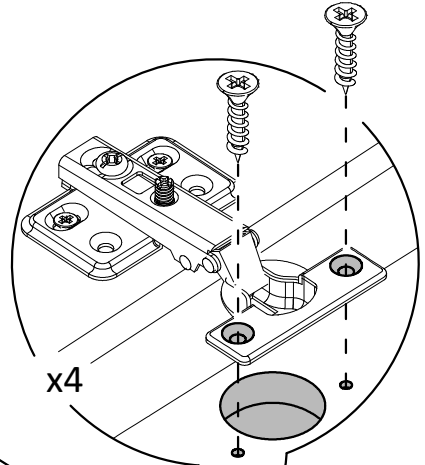
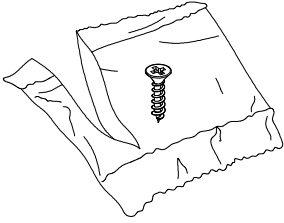
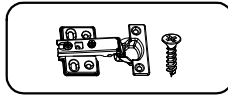

11

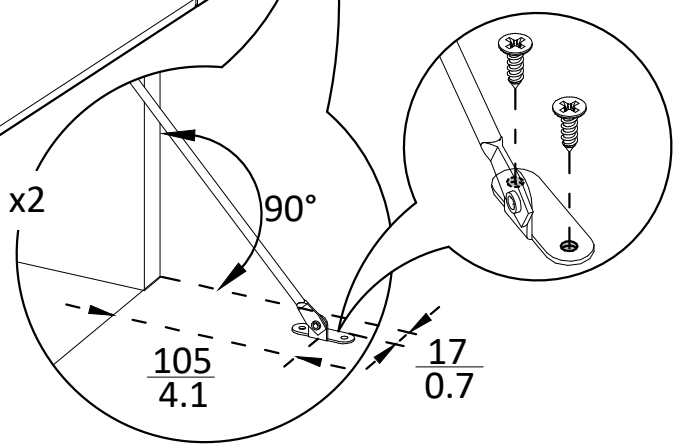
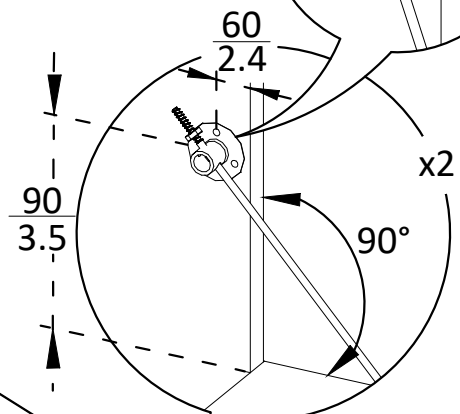
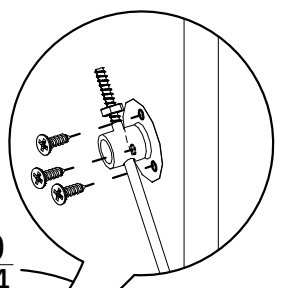
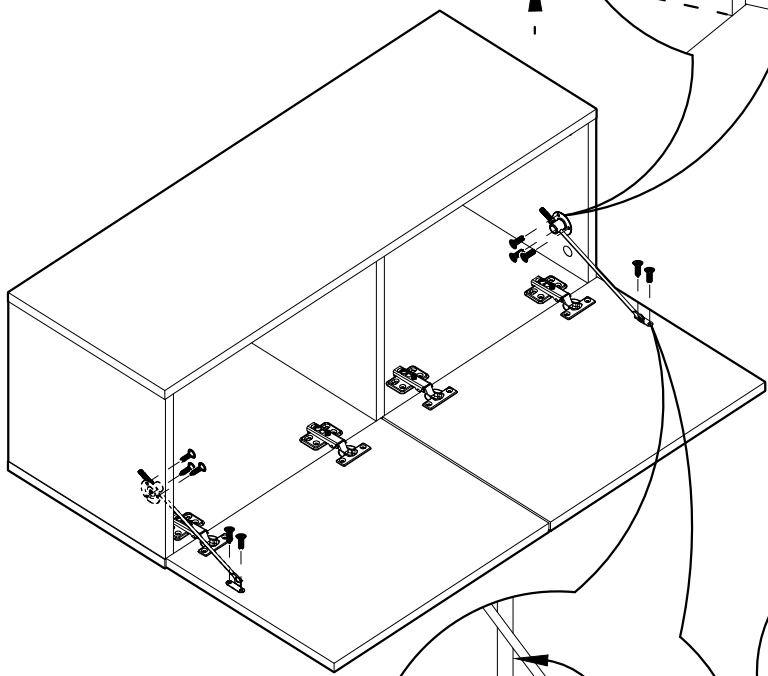
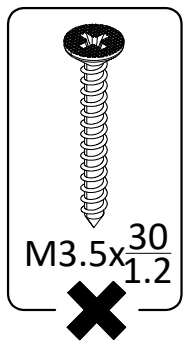
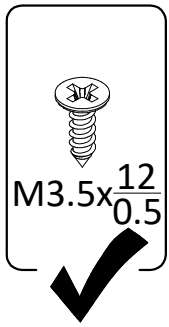
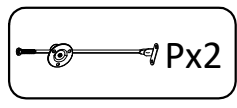
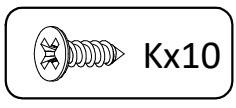

12

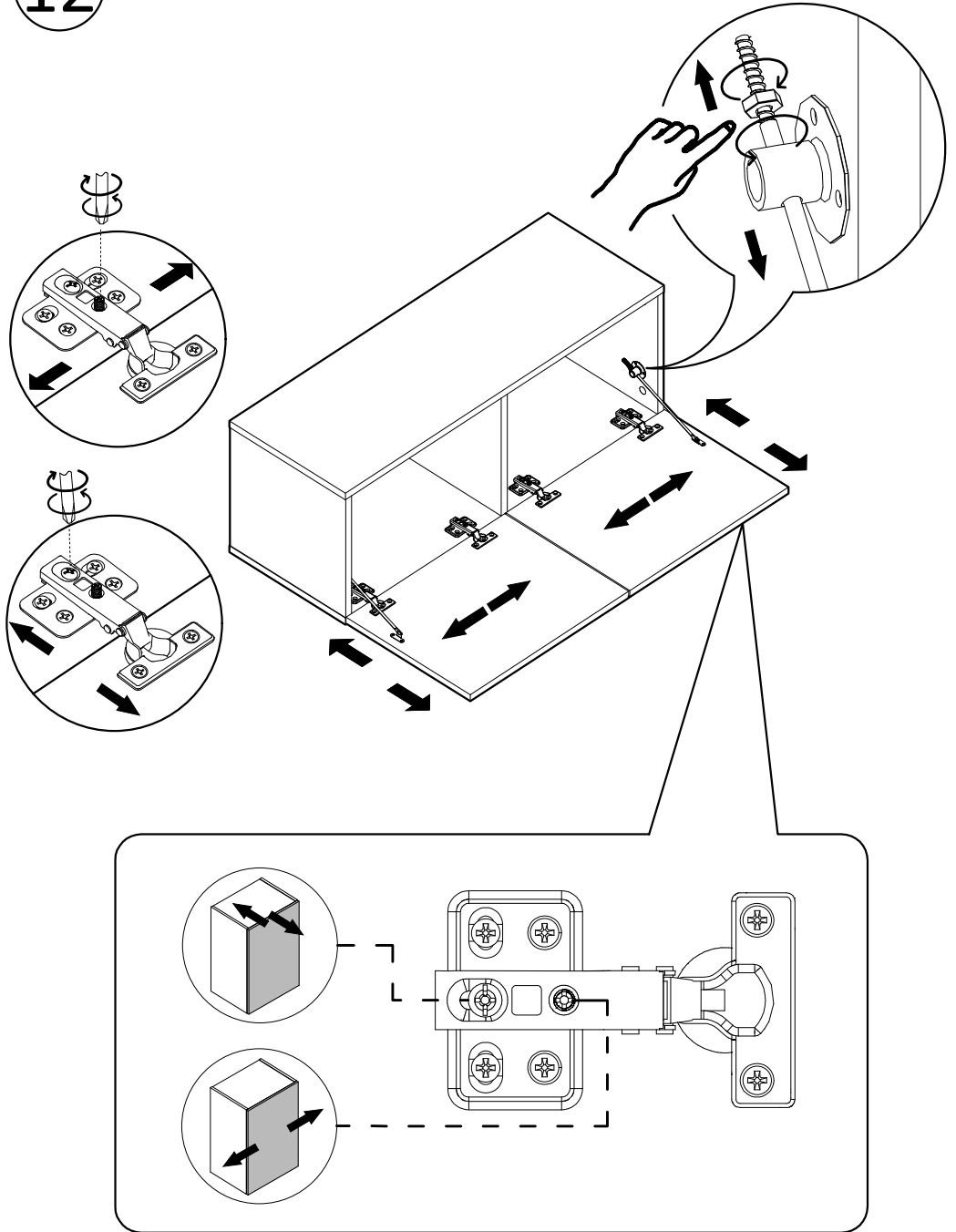

13

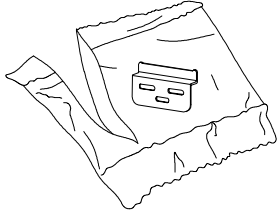
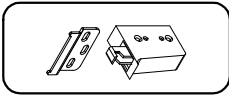

766
30.2

x4

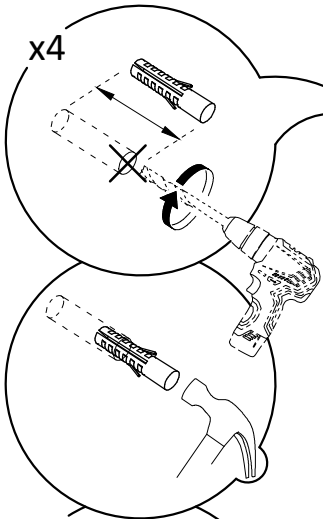

x2

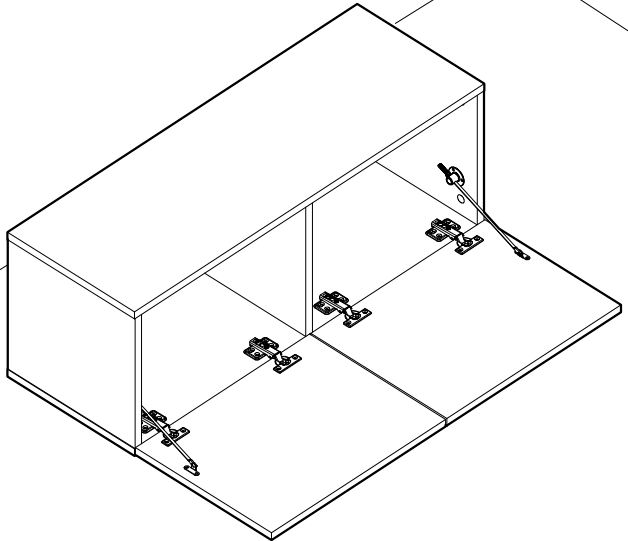
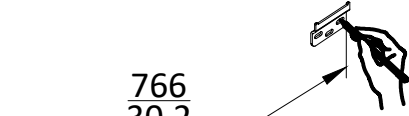
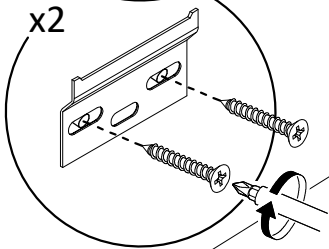

14

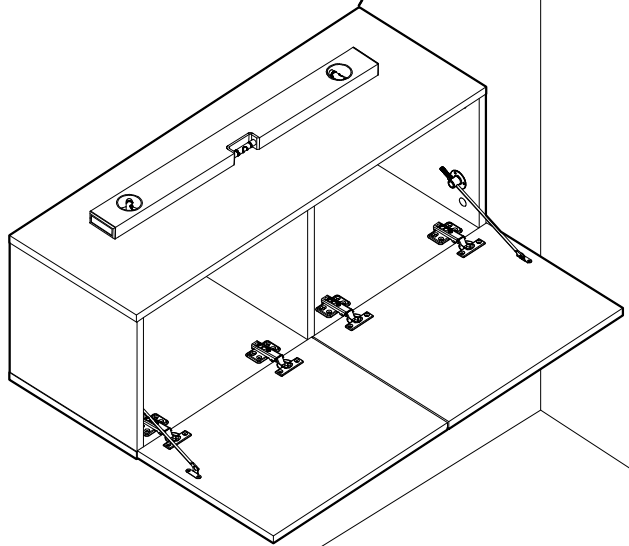
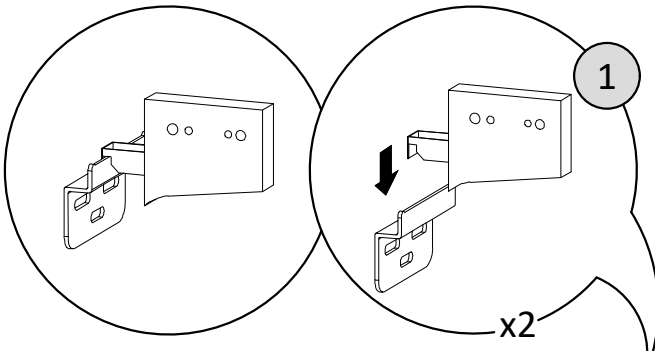
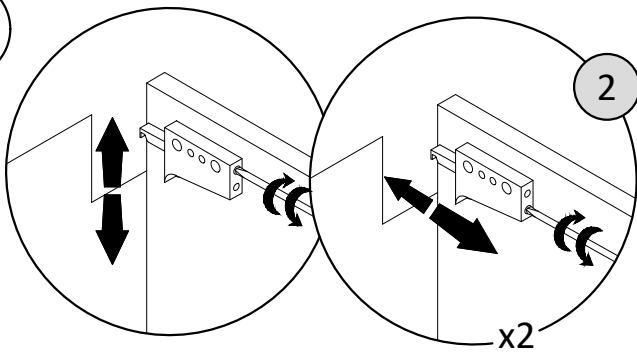



FR

**Pensez à
donner ou recycler.**



Association

ou



Magasin

ou



Déchèterie

<https://quefairedemesdechets.fr>

Ce logo Triman est le symbole de recyclage selon le décret français n°2014-1577. Veuillez ne pas jeter ces produits avec vos autres déchets ménagers ou municipaux. S'assurer de toujours profiter de l'occasion pour recycler les déchets d'emballage. Lorsque vous recyclez les déchets d'emballages, vous contribuez à éviter que les produits ne soient incinérés ou envoyés en décharge. Par conséquent, vous contribuez à minimiser l'impact négatif potentiel sur la santé humaine et l'environnement. Le recyclage responsable peut augmenter la réutilisation des ressources matérielles et il évite également les dommages potentiels à l'environnement ou à la santé résultant de l'élimination incontrôlée des déchets.

(only for Australia)

| ⚠ WARNING | |
|---|--|
| | |
| <p>Children have died from furniture tipover.</p> <ul style="list-style-type: none">● NEVER allow children to stand, climb or hang on drawers, doors, or shelves.● ALWAYS secure your television with an anchor device or mount the television on a wall. | |