



Alogfire
by *Flame King*

World's First
PORTABLE PROPANE GAS HEATER/FIREPLACE
Enjoy Real Flame Like Fireplace

OPERATING INSTRUCTIONS AND OWNER'S MANUAL

STYLE : ALF-P1 Series



Flame King

www.flameking.com

This product is covered by one or more China or international patents or pending patent applications in the US and other countries. Do not copy.



NEVER LEAVE THE HEATER UNATTENDED WHILE BURNING!

OPERATING INSTRUCTIONS AND OWNER'S MANUAL



Alogfire
by *Flame King*

PORTABLE CAMP HEATER WITH REALFLAME LIKE FIREPLACE

Model: ALF-P1A1

Model: ALF-P1B1

Model: ALF-P1A3

Model: ALF-P1B3



Glass Guard Style



Glass Guard Style



Wire Guard Style



Wire Guard Style

PORTABLE PROPANE HEATER FOR OUTDOOR,
RECREATIONAL AND EMERGENCY INDOOR USE

FOR US SALE EXCEPT MASSACHUSETTS
Not for use in a "dwelling home" in California

Suggest Use Only ALOGFIRE Branded Accessories (See Page 9 For WARNING Information)

⚠ WARNING: If the information in this manual is not followed exactly, a fire or explosion may result causing property damage, personal injury or loss of life.

Do not store or use gasoline or other flammable vapors and liquids in the vicinity of this or any other appliance.

An LP cylinder not connected for use shall not be stored in the vicinity of this or any other appliance. WHAT TO DO IF YOU SMELL GAS

- Do not try to light appliance.
- Extinguish any open flame
- Shut off gas to appliance

Service must be performed by a qualified installer, service agency.

This is an unvented gas-fired portable heater. It uses air (oxygen) from the area in which it is used. Adequate combustion and ventilation air must be provided. Refer to page 2.

READ INSTRUCTIONS CAREFULLY: Read and follow all instructions. Place instructions in a safe place for future reference. Do not allow anyone who has not read these instructions to assemble, light, adjust or operate the heater.

WARNING:

Early signs of carbon monoxide poisoning resemble the flu, with headache, dizziness and/or nausea. If you have these signs, heater may not be working properly. Get fresh air at once! Have heater serviced.

WARNING:

Every time hose or tank is connected to unit, connection must be checked for leaks in one or more ways: Apply soapy water to connection, look for bubbles, listen for hiss of escaping gas, feel for extreme cold, smell for rotten egg odor. Do not use if leaking! **NEVER USE AN OPEN FLAME TO CHECK FOR LEAKS.**

WARNING:

FIRE OR EXPLOSION HAZARD

If you smell gas:

1. Do not attempt to light appliance.
2. Extinguish any open flame.
3. Disconnect fuel supply.
4. Leave the area immediately.
5. Allow gas to dissipate 5 minutes before relighting the appliance.

Do not store or use gasoline or other flammable vapors and liquids in the vicinity of this or any other appliance.

Failure to follow these instructions could result in fire or explosion, which could cause property damage, personal injury, or death.

WARNING:

Any changes to this heater or its controls can be dangerous.

WARNING:

If the recreational enclosure does not have a window or roof vent, **DO NOT USE THIS HEATER INSIDE.**

WARNING:

Fuels used in liquefied propane gas appliances, and the products of combustion of such fuel, can expose you to chemicals including benzene, which is known to the state of California to cause cancer and cause birth defects or other reproductive harm, for more information go to www.P65Warnings.ca.gov

WARNING:

This product can expose you to chemicals including lead and lead compounds, which are known to the State of California to cause cancer and birth defects or other reproductive harm. For more information visit www.P65Warnings.ca.gov

This heater is equipped with a SAFETY SYSTEM designed to turn off the heater if not enough fresh air is available.

DO NOT TAMPER WITH THE SAFETY SYSTEM!

WARNING:

If heater shuts off, do not relight until you provide fresh air. If heater keeps shutting off, have the heater serviced. Keep burner and control compartment clean.

CONTENTS

- 2 Warnings
- 3 General Safety Instructions
- 3 Odor Fade Warning
- 4 General Information
- 5 Operation
 - Lighting
 - Shutdown
- 7 Maintenance
- 8 Troubleshooting
- 10 Parts List
- 12 Ordering Parts/Warranty

WARNING:

CARBON MONOXIDE POISONING MAY CAUSE DEATH OR INJURY

When used without adequate combustion and ventilation air, heater may give off excessive CARBON MONOXIDE, an odorless, poisonous gas.

This is an unvented gas-fired heater. The heater uses air (oxygen) from the area in which the heater is used. Adequate combustion and ventilation air must be provided. Refer to GENERAL SAFETY INSTRUCTIONS for more specific requirements regarding adequate combustion and ventilation air (page 3).

Caution:

- Some carpets or linoleum surfaces may discolor if heater is placed directly on these floor coverings.

**ODOR FADE WARNING
WARNING:
ASPHYXIATION HAZARD**

- Do not use in unventilated areas.
- The flow of combustion and ventilation air must not be obstructed.
- Proper ventilation air must be provided to support the combustion air requirements of the heater being used.
- Refer to the specification section of the heater's manual, heater dataplate, or contact the factory to determine combustion air ventilation requirements of the heater.
- Lack of proper ventilation air will lead to improper combustion.
- Improper combustion can lead to carbon monoxide poisoning leading to serious injury or death. Symptoms of carbon monoxide poisoning can include headaches, dizziness and difficulty in breathing.

- Do not place clothing or other flammable material on or near the appliance.
- Do not operate heater in any moving vehicle.
- Only disposable cylinders marked with the proper fuel type approved for the appliance, can be used.
- This heater can also be used in a recreational enclosure only if the enclosure has a window or roof vent. It may also be used outdoor.
- This heater requires a minimum vent area of 9 square inches, (example 3" x 3" opening at the ceiling and 3" x 3" at floor level for adequate ventilation during operation). Do not use other fuel burning appliances inside.
- A propane-fired portable heater used for emergency home use shall not be set at an input setting in excess of 5,000 BTU/HR (1,466 W) when located in a bathroom and shall not be set at an input setting of more than 10,000 BTU/HR (2,931 W) when located in a bedroom. Refer to Specifications table for permissible settings.
This heater can used in bedroom, but cannot use in bathroom.
- GAS PRESSURE AT HEATER IS REGULATED AND FIXED AT 11" W.C. WHEN USING A REMOTE HOSE CONNECTION DO NOT REGULATE OR REDUCE PROPANE TANK SUPPLY PRESSURE TO HEATER!
- REGULATOR IN HEATER MUST ALWAYS BE IN PLACE DURING OPERATION.
- If the wire guard is removed for servicing, it must be replaced prior to operating the heater.
- The appliance should be inspected before each use. Frequent cleaning may be required. The control compartments, burner and circulating air passageways of the appliance must be kept clean, see MAINTENANCE.
- DO NOT use this heater if any part has been under water. Immediately call a qualified service technician to inspect the heater and to replace any part of the control system and any gas control, which has been under water.
 - When used without adequate combustion and ventilation air, this heater may give off excessive CARBON MONOXIDE, an odorless, poisonous gas.

Specifications	
Model No.	ALF-P1
Gas Type	Propane (LP)
Input (Btu/Hr)	8,200
Minimum Ambient Temperature	-18° C/ 0° F
Clearance To Combustibles	
Top	30"
Front	24"
Sides	24"
Rear	0"
Permissible Settings	
Bathroom Use	CAN NOT
Bedroom Use	"HI" or "LO"

WARNING: Early signs of carbon monoxide poisoning resemble the flu, with headache, dizziness, and/or nausea. If you have these signs, the heater may not be working properly. Get fresh air at once! Have heater serviced.

Some people - pregnant women, persons with heart or lung disease, anemia, those under the influence of alcohol, those at high altitudes - are more affected by carbon monoxide than others.

- When heater is placed on the ground, make sure the ground is level and keep any objects at least 24 inches from the front of the heater. THIS HEATER IS EQUIPPED WITH A TIP OVER SWITCH THAT WILL SHUT THE HEATER OFF IF THE HEATER TIPS OVER HOWEVER, DO NOT LEAVE HEATER UNATTENDED OR WHERE CHILDREN MAY CAUSE THE HEATER TO TIP OVER. NEVER OPERATE THE HEATER WHILE SLEEPING!

FUEL GAS ODOR

Propane (LP) gas and natural gas have man-made odorants added specifically for detection of fuel gas leaks.

If a gas leak occurs you should be able to smell the fuel gas. Since propane (LP) gas is heavier than air you should smell for the gas odor low to the floor. ANY GAS ODOR IS YOUR SIGNAL TO GO INTO IMMEDIATE ACTION!

GENERAL SAFETY INSTRUCTIONS

THIS IS A HEATING APPLIANCE. DO NOT OPERATE THIS APPLIANCE WITHOUT THE FRONT OR SIDE GUARD OR INSTALLED. DO NOT ATTEMPT TO WARM OR COOK FOOD ON THIS HEATER.

- Do not use non-approved attachments on this heater.
- Due to high temperatures, the appliance should be located out of traffic and away from combustible materials.
- Children and adults should be alerted to the hazard of high surface temperatures and should stay away to avoid burns or clothing ignition.
- **Do not leave this heater unattended while it is in operation.** Keep children and pets away from the heater at all times.

- Do not take any action that could ignite the fuel gas. Do not operate any electrical switches. Do not pull any power supply or extension cords. Do not light matches or any other source of flame. Do not use your telephone.
- Get everyone out of the building and away from the area immediately.
- Close all propane (LP) gas tank or cylinder fuel supply valves, or the main fuel supply valve located at the meter if you use natural gas.
- Propane (LP) gas is heavier than air and may settle in low areas. When you have reason to suspect a propane (LP) gas leak, keep out of all low areas.
- Use your neighbor's phone and call your fuel gas supplier and your fire department. Do not re-enter the building or area.
- Stay out of the building and away from the area until declared safe by the firefighters and your fuel gas supplier.
- FINALLY, let the fuel gas service person and the firefighters check for escaped gas. Have them air out the building and area before you return. Properly trained service people must repair any leaks, check for further leakages, and then relight the appliance for you.

ODOR FADING - NO ODOR DETECTED

- Some people cannot smell well. Some people cannot smell the odor of the man-made chemical added to propane (LP) gas. You must determine if you can smell the odorant in these fuel gases.
- Learn to recognize the odor of propane (LP) gas. Local propane (LP) gas dealers will be more than happy to give you a scratch and sniff pamphlet. Use it to become familiar with the fuel gas odor.
- Smoking can decrease your ability to smell. Being around an odor for a period of time can affect your sensitivity to that particular odor. Odors present in animal confinement buildings can mask fuel gas odor.
- **The odorant in propane (LP) gas is colorless and the intensity of its odor can fade under some circumstances.**
- If there is an underground leak, the movement of gas through the soil can filter the odorant.

- Propane (LP) gas odor may differ in intensity at different levels. Since propane (LP) gas is heavier than air, there may be more odor at lower levels.
- **Always be sensitive to the slightest gas odor.** If you continue to detect any gas odor, no matter how small, treat it as a serious leak. Immediately go into action as discussed previously.

ATTENTION - CRITICAL POINTS TO REMEMBER!

- Propane (LP) gas has a distinctive odor. Learn to recognize these odors. (Reference Fuel Gas Odor and Odor Fading sections above.
- Even If you are not properly trained in the service and repair of the heater, ALWAYS be consciously aware of the odors of propane (LP) gas.
- If you have not been properly trained in repair and service of propane (LP) gas then do not attempt to light heater, perform service or repairs, or make any adjustments to the heater on the propane (LP) gas fuel system.
- A periodic sniff test around the heater or at the heater's joints; i.e. hose, connections, etc., is a good safety practice under any conditions. If you smell even a small amount of gas, CONTACT YOUR FUEL GAS SUPPLIER IMMEDIATELY. DO NOT WAIT!

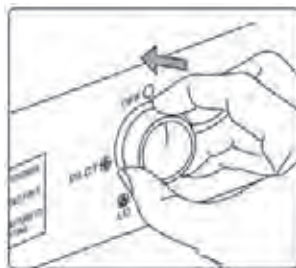

Figure 1

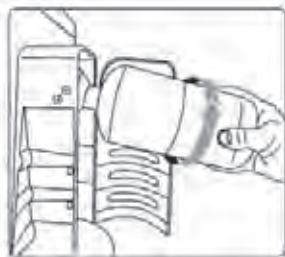

Figure 2

GENERAL INFORMATION

- This heater is safe for indoor use in small recreational enclosures having means for providing combustion air and ventilation, such as enclosed porches, cabins, fishing huts, trailers, tent trailers, tents, truck caps and vans . It may be used for emergency indoor heating when connected to a disposable 1 lb. propane cylinder.
- Note:** The heater is to be used outdoors, but may experience nuisance flame swing or shutoffs due to certain wind conditions.
- The protective wire on the front of this heater is coated with a special high-temperature resistant paint. When the heater is used for the first time, the grill may give off noticeable smoke or fumes. This is normal and will not occur during subsequent uses. The fumes are not harmful.

⚠WARNING: Always inspect propane cylinder and heater propane connections for damage, dirt, and debris before attaching propane cylinder. Do not use if head of cylinder is damaged, punctured or deteriorated.

⚠WARNING: Do not operate heater unless control knob is locked in a position marked "hi", "lo" or "pilot". Never set control knob between locked positions. Poor combustion and higher levels of carbon monoxide may result.

⚠CAUTION: Do not try to adjust heating levels by using the propane tank shut off valve.

CAUTION: Re-iterating the need for adequate combustion and ventilation air when the heater is used in a home, it requires a minimum vent area of 9 square inches, (example 3" x 3" opening at the ceiling and 3" x 3" at floor level for adequate ventilation during operation). Do not use other fuel burning appliances inside. See Page 3

- Operating time will be approximately 3 to 6 hours on a one 1lb cylinder and 48 to 110 hours on a 20 lb cylinder (based on "HI" and "LO" settings). Due to the properties of LP gas, runtimes can be significantly reduced when operating continuously at temperatures below 20°F. Use of a 20 lb. tank is recommended in these conditions.
- When moving heater when lit or bumping heater setting it down, the tip over switch may shut off heater. If this happens, re-light.
- Due to natural operation of small tanks, condensation may build up on tank and drip on surface under heater.

INSTALLATION:

- Install the Plastic Handle on the top and screw it tightly.
- Install 1x AA battery in the battery box on the back right lower, the battery in not include the packing and it need customer buy by themselves.
- Check the glowing wire in the groove of the log surface, use the complimentary hook make it as fluffy as possible. it will be very red and beautiful in fire, if it falls off, re-installed according maintenance
- If it is wire guard style, Install: Insert the two top pin of the mesh frame into the top hole, push the bottom into place till the bottom magnet can attract the bottom plate, Uninstall: Use the hook pull the mesh frame out and remove.
- If it is high guard glass style, Install the winds guard glass in the bracket of the card slot, and Use the screwdriver lock the screw with silicone tip. Uninstall: Use the screwdriver unlock the screw with silicone tip. and then remove the glass.

• LIGHTING / OPERATING INSTRUCTIONS FOR USE WITH DISPOSABLE 1 LB. PROPANE CYLINDERS:

- ALWAYS ATTACH OR DETACH CYLINDER OUTDOORS AWAY FROM FLAMES OTHER IGNITION SOURCES, AND ONLY WHEN HEATER IS COOL TO TOUCH. NEVER SMOKE WHEN ATTACHING OR REMOVING PROPANE CYLINDER OR MAKING REMOTE CONNECTIONS
- Only disposable cylinders marked with the Propane fuel type approved for the

appliance, can be used.

- The LP-gas cylinder(s) used must be constructed and marked in accordance with the specifications for LP-gas cylinders of the U.S. Department of Transportation (DOT).
- Use only VAPOR WITHDRAWAL propane supply. If there is any question about vapor withdrawal, ask your propane dealer.
- Use only 16.4 oz. (1 lb.) disposable cylinders that mate with No. 600 valve connection. Most of 1lb disposable cylinders on market are standard with NO.600 valve connect and cylinder's size is about :4"x4"x8"H
- This heater consumes oxygen from the room in which it is installed. To assure complete combustion, an adequate fresh air supply to the room, See General Safety Instructions, Page 3.
- Heater and attached cylinder must be in an upright position during operation.

IMPORTANT: The heater must not be exposed to flammable vapors or liquids during lighting.

1. Make sure four-position Control Knob is in "OFF" position. See Figure 1.
2. Swivel regulator outward for easy tank installation. Screw 1 lb. disposable LP-gas supply cylinder clockwise (from bottom) into portable heater until hand-tight and then put it perpendicular. See Figure 2. Do not use thread sealant on this connection.
3. Check cylinder connection for leaks with soapy water at the threaded connection under the domed plastic cover where the cylinder screws into the regulator. DO NOT USE ANY EXPOSED FLAME TO CHECK FOR LEAKS. DO NOT OVERTIGHTEN. SEE WARNING! ON DOMED PLASTIC COVER.
4. Turn Control Knob counterclockwise to "PILOT" position and depress to light. See Figure 3.
5. If heater does not light, hold depress for approximately 5-6 seconds until pilot lights.
6. After pilot lights, hold down for 3 -5 seconds and then release knob. Knob should return to fully extended position. See Figure 4.
7. To operate heater slightly depress knob and gently turn to lock in the "Lo" or "Hi" position to light burner log (Facefire™ log).

Shutdown Instructions

- To shut off heater, slightly push down and turn Control Knob clockwise to "OFF" position.
- Do not operate, store or remove cylinder near flammable items or ignition sources.
- Disconnect the gas Cylinder: Open the back fuel chamber, Swivel regulator outward, turn the gas cylinder anticlockwise (from bottom) until removed



Figure 3

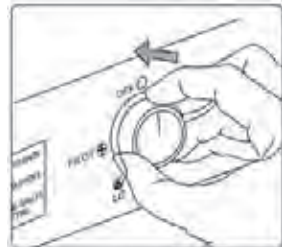

Figure 4

DANGER: Never bring a refillable propane cylinder indoors. A fire or explosion can occur causing property damage, serious injury or death!

CAUTION: After turning heater off, the wire or glass guard will remain hot. Allow to thoroughly cool before storing.

CAUTION: LP-GAS CYLINDERS MUST BE DISCONNECTED WHEN THE HEATER IS IN USE OR IN STORAGE!.

LIGHTING / OPERATING INSTRUCTIONS FOR USE WITH HOSE CONNECTED TO A REMOTE CYLINDER, MAXIMUM SIZE 20 LBS:

- This Heater may be used in a recreational enclosure (such as fishing huts, tents, and hunting blinds when such enclosures have adequate means for combustion air and ventilation) with a remote refillable propane cylinder **ONLY** when the cylinder is located outdoors, and recommended the proper hose connectors and fittings necessary for connecting the appliance to a remote fuel cylinder as following: the hose specified by alogfire manufacturer

(NOTE: operate without the fuel filter as fuel contamination may damage the heater. Because LPG contains grease or debris)

- Inspect the hose before each use of the heater. If there is excessive abrasion or wear, or the hose is cut, replace prior to using the heater with one of the Alogfire Hose shown above.

CAUTION: The hose is not allowed to touch or cross the upper and both sides of the heater. see figure 5

- The LP-gas cylinder(s) used must be constructed and marked in accordance with the specifications for LP-gas cylinders of the U.S. Department of Transportation (DOT).
- Use only VAPOR WITHDRAWAL propane supply. If there is any question about vapor withdrawal, ask your propane dealer.
- The propane cylinder must include a listed overfilling protection device as well as a collar to protect the cylinder valve.
- This heater consumes oxygen from the room in which it is installed. To assure complete combustion, an adequate fresh air supply to the room, See **General Safety Instructions**, Page 3.
- Heater must be in an upright position during operation.

IMPORTANT: The heater must not be exposed to flammable vapors or liquids

during lighting.

1. Make sure four-position Control Knob is in "OFF" position. See Figure 1 on previous page.
2. Swivel regulator outward for easy hose installation. Screw hose connector into regulator on heater and screw connector on other end of hose into LP-gas supply cylinder valve. Tighten all hose connections. DO NOT use thread sealant on any of these connections.
3. Strongly recommended using the hose specified by Alogfire manufacturer.
4. Open valve at LP-gas supply cylinder.
5. Check all hose connections for leaks with soapy water at the threaded connection under the back's plastic cover where the hose connector screws into the regulator and at LP-gas supply cylinder. DO NOT USE ANY EXPOSED FLAME TO CHECK FOR LEAKS. DO NOT OVERTIGHTEN. SEE WARNING! ON AND INSIDE THE PLASTIC COVER.
6. Turn Control Knob counterclockwise to "PILOT" position and depress to light. See Figure 3 on previous page. This may take longer to purge air from the supply hose depending on the length of the hose being used.
7. If pilot does not light, hold down for approximately 15 seconds; release and depress again. Repeat until pilot lights.
8. After pilot lights, hold down for 3-5 seconds and then release knob. Knob should return to fully extended position. See Figure 4 on previous page. The pilot should remain lit.
9. To operate heater slightly depress knob and gently turn to lock in the "LO" or "HI" position to light Facefire™ log.

Shutdown Instructions

1. To shut off heater, shut off propane at supply tank, allow heater to use-up propane in supply line until heater shuts off, then slightly push down and turn Control Knob clockwise to "OFF" position.
 - The gas must be turned off at the LP-gas supply cylinder when not in use.
 - As stated before allow heater to use up propane in supply line until heater shuts off.

- To Disconnect: Confirm around are safety without flammable materials and no open flame or smoker, check the gas supply tank and the heater are shut off and heater is cool, turn counterclockwise hose connector out of regulator on heater and connector on other end of hose out of LP-gas supply cylinder valve until detached.
 - When the LP-gas supply cylinder is not disconnected from the heater, the heater and the cylinder must be stored outdoors, in a well ventilated space, out of reach of children, and must not be stored in a building, garage or any other enclosed area.
- Indoor storage of the heater is permissible only if the cylinder is disconnected and removed from the heater. Cylinders must be stored outdoor out of the reach of children and must not be stored in a building, garage or any other enclosed area.

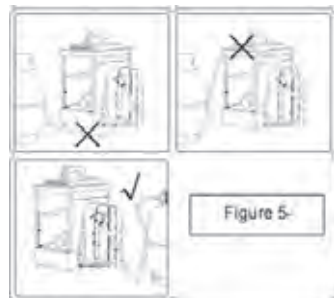

Maintenance

- Always keep the heater area clear and free from combustible materials, gasoline and other flammable vapors and liquids.

IMPORTANT: The heater and its surroundings should be kept clean and free of dust.

- Visually inspect the pilot flame and burner periodically during use. The pilot flame should be blue in color (not yellow) and will extend to the thermocouple. The flame will surround the thermocouple just below the tip. See Figure 6.
 - Usually the pilot flame is blue, the burner log flame is bright with slight yellow. If the pilot is yellow or the burner flame on "HI" level is too small, but Shake the gas cylinder and feel fluid in it, Also maybe indicates an accumulation of dust, lint or spider webs inside the pilot and main burner assembly. check and cleaning may be required.
 - It is necessary to periodically check the burner log tube and the venturi of burner and pilot to make sure that they are clear of things such as insect nests and spider webs that may accumulate over time.
 - Use the following procedure to inspect the pilot and main burner assembly.
3. Unscrew the lock nut on the end of the log that fixed the log. Pull burner log up, clean the soot or dust on surface with brush and vacuum, do not pull out the glowing wire in the groove
 4. Inspect and clean burner log tube and venturi by using a vacuum or apply air pressure through the pipe orifice.
 5. Inspect and clean pilot (mounted to bracket) by using a vacuum or apply air pressure through the holes in the pilot indicated by the arrows in Figure 6.
 6. Reassemble main burner log onto the burner venturi,
 7. If the glowing wire falls off that in the surface groove of the burner log, it needs to be re-installed, first insert two end into the hole at both end of groove, then insert the others in the groove equably. It will be very red and beautiful in fire if make the glowing wire as fluffy as possible use the complimentary hook.
 8. Reinstall fuel line and check for leaks.
 9. The exterior of the heater can be cleaned with a damp cloth. Avoid the direct use of any aerosol or spray-on cleaners. Do not use abrasive materials or cleaners on the decals or control knob.
 10. Accidental Tip-Over Switch: The sound of click is the operation of the Accidental Tip-Over Switch when the unit is shaken, bounced or tipped upside down. Do not worry, this is only your tip-switch operating as it's designed.

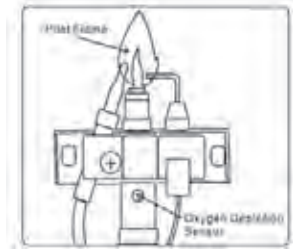

Figure 6

WARNING: Never use needles, wires or similar cylindrical objects to clean the pilot to avoid damaging the calibrated ruby that controls the gas flow through the pilot orifice.

OFFSEASON

- If the heater is to left "OFF" for a considerable period of time, the propane (LP) gas supply to the heater should be turned off as close to the gas source as possible. In the case of portable use, the gas should be turned off at the propane (LP) gas supply cylinder.
- If the heater is put into storage, make sure to disconnect the propane (LP) gas cylinder:
- When the LP-gas cylinder is not disconnected from the heater, the heater and cylinder must be located outdoors, in a well-ventilated space, out of the reach of children, and must not be stored in a building, garage, or any other enclosed area.
- Storage of the heater indoors is permissible only if the cylinder is disconnected and removed from the heater. Cylinders must be stored outdoors, in a well-ventilated space, out of the reach of children, and must not be stored in a building, garage, or any other enclosed area.
- Please remove the battery (in battery box)

Cleaning Instructions:

IMPORTANT: Allow heater to thoroughly cool before performing any maintenance.

1. Remove disposable 1 lb. cylinder from heater or turn OFF gas supply at remote cylinder valve, and disconnect hose from heater.
2. Inspect the surface of platform, burner log and the pilot for accumulation of dust, lint or spider webs. If necessary, clean with a vacuum cleaner or apply air pressure. Do not damage any components within the housing assembly when you are cleaning.

SYMPTOM

- **Spark electrode does not produce spark.**

CAUSE

1. Spark electrode broken.
2. Igniter wire may not be attached to spark electrode, ground wire may not be attached to frame.
3. Igniter wire damaged.
4. The battery is out or the igniter is defective

REMEDY

1. Replace ODS (Oxygen Depletion Sensor).
2. Attach igniter wire or ground wire.
3. Replace igniter wire.
4. Replace the battery, declare for maintenance if no useful

SYMPTOM

- **Spark electrode produces spark but pilot does not light.**

CAUSE

1. No gas to heater.
2. "PILOT" position not properly aligned.
3. Pilot is blocked with foreign debris.

REMEDY

1. Install disposable cylinder or connect hose and filter where required and turn on valve at remote cylinder.
2. Turn gas control knob to "PILOT" position and depress.
3. Clean pilot. See MAINTENANCE section.

SYMPTOM

- **Pilot flame does not stay lit when knob is released.**

CAUSE

1. Improper pilot lighting.
2. Pilot flame not surrounding thermocouple.
3. Pilot Assembly is defective.
4. Switch wires are disconnected.

REMEDY

1. Make sure that the control knob is completely depressed in the "PILOT" position and held long enough to purge air from lines.
2. Clean pilot, see MAINTENANCE.
3. Replace Pilot Assembly.
4. Connect tip switch wires.

SYMPTOM

- **Main burner (Burner log) does not ignite or fire is too small always**

CAUSE

1. Main burner orifice is blocked.
2. The hose or filter is blocked that connected tank

REMEDY

1. Clean burner - see Maintenance.
2. Change the hose or fuel filter

SYMPTOM

- **Heater keeps shutting "OFF" during normal operation.**

CAUSE

1. Pilot is blocked.
2. Inadequate fresh air opening.
3. Tip over switch activated from bumping heater.
4. Regulator defective.
5. Internal contamination.

REMEDY

1. Clean pilot. See MAINTENANCE section.
2. Provide minimum fresh air opening of 9 square inches (example 3" x 3" opening).
3. Re-light.
4. Replace regulator.
5. Replace control valve and regulator.

- For additional assistance or information, please call Technical services.

NEVER LEAVE THE HEATER UNATTENDED WHILE BURNING!

WARRANTY AND PARTS ORDERING



Alogfire
by *Flame King*

**PORTABLE CAMP HEATER WITH
REALFLAME LIKE FIREPLACE**

Model : ALF-P1 Series Include P1A1/A3, P1B1/B3

⚠ WARNING:

USE ONLY MANUFACTURER'S REPLACEMENT PARTS. IT ARE ONLY AVAILABLE DIRECT FROM THE FACTORY OR AUTHORISED DISTRIBUTOR. ALOGFIRE HOSES ARE SPECIFICALLY DESIGNED FOR USE WITH THIS HEATER. (ALL ACCESSORIES SOLD SEPARATELY). USE OF ANY OTHER PARTS COULD THE HEATER TO BECOME INOPERABLE, INJURY OR DEATH.

⚠ WARNING:

THIS PRODUCT IS A HEATER. IT IS CERTIFIED BY CSA TO ANSI INTERNATIONAL REQUIREMENT SECTION Z21.103-2017, "UNVENTED PORTABLE TYPE GAS CAMP HEATERS FOR INDOOR AND OUTDOOR USE". THIS PRODUCT IS NEVER TO BE USED FOR THE COOKING OR WARMING OF FOODS AS DOING SO CAN INTERFERE WITH THE SAFETY SYSTEMS OF THE HEATER, WHICH MAY RESULT IN A FIRE, EXPLOSION, THE PRODUCTION OF DEADLY CARBON MONOXIDE, AND PERSONAL INJURY OR DEATH TO YOU OR OTHERS. NEVER USE HAND-MADE OR THIRD PARTY ACCESSORIES OR ATTACHMENTS WITH THIS HEATER; THIS IS EXTREMELY DANGEROUS AND MAY RESULT IN PERSONAL INJURY OR DEATH TO YOU OR OTHERS.

PARTS ORDERING INFORMATION

PURCHASING: Accessories may be purchased at any Alogfire local dealer or direct from the factory
FOR INFORMATION REGARDING SERVICE

visit www.flameking.com or email to: info@flameking.com

Please include the model number, date of purchase, and description of problem in all communication when contact us.

LIMITED WARRANTY

Alogfire Company warrants its heaters and accessories to be free from defects in material and workmanship for a period of 1 year from date of purchase. flameking.com will repair or replace this product free of charge if it has been proven to be defective within the 1-year period, and is returned at customer expense with proof of purchase to Alogfire company within the warranty period. **DISCLAIMER:** This warranty does not cover any product that: a) has been subject to misuse or neglect; b) has been used in a manner inconsistent with the warnings and instructions contained in the owner's manual, including but not limited to using a heater for the cooking or warming of foods; or c) has been used with hand-made or third party accessories or attachments.

This warranty gives you specific legal rights, and you may also have other rights which vary from state to state.

This product is covered by one or more China or international patents or pending patent applications in the US and other countries. Do not copy.



THANK YOU FOR YOUR PURCHASE

Flame King 6677 Box Springs Blvd., Riverside CA 92507
Alogfire™ and Facefire™ are Registered Trademarks of Alogfire Company.
© 2024, Alogfire All rights reserved

INSTRUCCIONES DE SEGURIDAD

