

Operation Manual Of Quantum Lamp

1. Product parameters

Input power supply	5V2A		Lumen	120LM
output voltage	5V		Remote control distance	5—8 M
light source	colorful LED		Product size	10.3*9*3 CM
power	1.2W		USB line length	1.5 M

2. Quantity of packaging accessories

quantum lights, 1 infrared remote controls, 1 USB cable, double-sided tapes, connecting buttons

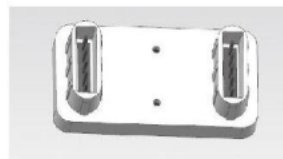
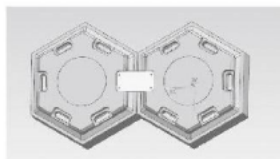

3. Lamp assembly and instructions

1. Connect the lamp with the connecting plate,
2. After matching the desired pattern, connect the USB cable to the USB port of the lamp closest to the power supply, and connect the other end of the USB cable to the appropriate output voltage of 5V2A On the adapter (not included), plug in the adapter.
3. Unplug the insulating piece of the remote control and press the on key towards the light to see if all the lights are on. If the light is not on, please point the remote control at the light that is not on and press the on key, If it is still not on, check whether the connecting plate is connected correctly.
4. Unplug the power supply and place the lamp on the flat surface with the bottom facing up. Apply double-sided tape to the bottom circle of the lamp.
5. Then wipe the wall where the lamp is to be placed, pick up the combined lamp and press the side with double-sided adhesive tape on the wall.
6. Connect the power supply and use the remote control to choose the color and flashing mode you like. Touch the center of each lamp with your hand to set the color of a single lamp.
7. The spare USB port on the lamp can be used to power or charge other devices.

4. Remote control description

Key	function	Key	function
ON/OFF	On / off		Timed, automatically extinguished after half an hour
Color key	Choose a fixed color	FLASH	Twinkle
FADE	Automatic gradient		Dim (4 levels in total)
JUMP	Automatic jump		Dimming (4 levels in total)

5. Matters needing attention

1. Please use high-quality USB charger with output of 5V and sufficient 2A, otherwise the lamp will be uncontrolled or work abnormally.
2. When remote control, please operate at the front of the lamp within the effective distance.
3. Do not click too fast when touching, and try to touch in the right center of the lamp.
4. When the light is white, the power consumption is the maximum. A line should not be connected with more than 7 lights, and idle USB port should not be connected with other devices. Other colors can be appropriateConnect more lights and external devices.
5. Wipe the wall before pasting it on the wall, so as to avoid falling down due to poor pasting. The hook can also be hung on the connecting plate to fix to the wall.