

LED CEILING FIXTURE



INSTRUCTIONS PERTAINING TO RISK OF FIRE OR INJURY TO PERSONS
READ ALL INSTRUCTIONS

IMPORTANT SAFETY INSTRUCTIONS

SAVE THESE INSTRUCTIONS

TOOLS AND MATERIALS REQUIRED:



Wiring supplies
as required by
electrical code



Pliers

SAFETY PRECAUTIONS:

1. TURN OFF ELECTRICAL POWER BEFORE STARTING INSTALLATION OF LIGHT FIXTURE.
2. THIS PRODUCT MUST BE INSTALLED IN ACCORDANCE WITH THE APPLICABLE INSTALLATION CODE BY A PERSON FAMILIAR WITH THE CONSTRUCTION AND OPERATION OF THE PRODUCT AND THE HAZARDS INVOLVED.
3. CAUTION - RISK OF ELECTRIC SHOCK. CONSULT A QUALIFIED ELECTRICIAN TO ENSURE CORRECT BRANCH CIRCUIT CONDUCTOR.
4. WARNING, THIS IS A LINE VOLTAGE MODEL AND DOES NOT AND CANNOT USE A DRIVER.
5. LINE VOLTAGE MODELS ALREADY HAVE A POWER SUPPLY CHIP BUILT INTO THE LED ARRAY.

INSTALLATION

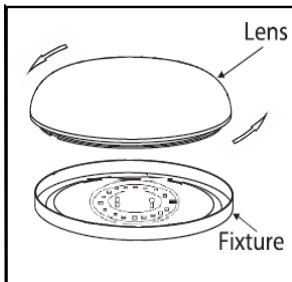

- 1.** Remove plastic lens by gently rotating and lifting.

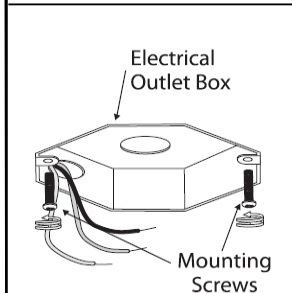

- 2.** Place mounting screws (included) in electrical box screwing in halfway.

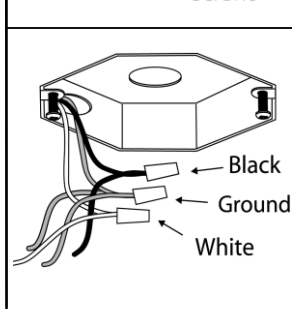

- 3.** Using wire nuts to connect ground wire (green) from fixture and LED board to ground wire from electrical box. Connect black wire from fixture to black wire from electrical box. Connect white wire from fixture to white wire from electrical box.

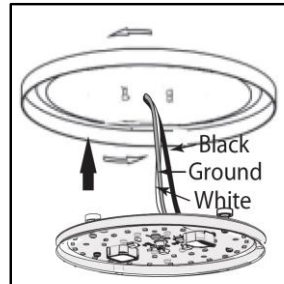

- 4.** Line up magnetic PCB board with mounting holes on metal pan. Attach fixture to mounting screws, turn fixture counter-clockwise to lock.

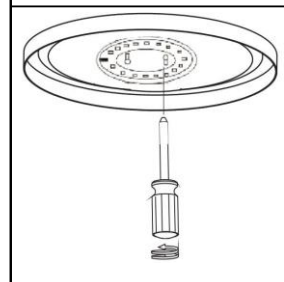

- 5.** Secure fixture by tightening mounting screws.

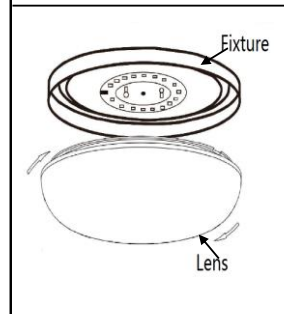

- 6.** To install acrylic plastic lens, hold lens up to fixture, and rotate until notches in lens line up with tabs in fixture. Continue rotating until lens stops.

This LED Light is suitable to be dimmed
Dimming levels will vary by dimmer.
MAGNETIC PCB BOARD MAY SHIFT OR MOVE DURING SHIPPING
PLEASE ADJUST AND OR CENTER THE PCB BOARD