

SUNVIVI

ZBS001

Instructions Manual Electric Hair Shaver

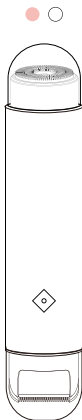

Model No.: 1618

Please read this manual carefully before use and keep it safe for future reference

 707-392-8405

 www.sunvivi.com

 support@sunvivi.com

Thank you for using our products

This manual describes the various functions, use methods and precautions of the product. Please read this manual carefully and keep it properly before using the instrument. This manual legend is for reference only, please refer to the actual product.

FUNCTION INTRODUCTION

Electric hair shaver is a one-machine double-head design hair removal tool, suitable for removing the whole body hair multi-effect hair removal tool, the serrated cutting head can be matched with detachable comb teeth, smooth hair cutting; 3D floating tip, fits skin to remove short hair. Both blades are detachable, easy to clean, and one-click control of the cycle of cutting both sides of the cutter head hair removal. It comes with a portable brush for quick cleaning of residual dander.

STATUS INDICATOR

No.	Item	Condition
1	Work instruction	The power button indicator is steady on
2	Function indicator	The "red" indicator light is on, and the serrated cutting head is working; The "blue" indicator lights up and the 3D floating cutter head works;
3	Low power indicator	When the battery is less than 30%, the indicator flashes every 5 seconds until it is reminded of power shortage
4	Power shortage warning instruction	When the battery is less than 10%, the indicator flashes for 10 times will automatically shut down
5	Charging indicator	The breathing light blinks slowly while charging
6	Charge completion indication	Indicator light keeps on



PART DESCRIPTION

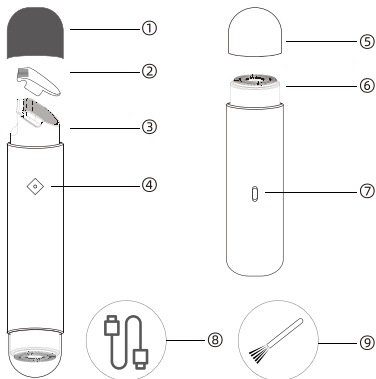

No.	Description	No.	Description
①	Dust cap	⑥	3D floating cutter head
②	Fixed length comb teeth	⑦	Type-C charging port
③	Serrated clipper head	⑧	Type-C charging cable
④	Power button/indicator light	⑨	Cleaning brush
⑤	Clear dust cover		

There are 2 versions of this product

Version A double head shaver: serrated clipper head +3D floating cutter head

Fixed length comb installation: Press the following picture, put on the fixed length comb teeth and fasten the comb sleeve at the cutter head clip;

Serrated cutting head installation: Align with the buckle position, turn counter clockwise to remove the serrated clipper, turn clockwise to close;

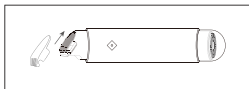

Loading and unloading 3D floating cutter head: Align with the buckle position, remove the 3D floating cutter head by turning it counter clockwise, and fasten it clockwise.

Version B Single head shaver : 3D floating cutter head

Loading and unloading 3D floating cutter head: remove 3D floating cutter head by counter clockwise rotation; Turn the buckle clockwise;

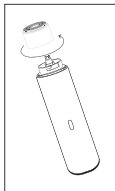

METHOD OF APPLICATION



1. Long press the "On/Off button" to start the product, red light a serrated cutting head; The blue light is 3D floating cutter head; By default, the mode used last time is restored after the system starts



2. Press the "On/Off" button to switch the two ends shaving Hair cutter head work, "blue" indicator light, 3D floating cutter head work;



3. Use of sawtooth clippers: sawtooth clippers trim hair against the direction of hair growth;



4. 3D floating cutter head use: Move the 3D floating cutter head in a circle against the direction of hair growth to remove hair;



5. After use, hold down the On/Off button for 1S to shut down*



6. Remove the cutter head and clean up any remaining dander with the equipped brush head



7. Cleanse your skin, moisturize your skin, etc.



COMMON FAILURE PROBLEM

Problem	Reason	Solution
After starting, the tool head does not work	1. Whether the knife cap is stuck in place	1. Reassemble the knife cap
	2. Whether there is any foreign object in the knife cap	2. Clean foreign bodies inside the cutter head
Unable to boot	Battery low	Please charge it and try again

PRECAUTIONS AND PRESERVATION

1. Please check whether there is obvious damage before each use. If there is damage or the machine is seriously dropped, do not use;
2. This product is not suitable for children use alone, it need to use with the cooperation of adults;
3. Try to ensure that the hair remover components are dry and dust-free when using;
4. It should not be used when facial skin is crusted or acne is severe.
5. Keep out of reach of infants and do not use as toys.
6. When using the action amplitude should not be too large or use too long;
7. Do not remove the tool head while the instrument is working;
8. This product is only suitable for use as a hair remover, not for other purposes;
9. Do not use after drinking alcohol;
10. Do not use chemicals when cleaning this product, wipe it gently with a wet paper towel, and then remove the water with a dry cloth;
11. Do not connect the product power supply with wet hands;
12. Please do not disassemble or assemble this product privately.
13. Please do not share or use this product with others because of the risk of infection.
14. When using this product, please keep away from radiators and other heating devices;
※ Radiators, furnaces, or devices that generate heat;
15. Do not charge the charging interface and charging cable of the machine after soaking in water. Be sure to wipe and dry before charging to prevent short circuit and fire.
16. Keep away from corrosive liquids;



CLEAN METHOD

After each use, please rotate the hair removal tool head assembly, clean the storage area with a brush, rinse the tool head assembly separately, and wipe it dry before reloading it into the main machine.

Do not flush the whole machine or soak it in water.

BATTERY SAFETY INSTRUCTIONS

1. Please follow the instructions to avoid adverse effects.

2. Be sure to unplug the power plug when the product is fully charged.

3. If the product is abnormally hot, emits odor, discoloration, or takes longer than normal to charge, stop using it and stop charging it, and contact after-sales service.

4. This product contains a non-rechargeable battery, do not open this product to replace the rechargeable battery.

5. In order to prevent the battery from heating or releasing toxic and harmful substances, do not modify, puncture or damage the product and battery, do not disassemble the battery, short circuit the battery, overcharge or reverse charge the battery.

6. To avoid an unexpected short circuit after the battery is removed, do not allow the battery terminal to touch metal objects (such as coins, bobby pins, and rings). Never wrap the battery in aluminum foil. Please put the battery in a plastic bag before disposing.

7. If the battery is damaged or leaking, avoid contact with skin or eyes. In case of contact, rinse immediately with water and seek medical attention.



DISPOSAL METHOD

Waste disposal methods for used electronic instruments (applicable in the European Union or other countries or regions with waste sorting systems).



The crossed pattern on the trash indicates that the instrument cannot be disposed of as household waste and should be sent to the appropriate electrical and electronic instrument recycling collection station (or recycling bin) for disposal. Proper disposal of this instrument can prevent the negative effects of waste instruments on the environment and human health. Material recycling also helps conserve natural resources. It is everyone's responsibility to protect the earth.

PRODUCT PARAMETER

Sku	ZBS001
Model	1618
Product Material	PC+Metal
Battery Capacity	300mAh
Input Voltage	5V
Charge Current	≤400mA
Charge Time	2H
Product Size	30.5*30.5*150mm
Net Weight	120g
Power	≤3W



GUARANTEE CLAUSE

- 1.The warranty time of the product is one year from the date of purchase;
- 2.The product warranty scope refers to the problem of the product under normal use;
- 3.Free maintenance within the warranty period and warranty scope;
- 4.In order to ensure cleanliness and prevent infectious skin diseases, this product is not refundable once used.

DISCLAIMER

User of the product at their own risk. Shall not be liable or liable for any physical or non-physical injury caused directly or indirectly by the use of the Products. In addition, the Company reserves the right to modify this Note and change the content at any time, and has no obligation to notify any individual of such modifications or changes.

WARRANTY EXCEPTIONS

1.Under any of the following circumstances, even within the warranty period, it cannot be treated as a warranty, but it can be repaired for a fee:

- ①Failure to use, maintain and keep in accordance with the requirements of the product specification, resulting in damage;
- ②Due to incorrect operation, damage (such as: falling, falling into the water, etc.), forced knob caused damage;
- ③Failure and damage caused by storage conditions than those specified by the product(such as: ambient temperature is too high, too low, wet, etc.)
- ④Damage caused by force majeure (such as: thunder, earthquake, fire, flood, war, etc.);

2.This warranty only applies to the occasions where consumers purchase and use for personal consumption needs, and does not apply to business operations.



WARRANTY CARD

Purchase channel /order number:
Purchase date:
Customer name:
E-mail:
Purchase address:
Product color:
Contact number:
Customer address:
Problem description:

If you have any quality problems, please contact the local seller



SUNVIVI



Any Problem? Let Us Know.



www.sunvivi.com



707-392-8405



support@sunvivi.com