

# User Manual And Warranty Certificate

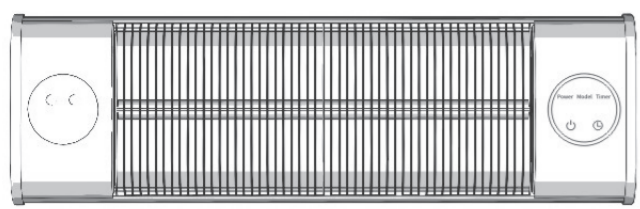

Model: PH-150R  
Infrared Heater

## Table of Content

- Safety Guidelines ..... 1
- General Safety Information..... 3
- Electrical Connection Safety..... 3
- Safe Distances Required for Installation..... 3
- Dispose..... 5
- Components and Specifications..... 5
- Assembly & Installation..... 7
- Operation..... 9
- The Remote Control Operating..... 11
- Application Fields..... 12
- Troubleshooting..... 13
- Cleaning and Maintenance Instructions..... 13
- Technical Service..... 15
- Warranty..... 15
- EXTENDED WARRANTY REGISTRATION..... 16

## SAVE THIS INSTRUCTIONAL MANUAL FOR FUTURE REFERENCE.

### Definitions: Safety Guidelines

The definitions below describe the level of severity for each signal word. Please read the manual and pay attention to these symbols.

**WARNING:** Indicates a potentially hazardous situation which, if not avoided, could result in death or serious injury.

**CAUTION:** Indicates a potentially hazardous situation which, if not avoided, may result in minor or moderate injury.

**NOTE:** Indicates a practice not related to personal injury which, if not avoided, may result in property damage.

### WARNING! PLEASE DO NOT USE THIS PRODUCT IN THE VERTICAL POSITION

Read and understand all instructions. This manual contains important information about the assembly, operation and maintenance of this infrared heater. General safety information is presented in the first few pages and is also located throughout this manual. Keep this manual for future reference and to educate new users of this appliance. Failure to follow all instructions listed below may result in electric shock, fire and/or serious personal injury.

## General Safety Information

### Electrical Connection Safety

- Check whether your appliance and power cord are damaged before operating your appliance.
- Check whether there is any crack, disjoint or scratch on the filament (heating tube). If any, contact with your authorized technical service.
- If you appliance or power cord is damaged, do not operate your appliance and return it to your technical service.
- Make sure that the main electricity circuit is 220-240V and 110-120V, 50-60HZ and the connection is fused.
- Check the safety of the network. The fuse must be 25A.
- Do not use your infrared heater together with another appliance plugged to the same multiple sockets or connected to the same fuse.
- Use your appliance with a properly earthed plug.
- The earthed plug must fall outside heating field and hot surface.
- The power cord must not be left on or around the frame of your infrared appliance.
- Unplug your appliance when you won't operate it for a long term or will conduct cleaning or maintenance.
- The damaged heater glass must be exchanged.
- If the cable of the heater should be damaged, this may be replaced only by the authorized service.
- If has to be notified that the mounting in the bath must be so that the persons in the bath can not reach the controls.
- It has to be notified that the product has to be installed at a dry location and may not be wet.

### Safe distances required for installation

- Attention! The appliance must only be operated in a horizontal position with max±15°slope. In case of operations in angels larger than 5°in horizontal position or of vertical operations, the heating loop wire may fall into disuse shortly.
- Never install your appliance on a combustible surface (carton etc.). The distance of your appliance from the ground is to min 1.8 m (6 feet).
- The distance of your appliance from the ceiling is to be min 0.7 m (2.5 feet).

- The distance of your appliance from the living beings is to be min 1 m (3.5 feet).
- The distance of heating area of your appliance from the materials such as wood, carton, cloth etc., must be min 1 m (3.5 feet).
- Do not cover your appliance and do not hang any clothing over the heater or do not place any clothing on or near the appliance.
- Do not stick anything into the protective grid.
- Do not make use of your heater to light up cigarette or similar materials.
- Supervision is needed when this product is used anywhere near children. The appliance is not intended for use by children or other persons without assistance or supervision if their physical, sensory or mental capabilities prevent them from using it safely.
- Risk of Fire-keep combustible material such as furniture, papers, cloths, and curtains at least 0.9 m (3 feet) from the front of the heater and away from the sides and rear.

### Warning-TO REDUCE THE RISK OF FIRE

- 1) Do not place any objects such as furniture, papers, cloths, and curtains at least 0.9m (3 feet) from the front of the heater and away from the sides and rear when the heater is plugged in.
- 2) Do not place the heater near a bed because objects such as pillows or blankets can fall off the bed and be ignited by the heater.
- 3) Always unplug the heater if it is not being used.
- 4) Do not operate within 7.6 m (25 feet) of flammable material.

- Never block the front grill of the heater.
- The heater is not suitable for hazardous locations. Never attempt to service the heater without disconnecting its power source.

## Dispose

- When you need to dispose of the unit, please consult with your local recycling center for information about how to dispose of the unit in an environmentally responsible manner.
- Please recycle or dispose the packaging material for the product in an environmentally responsible manner.

## Components and Specifications

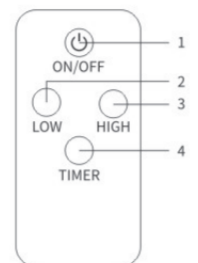
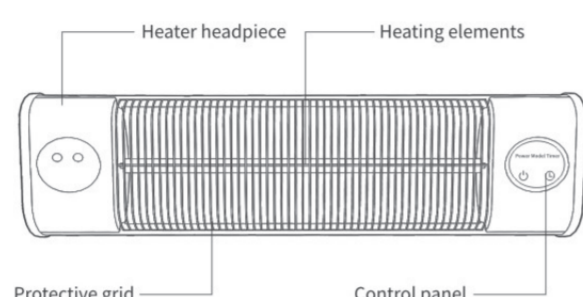

1. ON/OFF  
Switches on or off the heater or stands it by.
2. First Heating Mode  
After turn on the heater, you can choose low heating.
3. Second gear  
After turn on the heater, you can choose high heating.
4. Timer  
After turn on the heater, you can choose timer

## PARTS INSTRUCTION

NO.	PARTS	QTY	NO.	PARTS	QTY
A	Infrared Heater	1pcs	B	Remote control	1pcs
C	Fixed bracket	4pcs	H	Hexagonal screw	2pcs
I	Nut and Disc Tail	2pcs	J	selftapping screws	4pcs
K	Plastic expansion	4pcs	L	Flat pad	4pcs
M	round hea screw	4pcs			

## Assembly & Installation

Note: There may be a trace of odour during the first few minutes of initial use, or after a period of storage. This is normal and will quickly disappear.

1. There are 4 brackets and fasteners used with the heater. Furthermore, in the canal of back side of the heater there are 4 square fastener washers.

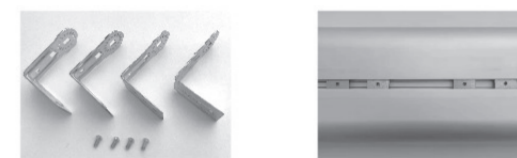

### 2. Bracket installation (From 1 to 4, as shown).

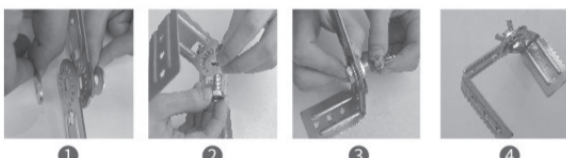

- 1 Match the round holes of the two wall bracket. Align the holes of the two flat pads on the same horizontal line with the wall bracket.
- 2 Depress both flat pads on the round hole of the wall bracket, insert the hexagonal screw through the aligned hole.
- 3 Fix the brackets structure with the nut and disc tail.
- 4 The final display effect is shown in the figure.

3. Fix the assembled bracket on the heater with phillips round head screw. Fasten the brackets at the appropriate distance of each other (1.5-1.8ft)



4. Drill a hole in the wall, put the plastic expansion into the wall hole first, then fix the heater wall bracket to the wall, and drive in the phillips flat self-tapping screws. Install the heater with the appropriate angle (in the direction to the area being heated). At least 2.5 ft from the floor and at least 1.6 ft from the ceiling.



Note: The angle of the bracket behind the heater can be adjusted by rotating the nut

## Operation

1. Plug in the power and turn on the power switch, the power indicator light is on, and the buzzer beeps once.

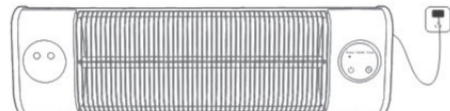

**NOTICE!!!** Remote Control Comes with a Plastic Paper to Prevent Battery from Draining During Transportation. Please Kindly PULL OUT the Plastic Paper to Activate Your Remote Control.

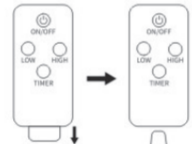

2. Press the power button once, the digital screen displays P0 (standby mode), and the buzzer beeps once.



3. Press the power button twice, the digital screen displays P1 (low power), the power indicator lights up, and the buzzer beeps once. The blue light is displayed under the mode.



4. Press the power button three times, the digital screen displays P2 (high-end power), the power indicator lights up, and the buzzer beeps once. The blue light is displayed under the mode.



5. Press the timer button, the 1-9 hour timer shutdown can be adjusted arbitrarily, the digital screen displays 01 for 1 hour, and 02 for 2 hours. The blue light is displayed under the timer.



### The Remote Control Operating

1. Plug in the power and turn on the power switch, the power indicator light is on, and the buzzer beeps once.

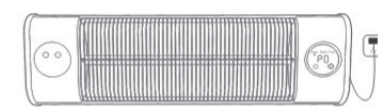

2. Press the ON/OFF button to turn on the heater, the display shows

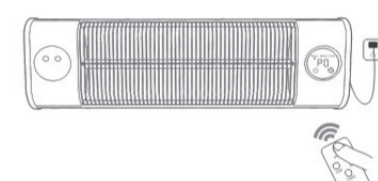

3. Press LOW, the display shows (620W, 1 Gear); Press HIGH, the display shows (1500W, 2 Gear).



4. Press TIMER. The digital screen displays 01 for 1 hour to 09 for 9 hours.

## Application Fields

Install the heater strict in horizontal position (PARALLEL TO FLOOR)

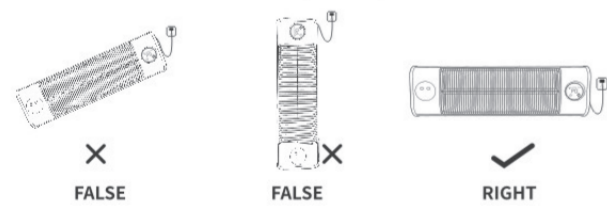

Direct the heater the APPROPRIATE ANGLE

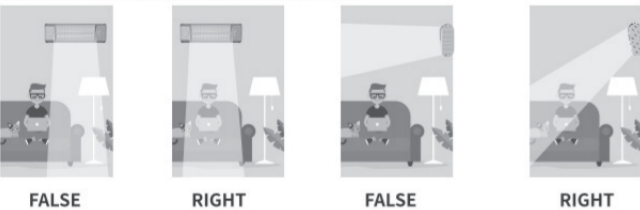

Prevent the loss of directed heat through the windows.



## Troubleshooting

Problems	Probable Causes	Solutions
The appliance will not start	<ul style="list-style-type: none"> <li>• The unit is unplugged</li> <li>• The switch is not on right position</li> <li>• Main burner will not light</li> </ul>	<ul style="list-style-type: none"> <li>• Make sure the power supply cord is plugged.</li> <li>• Check the position of the switches</li> <li>• Contact us if the unit is damaged or defective.</li> </ul>
Heating light is weak	<ul style="list-style-type: none"> <li>• Dust accumulation on the heater</li> <li>• arts need to be replaced</li> </ul>	<ul style="list-style-type: none"> <li>• Cleaning the heater</li> <li>• Contact us customer service team</li> </ul>
Burnt smell	<ul style="list-style-type: none"> <li>• Small bugs like mosquitoes are scorched by high temperature</li> <li>• The unit might be defective or damaged</li> </ul>	<ul style="list-style-type: none"> <li>• Cleaning the heater</li> <li>• Contact us if the unit is damaged or defective.</li> </ul>

## Cleaning & Maintenance

**Cleaning:**  
Attention! Regular and careful cleaning helps your heater operate for longer years and more efficiently.

1. Unplug your power cord for your safety before cleaning your appliance.

2. Take out the front grid wire through the inlets on the frame using a slotted screwdriver.
3. Make sure that the power is off for your safety. Power cord plug must be unplugged.
4. The reflector and filament must be cleaned with a soft cloth, a smooth brush or cool or dry air. The cloth may be damp but never too wet and the cleaner should not include any chemical.
5. Refrain from using cleaning material likely to damage the reflector (cleanser etc.).
6. Insert the wire grid using a slotted screwdriver.

**Maintenance:**  
Attention! Careful and regular maintenance of Infrared Heater considering our instructions assume great importance so as to attain a long and efficient operation of your appliance.

1. Check the filthiness of the Reflector and IR-Filament at least once a month. If necessary, apply cleaning and maintenance instructions.
2. The number of checks may be increased considering the amount of the dust in the environment.
3. Check the deformation of the Reflector, Wire and Frame visually while cleaning the appliance. In case of any deformation, consult to your technical service.
4. Check the power cord and plug visually while cleaning the appliance. In case of any deformation, consult to your technical services.
5. It is recommended to change the reflector every 2 years for the purpose of more efficient operation of you appliance.

## Technical Service

Attention! Only technical services and persons authorized by SUN may serve, repair and replace the spare parts of this heater. Points to be considered before shipping the product to the technical service:

1. Make sure that the thermostat of your appliance is in "0" mode.
2. Make sure that the plug, to which the appliance is connected, has power, check the fuse and power cord. If the plug lacks power, consult to an electrician.
3. Make sure that the appliance has been installed in accordance with the instructions in the manual. If the installation is inaccurate, consult to technical service.

## Warranty

Every product is warranted to the original purchaser only to be free from defects in material and workmanship. Subject to certain exceptions, we will replace any part on an electric power tool that is defective in material or workmanship for a period of 1 year after the date of purchase unless otherwise noted. This warranty does not apply to damage from repairs made or attempted by anyone other than Senssi, misuse, alterations, abuse, normal wear and tear, lack of maintenance, or accidents. Warranty Registration is not necessary to obtain the applicable warranty on a product. This warranty applies to product sold in the U.S.A. only.

THANK YOU FOR YOUR PURCHASE!  
OUR GOAL IS YOUR 100% SATISFACTION

**Our Warranty**  
For the products in the 1 year warranty period, we will offer free replacements for all quality problems, installation problems and missing parts problems.

**Service Guarantee**  
All of our items are brand new and in excellent condition. In the event that the product you received does not meet this standard, please contact us.

**Sincerely At Your Service**  
Your shopping experience is very important to us! If you are unsatisfied with our service with purchases, please feel free to let us know. We will always be here to offer you the best service and get your satisfaction.

# Tripod Stand with Tip-Over Protection

## Owner s' Manual

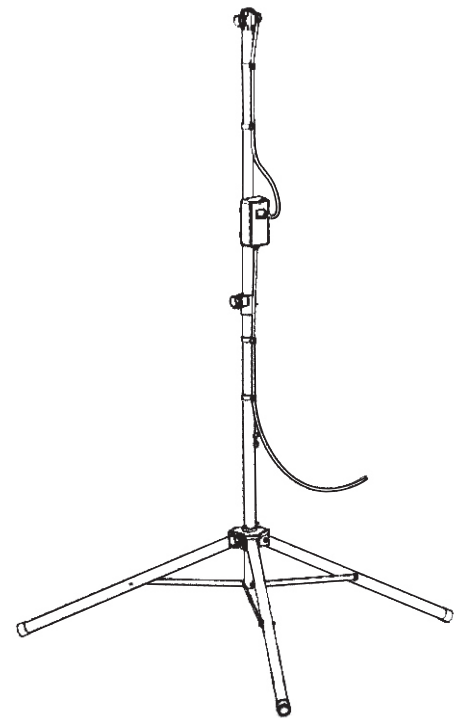

Recommended primary  
for sheltered EXTERNAL use  
Do not expose to rain or moisture

ASSEMBLY THE SOCKET WITH TIP-OVER PROTECTION ON THE TRIPOD STAND

1. Attached the Top fixing ring on the "socket position" label. Fasten 4 screws on two fixing rings. Make sure caution light is on the top.

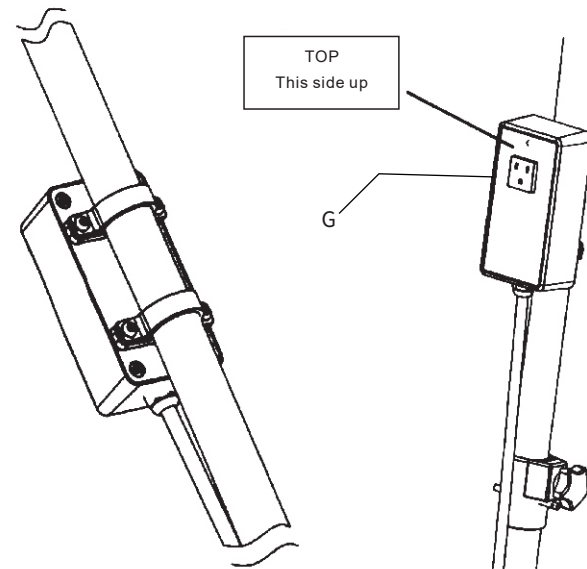
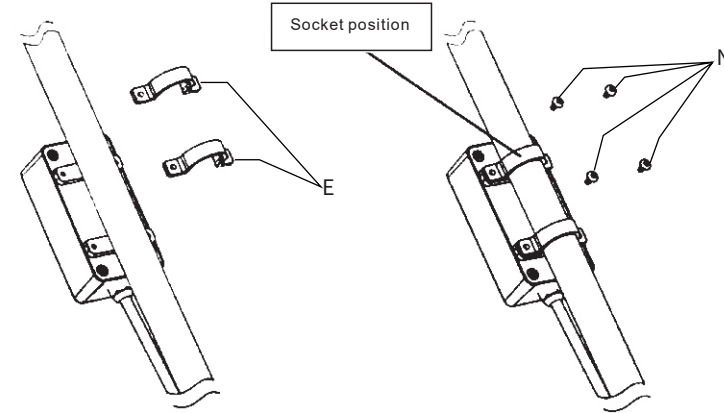

2. Fixing the power cord on the stand, Keep the distance at least 5.9in from the edge of heater



MAKE SURE THE POWER CORD NEVER TOUCH THE HEATER

3. Plug the heater plug in the socket, and then turn on the heater as heater manual.

THE CORD LENGTH OF SOCKET IS 13.1 ft

Noted: The socket has a tilt function. When the heater exceeds a 45° angle, it automatically stops working.

## Installation-Tripod Mount

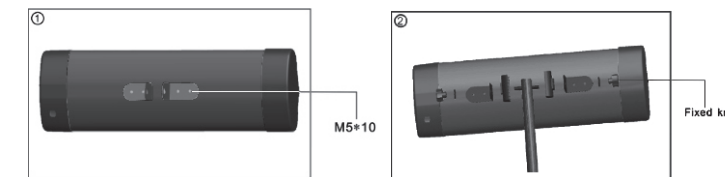

1. Install the product fixed bracket to the products, using four M5X10 screw fixed stent products.
2. Make the fixed knob on the pipe loosen, make the product holder according to the figure (2) sets on the pipe component

AFTER ASSEMBLY WELL THE HEATER AND STAND, ALSO PLEASE FOLLOW THE BELOW IMPORTANT STEPS.

3. Take out three empty drawstring bag on the box of stand.
4. Simply fill the each bag with 5kg/11lbs of sand, rock or dirt, then attach it to three legs of the stand

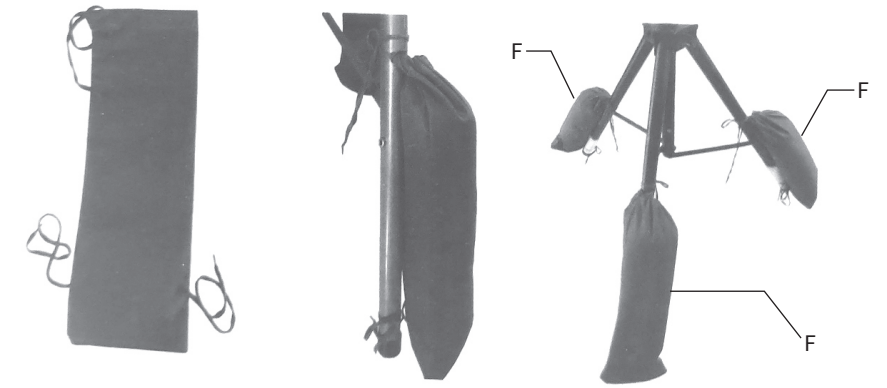

IMPORTANT-THREE BAGS WITH HEAVY ATTACHED TO THE STAND'S LEGS

THANK YOU FOR YOUR PURCHASE!  
OUR GOAL IS YOUR 100% SATISFACTION

**Our Warranty**  
For the products in the 1 year warranty period, we will offer free replacements for all quality problems, installation problems and missing parts problems.

**Service Guarantee**  
All of our items are brand new and in excellent condition. In the event that the product you received does not meet this standard, please contact us.

**Sincerely At Your Service**  
Your shopping experience is very important to us! If you are unsatisfied with our service with purchases, please feel free to let us know. We will always be here to offer you the best service and get your satisfaction.