

Power Lift Recliner Assembly Instructions

Estimated Assembly Time in Minutes

★ ☆ ☆
 <15 <45 60+

- Your recliner comes packaged in one box.
- **DO NOT** use any sharp objects to open plastic wrapped components as damage to product or components may result.
- Carefully remove all of the components from the packaging and set aside for assembly.
- Assemble on a soft surface to prevent scratching the finish.
- Zip ties are used to secure your recliner cords and avoid damage - do not cut.

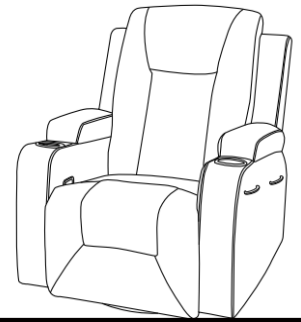

Parts List

A 1 x Back



B 1 x Seat



C 2 x Back Wings

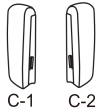

D 2 x Arm Pads



E 2 x Cup Holder



F 1 x Spring Coil Cushion



G 1 x Massor Remote

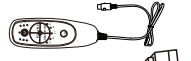

H 1 x Power Kit



I 1 x Motor Remote



Assembly

Step 1

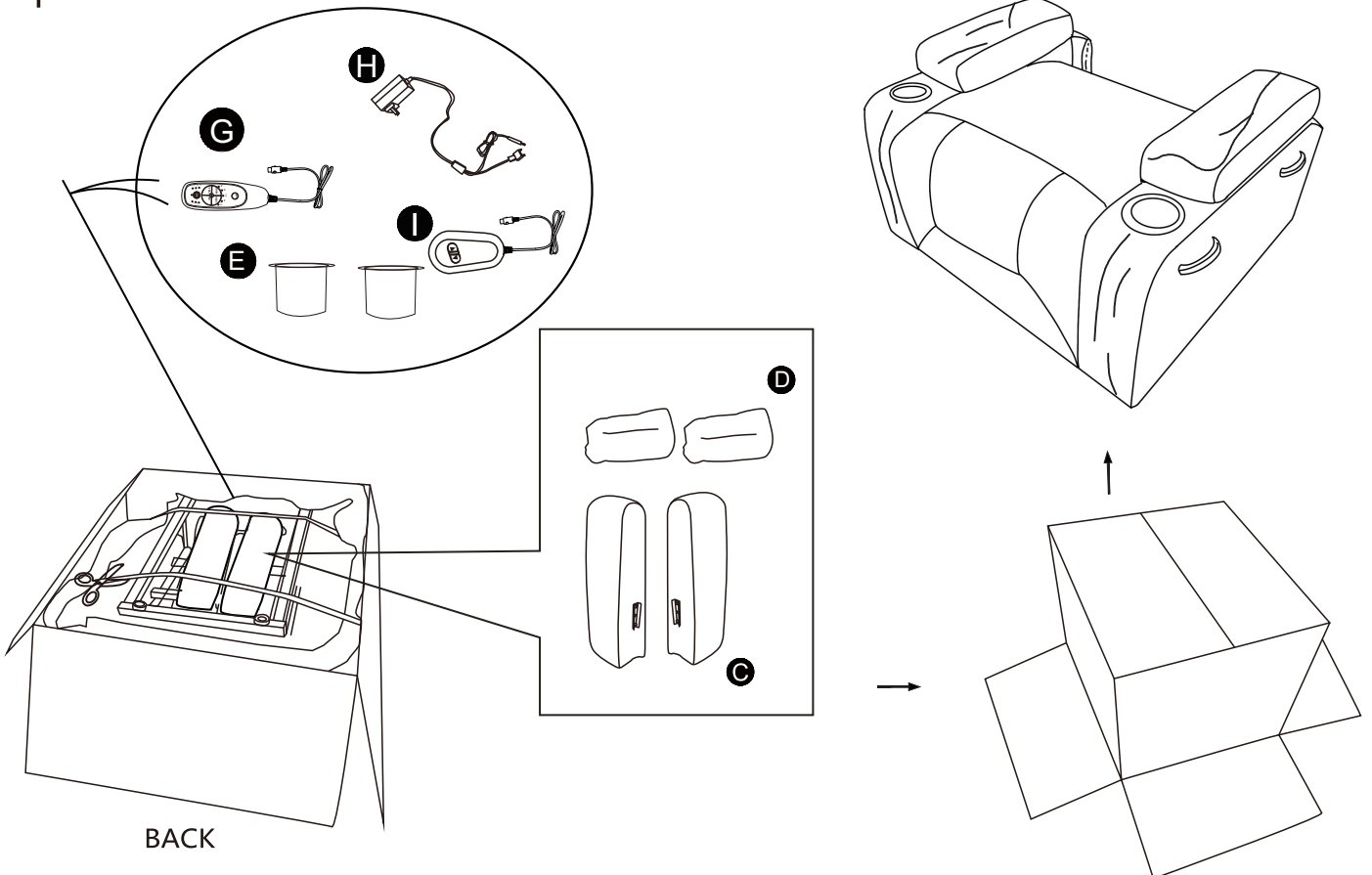

Assembly

Step 2

Pull hard

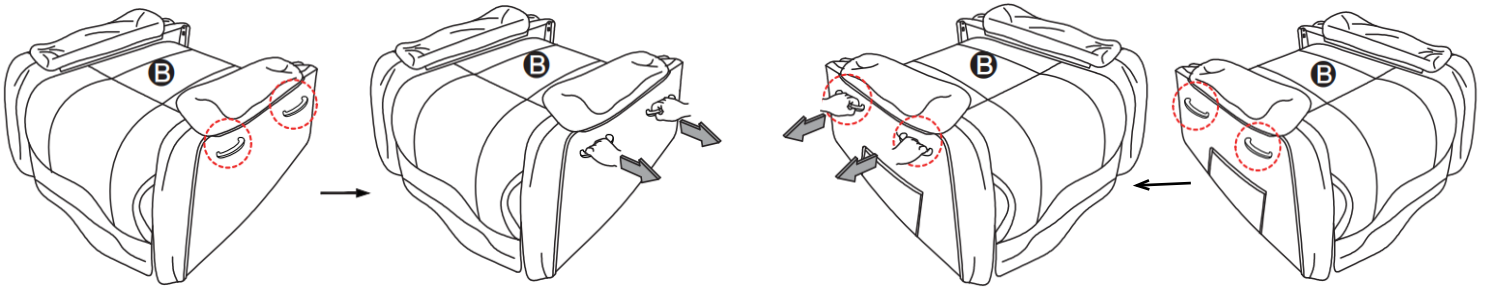

Hold the handle of the arm and pull hard to make it stretch out.

Step 3

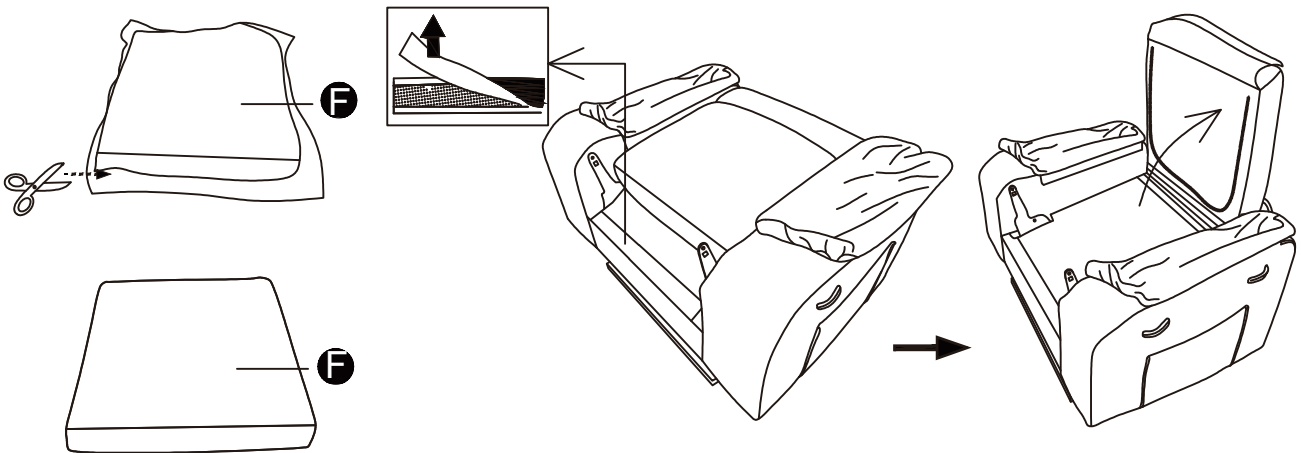

Step 4

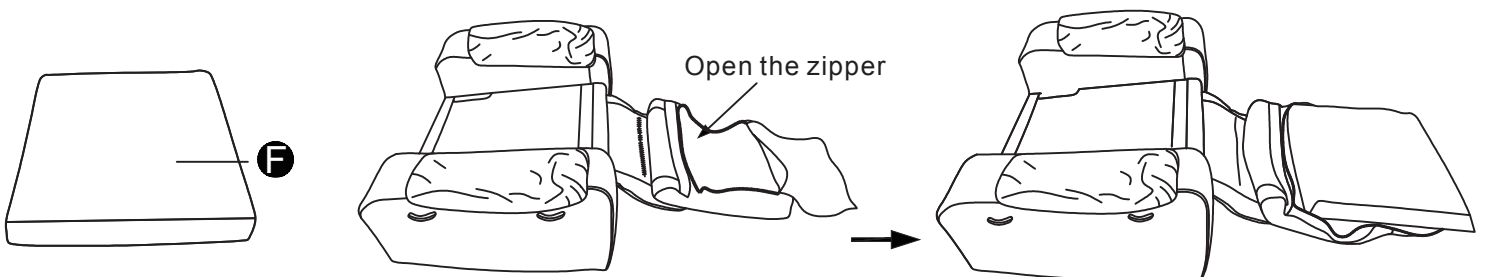

Put spring coil pad inside of the seat cushion cover and zipped.

Assembly

Step 5

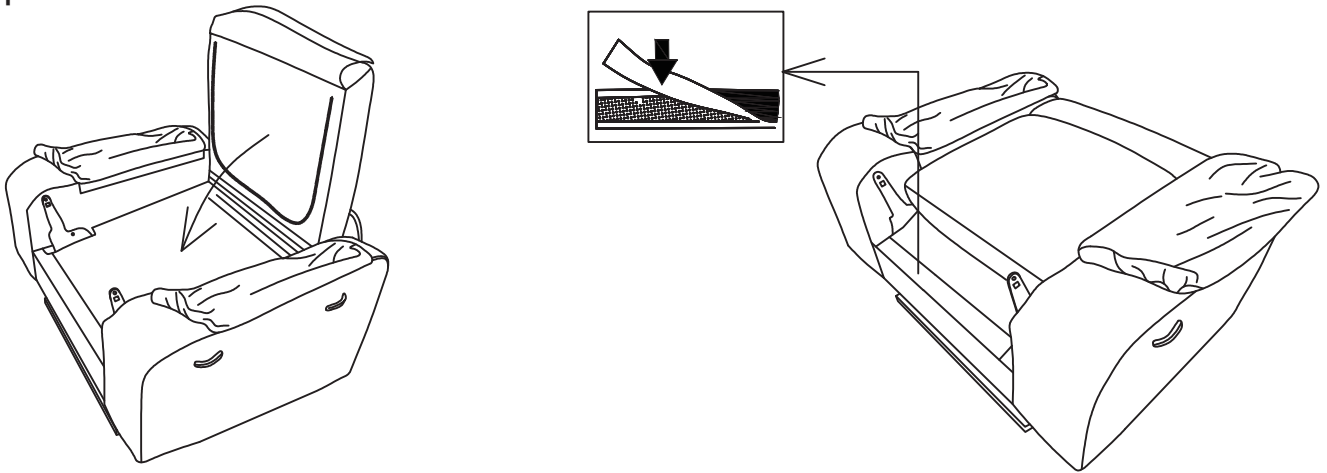

Then put the whole seat cushion on the center of seat base correctly and tighten the velcro.

Step 6

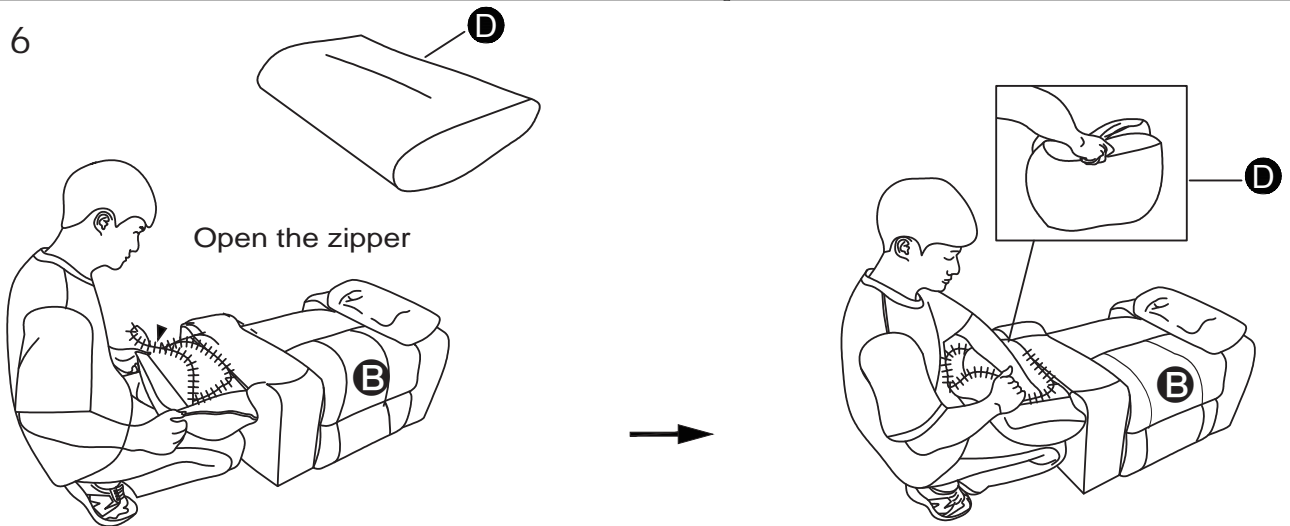

Open the zipper

Step 7

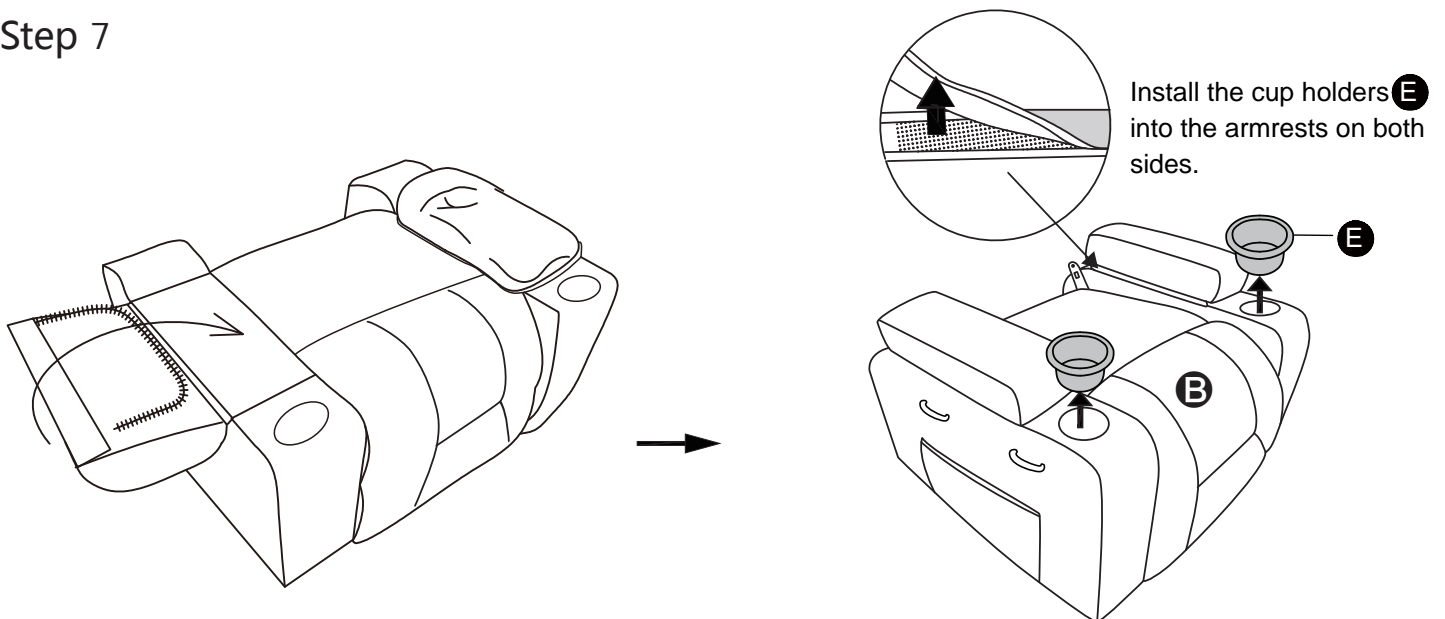

Install the cup holders **E** into the armrests on both sides.

Assembly

Step 8

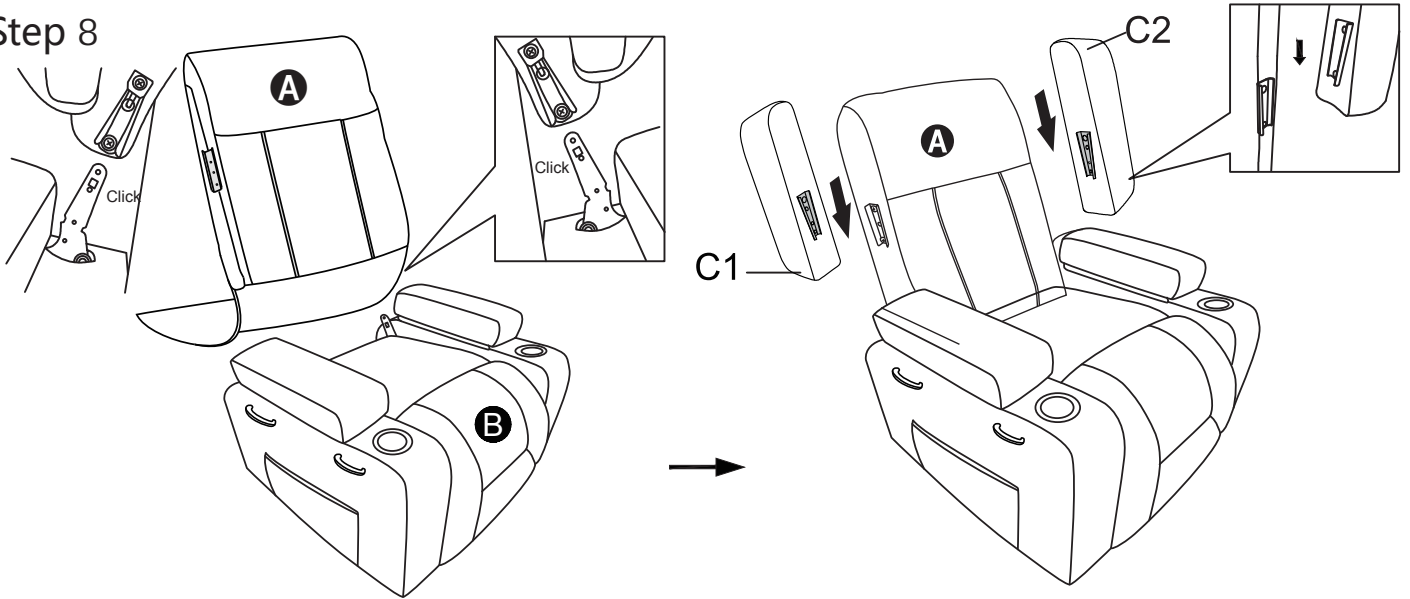

Step 9

The method of connecting the cables.

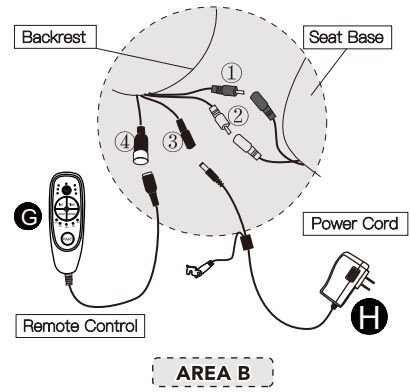
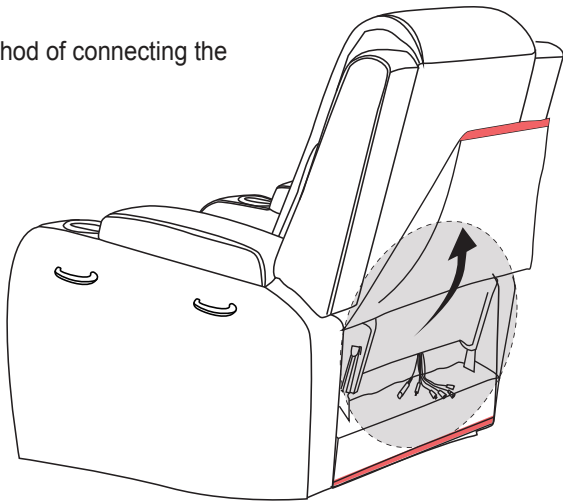

Connect ① ② with wires of same color from the seat base.

Connect ③ with Power cord **F** and ④ with Remote control **G**.

Step 10

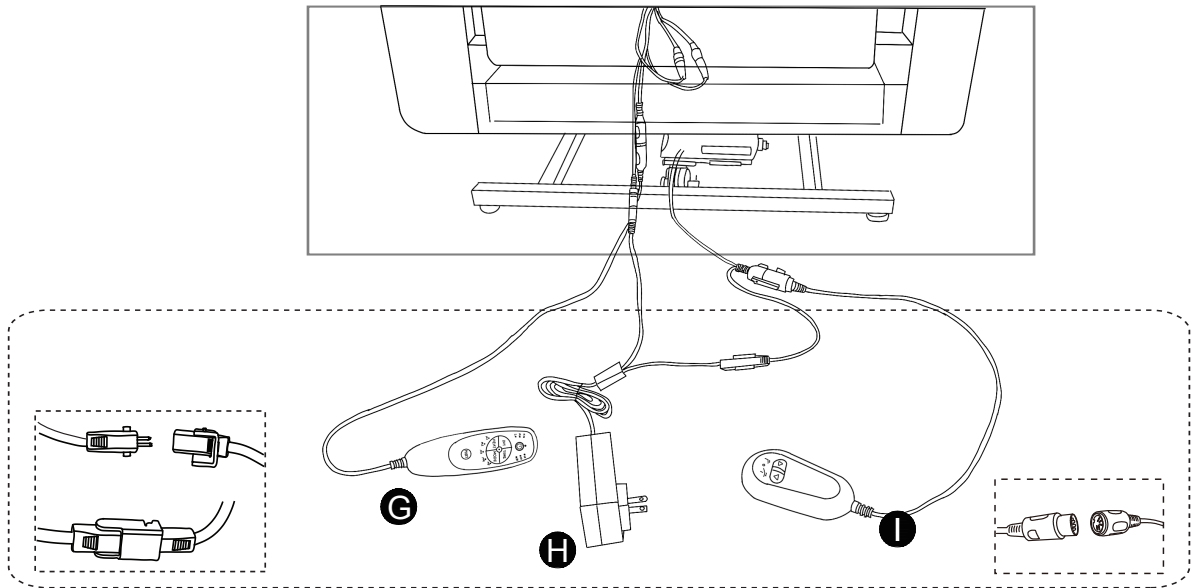

Assembly

Step 11

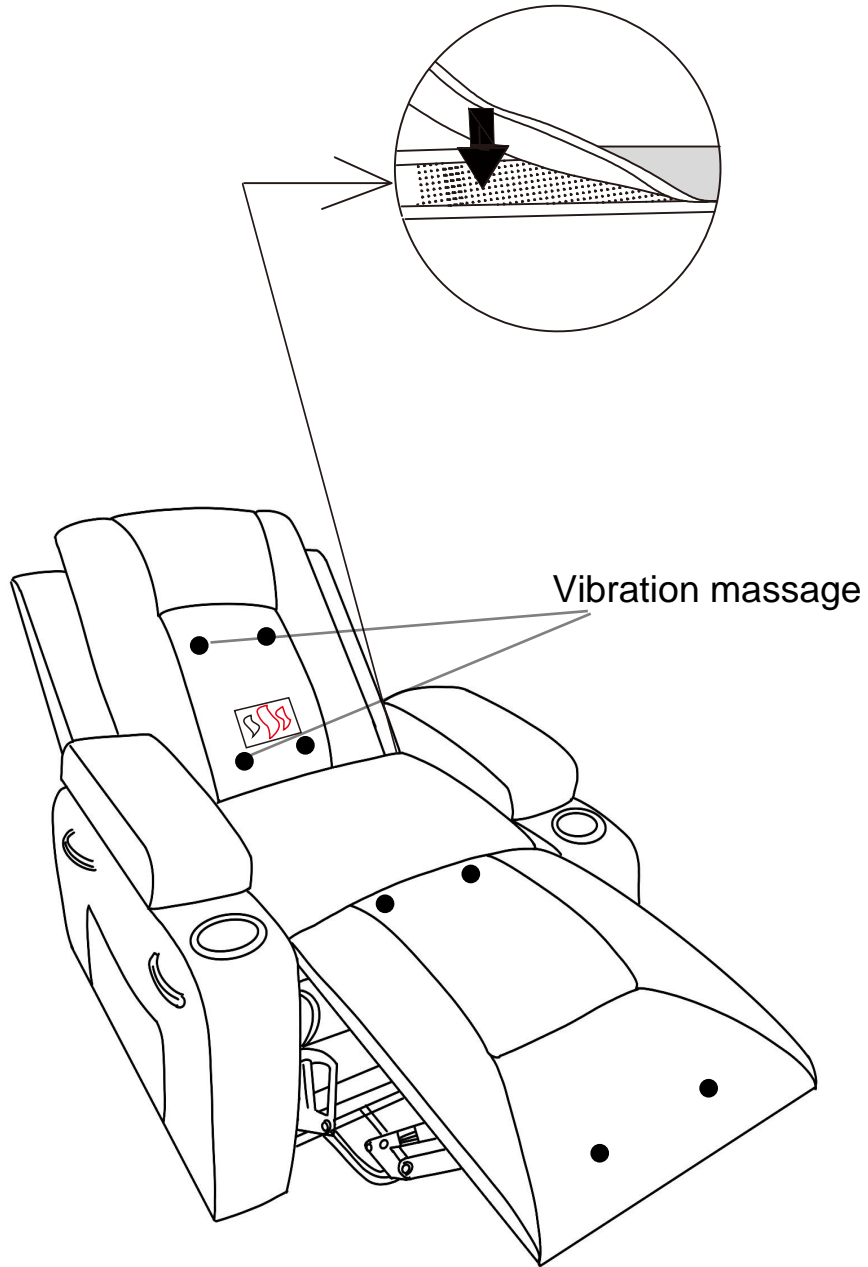
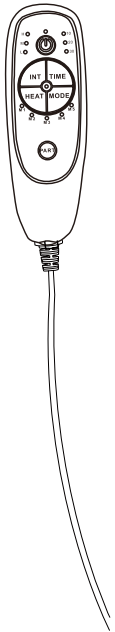

Vibration massage

Proper Usage

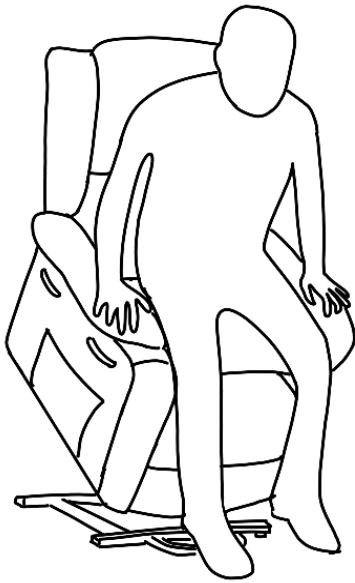

Steps to safely stand up from your Lift Recliner

1. Store remote safely in the recliner's side pocket
2. Plant feet firmly on the ground
3. Evenly distribute weight on both arms of the chair
4. Slowly stand up from lift position

*Remember to store remote safely in the recliner's side pocket when it is not in use

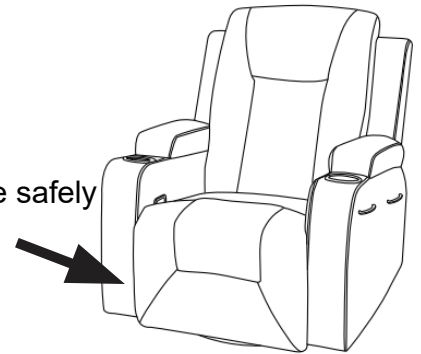

*Fabric will fade or discolor in direct sunlight. Minimize exposure to direct sunlight to extend the life of your furniture.

Improper Usage

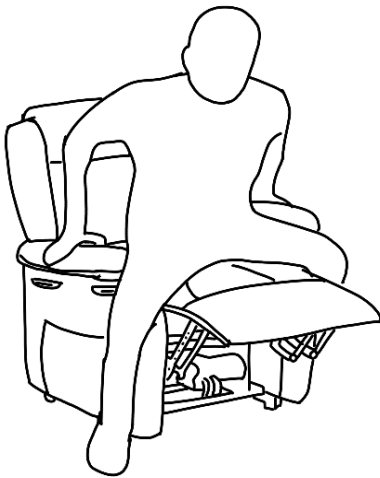

DO NOT stand up when the footrest is in the upright position

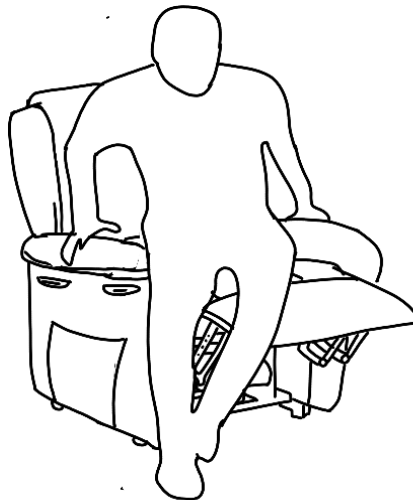

DO NOT stand up from your recliner with uneven weight



DO NOT stand up from your Lift Recliner with one arm

Your recliner style may differ from images.

About your furniture piece:

- Softening of foam is natural and will happen over time with use.
- Fabric will fade or discolor in direct sunlight. Minimize exposure to direct sunlight to extend the life of your furniture.
- Wood grain, knots, streaks, and color variation occur naturally in wood and are not considered defects.

CAUTION: Tighten all components securely before use. Failure to do so may result in personal injury.