

PART LIST

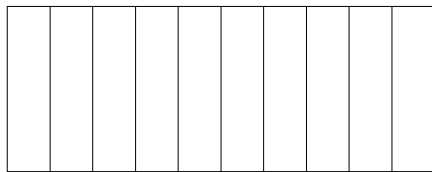

① x 1pc



② x 1pc

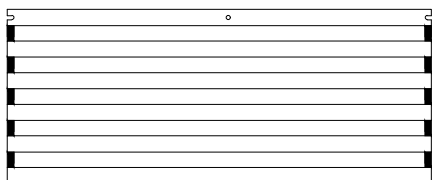

③ x 1pc

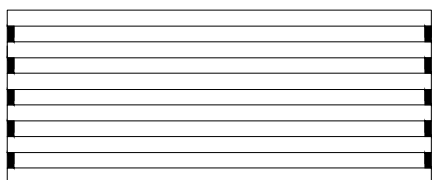

④ x 1pc



⑤-1 x 1pc



⑤-2 x 1pc



⑥-1 x 1pc

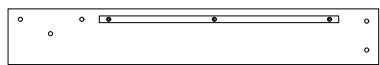

⑥-2 x 1pc

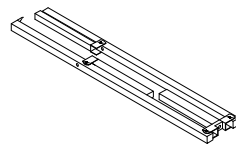

⑦ x 1pc

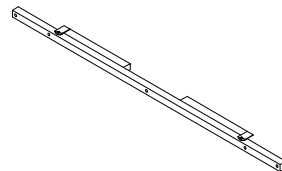

⑧ x 1pc

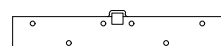

⑨ x 2pcs



⑩ x 2pcs

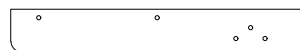

⑪ x 1pc



⑫ x 1pc

HARDWARE LIST



H1 M5 x 1pc



H2 M8x20mm x 9pcs



H3 M8x35mm x 7pcs



H4 M8x40mm x 22pcs



H5 M8 x 29pcs



H6 M8x17mm x 31pcs



H7 M8x22mm x 10pcs



H8 M8x60mm x 1pc



H9 M8x50mm x 2pcs

1 **NOTE:** PLEASE OPEN THE ZIPPER ON THE BACK OF **1** AND TAKE OUT THE PARTS.

Open the zipper

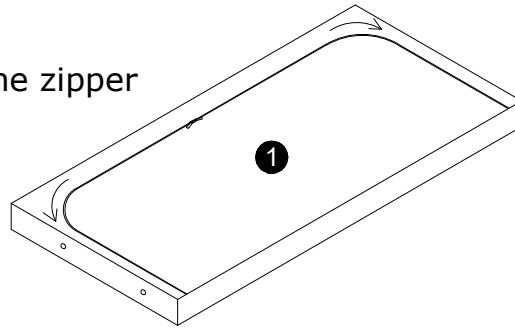

2

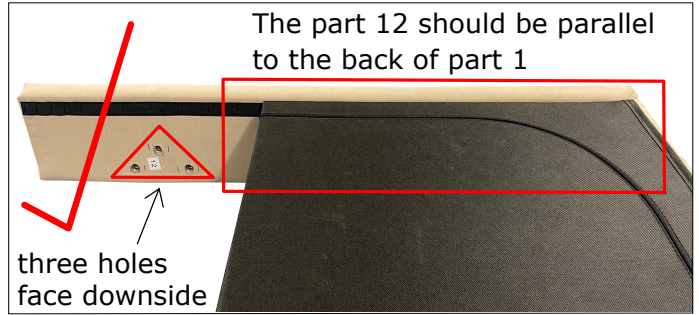

The part 12 should be parallel to the back of part 1

three holes face downside

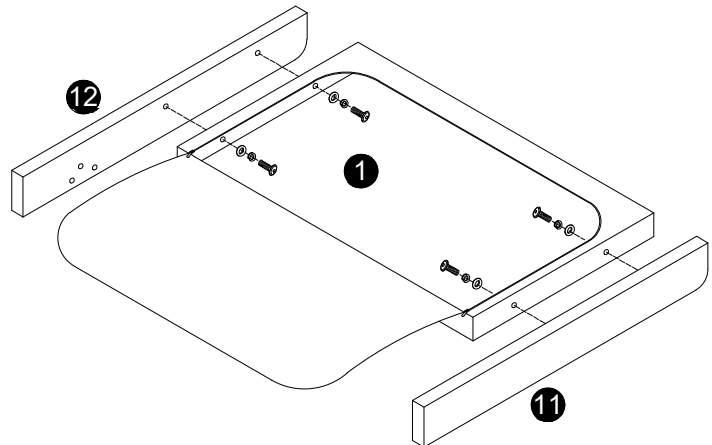
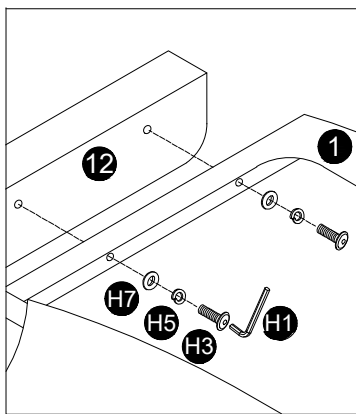

3

Important: part **9** , following the "INNER"

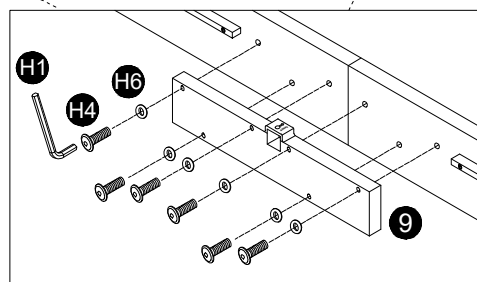
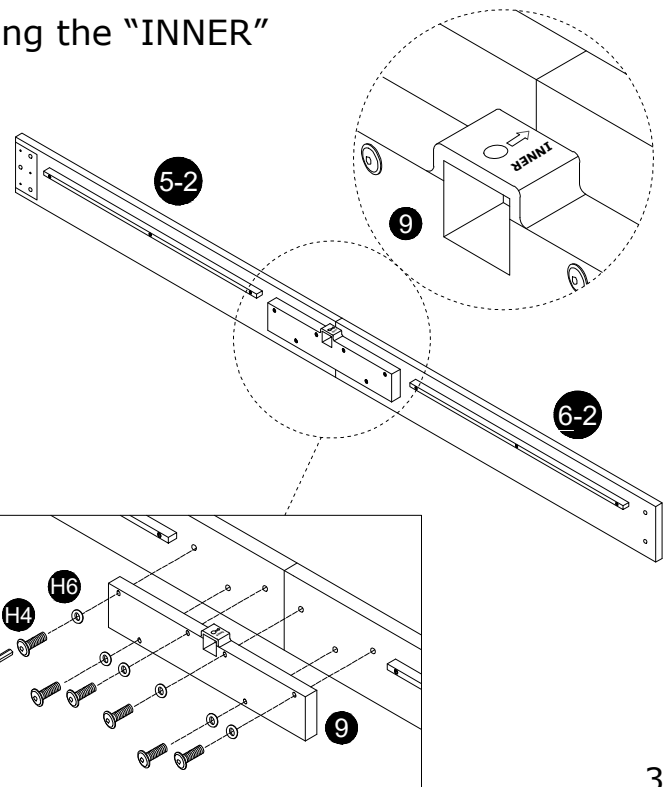
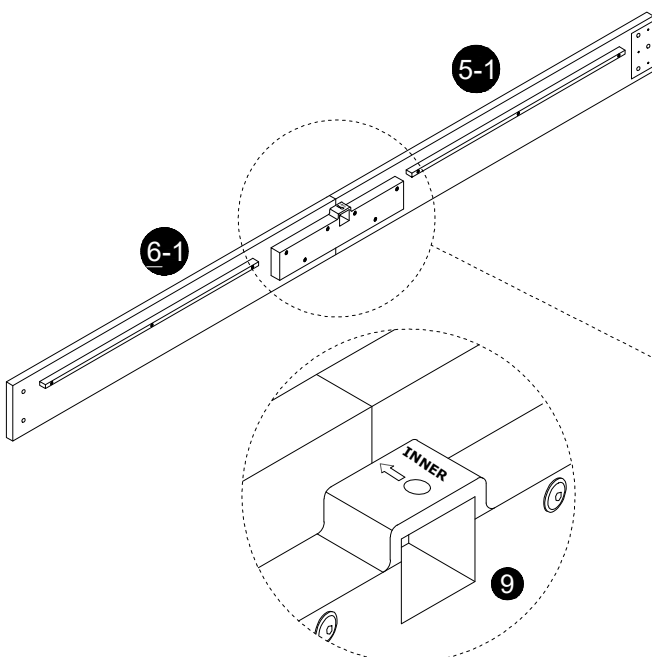

4

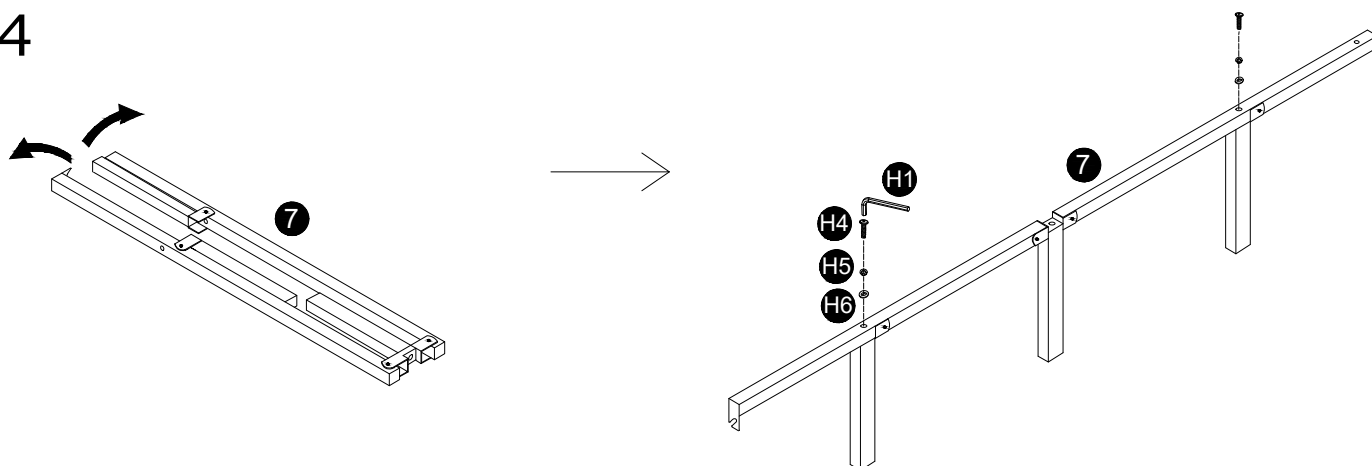

5

BEWARE OF CLAMP HAND

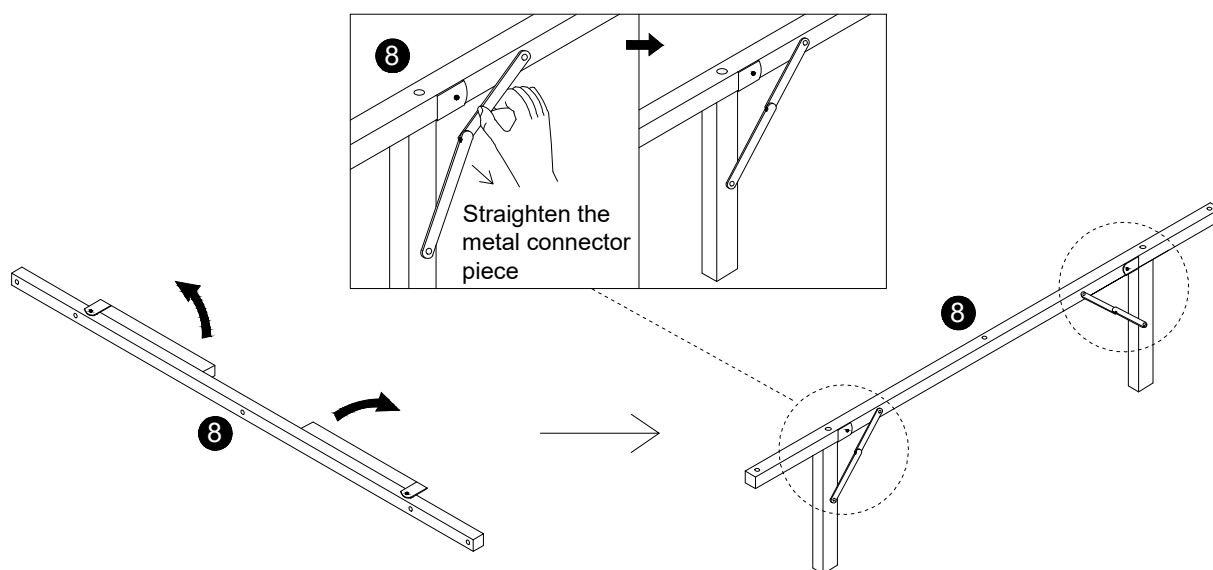

6

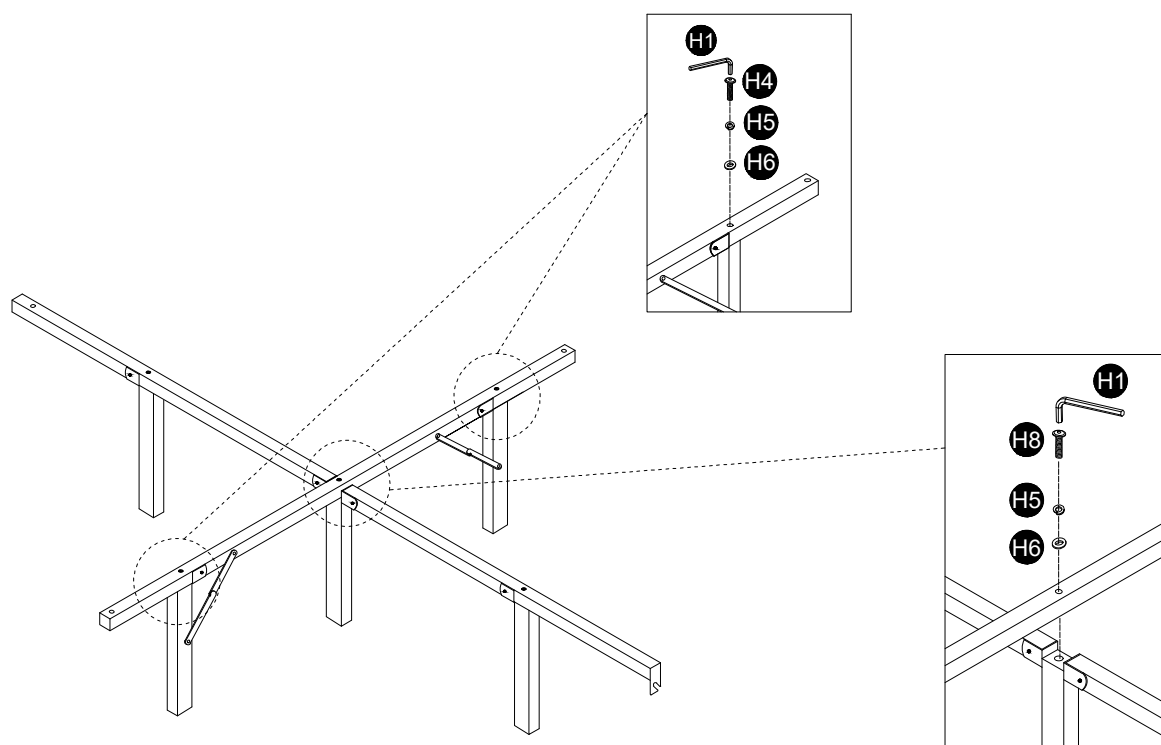

7

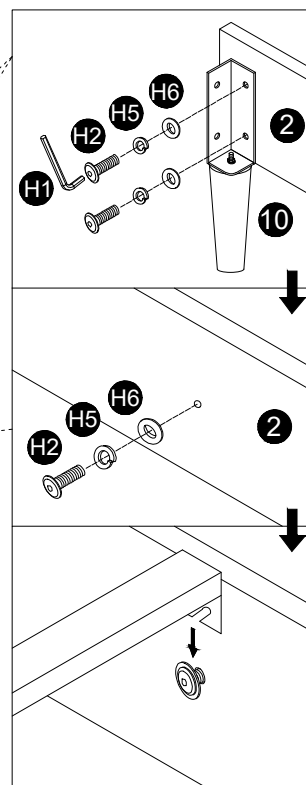
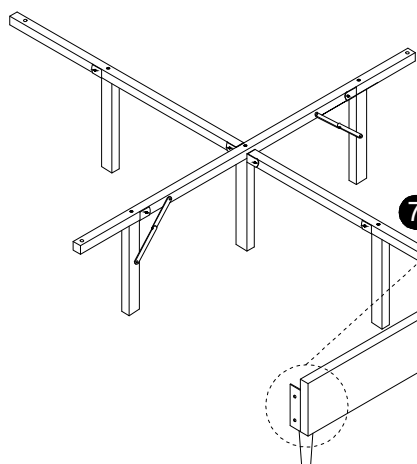

Do not fully tighten fixings!

8

If can't assembly, checking STEP 3 if wrong

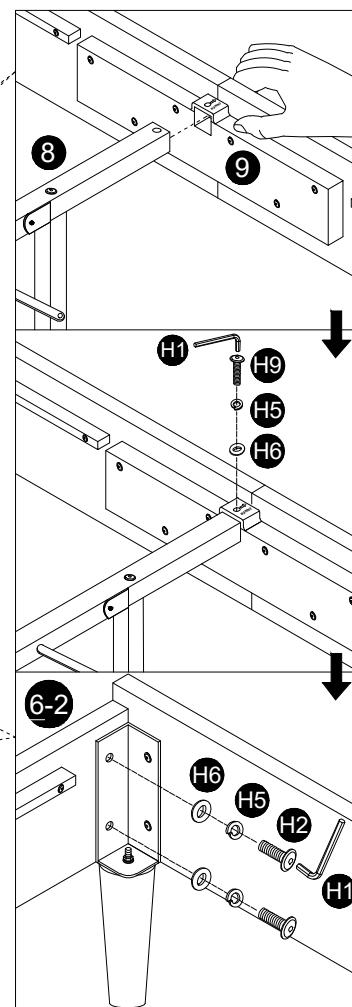
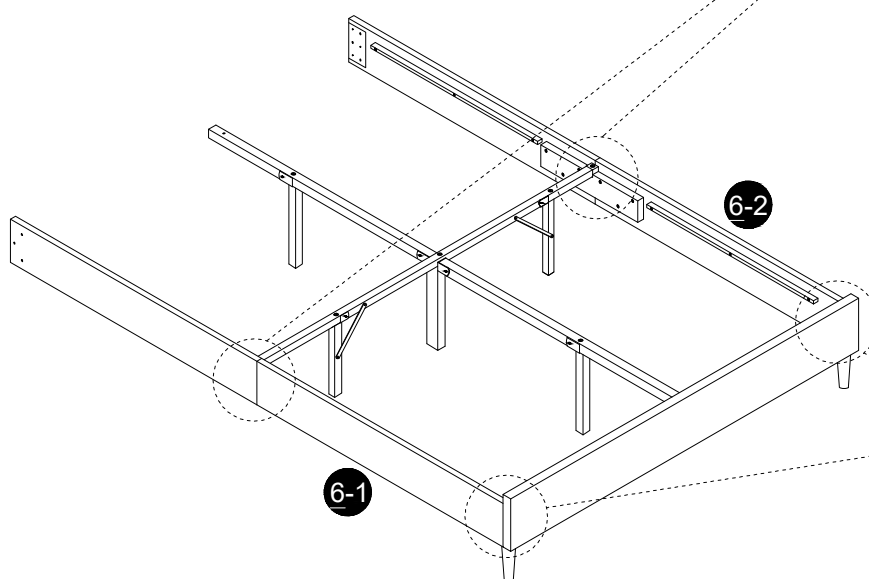

Do not fully tighten fixings!

9

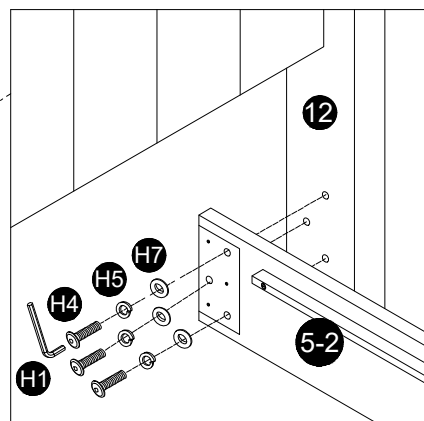
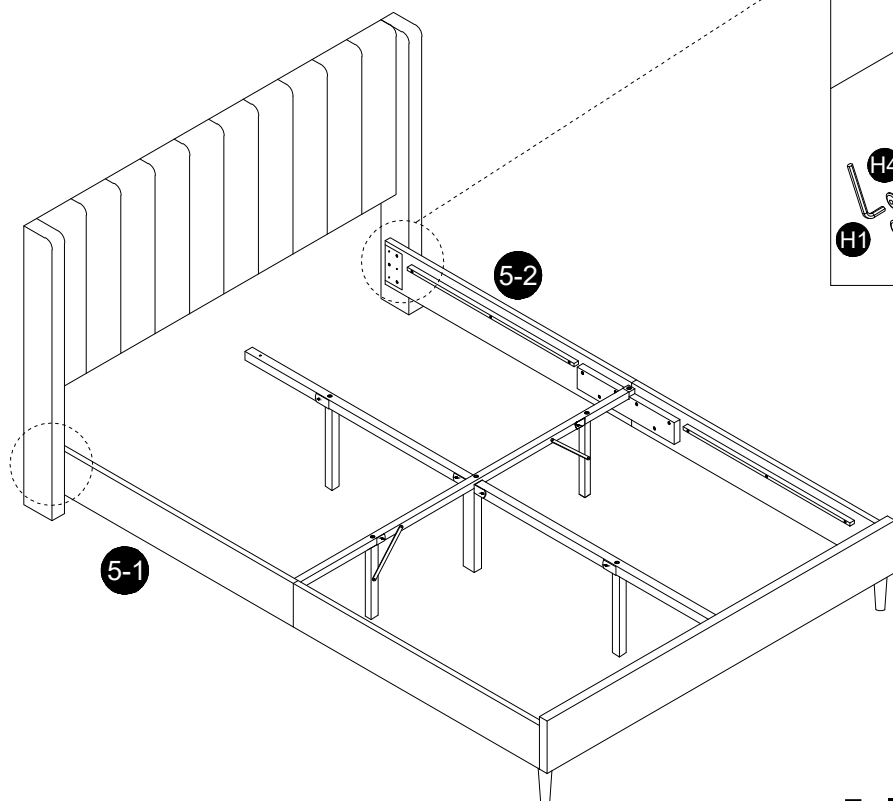

Fully tighten all fixings.

10

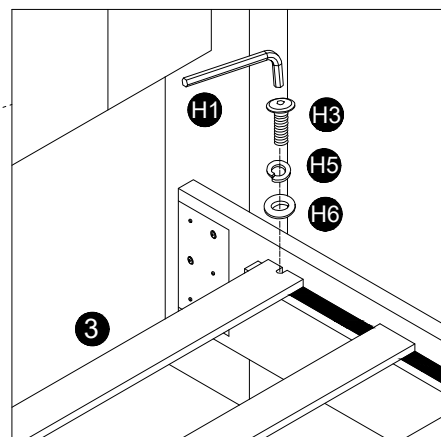
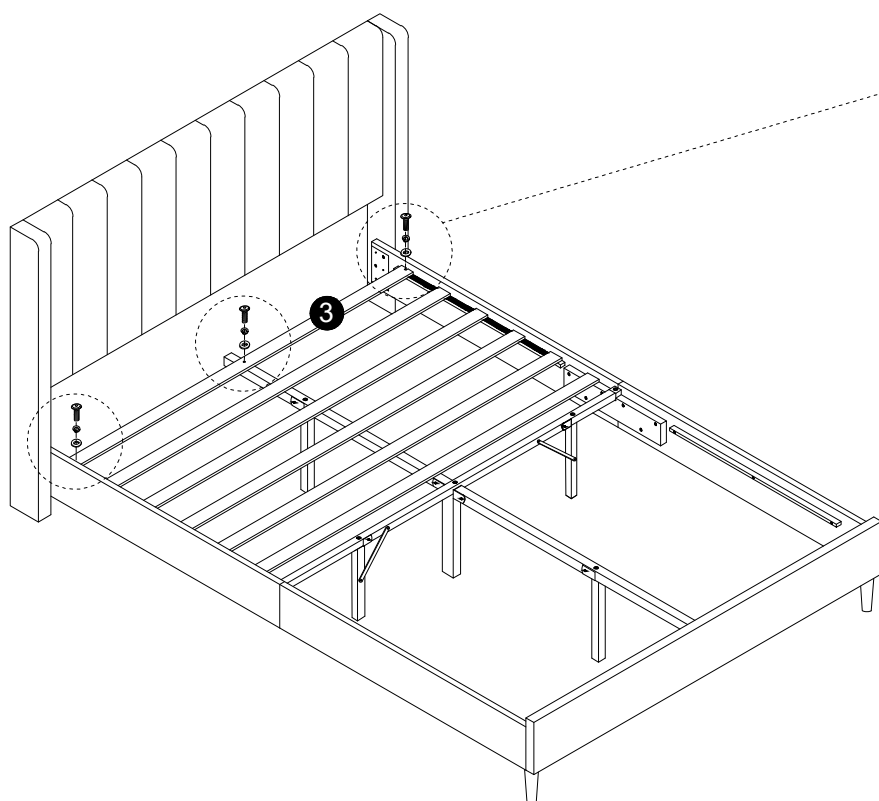

11

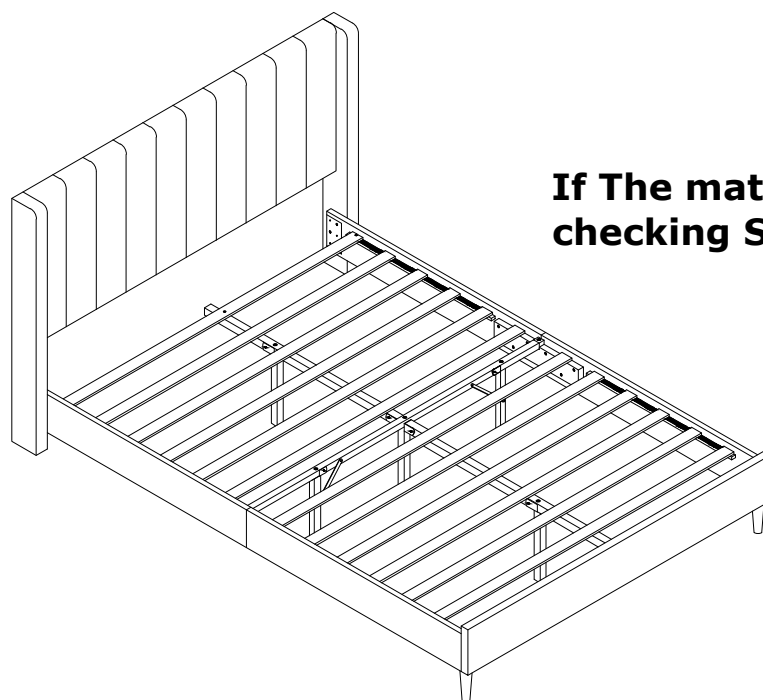
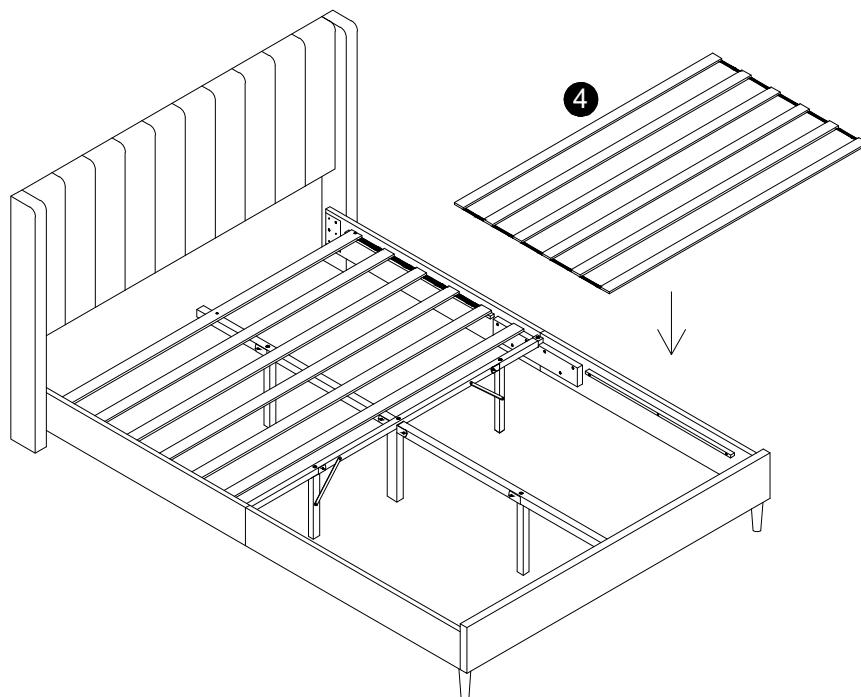

**If The mattress doesn't fit in,
checking STEP 2 if wrong**

Job Complete !

In the interest of our environment please dispose of all packaging thoughtfully.