

# 5 Level Steel Shelving Assembly

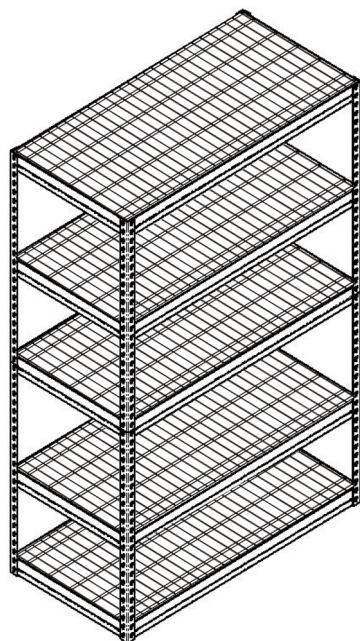

① Post

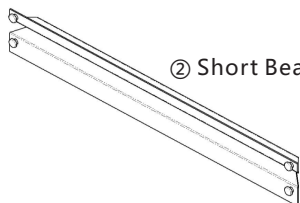

② Short Beam

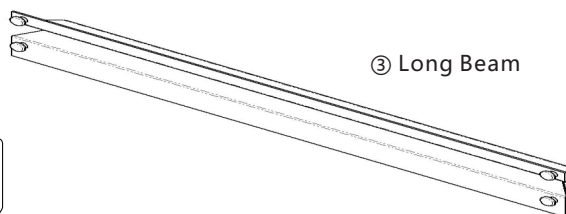

③ Long Beam



④ Post Coupler



⑤ Post Cap

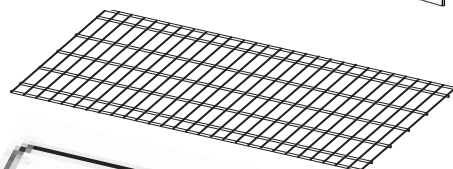

⑥ Wire or PB Deck

## Steel Shelving

Description	Qty	
· post	8	
· short beam	10	
· long beam	10	
· post coupler	4	
· post/ floor cap	8	
· wire/ wood deck	5	

## Safety Instructions

- These units should be placed on a level surface. Failure to do so can result in poor product performance or create a possible safety hazard.
- Do not stand on any part of the unit, or use it as a ladder
- Evenly distribute the weight on each level and always keep the heavier loads on the bottom.
- Do not place objects on the shelf with force. Doing so may cause the product to break and cause injury or other damage
- Do not use this unit for anything other than the manufactures intended purpose.
- A rubber hammer may be used on the beams to seat the rivets properly
- Use care when working with metal parts.

Should you have any comments, damage, missing parts, or problems with assembly of this unit please feel free to contact our customer service

MONDAY - FRIDAY 8:00 AM - 5:00PM CST

WEBSITE: [WWW.BANDBGOODSINC.COM](http://WWW.BANDBGOODSINC.COM)

EMAIL: [HELP@BANDBGOODSINC.COM](mailto:HELP@BANDBGOODSINC.COM)

To better assist you please have the following information available: model number, UPC or a description.

Scan for Video  
of Assembly



# Assembly Instruction

- Please assemble the shelf with care by two or more adults.
- Please assemble the shelf on a flat surface and lay out cardboard or similar material so as not to scratch the floor or other surfaces
- Please install the parts correctly.

When assembling, please pay attention to the orientation of each part.

- 1** Install the post coupler④ on the post①, install the post cap⑤ on the upper and lower portions and tap it with a rubber hammer to secure it firmly in place.(X4)

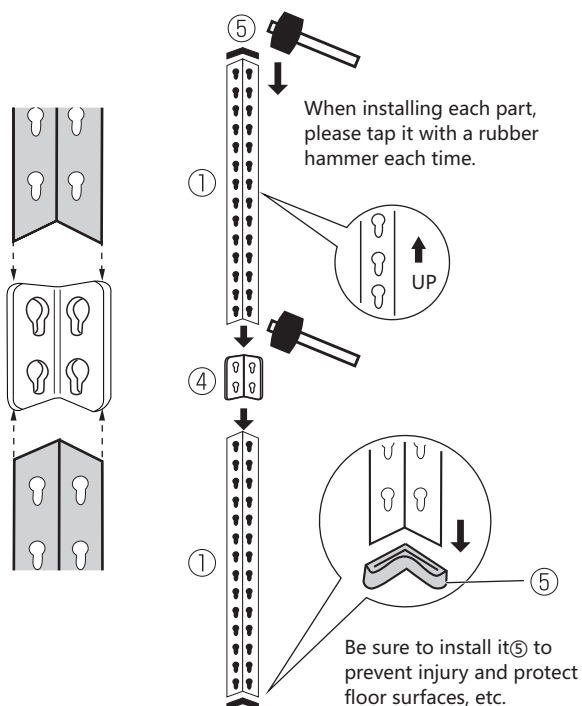

- 2** Insert the rivets of the beams②③ in the hole of the post①, tap it with a rubber hammer and fix it with force

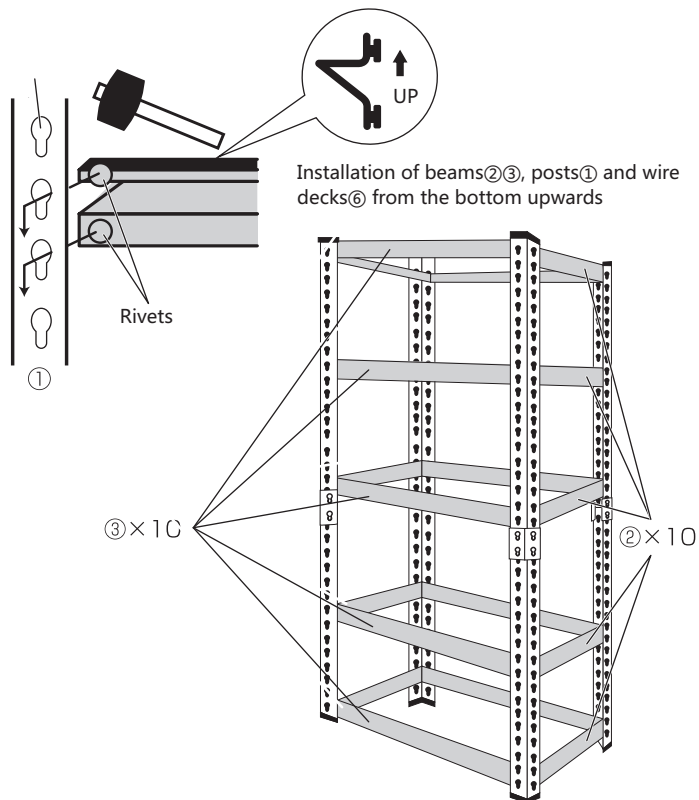

- 3** Place wire decks on the shelf supports of the long beams and short beams.

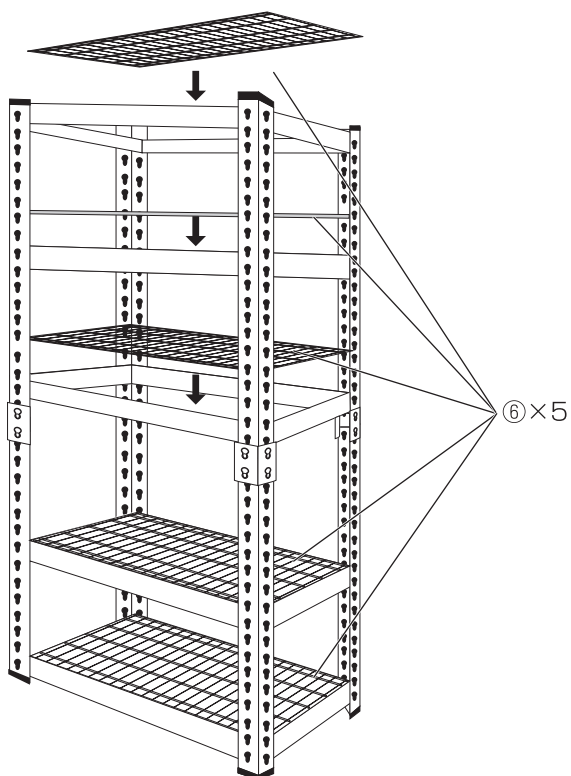

- 4**

The height can be adjusted according to the position where the beam is placed.

Can also be used in 2 parts without post coupler.

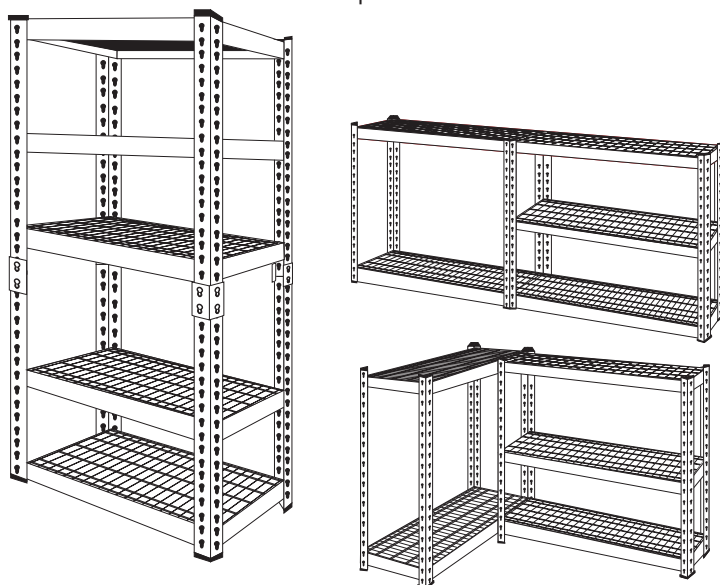

After assembly, check that the whole product is not distorted or twisted.