

Failure to return this card will not diminish your warranty rights.

Copyright © 2011 All Rights Reserved

Please seal with tape. Do not staple.

FOLD LINE
Seal with tape, DO NOT STAPLE

TAPE HERE

Please do not send products and other correspondence to this address

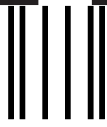

BUSINESS REPLY MAIL
FIRST-CLASS MAIL PERMIT NO. 828 DENVER, CO

POSTAGE WILL BE PAID BY ADDRESSEE

TAPE HERE

NO POSTAGE
NECESSARY
IF MAILED
IN THE
UNITED STATES

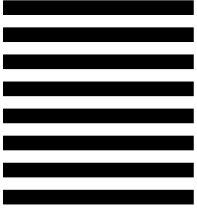

CUT LINE

PLEASE RETAIN THIS FOR YOUR RECORDS
You may need to refer to this information in case of warranty claim or for insurance purposes.

Date Purchased: _____

Store Name: _____

Model #: _____

Product Description: _____

FOLD LINE



Failure to return this card will not diminish your warranty rights.

▲ When folded this is the
OUTSIDE FLAP

We want to hear from you . . .

YOUR PARTICIPATION IS GREATLY APPRECIATED
Thank you for choosing us and for taking the time to register your product. Your participation will help us better serve you in the future.

1. Product Numbers. You can use this form to register multiple products at one time.

Product Model Number	<input type="text"/>
Lot Code Number	<input type="text"/>
Product Model Number	<input type="text"/>
Lot Code Number	<input type="text"/>
Product Model Number	<input type="text"/>
Lot Code Number	<input type="text"/>
Product Model Number	<input type="text"/>
Lot Code Number	<input type="text"/>
Product Model Number	<input type="text"/>
Lot Code Number	<input type="text"/>

2. Contact Information.

Mr. Mrs. Ms.

First Name	Initial	Last Name
<input type="text"/>	<input type="text"/>	<input type="text"/>
E-mail		
<input type="text"/>		
Street Address	Apt. No.	
<input type="text"/>	<input type="text"/>	
City	State/Province	ZIP Code
<input type="text"/>	<input type="text"/>	<input type="text"/>

Please take the time to answer these two brief survey questions.

- 3. What three (3) factors most influenced your furniture purchase?**
- 1) Quality
 - 2) Durability
 - 3) Affordability (lower price)
 - 4) Value for price
 - 5) Work surface size
 - 6) Storage space
 - 7) Product layout in your space
 - 8) Style/aesthetics
 - 9) Color/finish
 - 10) Warranty
 - 11) Brand name
 - 12) Product was in stock
 - 13) Fast delivery
 - 14) Ease of assembly
 - 15) Ease of transport
 - 16) Customer service support
 - 17) Space Planning service
 - 18) Delivery and installation service
 - 19) Other
- 4. What was the main reason for this purchase?**
- 1) Old furniture needed to be replaced
 - 2) New space/location
 - 3) New business
 - 4) Expanding business (new employees)
 - 5) New space plan to improve productivity
 - 6) Remodeling/redecorating
 - 7) Bought a new TV

I do not want to receive coupons, mailings, or other special offers.

Take advantage of these benefits. Register today!

- Expert customer service
- Exclusive product offers and special promotions
- Guaranteed replacement parts

SAVE TIME!
REGISTER ONLINE.

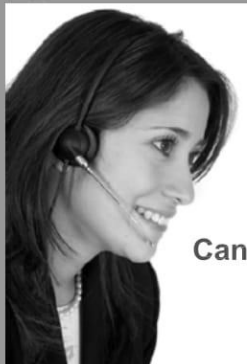

Can we help you ?

Difference

- QUALITY
- INNOVATION
- SERVICE
- VALUE

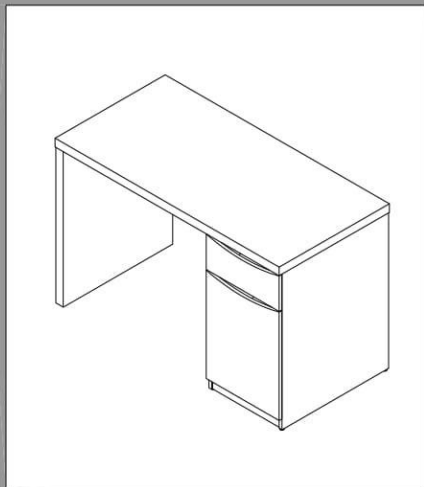

Thank you for purchasing this product.
We trust that you will be completely satisfied with your product for many years to come.

Merci d'avoir acheté ce produit .
Nous sommes sûr que vous serez complètement satisfait de votre meuble pendant de nombreuses années.

Gracias por comprar este producto de .
Confiamos que usted estará completamente satisfecho con su mueble por muchos años.

IT'S AS EASY AS 1,2,3

Assembly tips:

1. Read the instructions and become familiar with the parts.
2. Ensure this carton contains all parts, fasteners and hardware.
3. To protect floors, assemble the furniture on the carton.
4. An assistant may be helpful.
5. Use of power tools is not recommended.

Conseils d'assemblage:

1. Lisez les instructions et familiarisez-vous avec les pièces.
2. Assurez-vous que le carton contient toutes les pièces, toutes les pièces de fixation et toute la quincaillerie.
3. Pour protéger vos sols, assemblez le meuble sur le carton.
4. Il peut être utile de vous faire aider.
5. L'utilisation d'outils électriques n'est pas recommandée.

Consejos de Ensamblaje:

1. Lea las instrucciones y familiarícese con las partes.
2. Asegúrese de que esta caja contenga todas las piezas, los sujetadores y el equipo.
3. Para proteger el piso, ensamble el mueble en el carton.
4. Un asistente puede serle útil.
5. El uso de herramientas eléctricas no se recomienda.



CONSUMER SERVICE YOU CAN DEPEND ON

Questions? Operators are standing by at our TOLL-FREE help line to assist you with assembly; and, if necessary, to quickly replace damaged/missing parts. Simply have your store receipt, instruction manual, and part number/description ready when you call our TOLL -FREE help line. It's that easy.

UN SERVICE CLIENTELE SUR LEQUEL VOUS POUVEZ COMPTER
Des questions? Des opérateurs sont prêts sur notre ligne d'assistance GRATUITE pour vous aider à l'assemblage et, si nécessaire, remplacer rapidement les pièces endommagées/manquantes. Ayez simplement votre reçu de magasin, votre manuel d'instruction et le numéro de pièces/description à votre disposition lorsque vous appelez notre ligne d'assistance GRATUITE. C'est aussi simple que ça.

SERVICIO AL CONSUMIDOR CON EL QUE PUEDE CONTAR
¿Preguntas? Los operadores están listos para ayudarlo con el ensamblaje a través de una línea de ayuda GRATUITA, y en caso de ser necesario, reemplazar de inmediato las piezas dañadas o faltantes. Solamente tenga listos su recibo de compra, manual de indicaciones y número/descripción de la pieza al momento de llamarnos a la línea de ayuda GRATUITA, Es así de sencillo.

IMPORTANT SAFETY INFORMATION



WARNING

Do not move unit when loaded. Doing so could cause instability, product collapse, tip over, and/or serious injury.

No mueva la unidad cuando esté cargada. Hacerlo puede causar inestabilidad, que el producto se derrumbe, que se la caiga encima y/o heridas (golpes) serias.

Ne pas déplacer l'unité lorsqu'ell est chargée. Faire ainsi peut causer l'instabilité, l'effondrement ou le renversement du meuble et/ou des endommagements sérieux.



WARNING

This product is designed and intended for use with computer, fax, and printer equipment only. Improper loading with television or other heavy equipment could cause instability, tip over, and/or serious injury.

Este producto esta diseñado solamente para el uso con computadores, faxes, e impresoras. Inapropiado uso al poner televisores u otro equipo pesado puede causar inestabilidad, rodamiento, y/o herida (golpes) serios.

Ce produit est uniquement conçu pour une utilisation avec un ordinateur, un télécopieur, ou une imprimante. Un chargement incorrect avec une télévision ou autre matériel lourd peut le rendre instable ou le renverser, et peut vous causer des endommagements sérieux.

EXPLODED VIEW

A [1]
B [1]
C [1]
D [1]
E [1]
F [1]
G [1]
H [1]
I [1]

J [1]
K [1]
L [1]
M [1]
N [1]
O [1]

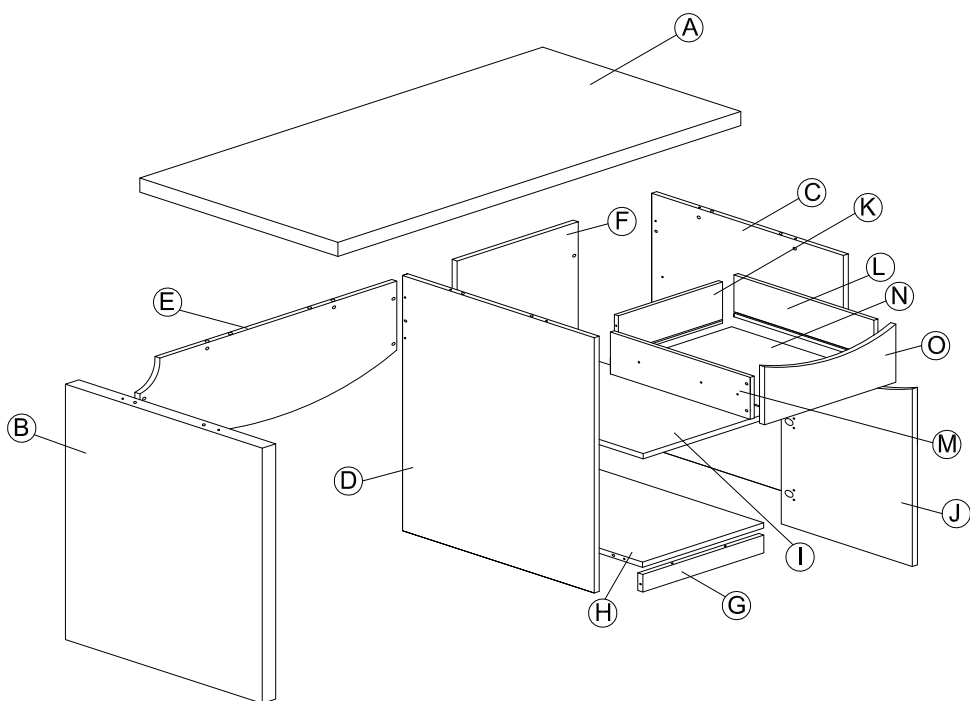
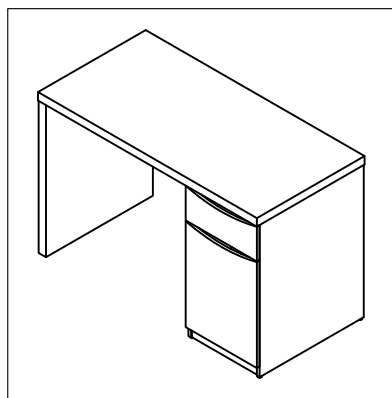

FASTENERS

Fasteners are shown in actual size.

Los fijadores son demostrados en su tamaño actual.

Les attaches sont montrées dans l'échelle grandeur.

H159917

Quantity
22

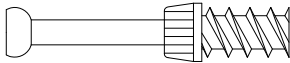

H159916

Quantity
22

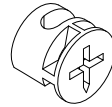

H35251

Quantity
4

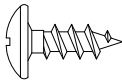

10 x 1/2"

H38169

Quantity
20



8x30mm

H101725

Quantity
18

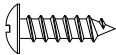

#6 x 1/2"

H167433

Quantity
4

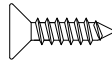

#6 x 9/16"

H160339

Quantity
6

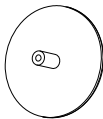

H167373

Quantity
2



H23198

Quantity
4

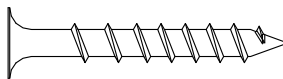

10 x 1-1/2"

HARDWARE

H156359

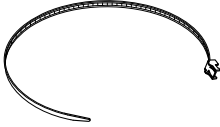

Quantity
2

H157328



Quantity
2

H166951



16"

Quantity
2

H23604

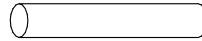

Quantity
4

H149989



Quantity
2

H126396



Quantity
4

H20385

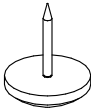

Quantity
6

H100445



Quantity
2

H170051

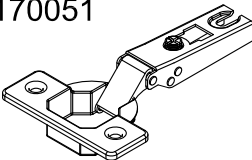

Quantity
2

H170050

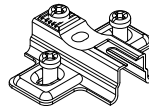

Quantity
2

Common assembly techniques.
Técnica común de ensamblaje.
Techniques communes d'assemblage.

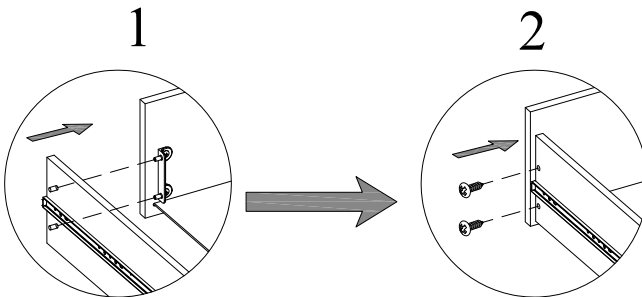
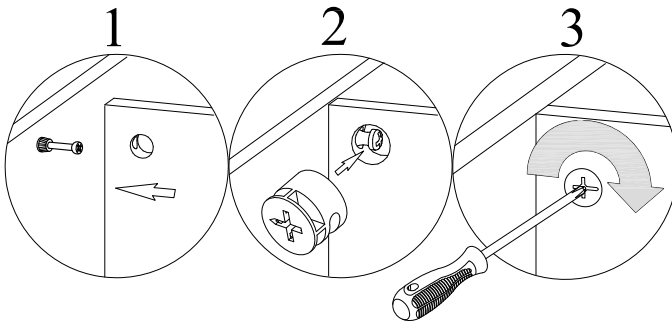
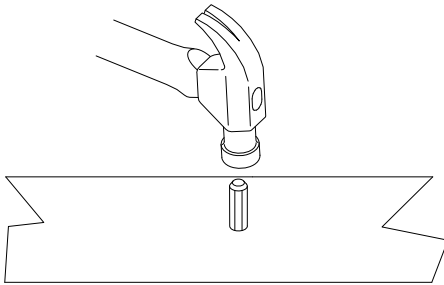

Common assembly techniques.
Técnica común de ensamblaje.
Techniques communes d'assemblage.

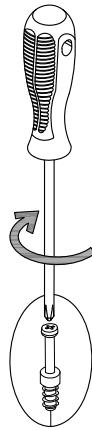
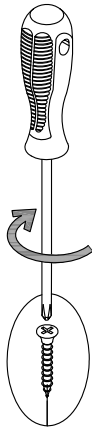

1

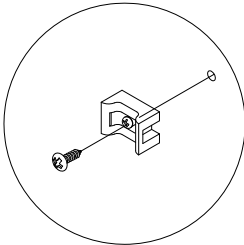

2

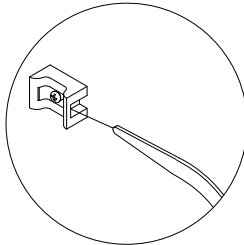

3

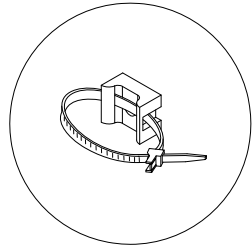

Common assembly techniques.
Técnica común de ensamblaje.
Techniques communes d'assemblage.

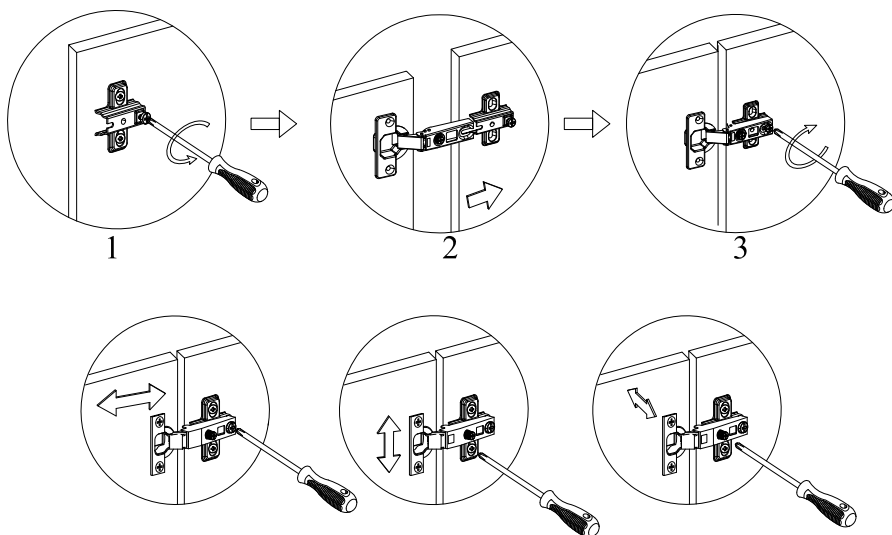

STEP 1

H170050



[2]

H159917

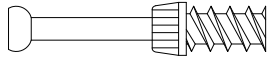

[5]

H101725



[3]

H38169

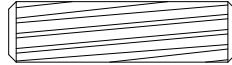

[2]

H20385



[2]

H166951



[1]

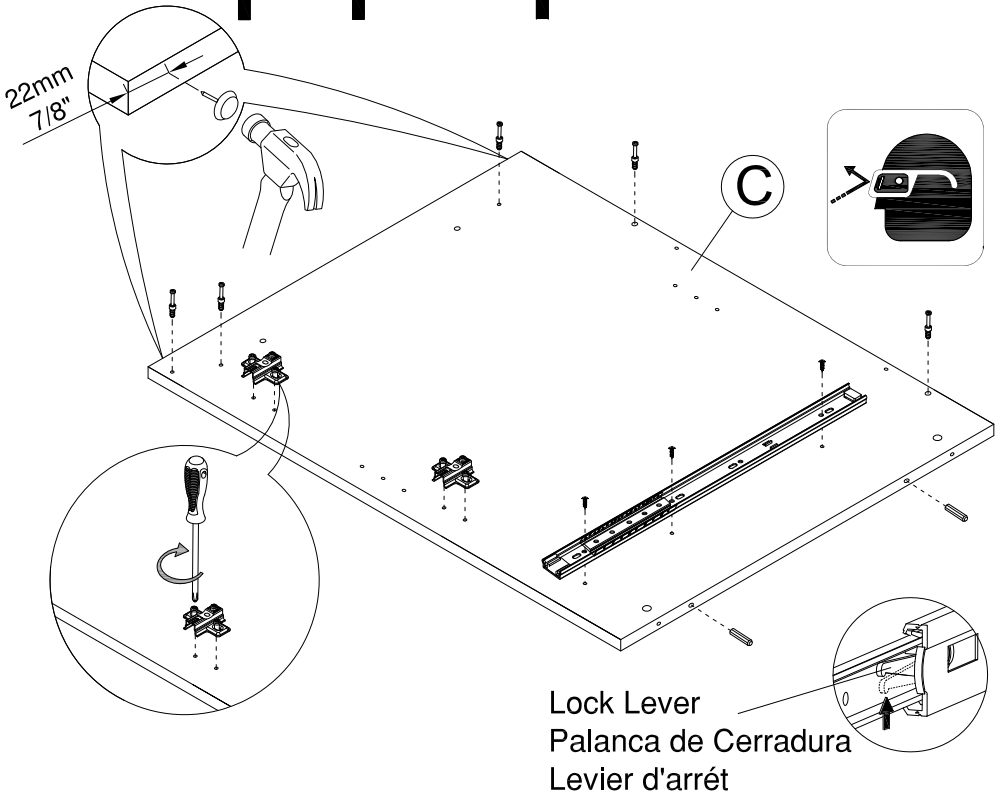

Move lock lever on the drawer runner as shown and separate drawer runner from drawer slide.
Mueva Palanca de la Cerradura en la corredera como se muestra y separe la corredera del deslizable.
Relever le Levier d'arrêt sur la coulisse pour tiror et séparez le coulisseau de la coulisse tel que montré.

STEP 2

H38169



[10]

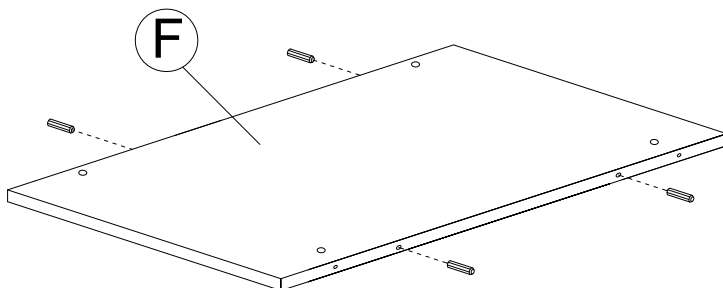
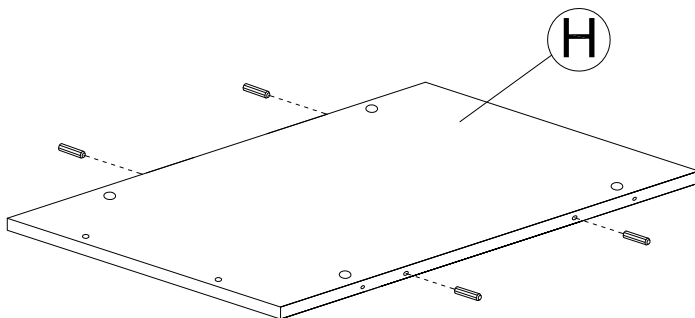
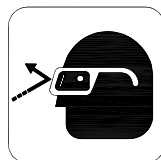
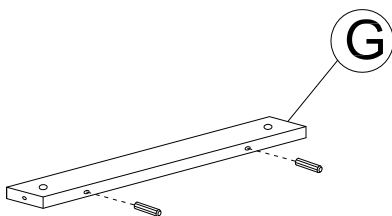

STEP 3

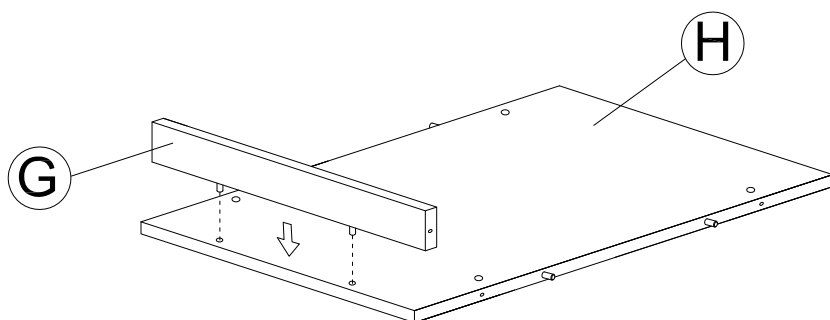

STEP 4

H159916

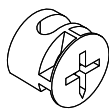

[3]

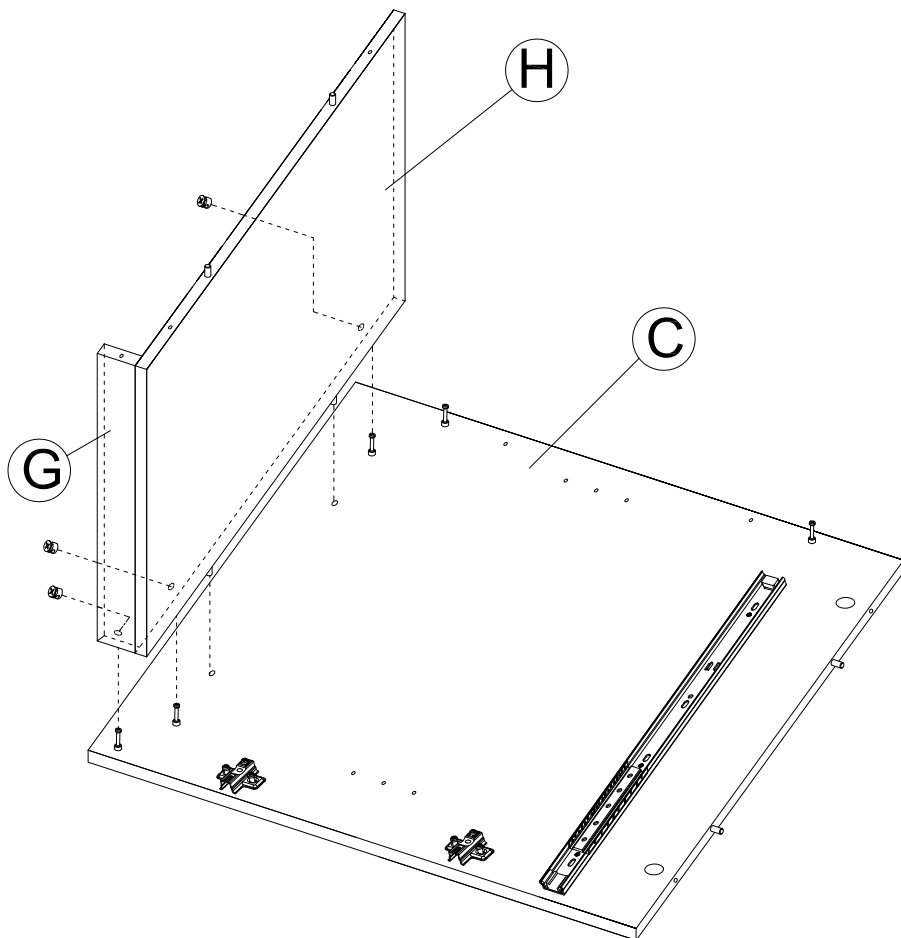

STEP 5

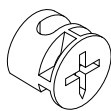

H159916

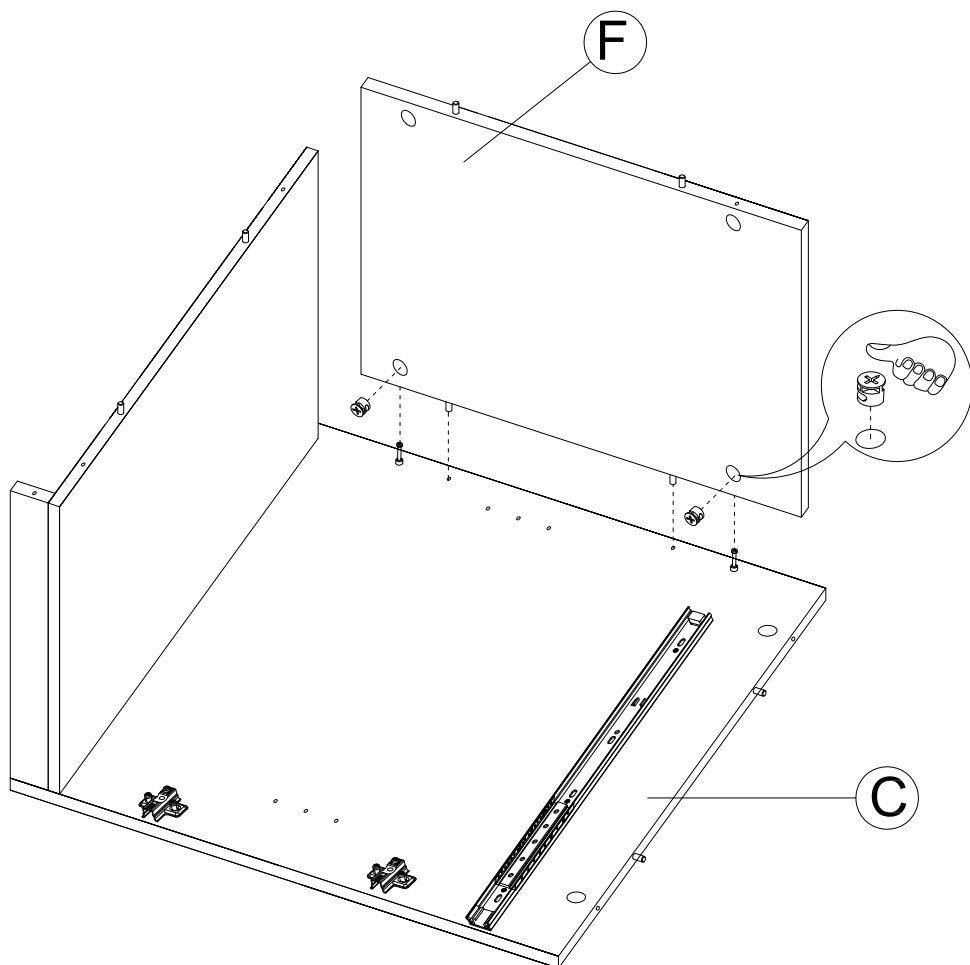

[2]

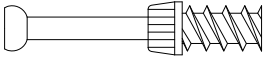

STEP 6

H159917  [5] H38169  [2]

H101725  [3] H20385  [2]

H166951  [1]

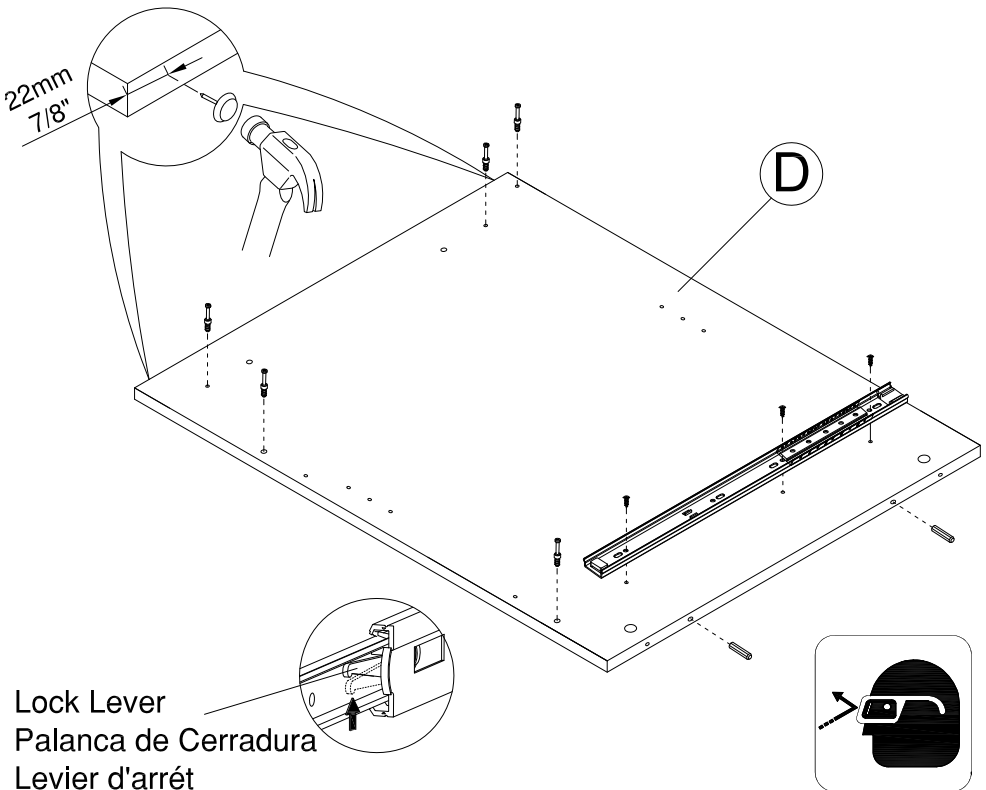

Move lock lever on the drawer runner as shown and separate drawer runner from drawer slide.
Mueva Palanca de la Cerradura en la corredera como se muestra y separe la corredera del deslizable.
Relever le Levier d'arrêt sur la coulisse pour tirer et séparez le coulisseau de la coulisse tel que montré.

STEP 7

H159917

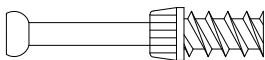

[2]

H159916

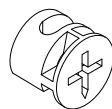

[5]

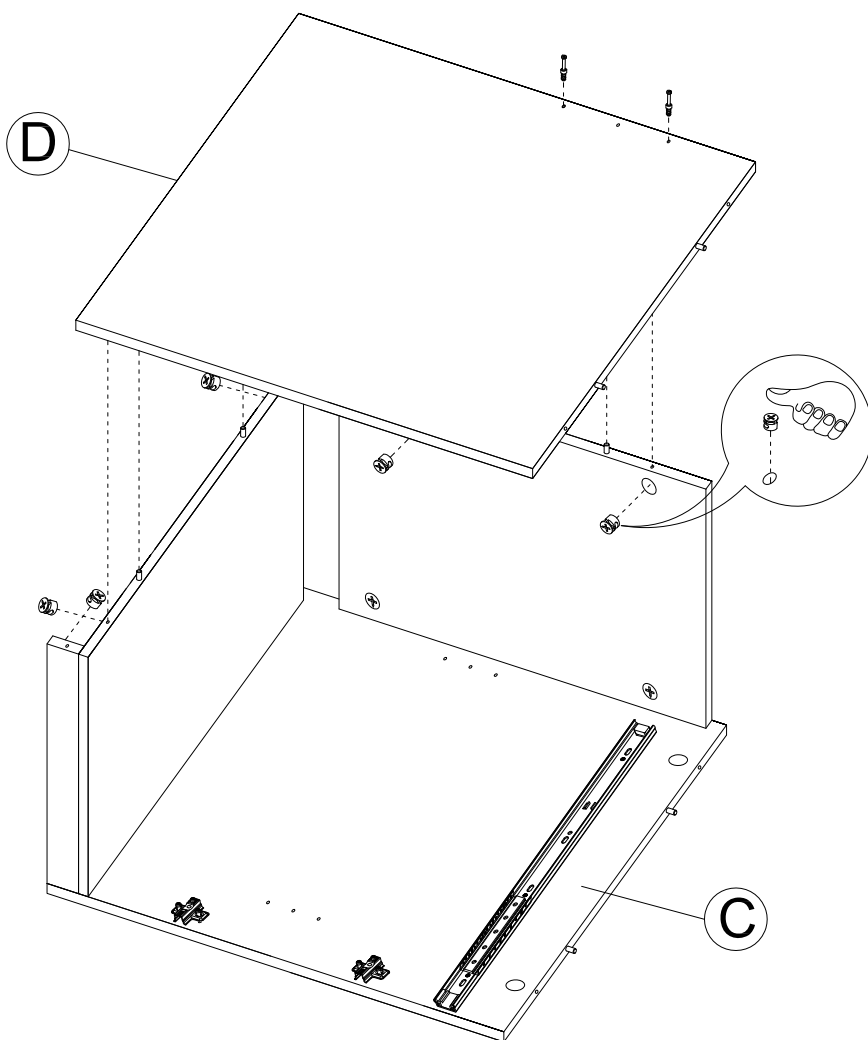

STEP 8

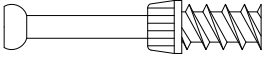
H159917  [2]

H20385  [2]

H38169  [6]

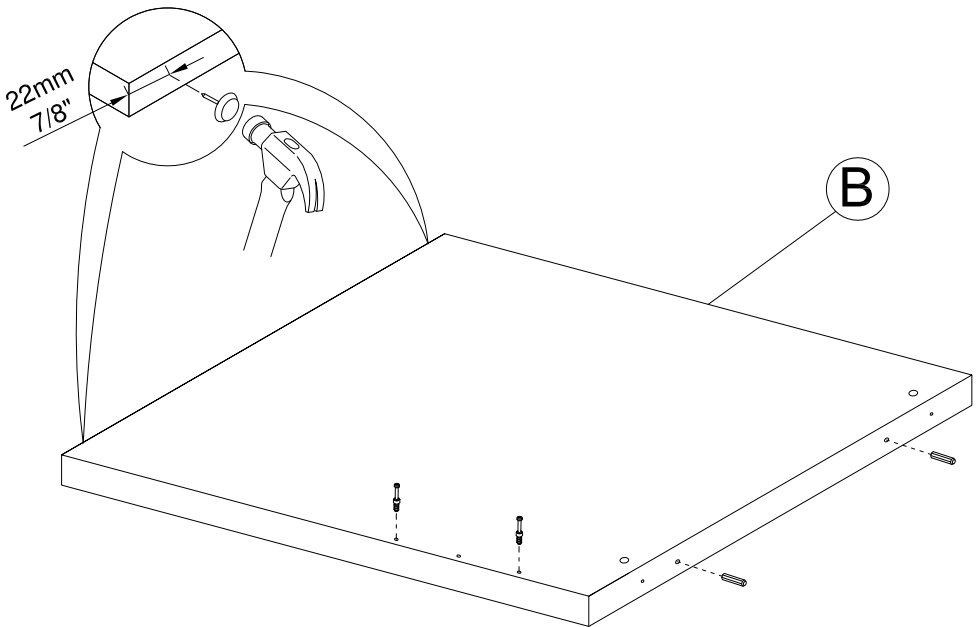
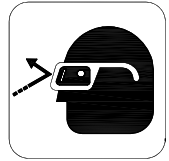
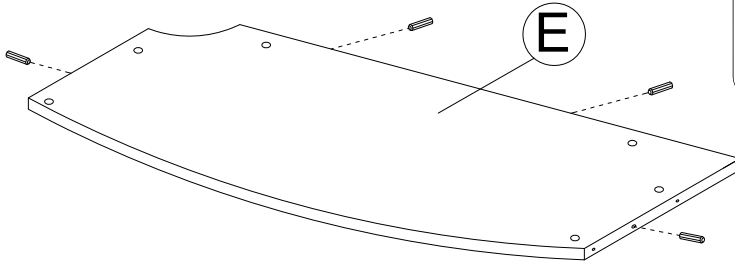

STEP 9

H159916

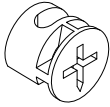

[4]

An assistant is required.
Es necesario un ayudante.
Un assistant est nécessaire.

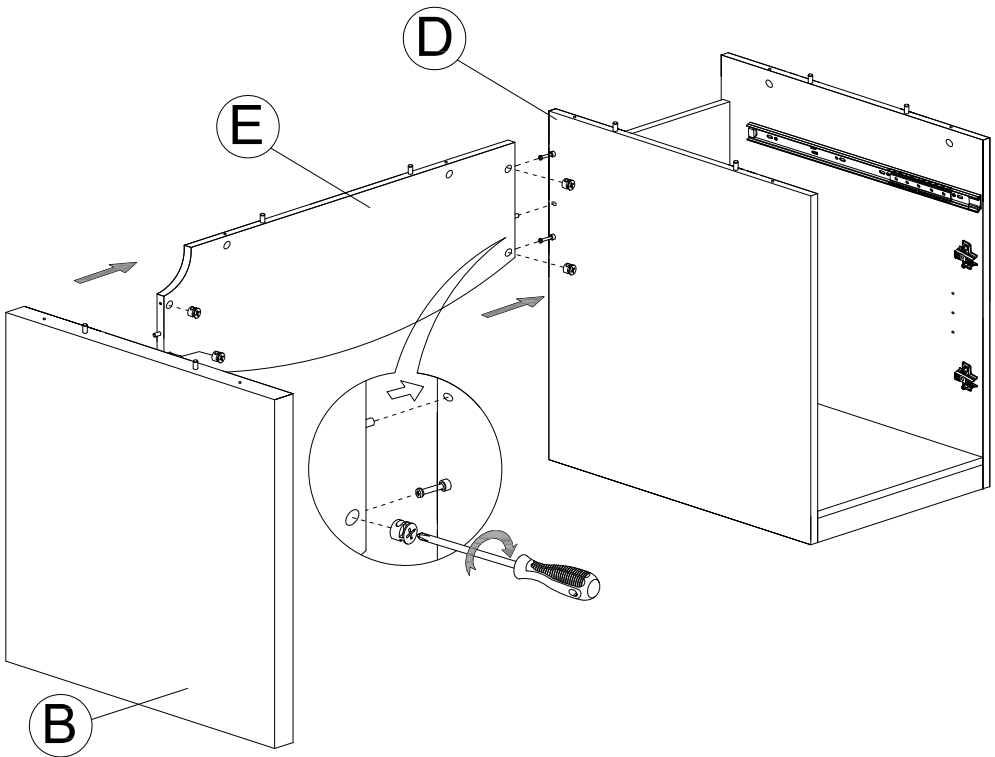

STEP 10

H159917

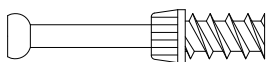

[8]

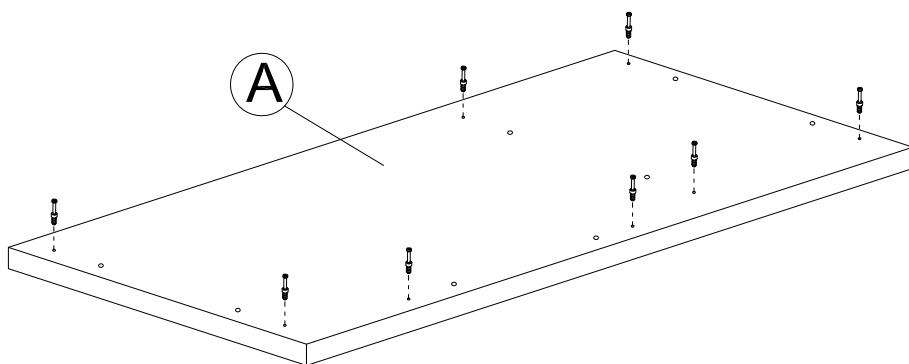

STEP 11

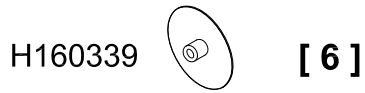

An assistant is required.
Es necesario un ayudante.
Un assistant est nécessaire.

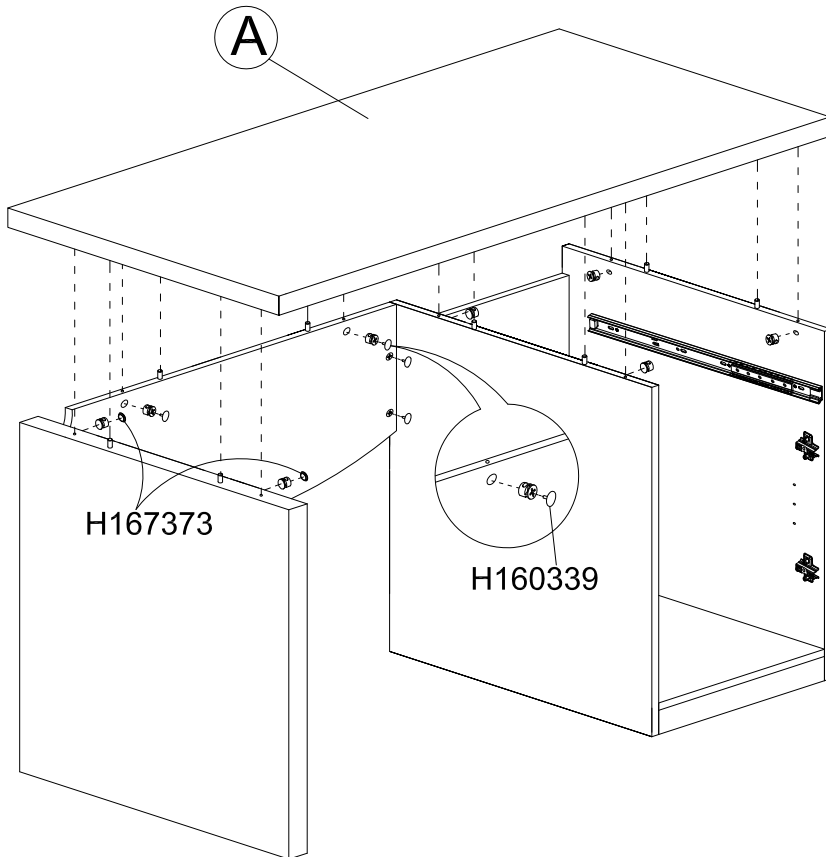

STEP 12

H170051

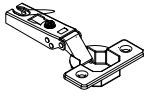

[2]

H149989



[2]

H167433

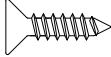

[4]

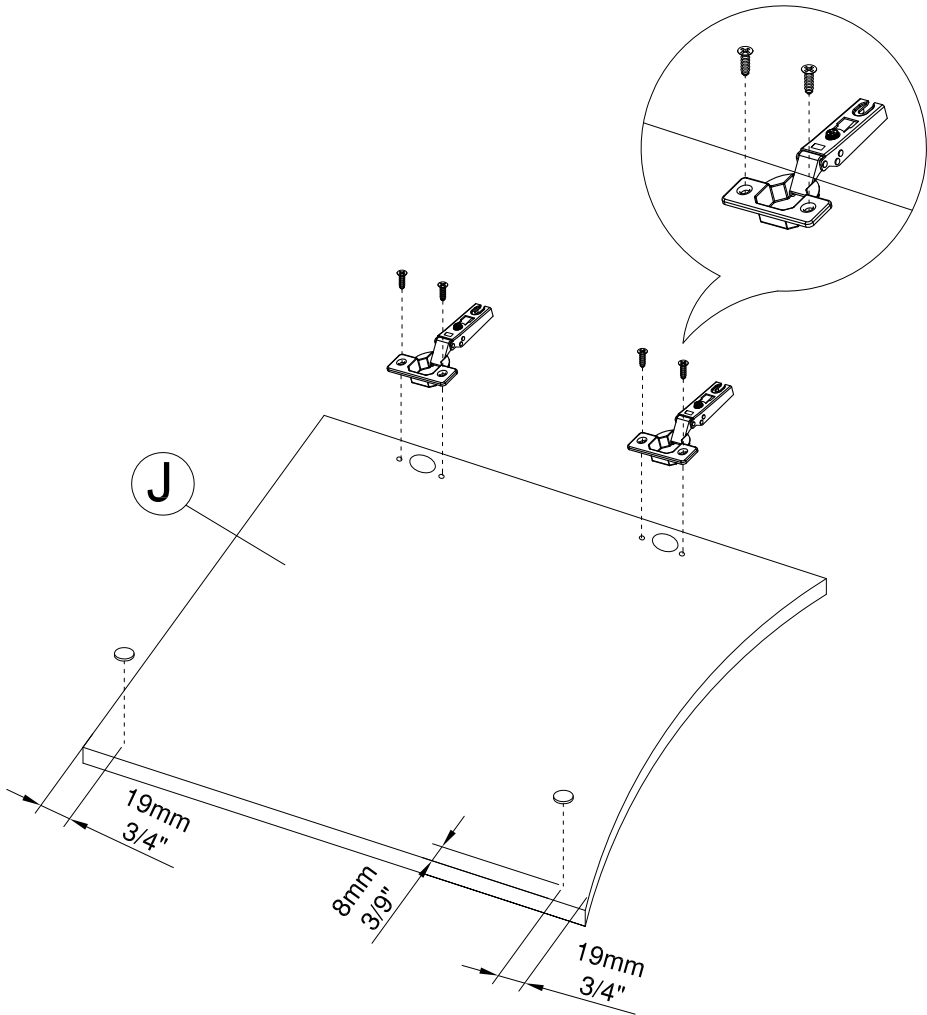

STEP 13

H23604  [4]

H126396  [4]

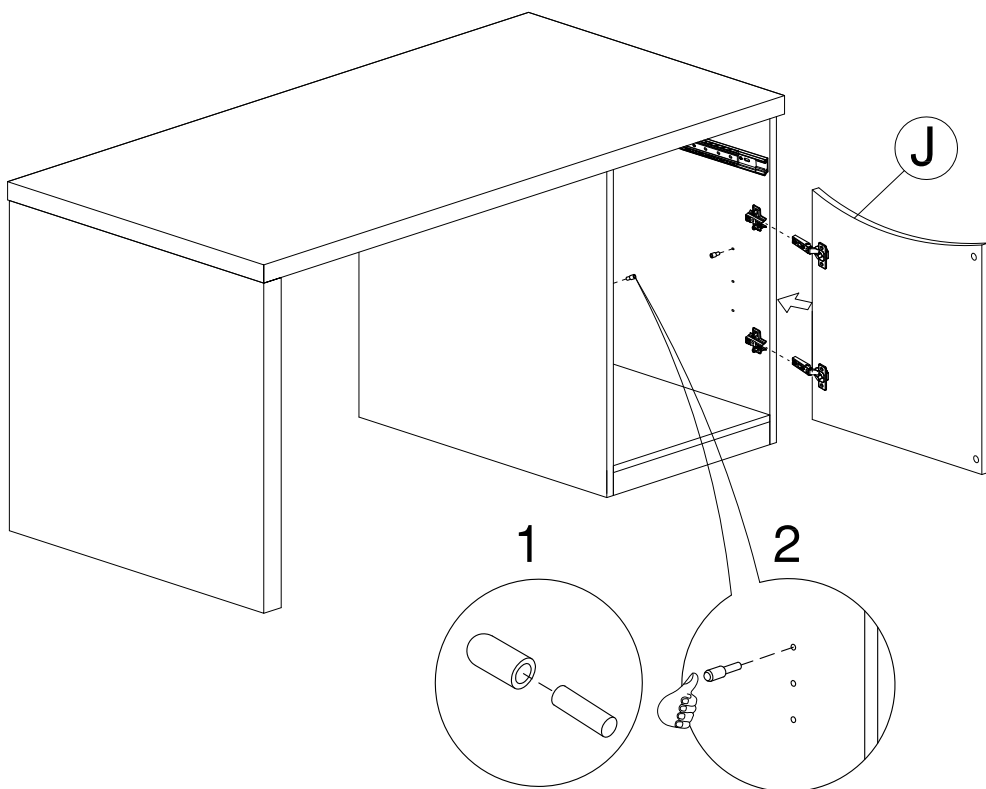
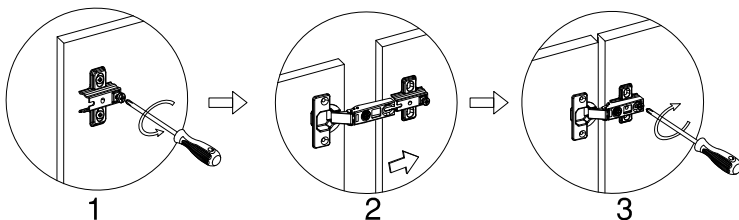

STEP 14

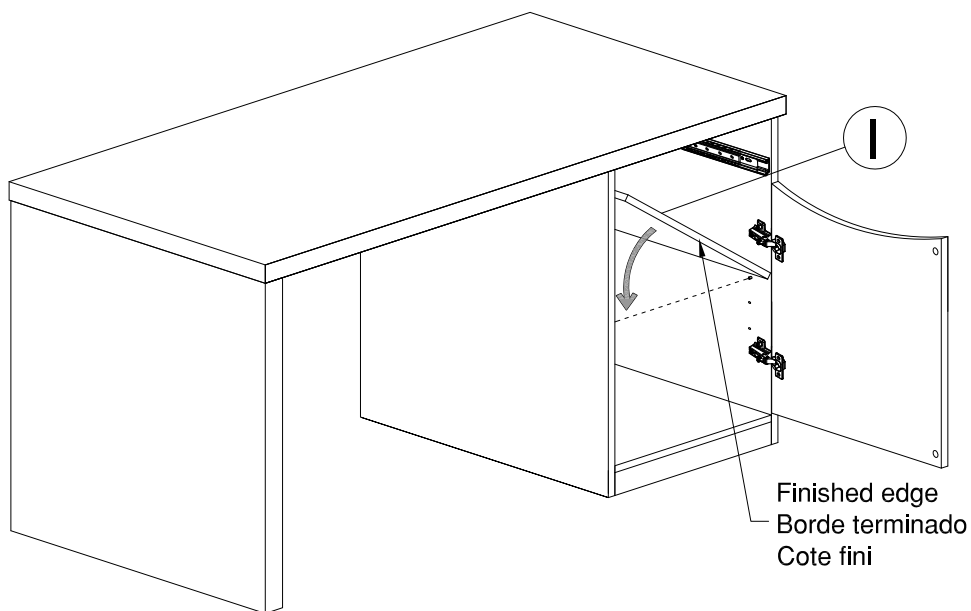
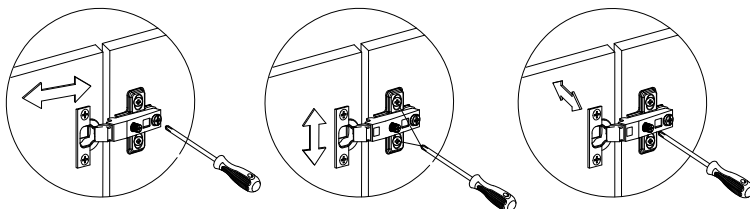

STEP 15

H101725

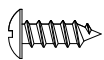

[6]

H35251

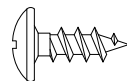

[4]

H166951



[2]

H100445

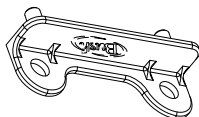

[2]

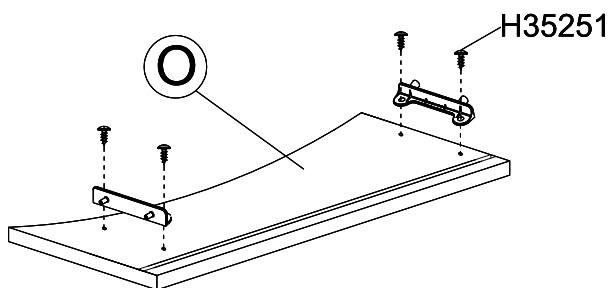
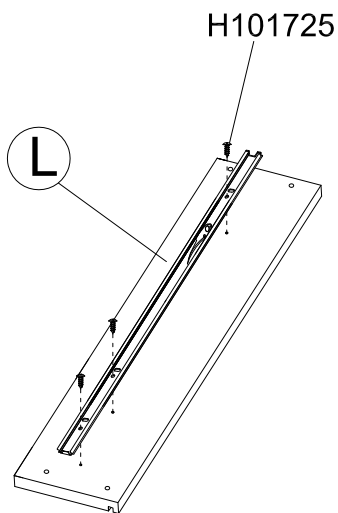
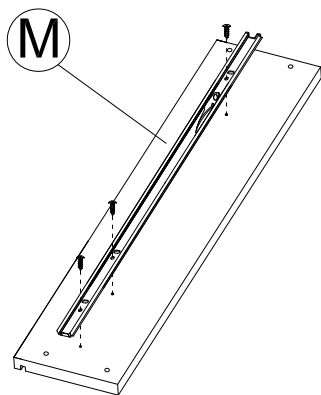

STEP 17

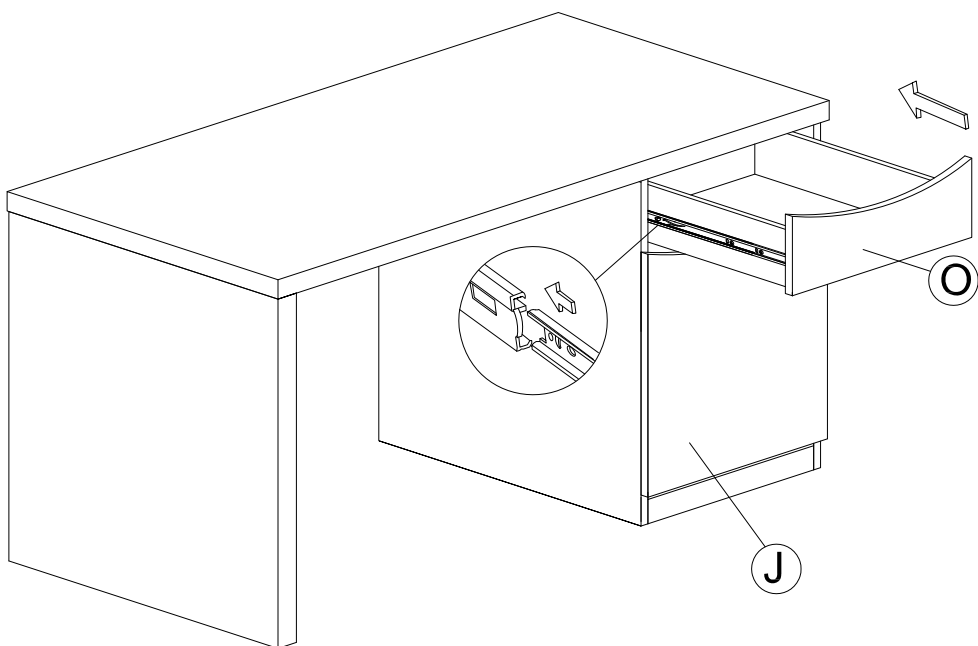

STEP 18

- Move unit to final location.
- Coloque esta unidad en su posición permanente.
- Déplacez l'unité dans l'endroit final.

- Adjust drawer fronts as shown below.
- Ajuste la parte delantera de las gavetas según es indicado.
- Ajustez les façades de tiroir comme montré ci-dessous.

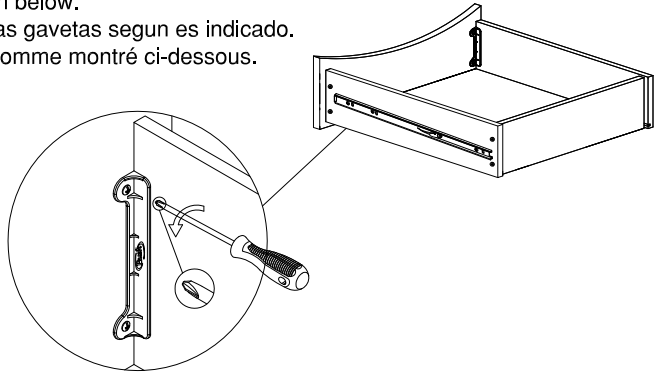

STEP 1.

- Loosen screws on back of drawer front brackets as shown.
- Afloje los tornillos en la parte trasera de la gaveta según es indicado.
- Desserrez les vis dans les appuis en plastique sur le dos de l'avant de tiroir comme montré.

STEP 2.

- Position drawer front as required.
- Ajuste la parte delantera de la gaveta según sea necesario.
- Placez l'avant de tiroir comme nécessaire.

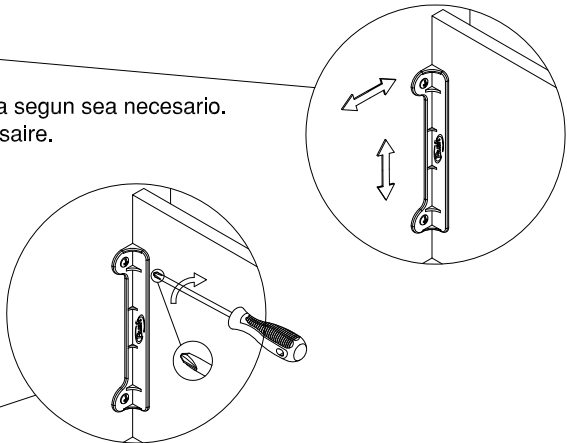

STEP 3.

- Tighten screws while holding drawer front in position.
- Apriete los tornillos mientras sujeta la parte delantera de la gaveta en su posición permanente.
- Serrez les vis tout en tenant l'avant de tiroir en position.

STEP 19

H101725

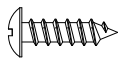

[2]

H156359

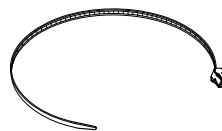

[2]

H157328

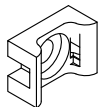

[2]

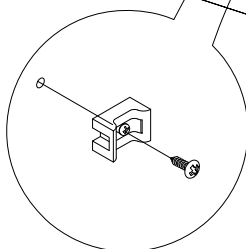
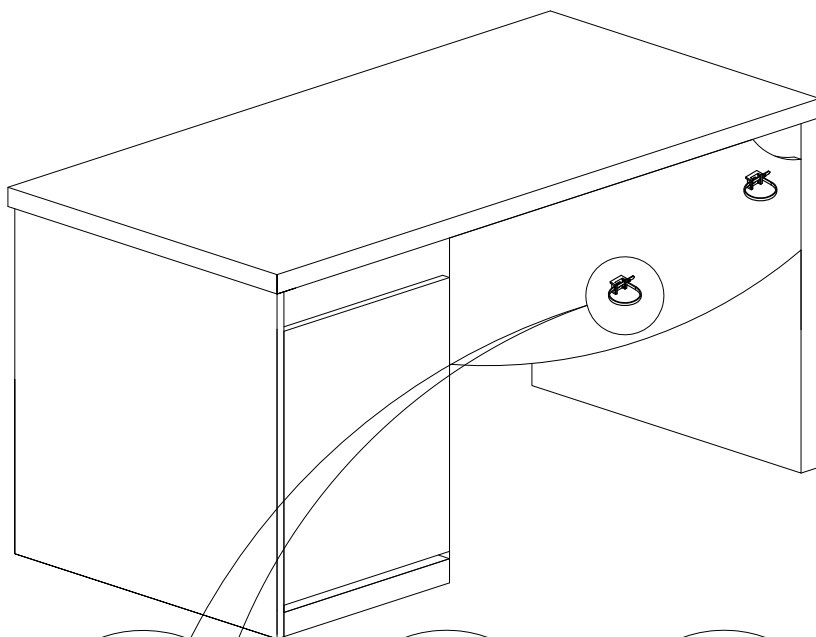

1

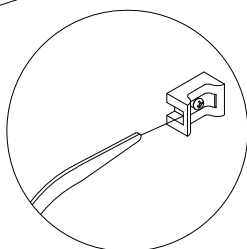

2

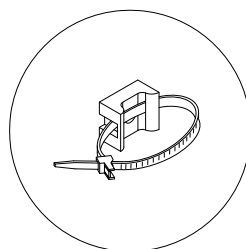

3

STEP 20

Maintenance Tip

It may be necessary to periodically open each drawer to its full extension. This will reset the drawer slides and allow for continued smooth operation.

Información de Mantenimiento

Puede ser necesario el abrir cada gaveta a su máxima extensión periódicamente. Este procedimiento ayuda a recomponer las correderas de las gavetas, asegurando una operación libre.

Conseil dentretien

Il faut de temps en temps ouvrir chaque tiroir jusqu'au bout.

Cela remboite les coulisses des tiroirs pour qu'elles continuent de fonctionner sans accroc.

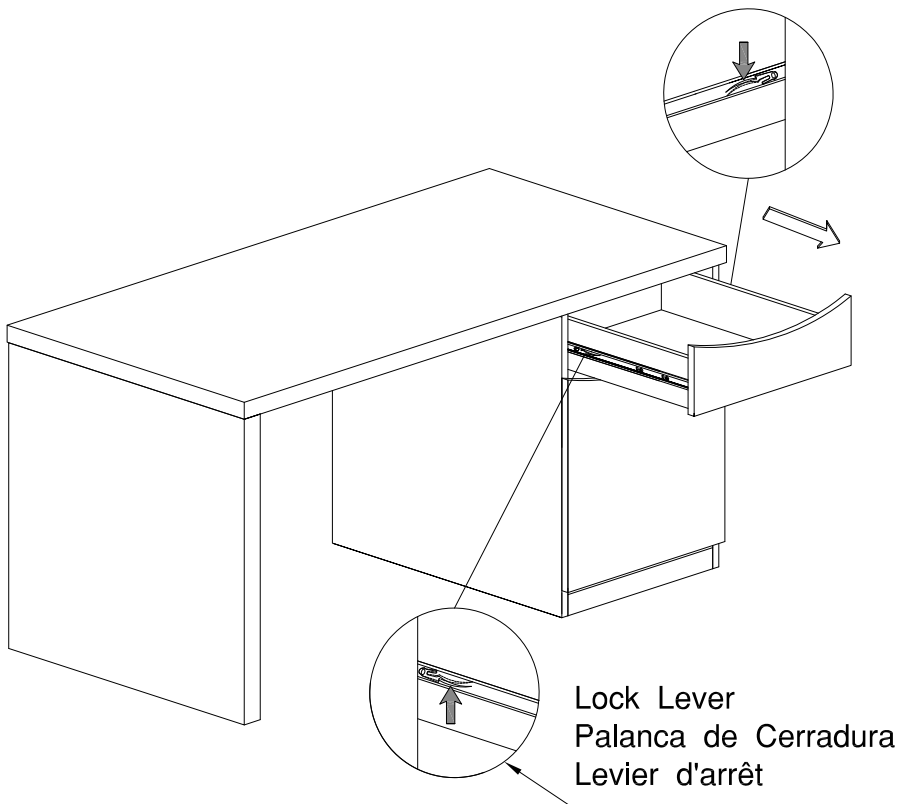

STEP 21

Maximum Weight: 200 Lbs.
Peso Máximo: 200 Libras
Poids Maximum: 90.8 Kilogramme

Maximum Weight: 15 Lbs.
Peso Máximo: 15 Libras
Poids Maximum: 6.8 Kilogramme

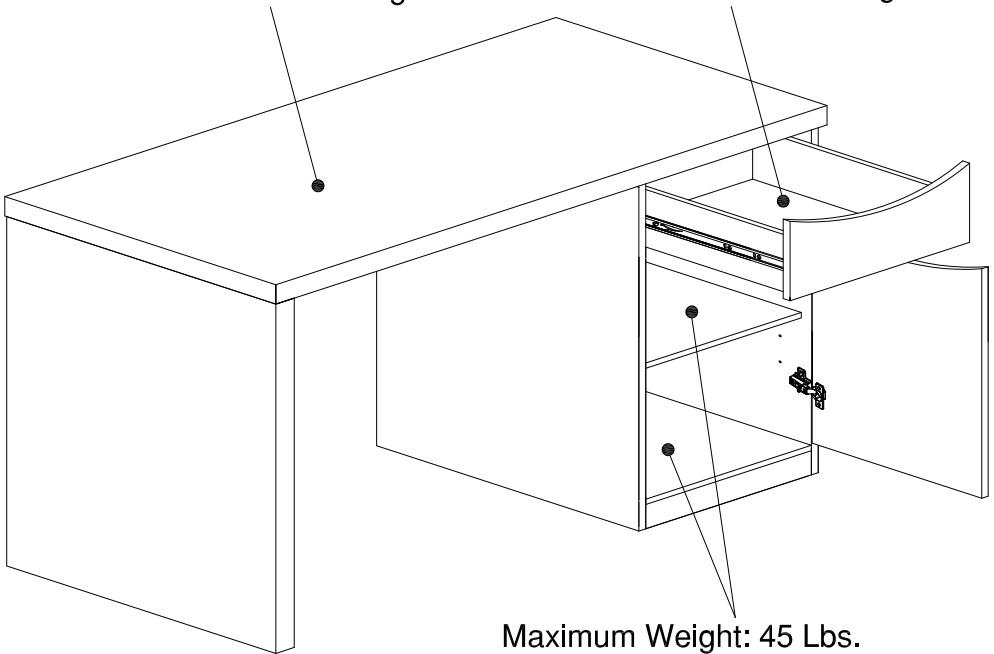

Maximum Weight: 45 Lbs.
Peso Máximo: 45 Libras
Poids Maximum: 20.4 Kilogramme

WARRANTY INFORMATION/INFORMATIONS POUR
LA GARANTIE/INFORMACIÓN DE GARANTÍA

PLEASE RETAIN THIS FOR YOUR RECORDS / VEUILLEZ CONSERVER CECI POUR VOS ARCHIVES
POR FAVOR CONSERVE ESTE DOCUMENTO PARA SUS REGISTROS

You may need to refer to this information in case of warranty claim for insurance purposes.
Il se peut que vous ayez besoin de ces informations en cas de réclamation de garantie pour votre assurance.
Puede necesitar referirse a esta información, en caso de algún reclamo de la garantía con fines relacionados al seguro.