

# ASSEMBLY INSTRUCTION

TABLE

42" x 42" X 60"L x 30 "H

Thank You for purchasing this Quality product. It has been engineered for easy assembly yet constructed for durability. Please take the time to read and follow the instruction while assembling.

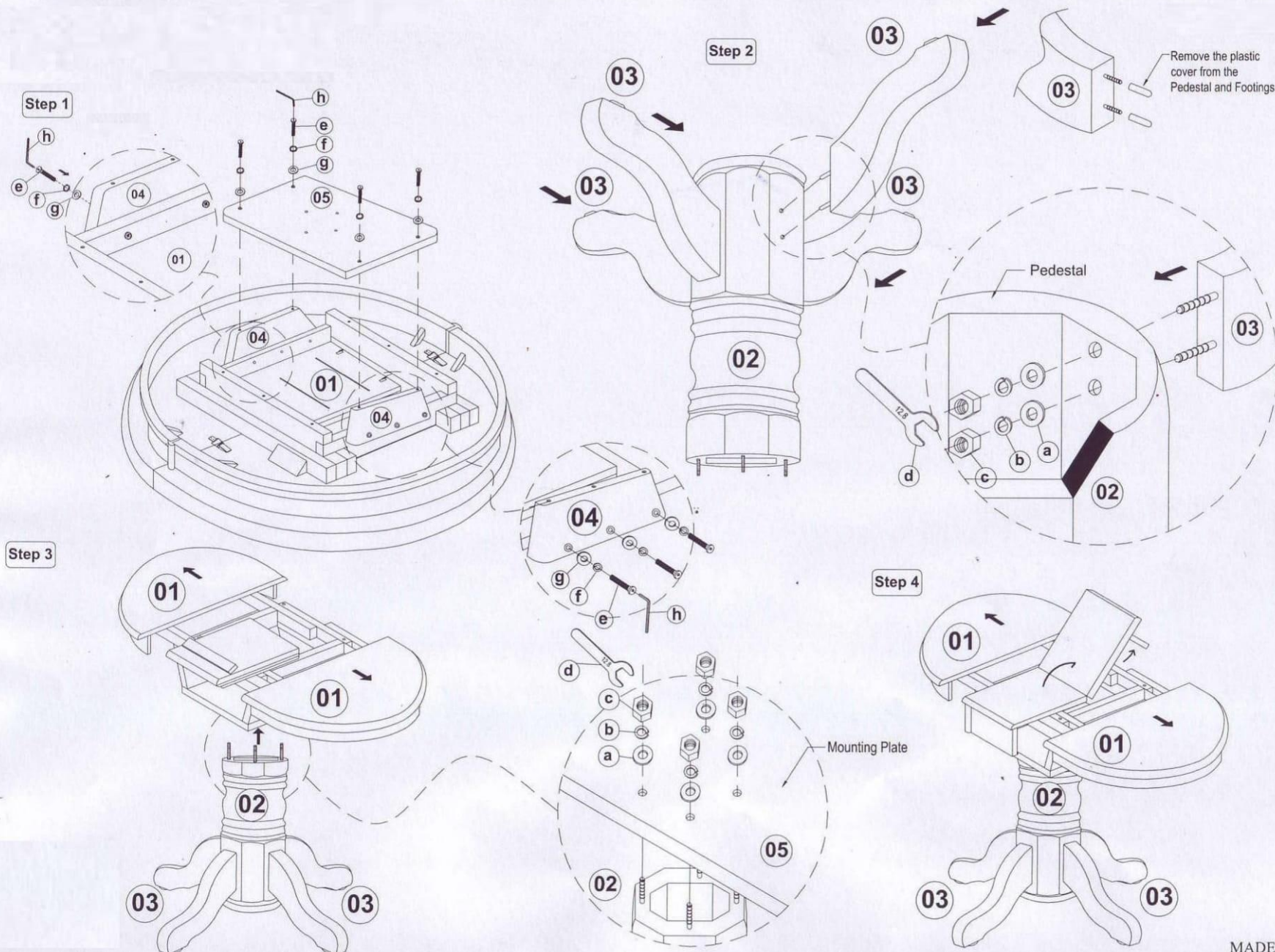

## List of Part For 1 Set

01	Table Top	1
02	Pedestal	1
03	Table Leg With Leveler	4
04	Supporting Rail	2
05	Mounting Plate	1

## List of hardware For 1 Set

a	Flat Washer 5/16" x 22mm	12
b	Spring Washer 5/16"	12
c	Hexagon Nut 5/16" x 7mm	12
d	Spanner 12.8mm	1
e	JCBC Bolt M6 x 40mm	10
f	Spring Washer 1/2"	10
g	Flat Washer 1/4 x 13mm	10
h	Allen Key M4	1

## Important Notes

- \* Keep all hardware parts out of reach of children.
- \* Must tighten screws periodically. With use screws will become loose. Check tightness of all screws every 6-8 weeks.
- \* Don't attempt to repair or modify parts that are broken or defective. Please contact the store immediately.
- \* Do not tighten all screw / bolt until all completely assembled

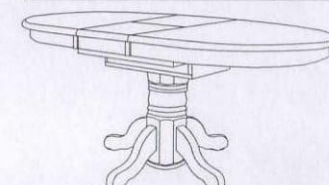

MADE IN MALAYSIA Assembly Completed !!..