

# Door Installation Instructions: Door Jamb, Header, and Door Slab

This guide provides step-by-step instructions for installing a new door system, including the jamb, header, and the door slab itself. Please ensure you have all necessary tools and materials before beginning.

## 1. Preparing the Rough Opening

Before starting the installation, inspect the rough opening to ensure it is square, plumb, and the correct size for your door unit.

1. **Check Dimensions:** Measure the width and height of the rough opening. The opening should typically be 2 inches wider and 2 inches taller than the door unit itself to allow for shims and leveling.
2. **Verify Plumb and Square:** Use a level to ensure the sides of the rough opening are plumb (vertical) and a square to ensure the corners are square (90 degrees).

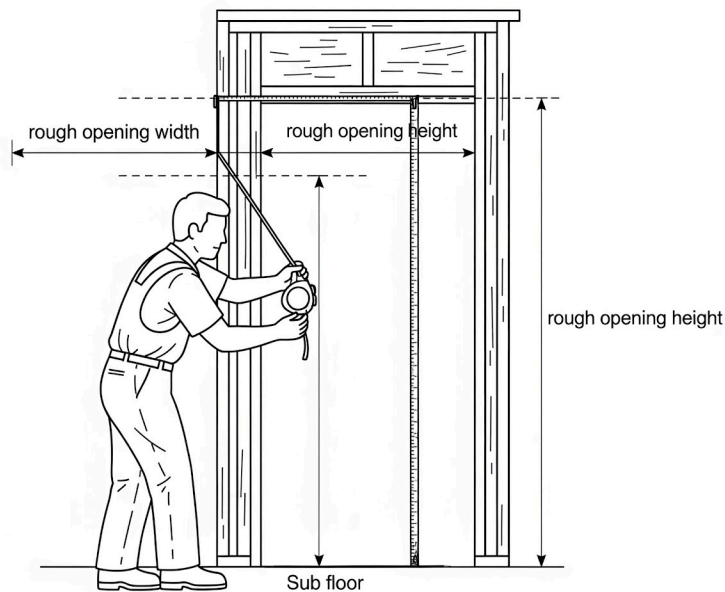

## 2. Installing the Door Jamb and Header

The door jamb is the frame into which the door slab is fitted. It consists of two vertical side jambs and a horizontal head jamb (header).

1. **Assemble the Jamb (if necessary):** Some door units come pre-assembled, while others require assembly. If assembling, join the side jambs and header using screws or nails, ensuring a tight and square fit.
2. **Apply Sealant/Flashing:** Apply a continuous bead of high-quality sealant or flashing tape around the perimeter of the rough opening where the jamb will meet the wall to ensure weather resistance.
3. **Position the Jamb:** Carefully place the assembled jamb into the rough opening.
4. **Level and Plumb:**
  - Place a level on the head jamb (header) and use shims at the top and sides to ensure it is perfectly level.
  - Start on the hinge side. Shim the jamb behind each hinge location and at the top and bottom.
  - Use a level to ensure the hinge-side jamb is perfectly plumb (vertical).
5. **Secure the Hinge Side:** Once the hinge-side jamb is level and plumb, secure it temporarily with finishing nails or screws through the shims and into the rough framing.
6. **Secure the Strike Side:** Shim the latch/strike side jamb in the corresponding locations (near the strike plate and middle/bottom). Ensure the distance between the hinge-side and strike-side jambs is consistent (parallel) and the strike-side jamb is also plumb.

7. **Final Fastening:** Drive longer, structural screws or nails through the shims on both sides to permanently secure the jamb to the rough opening. Trim excess shim

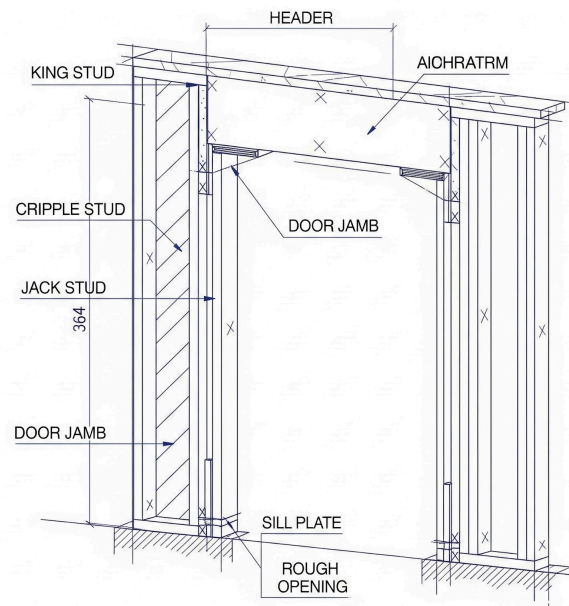

material.

### 3. Installing the Door Slab

The door slab is the actual movable door panel.

1. **Preparation:** Check the door slab for proper fit within the installed jamb. There should be a small, consistent gap (typically 1/8 inch) around the perimeter. If necessary, plane or trim the door slab.
2. **Attach Hinges (if not pre-hung):** If the door is not pre-hung, mount the hinges to the door slab edge and the corresponding mortises in the jamb. Ensure the screws are tight.
3. **Hang the Door:** Carefully lift the door slab and align the hinge leaves (if using removable pins) or the pins (if using pre-attached hinges) and insert the hinge pins to secure the door slab to the jamb.
4. **Check Operation:** Open and close the door several times. The door should operate smoothly, remain open when placed at various angles, and the reveal (the gap around the door) should be consistent. Adjust shims if the door binds or swings open/closed on its own.
5. **Install Hardware:** Install the door handle, lockset, and strike plate. Ensure the strike plate aligns properly with the door latch and deadbolt.



## 4. Final Steps and Trim

1. **Insulation:** Fill the gap between the installed door jamb and the rough opening with minimal-expanding foam insulation.
2. **Casing/Trim:** Install the interior and exterior trim (casing) to cover the gaps and shims. Miter the corners for a professional look.
3. **Finishing:** Caulk all seams and joints, and then prime and paint or stain the door and trim as desired.

If you have any issues during installation, please consult with a professional. You can book an appointment with a local installer here: [📅 Calendar event](#)