

Night Stand

Assembly Instructions

Contains One Night Stand and Hardware

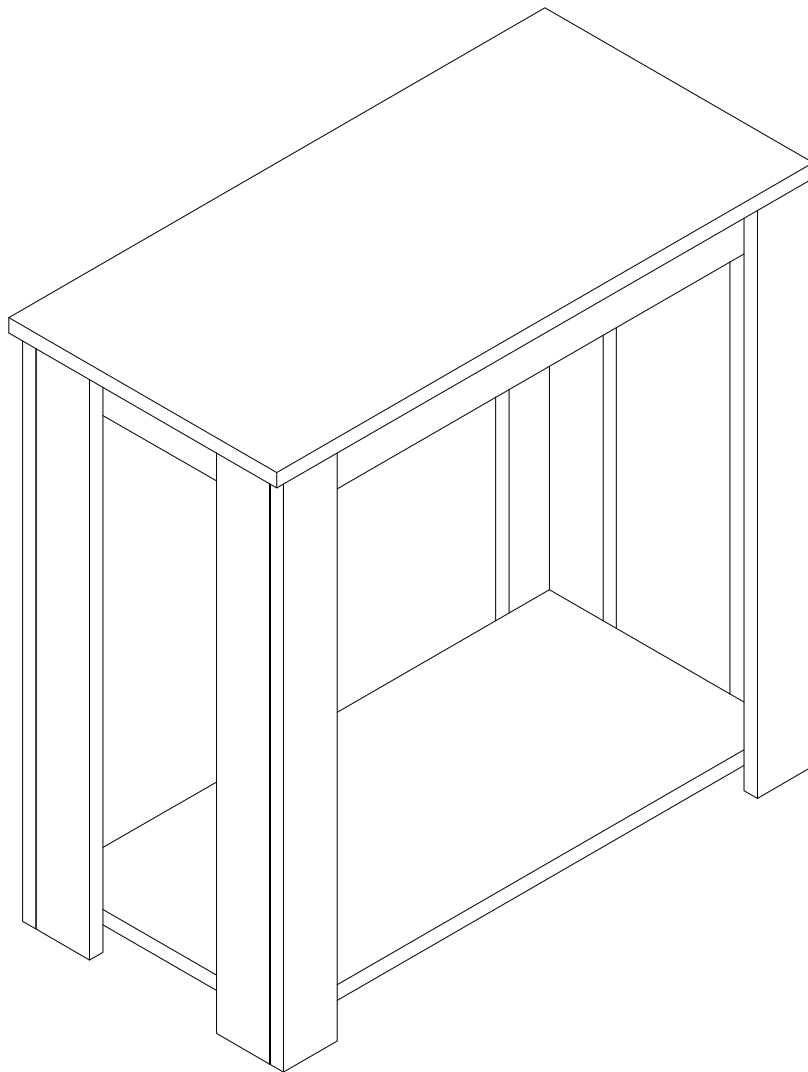

Night Stand
Contains One (1) Night Stand and Hardware

IMPORTANT NOTE:
Carefully remove all the parts from the box. Arrange on a flat surface and verify you have all of the following parts and hardware.

TOOLS REQUIRED:
-Phillips Screwdriver
-Mallet

PARTS LIST

1.Top Panel (1 PC)

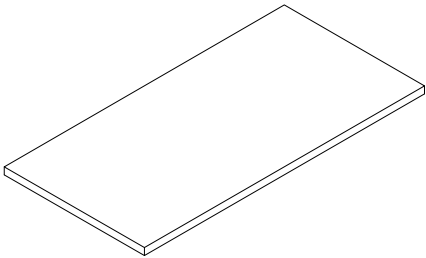

2.Shelf Panel (1 PC)

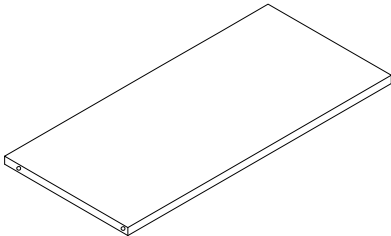

3.Leg Panel (R 1)
(2 PCS)

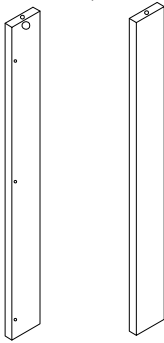

4.Leg Panel (R 2)
(2 PCS)

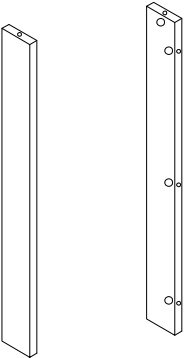

5.Leg Panel (L 1)
(2 PCS)

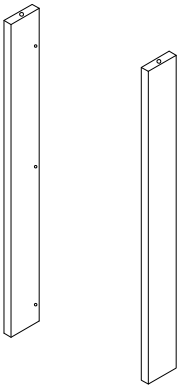

6.Leg Panel (L 2)
(2 PCS)

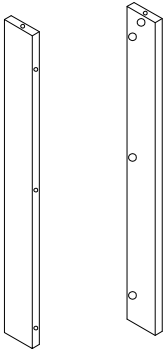

7.Front Apron Panel
(2 PCS)

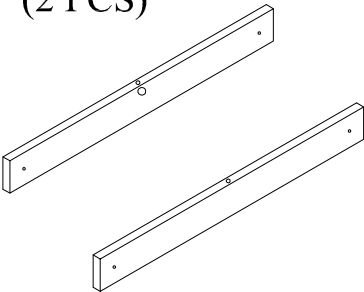

8.Side Apron Panel
(2 PCS)

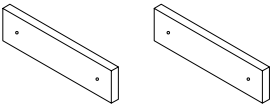

HARDWARE LIST

A.Allen Key (1 PC)

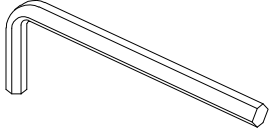

B.Minifix Bolt (26 PCS)

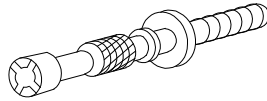

C.Minifix House (26 PCS)

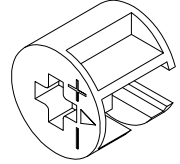

D.Minifix Cap (26 PCS)



E.Screw 25mm (8 PCS)

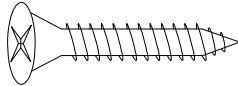

F.White Nail (4 PCS)

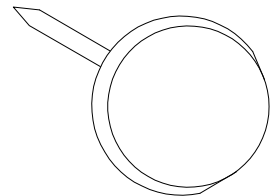

ASSEMBLY INSTRUCTIONS

STEP 1

Using a Phillips Head Screwdriver, attach Minifix Bolts (Part D) to the Panel (Parts 1,3,4,5,6).

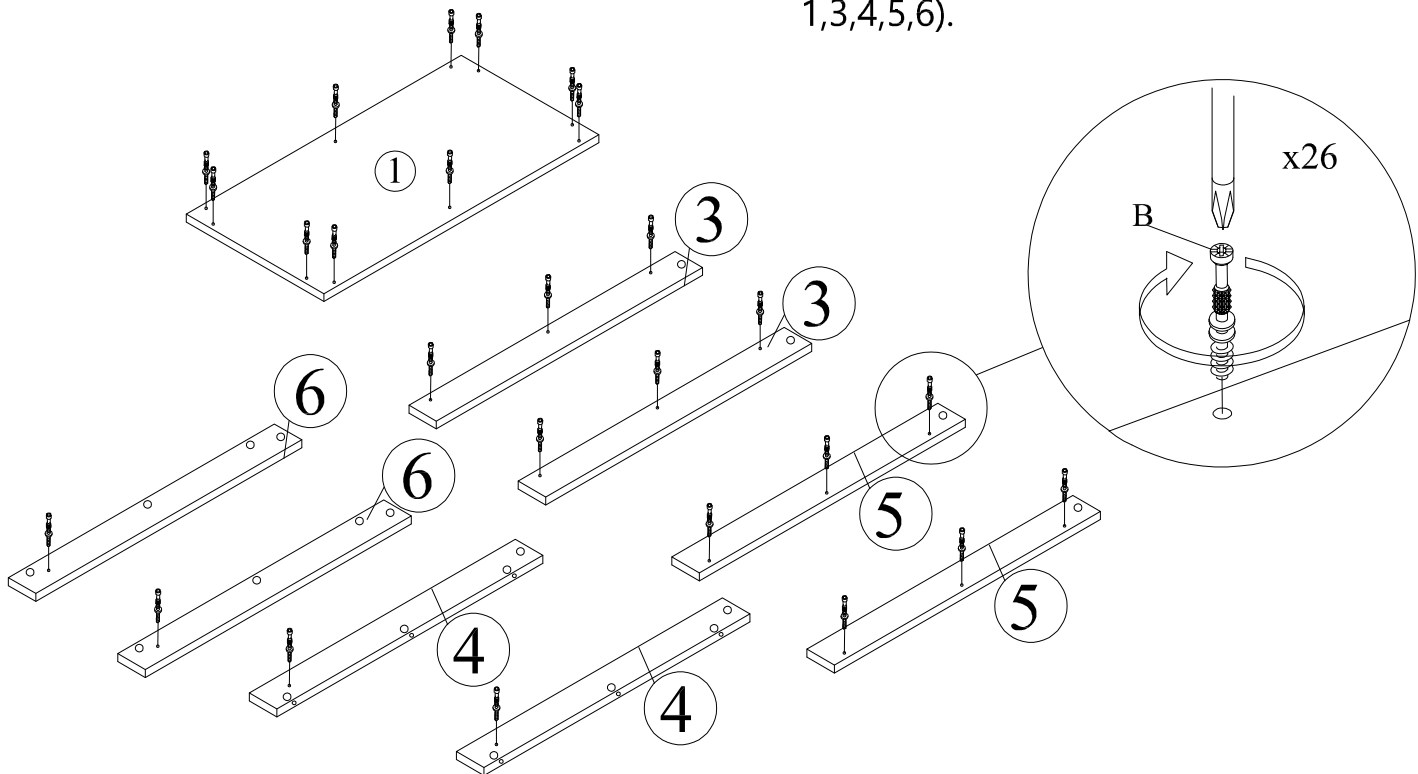

STEP 2

This is how a mini fix works...

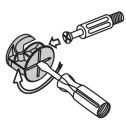

The head of the mini fix housing goes into the open mouth of the mini fix bolt. You then turn the mini fix housing so it tightens over the mini fix bolt.

Insert the minifix house (Part C) to the Leg Panels (Part 4,6) and make sure the open side of the Minifix House (Part C) is facing the opening on panels. Attach the Leg Panels (Part 3,4,5,6) as shown. Turn the Minifix House (Part C) to tighten using the Allen Key (Part A) or screwdriver. Cover the Minifix House (Part C) using the Minifix Cap (Part D) by pressing it into the Minifix House.

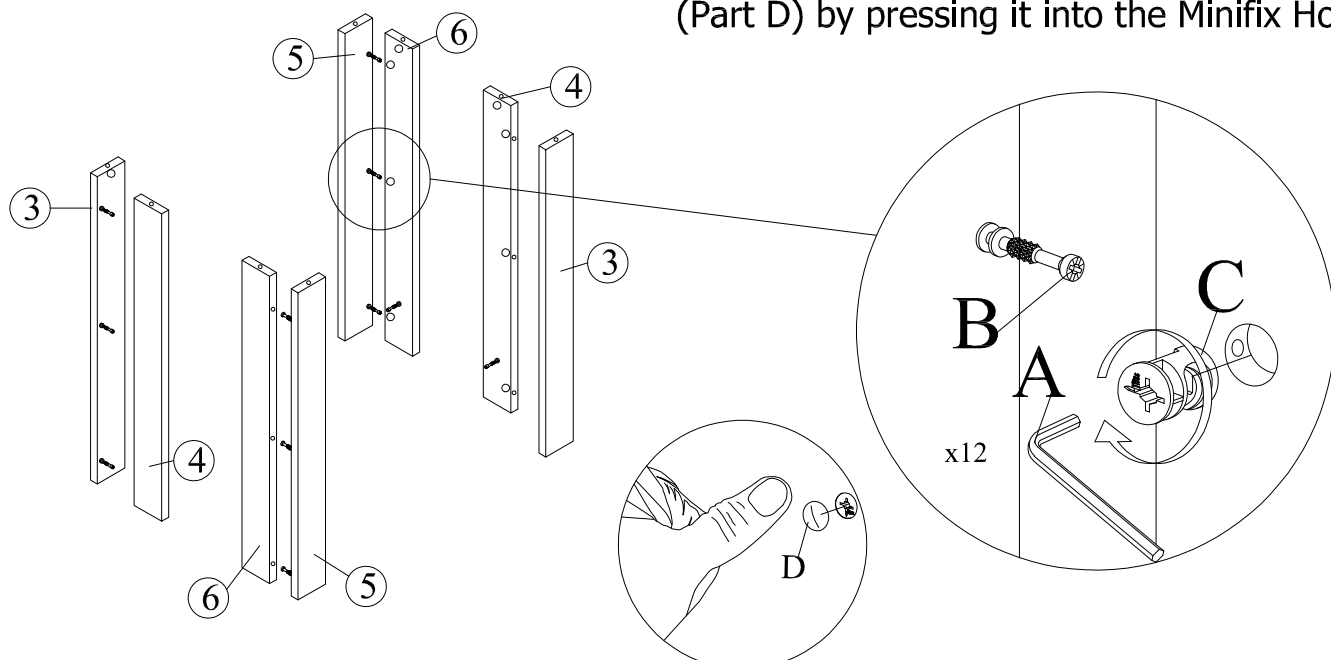

***Attach Minifix Cap as shown.**

ASSEMBLY INSTRUCTIONS

STEP 3

This is how a mini fix works...



The head of the mini fix housing goes into the open mouth of the mini fix bolt. You then turn the mini fix housing so it tightens over the mini fix bolt.

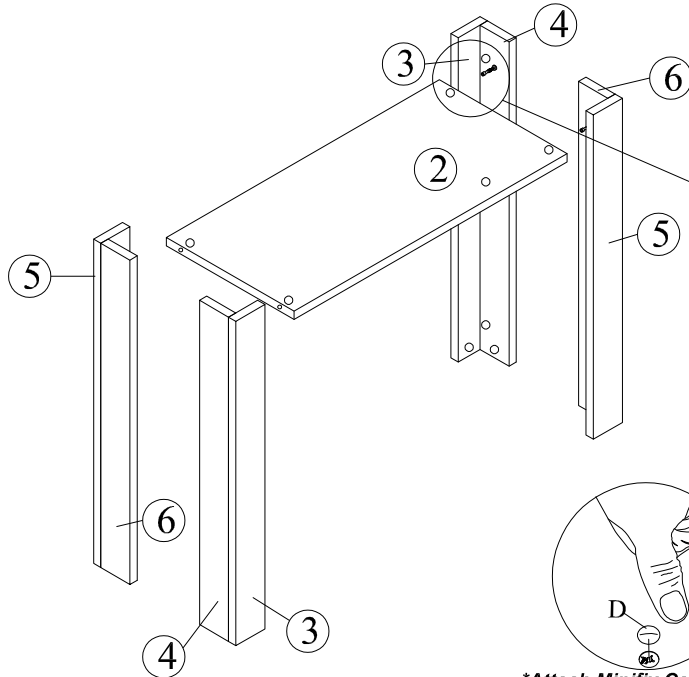

**Attach MiniFix Cap as shown.*

Insert the minifix house (Part C) to the Shelf Panel (Part 2) and make sure the open side of the Minifix House (Part C) is facing the opening on panels. Attach the Leg Panels as shown. Turn the Minifix House (Part C) to tighten using the Allen Key (Part A) or screwdriver. Cover the Minifix House (Part C) using the Minifix Cap (Part D) by pressing it into the Minifix House.

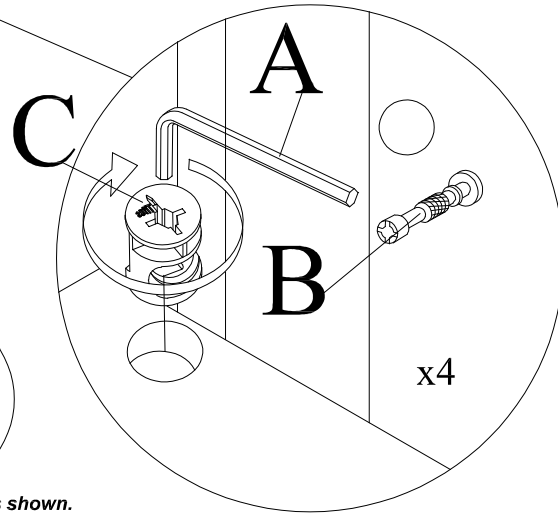

STEP 4

This is how a mini fix works...

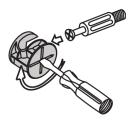

The head of the mini fix housing goes into the open mouth of the mini fix bolt. You then turn the mini fix housing so it tightens over the mini fix bolt.

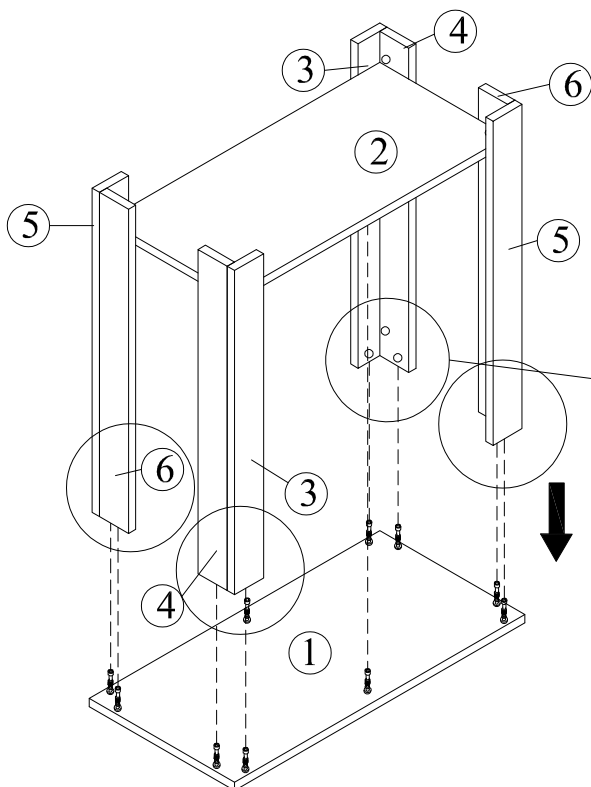

**Attach MiniFix Cap as shown.*

Insert the minifix house (Part C) to the Leg Panel (Part 3, 4, 5, 6) and make sure the open side of the Minifix House (Part C) is facing the opening on panels. Attach the Leg Panels to Top Panel (Part 1) as shown. Turn the Minifix House (Part C) to tighten using the Allen Key (Part A) or screwdriver. Cover the Minifix House (Part C) using the Minifix Cap (Part D) by pressing it into the Minifix House.

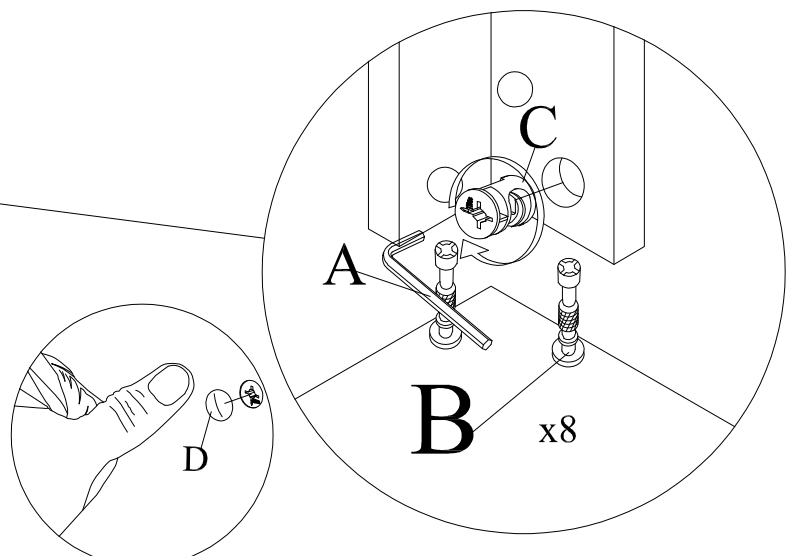

ASSEMBLY INSTRUCTIONS

STEP 5

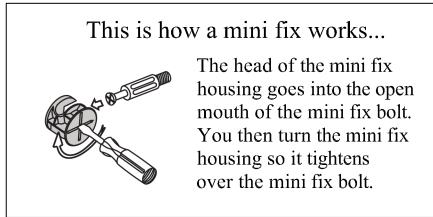

Insert the minifix house (Part C) to the Front Apron Panel (Part 7) and make sure the open side of the Minifix House (Part C) is facing the opening on panels. Attach the Front Apron Panel (Part 7) as shown. Turn the Minifix House (Part C) to tighten using the Allen Key (Part A) or screwdriver. Cover the Minifix House (Part C) using the Minifix Cap (Part D) by pressing it into the Minifix House.

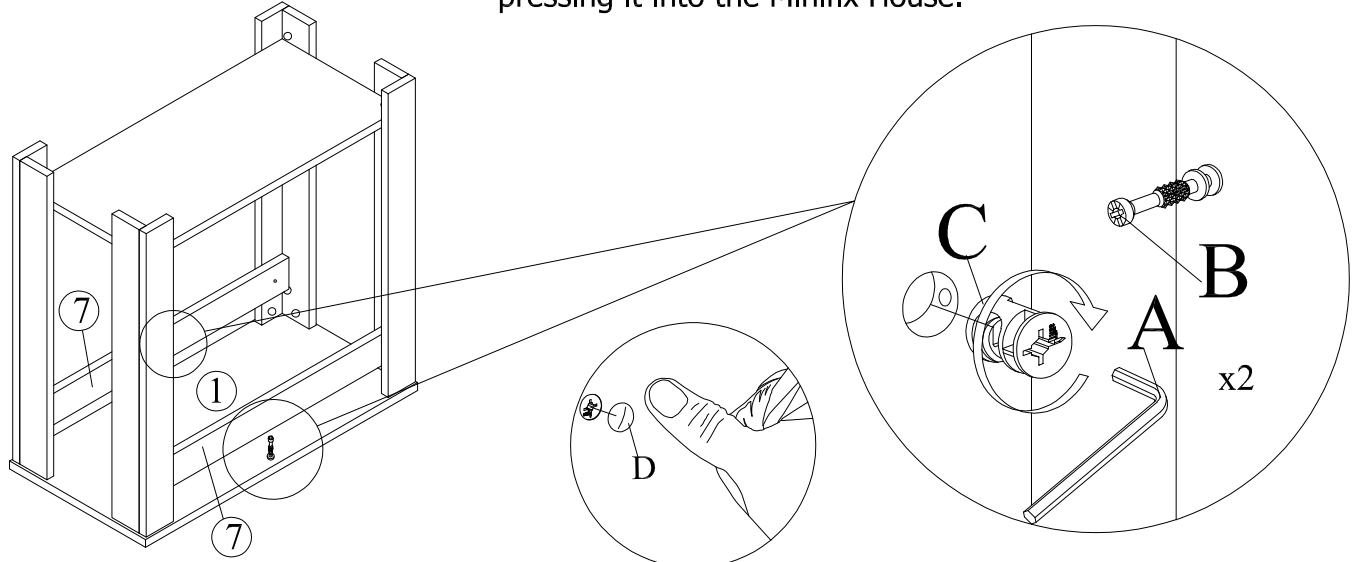

STEP 6

Attach Side Apron Panel (Part 8) as shown, then use screw 25mm (Part E) using screwdriver to tighten.

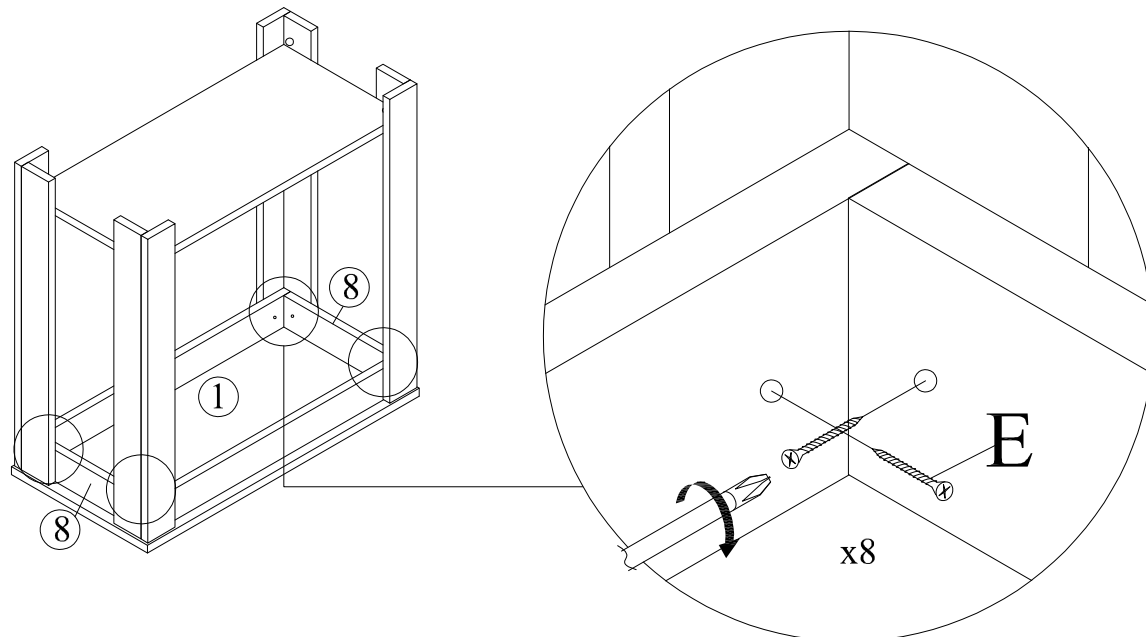

ASSEMBLY INSTRUCTIONS

STEP 7

Attach White Nail (Part F) to the Leg Panels using a mallet or hammer. Gently tap the white nail to secure them.

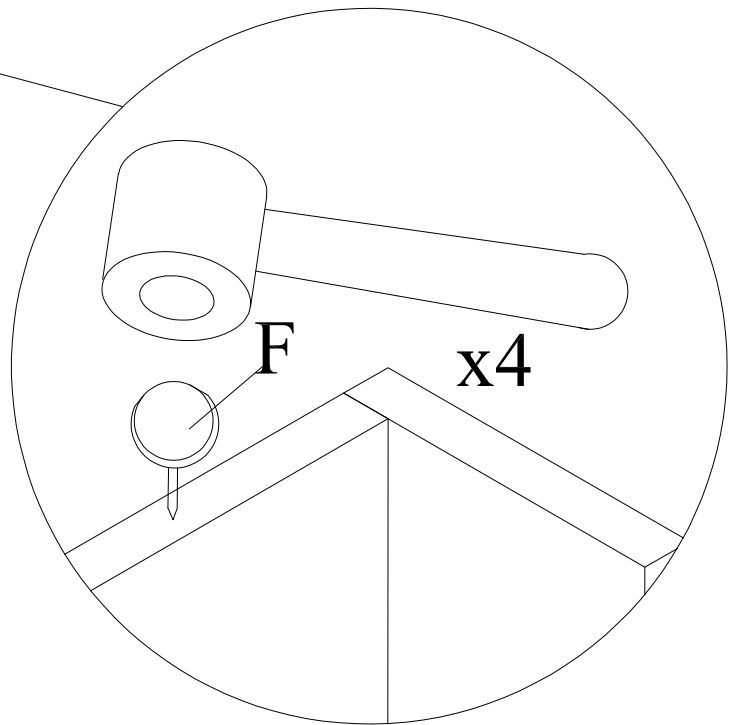
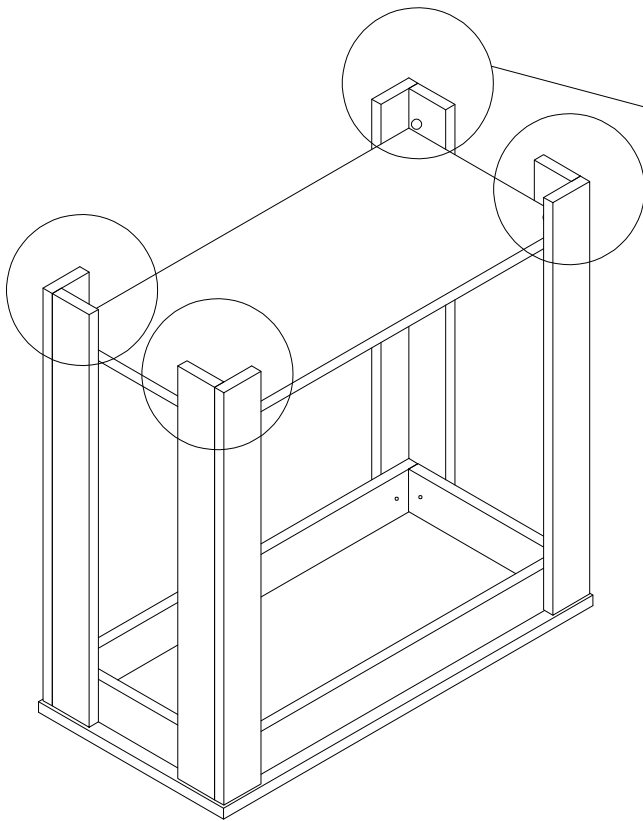

ASSEMBLY INSTRUCTIONS

YOUR NIGHTSTAND IS NOW READY FOR USE

