

Assembly Instructions

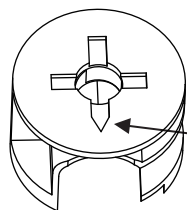

NOTICE "pointer arrow" on face of Cam (Part C)

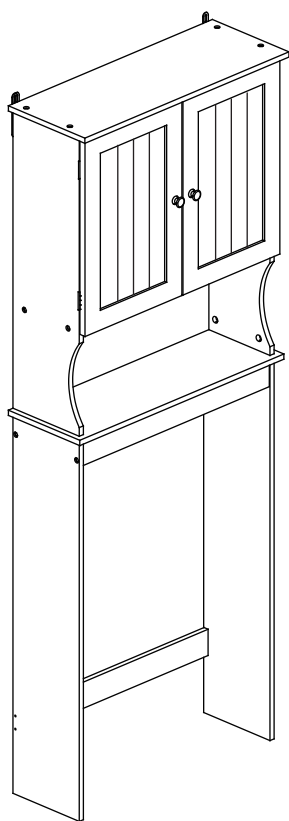

Caution: This unit must be securely attached to the wall using the included hardware kit. See Step 11 and Step 14.

Dimensions

Width-60cm
Depth-22.5cm
Height-157.5cm

Proper Pin (Part B) and Cam (Part C) Alignment:

Place the Cam so that the "pointer arrow" faces the edge of the panel. This allows for the Pin (Part B) to be correctly aligned with the opening of the Cam.

Turn the Cam clockwise (normally about ½ turn. The Cam will capture the head of the Pin. As the Cam is turned it will draw the two panels together.

See picture above and figures 3.1, 3.2, 3.3 for reference.

1 x 1pc	2 x 1pc	3 x 1pc	4 x 1pc	5 x 1pc	6 x 1pc	7 x 1pc
8 x 2pc	9 x 1pc	10 x 1pc	11 x 1pc	12 x 1pc	13 x 2pcs	14 x 1pc

Assembly Instructions

Ⓐ x 4pcs	Ⓑ x 4pcs	Ⓒ x 8pcs	Ⓓ x 2pcs	Ⓔ x 4pcs	Ⓕ x 6pcs	Ⓖ x 20pcs	Ⓗ x 1pc
			 Ø4 x 35mm	 Ø4 x 30mm	 Ø3 x 16mm	 Ø3 x 12mm	
Ⓘ x 2pcs	Ⓙ x 2pcs	Ⓚ x 2pcs	Ⓛ x 4pcs	Ⓜ x 4pcs	Ⓝ x 2pcs	Ⓞ x 12pcs	Ⓟ x 12pcs
Ⓢ x 1pc	Ⓡ x 1pc	Ⓣ x 2pcs	Ⓤ x 16pcs	Ⓡ x 4pcs			

STEP 1

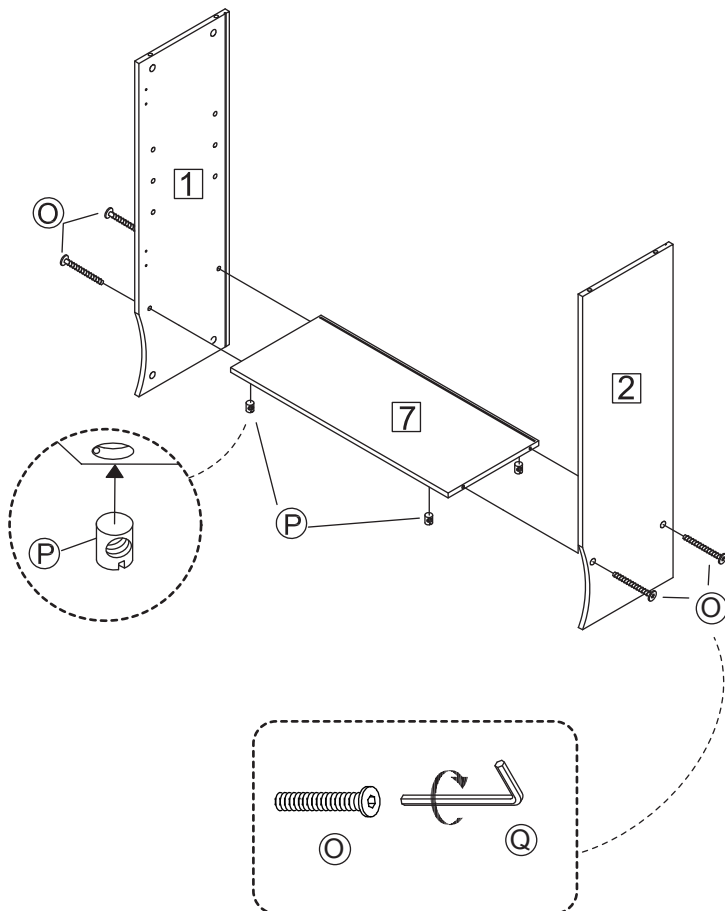

STEP 2

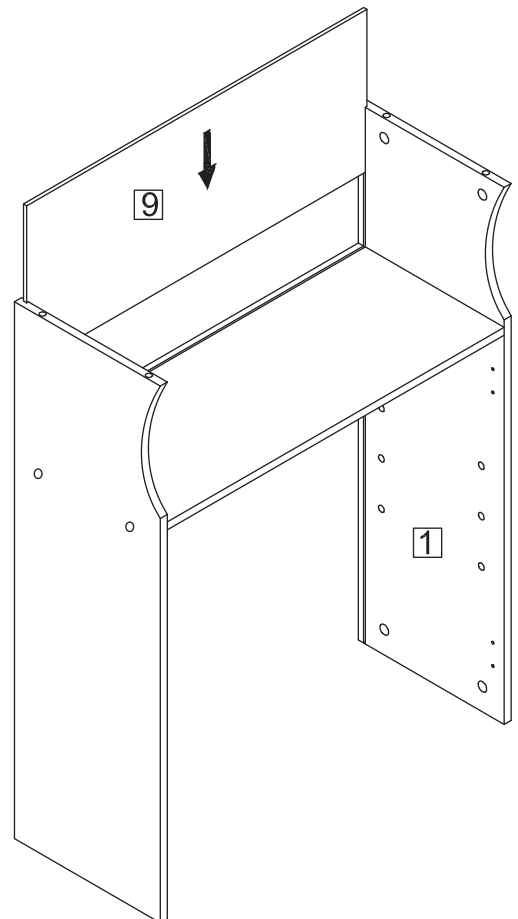

Assembly Instructions

STEP 3

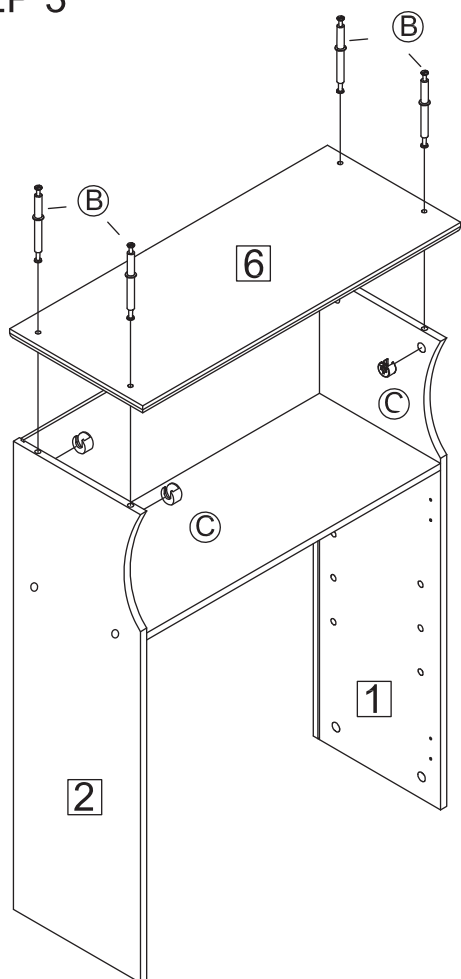

NOTE Proper Cam & Pin alignment
(Parts B & C)

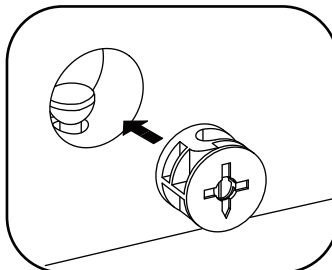

NOTE position of
"pointer arrow"
on Cam (Part C)
points toward
head of Pin (Part B)

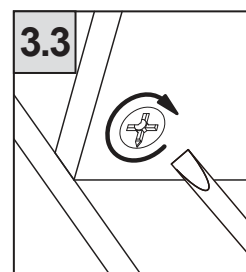
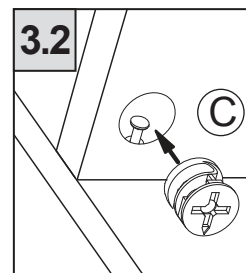
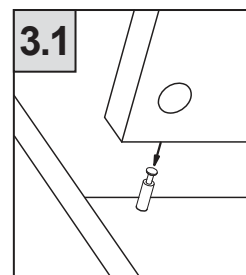

STEP 4

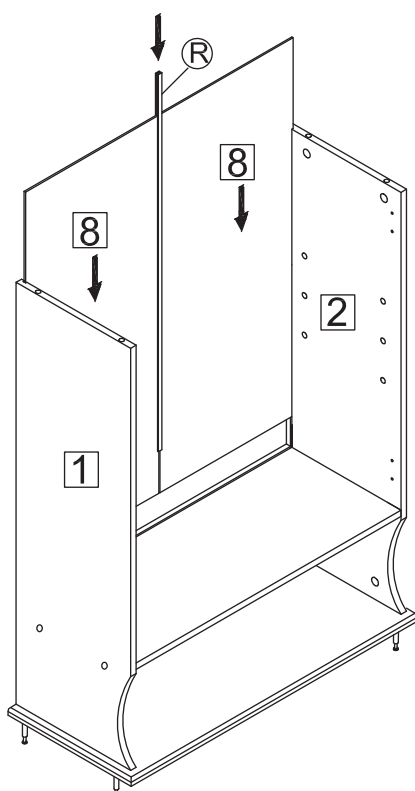

STEP 5

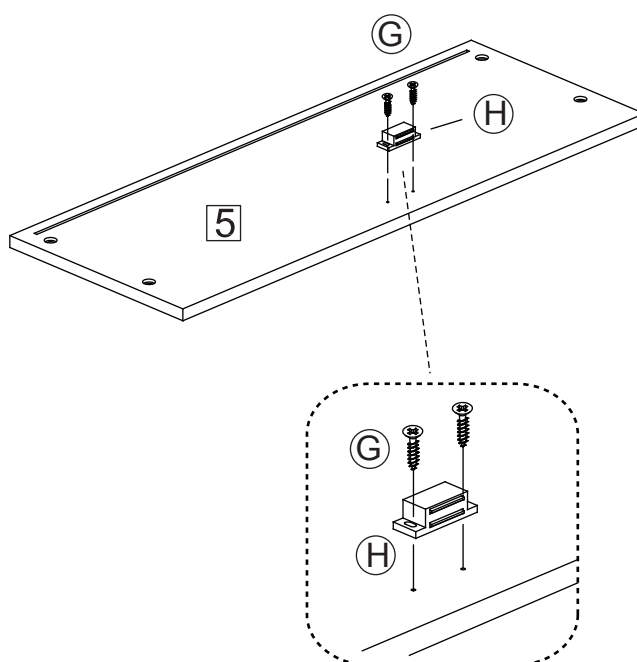

Assembly Instructions

STEP 6

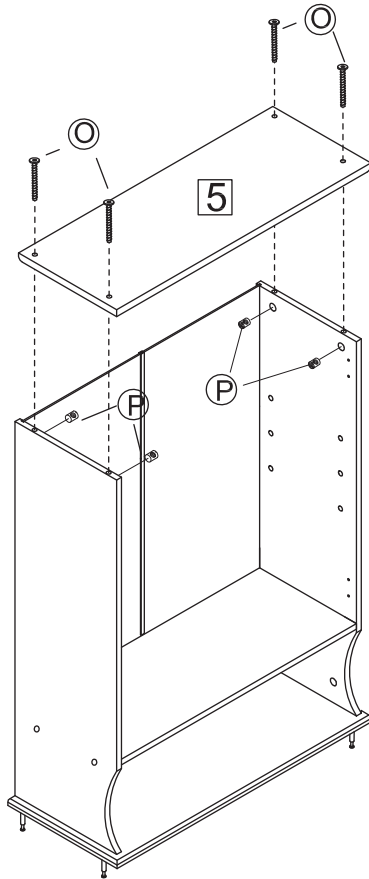

STEP 8

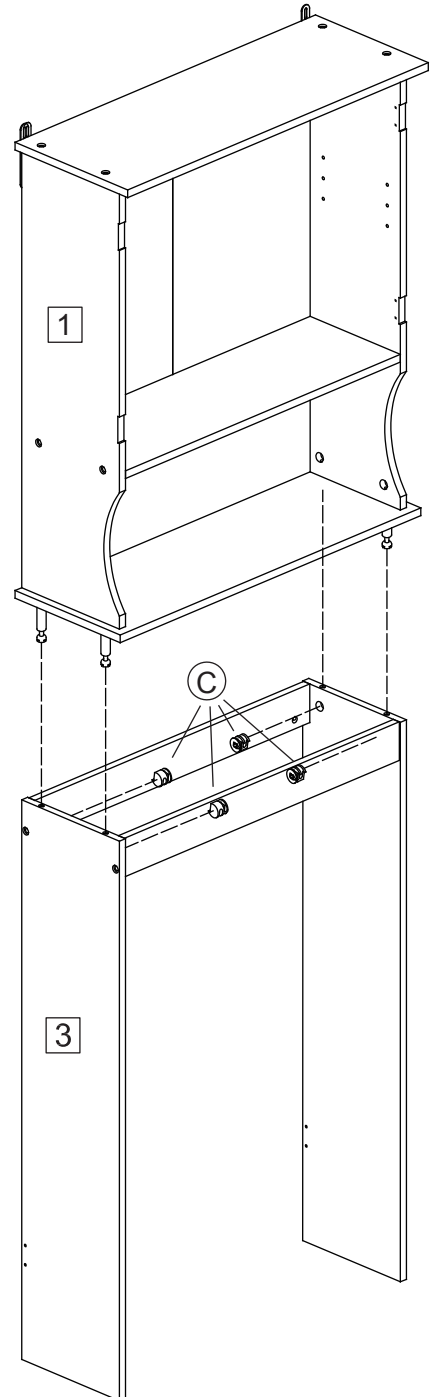

STEP 7

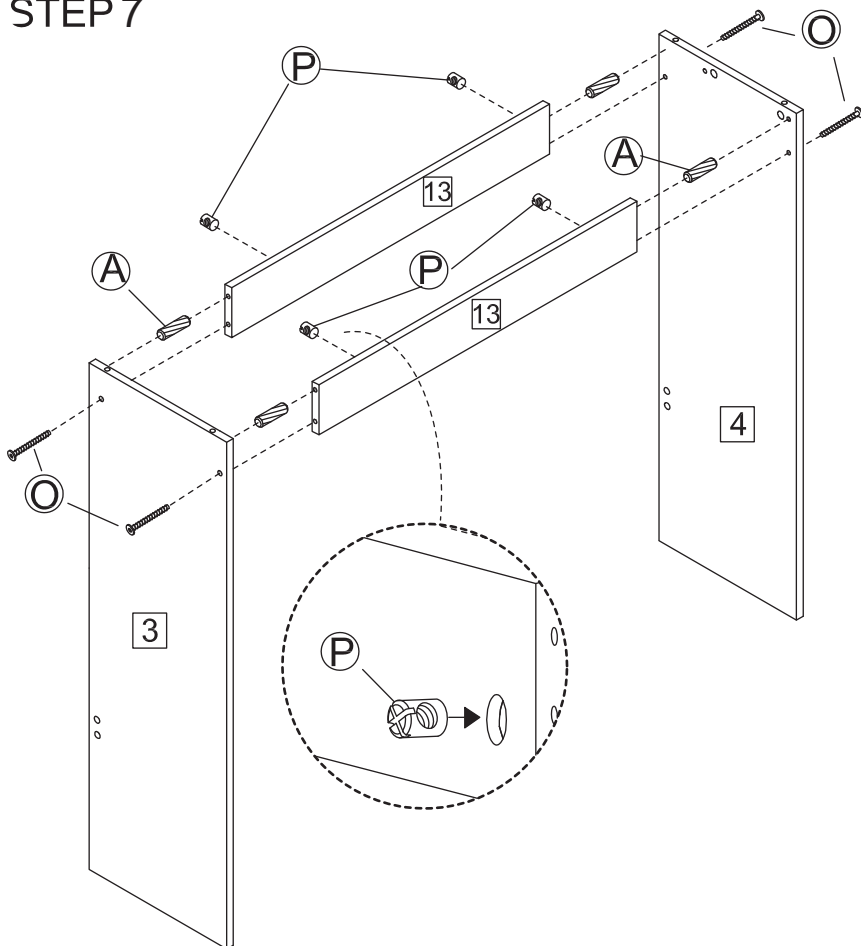

Assembly Instructions

STEP 9

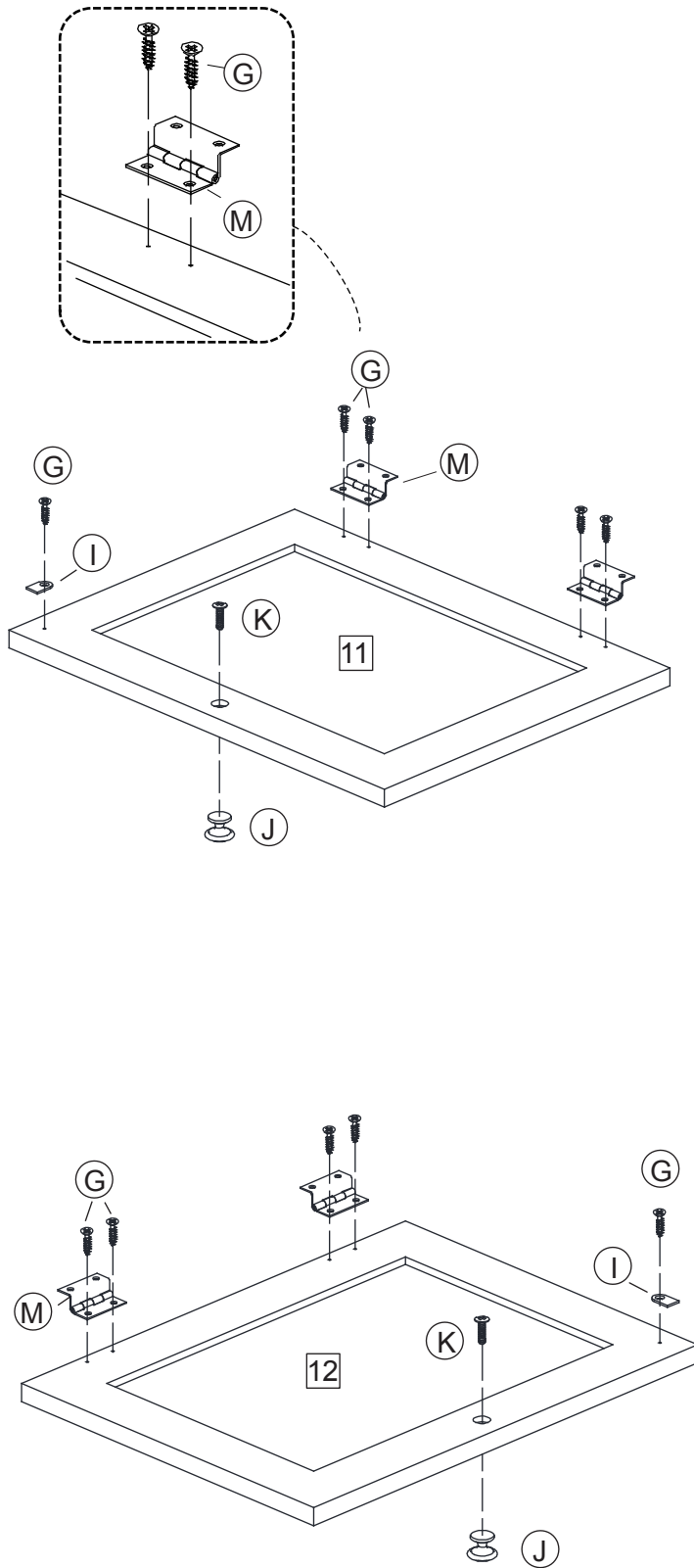

STEP 10

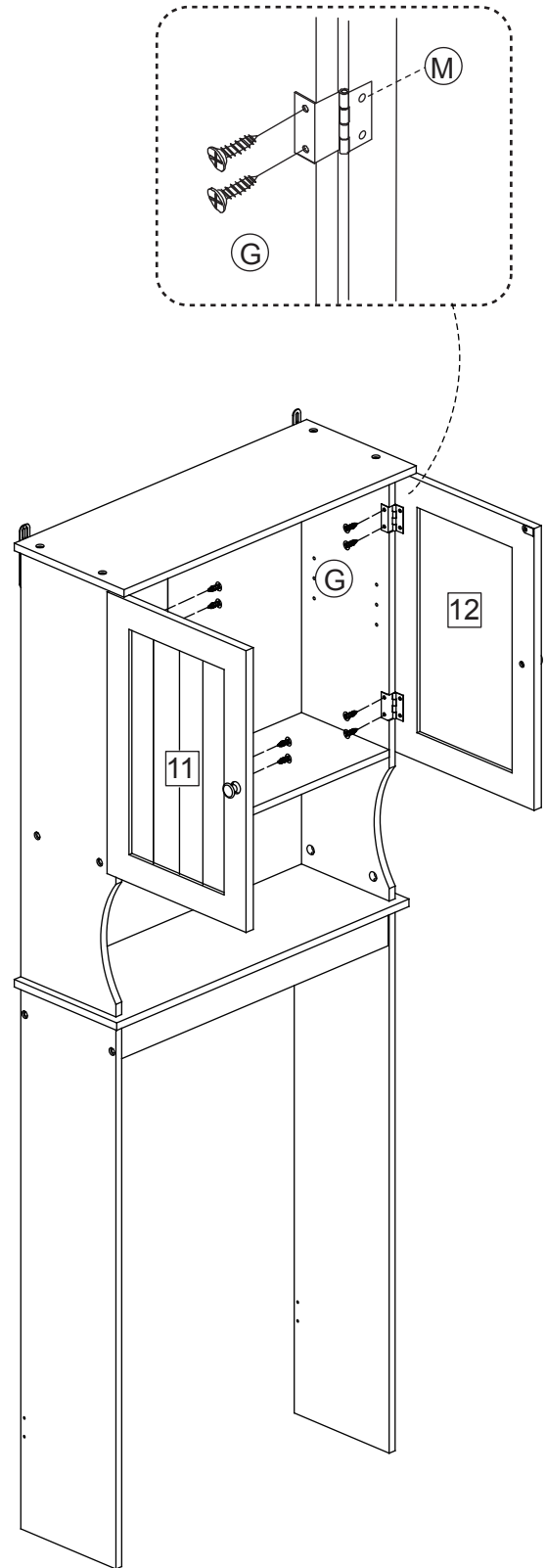

Assembly Instructions

STEP 11

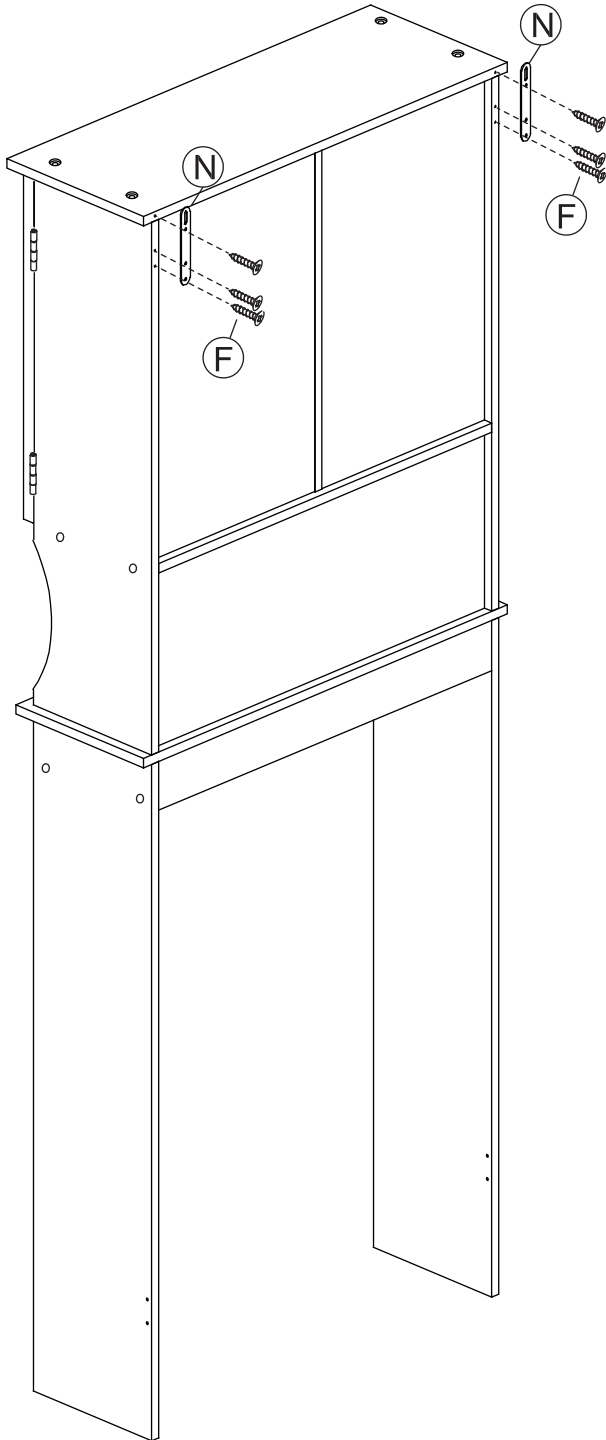

STEP 12

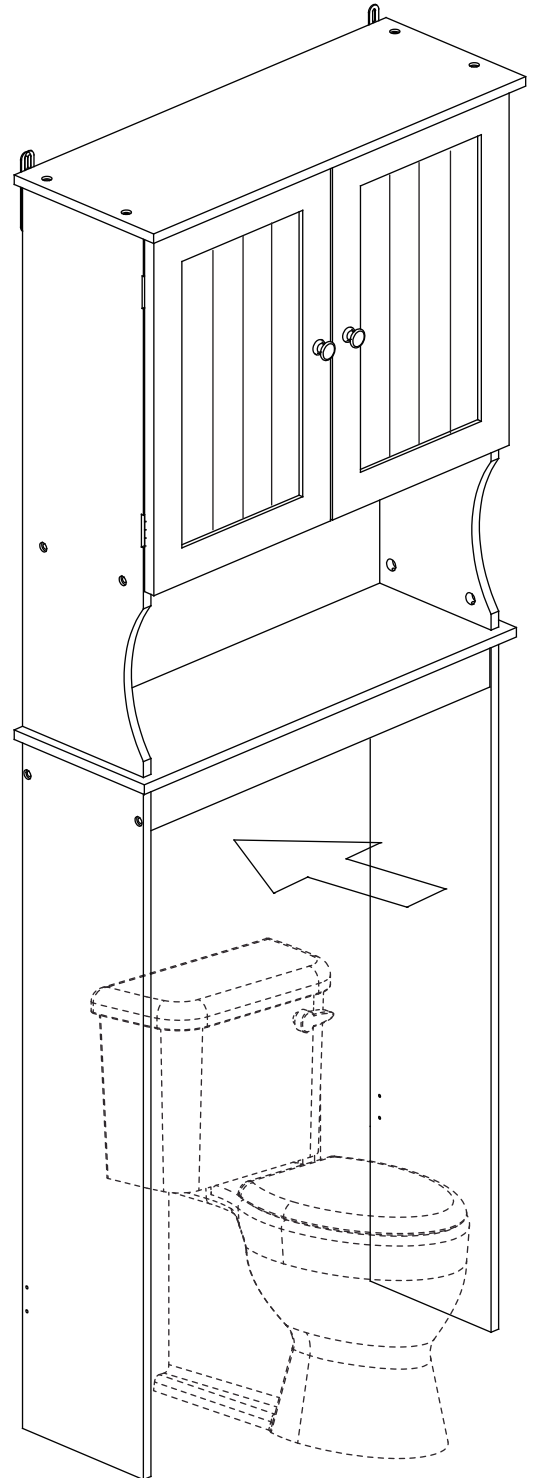

Assembly Instructions

STEP 13

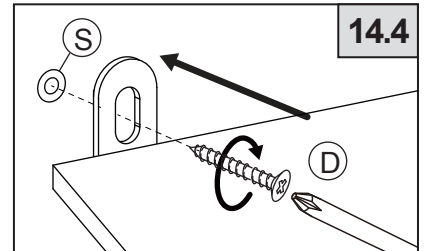
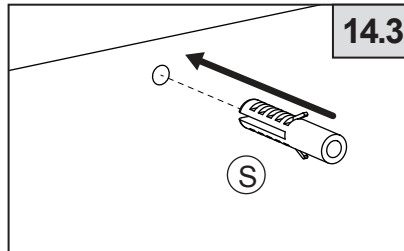
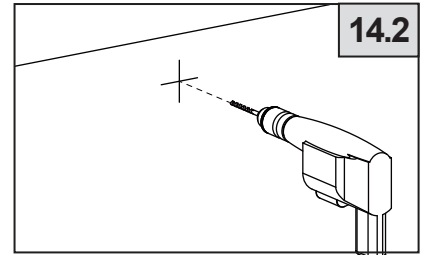
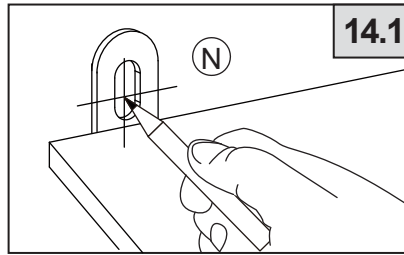

STEP 14

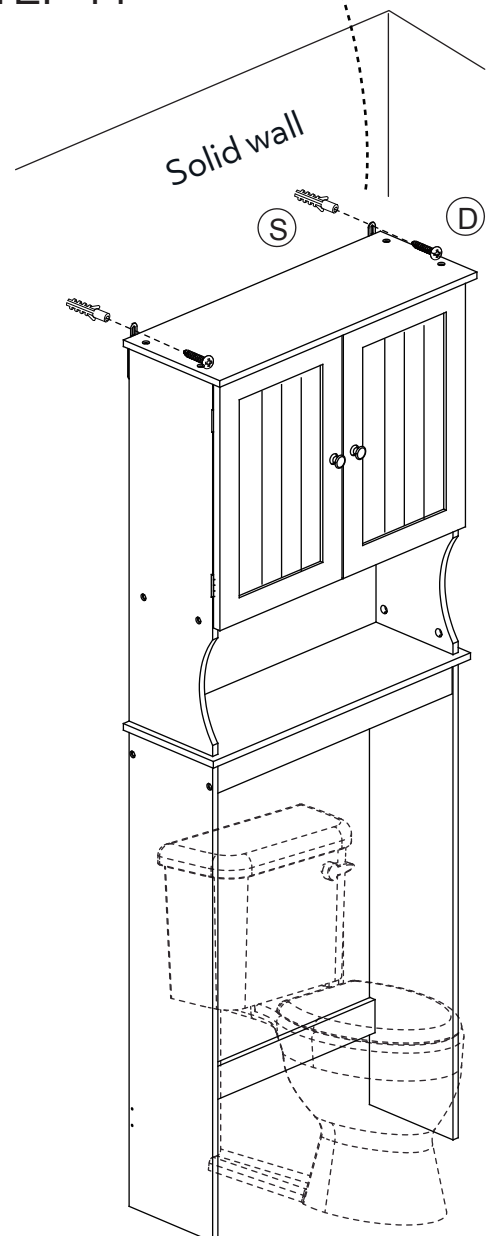
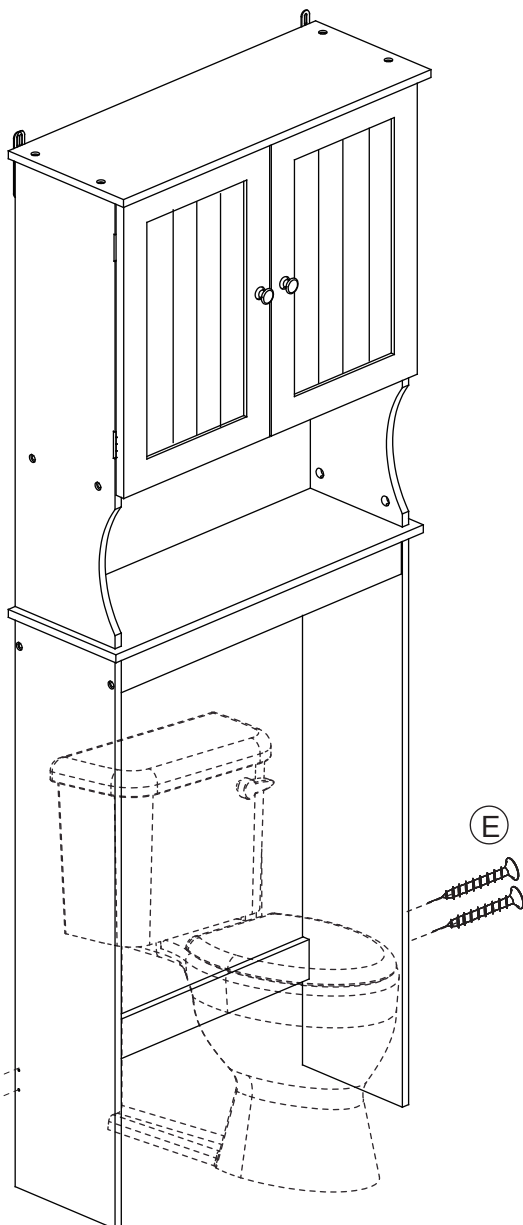

Assembly Instructions

STEP 15

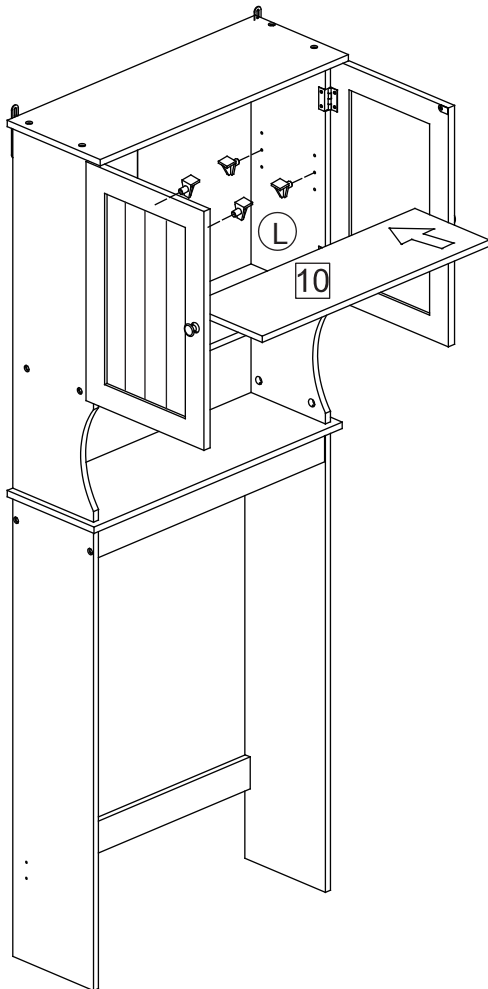

STEP 16

