

Assembly Instructions 40" Shelving Unit

PLEASE NOTE: Check that you have received all components and hardware before assembling. If you are missing any parts, contact your retailer.

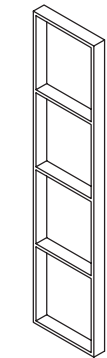

A (1 pc)

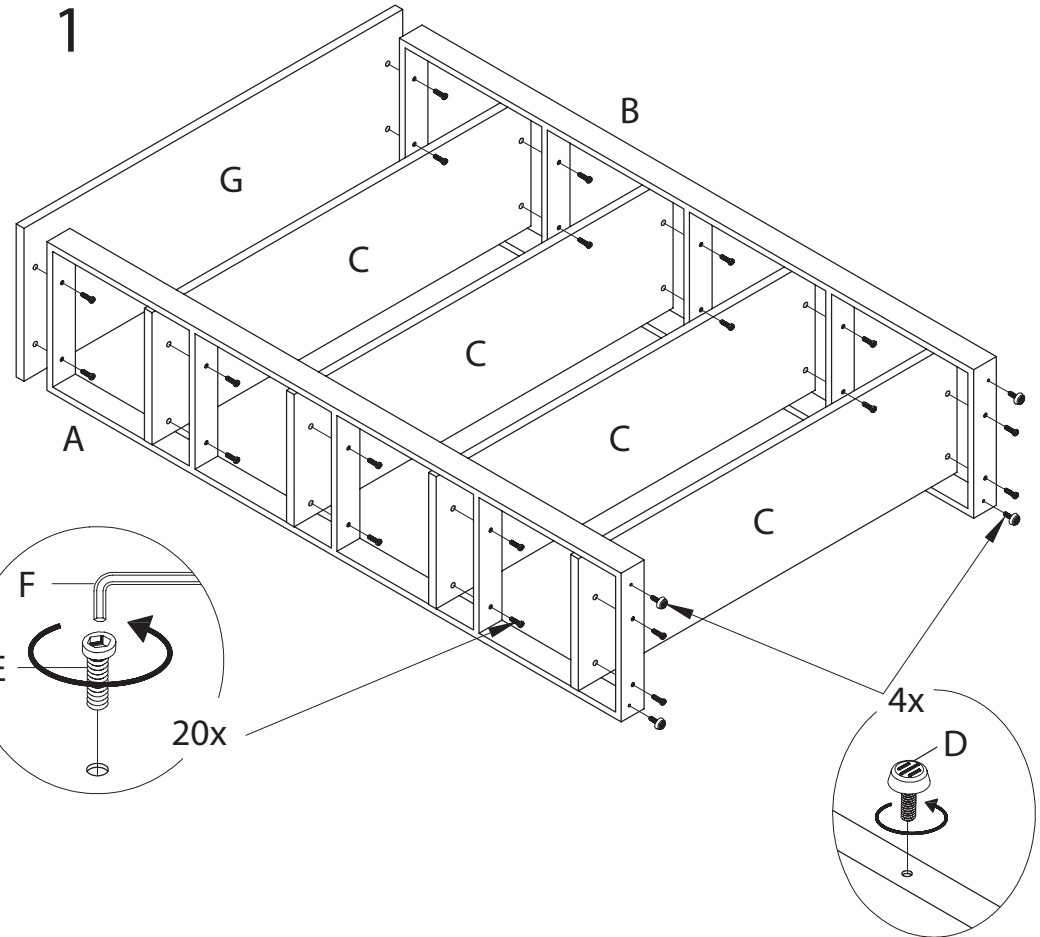
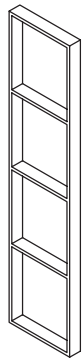

B (1 pc)

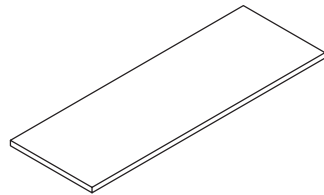

C (4 pcs)



D (4 pcs)
M6 x 15mm

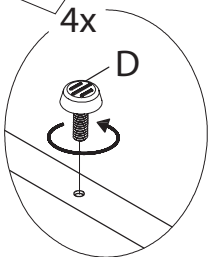
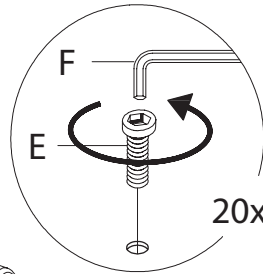

E (40 pcs)
M8 x 15mm

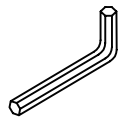

F (1 pc)
M5mm

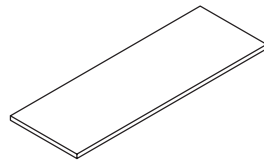

G (1 pcs)

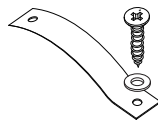

H (2 pcs)

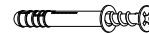

I (2 pcs)

During assembly, hand tighten screws only. When all screws are in place, then tighten completely.

Assembly Instructions 40" Shelving Unit

PLEASE NOTE: Check that you have received all components and hardware before assembling. If you are missing any parts, contact your retailer.



2

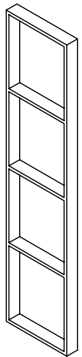

A (1 pc)

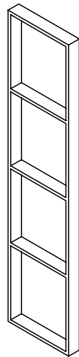

B (1 pc)

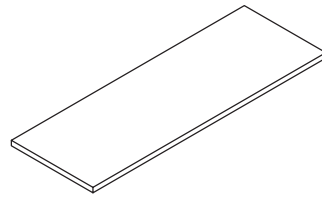

C (4 pcs)



D (4 pcs)
M6 x 15mm



E (40 pcs)
M8 x 15mm

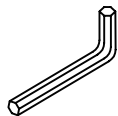

F (1 pc)
M5mm

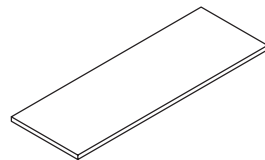

G (1 pcs)

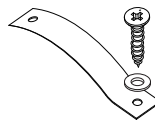

H (2 pcs)

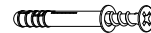

I (2 pcs)

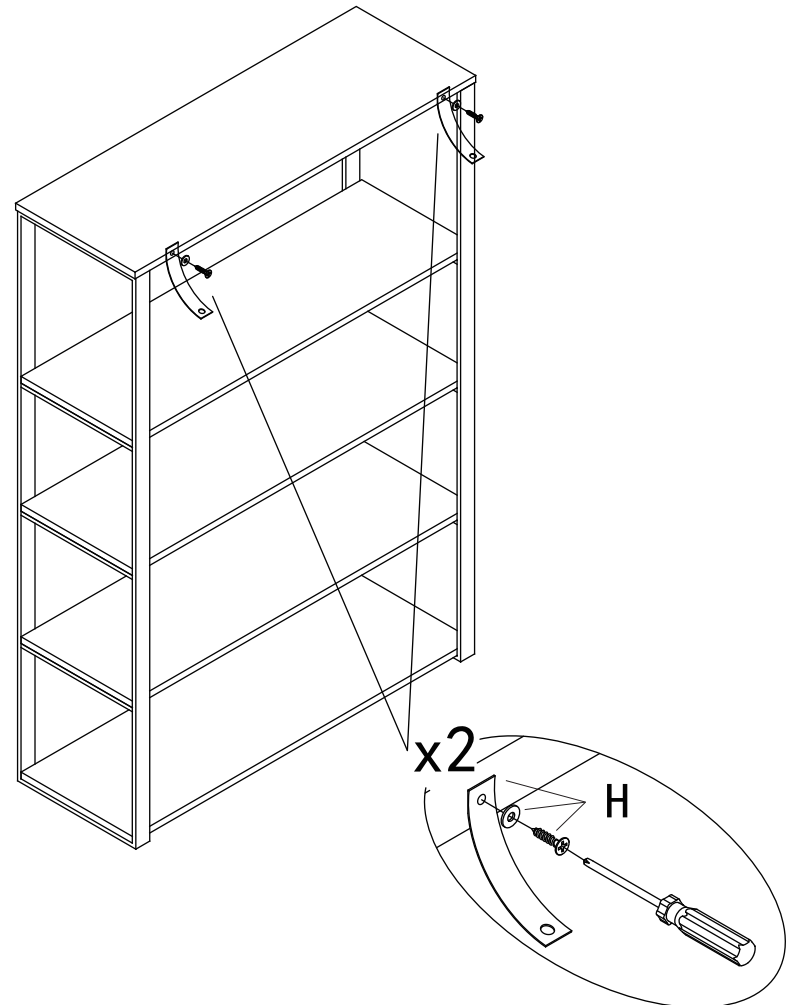

During assembly, hand tighten screws only. When all screws are in place, then tighten completely.

Assembly Instructions 40" Shelving Unit

PLEASE NOTE: Check that you have received all components and hardware before assembling. If you are missing any parts, contact your retailer.



3

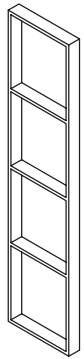

A (1 pc)

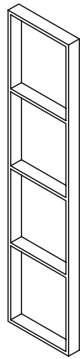

B (1 pc)

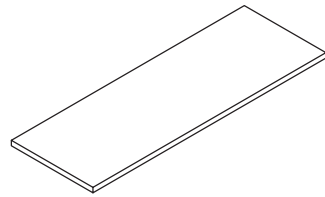

C (4 pcs)



D (4 pcs)
M6 x 15mm



E (40 pcs)
M8 x 15mm

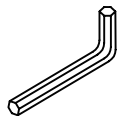

F (1 pc)
M5mm

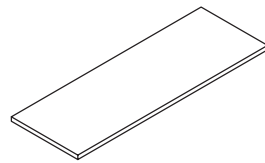

G (1 pcs)

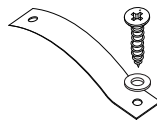

H (2 pcs)

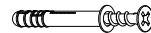

I (2 pcs)

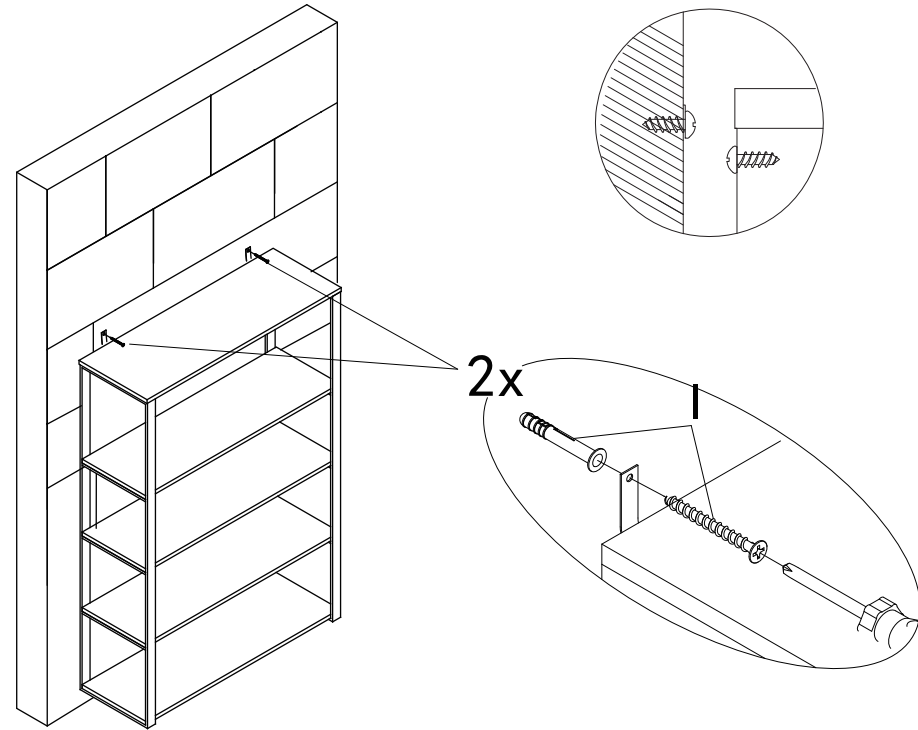

During assembly, hand tighten screws only. When all screws are in place, then tighten completely.